



Martin J. Chávez, Mayor

Robert E. Gurulé, Director

March 14, 1997

R.G. Lee
Lee Engineering
2316 Calle De Rafael NE
Albuquerque, New Mexico 87122

RE: DRAINAGE PLAN FOR AN ADDITION TO MTSO CELLULAR ONE (K17-D68)
ENGINEER'S STAMP DATED 3/14/97

Dear Mr Lee:

Based on the information provided on your March 14, 1997 submittal, the above referenced site is approved for Building Permit.

Please attach a copy of this approved plan to the construction sets prior to sign-off by Hydrology.

Also, prior to Certificate of Occupancy release, Engineer Certification per the DPM will be required.

If I can be of further assistance, please feel free to contact me at 924-3986.

C: Andrew Garcia
File

Sincerely
Bernie J. Montoya
Bernie J. Montoya CE
Engineering Associate

Good for You, Albuquerque!

P.O. Box 1293, Albuquerque, New Mexico 87103



DRAINAGE INFORMATION SHEET

PROJECT TITLE: MT50 Addition ZONE ATLAS/DRNG. FILE #: K17-D68
 DRB #: _____ EPC #: _____ WORK ORDER #: _____
 LEGAL DESCRIPTION: Lots 1,2,3,4 & 5 Blk 41 Valley View Addition
 CITY ADDRESS: 145 Quincy St. NE
 ENGINEERING FIRM: Lee Engineering CONTACT: _____
 ADDRESS: _____ PHONE: _____
 OWNER: Cellular One CONTACT: _____
 ADDRESS: 2125 East Adams St. PHONE: _____
 ARCHITECT: _____ CONTACT: _____
 ADDRESS: _____ PHONE: _____
 SURVEYOR: _____ CONTACT: _____
 ADDRESS: _____ PHONE: _____
 CONTRACTOR: _____ CONTACT: _____
 ADDRESS: _____ PHONE: _____

TYPE OF SUBMITTAL:

☒ DRAINAGE REPORT
☒ DRAINAGE PLAN
☐ CONCEPTUAL GRADING & DRAINAGE PLAN
☐ GRADING PLAN
☐ EROSION CONTROL PLAN
☐ ENGINEER'S CERTIFICATION
☐ OTHER _____

PRE-DESIGN MEETING:

☐ YES
☐ NO
☐ COPY PROVIDED

CHECK TYPE OF APPROVAL SOUGHT:

☐ SKETCH PLAT APPROVAL
☐ PRELIMINARY PLAT APPROVAL
☐ S. DEV. PLAN FOR SUB'D. APPROVAL
☐ S. DEV. PLAN FOR BLDG. PERMIT APPROVAL
☐ SECTOR PLAN APPROVAL
☐ FINAL PLAT APPROVAL
☒ FOUNDATION PERMIT APPROVAL
☐ BUILDING PERMIT APPROVAL
☐ CERTIFICATE OF OCCUPANCY APPROVAL
☐ GRADING PERMIT APPROVAL
☐ PAVING PERMIT APPROVAL
☐ S.A.D. DRAINAGE REPORT
☐ DRAINAGE REQUIREMENTS
☐ SUBDIVISION CERTIFICATION
☐ OTHER _____ (SPECIFY)

DATE SUBMITTED: 3/14/97
 BY: R.G. Lee

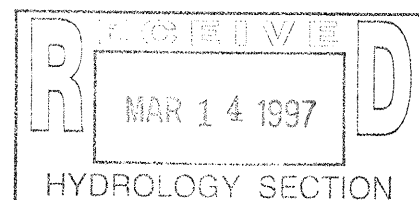

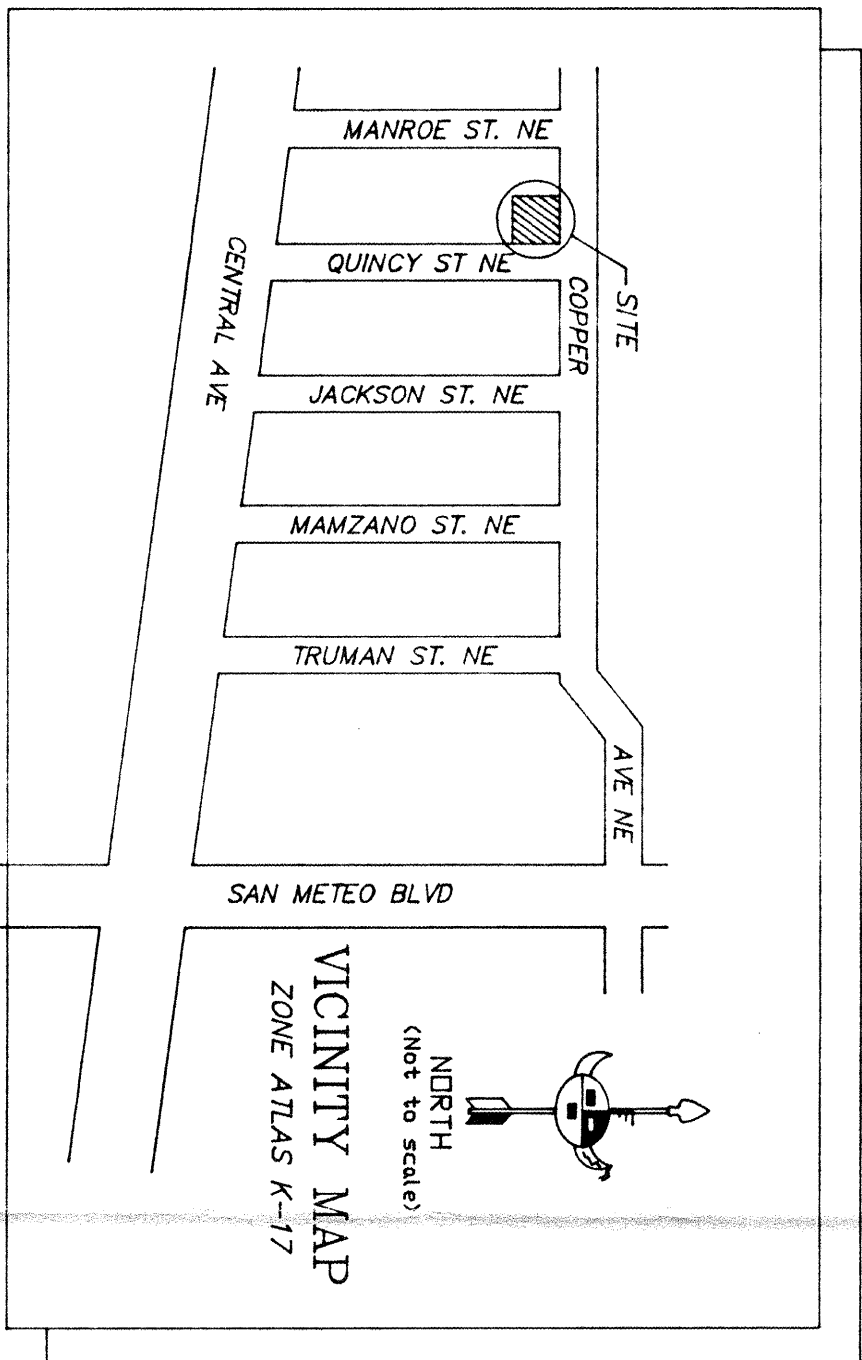

LEGAL DESCRIPTION
 LOTS 1, 2, 3, 4 & 5, BLOCK 41
 VALLEY VIEW ADDITION
 ALBUQUERQUE, BERNALILLO COUNTY,
 NEW MEXICO.

DRAINAGE CALCULATION

- I. REFERENCES:
 - A. SECTION 22.2, HYDROLOGY OF THE DEVELOPMENT PROCESS MANUAL, VOLUME 2, DESIGN CRITERIA FOR THE CITY OF ALBUQUERQUE, NEW MEXICO IN COOPERATION WITH BERNALILLO COUNTY, NEW MEXICO AND THE ALBUQUERQUE BERNALILLO COUNTY FLOOD CONTROL DISTRICT.
 - B. FLOODPLAIN FLOOD BOUNDARY AND FLOODPLAIN FLOOD CONTROL DISTRICT, CITY OF ALBUQUERQUE, NEW MEXICO, PANEL 29 OF 50.
 - C. ZONE ATLAS PAGE K-17-Z.
- II. GENERAL INFORMATION:
 - A. SITE LIES IN ZONE TWO (2) (SEE REF. A, PAGE A-13)
 - B. 100 YEAR, 6 HOUR RAINFALL CRITERIA
 - C. TIME OF CONCENTRATION, $T_c = 0.2 \text{ hr} (12 \text{ MINUTES})$.
- III. IMPERVIOUSNESS:

TREATMENT	SURFACES	SO. FT.	ACRES	EXISTING	PROPOSED
A	UNDEVELOPED	0	0.0000	0	0.0000
B	LANDSCAPING	2,396	0.0550	736	0.0169
C	COMPACTED/VACANT	0	0.0000	0	0.0000
D	IMPERVIOUS	16,354	0.3754	18,014	0.4135
	TOTAL AREA (TA)	18,750	0.4304	18,750	0.4304
- IV. PEAK DISCHARGE 100 YEAR (REF. A, TABLE A-9):

TREATMENT	SURFACES	CFS/AC	EXISTING	PROPOSED
A	UNDEVELOPED	1.59	0.00	0.00
B	LANDSCAPING	2.28	0.13	2.28
C	COMPACTED/VACANT	3.14	0.00	3.14
D	IMPERVIOUS	4.70	1.76	1.94
	PEAK DISCHARGE FROM SITE		1.89 CFS	1.98 CFS
- V. PEAK DISCHARGE 10 YEAR (REF. A, TABLE A-9):

TREATMENT	SURFACES	CFS/AC	EXISTING	PROPOSED
A	UNDEVELOPED	0.38	0.00	0.00
B	LANDSCAPING	0.95	0.05	0.02
C	COMPACTED/VACANT	1.71	0.00	1.71
D	IMPERVIOUS	3.14	1.18	1.30
	PEAK DISCHARGE FROM SITE		1.23 CFS	1.31 CFS
- VI. WEIGHTED "C" 100 YEAR, 6 HR (REF. A, TABLE A-8):

TREATMENT	SURFACES	EXISTING	PROPOSED
A	UNDEVELOPED	0.00	0.00
B	LANDSCAPING	0.00	0.00
C	COMPACTED/VACANT	1.13	0.03
D	IMPERVIOUS	2.12	2.04
	WEIGHTED "C" FACTOR	1.95 IN	2.07 IN
- VI. VOLUME 100 YEAR, V(360) (REF. A, TABLE A-8):

EXISTING	PROPOSED
$1.95 \times 0.43/12 =$	0.07 AC. FT.
	3.045 CU.FT.
$2.07 \times 0.43/12 =$	0.07 AC. FT.
	3.230 CU.FT.

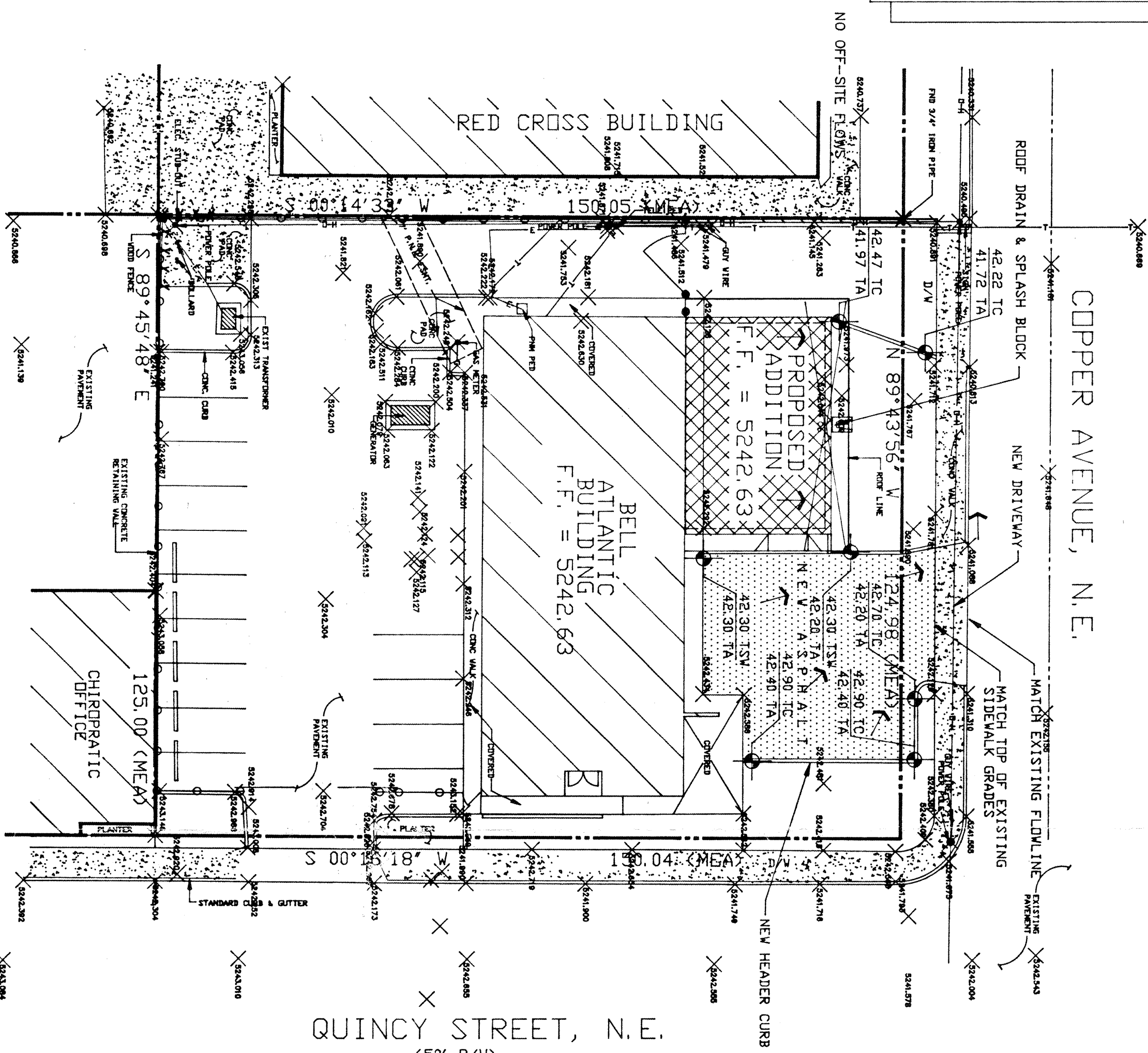

GRADING AND DRAINAGE PLAN

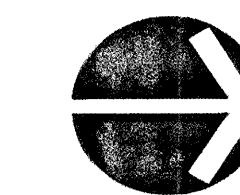
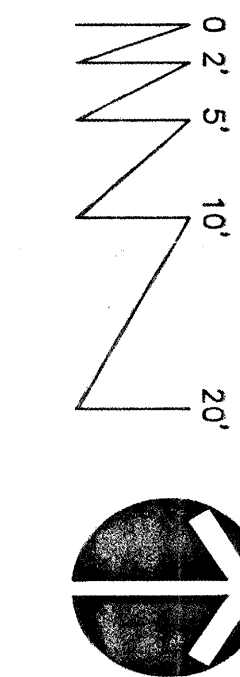

GENERAL NOTES:

1. ADD 5400 TO SPOT ELEVATIONS TO SHOW TRUE ELEVATION.
2. CONTOUR INTERVAL IS ONE (1) FOOT.
3. ELEVATIONS SHOWN ARE BASED ON CITY OF ALBUQUERQUE STATION "12-21", ELEVATION OF 5438.52.
4. UTILITIES SHOWN HEREON ARE IN THEIR APPROXIMATE LOCATION BASED ONLY ON ABOVE GROUND EVIDENCE FOUND IN THE FIELD AND AS-BUILT INFORMATION PROVIDED BY THE CLIENT. UTILITIES SHOWN HEREON, WHETHER INDICATED AS ABANDONED OR NOT, SHALL BE VERIFIED BY OTHERS FOR EXACT LOCATION AND/OR DEPTH PRIOR TO EXCAVATION.

NOTE TO CONTRACTOR

1. An excavation/construction permit will be required before beginning any work within the City right-of-way. Approved copy of this plan must be submitted at the time of application for permit.
2. All work detailed in this plan to be performed, except as otherwise stated or provided hereon, shall be constructed in accordance with City of Albuquerque Standard Specification for Public Works Construction.
3. Two working days prior to any excavation, contractor must contact line locating Services at (505) 260-1990 for locating existing utilities.
4. Prior to construction, the contractor shall excavate and verify the horizontal and vertical location of all construction. Should a conflict exist, the contractor shall notify the engineer so that the conflict can be resolved with a minimum amount of delay.
5. Backfill compaction shall be according to residential use.
6. All work on this project shall be performed in accordance with applicable Federal, State and local laws, rules and regulations concerning construction safety and health.

EROSION CONTROL MEASURES:

THE CONTRACTOR SHALL BE HELD RESPONSIBLE FOR MANAGEMENT OF STORM RUNOFF DURING CONSTRUCTION. HE SHALL INSURE THAT THE FOLLOWING MEASURES ARE TAKEN:

- ADJACENT PROPERTY SHALL BE PROTECTED AT ALL TIMES BY TEMPORARY GRADING AS REQUIRED TO PREVENT STORM RUNOFF TO ADJACENT PUBLIC RIGHT-OF-WAYS.
- ADJACENT PUBLIC RIGHT-OF-WAYS SHALL BE PROTECTED AT ALL TIMES FROM STORM WATER RUNOFF FROM THE SITE AND SEDIMENT BEARING WATER SHALL BE PERMITTED TO ENTER THE PUBLIC STREETS.
- THE CONTRACTOR SHALL IMMEDIATELY AND THOROUGHLY REMOVE ANY DRILL SEDIMENT WITHIN THE PUBLIC STREETS THAT HAVE BEEN ERODED FROM THE SITE AND DEPOSITED THERE.

ACCESSIBLE ROUTE
 THE ACCESSIBLE ROUTE IS A PATH CONNECTING ALL ACCESSIBLE ELEMENTS AND SPACES WITHIN A SITE, BUILDING OR FACILITY THAT IS USABLE BY PERSONS WITH PHYSICAL DISABILITIES. IN THIS FACILITY THE ACCESSIBLE ROUTE CONSISTS OF WALKING SURFACES WITH A SLOPE NOT STEEPER THAN 1:20, RAMP WITH A SLOPE NOT STEEPER THAN 1:12, NO PARKING SPACES AND ACCESS AISLES WITH A SLOPE NOT GREATER THAN 1:48 IN ANY DIRECTION AND CLEAR FLOOR SPACE FOR ACCESSIBLE ELEMENTS. CROSS SLOPES SHALL NOT EXCEED 1:48.

LEGEND

- T-- EXISTING UNDERGROUND TELEPHONE
- D-H- EXISTING OVERHEAD ELECTRICAL TELEPHONE
- E-- EXISTING UNDERGROUND ELECTRIC
- G-- EXISTING GAS
- W-- EXISTING WATER
- SAS- EXISTING SANITARY SEWER
- CONCRETE

X 5125 236 SPOT ELEVATIONS

DESIGN ELEVATIONS

ABBREVIATIONS

- TC TOP OF CURB
- TA TOP OF ASPHALTIC CONCRETE
- TCBC TOP OF CURB AT BACK OF CURB
- FL FLOW LINE

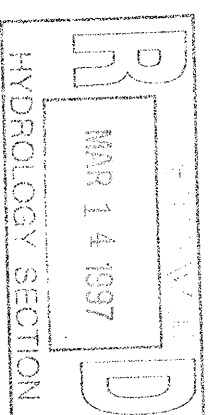

CELLULARONE®
 2125 East Adams Street
 Phoenix, Arizona 85034
 (602)-902-9882
 Fax (602)-902-9802

INTERNAL REVIEWS	INITIALS	DATE
DEPARTMENT		
SITE ACQUISITION		
CONSTRUCTION		
ZONING		
CELLULARONE		
OWNER		
SOILS ENGINEER		
R.F. ENGINEER		

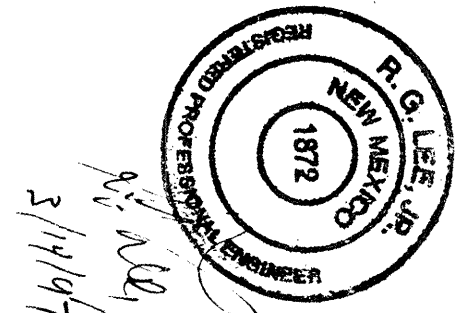

OWNERS PROJECT #
 950253

SITE NAME
 ALBUQUERQUE
 MTSO
 STREET ADDRESS
 145 QUINCY ST. NE
 ALBUQUERQUE, N.M.

phoenix o design
 o group
 1625 E. Via Linda, Suite 105
 Scottsdale, AZ 85238
 P.O. Box 14100
 Phoenix, AZ 85062
 1351 Chandler, AZ 85224
 Fax: 602-998-1567

DRAWING DATE	10/15/96
REVISIONS	
NO.	DATE
1	
2	
3	
ARCHITECTS JOB NO.	PDC-399
SHEET TITLE	DRAINAGE PLAN
SHEET NUMBER	DP