

For each dwelling with net leasable area of less than 1,000 square feet:
one space per bath but not less than one and one-half spaces.

Unit A- 920sq.ft. 1-1/2 spaces
Unit B- 780sq.ft. 1-1/2 spaces
Unit C- 800sq.ft. 1-1/2 spaces

Total 4-1/2 spaces **REQUIRED (six (6) shown)**

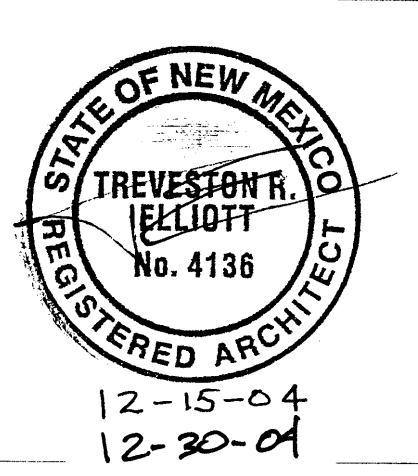
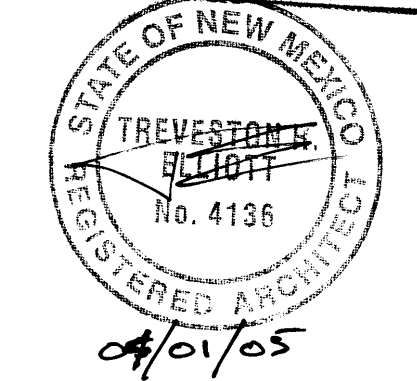
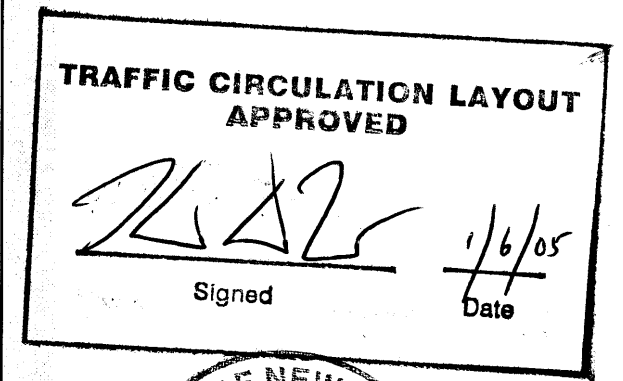
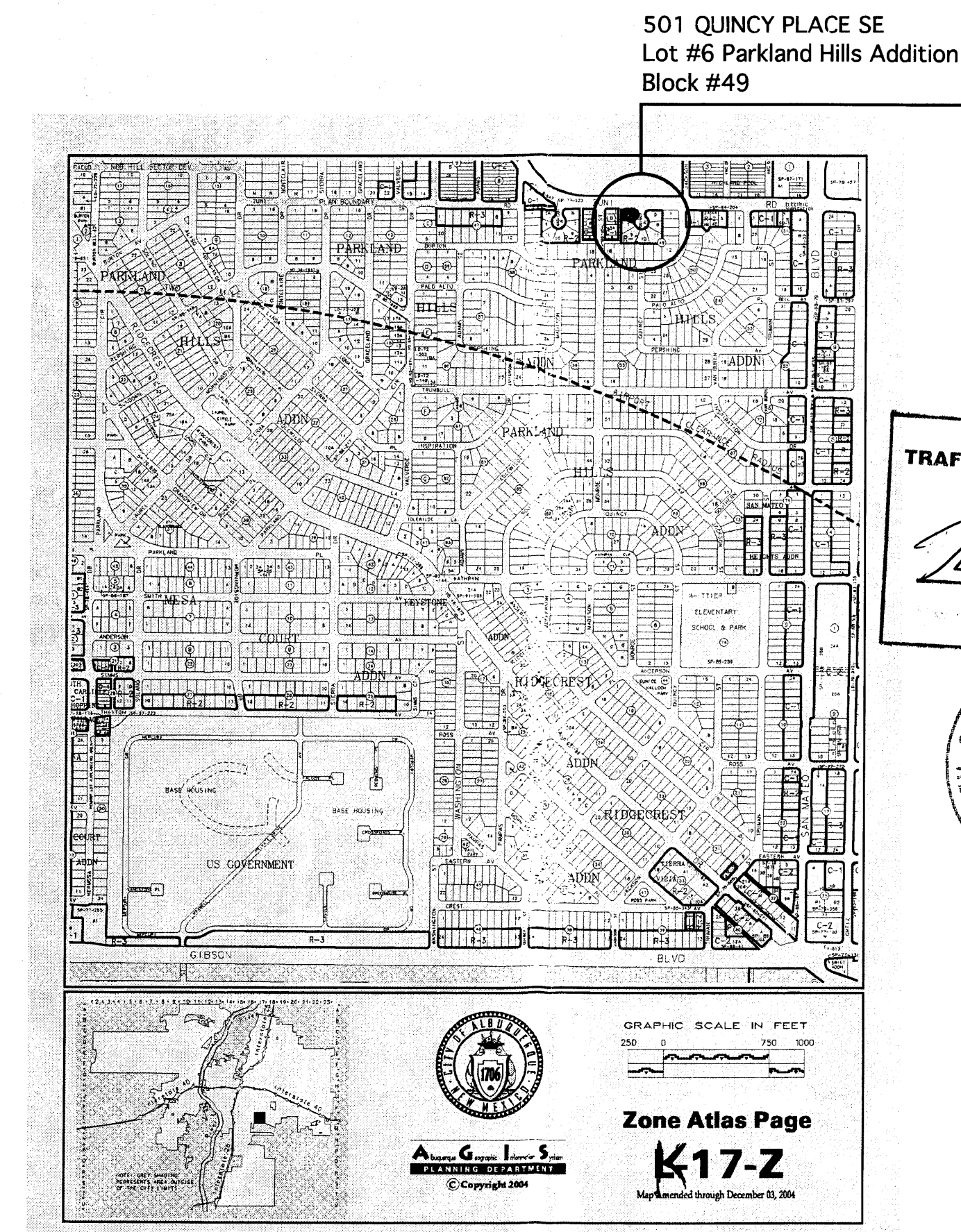

Date:
14 December 2004
Sheet:
TCL PLAN

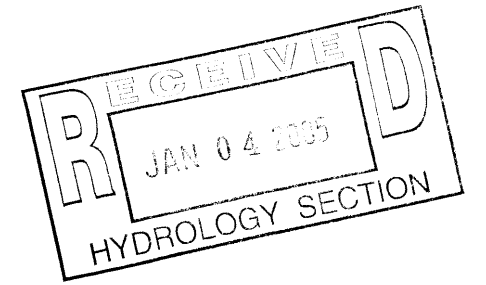

Public infrastructure shown
on these plans for information
only and not part of approval.
Separate DFC Permit required
with Work Order request.

