



# City of Albuquerque

P.O. BOX 1293 ALBUQUERQUE, NEW MEXICO 87103

October 1, 1993

Bob Ryals  
Ryals Engineering  
4929 Idlewilde SE  
Albuquerque, NM 87108

RE: GRADING/PAVING FOR FIRST NATIONAL BANK @ 4401 CENTRAL AVE. NE  
(K18-D65) ENGINEER'S STAMP DATED 9/28/93.

Dear Mr. Ryals:

Based on the information provided on your September 29, 1993 submittal, the above referenced site is approved for Grading/Paving.

Please be advised that no developed run-off is allowed to discharge across a public sidewalk.

Also, Engineer Certification per the D.P.M. checklist will be required after construction.

If I can be of further assistance, please feel free to contact me at 768-2667.

Sincerely,

Bernie J. Montoya, CE  
Engineer Associate

BJM/d1/WPHYD/8020

xc: Alan Martinez  
File

PUBLIC WORKS DEPARTMENT

PROJECT TITLE: FIRST NATL BANK ZONE ATLAS/DRNG. FILE #: K-18 / D65  
JOB #: N/A EPC #: N/A WORK ORDER #: N/A  
LEGAL DESCRIPTION: 7000 TIJERAS PLACE Addition (see attached survey)  
CITY ADDRESS: 4401 CENTRAL AVE NE  
ENGINEERING FIRM: Ryals Engineering CONTACT: Bob Ryals  
ADDRESS: 4929 Idlewild SE PHONE: 265-8267  
OWNER: GULFSTREAM Worldwide CONTACT: Bill Whittington  
ADDRESS: 4401 CENTRAL AVE NE PHONE: 255-5422  
ARCHITECT: N/A CONTACT: N/A  
ADDRESS: \_\_\_\_\_ PHONE: \_\_\_\_\_  
SURVEYOR: Ryals Eng CONTACT: Bob Ryals  
ADDRESS: \_\_\_\_\_ PHONE: \_\_\_\_\_  
CONTRACTOR: ALBQ Asphalt CONTACT: Bob  
ADDRESS: 202 94 SW PHONE: 831-7311

## TYPE OF SUBMITTAL:

- ☐ DRAINAGE REPORT  
☐ DRAINAGE PLAN  
☐ CONCEPTUAL GRADING & DRAINAGE PLAN  
☒ GRADING PLAN  
☐ EROSION CONTROL PLAN  
☐ ENGINEER'S CERTIFICATION  
☐ OTHER

## PRE-DESIGN MEETING:

- ☐ YES  
☐ NO  
☐ COPY PROVIDED

## CHECK TYPE OF APPROVAL SOUGHT:

- ☐ SKETCH PLAT APPROVAL  
☐ PRELIMINARY PLAT APPROVAL  
☐ S. DEV. PLAN FOR SUB'D. APPROVAL  
☐ S. DEV. PLAN FOR BLDG. PERMIT APPROVAL  
☐ SECTOR PLAN APPROVAL  
☐ FINAL PLAT APPROVAL  
☐ FOUNDATION PERMIT APPROVAL  
☐ BUILDING PERMIT APPROVAL  
☐ CERTIFICATE OF OCCUPANCY APPROVAL  
☐ GRADING PERMIT APPROVAL  
☒ PAVING PERMIT APPROVAL  
☐ S.A.D. DRAINAGE REPORT  
☐ DRAINAGE REQUIREMENTS  
☐ OTHER \_\_\_\_\_ (SPECIFY)

DATE SUBMITTED:

8-28-93

BY:

BBG(2 COPIES  
ATTACHED)

# GENERAL NOTES

1. An excavation/construction permit will be required before beginning any work within City of Albuquerque right-of-way. An approved copy of these plans must be submitted at the time of application for this permit.
2. All work detailed on these plans to be performed, except as otherwise stated or provided herein, shall be constructed in accordance with the City of Albuquerque Standard Specifications for Public Works Construction, most recent edition.
3. Two working days prior to any excavation, contractor must contact Line Locating Service (260-1990) for location of existing utilities.
4. Prior to construction, the contractor shall excavate and verify the horizontal and vertical locations of all obstructions. Should a conflict exist, the contractor shall notify the Engineer so that the conflict can be resolved with a minimum amount of delay.
5. Backfill compaction shall be according to residential street use.
6. Maintenance of these facilities shall be the responsibility of the Owner of the property served.
7. Verify all flowline elevations and slopes prior to construction. Consult with engineer regarding discrepancies immediately, before final layout or start of construction.
8. All onsite curbs and sidewalks are 6" above adjacent pavement. All onsite curbs are 6" header curbs per Dwg 2415 except as shown.
9. Curbs & sidewalks in the ROW are per City Standards.

SAN MATEO BLVD. N.E.

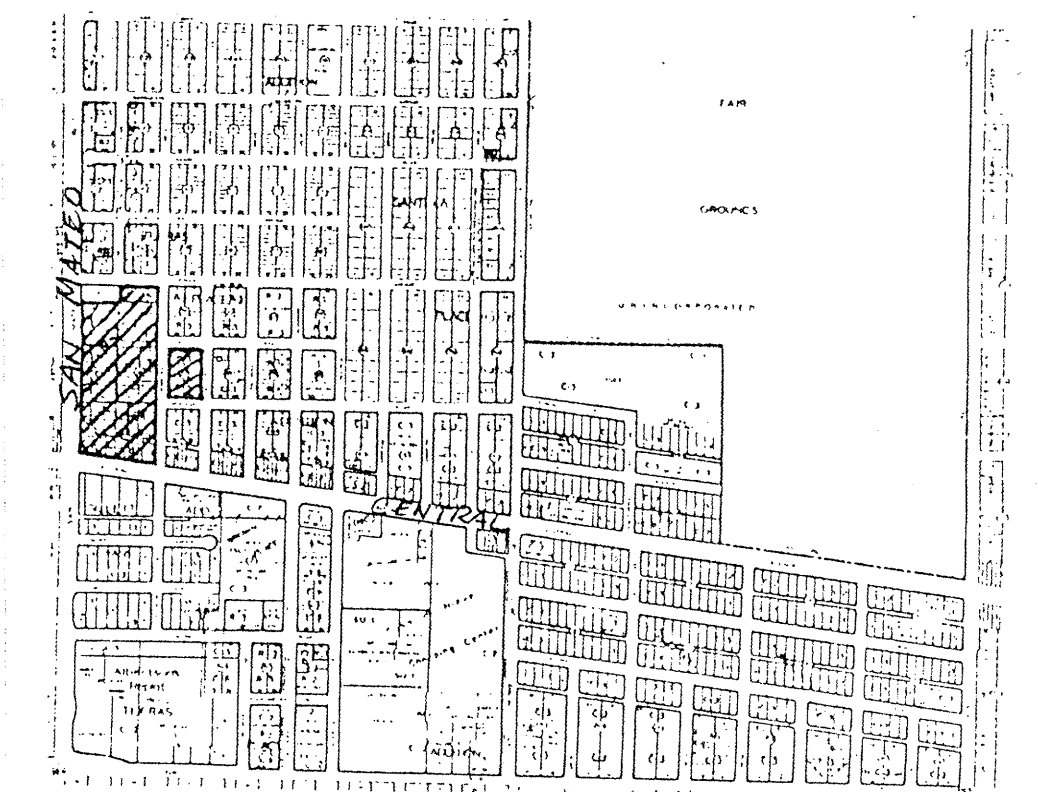

VICINITY MAP

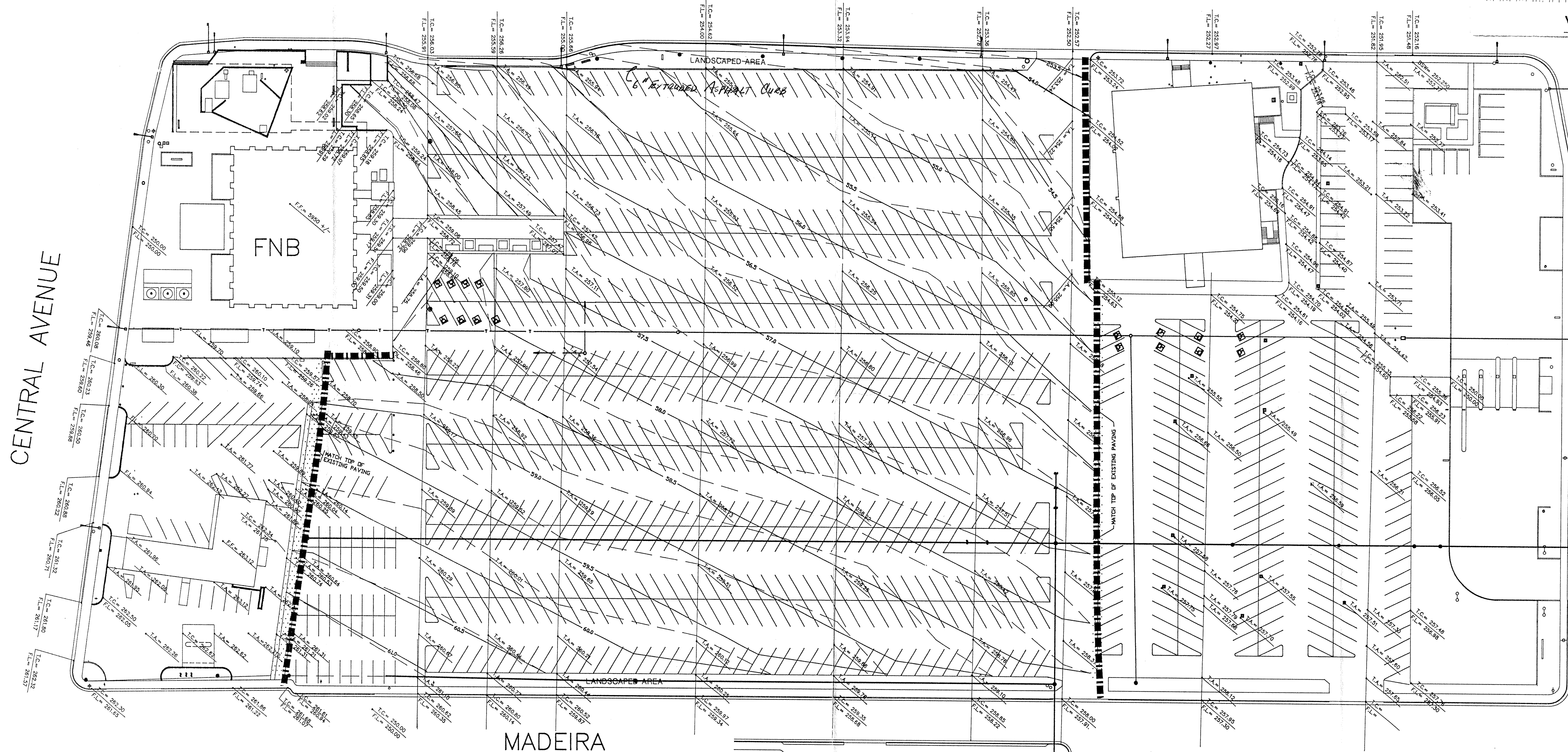

BM=ACS#6-K-18  
200' E. OF SAN MATEO  
IN CENTRAL MEDIAN

LIMIT OF 2" ASPHALT OVERLAY  
ON RECYCLED EXISTING ASPHALT

SCALE: 1"=40'  
0 10 20 40

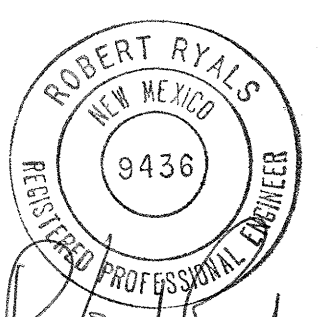

DESIGN BY: R.R.	<b>GRADING PLAN</b> WITHIN <b>TIJERAS PLACE ADDITION</b> ALBUQUERQUE, NEW MEXICO JUNE, 1993	SHEET NO. 10F -
DRAWN BY: SUM & DJH		
<b>RYALS</b> engineering & construction services 4929 Idlewild S.E. Albuquerque, NM 87108 (505) 265-8267 269-1142 mobile telephone		