

**DOMINGO B RECONSTRUCTION GRADING AND DRAINAGE**

The eastern building on Lot 7-A was destroyed by fire. The building is being reconstructed with the same size and type of building. The majority of the parking lot is undamaged and will remain in place. The portion of the parking lot east of the proposed reconstruction is in disrepair and is uneven. This portion of the parking lot will be re-paved with improvements in the grades to prevent water pooling along the eastern side of the building.

Currently the majority of runoff flows in this eastern area discharge sporadically over the sidewalk to California St. NE which in turn discharges flows to Domingo Road NE which runs along the northern edge of the property. Domingo Road slopes from east to west. The remaining flows on the eastern side parking lot are pooled along the eastern edge of the building until spilling to the east around the NE edge of the building. This is caused by an irregular highpoint approximately 15-20 feet from the building. This flow ultimately drains via the northern drive pad to Domingo NE.

The proposed grading concentrates flows from the eastern area to a proposed landscaped area, along the north-east and northern boundary between the parking lot and the sidewalk, with a consistent slope away from the building. The landscaping is graded to be slightly depressed (0.5' deep) at the north-east corner with a landscaping swale that will drain overflow to the west and ultimately to the northern drive pad where flows are currently being discharged to Domingo Road NE. This improves conditions for the building and does not change the existing condition where all flows ultimately discharge to Domingo Road NE. In addition this configuration provides water quality benefit by the use of the landscaping swale to slow flows and allow filtration by planted vegetation.

Concurrent with this work, three existing but unused drive pads will be closed under a separate permit.

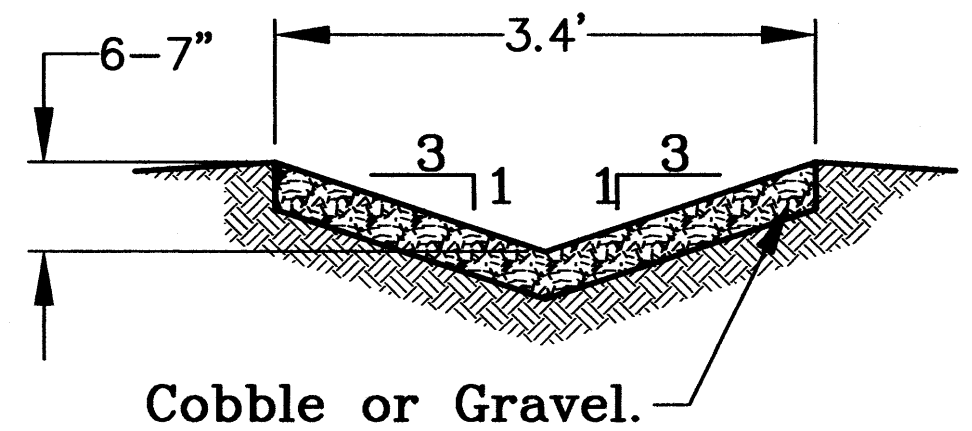

**WQ SWALE SECTION A-A'**

NTS

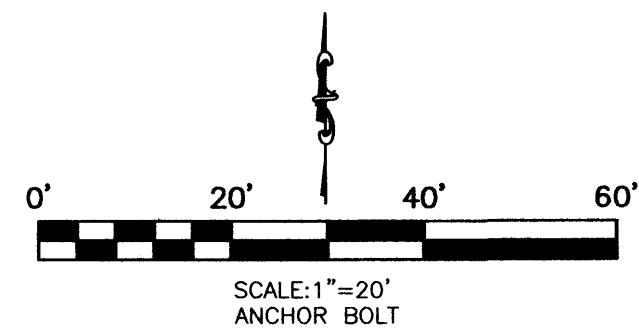

<b>BENCHMARK</b> ACS STATION 5_K18A ELEV.= 5280.174 NAVD 1988		<b>SCALES:</b> 1" = 20' CONT. INT. = 1'		<b>Easterling Consultants LLC</b> Engineering and Environmental Consulting 3613 NMSR 528 NW, Suite E-2 Albuquerque, New Mexico 87114 (505) 821-6646 FAX (505) 897-2965		<b>DOMINGO B RECONSTRUCTION</b> ALBUQUERQUE, NEW MEXICO <b>DOMINGO B RECONSTRUCTION</b> 6320 B Domingo Road NE GRADING AND DRAINAGE PLAN		 © COPYRIGHT Sheet C1 of C1	
<b>NO.</b>		<b>REVISIONS</b>		<b>BY</b>		<b>DATE</b>		<b>File No.</b> 140-11-01	
								<b>Date:</b> JUNE 2011	

<b>A0</b>	<b>Cover Sheet-Site Plan</b>
<b>S1</b>	<b>Survey of Existing Concrete Slab</b>
<b>A1</b>	<b>Floor Plan</b>
<b>A2</b>	<b>Anchor Bolt Placement Plan</b>
<b>A3</b>	<b>Anchor Bolt Insert Details</b>
<b>A4</b>	<b>Building Elevations</b>
<b>A5</b>	<b>Roof Plan</b>

E1 of 13	Cover Sheet	AB1 of 3	Anchor Bolt Plan
E2 of 13	Roof Framing	AB2 of 3	Anchor Bolt Details
E3 of 13	Rigid Frame Elevation	AB3 of 3	Anchor bolt Reactions
E4 of 13	Rigid Frame Elevation		
E5 of 13	Rigid Frame Elevation		
E6 of 13	Side Wall Framing		
E7 of 13	Side Wall Framing		
E8 of 13	End Wall Framing		
E9 of 13	End Wall Framing		
E10 of 13	Detail Drawings		
E11 of 13	Detail Drawings		
E12 of 13	Detail Drawings		
E13 of 13	Detail Drawings		

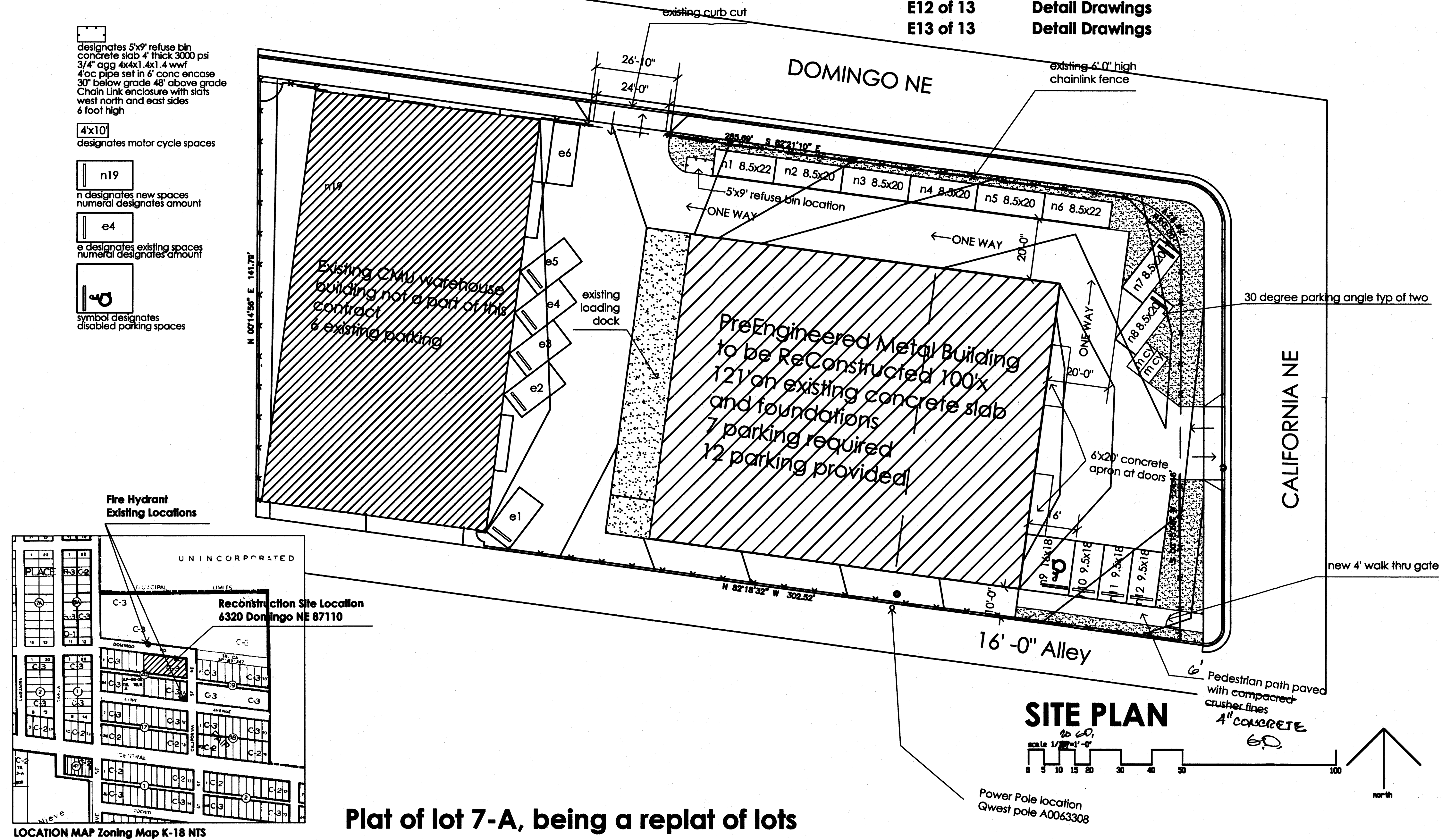

**Plat of lot 7-A, being a replat of lots  
7 through 12, inclusive, Block 20  
Fairgrounds Addition  
within section 24 T10N N. M. PM  
Albuquerque, New Mexico**

## **Zoning C3, Zoning atlas K-18 Near Heights Metropolitan Redevelopment Area**

**TRAFFIC CIRCULATION LAYOUT  
APPROVED**

  
\_\_\_\_\_  
Signed

06-16-11  
\_\_\_\_\_  
Date

**Public Infrastructure shown  
on these plans for Information  
only and not part of approval.  
Separate DRC/Permit approval  
and Work Order required.**

**ALL WHEELCHAIR RAMPS LOCATED  
WITHIN THE PUBLIC RIGHT OF WAY  
MUST HAVE TRUNCATED DOMES.**

MAY 21, 2011

RECEIVED  
MAY 23 2011  
HYDROLOGY  
SECTION

OWNER: Gene and Dorothy Dyer  
1208 San Pedro NE  
Albuquerque, New Mexico 87110  
505 262 2027 gene\_dyer@usa.net

DYER+DYER ARCHITECTS  
1208 San Pedro NE  
Albuquerque, New Mexico 87110  
505 262 2027 [gene\\_dyer@usa.net](mailto:gene_dyer@usa.net)

**PROJECT:**  
Domingo B Reconstruction  
6320 B Domingo Av NE  
Albuquerque, NE 87108

COVER SHEET-SITE PLAN  
scale 1" = 20'-0"

A-0



<b>A0</b>	<b>Cover Sheet-Site Plan</b>
<b>S1</b>	<b>Survey of Existing Concrete Slab</b>
<b>A1</b>	<b>Floor Plan</b>
<b>A2</b>	<b>Anchor Bolt Placement Plan</b>
<b>A3</b>	<b>Anchor Bolt Insert Details</b>
<b>A4</b>	<b>Building Elevations</b>
<b>A5</b>	<b>Roof Plan</b>

E1 of 13	Cover Sheet	AB1 of 3	Anchor Bolt Plan
E2 of 13	Roof Framing	AB2 of 3	Anchor Bolt Details
E3 of 13	Rigid Frame Elevation	AB3 of 3	Anchor bolt Reactions
E4 of 13	Rigid Frame Elevation		
E5 of 13	Rigid Frame Elevation		
E6 of 13	Side Wall Framing		
E7 of 13	Side Wall Framing		
E8 of 13	End Wall Framing		
E9 of 13	End Wall Framing		
E10 of 13	Detail Drawings		
E11 of 13	Detail Drawings		
E12 of 13	Detail Drawings		
E13 of 13	Detail Drawings		

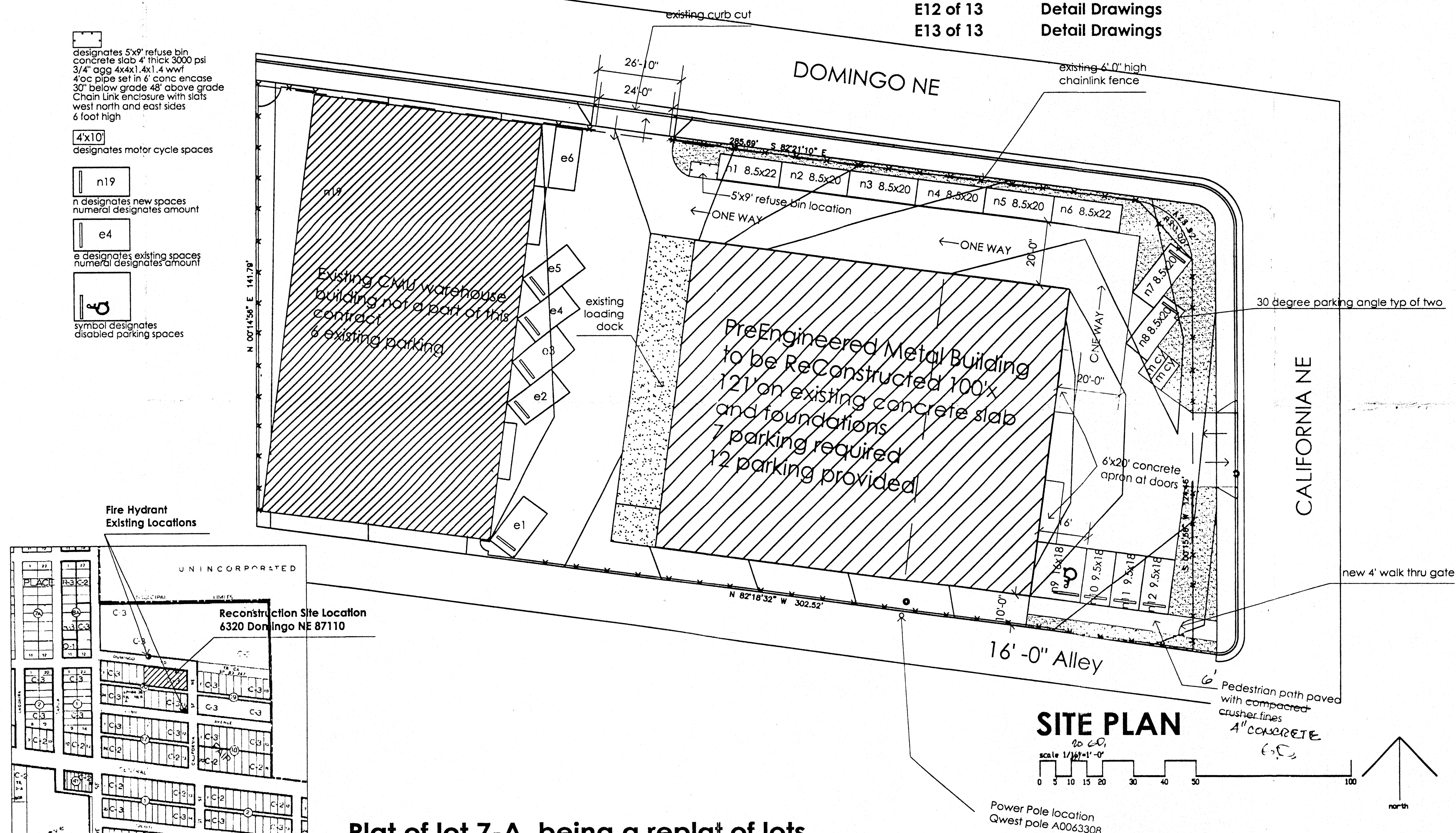

**Plat of lot 7-A, being a replat of lots  
7 through 12, inclusive, Block 20  
Fairgrounds Addition  
within section 24 T10N N. M. PM  
Albuquerque, New Mexico**

**Zoning C3, Zoning atlas K-18**  
**Near Heights Metropolitan Redevelopment Area**

## SITE PLAN

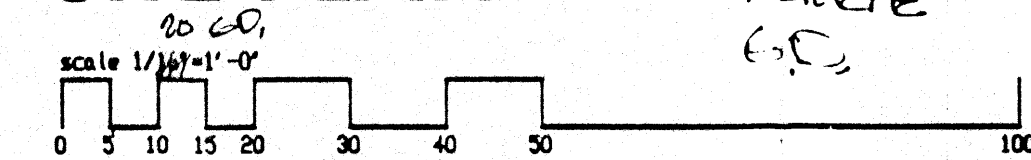

Power Pole location  
Qwest pole A0063308

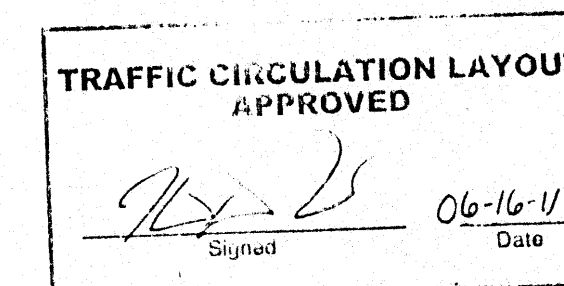

Public infrastructure shown  
on these plans for information  
only and not part of approval.  
Separate DRC/Permit approval  
and Work Order required

ALL WHEELCHAIR RAMPS LOCATED  
WITHIN THE PUBLIC RIGHT OF WAY  
MUST HAVE TRUNCATED DOMES.

MAY 21, 2011

**RECEIVED**

OCT 19 2011  
HYDROLOGY  
SECTION

COVER SHEET-SITE PLAN

scale 1" = 20'-0"

A-0

OWNER: Gene and Dorothy Dyer  
1208 San Pedro NE  
Albuquerque, New Mexico 87110  
505 262 2027 gene\_dyer@usa.net

DYER+DYER ARCHITECTS  
1208 San Pedro NE  
Albuquerque, New Mexico 87110  
505 262 2027 gene\_dyer@usa.net

**PROJECT:**  
Domingo B Reconstruction  
6320 B Domingo Av NE  
Albuquerque, NE 87108



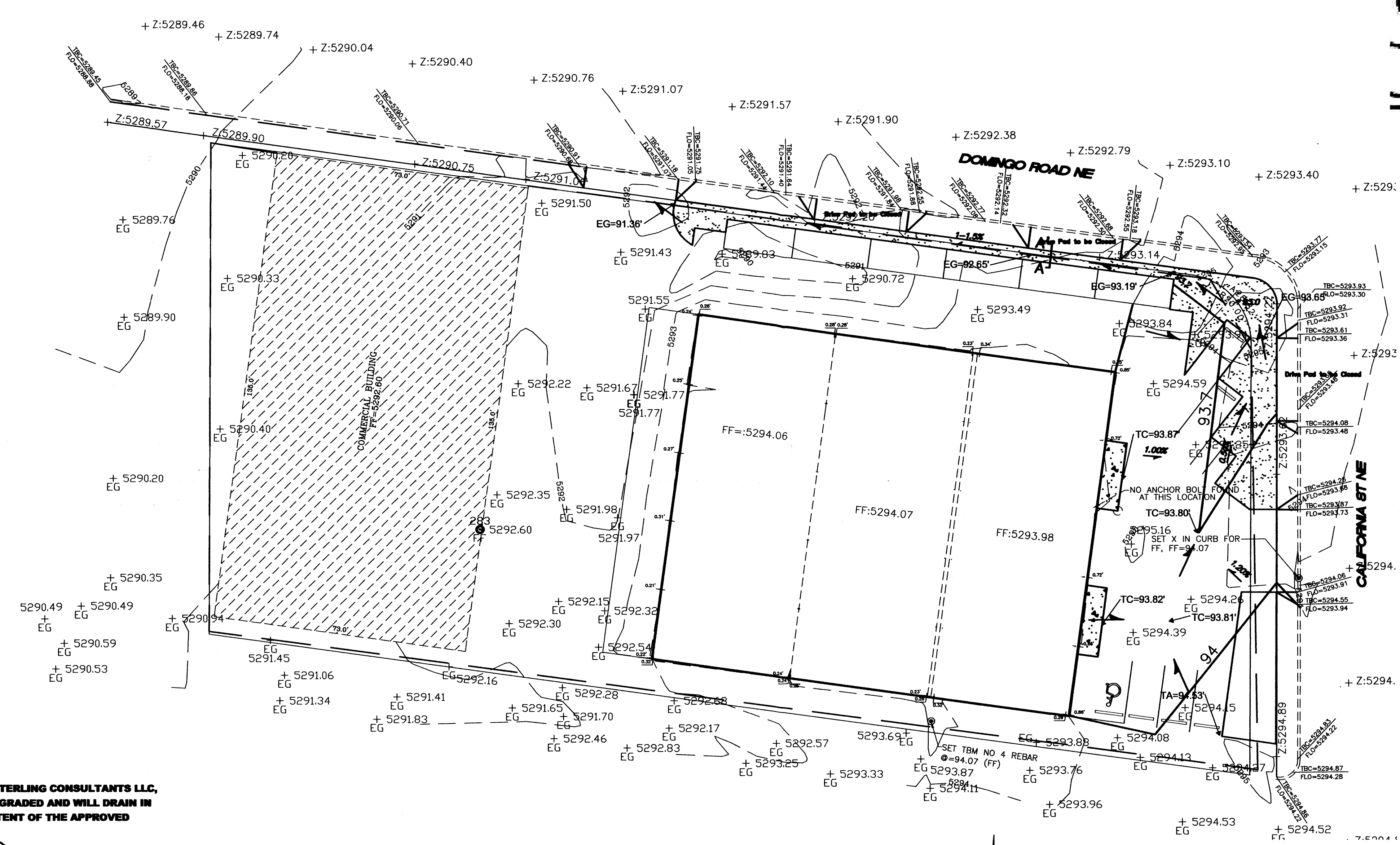
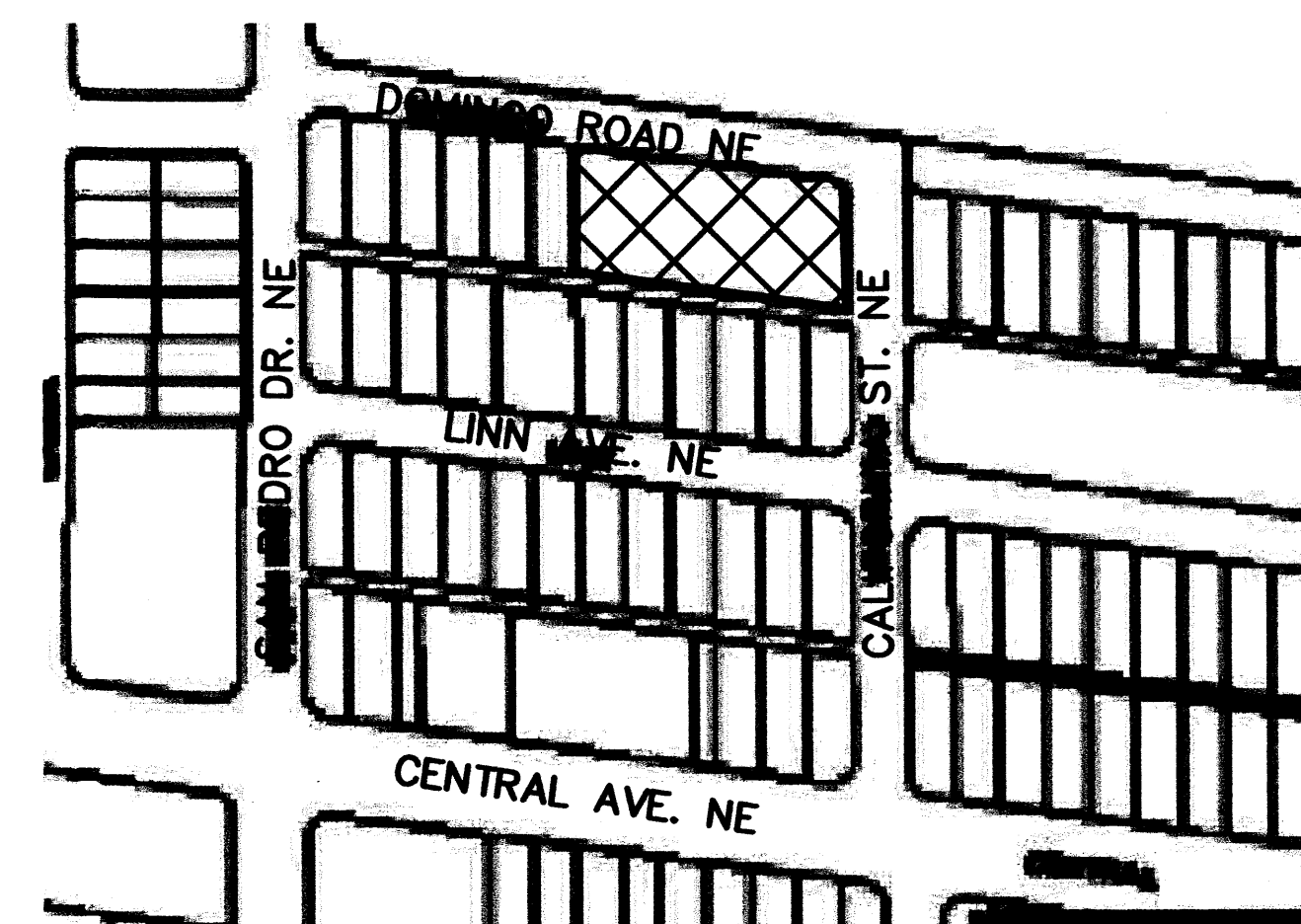

**DOMINGO B RECONSTRUCTION GRADING AND DRAINAGE**

The eastern building on Lot 7-A was destroyed by fire. The building is being reconstructed with the same size and type of building. The majority of the parking lot is undamaged and will remain in place. The portion of the parking lot east of the proposed reconstruction is in disrepair and is uneven. This portion of the parking lot will be re-paved with improvements in the grades to prevent water pooling along the eastern side of the building.

Currently the majority of runoff flows in this eastern area discharge sporadically over the sidewalk to California St. NE which in turn discharges flows to Domingo Road NE which runs along the northern edge of the property. Domingo Road slopes from east to west. The remaining flows on the eastern side parking lot are pooled along the eastern edge of the building until spilling to the east around the NE edge of the building. This is caused by an irregular highpoint approximately 15-20 feet from the building. This flow ultimately drains via the northern drive pad to Domingo NE.

The proposed grading concentrates flows from the eastern area to a proposed landscaped area, along the north-east and northern boundary between the parking lot and the sidewalk, with a consistent slope away from the building. The landscaping is graded to be slightly depressed (0.5' deep) at the north-east corner with a landscaping swale that will drain overflow to the west and ultimately to the northern drive pad where flows are currently being discharged to Domingo Road NE. This improves conditions for the building and does not change the existing condition where all flows ultimately discharge to Domingo Road NE. In addition this configuration provides water quality benefit by the use of the landscaping swale to slow flows and allow filtration by planted vegetation.

Concurrent with this work, three existing but unused drive pads will be closed under a separate permit.

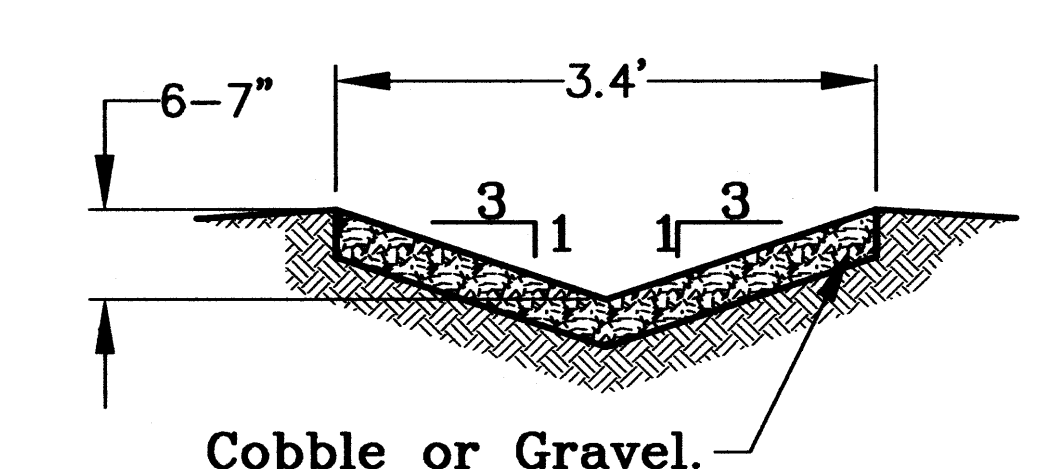

**WQ SWALE SECTION A-A'**  
NTS

**DRAINAGE CERTIFICATION**

I, HUGH W. FLOYD, NMPE 16633, OF THE FIRM EASTERLING CONSULTANTS LLC, HEREBY CERTIFY THAT THIS PROJECT HAS BEEN GRADED AND WILL DRAIN IN SUBSTANTIAL COMPLIANCE WITH THE DESIGN INTENT OF THE APPROVED PLAN DATED 6-20-11.

*Hugh W. Floyd*  
HUGH W. FLOYD, NMPE 16633



DATE 10-25-11

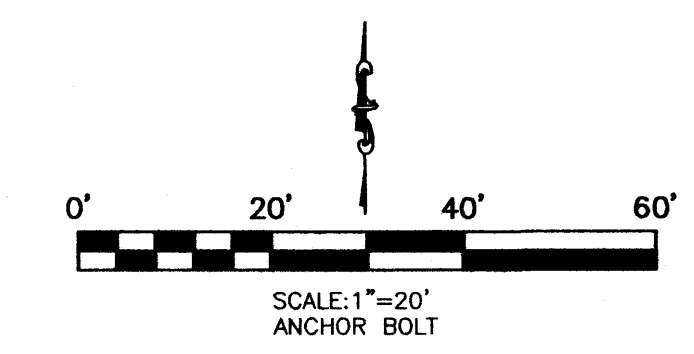

<b>BENCHMARK</b> ACS STATION 5_K18A ELEV. = 5280.174 NAVD 1988		<b>SCALES:</b> 1" = 20' CONT. INT. = 1'		<b>Easterling Consultants LLC</b> Engineering and Environmental Consulting 3613 NMSR 528 NW, Suite E-2 Albuquerque, New Mexico 87114 (505) 821-6646 FAX (505) 897-2965		<b>DOMINGO B RECONSTRUCTION</b> ALBUQUERQUE, NEW MEXICO <b>DOMINGO B RECONSTRUCTION</b> 6320 B Domingo Road NE GRADING AND DRAINAGE PLAN		<b>Sheet C1 of C1</b>	
<b>NO.</b>		<b>REVISIONS</b>		<b>BY</b>		<b>DATE</b>		<b>DESIGNED BY</b>	
								<b>DRAWN BY</b>	
								<b>CHECKED BY</b>	
								<b>FILE NO.</b>	
								<b>DATE</b>	
								<b>140-11-01</b>	
								<b>JUNE 2011</b>	



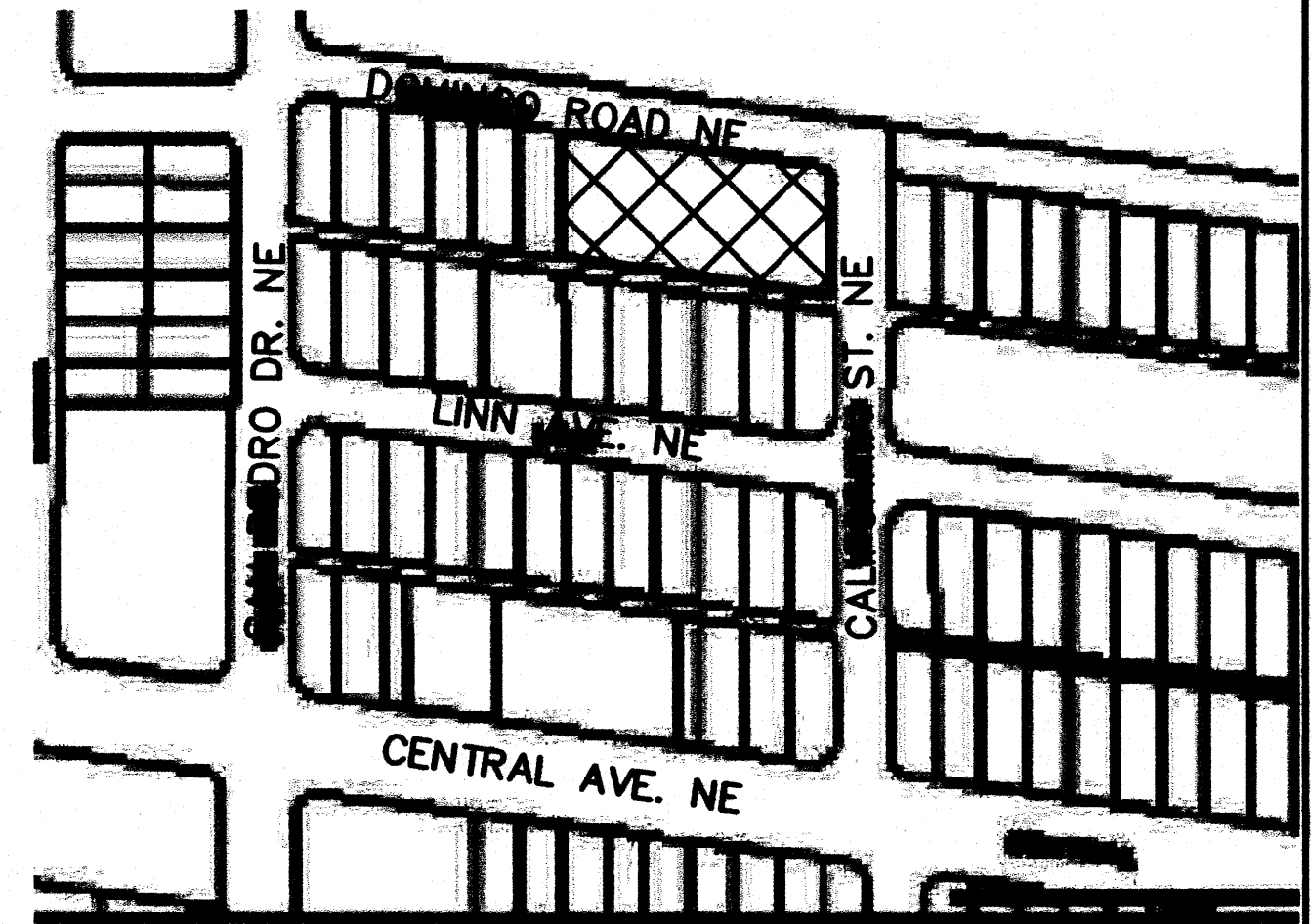
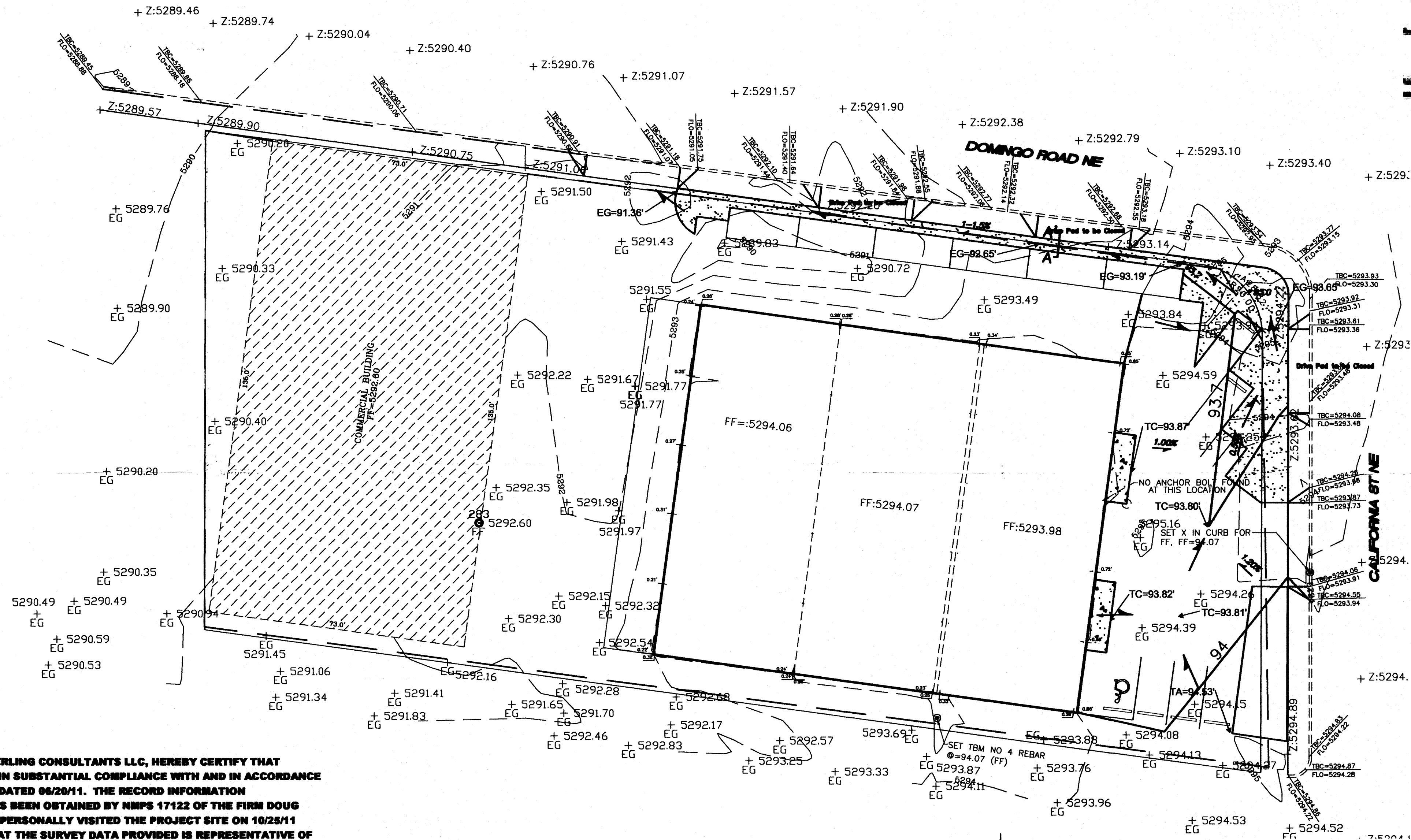

#### DOMINGO B RECONSTRUCTION GRADING AND DRAINAGE

The eastern building on Lot 7-A was destroyed by fire. The building is being reconstructed with the same size and type of building. The majority of the parking lot is undamaged and will remain in place. The portion of the parking lot east of the proposed reconstruction is in disrepair and is uneven. This portion of the parking lot will be re-paved with improvements in the grades to prevent water pooling along the eastern side of the building.

Currently the majority of runoff flows in this eastern area discharge sporadically over the sidewalk to California St. NE which in turn discharges flows to Domingo Road NE which runs along the northern edge of the property. Domingo Road slopes from east to west. The remaining flows on the eastern side parking lot are pooled along the eastern edge of the building until spilling to the east around the NE edge of the building. This is caused by an irregular highpoint approximately 15-20 feet from the building. This flow ultimately drains via the northern drive pad to Domingo NE.

The proposed grading concentrates flows from the eastern area to a proposed landscaped area, along the north-east and northern boundary between the parking lot and the sidewalk, with a consistent slope away from the building. The landscaping is graded to be slightly depressed (0.5' deep) at the north-east corner with a landscaping swale that will drain overflow to the west and ultimately to the northern drive pad where flows are currently being discharged to Domingo Road NE. This improves conditions for the building and does not change the existing condition where all flows ultimately discharge to Domingo Road NE. In addition this configuration provides water quality benefit by the use of the landscaping swale to slow flows and allow filtration by planted vegetation.

Concurrent with this work, three existing but unused drive pads will be closed under a separate permit.

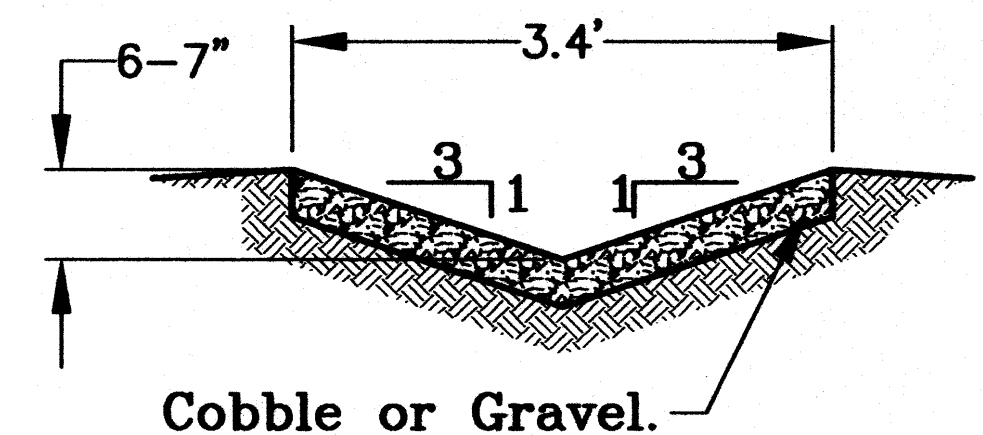

#### WQ SWALE SECTION A-A'

NTS

#### DRAINAGE CERTIFICATION

I, HUGH W. FLOYD, NMPE 16633, OF THE FIRM EASTERLING CONSULTANTS LLC, HEREBY CERTIFY THAT THIS PROJECT HAS BEEN GRADED AND WILL DRAIN IN SUBSTANTIAL COMPLIANCE WITH AND IN ACCORDANCE WITH THE DESIGN INTENT OF THE APPROVED PLAN DATED 06/20/11. THE RECORD INFORMATION EDITED ONTO THE ORIGINAL DESIGN DOCUMENT HAS BEEN OBTAINED BY NMPS 17122 OF THE FIRM DOUG SURVEYING, INC. I FURTHER CERTIFY THAT I HAVE PERSONALLY VISITED THE PROJECT SITE ON 10/25/11 AND HAVE DETERMINED BY VISUAL INSPECTION THAT THE SURVEY DATA PROVIDED IS REPRESENTATIVE OF ACTUAL SITE CONDITIONS AND IS TRUE AND CORRECT TO THE BEST OF MY KNOWLEDGE AND BELIEF. THIS CERTIFICATION IS SUBMITTED IN SUPPORT OF A REQUEST FOR PERMANENT CERTIFICATE OF OCCUPANCY. THE RECORD INFORMATION PRESENTED HEREON IS NOT NECESSARILY COMPLETE AND INTENDED ONLY TO VERIFY SUBSTANTIAL COMPLIANCE OF THE GRADING AND DRAINAGE ASPECTS OF THIS PROJECT. THOSE RELYING ON THIS RECORD DOCUMENT ARE ADVISED TO OBTAIN INDEPENDENT VERIFICATION OF ITS ACCURACY BEFORE USING IT FOR ANY OTHER PURPOSE.

HUGH W. FLOYD, NMPE 16633



10-26-11  
DATE

BENCHMARK						SCALES: 1" = 20' CONT. INT. = 1'		<b>Easterling Consultants LLC</b> Engineering and Environmental Consulting 3613 NMSR 528 NW, Suite E-2 Albuquerque, New Mexico 87114 (505) 821-6646 FAX (505) 897-2965		DOMINGO B RECONSTRUCTION ALBUQUERQUE, NEW MEXICO	
ACS STATION 5_K18A ELEV.= 5280.174 NAVD 1988						Designed By: _____ Drawn By: _____ Checked By: _____				DOMINGO B RECONSTRUCTION 6320 B Domingo Road NE GRADING AND DRAINAGE PLAN	
NO.	REVISIONS	BY	DATE	File No.	Date:					© COPYRIGHT	
				140-11-01	JUNE 2011					Sheet C1 of C1	

