

1 2 3 4 5 6 7 8 9 10 11 12
26-7612.83-2014

RECORD DRAWINGS

CONSTRUCTION PLANS FOR THE TRAILS UNIVERSE STORM DRAIN ALBUQUERQUE, NEW MEXICO

APPROVED AS RECORD DRAWINGS
DESIGN REVIEW SECTION
CITY CONSTRUCTION ENGINEER
DATE: March 17, 2014

INDEX

SHEET NO.	DESCRIPTION
1	COVER SHEET
2A-2C	TOPOGRAPHIC SURVEY
3	OVERALL STORM DRAIN PLAN
4-8	STORM DRAIN PLAN AND PROFILE SHEETS
9	MISC DRAINAGE DETAILS 7/9/13 SJS

STORM DRAIN PLANS

SHEET NO.	DESCRIPTION
4	UNIVERSE STORM DRAIN STA 26+00 TO 31+00
5	UNIVERSE STORM DRAIN STA 31+00 TO 41+00
6	UNIVERSE STORM DRAIN STA 41+00 TO 51+00
7	UNIVERSE STORM DRAIN STA 51+00 TO 60+00
8	UNIVERSE STORM DRAIN STA 60+00 TO 63+36

SURVEYORS CERTIFICATION

I, Russ P. Hugg, New Mexico Professional Surveyor Number 9750, hereby certify that the as-built information shown hereon is the result of an actual field survey performed by me or under my direct supervision and that the same is true and correct to the best of my knowledge and belief.

Russ P. Hugg
NMPs No. 9750
02/17, 2014



CERTIFICATE OF SUBSTANTIAL COMPLIANCE ON PLANS

I, Matthew A. Santistevan of the firm of Bohannon-Huston, Inc., a Registered Professional Engineer in the State of New Mexico, do hereby certify, to the best of my knowledge and belief, that the infrastructure installed as shown on these drawings (The Trails Universe Storm Drain) has been inspected by me or by a qualified person under my direct supervision and has been constructed in accordance with the plans and specifications and that the original design intent of the approved plans has been met, except as noted by me on the as-built construction drawings. This Certification is based on site inspections by me or personnel under my direction and survey information provided by the contractor, Pythion Construction Company and the surveyor, Russ P. Hugg, NMPs No. 9750.



NOTES:

- ALL SHOULDER WORK, CLEAR ZONE & SIDE SLOPE CRITERIA PER ROADSIDE DESIGN CRITERIA DURING WORK & NON WORK HOURS (SHALL BE COMPLIED) NBY 02/13/13
- CONTRACTOR TO COORDINATE WITH THE CITY OF ALBUQUERQUE CONSTRUCTION COORDINATION ENGINEER (924-3400) PRIOR TO THE PRE-CONSTRUCTION MEETING.
- CONTRACTOR TO COORDINATE WITH SAD 228 CITY OF ALBUQUERQUE PM MANH TRAN (168.2791) PRIOR TO START OF CONSTRUCTION.

- AN SO 19 PERMIT IS REQUIRED TO PLACE ANY MATERIAL ON OR AROUND A STORM DRAIN INLET IN THE CITY RIGHT-OF-WAY THAT WOULD INTERFERE WITH THE INLET RECEIVING STORM WATER PER THE ENGINEER'S DESIGN. CITY PERSONNEL MAY REMOVE THIS MATERIAL AT ANY TIME WITHOUT NOTICE. THE PREFERRED BMP IS TO REMOVE SEDIMENT/POLLUTANTS ON THE PROPERTY WHERE CONSTRUCTION ACTIVITY IS OCCURRING.
- ALL EXCAVATION, TRENCHING, AND SHORING ACTIVITIES MUST BE CARRIED-OUT IN ACCORDANCE WITH OSHA 29 CFR 1926.650 SUBPART P.

CONSTRUCTION NOTES:

- THE CONTRACTOR SHALL ABIDE BY ALL LOCAL, STATE, AND FEDERAL LAWS, RULES AND REGULATIONS WHICH APPLY TO THE CONSTRUCTION OF THESE IMPROVEMENTS.
- PRIOR TO CONSTRUCTION, CONTRACTOR SHALL EXCAVATE AND VERIFY THE HORIZONTAL AND VERTICAL LOCATIONS OF ALL POTENTIAL OBSTRUCTIONS. SHOULD A CONFLICT EXIST, THE CONTRACTOR SHALL NOTIFY THE ENGINEER OR CONSTRUCTION OBSERVER SO THAT THE CONFLICT CAN BE RESOLVED WITH A MINIMUM AMOUNT OF DELAY.
- ALL ELECTRICAL, TELEPHONE, CABLE TV, GAS AND OTHER UTILITY LINES, CABLES AND APPURTENANCES ENCOUNTERED DURING CONSTRUCTION THAT REQUIRE RELOCATION, SHALL BE COORDINATED WITH THAT UTILITY. THE CONTRACTOR SHALL BE RESPONSIBLE FOR COORDINATION OF ALL NECESSARY UTILITY ADJUSTMENTS. NO ADDITIONAL COMPENSATION WILL BE ALLOWED FOR DELAYS OR INCONVENIENCES CAUSED BY UTILITY COMPANY WORK CREWS. THE CONTRACTOR MAY BE REQUIRED TO RESCHEDULE HIS ACTIVITIES TO ALLOW UTILITY CREWS TO PERFORM THEIR REQUIRED WORK.
- DISPOSAL SITE FOR ALL EXCESS EXCAVATION MATERIAL, AND UNSUITABLE MATERIAL SHALL BE OBTAINED BY THE CONTRACTOR IN COMPLIANCE WITH APPLICABLE ENVIRONMENTAL REGULATIONS AND APPROVED BY THE CONSTRUCTION OBSERVER. ALL COSTS INCURRED IN OBTAINING A DISPOSAL SITE AND HAUL THERE TO SHALL BE CONSIDERED INCIDENTAL TO THE PROJECT AND NO SEPARATE MEASUREMENT OR PAYMENT SHALL BE MADE.
- THE CONTRACTOR IS RESPONSIBLE FOR PROTECTING THE EXISTING UTILITY LINES WITHIN THE CONSTRUCTION AREA. ANY DAMAGE TO EXISTING FACILITIES CAUSED BY CONSTRUCTION ACTIVITY SHALL BE REPAIRED OR REPLACED AT THE CONTRACTOR'S EXPENSE AND APPROVED BY THE CONSTRUCTION OBSERVER.
- CONSTRUCTION ACTIVITY SHALL BE LIMITED TO THE PROPERTY AND/OR PROJECT LIMITS. ANY DAMAGE TO ADJACENT PROPERTIES RESULTING FROM THE CONSTRUCTION PROCESS IS THE RESPONSIBILITY OF THE CONTRACTOR. ANY COSTS INCURRED FOR REPAIRS SHALL BE THE COST OF THE CONTRACTOR.
- OVERNIGHT PARKING OF CONSTRUCTION EQUIPMENT SHALL NOT OBSTRUCT DRIVEWAYS OR DESIGNATED TRAFFIC LANES. THE CONTRACTOR SHALL NOT STORE ANY EQUIPMENT OR MATERIAL WITHIN THE PUBLIC RIGHT-OF-WAY.
- THE CONTRACTOR SHALL OBTAIN ALL THE NECESSARY PERMITS FOR THE PROJECT PRIOR TO COMMENCING CONSTRUCTION (I.E. BARRICADING, SURFACE DISTURBANCE).
- THE CONTRACTOR SHALL BE RESPONSIBLE TO REPLACE AT HIS EXPENSE ANY AND ALL PROPERTY CORNERS DESTROYED DURING CONSTRUCTION. ALL PROPERTY CORNERS MUST BE RESET BY A REGISTERED LAND SURVEYOR.
- ALL PERMANENT PAVEMENT MARKING AND TRAFFIC SIGNING SHALL BE FURNISHED AND PLACED BY THE CONTRACTOR PER PLAN.
- THE CONTRACTOR SHALL COORDINATE WITH THE CITY OF ALBUQUERQUE, DMD CONSTRUCTION COORDINATION DIVISION, PRIOR TO BEGINNING ANY CONSTRUCTION WORK ON OR ADJACENT TO EXISTING STREETS.
- ALL BARRICADES AND CONSTRUCTION SIGNING SHALL CONFORM TO APPLICABLE SECTIONS OF THE "MANUAL ON UNIFORM TRAFFIC CONTROL DEVICES" (MUTCD), U.S. DEPARTMENT OF TRANSPORTATION, LATEST EDITION.
- THE CONTRACTOR SHALL BE RESPONSIBLE FOR PROVIDING AND MAINTAINING CONSTRUCTION SIGNAGE UNTIL THE PROJECT HAS BEEN ACCEPTED BY THE CITY OF ALBUQUERQUE. THE CONTRACTOR SHALL VERIFY THE PROPER LOCATION OF ALL BARRICADING AT THE END AND BEGINNING OF EACH DAY.
- ALL SAWCUT PAVEMENT SHALL HAVE A UNIFORM EDGE AND BE SPRAYED WITH TACK.
- WHEN ABUTTING NEW CURB AND GUTTER TO EXISTING PAVEMENT, A 1' WIDE SECTION OF EXISTING PAVEMENT ADJACENT TO THE CURB AND GUTTER SHALL BE SAWCUT, REMOVED, AND REPLACED AS PER THE STANDARD SPECIFICATIONS.
- THE CONTRACTOR SHALL ASSUME RESPONSIBILITY FOR ANY DAMAGE TO EXISTING PAVEMENTS, PAVEMENT MARKINGS, CURB & GUTTER, DRIVE PADS, WHEELCHAIR RAMPS, AND SIDEWALK DURING CONSTRUCTION, APART FROM THOSE SECTIONS INDICATED FOR REMOVAL ON THE PLANS AND SHALL REPAIR OR REPLACE PER CDA STANDARDS, AT HIS OWN EXPENSE.

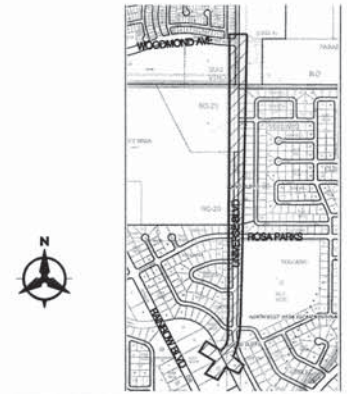

VICINITY MAP
C-09-2 / D-09-2

NOTICE TO CONTRACTORS

- AN EXCAVATION/CONSTRUCTION PERMITS WILL BE REQUIRED BEFORE BEGINNING ANY WORK WITHIN THE CITY RIGHT-OF-WAY.
- ALL WORK DETAILED ON THESE PLANS TO BE PERFORMED UNDER CONTRACT SHALL, EXCEPT AS OTHERWISE STATED OR PROVIDED FOR HEREON, BE CONSTRUCTED IN ACCORDANCE WITH THE CITY OF ALBUQUERQUE STANDARD SPECIFICATIONS FOR PUBLIC WORKS CONSTRUCTION, 1986 EDITION AS REVISED THROUGH UPDATE #8.
- TWO WORKING DAYS PRIOR TO ANY EXCAVATION, THE CONTRACTOR MUST CONTACT NEW MEXICO ONE CALL SYSTEM (260-1990) FOR LOCATION OF EXISTING UTILITIES.
- PRIOR TO CONSTRUCTION, THE CONTRACTOR SHALL EXCAVATE AND VERIFY THE HORIZONTAL AND VERTICAL LOCATIONS OF ALL OBSTRUCTIONS. SHOULD A CONFLICT EXIST, THE CONTRACTOR SHALL NOTIFY THE ENGINEER IMMEDIATELY SO THAT THE CONFLICT CAN BE RESOLVED WITH A MINIMUM AMOUNT OF DELAY.
- SEVEN (7) WORKING DAYS PRIOR TO BEGINNING CONSTRUCTION, THE CONTRACTOR SHALL SUBMIT TO CONSTRUCTION COORDINATION DIVISION A DETAILED CONSTRUCTION SCHEDULE. TWO (2) WORKING DAYS PRIOR TO THE START OF CONSTRUCTION, THE CONTRACTOR SHALL OBTAIN A BARRICADING PERMIT FROM THE CONSTRUCTION COORDINATION DIVISION. CONTRACTOR SHALL NOTIFY THE CONSTRUCTION COORDINATION ENGINEER (924-3400) PRIOR TO OCCUPYING AN INTERSECTION. REFER TO SECTION 19 OF THE GENERAL CONDITIONS OF THE STANDARD SPECIFICATIONS.
- ALL WORK EFFECTING ARTERIAL ROADWAYS REQUIRES TWENTY-FOUR HOUR CONSTRUCTION.
- ALL STREET STRIPING ALTERED OR DESTROYED SHALL BE REPLACED WITH PLASTIC REFLECTORIZED PAVEMENT MARKING BY CONTRACTOR TO THE SAME LOCATION AS WAS EXISTING, OR AS INDICATED BY THIS PLAN SET.
- CONTRACTOR SHALL NOTIFY THE ENGINEER NOT LESS THAN SEVEN (7) DAYS PRIOR TO STARTING WORK IN ORDER THAT THE CITY SURVEYOR MAY TAKE NECESSARY MEASURES TO INSURE THE PRESERVATION OF SURVEY MONUMENTS. CONTRACTOR SHALL NOT DESTROY PERMANENT SURVEY MONUMENTS WITHOUT THE CONSENT OF THE CITY SURVEYOR AND SHALL NOTIFY THE CITY SURVEYOR AND BEAR THE EXPENSE OF REPLACING ANY THAT MAY BE DISTURBED WITHOUT PERMISSION. REPLACEMENT SHALL BE DONE ONLY BY THE CITY SURVEYOR. WHEN A CHANGE IS MADE IN THE FINISHED ELEVATIONS OF THE PAVEMENT OF ANY ROADWAY IN WHICH A PERMANENT SURVEY MONUMENT IS LOCATED, CONTRACTOR SHALL, AT HIS OWN EXPENSE, ADJUST THE MONUMENT COVER TO THE NEW GRADE UNLESS OTHERWISE SPECIFIED. REFER TO SECTION 4.4 OF THE GENERAL CONDITIONS OF THE STANDARD SPECIFICATIONS.
- CONTRACTOR SHALL RECORD DATA ON ALL UTILITY LINES AND ACCESSORIES AS REQUIRED BY ABQWMA FOR THE PREPARATION OF "AS CONSTRUCTED" DRAWINGS. CONTRACTOR SHALL NOT COVER UTILITY LINES AND ACCESSORIES UNTIL ALL DATA HAS BEEN RECORDED.
- CONTRACTOR SHALL MAINTAIN A GRAFFITI-FREE WORK SITE. CONTRACTOR SHALL PROMPTLY REMOVE ANY GRAFFITI FROM ALL EQUIPMENT, WHETHER PERMANENT OR TEMPORARY.
- THE CONTRACTOR SHALL COORDINATE WITH THE WATER AUTHORITY SEVEN (7) DAYS IN ADVANCE OF PERFORMING WORK THAT WILL AFFECT THE PUBLIC WATER OR SANITARY SEWER INFRASTRUCTURE. WORK REQUIRING SHUTOFF OF WELL COLLECTORS, TRANSMISSION LINES, OR FACILITIES DESIGNATED AS MASTER PLAN FACILITIES MUST BE COORDINATED WITH THE WATER AUTHORITY 14 DAYS IN ADVANCE OF PERFORMING SUCH WORK. ONLY WATER AUTHORITY CREWS ARE AUTHORIZED TO OPERATE PUBLIC VALVES. SHUTOFF REQUESTS MUST BE MADE ONLINE AT <http://abqwa.org/content/view/full/463/729/>.

THE FOLLOWING NOTES ALSO APPLY WHEN CHECKED

- ☒ ALL UTILITIES AND UTILITY SERVICE LINES SHALL BE INSTALLED PRIOR TO PAVING.
- ☒ BACKFILL COMPACTION SHALL BE ACCORDING TO SPECIFIED STREET USE.
- ☒ SIDEWALKS AND WHEELCHAIR RAMPS WITHIN THE CURB RETURNS SHALL BE CONSTRUCTED WHEREVER A NEW CURB RETURN IS PROVIDED.
- ☒ IF CURB IS DEEPER FOR A DRIVEPAD, THE DRIVEPAD SHALL BE CONSTRUCTED PRIOR TO ACCEPTANCE OF CURB AND GUTTER.
- ☒ ALL STORM DRAINAGE FACILITIES SHALL BE COMPLETED PRIOR TO FINAL ACCEPTANCE.
- ☒ THE REQUESTOR OR DEVELOPER SHALL BE RESPONSIBLE FOR REPAIR OR REPLACEMENT OF ALL CURB AND GUTTER OR SIDEWALK DAMAGED AFTER APPROVAL BY THE CITY ENGINEER OF WORK COMPLETED BY THE CONTRACTOR.

DRB #1008797

REV.	SHEETS	CITY ENGINEER	DATE	USER DEPARTMENT	DATE	USER DEPARTMENT	DATE
ENGINEERS STAMP & SIGNATURE		APPROVALS		ENGINEER		DATE	
		DRC Chairman	<i>[Signature]</i>	3/12/13	*****		
		Transportation	<i>[Signature]</i>	02/13/13	APPROVED FOR CONSTRUCTION		
		Water/Wastewater	<i>[Signature]</i>	2-13-13			
		Hydrology	<i>[Signature]</i>	2-13-13			
		Parks					
		Const. Coord.					
City Project No.		761283		Sheet		Of	
				1		89	

Bohannon & Huston

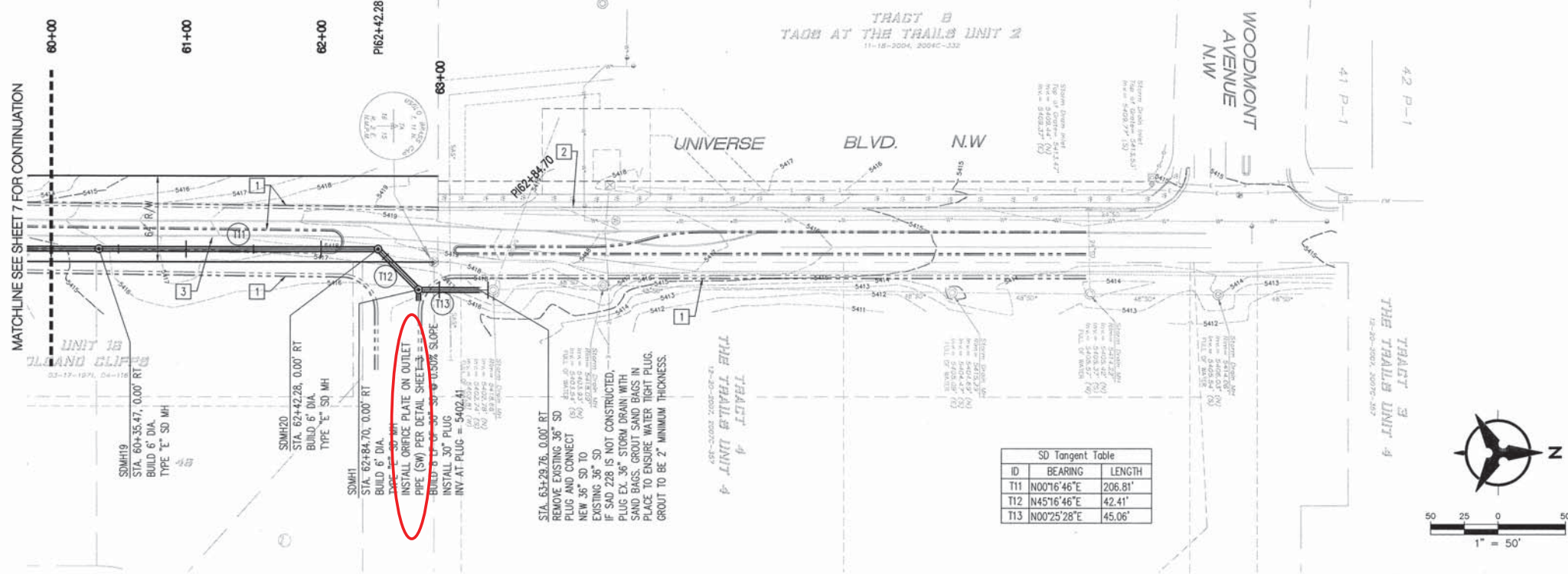

RECORD DRAWINGS

GENERAL NOTES

- THE CONTRACTOR SHALL FIELD VERIFY ALL EXISTING UTILITY LOCATIONS AND NOTIFY THE ENGINEER IMMEDIATELY OF ANY DISCREPANCIES. CONTRACTOR SHALL COORDINATE RELOCATION OF UTILITY LINES WITH UTILITY COMPANIES AS REQUIRED.
- ALL CURVE DATA AND DIMENSIONS ARE CALCULATED FROM CENTERLINE OF PIPE OR MANHOLE. ALL S&S & SD SLOPES ARE CALCULATED TO TRUE PIPE DIMENSIONS FROM INVERT TO INVERT. (PAY ITEMS ARE SHOWN IN PARENTHESES)
- GRADE ELEVATIONS, WHERE NOTED, ARE FOR FLOWLINE OF STANDARD CURB UNLESS OTHERWISE SPECIFIED.
- CONTRACTOR IS RESPONSIBLE FOR REPAIR AND/OR REPLACEMENT OF ALL DAMAGED EXISTING UTILITY CONDUITS AND EXISTING LINES.
- CONTRACTOR SHALL PARK EQUIPMENT AND VEHICLES AS NOT TO INTERFERE WITH NORMAL ACTIVITIES OF RESIDENTS OR OTHER CONTRACTORS ON SITE.
- ANY DAMAGE TO THE EXISTING FACILITIES (CURB & GUTTER, PAVEMENT, LANDSCAPING, ETC.) DURING CONSTRUCTION SHALL BE REPLACED AT THE CONTRACTOR'S EXPENSE.
- MH RIMS & CATCH BASIN INLET ELEVATIONS, FIRE HYDRANT & FLANGE ELEVATIONS ARE APPROXIMATE. CONTRACTOR SHALL FIELD VERIFY AND ADJUST TO FINAL PAVEMENT OR SURFACE GRADES.
- STORM DRAIN STATIONING FOLLOWS CL OF STORM DRAIN UNLESS OTHERWISE NOTED.
- STATIONING OF DROP INLET IS TO MIDDLE OF DOWN HILL GRATE AT FACE OF CURB.
- FLOWLINE ELEVATIONS FOR DROP INLETS ARE PROJECTED FROM FLOWLINE OF STANDARD CURB TO MIDDLE OF DOWNHILL GRATE.
- ALL WATERLINE FITTINGS, VALVES, BENDS, TEES, CROSSES AND APPURTENANCES SHALL USE RESTRAINED JOINTS UNLESS OTHERWISE NOTED ON THE PLANS.
- AT UTILITY CROSSING WHERE LESS THAN 1 FOOT OF COVER OVER STORM DRAIN PIPE IS PRESENT LEAN FILL IS TO BE USED FOR A DISTANCE OF 5 FEET ON EACH SIDE OF THE SD & FROM TOP OF STORM DRAIN TO BOTTOM OF SANITARY SEWER OR WATER LINE.
- ROP SHALL BE INSTALLED SO THAT THE JOINT GAP AT THE HOME POSITION SHALL CONFORM TO THE APPROVED MANUFACTURER'S RECOMMENDATIONS. MANUFACTURER'S RECOMMENDED JOINT GAP TOLERANCES FOR EACH PIPE SIZE AND TYPE SHALL BE SUBMITTED TO THE ENGINEER FOR APPROVAL PRIOR TO PLACEMENT OF PIPE. ROP JOINTS SHALL NOT BE GROUTED UNLESS DIRECTED BY THE ENGINEER AFTER CITY APPROVAL.
- ALL EXCAVATION, TRENCHING AND SHORING ACTIVITIES MUST BE CARRIED-OUT IN ACCORDANCE WITH OSHA 29 CFR 1926.650 SUBPART P.

AS-BUILT INFORMATION		BENCH MARKS		SURVEY INFORMATION		FIELD NOTES		ENGINEER'S SEAL	
CONTRACTOR	DATE	NO.	DATE	NO.	DATE	NO.	DATE	NO.	DATE
DATE 3/14	DATE 3/14	DATE 3/14	DATE 3/14	DATE 3/14	DATE 3/14	DATE 3/14	DATE 3/14	DATE 3/14	DATE 3/14
DATE 3/14	DATE 3/14	DATE 3/14	DATE 3/14	DATE 3/14	DATE 3/14	DATE 3/14	DATE 3/14	DATE 3/14	DATE 3/14
DATE 3/14	DATE 3/14	DATE 3/14	DATE 3/14	DATE 3/14	DATE 3/14	DATE 3/14	DATE 3/14	DATE 3/14	DATE 3/14
DATE 3/14	DATE 3/14	DATE 3/14	DATE 3/14	DATE 3/14	DATE 3/14	DATE 3/14	DATE 3/14	DATE 3/14	DATE 3/14
DATE 3/14	DATE 3/14	DATE 3/14	DATE 3/14	DATE 3/14	DATE 3/14	DATE 3/14	DATE 3/14	DATE 3/14	DATE 3/14
DATE 3/14	DATE 3/14	DATE 3/14	DATE 3/14	DATE 3/14	DATE 3/14	DATE 3/14	DATE 3/14	DATE 3/14	DATE 3/14
DATE 3/14	DATE 3/14	DATE 3/14	DATE 3/14	DATE 3/14	DATE 3/14	DATE 3/14	DATE 3/14	DATE 3/14	DATE 3/14
DATE 3/14	DATE 3/14	DATE 3/14	DATE 3/14	DATE 3/14	DATE 3/14	DATE 3/14	DATE 3/14	DATE 3/14	DATE 3/14

STA. 60+00.00 - 63+36.00

ELEVATIONS ARE IN NAVD 88

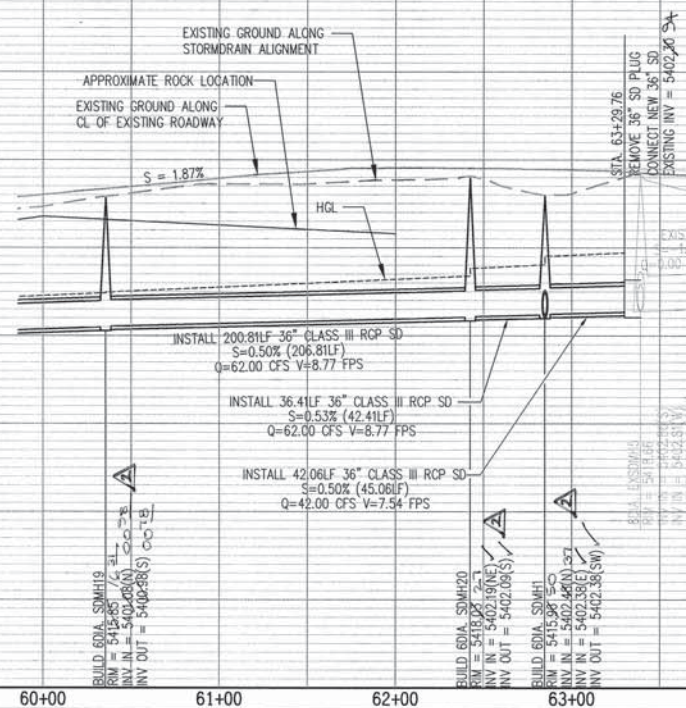

SURVEYORS CERTIFICATION

I, Russ P. Hugg, New Mexico Professional Surveyor Number 9750, hereby certify that the as-built information shown hereon is the result of an actual field survey performed by me or under my direct supervision and that the same is true and correct to the best of my knowledge and belief.

Russ P. Hugg
NMPS No. 9750
2014



KEYED NOTES

- FUTURE CURB & GUTTER
- EXISTING CURB & GUTTER
- EXISTING EDGE OF ASPHALT
- EXISTING 48" STORM DRAIN

Bohannon & Huston



CITY OF ALBUQUERQUE
PUBLIC WORKS DEPARTMENT

THE TRAILS UNIVERSE STORM DRAIN
UTILITY PLAN AND PROFILE
STA. 60+00.00 - 63+36.00



Mo./Day/Yr.	Mo./Day/Yr.
3/14/2013	3/14/2013
3/14/2013	3/14/2013
3/14/2013	3/14/2013
3/14/2013	3/14/2013
3/14/2013	3/14/2013
3/14/2013	3/14/2013
3/14/2013	3/14/2013
3/14/2013	3/14/2013
3/14/2013	3/14/2013
3/14/2013	3/14/2013

City Project No.

761283

Zone Map No.

C-9 / D-9

Sheet 8 of 8