



# ***City of Albuquerque***

P.O. BOX 1293 ALBUQUERQUE, NEW MEXICO 87103

September 29, 1995

Greg Krenik  
Mark Goodwin & Associates  
P.O. Box 90606  
Albuquerque, NM 87199

RE: ENGINEER CERTIFICATION FOR MICHAEL'S @ MARKET CENTRE EAST I  
(K21-D16K) CERTIFICATION STATEMENT DATED 9/12/95.

Dear Mr. Krenik:

Based on the information provided on your September 14, 1995  
submittal, Engineer Certification for the above referenced site  
is acceptable.

If I can be of further assistance, please feel free to contact me  
at 768-2667.

Sincerely,

Bernie J. Montoya, CE  
Engineering Associate

BJM/dl

c: Andrew Garcia  
File

# DRAINAGE INFORMATION SHEET

PROJECT TITLE: Michael's - Market Center East ZONE ATLAS/DRNG, FILE#: K-21/10/16K  
DRB #: \_\_\_\_\_ EPC #: \_\_\_\_\_ WORK ORDER #: \_\_\_\_\_  
LEGAL DESCRIPTION: Portion of Tract 2A5A1A Horne Development Addition  
CITY ADDRESS: 11140 Lomas NE

ENGINEERING FIRM: Mark Goodwin & Associates, PA CONTACT: Gregory J. Krenik, PE  
ADDRESS: PO Box 90606 PHONE: 345-2010  
OWNER: Michael's CONTACT: George Rainhart  
ADDRESS: 7801 Academy NE PHONE: 828-9611  
ARCHITECT: De la Torre - Rainhart CONTACT: George Rainhart  
ADDRESS: 7801 Academy NE PHONE: 828-9611  
SURVEYOR: \_\_\_\_\_ CONTACT: \_\_\_\_\_  
ADDRESS: \_\_\_\_\_ PHONE: \_\_\_\_\_  
CONTRACTOR: \_\_\_\_\_ CONTACT: \_\_\_\_\_  
ADDRESS: \_\_\_\_\_ PHONE: \_\_\_\_\_

## TYPE OF SUBMITTAL:

\_\_\_\_ DRAINAGE REPORT  
\_\_\_\_ DRAINAGE PLAN  
\_\_\_\_ CONCEPTUAL GRADING & DRAINAGE PLAN  
\_\_\_\_ GRADING PLAN  
\_\_\_\_ EROSION CONTROL PLAN  
☒ ENGINEER'S CERTIFICATION  
\_\_\_\_ OTHER

## PRE-DESIGN MEETING:

\_\_\_\_ YES  
☒ NO  
\_\_\_\_ COPY PROVIDED

## CHECK TYPE OF APPROVAL SOUGHT:

\_\_\_\_ SKETCH PLAT APPROVAL  
\_\_\_\_ PRELIMINARY PLAT APPROVAL  
\_\_\_\_ S. DEV. PLAN FOR SUB'D APPROVAL  
\_\_\_\_ S. DEV. PLAN FOR BLDG PERMIT APPROVAL  
\_\_\_\_ SECTOR PLAN APPROVAL  
\_\_\_\_ FINAL PLAT APPROVAL  
\_\_\_\_ FOUNDATION PERMIT APPROVAL  
\_\_\_\_ BUILDING PERMIT APPROVAL  
☒ CERTIFICATION OF OCCUPANCY APPROVAL  
\_\_\_\_ GRADING PERMIT APPROVAL  
\_\_\_\_ PAVING PERMIT APPROVAL  
\_\_\_\_ S.A.D. DRAINAGE REPORT  
\_\_\_\_ DRAINAGE REQUIREMENTS  
\_\_\_\_ OTHER \_\_\_\_\_ (Specify)

30 day Temp Fssued on

DATE SUBMITTED: \_\_\_\_\_

9-12-95

BY: \_\_\_\_\_

Gregory J. Krenik, PE

SEP 14 1995

HYDROLOGY DEPT



# *City of Albuquerque*

P.O. BOX 1293 ALBUQUERQUE, NEW MEXICO 87103

May 18, 1995

Gregory J. Krenik  
Mark Goodwin & Associates  
P.O. Box 90606  
Albuquerque, NM 87199

RE: DRAINAGE PLAN FOR AN ADDITION @ MARKET CENTER EAST  
MICHAEL'S (K21-D16K) ENGINEER'S STAMP DATED 4/16/95.

Dear Mr. Krenik:

Based on the information provided on your April 14, 1995  
submittal, the above referenced site is approved for Building  
Permit. Please attach a copy of this approved plan to the  
construction sets prior to sign-off by Hydrology.

Also, prior to Certificate of Occupancy release, Engineer  
Certification per the D.P.M. checklist will be required.

If I can be of further assistance, please feel free to contact me  
at 768-2667.

Sincerely,

Bernie J. Montoya, CE  
Engineering Associate

BJM/dl

c: Andrew Garcia  
File

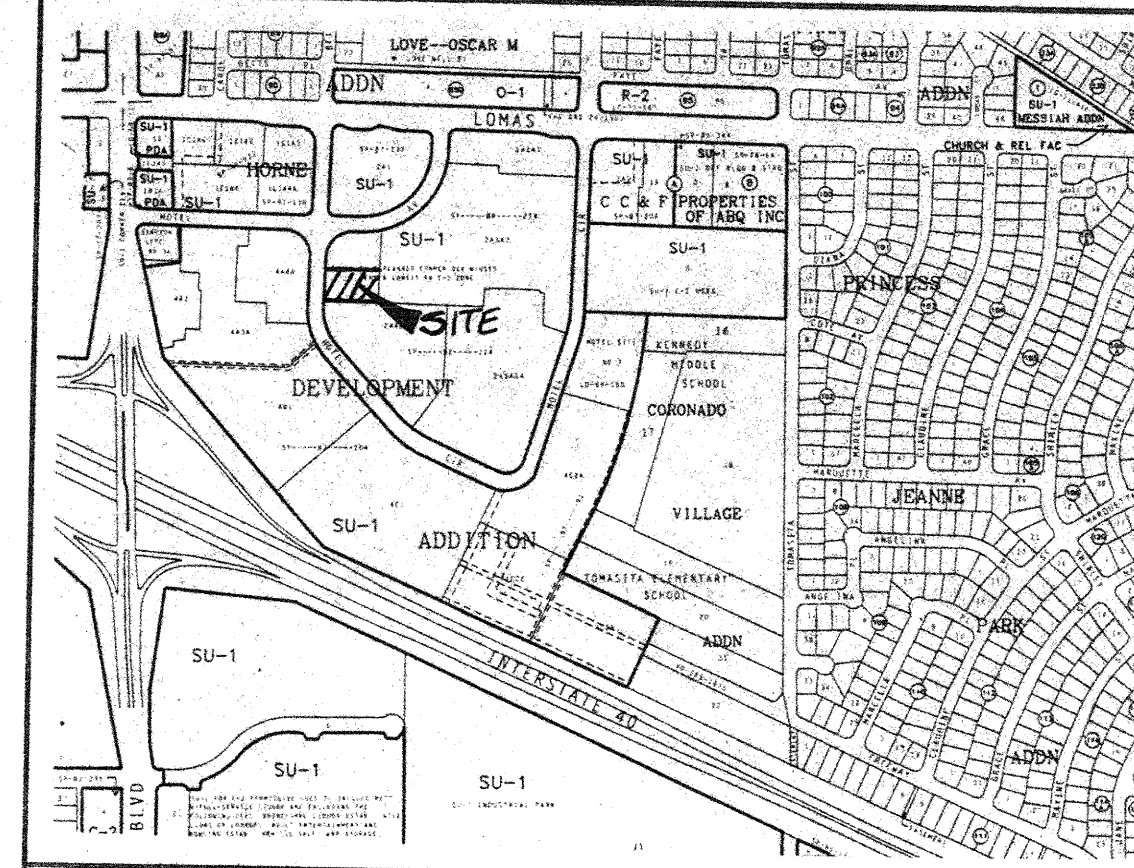

VICINITY MAP ZONE MAP: K-21-Z

TBM (TEMPORARY BENCHMARK)  
TOP OF EXISTING DROP INLET EL= 66.00

ACS BENCHMARK  
STATION MARK IS A STANDARD INMSHC BRASS TABLET STAMPED "STA. 1-40-3" AND SET IN CONCRETE MONUMENT FLUSH WITH THE GROUND. TO REACH STATION FROM INTERSECTION AT EUBANK BLVD. AND CENTRAL AVE. GO NORTH ON EUBANK 0.7 MILES TO BRIDGE OVER INTERSTATE 40. STATION IS LOCATED IN THE MEDIAN OF EUBANK BLVD., 4TH SOUTH END OF THE BRIDGE.  
X=415,675.15, Y=1,485,440.00, Z=5452.804

LEGAL DESCRIPTION  
A PORTION OF TRACT ZASATA HORNE DEVELOPMENT ADDITION MARKET CENTER EAST.

- LEGEND
- EXISTING CONTOUR
  - NEW ASPHALT PAVING
  - EXISTING DROP INLET
  - NEW SPOT ELEVATION

de la torre • rainhart, pa  
architects  
north town office park  
780 academi rd n.e., building 2, suite 200  
albuquerque, nm 87109 / 505-828-9611

MICHAEL'S @ MARKET CENTRE EAST 1  
GRADING & DRAINAGE PLAN

dmg D. MARK GOODWIN & ASSOCIATES, P.A.  
CONSULTING ENGINEERS & SURVEYORS  
P.O. BOX 90606  
ALBUQUERQUE, NEW MEXICO 87199  
(505) 345-2010

Designed: GJK Drawn: JMB Checked: DMG Sheet 1 of 1  
Scale: AS SHOWN Date: 9/5/95 Job: 95096

DRAINAGE CALCULATIONS  
SINCE THE IMPREVIOUS AREA FOR THE PROPOSED PLAN IS THE SAME AS THAT OF THE APPROVED MASTER DRAINAGE PLAN FOR MARKET CENTER EAST DIRECT DISCHARGE IS ALLOWED.

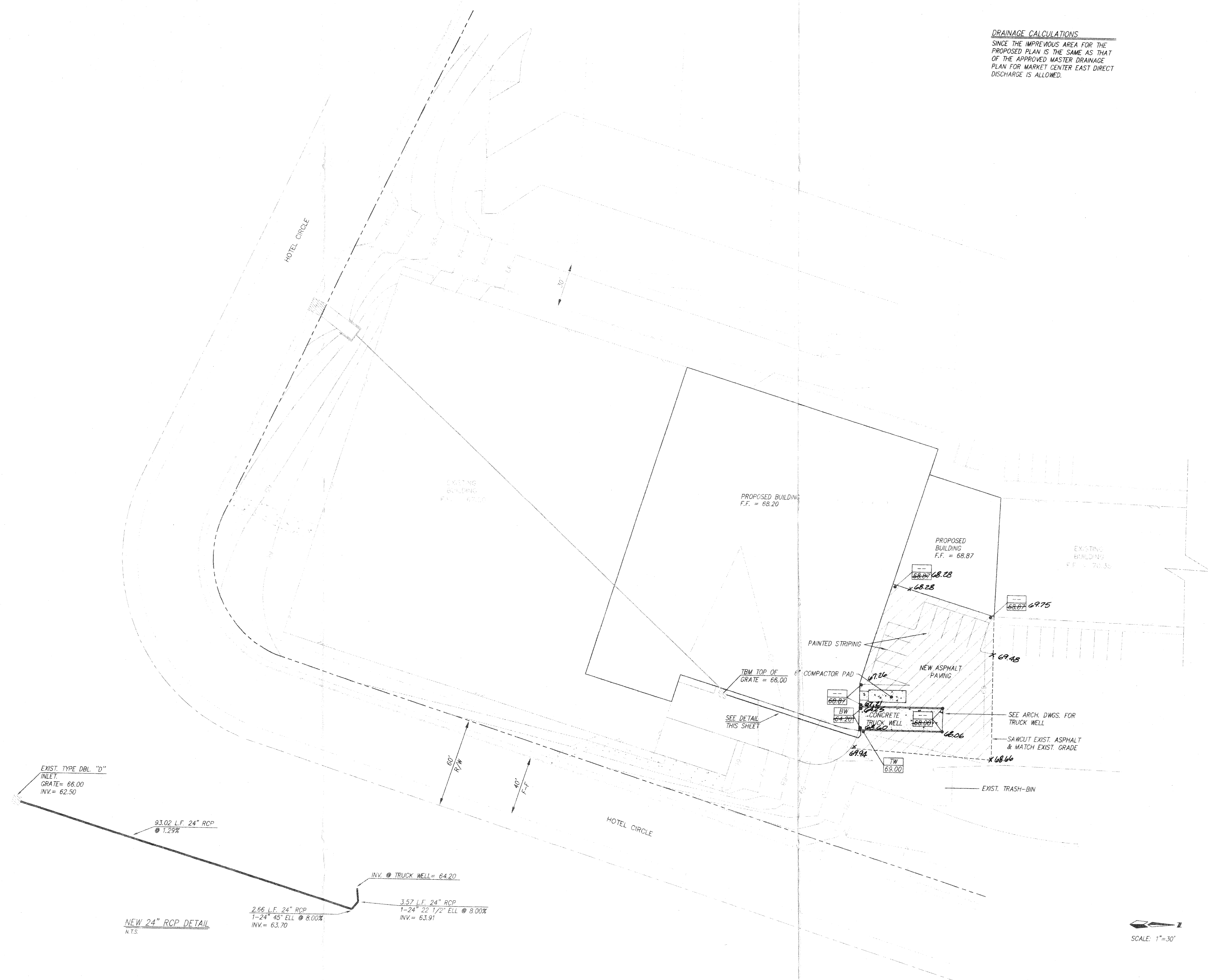

SCALE: 1"=30'

RECORD DRAWING

I hereby certify that the information contained on this drawing has been revised in accordance with information furnished by the Contractor, Wilger Enterprises, Inc. and reflects the construction as actually accomplished. This plan as constructed is in substantial compliance with the Approved Plan.

Gregory J. Krenik, NMPE 11929

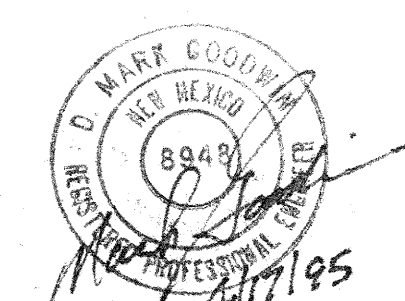
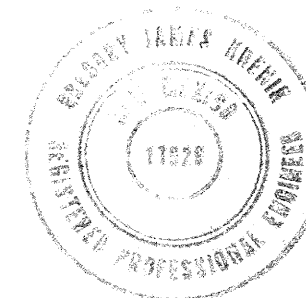

RECEIVED  
SEP 14 1995