

CITY OF ALBUQUERQUE



June 25, 2020

Patrick Whelan, RA
DIZIGNX
2440 Mares Rd SW
Albuquerque NM 87105

Re: Stripes Burrito CO#5
801 Juan Tabo NE
Traffic Circulation Layout
Architect's Stamp 06-12-20 (K21-D021)

Dear Mr. Whelan,

The TCL submittal received 06-22-2020 is approved for Building Permit with. A copy of the stamped and signed plan will be needed for each of the building permit plans. Please keep the original to be used for certification of the site for final C.O. for Transportation.

When the site construction is completed and an inspection for Certificate of Occupancy (C.O.) is requested, use the original City stamped approved TCL for certification. Redline any minor changes and adjustments that were made in the field. A NM registered architect or engineer must stamp, sign, and date the certification TCL along with indicating that the development was built in "substantial compliance" with the TCL. Submit this certification, the TCL, and a completed Drainage and Transportation Information Sheet to front counter personnel for log in and evaluation by Transportation.

Once verification of certification is completed and approved, notification will be made to Building Safety to issue Final C.O. To confirm that a final C.O. has been issued, call Building Safety at 924-3690.

Sincerely,

Nilo Salgado-Fernandez, P.E.
Senior Engineer, Planning Dept.
Development Review Services

C: CO Clerk, File

PO Box 1293

Albuquerque

NM 87103

www.cabq.gov

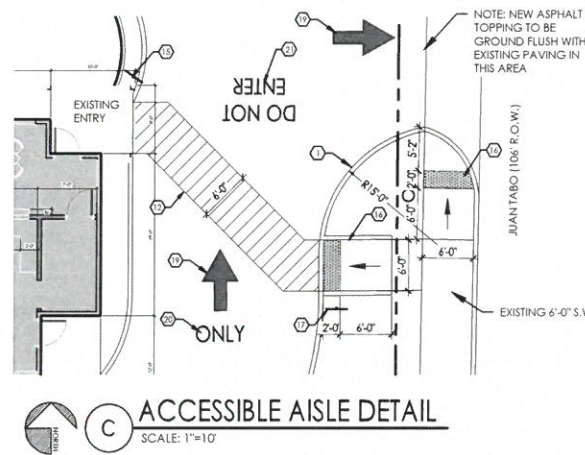
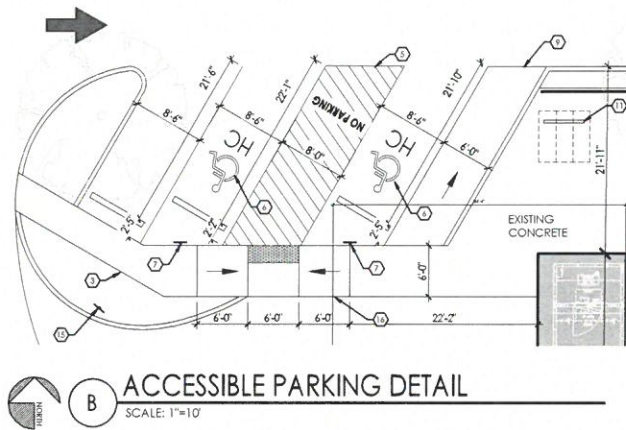

- ### DESIGN STANDARDS
1. ALL CURB ACCESS RAMPS (DRIVEPADS) SHALL BE CONSTRUCTED TO MEET THE CITY OF ALBUQUERQUE STD. DRAWING 2425.
 2. ALL SIDEWALKS SHALL BE CONSTRUCTED TO MEET THE CITY OF ALBUQUERQUE STD. DRAWING 2430.
 3. ALL SIDEWALK OBSTRUCTION SHALL MEET THE STANDARDS OF THE CITY OF ALBUQUERQUE STD. DRAWING 2431.
 4. ALL SIDEWALK JOINTS AND TRANSITIONS BETWEEN EXISTING AND NEW SIDEWALKS SHALL CONFORM TO THE CITY OF ALBUQUERQUE STD. DRAWING 2450.
 5. ALL NEW CURB CUTS TO THE SITE MUST BE CONSTRUCTED IN ACCORDANCE WITH THE CITY OF ALBUQUERQUE CITY STANDARD 2425 WITH THE GUTTER PROFILE MATCHING EXISTING.
 6. ALL NEW CURB AND GUTTERS MUST BE CONSTRUCTED IN ACCORDANCE WITH THE CITY OF ALBUQUERQUE CITY STANDARD 2415A, MATCHING EXISTING PROFILES.

- ### TCL NOTES:
1. LANDSCAPING AND SIGNAGE WILL NOT INTERFERE WITH CLEAR SIGHT REQUIREMENTS. THEREFORE, SIGNS, WALLS, TREES AND SHRUBBERY BETWEEN 3 AND 8 FEET TALL (AS MEASURED FROM THE GUTTER PAN) WILL NOT BE ACCEPTABLE IN THE CLEAR SIGHT TRIANGLE.
 2. ALL BROKEN OR CRACKED SIDEWALK MUST BE REPLACED WITH SIDEWALK AND CURB & GUTTER.
 3. REFUSE VEHICLE MANEUVERING SHALL BE CONTAINED ON-SITE. THE REFUSE VEHICLE SHALL NOT BACK INTO THE PUBLIC RIGHT OF WAY.

- ### KEYED NOTES
1. EXISTING 6" CONCRETE CURB AND GUTTER, TYPICAL.
 2. OVERLAY 1" ASPHALT OVER EXISTING PAVING, TYPICAL.
 3. EXISTING CONCRETE SIDEWALK, TYPICAL.
 4. NEW 4" WIDE PARKING STRIPPING PER CABQ STANDARDS, TYPICAL.
 5. HANDICAP ACCESSIBLE AISLE STRIPPING PER LOCAL CITY CODE & STANDARDS WITH THE WORD "NO-PARKING" MIN. 12" HIGH 2" STROKE, BLUE COLOR, 4" WIDE WHITE STRIPPING @ 1'-6" O.C. AT 45° ANGLE, TYP.
 6. INTERNATIONAL SYMBOL OF ACCESSIBILITY, CENTER IN PARKING SPACE, SYMBOL SHALL BE COLOR WHITE ON BLUE BACKGROUND.
 7. INSTALL HANDICAP PARKING SIGN AT ALL HANDICAP SPACES, SEE DETAIL 2/TCL-02.
 8. NEW DUMPSTER ENCLOSURE, SEE DETAIL 1/TCL-02.
 9. EXISTING 6'-0" WIDE CONCRETE A.D.A. RAMP WITH 1:12 MAX. SLOPE.
 10. EXISTING MENU BOARD LOCATION TO REMAIN.
 11. NEW BIKE RACK SEE DETAIL 8/TCL-02.
 12. NEW 6'-0" WIDE PEDESTRIAN ACCESS ISLE FROM EXISTING SIDEWALK, 4" WIDE WHITE STRIPPING @ 1'-6" O.C. AT 45° ANGLE, TYP.
 13. EXISTING SIGNAGE TO REMAIN.
 14. MOTORCYCLE ONLY PARKING SIGN, SEE DETAIL 4/TCL-02.
 15. "DO NOT ENTER" SIGN SEE DETAIL 5/TCL-02.
 16. EXISTING CONCRETE RAMP, INSTALL MIN. 2'-0" WIDE TRUNCATED DOMES STRIP AT LANDING.
 17. "PEDESTRIAN CROSSING" SIGN, SEE DETAIL 6/TCL-02.
 18. 4" WIDE STRIPPING PAINTED WHITE @ 1'-6" O.C. AT 45° ANGLE, TYP.
 19. DIRECTIONAL ARROW, SEE DETAIL 3/TCL-02.
 20. "ONLY" WITH DIRECTIONAL ARROW PAINTED ONTO ASPHALT PAVING, SEE DETAIL 9/TCL-02.
 21. "DO NOT ENTER" SIGN PAINTED ON ASPHALT PAVING SEE DETAIL 10/TCL-02.

- ### GENERAL NOTES
- A. PARKING LOT DIMENSIONS ARE FROM FACE OF CURB TO FACE OF CURB UNLESS OTHERWISE NOTED.
 - B. PROVIDE EXPANSION JOINTS IN CONCRETE WALK @ 40' O.C. AND WHERE CONCRETE ABUTS THE BUILDING.
 - C. PREMIS IDENTIFICATION - SHALL BE MINIMUM 24 INCHES HIGH x .5 INCH WIDE AND SHALL CONTRAST WITH THEIR BACKGROUND AND SHALL BE VISIBLE FROM THE STREET OR ROAD FRONTING THE PROPERTY.
 - D. O.C. TO PROVIDE FIRE EXTINGUISHERS 2A-10-BC, 1 PER EACH 3,000 S.F., REF: FLOOR PLANS FOR QUANTITY AND LOCATIONS.

PARKING CALCULATIONS

REQUIRED:	11 SPACES REQUIRED
RESTAURANT = 8 SPACES / 1,000 S.F. = 1,420 x .008 = 11.37	
ACCESSIBLE PARKING: 1-25 SPACES = 1 REG. & 1 VAN, ACC.	2 SPACES REQUIRED
MOTORCYCLE: 1-25 = 1	1 SPACE REQUIRED
BICYCLE: 3 REQUIRED	3 SPACES REQUIRED
PROVIDED:	14 SPACES PROVIDED
REGULAR PARKING SPACES =	
ACCESSIBLE PARKING SPACES =	2 SPACES PROVIDED
MOTORCYCLE:	1 SPACE PROVIDED
BICYCLE PARKING:	3 SPACES PROVIDED

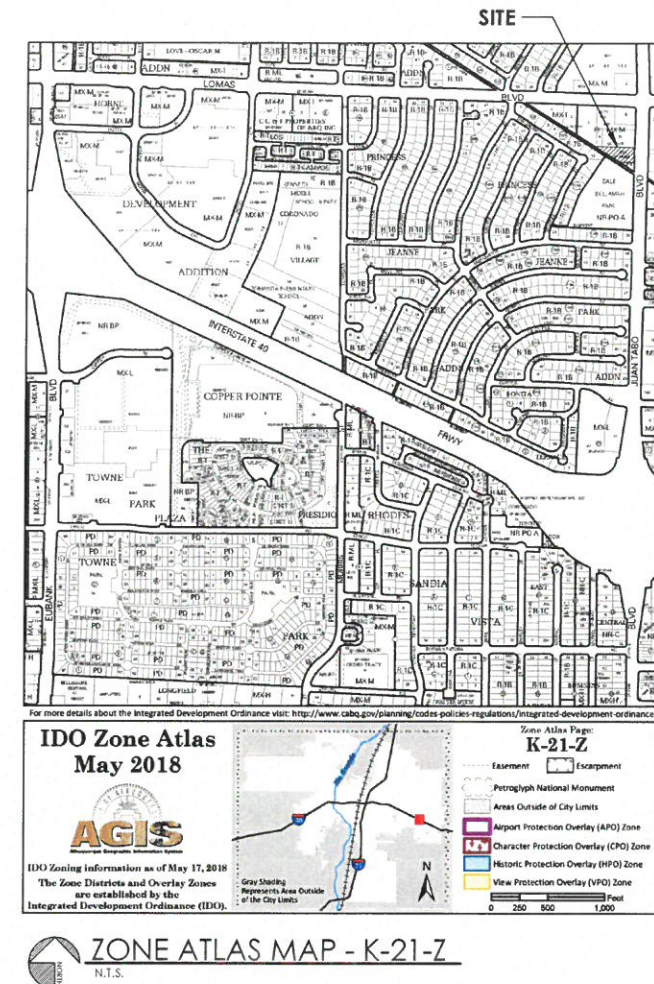

TRAFFIC CIRCULATION LAYOUT APPROVED

Signed: Date: 06/25/20

ALL WHEELCHAIR RAMPS LOCATED WITHIN THE PUBLIC RIGHT OF WAY MUST HAVE TRUNCATED DOMES.

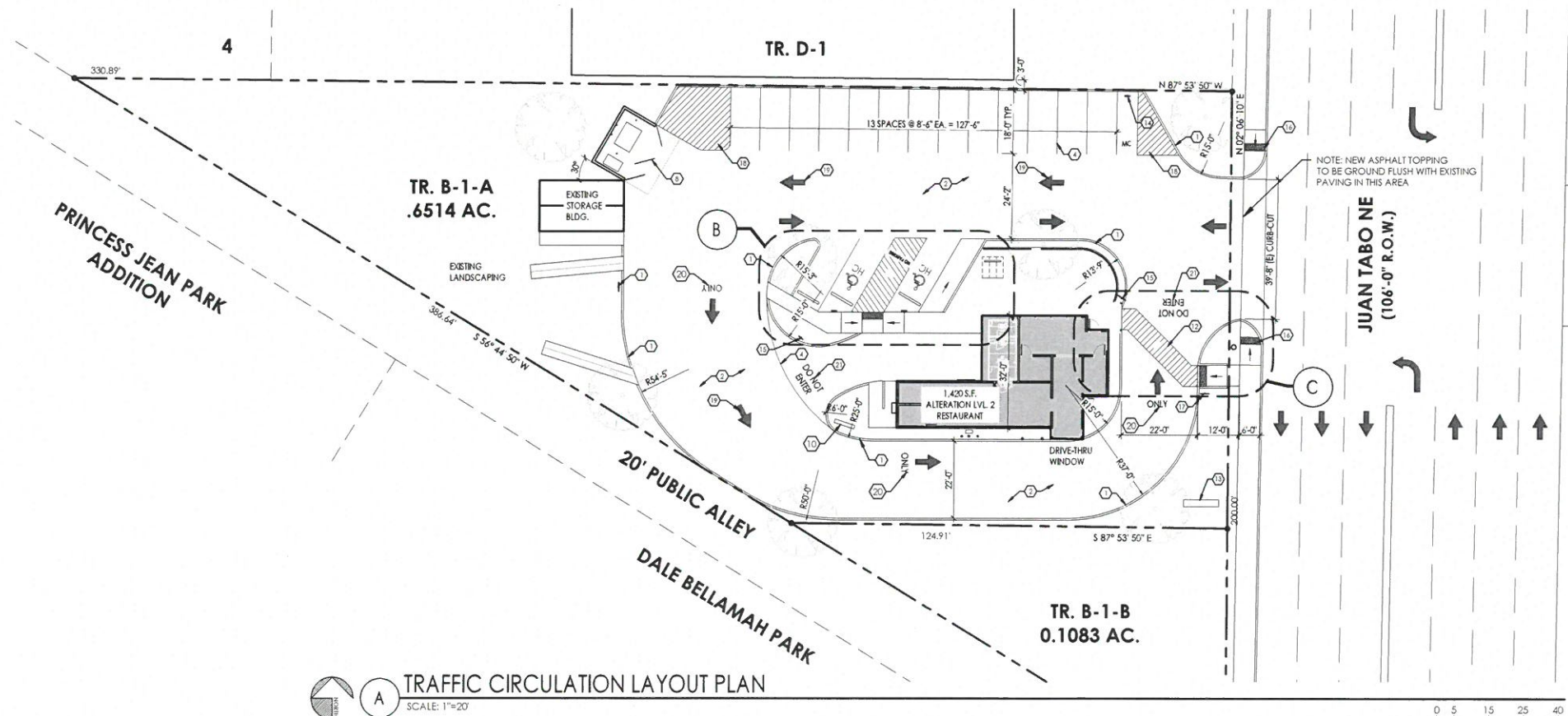

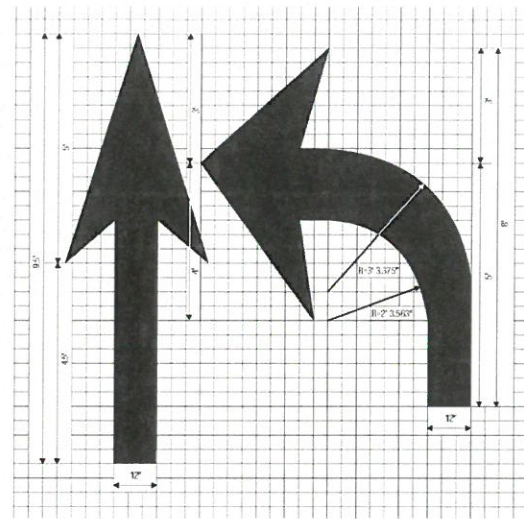

3 DIRECTIONAL ARROWS DETAIL
1" = 1'-0"

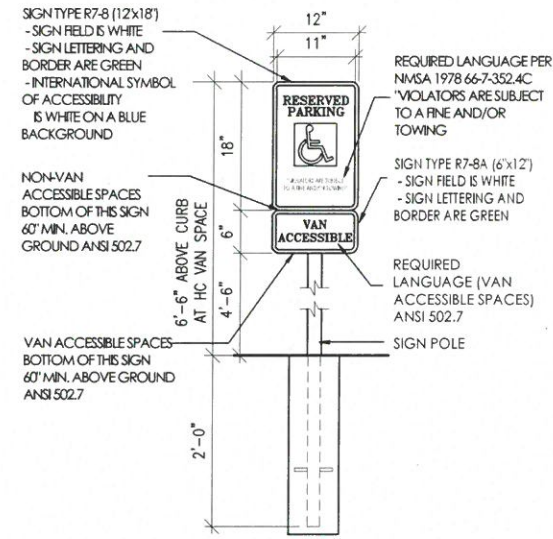

2 H.C. PARKING SIGN DETAIL
N.T.S.

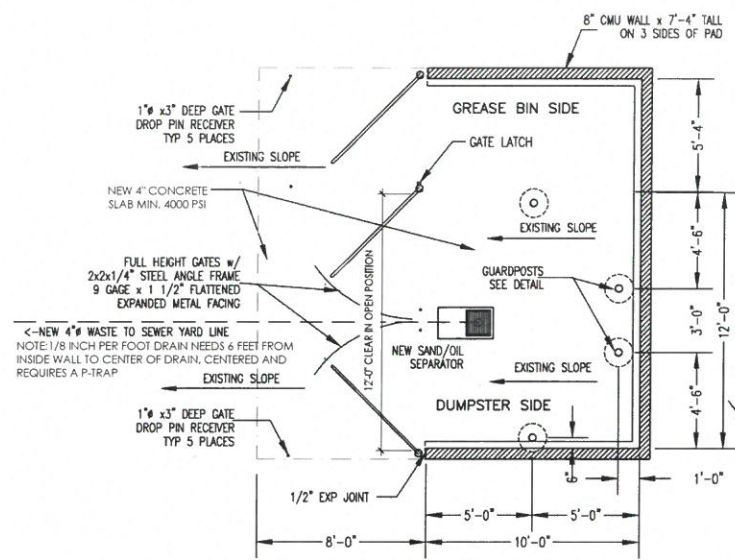

1 DUMPSTER ENCLOSURE DETAIL
1/4" = 1'-0"

THE SOLID WASTE DEPARTMENT IS TO PROVIDE ALL INSPECTIONS ON THE TRASH ENCLOSURE SUCH AS PRE-POUR FOR SLAB AND APRON, BOND BEAM, BOLLARD, AND FINAL INSPECTION INSPECTIONS WILL BE CONTINGENT FOR SOLID WASTE SIGN OFF FOR FINAL CO

THE SOLID WASTE DEPARTMENT WILL NOT BE HELD LIABLE FOR ANY DAMAGE TO THE EXISTING CONCRETE

THE SANITARY DRAIN IS TO MEASURE 6" INSIDE TO INSIDE AND IS REQUIRED TO HAVE A P-TRAP.

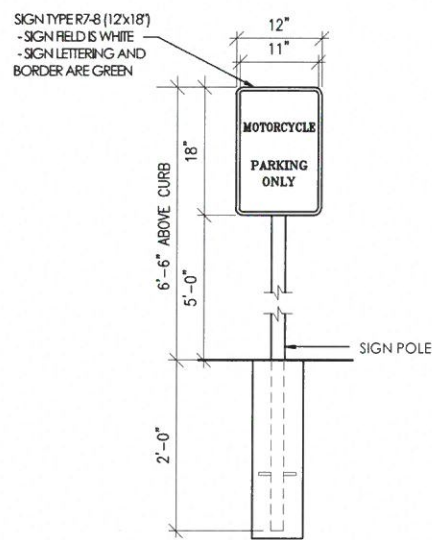
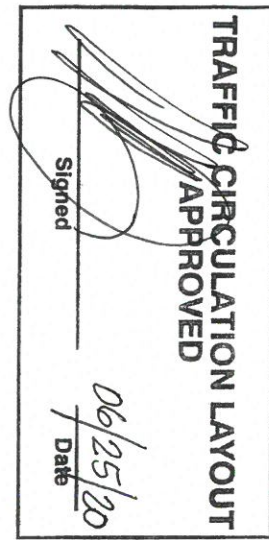

4 MOTORCYCLE SIGN DETAIL
N.T.S.

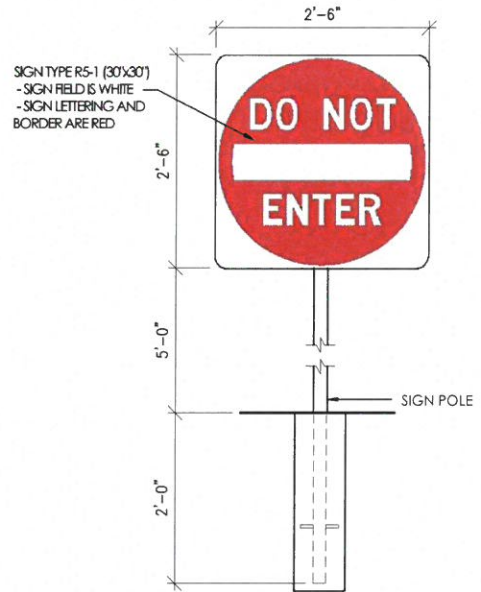

5 "DO NOT ENTER" SIGN
N.T.S.

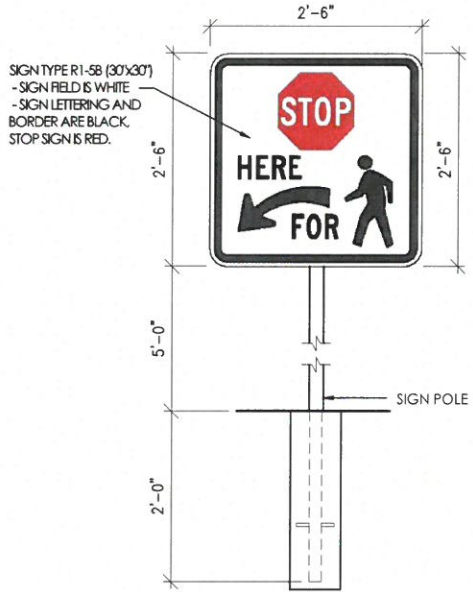

6 "PEDESTRIAN CROSSING" SIGN
N.T.S.

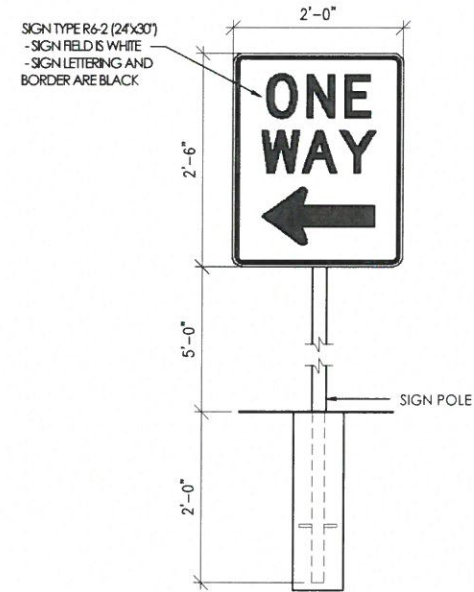

7 "ONE-WAY" SIGN
N.T.S.

ALL BICYCLE RACKS SHALL BE DESIGNED ACCORDING TO THE FOLLOWING GUIDELINES:

A. THE RACK SHALL BE A MINIMUM 30 INCHES TALL AND 18 INCHES WIDE.

B. THE BICYCLE FRAME SHALL BE SUPPORTED HORIZONTALLY AT TWO OR MORE PLACES. COMB/TOASTER RACKS ARE NOT ALLOWED.

C. THE RACK SHALL BE DESIGNED TO SUPPORT THE BICYCLE IN AN UPRIGHT POSITION. SEE THE I.D.O. FOR ADDITIONAL INFORMATION.

D. THE RACK ALLOWS VARYING BICYCLE FRAME SIZES AND STYLES TO BE ATTACHED.

E. THE USER IS NOT REQUIRED TO LIFT THE BICYCLE ONTO THE BICYCLE RACK.

F. EACH BICYCLE PARKING SPACE IS ACCESSIBLE WITHOUT MOVING ANOTHER BICYCLE.

G. BICYCLE RACKS SHALL BE STURDY AND ANCHORED TO A CONCRETE PAD.

H. A 1'-0" CLEAR ZONE AROUND THE BICYCLE PARKING STALL SHALL BE PROVIDED.

I. BICYCLE PARKING SPACES SHALL BE AT LEAST 6'-0" LONG AND 2'-0" WIDE.

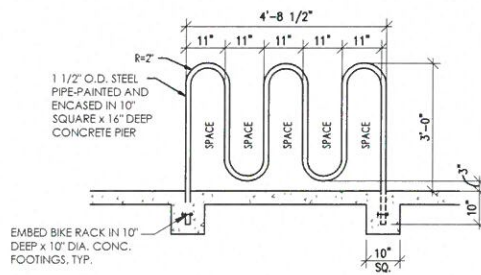

8 BIKE RACK DETAIL
N.T.S.

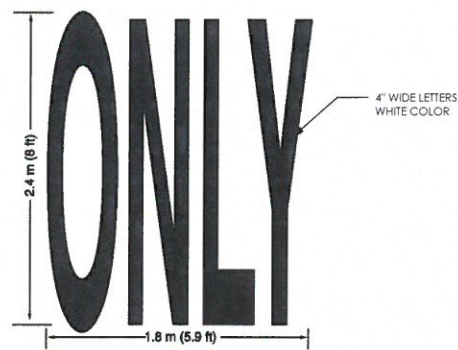

9 "ONLY" PAVEMENT MARKING DETAIL
N.T.S.



10 "DO NOT ENTER" PAVEMENT MARKING DETAIL
N.T.S.

DIZIGN X

XAVIER NUÑO-WHELAN
DESIGNER



PROJECT TITLE:

STRIPES BURRITO CO #5 - ALTERATION LVL 2

801 JUAN TABO NE

ALBUQUERQUE, NM 87123

SHEET TITLE:

SITE DETAILS

REVISION DATES:

01 06/22/2020

SHEET NUMBER:

TCL-02

SHEET 2 OF 2