

CITY OF ALBUQUERQUE

Planning Department
Brennon Williams, Director



Mayor Timothy M. Keller

May 26, 2021

Raymond J. Smith, P.E.
Souder, Miller & Associates
5454 Venice Ave NE, Suite D
Albuquerque, NM 87113

**RE: Freezer Expansion Phase 4
EL Encanto INC. (Bueno Foods)
2001 4th St. SW
Grading & Drainage Plan
Engineer's Stamp Date: 05/13/21
Hydrology File: L14D001A**

Dear Mr. Smith:

PO Box 1293

Based upon the information provided in your submittal received 05/14/2021, the Grading and Drainage Plan is approved for Building Permit.

Albuquerque

Please attach a copy of this approved plan in the construction sets for Building Permit processing along with a copy of this letter. Prior to approval in support of Permanent Release of Occupancy by Hydrology, Engineer Certification per the DPM checklist will be required.

NM 87103

www.cabq.gov

As a reminder, if the project total area of disturbance (including the staging area and any work within the adjacent Right-of-Way) is 1 acre or more, then an Erosion and Sediment Control (ESC) Plan and Owner's certified Notice of Intent (NOI) is required to be submitted to the Stormwater Quality Engineer (Doug Hughes, PE, jhughes@cabq.gov, 924-3420) 14 days prior to any earth disturbance.

Please provide Drainage Covenant for the detention pond per Article 6-15(C) of the DPM prior to Permanent Release of Occupancy. There is a recording fee (\$25, payable to Bernalillo County). Please contact me if you have any question pertaining to the Drainage Covenant and email me the Covenant and Exhibit prior to executing it for completeness.

Please do one of the following:

- Drop off the original executed drainage covenant, the exhibit, and the \$ 25.00 recording fee check made payable to Bernalillo County at the drop box outside the building and labeled the package using the address below.
- Mail the original executed drainage covenant, the exhibit, and the \$ 25.00 recording fee check made payable to Bernalillo County to:

CITY OF ALBUQUERQUE

Planning Department
Brennon Williams, Director



Mayor Timothy M. Keller

Planning Dept./DRC
Attn: Curtis Cherne
600 2nd St. NW, Ste. 400
Albuquerque, NM, 87102

Once approved and recorded, you will get a pdf copy of the recorded Drainage Covenant via email.

If you have any questions, please contact me at 924-3995 or rbrissette@cabq.gov.

Sincerely,

Renée C. Brissette

Renée C. Brissette, P.E. CFM
Senior Engineer, Hydrology
Planning Department

PO Box 1293

Albuquerque

NM 87103

www.cabq.gov



City of Albuquerque

Planning Department

Development & Building Services Division

DRAINAGE AND TRANSPORTATION INFORMATION SHEET (REV 10/2018)

Project Title: FREEZER EXPANSION PHASE 4
EL ENCANTO INC. (BUENO FOODS) **Building Permit #:** BP-2021-15703 **Hydrology File #:** _____
DRB#: _____ **EPC#:** _____ **Work Order#:** _____
Legal Description: PARID: 101405606625930418, PARID: 101405611124630419, PARID: 101405609518530434
City Address: 2001 4TH. ST. SW ALBUQUERQUE, NM 87102

Applicant: HANSEN RICE, INC. **Contact:** TYLER GOODWILL
Address: 1717 E. CHISHOLM DR. BOISE, ID 83687
Phone#: 208-442-4249 **Fax#:** _____ **E-mail:** tgoodwill@hansen-rice.com

Other Contact: SMA **Contact:** RAYMOND J. SMITH, P.E.
Address: 5454 VENICE AVENUE, SUITE D ALBUQUERQUE, NM 87113
Phone#: 505-595-7758 **Fax#:** _____ **E-mail:** raymond.smith@soudermiller.com

TYPE OF DEVELOPMENT: _____ PLAT (# of lots) _____ RESIDENCE _____ DRB SITE ☒ ADMIN SITE

IS THIS A RESUBMITTAL? _____ Yes ☒ No

DEPARTMENT: _____ TRAFFIC/TRANSPORTATION ☒ HYDROLOGY/DRAINAGE

Check all that Apply:

TYPE OF SUBMITTAL:

_____ ENGINEER/ARCHITECT CERTIFICATION
_____ PAD CERTIFICATION
_____ CONCEPTUAL G & D PLAN
☒ GRADING PLAN
_____ DRAINAGE MASTER PLAN
_____ DRAINAGE REPORT
_____ FLOODPLAIN DEVELOPMENT PERMIT APPLIC
_____ ELEVATION CERTIFICATE
_____ CLOMR/LOMR
_____ TRAFFIC CIRCULATION LAYOUT (TCL)
_____ TRAFFIC IMPACT STUDY (TIS)
_____ OTHER (SPECIFY) _____
_____ PRE-DESIGN MEETING?

TYPE OF APPROVAL/ACCEPTANCE SOUGHT:

☒ BUILDING PERMIT APPROVAL
_____ CERTIFICATE OF OCCUPANCY
_____ PRELIMINARY PLAT APPROVAL
_____ SITE PLAN FOR SUB'D APPROVAL
_____ SITE PLAN FOR BLDG. PERMIT APPROVAL
_____ FINAL PLAT APPROVAL
_____ SIA/ RELEASE OF FINANCIAL GUARANTEE
_____ FOUNDATION PERMIT APPROVAL
_____ GRADING PERMIT APPROVAL
_____ SO-19 APPROVAL
_____ PAVING PERMIT APPROVAL
_____ GRADING/ PAD CERTIFICATION
_____ WORK ORDER APPROVAL
_____ CLOMR/LOMR
_____ FLOODPLAIN DEVELOPMENT PERMIT
_____ OTHER (SPECIFY) _____

DATE SUBMITTED: 05/13/2021 **By:** TYLER GOODWILL

COA STAFF:

ELECTRONIC SUBMITTAL RECEIVED: _____

FEE PAID: _____

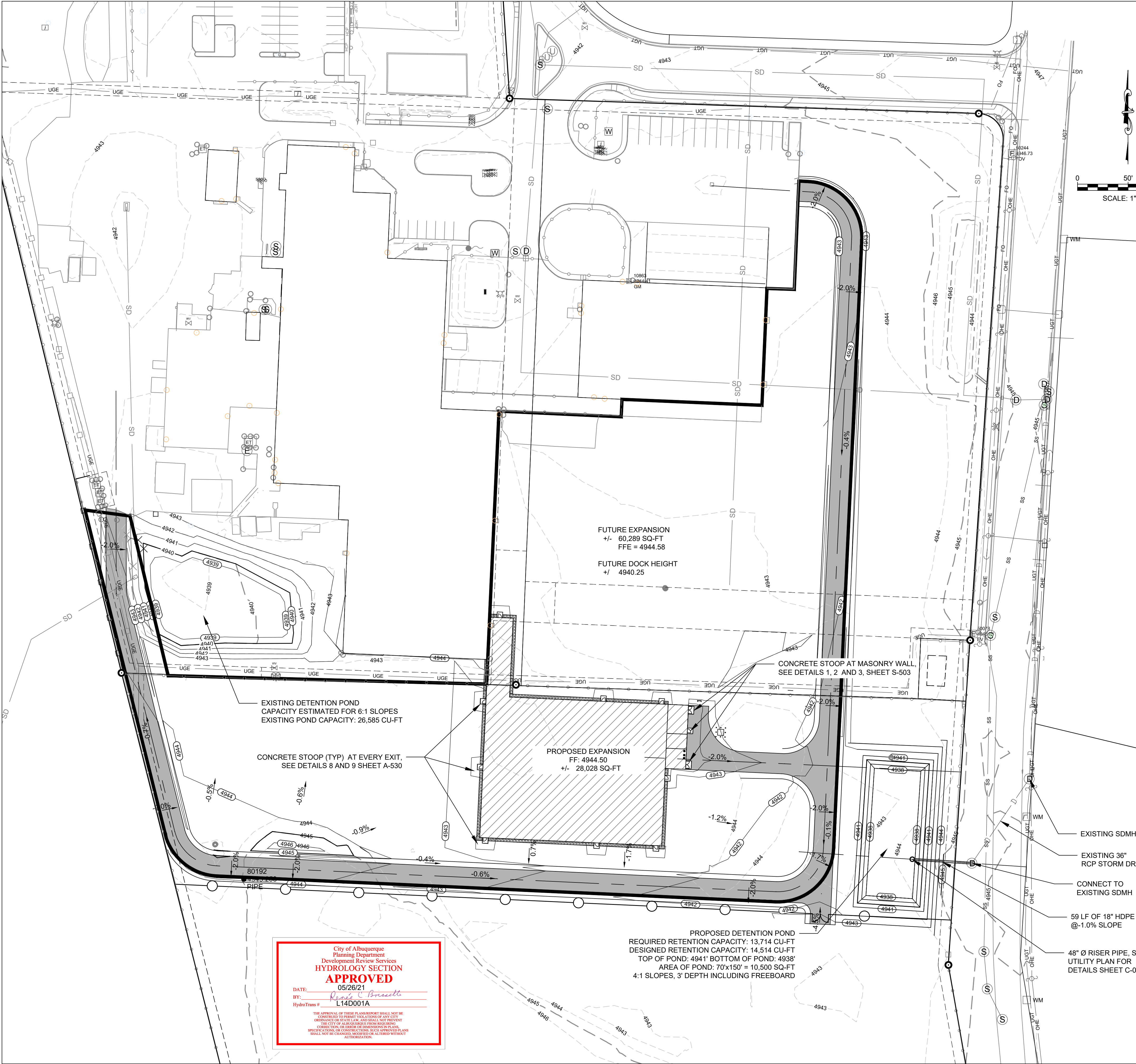

City of Albuquerque
Planning Department
Development Review Services
HYDROLOGY SECTION
APPROVED
DATE: 05/26/21
BY: *Renee C. Bennett*
Hydrology # L14D001A
THE APPROVAL OF THESE PLANS DOES NOT CONSTITUTE A GUARANTEE OF THE ACCURACY OF THE INFORMATION PROVIDED HEREON. THE USER OF THESE PLANS SHALL BE RESPONSIBLE FOR OBTAINING ALL NECESSARY PERMITS AND FOR OBTAINING ALL NECESSARY INFORMATION FROM ALL AFFECTED AGENCIES AND FOR OBTAINING ALL NECESSARY INFORMATION FROM ALL AFFECTED AGENCIES AND FOR OBTAINING ALL NECESSARY INFORMATION FROM ALL AFFECTED AGENCIES.

PROPOSED DETENTION POND		
100-YR ROUTING SUMMARY		
DESCRIPTION	UNIT	VALUE
RETURN PERIOD/DURATION	YR/HR	100/24
TOTAL DRAINAGE AREA	AC	5.9
INFLOW TIME TO PEAK	HRS	0.58
INFLOW PEAK FLOW RATE	CFS	19.5
INFLOW TOTAL RUNOFF VOLUME	CU-FT	40,188
OUTFLOW TIME TO PEAK	HRS	0.58
OUTFLOW PEAK FLOW RATE	CFS	13
OUTFLOW TOTAL RUNOFF VOLUME	CU-FT	40,188
MAXIMUM STORAGE VOLUME	CU-FT	14,514
DEAD STORAGE VOLUME	CU-FT	2,941
TOTAL RESERVOIR STORAGE TIME	HRS	24
RESERVOIR INVERT ELEVATION	FT	4,938.0
EMERGENCY SPILLWAY ELEVATION	FT	4,941.0
TOP OF EMBANKMENT ELEVATION	FT	4,941.0
MAXIMUM WATER SURFACE ELEVATION	FT	4,940.0
MAXIMUM WATER DEPTH	FT	2

CITY OF ALBUQUERQUE APPROVAL

CITY OF ALBUQUERQUE DEVELOPMENT PROCESS MANUAL (DPM)
PROCEDURE FOR 40 ACRE AND SMALLER BASINS

THE PRIMARY METHOD FOR HYDROLOGY CALCULATIONS IN THE DPM IS BASED ON THE ARID-LANDS HYDROLOGIC MODEL (AHYMO) CALCULATIONS. A SIMPLIFIED PROCEDURE FOR PROJECTS WITH BASINS SMALLER THAN 40 ACRES HAS BEEN DEVELOPED BASED ON INITIAL ABSTRACTION/UNIFORM INFILTRATION PRECIPITATION LOSSES AND RATIONAL METHOD PROCEDURES.

PRECIPITATION ZONES: SECTION 6-2(A)(1)

BERNALILLO COUNTY WITHIN CITY LIMITS HAS BEEN DIVIDED INTO 4 PRECIPITATION ZONES THAT CAN BE REVIEWED IN SECTION 6-2(A)(1). DPM IS BASED ON NATIONAL OCEANIC AND ATMOSPHERIC AGENCY (NOAA) ATLAS 14 PRECIPITATION DATA. FOR THE PROJECT SITE, ZONE 2 HAS BEEN SELECTED FOR LOCATIONS "BETWEEN THE RIO GRANDE AND SAN MATEO" AN EXCERPT OF PRECIPITATION DATA FROM TABLE 6.2.8 FOR ZONE 2 FOR THE 100-YEAR STORM EVENT IS INCLUDED BELOW.

PRECIPITATION FOR ZONE 2: 100-YEAR STORM EVENT											
	5	10	12	15	30	60	2	3	6	24	4
	MIN	MIN	MIN	MIN	MIN	MIN	HR	HR	HR	HR	DAY
DEPTH (IN)	0.565	0.860	1.070	1.440	1.780	2.030	2.100	2.290	2.590	2.960	3.620
INTENSITY (IN/HR)	6.78	5.16	4.81	4.28	2.88	1.78	1.02	0.70	0.38	0.11	0.03
FROM DPM TABLE 6.2.8											

LAND TREATMENTS: SECTION 6-2(A)(2)

LAND AREAS ARE DESCRIBED BY ONE OF FOUR BASIC LAND TREATMENTS OR BY A COMBINATION OF THE FOUR LAND TREATMENTS. LAND TREATMENTS CAN BE REVIEWED IN TABLE 6.2.9.

LAND TREATMENTS IN PROJECT SITE					
BASIN	AREA	LAND TREATMENT A (ACRES)	LAND TREATMENT B (ACRES)	LAND TREATMENT C (ACRES)	LAND TREATMENT D (ACRES)
SITE (HISTORIC)	5.9	1.7		4.1	0.1
SITE (DEVELOPED)	5.9	0.9		1.9	3.1
FROM TABLE 6.2.9 IN DPM					

ABSTRACTIONS: SECTION 6-2(A)(3)

INITIAL ABSTRACTION IS THE PRECIPITATION DEPTH THAT MUST BE EXCEEDED BEFORE DIRECT RUNOFF BEGINS. INITIAL ABSTRACTION MAY BE INTERCEPTED BY VEGETATION, RETAINED IN SURFACE DEPRESSIONS, OR ABSORBED ON THE WATERSHED SURFACE.

ABSTRACTION IN PROJECT SITE BY LAND TREATMENT					
BASIN	ABSTRACTION FOR TREATMENT A	ABSTRACTION FOR TREATMENT B	ABSTRACTION FOR TREATMENT C	ABSTRACTION FOR TREATMENT D	WEIGHTED INITIAL ABSTRACTION (IN)
SITE (HISTORIC)	0.65	0.50	0.35	0.10	0.54
SITE (DEVELOPED)	0.65	0.50	0.35	0.10	0.31
FROM TABLE 6.2.11 IN DPM					

EXCESS PRECIPITATION AND VOLUMETRIC RUNOFF: SECTION 6-2(A)(4)

EXCESS PRECIPITATION, E, IS THE DEPTH OF PRECIPITATION REMAINING AFTER ABSTRACTIONS ARE REMOVED. EXCESS PRECIPITATION DOES NOT DEPEND ON WATERSHED AREA. EXCESS PRECIPITATION IS DETERMINED BY SUBTRACTING THE INITIAL ABSTRACTION AND INFILTRATION FROM THE DESIGN STORM HYDROGRAPH.

HISTORIC VOLUMETRIC RUNOFF PER EQUATION 6.2 = 23,003 CU-FT
DEVELOPED VOLUMETRIC RUNOFF PER EQUATION 6.2 = 40,188 CU-FT

EXCESS PRECIPITATION IN PROJECT SITE BY LAND TREATMENT					
BASIN	EXCESS PRECIPITATION TREATMENT A	EXCESS PRECIPITATION TREATMENT B	EXCESS PRECIPITATION TREATMENT C	EXCESS PRECIPITATION TREATMENT D	WEIGHTED EXCESS PRECIPITATION (IN)
SITE (HISTORIC)	0.62	0.80	1.03	2.33	0.77
SITE (DEVELOPED)	0.62	0.80	1.03	2.33	1.58
FROM TABLE 6.2.13 IN DPM					

PEAK DISCHARGE RATE FOR SMALL WATERSHEDS: SECTION 6-2(A)(5)

PEAK DISCHARGE RATES ARE GIVEN IN TABLE 6.2.14 FOR SMALL WATERSHEDS, LESS THAN OR EQUAL TO 40 ACRES, WHERE THE TIME OF CONCENTRATION IS ASSUMED TO BE 12 MINUTES.

HISTORIC PEAK DISCHARGE RATE PER EQUATION 6.6 = 13.0 CFS
DEVELOPED PEAK DISCHARGE RATE PER EQUATION 6.6 = 19.5 CFS

STORM WATER QUALITY VOLUME

TO CALCULATE THE REQUIRED SWQV, THE IMPERVIOUS AREA IS MULTIPLIED BY 0.42" FOR NEW DEVELOPMENT OR 0.26" FOR REDEVELOPMENT SITES.

(3.1 ac * 43,560 ft / ac) * (0.26 in * 1 ft / 12 in) = 2,926 cu-ft
REQUIRED VOLUME TO BE RETAINED IN BMP: 2,926 cu-ft
PROVIDED VOLUME TO BE RETAINED IN BMP: 2,941 cu-ft

SOUDER, MILLER & ASSOCIATES
Engineering • Environmental • Surveying
Serving the Southwest & Rocky Mountains
5454 Venice Avenue NE, Suite D
Albuquerque, NM 87113
Phone (505) 299-0942 Toll Free (877) 299-0942 Fax (505) 293-3430
www.soudermiller.com



PROFESSIONAL SEAL

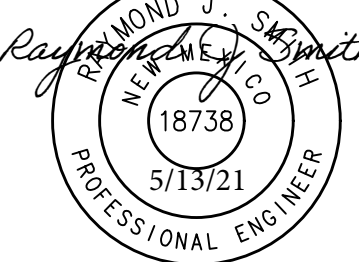

DO NOT SCALE DRAWINGS

CONTRACTOR SHALL VERIFY ALL CONDITIONS AND DIMENSIONS AT THE JOB SITE AND NOTIFY HANSEN-RICE, INC. OF ANY DIMENSIONAL ERRORS, OMISSIONS, OR DISCREPANCIES BEFORE BEGINNING OR FABRICATING ANY WORK.



CLIENT DESCRIPTION:
BUENO FOODS

2001 4TH ST SW ALBUQUERQUE, NM 87102
FREEZER EXPANSION - PHASE IV

DATE	04/09/2021
DESCRIPTION	ISSUED FOR PERMIT REVIEW ADDED CALL-OUT FOR STORMWATER QUALITY VOLUME
NO.	1
JOB NUMBER	20002500
SCALE	SCALE @ 24"x36" As indicated
DRAWN BY	CYO
DATE ISSUED	4/09/2021
SHEET NAME	GRADING AND DRAINAGE PLAN
REVISION	SHEET
	C-004

