

DRAINAGE INFORMATION SHEET

PROJECT TITLE: TRACT 1 - CLAYTON HEIGHTS ZONE ATLAS/DRNG. FILE #: L-15 1021

LEGAL DESCRIPTION: TRACT 1 - CLAYTON HEIGHTS

CITY ADDRESS: \_\_\_\_\_

ENGINEERING FIRM: FRED DENNEY & ASSOCIATES, INC. CONTACT: Joe Jones

ADDRESS: 2400 Comanche NE, Albuquerque, NM 87107 PHONE: 884-0696

OWNER: \_\_\_\_\_ CONTACT: \_\_\_\_\_

ADDRESS: \_\_\_\_\_ PHONE: \_\_\_\_\_

ARCHITECT: LARRY ABRAMS CONTACT: LARRY ABRAMS

ADDRESS: \_\_\_\_\_ PHONE: 275-2220

SURVEYOR: FRED DENNEY & ASSOCIATES, INC. CONTACT: Kevin Daly

ADDRESS: 2400 Comanche NE, Albuquerque, NM 87107 PHONE: 884-0696

CONTRACTOR: \_\_\_\_\_ CONTACT: \_\_\_\_\_

ADDRESS: \_\_\_\_\_ PHONE: \_\_\_\_\_

PRE-DESIGN MEETING:

YES  
 NO

COPY OF CONFERENCE RECAP SHEET PROVIDED

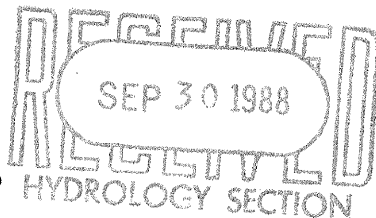

DRB No. \_\_\_\_\_  
EPC No. \_\_\_\_\_  
PROJ. No. \_\_\_\_\_

TYPE OF SUBMITTAL:

- DRAINAGE REPORT
- DRAINAGE PLAN
- CONCEPTUAL GRADING & DRAINAGE PLAN
- GRADING PLAN
- EROSION CONTROL PLAN
- ENGINEER'S CERTIFICATION

CHECK TYPE OF APPROVAL SOUGHT:

- SECTOR PLAN APPROVAL
- SKETCH PLAT APPROVAL
- PRELIMINARY PLAT APPROVAL
- SITE DEVELOPMENT PLAN APPROVAL
- FINAL PLAT APPROVAL
- BUILDING PERMIT APPROVAL
- FOUNDATION PERMIT APPROVAL
- CERTIFICATE OF OCCUPANCY APPROVAL
- ROUGH GRADING PERMIT APPROVAL
- GRADING/PAVING PERMIT APPROVAL

DATE SUBMITTED: 9/30/88

BY: Joe Jones

REV. 10/85

OTHER \_\_\_\_\_ (SPECIFY)



DENNEY - GROSS & ASSOCIATES, INC.  
 ENGINEERS SURVEYORS PLANNERS  
 2400 COMANCHE ROAD N.E.  
 ALBUQUERQUE, NEW MEXICO 87107  
 (505) 884-0895

LOCATION CLAYTON HEIGHTS  
 PROJ. NO. 848.11  
 DATE 1/14/86  
 DESIGNER J. JONES  
 PAGE 1

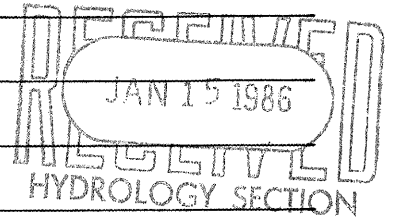

DRAINAGE CALCULATIONS	
<p><u>MANNING'S</u>  <math>Q = \frac{1.486 S^{1/2}}{n} A R^{2/3}</math></p>	
<p><math>n = 0.02</math> (PART CONCRETE, PART EARTH)  <math>S = 0.0089</math>  <math>Q = 2.4</math> CFS</p>	<p><math>2.4 = \frac{1.486 (0.0089)^{1/2}}{0.02} A R^{2/3}</math>  <math>A R^{2/3} = 0.34</math></p>
<p><u>TRY</u> <math>d = 0.3'</math></p>	<p><math>A = \frac{1}{2} (0.3) (0.3) = 1.1</math> SF  <math>R = \frac{A}{P} = \frac{1.1}{7.7} = 0.143</math>  <math>A R^{2/3} = 1.1 (0.143)^{0.67} = 0.30 \approx 0.34</math> (OK)</p>
	<p><u>100 YR DEPTH = APPROXIMATELY 0.3'</u></p>
<p><u>VELOCITY</u>  <math>V = \frac{Q}{A} = \frac{2.4}{1.1} = 2.2</math> FPS 100 YR VELOCITY</p>	
<p><u>ROOF DRAIN (AT REAR)</u>  <math>A = 130 \times 36 = 0.107</math> AC  <math>Q = C I A = 0.9 (4.86) (0.107) = 0.45</math> CFS</p>	
<p><u>SWALE CAPACITY</u>  <math>Q = \frac{1.486 S^{1/2}}{n} A R^{2/3}</math></p>	
<p><math>A = \frac{1}{2} (5 \times 0.5) = 1.25</math>  <math>S = 0.02</math> (MINIMUM)  <math>n = 0.025</math> (GRASS)</p>	<p><math>R = \frac{A}{P} = \frac{1.25}{5.4} = 0.23</math>  <math>Q = \frac{1.486 (0.02)^{1/2} (1.25) (0.23)^{0.67}}{0.025} = 3.9</math> CFS <math>&gt; 0.5</math> (OK)</p>



DENNEY - GROSS & ASSOCIATES, INC.  
 ENGINEERS SURVEYORS PLANNERS  
 2400 COMANCHE ROAD N.E.  
 ALBUQUERQUE, NEW MEXICO 87107  
 (505) 884-0695

LOCATION CLAYTON HEIGHTS  
 PROJ. NO. 848.11  
 DATE 1/14/86  
 DESIGNER J. JONES  
 PAGE 2

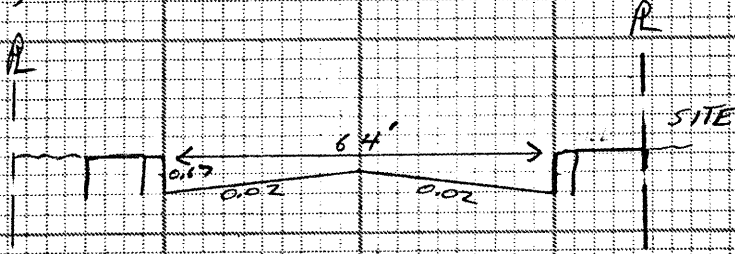
<p><u>MANNINGS</u>  <math>Q = 1.486 S^{1/2} A R^{2/3}</math>  <math>n = 0.013</math> (CONCRETE)  <math>S = 0.11</math>  <math>A = 1 \times 0.67 = 0.67 SF</math>  <math>R = \frac{0.67}{1.34} = 0.5</math></p>	<p><u>SIDEWALK CULVERT (CAPACITY)</u>  <math>Q = \frac{1.486}{0.013} (0.11)^{1/2} (0.67) (0.5)^{2/3}</math>  <math>Q = 11.1 CFS \gg 2.4 CFS (OK)</math></p>
<p><u>OFFSITE Q = 30 CFS (SEE PLAN)</u>  <u>MANNINGS</u>  <math>Q = 30 CFS</math>  <math>n = 0.017</math>  <math>S = 0.005</math> (MINIMUM)</p>	<p><u>YALE BLVD. (CAPACITY) 64' F-F</u></p>  <p><u>TYPICAL SECTION</u></p>
<p>NOTE: FLOWS ARE FROM THE EAST. CHECK TO SEE IF FLOWS WILL REMAIN IN EAST LANES.</p>	<p><math>A = \frac{1}{2} (6.7 \times 32) = 10.72</math>  <math>R = \frac{A}{P} = \frac{10.72}{12.67} = 0.84</math></p> <p><math>Q = \frac{1.486}{0.017} (0.005)^{1/2} (10.72) (0.84)^{2/3}</math>  <math>Q = 31.5 CFS</math> MAXIMUM CAPACITY (1/2 STREET)</p>
<p><u>CONCLUSION:</u> THE MAJOR PORTION OF THE FLOWS IN THE STREET WILL REMAIN IN THE EAST LANES. THE EAST LANES WILL FLOW AT CURB DEPTH.</p>	



# City of Albuquerque

P.O. BOX 1293 ALBUQUERQUE, NEW MEXICO 87103

DESIGN HYDROLOGY SECTION  
123 Central NW, Albuquerque, NM 87102  
(505) 766-7644

January 31, 1986

Joe Jones  
Denney-Tibljias-McLean & Associates, Inc.  
2400 Comanche Road, NE  
Albuquerque, New Mexico 87107

RE: DRAINAGE PLAN FOR TRACT 1 OF CLAYTON HEIGHTS  
RECEIVED JANUARY 15, 1986 (L-15/D21)

Dear Mr. Jones:

The referenced plan dated January 14, 1986, is approved for Building Permit sign-off.

Please attach a copy of this approved plan along with the appropriately approved "Drainage Facilities Within City Right-of-Way" document to the constructions plans prior to sign-off.

If you have any questions regarding this project, call me at 766-7644.

Cordially,

Carlos A. Montoya, P.E.  
City/County Floodplain Administrator

CAM/bsj

MUNICIPAL DEVELOPMENT DEPARTMENT

C. Dwayne Sheppard, P.E., City Engineer

ENGINEERING DIVISION

Telephone (505) 766-7467

AN EQUAL OPPORTUNITY EMPLOYER

FILE COPY

# City of Albuquerque

P.O. BOX 1293 ALBUQUERQUE, NEW MEXICO 87103



## HYDROLOGY SECTION

123 Central NW, Albuquerque, NM 87102  
(505) 766-7644

November 13, 1986

Joe Jones  
Denney-Tibljias-McLean & Associates, Inc.  
2400 Comanche Road, NE  
Albuquerque, New Mexico 87107

RE: DRAINAGE COMPLAINT FOR TRACT 1 OF CLAYTON HEIGHTS  
APPROVED JANUARY 31, 1986 (L-15/D21)

Dear Mr. Jones:

We have received drainage complaints from the west adjoining property owners. The berm shown on section B-B has eroded and failed, causing flow to drain to the west properties.

Please correct this problem prior to Certificate of Occupancy release. We would suggest a more permanent swale so that this problem does not occur in the future.

Cordially,

Carlos A. Montoya, P.E.  
City/County Floodplain Administrator

cc: Rick Duran

CAM/bsj

PUBLIC WORKS DEPARTMENT

Walter Nickerson, P.E., City Engineer

ENGINEERING GROUP

Telephone (505) 768-2500

AN EQUAL OPPORTUNITY EMPLOYER

FILE COPY



# City of Albuquerque

P.O. BOX 1293 ALBUQUERQUE, NEW MEXICO 87103

Ken Schultz  
Mayor

UTILITY DEVELOPMENT DIVISION  
HYDROLOGY SECTION  
(505) 768-2650

April 14, 1987

Joe Jones  
Denney-Tibljias-McLean & Associates  
2400 Comanche Road, NE  
Albuquerque, New Mexico 87107

RE: DRAINAGE COMPLAINT FOR TRACT 1 OF CLAYTON HEIGHTS APPROVED  
JANUARY 31, 1986 (L-15/D21)

Dear Mr. Jones:

This is a follow-up to my November 13, 1986 letter. As stated in that letter, runoff from your site is discharging west onto adjoining properties contrary to the approved drainage plan. At that time, I was assured that this problem would be corrected. We are still receiving complaints from these property owners. A site visit indicated that the parking lot and the west swale (Section B-B) are discharging to the west properties. The proposed sidewalk culvert, curb and gutter, and pond were not constructed. We will not release the Certificate of Occupancy till these matters are corrected. Also, because of the potential damage to the west property owners, if the problems are not corrected within thirty (30) days, we will submit this information to the City Legal Department.

If you should have any questions, please call me at 768-2650.

Cordially,

Carlos A. Montoya, P.E.  
City/County Floodplain Administrator

cc: Rick Duran  
Knight Seavey

CAM/bsj

PUBLIC WORKS DEPARTMENT

Walter Nickerson, P.E., City Engineer

ENGINEERING GROUP

Telephone (505) 768-2500

# dtm & associates, inc

Denney-Tibljias-McLean & Associates, Inc.  
Consulting Engineers ■ Planners ■ Surveyors

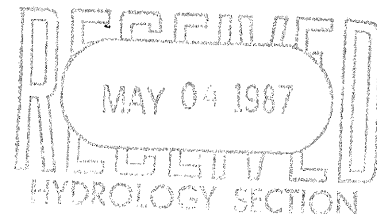

April 30, 1987

Mr. Larry P. Abraham  
First City Realtors, Inc.  
2501 San Pedro Drive NE  
Albuquerque, NM 87110

Re: Clayton Heights  
(L-15/D21)  
DTM Job No. 848.11

Dear Larry:

Enclosed is one copy of a complaint letter that we recently received from City Hydrology concerning subject project. The letter states that there is stormwater runoff discharging from your site west onto adjacent properties.

We have completed a site investigation, and we concur with City Hydrology. Although most of the runoff from your site is diverted north through the trash enclosure, the existing berm has breached and some runoff is entering the western properties. Also, the roof drain on the south side of the building needs to be relocated to the rear of the building and the proposed swale constructed as indicated on the Drainage Plan.

Due to the potential damage to the property to the west, we recommend that a berm be constructed along your western boundary immediately. This berm should be maintained while the remaining drainage improvements are constructed.

If you have any questions or comments concerning this project, please call.

Sincerely,

A handwritten signature in cursive script that reads "Joe Jones".

Joe Jones

JJ/k1b  
Enclosure  
cc: ✓ Mr. Carlos Montoya  
Mr. Knight Seavey

2400 COMANCHE ROAD, NE ■ ALBUQUERQUE, NM 87107  
TELEPHONE [505] 884-0696

# City of Albuquerque

P.O. BOX 1293 ALBUQUERQUE, NEW MEXICO 87103



HYDROLOGY SECTION  
123 Central NW, Albuquerque, NM 87102  
(505) 766-7644

November 13, 1986

Joe Jones  
Denney-Tibljias-McLean & Associates, Inc.  
2400 Comanche Road, NE  
Albuquerque, New Mexico 87107

RE: DRAINAGE COMPLAINT FOR TRACT 1 OF CLAYTON HEIGHTS  
APPROVED JANUARY 31, 1986 (L-15/D21)

Dear Mr. Jones:

We have received drainage complaints from the west adjoining property owners. The berm shown on section B-B has eroded and failed, causing flow to drain to the west properties.

Please correct this problem prior to Certificate of Occupancy release. We would suggest a more permanent swale so that this problem does not occur in the future.

Cordially,

Carlos A. Montoya, P.E.  
City/County Floodplain Administrator

cc: Rick Duran

CAM/bsj

PUBLIC WORKS DEPARTMENT

Walter Nickerson, P.E., City Engineer

ENGINEERING GROUP

Telephone (505) 768-2500

AN EQUAL OPPORTUNITY EMPLOYER



FILE COPY

# City of Albuquerque

P.O. BOX 1293 ALBUQUERQUE, NEW MEXICO 87103



Ken Schultz  
Mayor

UTILITY DEVELOPMENT DIVISION  
HYDROLOGY SECTION  
(505) 768-2650

June 16, 1987

Joe Jones  
Fred Denney & Associates  
2400 Comanche Road, NE  
Albuquerque, New Mexico 87107

RE: RESUBMITTAL OF DRAINAGE PLAN FOR TRACT 1 OF CLAYTON HEIGHTS  
(L-15/D21) RECEIVED JUNE 4, 1987

Dear Mr. Jones:

The above referenced plan dated June 1987, (Revision #4), is approved for Building Permit.

Please attach a copy of this plan along with the approved "Drainage Facilities Within City Right-of-Way" to both sets of construction drawings prior to sign-off by Hydrology.

If I can be of further assistance, please feel free to call me at 768-2650.

Cordially,

Carlos A. Montoya, P.E.  
City/County Floodplain Administrator

BJM/bsj

cc: Rick Duran  
Lloyd Barlow  
Rita Conlin  
Becky Sandoval

CAM/bsj

PUBLIC WORKS DEPARTMENT

Walter Nickerson, P.E., City Engineer

ENGINEERING GROUP

Telephone (505) 768-2500

AN EQUAL OPPORTUNITY EMPLOYER

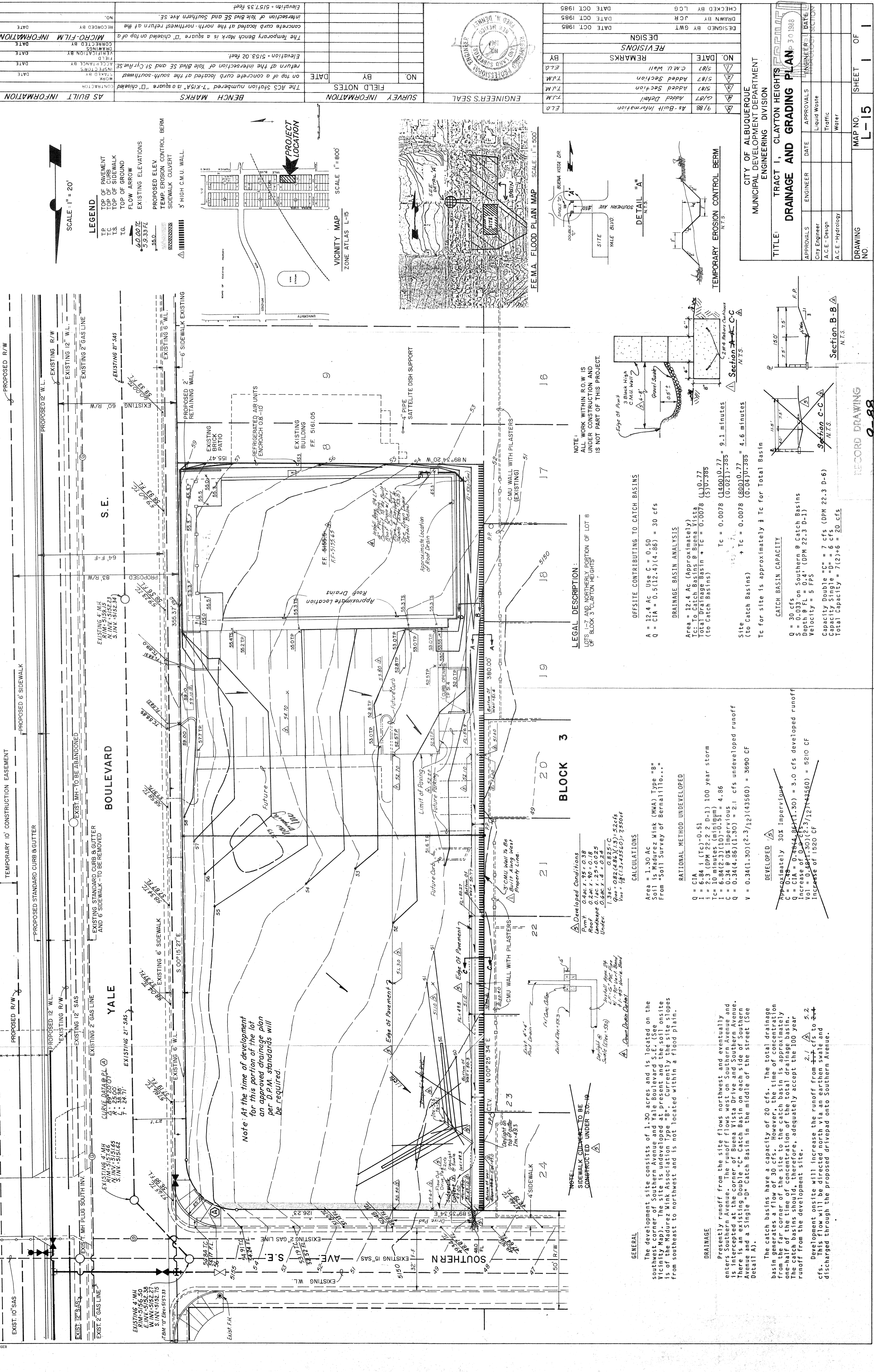

AS BUILT INFORMATION

NO.	DATE	BY	DESCRIPTION
1	10/15/85	JCR	Initial Design
2	10/22/85	JCR	Revised Design
3	11/05/85	JCR	Final Design

FIELD NOTES

The ACS Station numbered "7-K15" is a square "C" chiseled on top of a concrete curb located at the south-southwest return of the intersection of Yale Blvd SE and St Cyr Ave SE.

The temporary bench mark is a square "D" chiseled on top of a concrete curb located at the north-northwest return at the intersection of Yale Blvd SE and Southern Ave SE.

Elevation = 5157.33 feet

Elevation = 5153.02 feet

RECORD DRAWING

9-88

MAP NO. L-15

SHEET 1 OF 1

DRAWING NO. L-15

DATE OCT 1985

DESIGNED BY GW

CHECKED BY LCG

DATE OCT 1985

REVISIONS

NO.	DATE	REMARKS
1	9/88	As-Built Information
2	6/87	Added Detail
3	5/87	Added Section
4	5/87	CMU Wall

LEGEND

- TP TOP OF PAVEMENT
- TC TOP OF CURB
- T.S. TOP OF SIDEWALK
- T.G. TOP OF GROUND
- FLOW ARROW
- EXISTING ELEVATIONS
- PROPOSED ELEV.
- TEMP. EROSION CONTROL BERM
- SIDEWALK CURB
- 3' HIGH CMU WALL

SCALE: 1" = 20'

VICINITY MAP

SCALE: 1" = 800'

ZONE ATLAS L-15

ENGINEER'S SEAL

PROPOSED 10' CONSTRUCTION EASEMENT

PROPOSED 12' W.L.

EXISTING 12' W.L.

EXISTING 6' SIDEWALK

EXISTING 2' GAS LINE

EXISTING 21" GAS

EXISTING 6" SIDEWALK

EXISTING 6" SIDEWALK

EXISTING 6" SIDEWALK

EXISTING 6" SIDEWALK

EXISTING 6" SIDEWALK

EXISTING 6" SIDEWALK

EXISTING 6" SIDEWALK

EXISTING 6" SIDEWALK

PROPOSED 10' CONSTRUCTION EASEMENT

PROPOSED 12' W.L.

EXISTING 12' W.L.

EXISTING 6' SIDEWALK

EXISTING 2' GAS LINE

EXISTING 21" GAS

EXISTING 6" SIDEWALK

EXISTING 6" SIDEWALK

EXISTING 6" SIDEWALK

EXISTING 6" SIDEWALK

EXISTING 6" SIDEWALK

EXISTING 6" SIDEWALK

EXISTING 6" SIDEWALK

EXISTING 6" SIDEWALK

EXISTING 6" SIDEWALK

EXISTING 6" SIDEWALK

EXISTING 6" SIDEWALK

EXISTING 6" SIDEWALK

PROPOSED 10' CONSTRUCTION EASEMENT

PROPOSED 12' W.L.

EXISTING 12' W.L.

EXISTING 6' SIDEWALK

EXISTING 2' GAS LINE

EXISTING 21" GAS

EXISTING 6" SIDEWALK

EXISTING 6" SIDEWALK

EXISTING 6" SIDEWALK

EXISTING 6" SIDEWALK

EXISTING 6" SIDEWALK

EXISTING 6" SIDEWALK

EXISTING 6" SIDEWALK

EXISTING 6" SIDEWALK

EXISTING 6" SIDEWALK

EXISTING 6" SIDEWALK

EXISTING 6" SIDEWALK

EXISTING 6" SIDEWALK

PROPOSED 10' CONSTRUCTION EASEMENT

PROPOSED 12' W.L.

EXISTING 12' W.L.

EXISTING 6' SIDEWALK

EXISTING 2' GAS LINE

EXISTING 21" GAS

EXISTING 6" SIDEWALK

EXISTING 6" SIDEWALK

EXISTING 6" SIDEWALK

EXISTING 6" SIDEWALK

EXISTING 6" SIDEWALK

EXISTING 6" SIDEWALK

EXISTING 6" SIDEWALK

EXISTING 6" SIDEWALK

EXISTING 6" SIDEWALK

EXISTING 6" SIDEWALK

EXISTING 6" SIDEWALK

EXISTING 6" SIDEWALK

PROPOSED 10' CONSTRUCTION EASEMENT

PROPOSED 12' W.L.

EXISTING 12' W.L.

EXISTING 6' SIDEWALK

EXISTING 2' GAS LINE

EXISTING 21" GAS

EXISTING 6" SIDEWALK

EXISTING 6" SIDEWALK

EXISTING 6" SIDEWALK

EXISTING 6" SIDEWALK

EXISTING 6" SIDEWALK

EXISTING 6" SIDEWALK

EXISTING 6" SIDEWALK

EXISTING 6" SIDEWALK

EXISTING 6" SIDEWALK

EXISTING 6" SIDEWALK

EXISTING 6" SIDEWALK

EXISTING 6" SIDEWALK

PROPOSED 10' CONSTRUCTION EASEMENT

PROPOSED 12' W.L.

EXISTING 12' W.L.

EXISTING 6' SIDEWALK

EXISTING 2' GAS LINE

EXISTING 21" GAS

EXISTING 6" SIDEWALK

EXISTING 6" SIDEWALK

EXISTING 6" SIDEWALK

EXISTING 6" SIDEWALK

EXISTING 6" SIDEWALK

EXISTING 6" SIDEWALK

EXISTING 6" SIDEWALK

EXISTING 6" SIDEWALK

EXISTING 6" SIDEWALK

EXISTING 6" SIDEWALK

EXISTING 6" SIDEWALK

EXISTING 6" SIDEWALK

PROPOSED 10' CONSTRUCTION EASEMENT

PROPOSED 12' W.L.

EXISTING 12' W.L.

EXISTING 6' SIDEWALK

EXISTING 2' GAS LINE

EXISTING 21" GAS

EXISTING 6" SIDEWALK

EXISTING 6" SIDEWALK

EXISTING 6" SIDEWALK

EXISTING 6" SIDEWALK

EXISTING 6" SIDEWALK

EXISTING 6" SIDEWALK

EXISTING 6" SIDEWALK

EXISTING 6" SIDEWALK

EXISTING 6" SIDEWALK

EXISTING 6" SIDEWALK

EXISTING 6" SIDEWALK

EXISTING 6" SIDEWALK

PROPOSED 10' CONSTRUCTION EASEMENT

PROPOSED 12' W.L.

EXISTING 12' W.L.

EXISTING 6' SIDEWALK

EXISTING 2' GAS LINE

EXISTING 21" GAS

EXISTING 6" SIDEWALK

EXISTING 6" SIDEWALK

EXISTING 6" SIDEWALK

EXISTING 6" SIDEWALK

EXISTING 6" SIDEWALK

EXISTING 6" SIDEWALK

EXISTING 6" SIDEWALK

EXISTING 6" SIDEWALK

EXISTING 6" SIDEWALK

EXISTING 6" SIDEWALK

EXISTING 6" SIDEWALK

EXISTING 6" SIDEWALK

PROPOSED 10' CONSTRUCTION EASEMENT

PROPOSED 12' W.L.

EXISTING 12' W.L.

EXISTING 6' SIDEWALK

EXISTING 2' GAS LINE

EXISTING 21" GAS

EXISTING 6" SIDEWALK

EXISTING 6" SIDEWALK

EXISTING 6" SIDEWALK

EXISTING 6" SIDEWALK

EXISTING 6" SIDEWALK

EXISTING 6" SIDEWALK

EXISTING 6" SIDEWALK

EXISTING 6" SIDEWALK

EXISTING 6" SIDEWALK

EXISTING 6" SIDEWALK

EXISTING 6" SIDEWALK

EXISTING 6" SIDEWALK

PROPOSED 10' CONSTRUCTION EASEMENT

PROPOSED 12' W.L.

EXISTING 12' W.L.

EXISTING 6' SIDEWALK

EXISTING 2' GAS LINE

EXISTING 21" GAS

EXISTING 6" SIDEWALK

EXISTING 6" SIDEWALK

EXISTING 6" SIDEWALK

EXISTING 6" SIDEWALK

EXISTING 6" SIDEWALK

EXISTING 6" SIDEWALK

EXISTING 6" SIDEWALK

EXISTING 6" SIDEWALK

EXISTING 6" SIDEWALK

EXISTING 6" SIDEWALK

EXISTING 6" SIDEWALK

EXISTING 6" SIDEWALK

PROPOSED 10' CONSTRUCTION EASEMENT

PROPOSED 12' W.L.

EXISTING 12' W.L.

EXISTING 6' SIDEWALK

EXISTING 2' GAS LINE

EXISTING 21" GAS

EXISTING 6" SIDEWALK

EXISTING 6" SIDEWALK

EXISTING 6" SIDEWALK

EXISTING 6" SIDEWALK

EXISTING 6" SIDEWALK

EXISTING 6" SIDEWALK

EXISTING 6" SIDEWALK

EXISTING 6" SIDEWALK

EXISTING 6" SIDEWALK

EXISTING 6" SIDEWALK

EXISTING 6" SIDEWALK

EXISTING 6" SIDEWALK

PROPOSED 10' CONSTRUCTION EASEMENT

PROPOSED 12' W.L.

EXISTING 12' W.L.

EXISTING 6' SIDEWALK

EXISTING 2' GAS LINE

EXISTING 21" GAS

EXISTING 6" SIDEWALK

EXISTING 6" SIDEWALK

EXISTING 6" SIDEWALK

EXISTING 6" SIDEWALK

EXISTING 6" SIDEWALK

EXISTING 6" SIDEWALK

EXISTING 6" SIDEWALK

EXISTING 6" SIDEWALK

EXISTING 6" SIDEWALK

EXISTING 6" SIDEWALK

EXISTING 6" SIDEWALK

EXISTING 6" SIDEWALK

PROPOSED 10' CONSTRUCTION EASEMENT

PROPOSED 12' W.L.

EXISTING 12' W.L.

EXISTING 6' SIDEWALK

EXISTING 2' GAS LINE

EXISTING 21" GAS

EXISTING 6" SIDEWALK

EXISTING 6" SIDEWALK

EXISTING 6" SIDEWALK

EXISTING 6" SIDEWALK

EXISTING 6" SIDEWALK

EXISTING 6" SIDEWALK

EXISTING 6" SIDEWALK

EXISTING 6" SIDEWALK

EXISTING 6" SIDEWALK

EXISTING 6" SIDEWALK

EXISTING 6" SIDEWALK

EXISTING 6" SIDEWALK

PROPOSED 10' CONSTRUCTION EASEMENT

PROPOSED 12' W.L.

EXISTING 12' W.L.