

CITY OF ALBUQUERQUE

Planning Department
Alan Varela, Director



Mayor Timothy M. Keller

February 13, 2026

Jonathan Turner
Consensus Planning Inc
302 8th St NW
Albuquerque, NM 87102

turner@consensusplanning.com

**Re: In-N-Out Gibson Burger
Gibson & Alumni SE
Traffic Circulation Layout**
Engineer's Stamp 1/28/26 (L15D047)-TRANS-2026-00037

Dear Turner,

The TCL resubmittal received 2-6-26 is approved for Building Permit by Transportation. A copy of the stamped and signed plan will be needed for each of the building permit plans. Please keep the original to be used for certification of the site for final C.O. for Transportation.

PO Box 1293

When the site construction is completed and an inspection for Certificate of Occupancy (C.O.) is requested, use the original City stamped approved TCL for certification. Redline any minor changes and adjustments that were made in the field. A NM registered architect or engineer must stamp, sign, and date the certification TCL along with indicating that the development was built in "substantial compliance" with the TCL. Submit this certification, and the TCL to the [ABQ-PLAN](#) for log in and evaluation by Transportation.

Albuquerque

NM 87103

Once verification of certification is completed and approved, notification will be made to Building Safety to issue Final C.O. To confirm that a final C.O. has been issued, call Building Safety at 924-3690.

www.cabq.gov

Sincerely,

Sertil A. Kanbar

Sertil Kanbar, PhD, PE, CFM
Sr. Engineer, Planning Dept.
Development Review Services

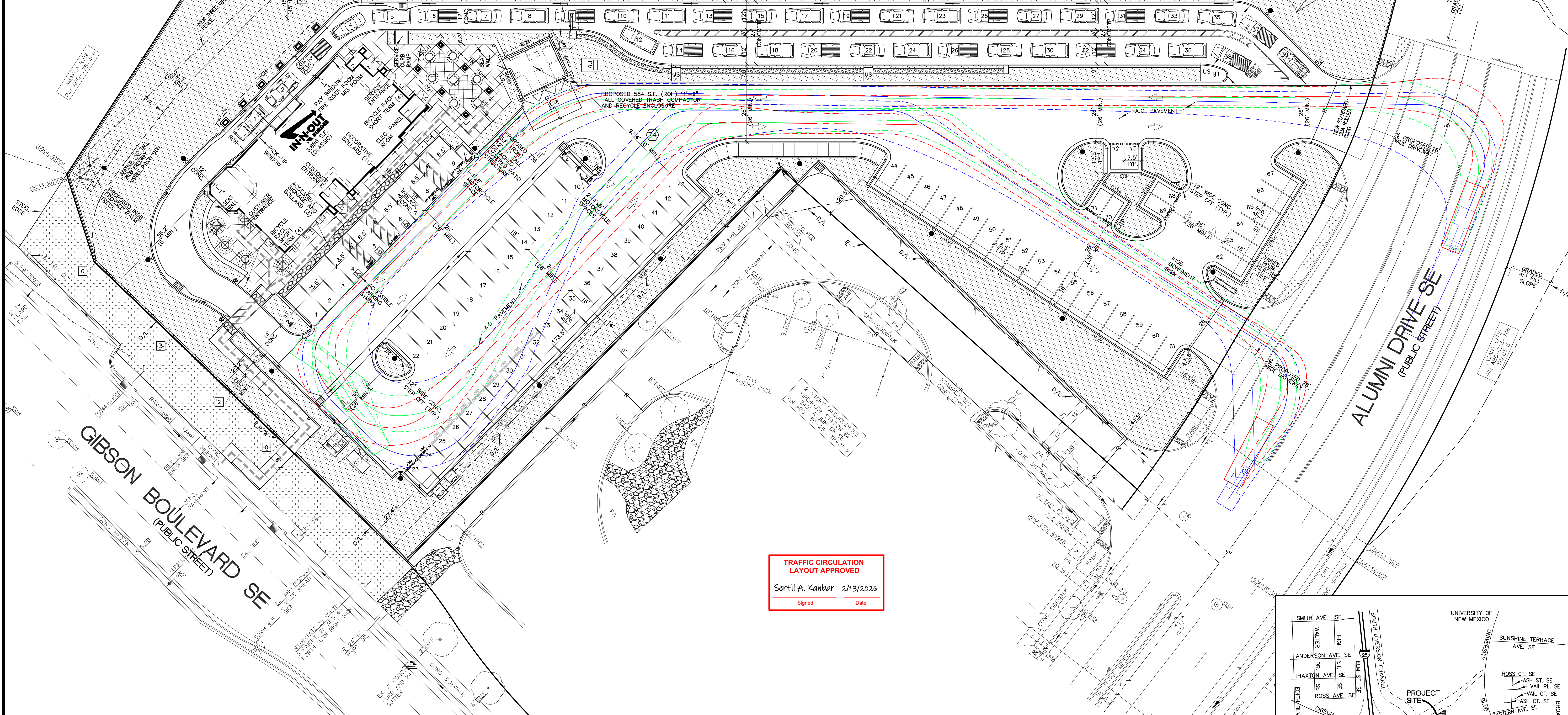
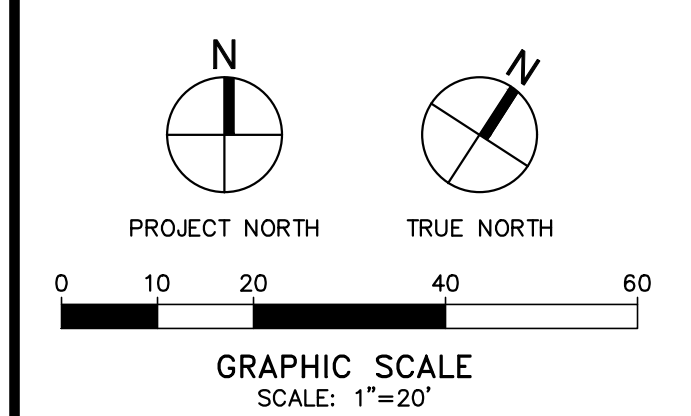

TRAFFIC CIRCULATION LAYOUT APPROVED
 Sertil A. Kanbar 2/13/2026
 Signed Date

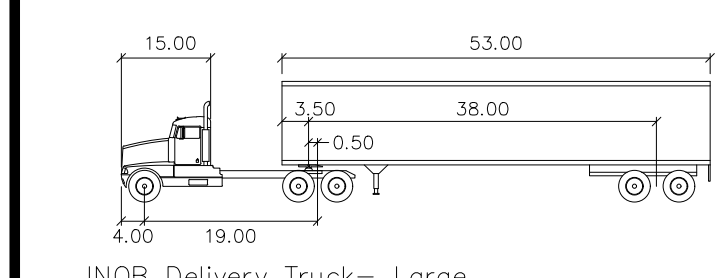
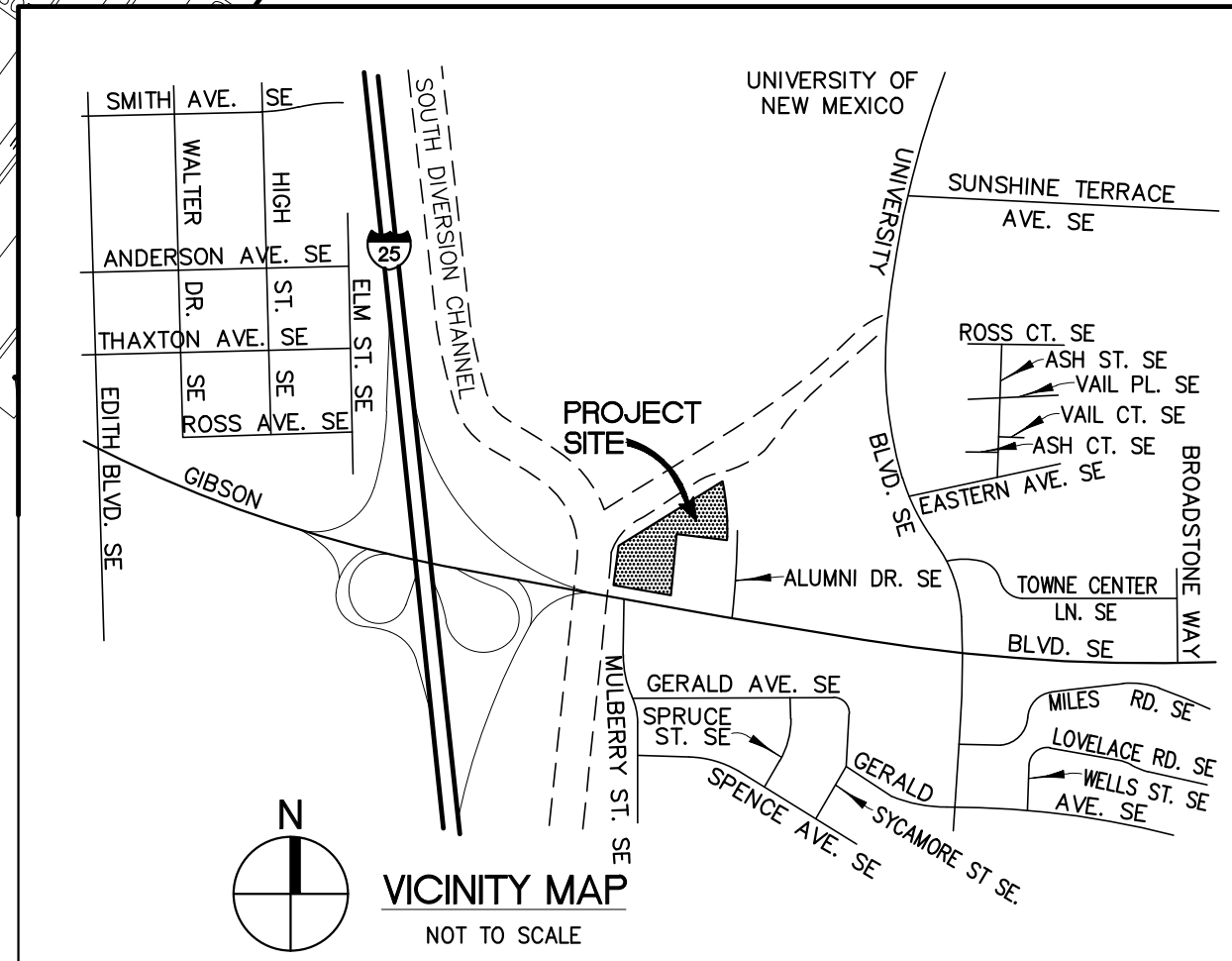

INOB Delivery Truck - Large

| | | | |
|-------------------|--------|--------------------|--------|
| Tractor Width | : 8.00 | Lock to Lock Time | : 6.0 |
| Tractor Length | : 8.50 | Steering Angle | : 25.4 |
| Tractor Track | : 8.00 | Articulating Angle | : 75.0 |
| Tractor Wheelbase | : 6.50 | | |

LEGEND

- AutoTURN GENERATED BODY ENVELOPE
- PATH OF TRAVEL FOR AN IN-N-OUT BURGER DELIVERY TRUCK.

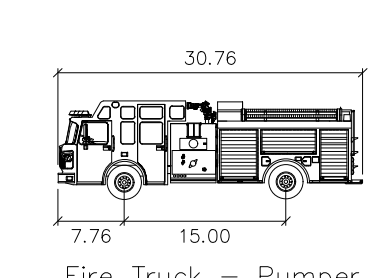

Fire Truck - Pumper

| | |
|-------------------|--------|
| Width | : 8.25 |
| Track | : 8.00 |
| Lock to Lock Time | : 6.0 |
| Steering Angle | : 35.9 |

LEGEND

- AutoTURN GENERATED BODY ENVELOPE
- PATH OF TRAVEL FOR A PUMPER FIRE TRUCK.

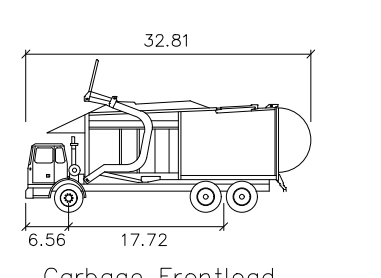

Garbage Frontload

| | |
|-------------------|--------|
| Width | : 8.53 |
| Track | : 8.53 |
| Lock to Lock Time | : 6.0 |
| Steering Angle | : 27.7 |

LEGEND

- AutoTURN GENERATED BODY ENVELOPE
- PATH OF TRAVEL FOR A FRONT LOAD SOLID WASTE TRUCK.



DEVELOPER:
 IN-N-OUT BURGER
 13502 HAMBURGER LANE
 BALDWIN PARK, CA 91706
 CONTACT: TODD SMITH
 PHONE: 626 813-5399
 CONTACT: DANIEL POCUIS
 PHONE: 626 813-8275

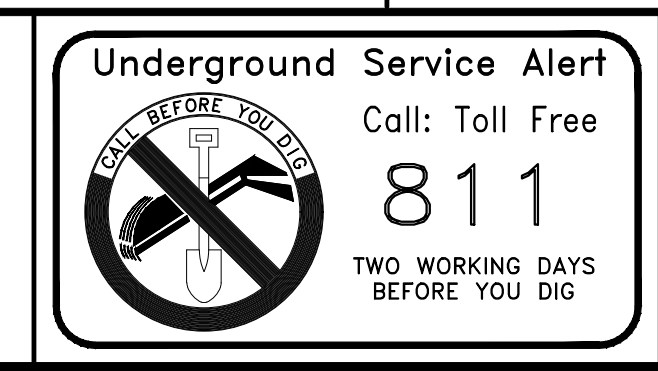

REVISIONS

| | |
|--|--|
| | |
| | |
| | |
| | |
| | |
| | |



CIVIL ENGINEER:
MSI ENGINEERING, INC.
 CIVIL ENGINEERS AND LAND SURVEYORS SPECIALIZING IN SITE DEVELOPMENT
 301 NORTH SAN DIMAS AVENUE, SAN DIMAS, CA. 91773
 (909) 305-2395 FAX (909) 305-2397
 Aaron D. Pellow
 AARON D. PELLOW R.C.E. 27112



IN-N-OUT BURGER
 NWQ GIBSON BOULEVARD SE
 AND ALUMNI DRIVE SE
 ALBUQUERQUE, NM 87106

TRAFFIC CIRCULATION PLAN
 1 OF 2

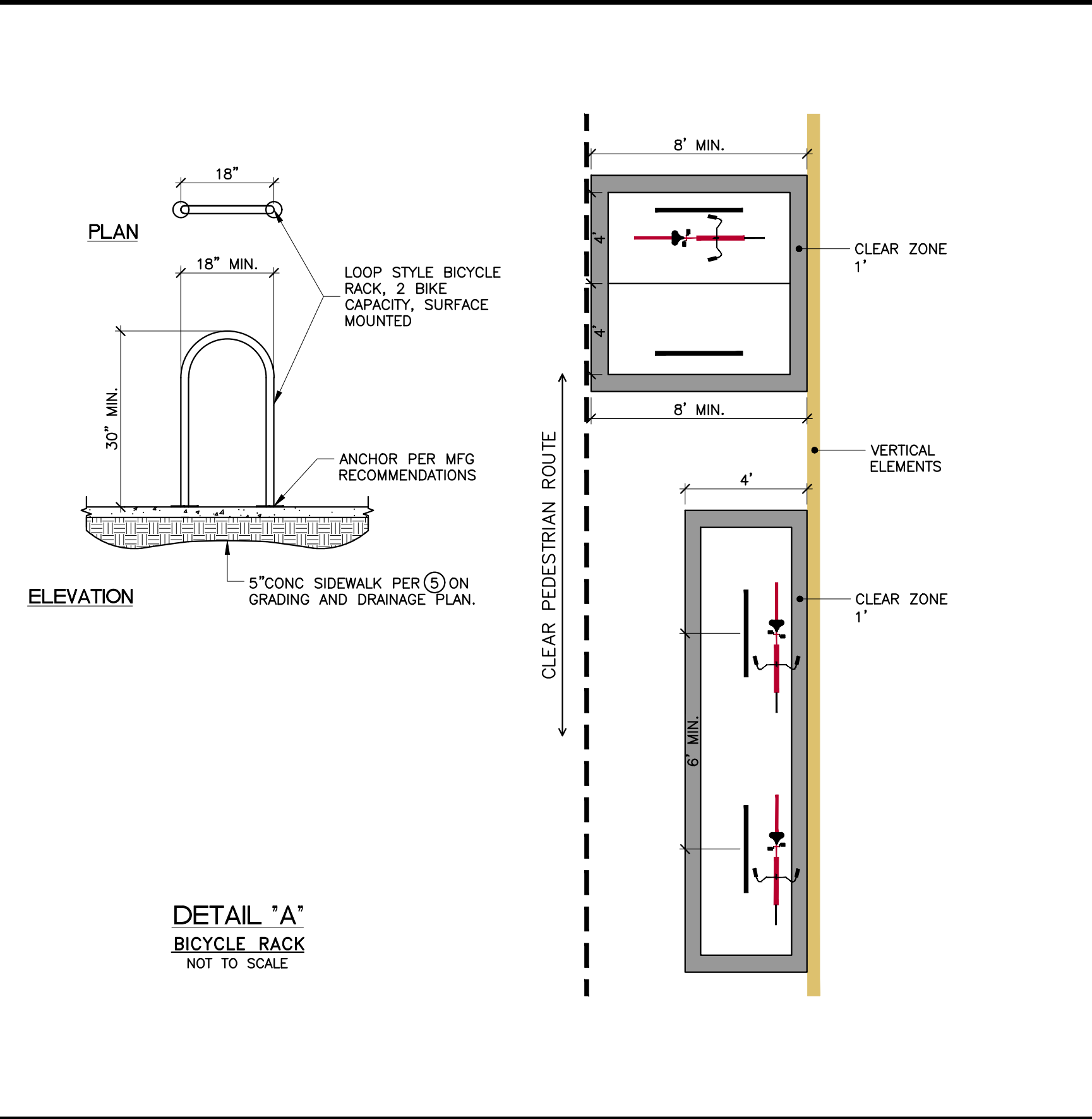
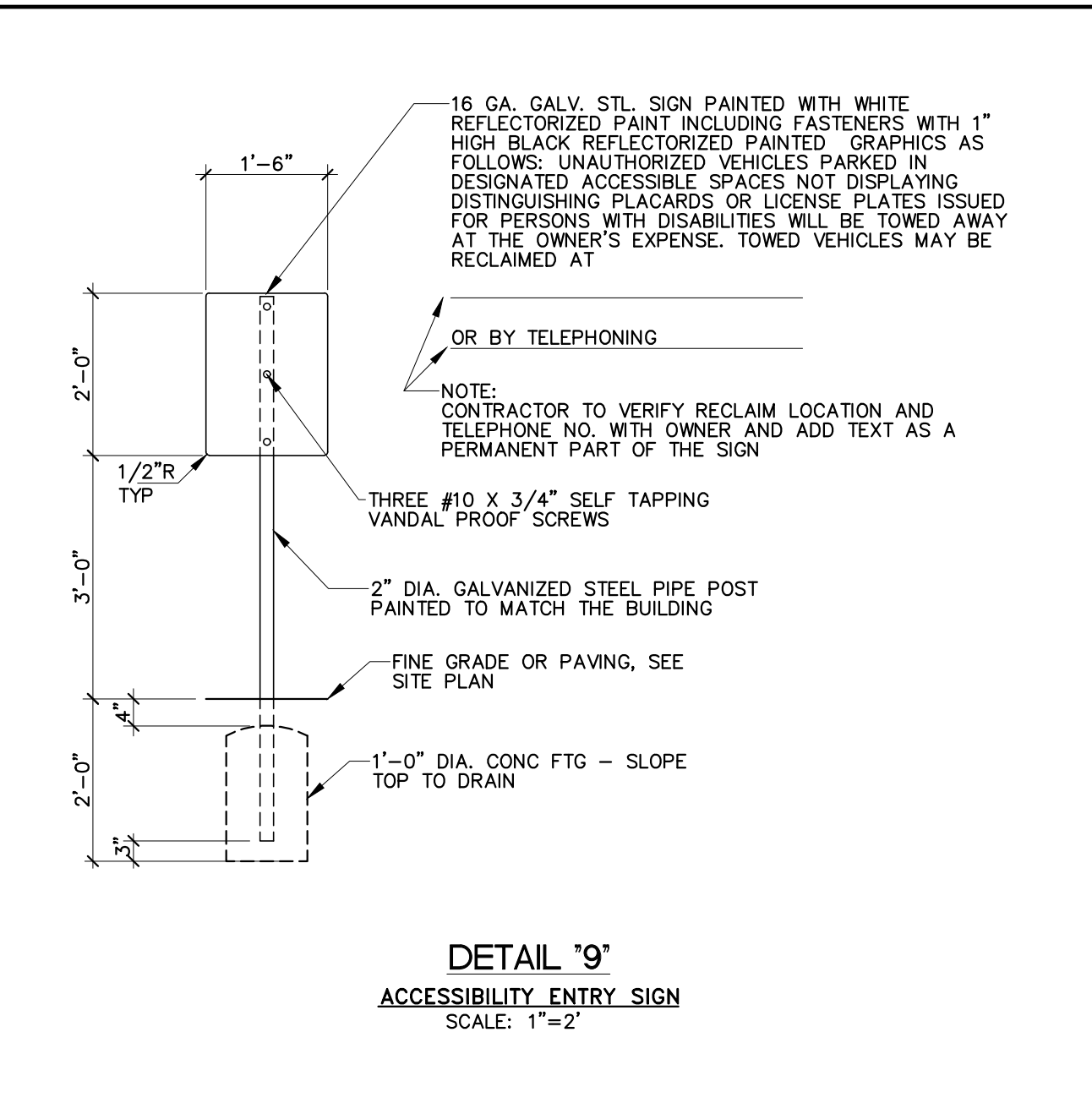
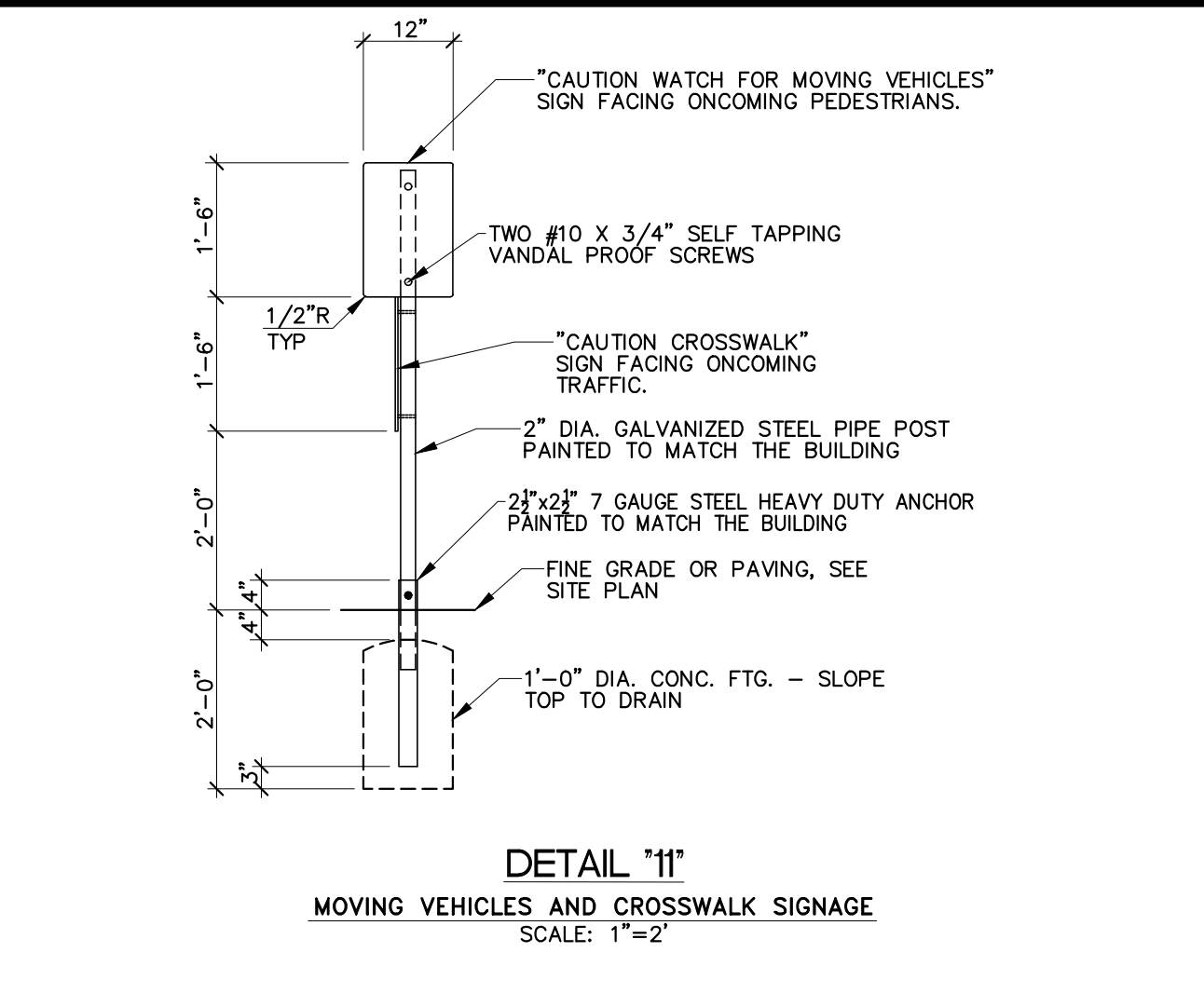
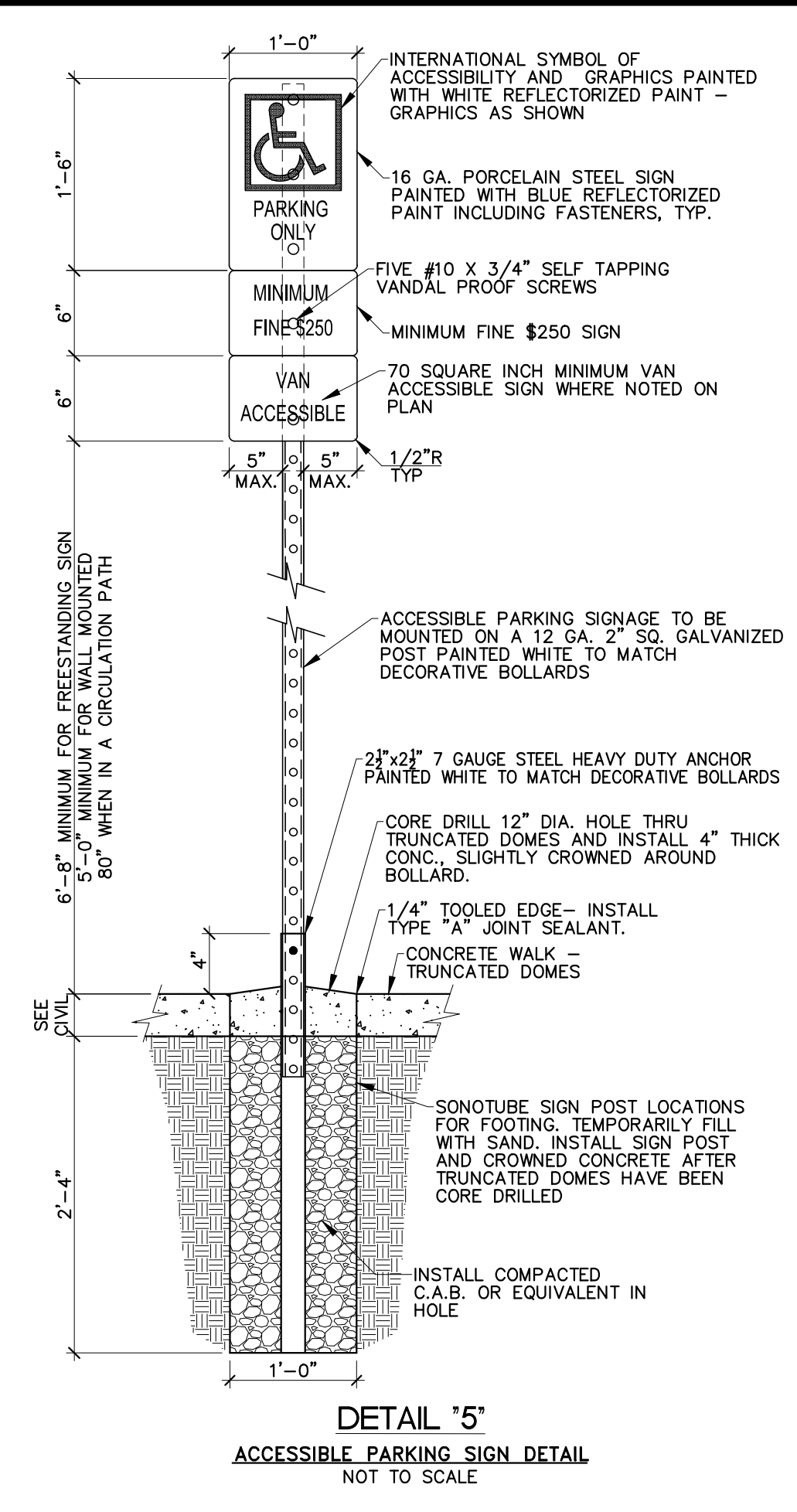
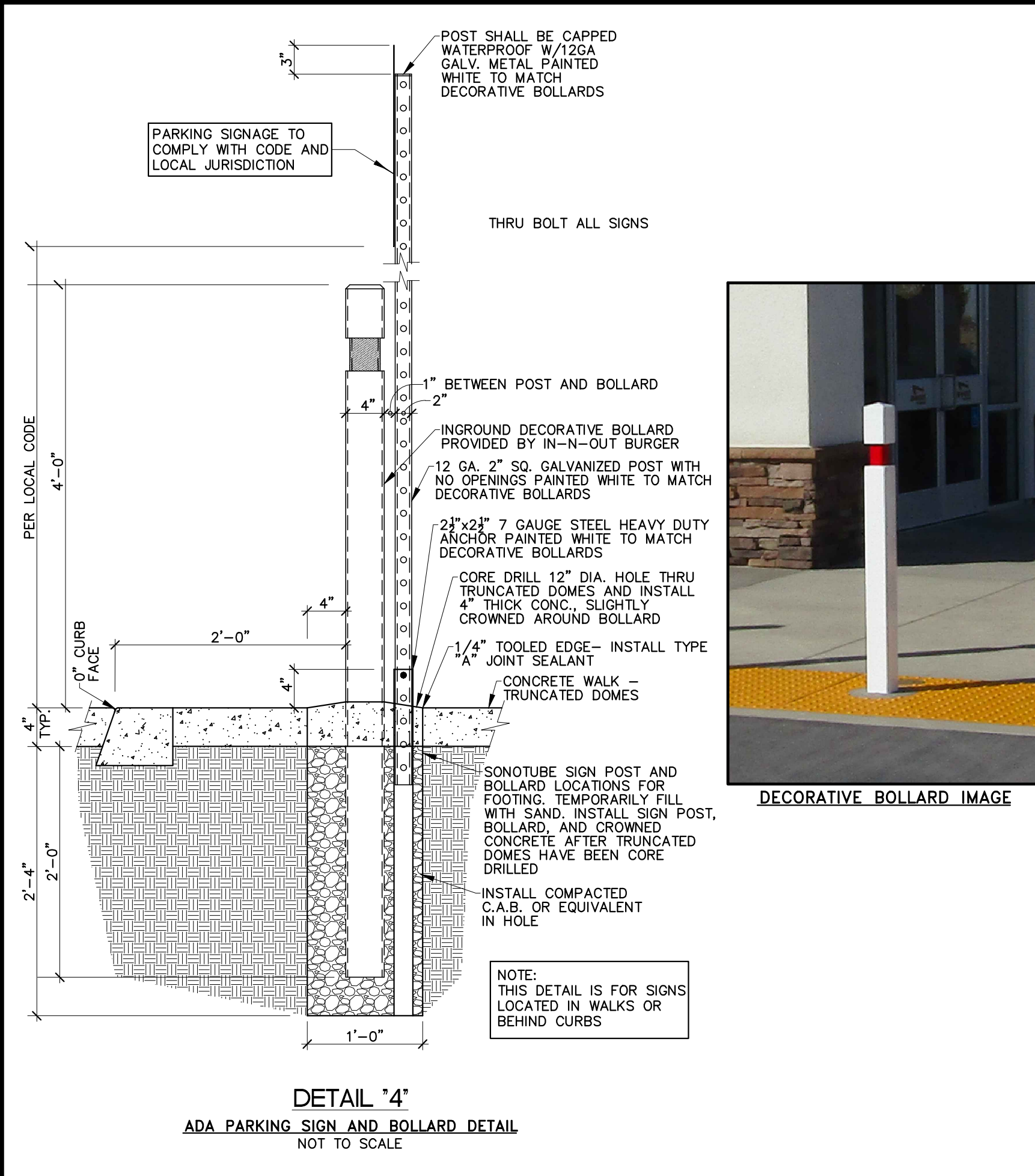

TRAFFIC CIRCULATION LAYOUT APPROVED

Sertil A. Kambar 2/13/2024

Signed Date

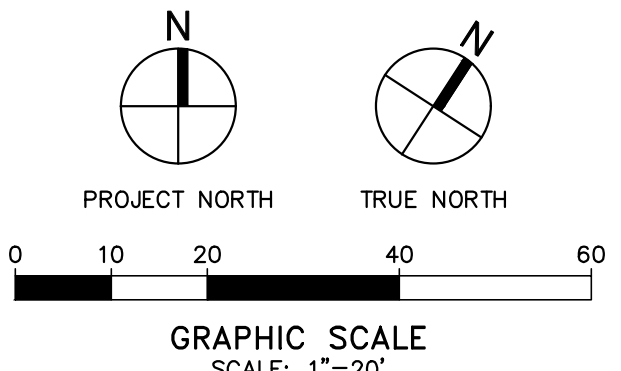

REFER TO THE LEGEND SHOWN ON SHEET C1.0 AND C9.1 FOR ABBREVIATIONS AND SYMBOLS SHOWN ON THIS SHEET.

DEVELOPER:
IN-N-OUT BURGER
13502 HAMBURGER LANE
BALDWIN PARK, CA 91706
CONTACT: TODD SMITH
PHONE: 626 813-5399
CONTACT: DANIEL POCIUS
PHONE: 626 813-8275

Underground Service Alert
Call: Toll Free
811
TWO WORKING DAYS BEFORE YOU DIG

REVISIONS

| | |
|--|--|
| | |
| | |
| | |
| | |
| | |
| | |

APOGEE PROJECT NO. _____

Apogee
Architectural Partners
16775 ADDISON ROAD, SUITE 350
ADDISON, TX 75001
PH: (469) 980-2322

CIVIL ENGINEER:
MSI ENGINEERING, INC.
CIVIL ENGINEERS AND LAND SURVEYORS SPECIALIZING IN SITE DEVELOPMENT
301 NORTH SAN DIMAS AVENUE, SAN DIMAS, CA. 91773
(909) 305-2395 FAX (909) 305-2397

Aaron D. Pellow
AARON D. PELLOW R.C.E. 27112 01-27-2026 DATE

IN-N-OUT BURGER
NWQ GIBSON BOULEVARD SE
AND ALUMNI DRIVE SE
ALBUQUERQUE, NM 87106

TRAFFIC CIRCULATION PLAN
DETAIL SHEET

2 OF 2