

# CITY OF ALBUQUERQUE

PLANNING DEPARTMENT – Development Review Services



May 15, 2014

Dennis Lorenz, PE  
Lorenz Design & Consulting  
2501 Rio Grande Blvd. NW  
Albuquerque, NM 87104

Richard J. Berry, Mayor

**RE: 9700 Trumbull Avenue SE  
Drainage Plan For Building Permit and Work Order  
Engineer's Stamp Date 5-7-2014 (File: L20D051)**

Dear Mr. Lorenz:

Based upon the information provided in your submittal received 5-7-14, the above referenced plan is approved for Building Permit and Work Order. Please attach a copy of this approved plan in the construction sets when submitting for a building permit.

Prior to Certificate of Occupancy release, Engineer Certification per the DPM checklist will be required.

PO Box 1293

If you have any questions, you can contact me at 924-3695.

Albuquerque

New Mexico 87103

[www.cabq.gov](http://www.cabq.gov)

Sincerely,

Rita Harmon, P.E.  
Senior Engineer, Planning Dept.  
Development Review Services

Orig: Drainage file  
c.pdf: via Email: Recipient, Tim Sims, Monica Ortiz

**DRAINAGE AND TRANSPORTATION INFORMATION SHEET**  
(REV 04/2009)

L20D051

PROJECT TITLE: 9700 TRUMBULL AVENUE SE ZONE MAP: L-20-  
DRB#: NA EPC#: NA WORK ORDER#: \_\_\_\_\_

LEGAL DESCRIPTION: TRACT A, BLOCK 26, SKYLINE HEIGHTS  
CITY ADDRESS: 9700 TRUMBULL AVE SE

ENGINEERING FIRM: LORENZ DESIGN & CONSULTING CONTACT: DENNIS LORENZ  
ADDRESS: 2501 RIO GRANDE BLVD. NW PHONE: 888-6088  
CITY, STATE: ALBUQUERQUE, NEW MEXICO ZIP CODE: 87104

OWNER: TRUMBULL M&M LLC CONTACT: \_\_\_\_\_  
ADDRESS: 9701 TRUMBULL AVE SE PHONE: \_\_\_\_\_  
CITY, STATE: ALBUQUERQUE, NEW MEXICO ZIP CODE: 87123

ARCHITECT: SANDERS & ASSOCIATES CONTACT: G. SANDERS  
ADDRESS: 5921 LOMAS NE, SUITE B PHONE: 255-5040  
CITY, STATE: ALBUQUERQUE, NEW MEXICO ZIP CODE: 87110

SURVEYOR: TERRA SURVEYS CONTACT: C. MEDINA  
ADDRESS: PO BOX 2532 PHONE: 792-0513  
CITY, STATE: CORRALES, NEW MEXICO ZIP CODE: 87043

CONTRACTOR: UNKNOWN CONTACT: \_\_\_\_\_  
ADDRESS: \_\_\_\_\_ PHONE: \_\_\_\_\_  
CITY, STATE: \_\_\_\_\_ ZIP CODE: \_\_\_\_\_

TYPE OF SUBMITTAL:  
\_\_\_\_ DRAINAGE REPORT  
\_\_\_\_ DRAINAGE PLAN 1<sup>st</sup> SUBMITTAL  
XX DRAINAGE PLAN RESUBMITTAL  
\_\_\_\_ CONCEPTUAL G & D PLAN  
\_\_\_\_ GRADING PLAN  
\_\_\_\_ EROSION CONTROL PLAN  
\_\_\_\_ ENGINEER'S CERT (HYDROLOGY)  
\_\_\_\_ CLOMR/LOMR  
\_\_\_\_ TRAFFIC CIRCULATION LAYOUT  
\_\_\_\_ ENGINEER'S CERT (TCL)  
\_\_\_\_ ENGINEER'S CERT (DRB SITE PLAN)  
\_\_\_\_ OTHER (SPECIFY) \_\_\_\_\_

CHECK TYPE OF APPROVAL SOUGHT:  
\_\_\_\_ SIA/FINANCIAL GUARANTEE RELEASE  
\_\_\_\_ PRELIMINARY PLAT APPROVAL  
\_\_\_\_ S. DEV. PLAN FOR SUB'D APPROVAL  
\_\_\_\_ S. DEV. FOR BLDG. PERMIT APPROVAL  
\_\_\_\_ SECTOR PLAN APPROVAL  
\_\_\_\_ FINAL PLAT APPROVAL  
\_\_\_\_ FOUNDATION PERMIT APPROVAL  
XX BUILDING PERMIT APPROVAL  
\_\_\_\_ CERTIFICATE OF OCCUPANCY (PERM)  
\_\_\_\_ CERTIFICATE OF OCCUPANCY (TEMP)  
\_\_\_\_ GRADING PERMIT APPROVAL  
\_\_\_\_ PAVING PERMIT APPROVAL  
\_\_\_\_ WORK ORDER APPROVAL  
\_\_\_\_ GRADING CERTIFICATION  
\_\_\_\_ OTHER (SPECIFY) SO-19 \_\_\_\_\_

450<sup>00</sup>

WAS A PRE-DESIGN CONFERENCE ATTENDED:  
\_\_\_\_ YES  
\_\_\_\_ NO  
\_\_\_\_ COPY PROVIDED

DATE SUBMITTED: 5-2-2014 BY: DENNIS A. LORENZ

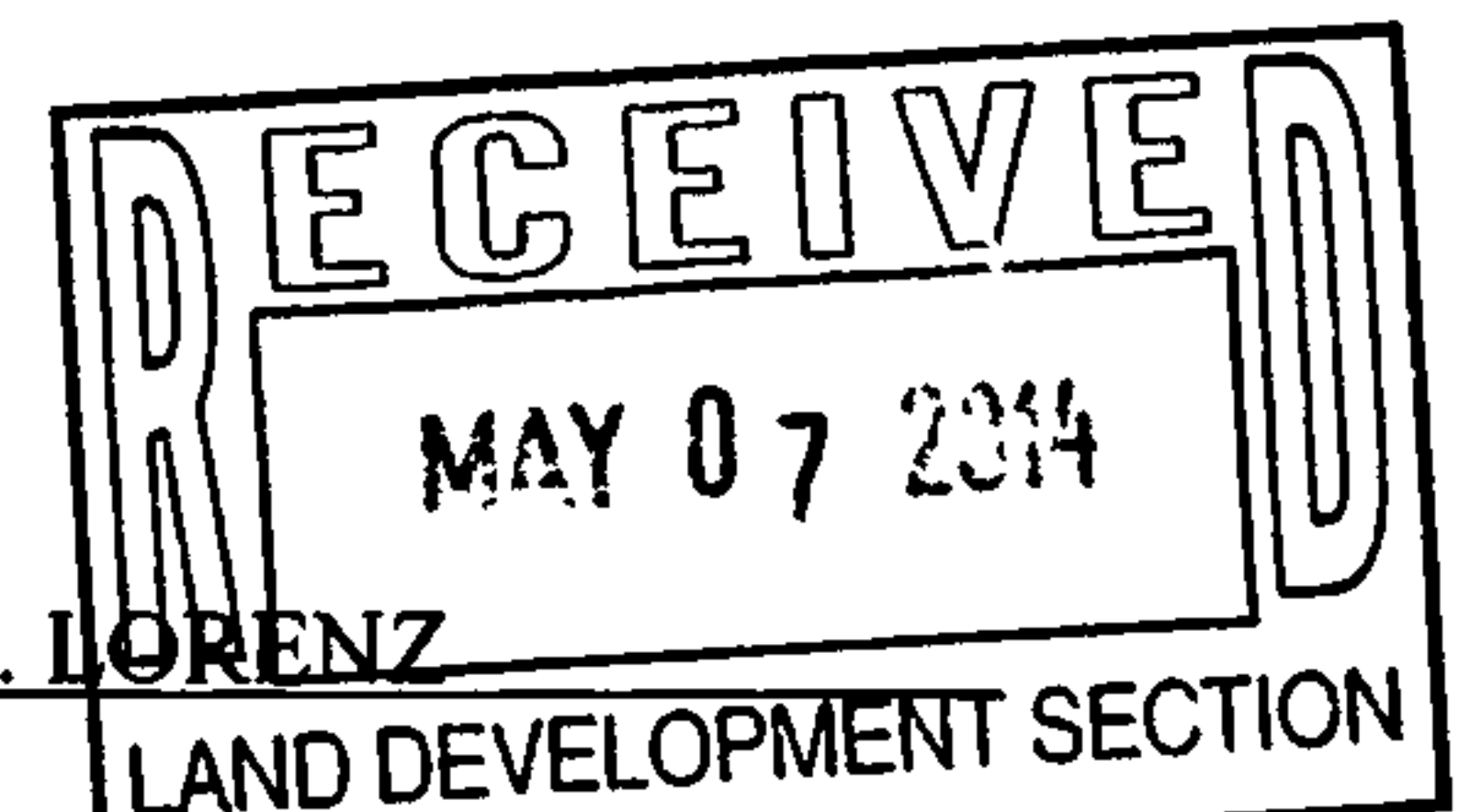

Requests for approvals of Site Development Plans and/or Subdivision Plats shall be accompanied by a drainage submittal. The particular nature, location, and scope to the proposed development defines the degree of drainage detail. One or more of the following levels of submittal may be required based on the following:

1. **Conceptual Grading and Drainage Plan:** Required for approval of Site Development Plans greater than five (5) acres and Sector Plans.
2. **Drainage Plans:** Required for building permits, grading permits, paving permits and site plans less than five (5) acres.
3. **Drainage Report:** Required for subdivision containing more than ten (10) lots or constituting five (5) acres or more

05/07/2014 Issued By: PLNTES 236894

**TOTAL: \$50.00**

City of Albuquerque Treasurer  
Date: 5/7/2014 Office: ANEXY  
Print ID: W8000006 Cashier: KSDIT  
Batch: 3623 Trans 4:19  
Permit #: 2014040026  
Receipt Num 00137345  
Payment Total: \$50.00  
0000 REV Actions \$50.00  
Check Tendered : \$50.00

Duplicate



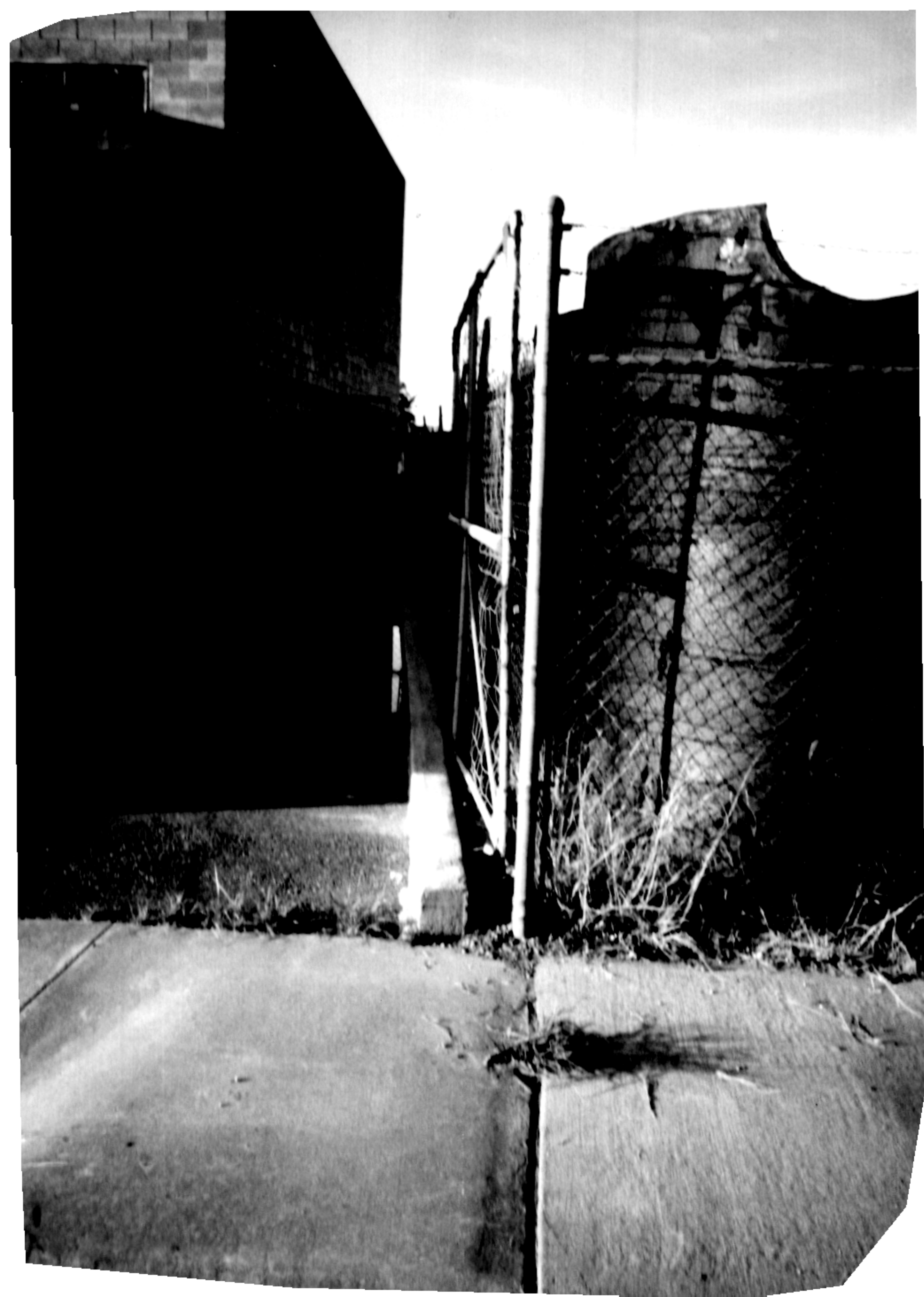





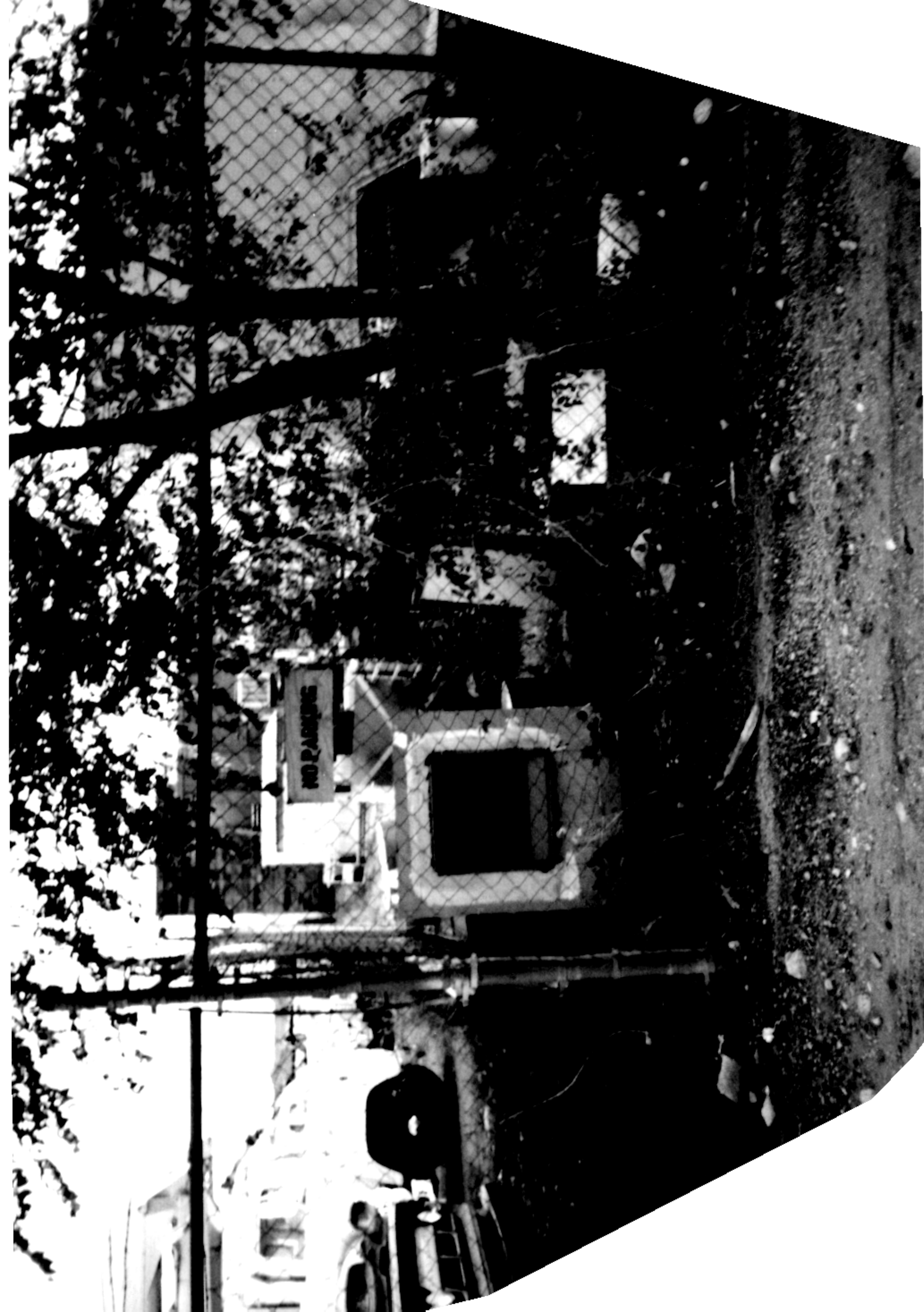

















PAGE ONE OF TWO

OCTOBER 1, 1997

FAXED TO 505-768-3227

PRESIDENT VICKIE S. PEREA  
ALBUQUERQUE CITY COUNCIL

RE: DOCUMENT REQUEST  
SAD # 224,

MRS PRESIDENT

I SUBMITTED A LETTER OF PROTEST.. AND.. A DOCUMENT REQUEST ON SEPTEMBER 15, 1997 TO THE CITY COUNCIL... AND... LEE R. LUNSFORD ,P.E. I HAVE YET TO RECEIVE ANY RESPONSE FROM ANYONE.

I FORMALLY REQUESTED THE FOLLOWING FIVE DOCUMENTS:

- 1....A COPY OF THE 1989 OR 1990 RIDGECREST RESERVOIR CONTRACT, DRAWINGS, AND SPECIFICATIONS THAT PUBLIC WORKS HAS BEEN WITHHOLDING AND CLAIMING FOR YEARS THAT ALL THE PAPERWORK "GOT LOST".
- 2....ALL PERTINENT RECORDS OF QUALITY CONTROL, CHANGE ORDERS, AS BUILT PLANS AND THE NAMES OF THE INSPECTORS THAT ACCEPTED THE WORK AND THE DEPARTMENT HEADS THAT AUTHORIZED PAYMENT TO THE CONTRACTOR OF THE RIDGECREST TANK JOB.
- 3....AN ITEMIZATION OF THE AMOUNT OF MANHOURS AND EQUIPMENT THAT TAXPAYERS SUBSEQUENTLY PAID (AND WILL CONTINUE TO PAY) TO MAINTAIN SANTA CLARA STREET AS A DIRECT/INDIRECT RESULT FROM THE CITY ACCEPTING SUBSTANDARD WORK.

RECEIVED  
OCT 13 1997

# 11314

PAGE TWO OF TWO

4....THE NAME OF THE PERSON WHO AUTHORIZED SPENDING THOUSANDS OF CITY/TAXPAYERS DOLLARS TO PROVIDE A PRIVATE STORMSEWER AND MANHOLE INSTALLATION FOR ENCHANTMENT JEWELRY ON SANTA CLARA STREET.(EAST OF MY PROPERTY)

THIS "FREE" WORK REQUIRED DAYS OF CITY WORKERS AND CITY EQUIPMENT PLUS OTHER EXPENSIVE MATERIALS AND LOADS OF READY MIX CONCRETE.

5....THE NAME OF THE PERSON WHO AUTHORIZED SPENDING CITY/TAXPAYERS MONEY TO PROVIDE MATERIALS, GRADING AND PAVING REPAIRS FOR SCHUBES JEWELRY PRIVATE PARKING LOT ON SANTA CLARA ST.(ACROSS FROM MY PROPERTY)

IN ADDITION, I MENTIONED THAT MAYBE SOMEONE IN THE COUNCIL WAS INTERESTED IN LOOKING INTO THE MATTER. I ALSO MENTIONED THAT I HAVE AMPLE DATA, SHOULD ANY COUNCILLOR DESIRE TO PURSUE IT AND I COULD BE REACHED AT 505-323-1483.

OBVIOUSLY NO ONE SEEMS TO BE CONCERNED.

I FEEL THAT THIS MATTER MUST BE INVESTIGATED BY SOMEONE. BE IT YOU, THE CITY ATTY, THE D.A., THE NM AG, THE FBI (IF APPLICABLE) OR EVEN A NEWS MEDIA INVESTIGATING REPORTER SHOULD ALL OTHERS CONTINUE TO PASS THE BUCK.

THE REASON THAT I REQUESTED THE DOCUMENTATION IS BECAUSE I HAVE BEEN ABUSED AND DAMAGED BY CERTAIN CITY DEPARTMENT PERSONNEL FROM EITHER/OR ZONING, HYDROLOGY, WATER RESOURCES, STREET MAINTENANCE, THE STORM SEWER DEPT.

SOME OR ALL OF THIS PERSONS SHOULD BEAR RESPONSIBILITY FOR THEIR ACTIONS/IN ACTIONS. EXPENSIVE FAVORS AT TAXPAYER'S EXPENSE WERE PROVIDED FOR MY NEIGHBORS WHILE MY PROPERTY CONTINUES TO BE FLOODED FROM CITY STREETS AND ADJOINING PROPERTIES.

CANCELING THE SAD TO AVOID THIS ISSUE WILL NOT DO IT. THE BUCK HAS TO STOP SOMEWHERE. I INTEND TO GET THIS MATTER SETTLED BY WHATEVER MEANS ARE NECESSARY, INCLUSIVE OF LITIGATION. IT'S UP TO YOU NOW.

SINCERELY,



ALEX C DE BACA



# City of Albuquerque

P.O. BOX 1293 ALBUQUERQUE, NEW MEXICO 87103

October 14, 1994

J. Michael Jones  
Enchantment Jewelry Corp.  
9700 Trumbull SE  
Albuquerque, N.M. 87123

RE: GRADE PROBLEMS SANTA CLARA AVE. (EAST OF MOON SE) (L-20/051)

Dear Mr. Jones:

This is in reply to your letter addressed to John Castillo; dated October 4, 1994.

The City agrees with your concern with the grade on Santa Clara Avenue. The City surveyed this street on 10-10-94 and regrading is scheduled to start the week of 10-17-94. The regrading of this street is to insure drainage is confined to the Right-of-Way and directed to the appropriate storm inlet. Unfortunately a permanent solution cannot be guaranteed without ultimately paving the street.

To avoid damaging your chain link fence, City Maintenance crews will not grade close to the right of way line. Because of this, the existing runoff from your property may not drain into the street after the regrading is completed.

When Phase 2 develops, runoff from that area must discharge at a controlled rate, because there are existing flooding problems downstream that must not be aggravated. The simplest way to do this is to route the runoff through a detention pond into the existing manhole in Santa Clara Avenue.

I hope this answers your questions. In the future questions on grading of Santa Clara can be answered by Andre Houle of Street Maintenance. He can be reached at 857-8025. I will also be happy to address any questions you may have about drainage. You may contact me at 768-2727.

Sincerely,

  
John P. Curtin, P.E.  
Civil Engineer/Hydrology

c: John Castillo  
Dan Hogan

WPHYD/8873/jpc



# SANTA CLARA AVENUE

$S = 1.34\%$

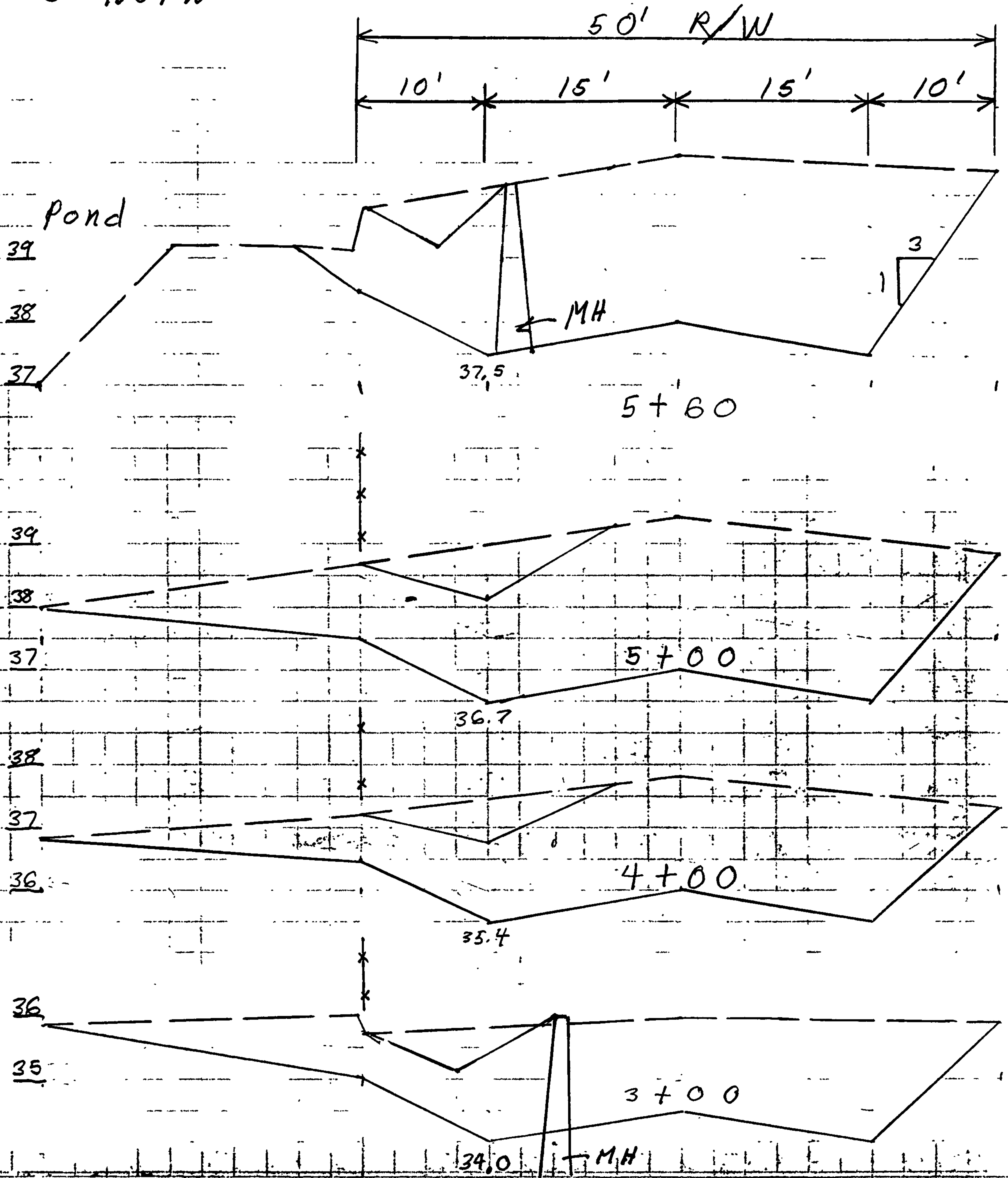

Roadway

Zone 3

$$25' \times 330' / 43560 = 0.20 \text{ Ac} \times 3.45 = 0.65 \text{ cfs}$$

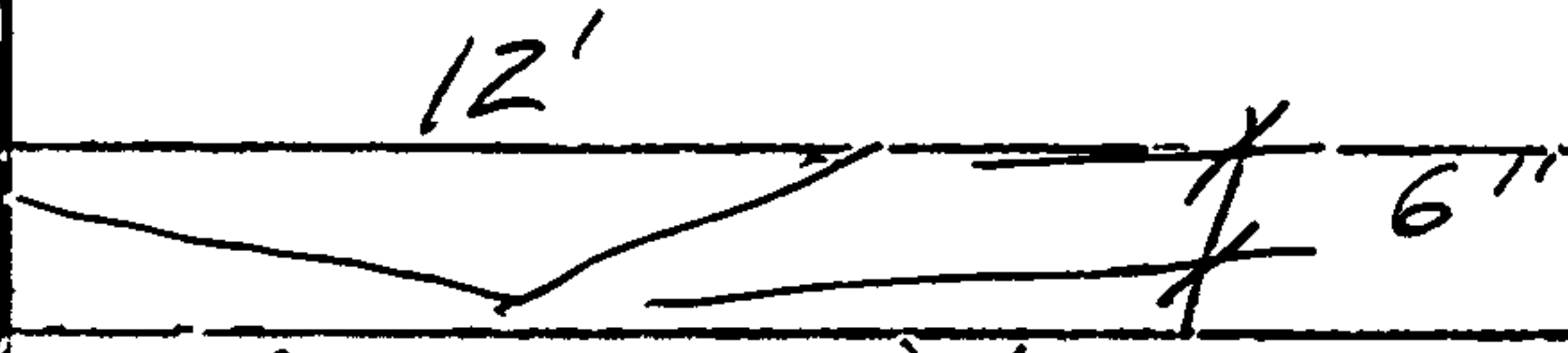
12'   $A = 12'(.5')/2 = 3 \text{ sf}$

$$S = (36.5 - 35.25) / 100 = 0.0125 \quad P = 12' \quad n = 0.030$$

$$Q = \frac{1.486 (3)^{5/3} \sqrt{0.0125}}{0.030 (12)^{2/3}} = \frac{1.037}{0.157} = 6.6 \text{ cfs}$$

$$d = 3'' \quad A = 6'(.25')/2 = 0.75 \text{ sf} \quad P = 6'$$

$$Q = \frac{1.486 (0.75)^{5/3} \sqrt{0.0125}}{0.030 (6)^{2/3}} = \frac{0.1029}{0.0991} = 1.04 \text{ cfs}$$

Survey	Date	Top of Grate	Spillway
Det'n	As-Built	12-91	38.00 (1.70) 39.70
Pond	M. Kortum	3-93	37.34 (1.85) 39.19
	G. Haikin	7-93	37.78 (1.86) 39.64



October 4, 1994

Mr. John Castillo  
Assistant Director/Public Works Department  
City of Albuquerque  
PO Box 1293  
Albuquerque NM 87123

RE: Grade problems Santa Clara Ave. (east of Moon SE)

Dear Mr. Castillo :

I own property bounded by Santa Clara Ave SE east of Moon St. SE. Shortly after purchasing the property the city constructed a water tank east of and adjacent to my property. Attendant to the construction was the need to put a large storm (overflow) drain in Santa Clara. When the roadway was restored the grade was raised significantly. We have addressed this issue in a cursory manner on a few occasions in the past without resolution. Each time we have attempted to seek restoration of the roadway to its original grade the issue of a special assessment arises. We do not need nor do we desire a paved roadway. It is also my belief that my business neighbors do not want an assessment either.

The drainage from the elevated roadway is running onto our property causing erosion and general nuisance. Our parking lot gets flooded and our employees must walk through and park in a pond. The second obvious problem is that the water from our property that we need to drain to Santa Clara cannot drain for the same reason.

Mr. John Curtin/ City Hydrologist has all of the information that you need to evaluate the situation and see that we are being forced to deal with a situation not of our making. In addition to information





Mr. Curtin can advise you of his findings from a visit to our site today.

My request is that the City of Albuquerque return the roadway to a grade that will allow proper drainage to take place and to stop the flow of water from city property and from the roadway onto private property.

Please call upon me if I can be of any assistance in resolving this matter. 271-2929

Awaiting your prompt reply.

Sincerely,

J. Michael Jones

cc: Mr. Bob Gurule, Director of Public Works  
Alex C de Baca  
Dan Hogan, Hydrology Division Manager  
Fred Aguirre, City Hydrologist  
John Curtin, City Hydrologist

CC: John P. Curtin 768-2727  
From: Andre Houle Security: Limited  
Subject: Santa Clara Grading Date Received: 10/11/94

---

10/11/94

RE: Santa Clara between Moon and Altez  
Suspense File Dated 10/7/94

I meet with J. Michael Jones and Alex C De Baca regarding the situation on Santa Clara.

I informed him that Street Maintenance will be installing a road side swale on the north side of the road to prevent any flow from coming off the street onto private property. The drainage plan for Enchantment Jewelry Corp. has not been constructed which is why Alex C De Baca is being flooded.

Street maintenance will be installing the swale Monday 10/17. City Survey has installed the control for the grading operation. Line spots were called on Monday and should be clear for grading on 10/12/94.

I also informed the property owners that this street will be included in a SAD for curb gutter, pavement and sidewalk and their support would be appreciated on the assessment district.

I will need a Grant of Entry form to waste the spoil from the swale on Alex C De Baca property to save us the haul.

Is John Curtin going to draft response to property owners? (Letters dated 10-4-94)

*Enchantment Jewelry  
Phase I only.*

*Go Slow on SAD.*

*S.D. MH on line w/invert.  
Will detour around MHs.*



**Tuesday 10/11/94 09:19 am Page: 1**

CC:	John P. Curtin	768-2727	
From:	Doug Dailey	Security:	Limited
Subject:	Grading of Santa Clara	Date Received:	10/11/94

Completed the bearing strength calculations for the RCP and CCP lines in Santa Clara NE (west of Ridgecrest reservoir). Six inches can be removed from the street without any problems with soil cover over these storm and water lines. I discussed the grading with Andre Houle and he is making the arrangements to have the work completed next week.

CC: John P. Curtin 768-2727  
From: Andre Houle Security: Limited  
Subject: Grading Santa Clara Date Received: 10/10/94

10/10/94

I meet with Joe David regarding the drainage problem on Santa Clara. I Called line spot and all utilities should be marked by 10:00 am on 10/12/94. The surveyors will set a hub and lathe offset with grade for cut along the north side of Santa Clara. I talked to Shube's Manufacturing about not parking along that run of street for next Monday through Wednesday. The surveyors should have all the stakes ready by then. Can you verify the availability of your grading crew for those three days. If not let me know so I can let Shube's know of the change.

----- Reply -----

To: Andre Houle From: Ray Baca  
Subject: Grading on Santa Clara Date Sent: 10/10/94

I'LL TRY TO BE THERE AND I'LL HAVE JOE DAVID THE UNPAVED FOREMAN BE THERE SO HE CAN SCEDULE WHATEVER EQIPMENT HE NEEDS TO DO THE JOB.

----- Original Memo -----

To: Ray Baca From: Andre Houle 857-8025  
Subject: Grading on Santa Clara Date Sent: 10/07/94

Apparently there is a drainage situation on Santa Clara Between Altez and Moon by the Ridgecrest Reservoir that Street Maintenace needs to fix. I just got word from water system that up to 6" of soil can be removed from over the water pipe. I have scheduled a meeting with the surveyor to set some lathe or what ever control you need to grade that road out. I will meet them on Monday at 10:30 on site. Can you make it? If not I'll go ahead and request some survey control but I'll need you to schedule a grader and possibly a loader and truck to haul spoil. I'll be at 8:30 staff probably out at 9:30.

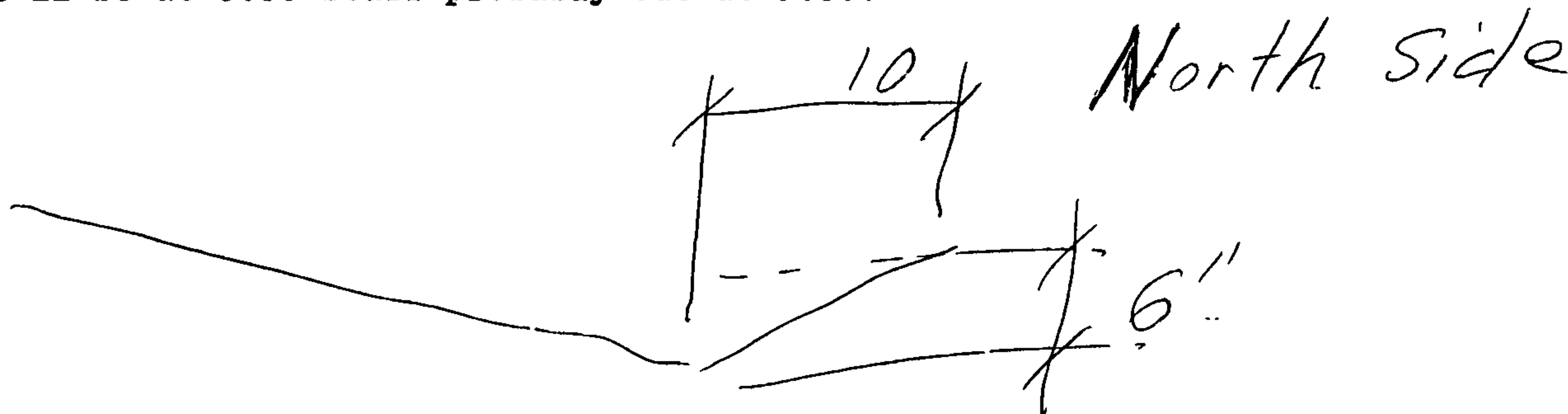

Dirt will be given to Mr. ~~Curtin~~ C de Baca.  
Staked Monday 10/10/94  
Grading starts Monday 10/17/94



Intended For: DISTRIBUTION

This Item is In Progress

Author: John P. Curtin

Subject: Meeting RE: Santa Clara

.1  
.1  
.1  
.1

-----

The meeting will be at 8:30 AM 10-6-94. If the 5th floor conference room is not available we will meet in John Castillo's office. This meeting will determine solutions for the drainage problems that the neighbors claim were created when Ridgecrest Reservoir #2 was constructed.

Attendees: John Castillo  
Dean Wall  
Lee Lunsford  
Bob Sedu  
Doug Dailey  
Dan Hogan  
John Curtin



# ***City of Albuquerque***

P.O. BOX 1293 ALBUQUERQUE, NEW MEXICO 87103

October 11, 1994

Alex C de Baca  
P.O. Box 11306  
Albuquerque, N.M. 87192

RE: GRADING COMPLAINT AT ENCHANTMENT JEWELRY (L-20/D51)  
LETTER DATED OCT 4, 1994

Dear Mr. C de Baca:

I understand your concern and frustration over the boundary problems between you and Enchantment Jewelry. Unfortunately, the City cannot help with this problem as it is a civil matter between the affected parties. I certainly endorse your decision to verify boundary concerns with a professional surveyor.

Runoff problems, disputes over differences in grade, inappropriate usage of fencing, or the necessity for retaining systems and other such problems between adjacent land owners is not the concern of the City. These complaints must be addressed by the parties directly involved. Section B-B appears to be constructed substantially correct by my field observations. This section was indicated only at the corner of the new addition. Enchantment Jewelry has hired a professional engineer to certify the addition that was constructed. When the Engineer's Certification is submitted it must identify and justify any alterations to the approved plan.

Your concern with the grade on Santa Clara Street is a concern to the City. The City will survey and regrade this street to insure drainage is confined to the Right-of-Way and directed to the appropriate storm inlet. Unfortunately a permanent solution cannot be guaranteed without ultimately paving the street.

I hope this answers your questions. In the future questions on grading of Santa Clara can be answered by Dean Wall of Street Maintenance. He can be reached at 857-8025. I will also be happy to address any questions you may have. You may contact me at 768-2727.

Sincerely,

  
John P. Curtin, P.E.  
Civil Engineer/Hydrology

c: J.Michael Jones, Enchantment Jewelry, 9700 Trumbull SE, 87123  
John Castillo, Ast. Dir. Public Works Dept.

WPHYD/7641/jpc

I MADE MY CONCERNS KNOWN TO MR JONES SINCE LAST YEAR WHEN HE PLACED THE FILL AGAINST THE FENCE. YET, NOTHING WAS DONE TO CORRECT IT. I THEN QUICKLY FOLLOWED UP AND MADE VARIOUS CITY DEPARTMENTS AWARE OF THE SITUATION BUT. NO ENFORCEMENT ACTION WAS TAKEN. I WAS TOLD LATER THAT MR JONES WAS GIVEN A "CERTIFICATE OF OCCUPANCY" EVEN THOUGH THE CITY HAD BEEN NOTIFIED OF THE CIRCUMSTANCES.

I HAVE ONLY ASKED FOR THE CITY TO HAVE MR JONES :

(A) COMPLY WITH HIS SUBMITTAL AS PER HIS DRAWINGS AND PERMIT,

(B) INSTALL A CONCRETE STEM/RETAINER WALL ON THE PROPERTY LINE IN COMPLIANCE WITH ALL CITY CODES

(C) NOT DISCHARGE HIS RUNOFF ONTO MY PROPERTY.

I HAVE ONLY ASKED FOR THE CITY TO LOOK AT THE DRAWINGS AND OTHER SUBMITTALS AND ENFORCE COMPLIANCE. THIS INCLUDES NOT ONLY MR JONES BUT ALSO THE CONTRACTOR AND INSPECTOR WHO WERE RESPONSIBLE FOR BUILDING AND INSPECTING THE STORM AND WATER LINES ON SANTA CLARA ST.

IT APPEARS TO ME THAT THE TAXPAYERS HAVE BEEN STUCK TWICE. ONCE FOR PAYING A ROAD CONTRACTOR, THEN WITH PAYING THE CITY STREET MAINTENANCE DEPT TO ATTEMPT FINISHING THE SUBSTANDARD JOB THAT WAS ACCEPTED BY "SOMEONE". THE ROAD IS NOW RARELY GRADED AND I HAVE TO KEEP REPAIRING THE STREET TO BE ABLE TO ENTER MY PROPERTY. YET I STILL PAY FULL SCALE TAXES.

I RECENTLY CALLED THE CITY PUBLIC WORKS DIRECTOR AND HAD MY CALL RETURNED BY THE ASSISTANT DIRECTOR, MR JOHN CASTILLO, WHO PROMISED TO LOOK INTO THE MATTER. I WISH TO THANK HIM FOR HIS RAPID RESPONSE. I HOPE THAT YOU CAN NOW ASSIST ME IN SOLVING THIS PROBLEM. I THANK YOU FOR COMING OVER AND PERSONALLY SEEING THE EXISTING PROBLEM AND THEN FOLLOWING UP ON IT. HOWEVER, AFTER READING MIKE JONES' RESPONSE, I FEEL THAT I AM ABOUT TO BE FACED WITH DELAYS AND THE RUNAROUND ONCE AGAIN. I AM HOPEFUL THAT YOU WILL PURSUE A TIMELY SOLUTION. THIS MATTER HAS DELAYED ME FROM PERFORMING IMPROVEMENTS ON MY PROPERTY AND THE LOSS OF ANY POTENTIAL REVENUES THEREOF. I HAVE BEEN SUBJECTED TO NEEDLESS EXPENDITURES THROUGH NO FAULT OF MY OWN.

SINCERELY,

ALEX C DE BACA

CC:

DOLAN AND DOMENICI  
JOHN CASTILLO



OCT 4, 1994

FAXED TO 505-768-3629 1:45-

PWD/ASST. DIRECTOR

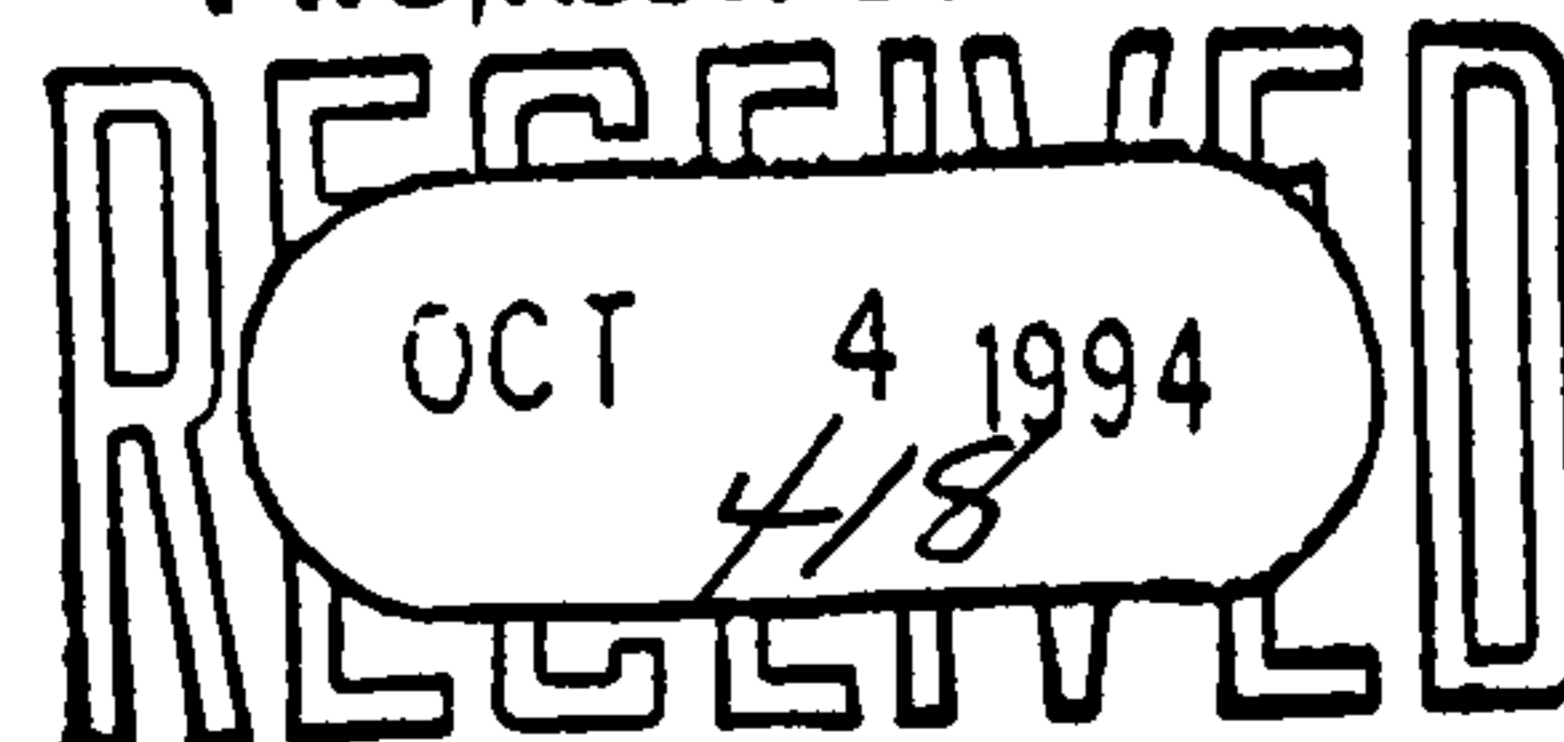

JOHN P. CURTAIN, P.E.  
CIVIL ENGINEERING/HYDROLOGY  
CITY OF ALBUQUERQUE  
P O BOX 1293  
ALBUQUERQUE, N.M. 87123

RE: LETTER FROM J. MICHAEL JONES

MR CURTAIN,

I HAVE RECEIVED COPIES OF BOTH YOUR LETTER TO MR JONES AND HIS RESPONSE TO YOU. FIRST OF ALL, I DID NOT PERFORM THE SURVEY ON MY PROPERTY. I WOULD LIKE TO KNOW EXACTLY ON WHAT FACTS MR JONES IS BASING HIS "REASONS" FOR IMPLYING SURVEY INACCURACY. I VIEW HIS RESPONSE AS AN ACCUSATION THAT I INTENTIONALLY MISREPRESENTED AND FALSIFIED THE BOUNDARIES.

MR JONES MENTIONED TO ME YESTERDAY THAT HIS SURVEYOR, HALL SURVEYING, ORIGINALLY USED A "NATURAL FORMATION" AS A BOUNDARY POINT BUT HAD NOT MONUMENTED THE BOUNDARIES. HE THEN REFERRED TO A SCRATCH ON THE SIDEWALK AS BEING THE ABSOLUTE PROPERTY BOUNDARY MARKER LINE.

I CHOSE TO HIRE A PROFESSIONAL SURVEYOR INSTEAD OF RELYING ON SCRATCHES ON THE SIDEWALK OR NATURAL FORMATIONS (WHATEVER THAT MEANS) TO DETERMINE THE BOUNDARIES.

MR BOB MARTINEZ SURVEYED AND MONUMENTED MY PROPERTY BOUNDARIES. MR MARTINEZ ASSURES ME THAT HE STANDS BY HIS MONUMENTED BOUNDARIES.

REGARDLESS OF THE EXACT BOUNDARIES, THE FACT IS, THAT MR JONES RUNOFF SHOULD NOT BE DISCHARGED ONTO MY PROPERTY. THE ONLY "MOOT POINT" IS WHETHER THE CITY IS GOING TO ENFORCE TIMELY COMPLIANCE, OR NOT.

I MUST CONTINUOUSLY GRADE (NOT NECESSARILY LOWER THE GRADE) ON MY PROPERTY TO LEVEL OFF THE ARROYOS THAT ARE CREATED FROM THE RUNOFF FROM MR JONES PROPERTY ONTO MY PROPERTY. AGAIN, THE ELEVATIONS ON MY PROPERTY HAVE NO BEARING ON THE FACT THAT HE CAN NOT DISCHARGE HIS RUNOFF ONTO MY PROPERTY.

FURTHERMORE, I ALSO NOTICED THAT A DRAWING JONES SUBMITTED TO THE CITY SHOWS A CONTINUOUS CURB (SECTION B-B) SEPARATING OUR PROPERTIES. THIS IS NOT THE FACT. HE RAISED THE GRADE ON THE SOUTHERN PORTION OF HIS PROPERTY WITH BARROW CONSISTING OF LOOSE SOIL AND GRAVEL THAT CONTINUOUS TO PERMIT HIS RUNOFF TO DISCHARGE ONTO MY PROPERTY.



# *City of Albuquerque*

P.O. BOX 1293 ALBUQUERQUE, NEW MEXICO 87103

October 4, 1994

Alex C de Baca  
P.O. Box 11306  
Albuquerque, N.M. 87192

RE: GRADING COMPLAINT AT ENCHANTMENT JEWELRY (L-20/D51),

Dear Mr. C de Baca:

Today I visited the site again and discussed your complaint with J. Michael Jones & Bob Geyer of Enchantment Jewelry. They explained that their surveyor & your surveyor were trying to arbitrate the disputed boundary between the two properties.

Enchantment Jewelry is removing the fill next to the fence between Enchantment Jewelry and your property to comply with the approved Grading Plan. The bottom of that fence is about 8 inches above the ground on your side of the fence. This leads me to believe that some excavation on your side of the fence has aggravated the abrupt grade change at the fence line.

Mr. Jones of Enchantment Jewelry has indicated a willingness to meet you half way. He proposed that you share the cost of constructing a retaining wall between the two properties. I suggest that you can solve most of your problem by working with Mr. Jones.

If you wish to pursue this further it will be a civil matter between yourself and Enchantment Jewelry. City Hydrology will not be involved.

Sincerely,

John P. Curtin, P.E.  
Civil Engineer/Hydrology

c: J. Michael Jones, Enchantment Jewelry, 9700 Trumbull SE, 87123  
John Castillo, Ast. Dir. Public Works Dept.  
Dan Hogan, Hydrology Division Manager  
Fred Aguirre, City Hydrologist  
Andrew Garcia, Inspector

WPHYD/7641/jpc





South Corner 10-4-94  
on Santa Clara

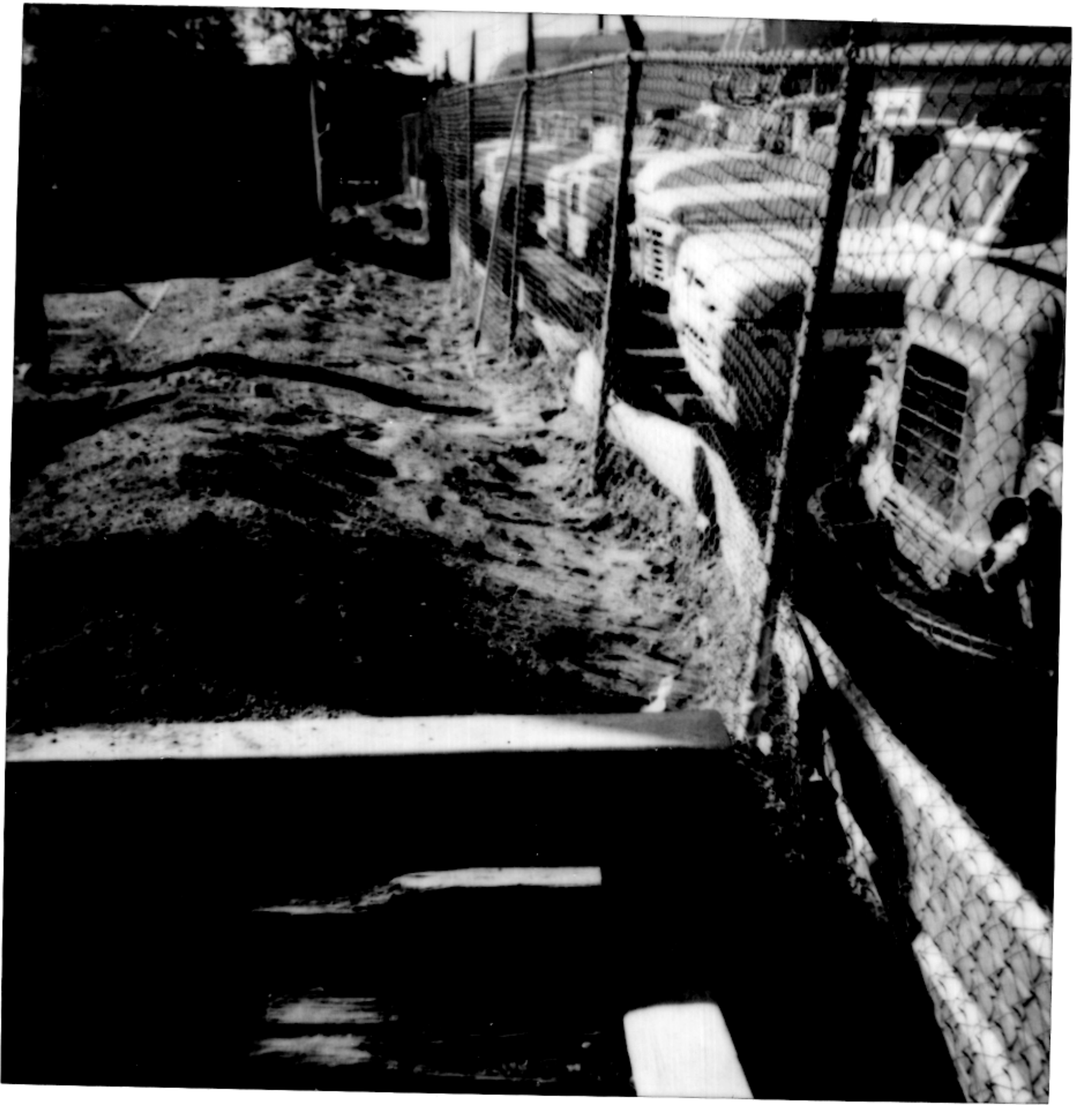

swale being constructed 10-4-94  
next fence.

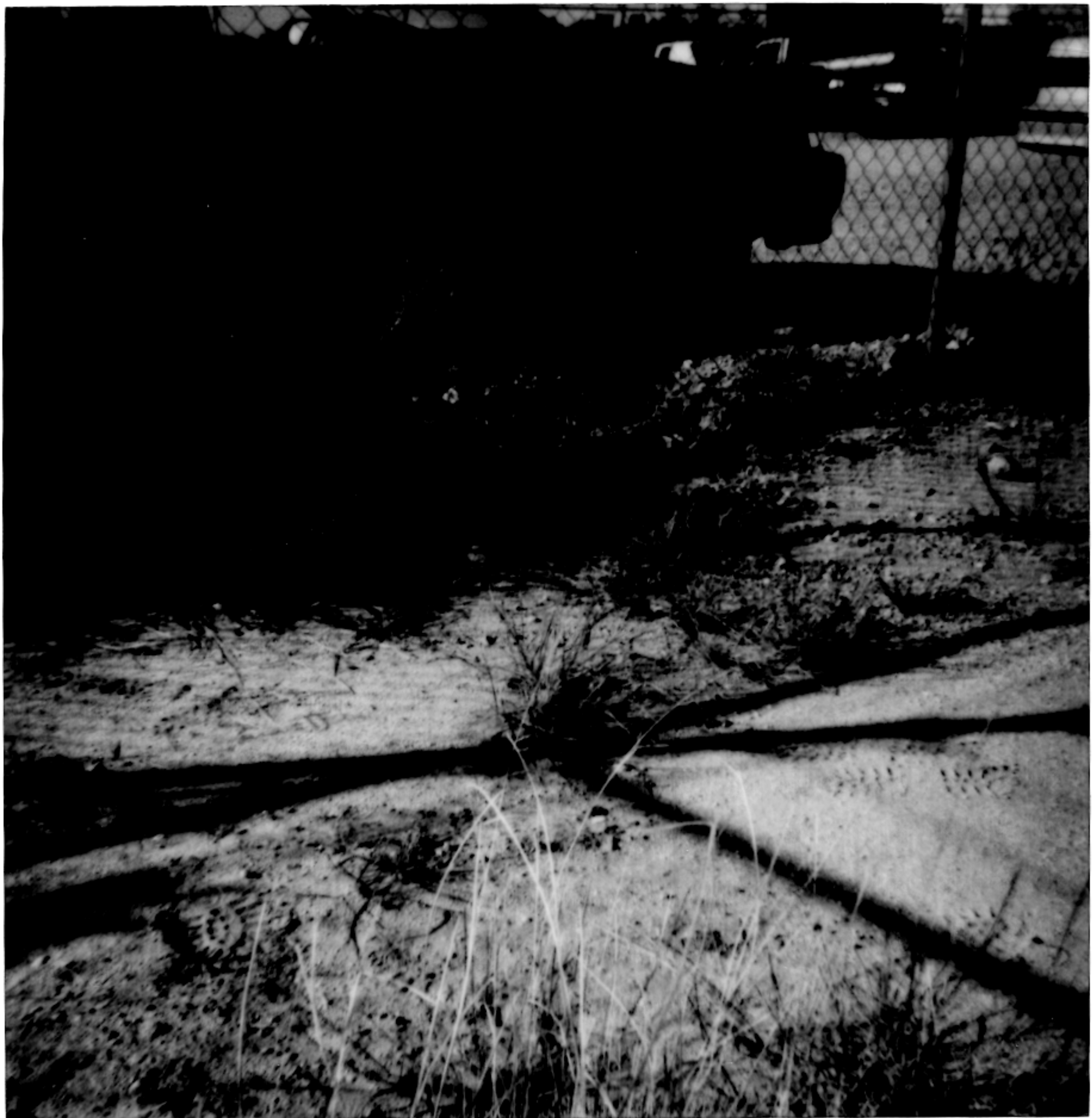

Gully formed 10-4-94  
by runoff from Santa  
Clara onto Enchantment J



10-4-94



Intended For: DISTRIBUTION

This Item is In Progress

Author: John P. Curtin

Subject: Enchantment Jewelry Corp.

---

RE: DRAINAGE COMPLAINT AT ENCHANTMENT JEWELRY (L-20/D51)

Based on the Response from J. Michael Jones, Enchantment Jewelry Corp,  
there are two main problems involved in this complaint:

1. The boundary between Mr. C de Baca's property and Enchantment Jewelry is disputed.
2. There is an abrupt grade change at the existing chain link fence that appears to have been created by Enchantment Jewelry when they place fill on their side of the fence and by Mr. C de Baca when he excavated on his side of the fence.

Both of these problems are civil matters between Mr. C de Baca and Enchantment Jewelry. Hydrology will try not to become involved any further if possible.

John P. Curtin

10/03/94



# ENCHANTMENT JEWELRY Corporation

September 30, 1994

John P. Curtin, P.E.  
Civil Engineer/Hydrology  
City of Albuquerque  
PO Box 1293  
Albuquerque NM 87123

RE: Alleged Grading Problems at 9700 Trumbull Ave. S.E.  
(L-20/D51)

Dear Mr. Curtin:

In response to your letter addressed to Bob Geyer/Plant Manager of Enchantment Jewelry Corporation dated September 28, 1994.

I am the property owner as well as the President of Enchantment Jewelry Corporation. I offer the following:

1. We have reason to believe that Mr. C de Baca's survey is inaccurate. We built the paved swale according to our survey. I have included a copy of the recording information from the survey that we used.
2. We indeed did place dirt against the fence the exact amount would be debatable. The reason that it appears to be two feet of dirt is due to Mr. C de Baca's continual lowering of the grade on his property. Our survey does not indicate that the fence is on Mr. C de Baca's property.

With reference to City Hydrology's opinion about responsibility for damage, we would conclude that it is a moot point until the boundary

OCT 3 1994

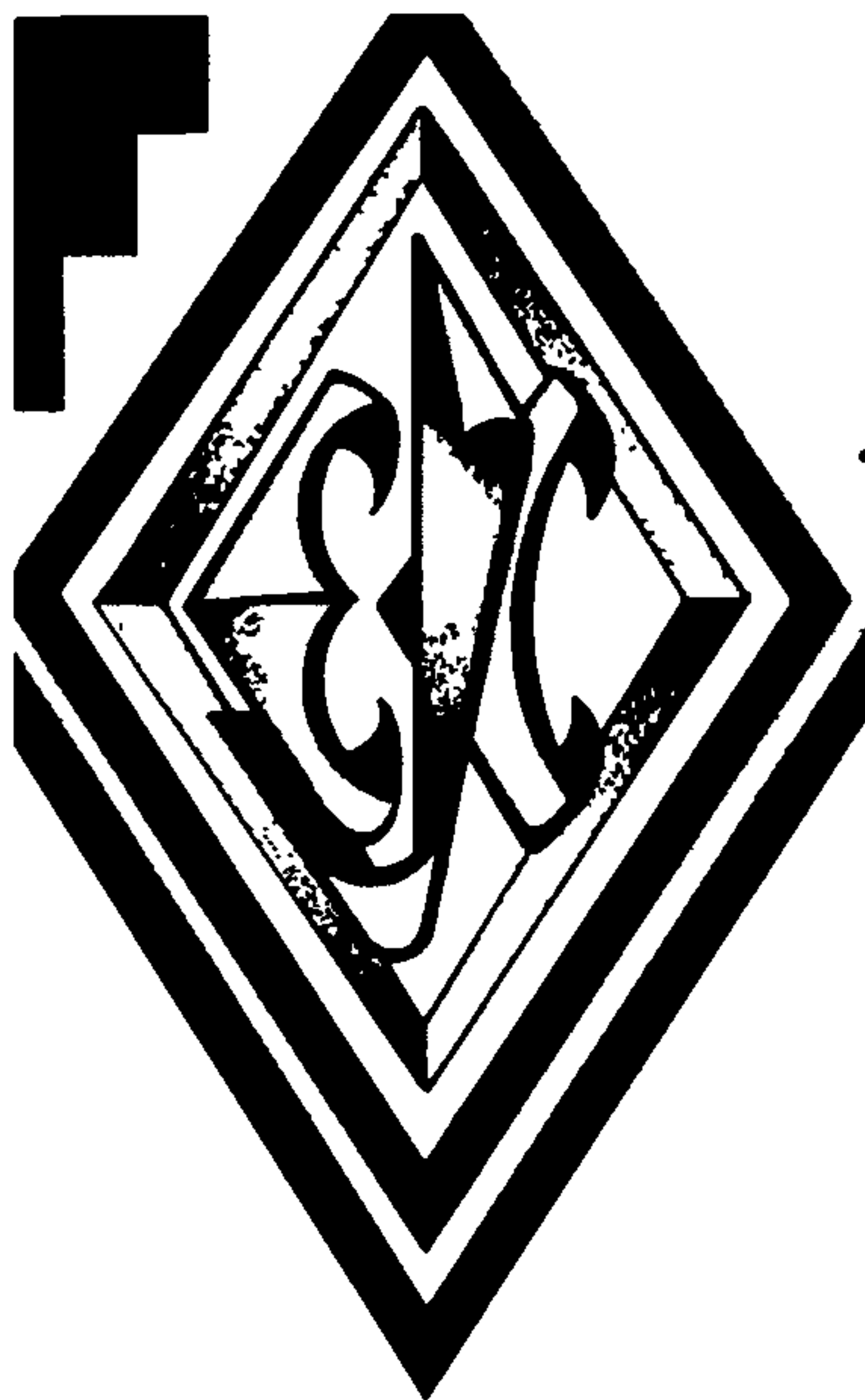

# ENCHANTMENT JEWELRY Corporation

issue is resolved. Should the resulting decision determine that we need to take actions to protect Mr. C de Baca's property we will do so. If, in fact, the conclusion is reached that Mr. C de Baca's survey is inaccurate we will reassess our position as to actions that we would like Mr. C de Baca to take relative to our property.

We will proceed with efforts to clear up the matter. We will take your recommendations under advisement until such time as the boundary issue is resolved.

If you require additional information contact me at 271-2929

Sincerely,

J. Michael Jones

cc: Marvin Kortum  
Alex C de Baca  
Dan Hogan, Hydrology Division Manager  
Fred Aguirre, City Hydrologist  
Alan Martinez, Inspector  
Bob Geyer, EJC



PLAT OF 9015896  
TRACTS "A" & "B", BLOCK 26  
SKYLINE HEIGHTS  
ALBUQUERQUE, NEW MEXICO

State of New Mexico } SS  
County of Bernalillo }  
This instrument was filed for record on

MAR 1 1990

1:32 PM Recorded in Vol 90-C  
of records of said County Folio 54  
Deputy Clerk

(A Replat of Lots 1, 2, 3, 4, 5, 7, 8, 9 & 10, Block 26, Together  
with the east 1/2 of vacated Erbbe St. adjacent to Lots  
1 & 10 & the west 1/2 of vacated Altez St. adjacent to Lot 5)  
DECEMBER, 1989

DESCRIPTION

Lots numbered 1, 2, 3, 4, 5, 7, 8, 9 & 10 in Block numbered 26 of SKYLINE HEIGHTS, a Subdivision, Albuquerque, New Mexico, as the same are shown and designated on the Plat filed in the office of the County Clerk of Bernalillo County, New Mexico, on November 18, 1946, TOGETHER WITH the East one-half of Vacated Erbbe St. SE, lying adjacent to said Lots 1 and 10, Block 26 and the West one-half of vacated Altez St. SE, lying adjacent to said Lot 5, Block 26, said right-of-ways having been vacated by City Ordinance No. 1231, adopted June 4, 1957.

FREE CONSENT, DEDICATION

The undersigned owners and proprietors of the property described hereon, do hereby consent to the replatting of said property as shown on this Plat and the same is with their free consent and in accordance with their desires.

Jackie Hodges, Owner of Tract "B"

2-16-90

Stella Hodges, Owner of Tract "A"

2-16-90

UNITED NEW MEXICO BANK OF RIO RANCHO  
as Mortgagee for Tract "A"

BY:

Ron Smith, President



# *City of Albuquerque*

P.O. BOX 1293 ALBUQUERQUE, NEW MEXICO 87103

September 28, 1994

Bob Geyer  
Plant Engineer  
Enchantment Jewelry  
9700 Trumbull SE  
Albuquerque, N.M. 87123

RE: GRADING PROBLEMS AT ENCHANTMENT JEWELRY (L-20/D51)

Dear Mr. Geyer:

In response to a complaint from Alex C de Baca, City Hydrology observed the following grading problems when we visited the site on 9-27-94:

1. Based on Mr. C de Baca's property survey, it appears that where the paved swale bends around the corner of the new addition it enters Mr. C de Baca's property.
2. About 2 feet of fill appears to have been placed against against the chain link fence on the side of Mr. C de Baca property south of the new addition. The property survey indicates that the fence is on Mr. C de Baca's property and belongs to him.

It is City Hydrology's opinion that Enchantment Jewelry is responsible for any damage caused by these drainage problems. City Hydrology recommends the following remedies to these grading problems:

1. Obtain permission from Mr. C de Baca to encroach on his property with the paved swale.
2. Construct a retaining wall along your west property line to relieve the pressure on Mr. C de Baca's fence.
3. Engineer's Certification must be submitted to verify that the Phase 1 addition has not caused any other grading & drainage problems.

If you have any questions about this site, you may contact me at 768-2727.

Page 2 of 2  
ENCHANTMENT JEWELRY (L-20/D51)  
September 28, 1994

Sincerely,



John P. Curtin, P.E.  
Civil Engineer/Hydrology

c: Marvin Kortum, 1605 Speakman SE; 87123  
Alex C de Baca, P.O. Box 11306; 87192  
Dan Hogan, Hydrology Division Manager  
Fred Aguirre, City Hydrologist  
Alan Martinez, Inspector

WPHYD/7641/jpc



(L-20/D51) Enchantment  
Jewelry

9-27-94



Santa Clara side



From Trumbull side



From Santa Clara







COMPLAINT FORM

PUBLIC WORKS DEPARTMENT  
UTILITY DEVELOPMENT DIVISION  
HYDROLOGY SECTION  
768-2650

Complainant: Alex C de Baca Phone #: 292-1003  
Address/Location: 500 Moon SE

Complaint: Alex is said that Enchantment Jewelry has caused drainage problems when they developed and that the City created drainage problems when the Well overflow line was constructed. (See Memo) in Santa Clara.

Referred to: John Curtin on 9-26-94

Investigation-Comments: Visited the site and observed that: 1. the paved swale appears to bend into Alex's property to go around new addition. 2. About 2' of fill appears to have been placed against the chain link fence on the ~~west~~ <sup>east</sup> side of Alex's property. Survey shows fence on Alex's property.

Santa Clara was discussed at a site meeting w/ EJ & street maintenance 7-8-93.

Follow-up: Notify Enchantment Jewelry of grading problems.

Discussion w/ street maintenance indicates that an SAD is needed to pave Santa Clara.

Resolved by: John Curtin Date: 9-28-94

COMPLAINT FILE NO.:

ZONE ATLAS/DRAINAGE FILE NO.:

L-20/1051

DATE COMPLAINT RECEIVED:

9-23-94



Intended For:

This Item is In Progress

Author: Daniel W. Hogan

Subject: Alex C de Baca

-----

To: Daniel W. Hogan  
Subject: Alex C de Baca

From: John Castillo  
Date Sent: 09/23/94

I spoke to Alex. He said that he has been having alot of problems getting someone to respond to his concerns. He owns property on the 500' block of Moon SE and also on Santa Clara and Trumbull. He said that Enchantment Jewelry just developed and created a drainage problem, by building on the property line. Have someone get the plans for this development and get together w/ him to review the site. His number is 292-1003. I understand that Enchantment J is on Trumbull. I told him that I was not sure if we would be able to help him, but see what the problem is and what can be done.

----- Original Memo -----

To: John Castillo  
Subject: Alex C de Baca

From: Daniel W. Hogan  
Date Sent: 09/23/94

Can't find anything. Let me know.

Dan

----- Reply -----

10-4

Bornick,  
what  
situation?  
7700 Trumbull SE  
L20-DS1

called & Left Message 9-26-94 Morning  
9-27-94 8:45 AM  
Visited site & Met Alex 9-27-94 4:00 PM

CITY OF ALBUQUERQUE  
PUBLIC WORKS DEPARTMENT



INTER-OFFICE CORRESPONDENCE

October 7, 1993

ENGINEERING GROUP

TO: BOB SIDHU - PWD/Water System

FROM: JOHN CURTIN - PWD/Hydrology

A handwritten signature in cursive script, reading "John P. Curtin".

SUBJECT: COMPLAINT ABOUT POND AT RIDGECREST RES.  
FROM ENCHANTMENT JEWELRY }

Thank you for a copy of the notes for the survey of the Stormwater Detention Pond that Glen Haikins did in July. Based on these elevations you need to raise the berm on the north side of the pond by about 0.6' to comply with the approved drainage plan.

Please contact storm drainage maintenance to arrange for them to do the grading necessary for compliance. When the grading work is completed, Glen will need to do an as-built survey to verify that the pond is in compliance.

If you have any questions about the pond, You may call me at 768-2727.

xc: Marvin Kortum, Consultant for Enchantment Jewelry

WPHYD/7641



\*Ridgecrest Res. site  
Hand write survey  
elevations \*

by Glen H. King  
7-26-93

STORMWATER DETENTION POND  
OVERFLOW WEIR, SEE DETAIL:  
SHT. 21

LIMITS OF STORMWATER  
DETENTION POND

[illegible]

about 4' higher than Marvin!



To John Custin

John C.

from

Bob Sidhu  
(857-8226)

AUG 25 1993

RECEIVED

Address 9700 TRUMBELL AVE SE Engr/Arch M. KORTUM

Plans Approved 4-14-93 <sup>PLAN DATE</sup> 9-14-93 Cond. \_\_\_\_\_

Comments: L-20/051 ENHANCEMENT JEWELRY  
PH I

Inspection Requested \_\_\_\_\_ Contractor \_\_\_\_\_

Appr. \_\_\_\_\_ Disappr. \_\_\_\_\_ 30 Day Temp. \_\_\_\_\_

Comments: \_\_\_\_\_  
\_\_\_\_\_  
\_\_\_\_\_  
\_\_\_\_\_  
\_\_\_\_\_

C.O. ~~granted~~ issued by Code 9-7-93

CITY OF ALBUQUERQUE  
PUBLIC WORKS DEPARTMENT



INTER-OFFICE CORRESPONDENCE

July 14, 1993

ENGINEERING GROUP

TO: RAY CHAVEZ - PWD/Street Maintenance

FROM: JOHN CURTIN - PWD/Hydrology

A handwritten signature in cursive script, appearing to read "John P. Curtin".

SUBJECT: COMPLAINT ABOUT SANTA CLARA AVENUE  
FROM ENCHANTMENT JEWELRY

As you requested, I contacted Lee Lunsford about the possibility of paving Santa Clara Avenue as part of a Special Assessment District. Lee said that five years ago he contacted the property owners and they were not interested. Lee said he would contact them again to see if they have changed their minds.

At our field meeting on July 8, it was decided street grades need to be designed for Santa Clara Avenue and these grades would need to be about two feet lower than the existing. I discussed this situation with my boss, Dan Hogan, this morning and he instructed me to hand off the responsibility for this request to you.

If I can be of further assistance, you may contact me at 768-2727.

xc: Dean Wall, Maintenance Division Manager  
Dan Hogan, Hydrology Division Manager  
Marvin Kortum, Consultant for Enchantment Jewelry

WPHYD+7641;jpc





# SANTA CLARA AVENUE

$$S = 1.34\%$$

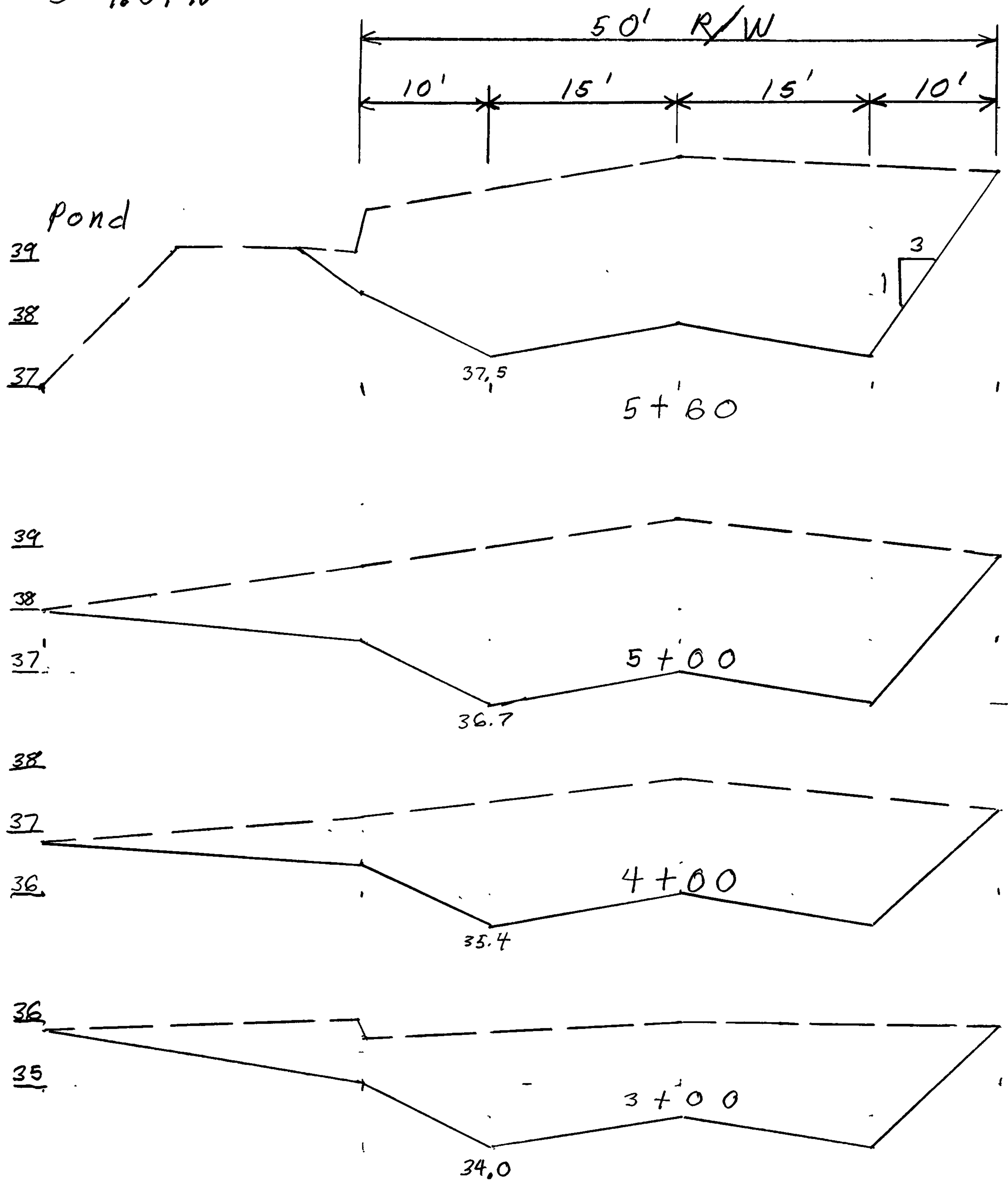

# Earth work

$$Vol = 2' (50') 800' / 27 = 2,963 \text{ CY} \approx 3,000 \text{ cy}$$

$$3,000 \text{ cy} @ \$3.33/\text{cy} = \$9,990 \approx \$10,000$$

Adjust MH F&C

$$5 @ \$400 \text{ Ea} = \$2,000$$





# City of Albuquerque

P.O. BOX 1293 ALBUQUERQUE, NEW MEXICO 87103

July 8, 1993

RE: FIELD MEETING FOR ENCHANTMENT JEWELRY (L-20/D51)  
HELD 9:00 A.M. JULY 8, 1993 ON SANTA CLARA AVENUE

ATTENDEES: Bob Sedu, PWD/Water Services  
Art Stewart, PWD/Water Services  
Ray Chavez, PWD/Street Maintenance  
John Curtin, PWD/Hydrology  
Bob Geyer, Enchantment Jewelry  
Marvin Kortum, Consultant

## SUMMARY:

The following things were determined:

1. The crux of the problem is that Santa Clara needs to be lowered to allow adjacent properties to drain into the public right of way. To accomplish this Santa Clara will need to be surveyed and street grades calculated. Then the manhole covers will need to be lowered and about 2' of dirt will need to be removed. I will ask Lee Lunsford to see if the property owners are willing to participate in a Special Assessment District to pave Santa Clara & Altez.
2. The detention pond for Ridgcrest Reservoir # 2 was designed to handle storm water runoff only. The 24" RCP was designed to drain the reservoir without using the pond. Water Services needs to bring the pond into compliance with the approved drainage plan. If Water Services wishes to make changes, Then they will need to submit a revised Drainage Plan and have it approved by Hydrology.
3. The City has used steel reservoir for 40 years and has never had one rupture. Steel reservoirs are inspected once a year and any corroded areas are repaired or replaced.

Since the quantity of dirt which needs to be removed from Santa Clara Avenue exceeds what Street Maintenance can do in house I will need to discuss with my boss, Dan Hogan, how this will be accomplished and how it will be financed. If anyone has any questions about this summary, you may contact me at 768-2727.

Sincerely,

  
John P. Curtin, P.E.  
Civil Engineer/Hydrology

WPHYD+7641;jpc

PUBLIC WORKS DEPARTMENT

Ray - S.A.D. to pave Santa Clara. Liquid Waste could lower manhole. Call David Salsido or Tim Fink

Water Services will need to bring Detention Pond into compliance with the Approved Plan.

☐ Dan Montano needs to survey Santa Clara to determine Street Grades.

Call Lee Lundsford to see if any S.A.D.s are planned.

Bob Sedu	Meeting 7-8-93
Art Stewart	9:00 AM at
Ray Chavez	Enchantment
John Curtin	Jewelry.
Bob Geyer	
Marvin Kortum.	



**ENCHANTMENT**  
**JEWELRY** CORPORATION

Bob Geyer  
Plant Engineer

Turquoise Jewelry Manufacturers  
9700 Trumbull SE Albuquerque, NM 87123  
(505) 271-2929 1-800-545-6263





Facing West 7-6-93  
on Santa Clara



Spillway 7-6-93





# City of Albuquerque

P.O. BOX 1293 ALBUQUERQUE, NEW MEXICO 87103

April 6, 1993

Marvin R. Kortum  
1605 Speakman Dr. SE  
Albuquerque, N.M. 87123

RE: GRADING & DRAINAGE PLAN FOR ENCHANTMENT JEWELRY (L-20/D51)  
RECEIVED MARCH 17, 1993 FOR BUILDING PERMIT APPROVAL  
ENGINEER'S STAMP DATED MARCH 16, 1993

Dear Mr. Kortum:

Based on the information included in the submittal referenced above, City Hydrology APPROVES the Building Permit for Phase I of this Project.

The following comments must be addressed before Phase II can be approved:

1. Finish Legend. Use different line types for contours, buildings & landscaped areas so that they can be easily identified.
2. When the shed is removed, what replaces it, asphalt or landscape?
3. Contours around the Phase II building are incomplete. Proposed grades slope from 38.20 at the west side of building to 35.00 at the top of the concrete pond. Be careful not to grade too steeply.
4. Off-site flows must be resolved. Currently Hydrology is discussing the issues that were raised with Water Systems.

If you have any questions about this project, you may contact me at 768-2727.

Sincerely,

  
John P. Curtin, P.E.  
PWD/Hydrology

xc: Dan Hogan, Hydrology Division Manager  
Fred Aguirre, City Hydrologist  
Alan Martinez, Permits

WPHYD+7641;jpc

PUBLIC WORKS DEPARTMENT

PROJECT TITLE: Grading and Drainage Plan  
Enchantment Jewelry ZONE ATLAS/DRNG. FILE #: L-20 1051

LEGAL DESCRIPTION: Tract. A, Block 26, Skyline Heights

CITY ADDRESS: 9700 Trumbull Avenue, SE 87123

ENGINEERING FIRM: Marvin R Kortum CONTACT: Marvin R Kortum  
1605 Speakman Drive, SE  
 ADDRESS: Albuquerque, New Mexico 87123 PHONE: (505) 299-0774

OWNER: Enchantment Jewelry CONTACT: Bob Geyer  
9700 Trumbull Avenue  
 ADDRESS: Albuquerque, NM 87123 PHONE: 271-2929

ARCHITECT: \_\_\_\_\_ CONTACT: \_\_\_\_\_  
 ADDRESS: \_\_\_\_\_ PHONE: \_\_\_\_\_

SURVEYOR: \_\_\_\_\_ CONTACT: \_\_\_\_\_  
 ADDRESS: \_\_\_\_\_ PHONE: \_\_\_\_\_

CONTRACTOR: \_\_\_\_\_ CONTACT: \_\_\_\_\_  
 ADDRESS: \_\_\_\_\_ PHONE: \_\_\_\_\_

## PRE-DESIGN MEETING:

☒ YES☐ NO☒ COPY OF CONFERENCE RECAP  
SHEET PROVIDED

DRB NO.	_____
EPC NO.	_____
PROJ. NO.	_____
MAR 17 1993	

## TYPE OF SUBMITTAL:

☐ DRAINAGE REPORT☒ DRAINAGE PLAN☐ CONCEPTUAL GRADING & DRAINAGE PLAN☒ GRADING PLAN☐ EROSION CONTROL PLAN☐ ENGINEER'S CERTIFICATION

## CHECK TYPE OF APPROVAL SOUGHT:

☐ SKETCH PLAT APPROVAL☐ PRELIMINARY PLAT APPROVAL☐ SITE DEVELOPMENT PLAN APPROVAL☐ FINAL PLAT APPROVAL☒ BUILDING PERMIT APPROVAL☐ FOUNDATION PERMIT APPROVAL☐ CERTIFICATE OF OCCUPANCY APPROVAL☐ ROUGH GRADING PERMIT APPROVAL☐ GRADING/PAVING PERMIT APPROVAL☐ OTHER \_\_\_\_\_ (SPECIFY)DATE SUBMITTED: March 17, 1993BY: Marvin R Kortum

7641



CITY OF ALBUQUERQUE  
PUBLIC WORKS DEPARTMENT  
UTILITY DEVELOPMENT DIVISION/HYDROLOGY SECTION

PRE-DESIGN CONFERENCE

DRAINAGE FILE/ZONE ATLAS PAGE NO.: L-20 DATE: 2-4-93  
EPC NO.: \_\_\_\_\_ DRB NO.: \_\_\_\_\_ ZONE: C-3  
SUBJECT: Enchantment Jewelry  
STREET ADDRESS: 9700~~0~~ Trumbull # SE  
LEGAL DESCRIPTION: Replat to Tract A B/LK 26 Skyline Heights

APPROVAL REQUESTED: \_\_\_\_\_ PRELIMINARY PLAT \_\_\_\_\_ FINAL PLAT  
\_\_\_\_\_ SITE DEVELOPMENT PLAN X BUILDING PERMIT  
\_\_\_\_\_ GRADING/PAVING PERMIT \_\_\_\_\_ OTHER \_\_\_\_\_

ATTENDANCE: WHO REPRESENTING  
Marvin Kortum Enchantment Jewelry  
John Curtin PWD/Hydrology

FINDINGS:

- Wash line from Ridgecrest Reservoir <sup>L-20/038</sup>  
was enlarged in 1989. Project # 3458 3245  
1. Could tie into MH S 353 on Trumbull  
using the DRC Process, or  
2. Could use on site pond to limit  
runoff to the existing rate.

If #1 is chosen the downstream  
capacity must be checked to  
prevent aggravating downstream  
problems on Moon or Wyoming.

Santa Clara is unpaved & does not need  
paving if access is taken from other  
paved streets. Surface runoff to  
Moon or Trumbull ~~we~~ shall not aggravate problems  
on Moon or Wyoming.

The undersigned agrees that the above findings are summarized accurately and are only  
subject to change if further investigation reveals that they are not reasonable or that  
they are based on inaccurate information.

SIGNED: Marvin R Kortum Env.  
TITLE: Marvin R Kortum Env.  
DATE: Feb 4 1993

SIGNED: John P Curtin  
TITLE: CE/Hydrology  
DATE: 2-4-93

**\*\*NOTE\*\*** PLEASE PROVIDE A COPY OF THIS PRE-DESIGN FORM WITH THE DRAINAGE SUBMITTAL.