

# CITY OF ALBUQUERQUE

Planning Department  
David Campbell, Director



Mayor Timothy M. Keller

November 30, 2018

David Soule, P.E.  
Rio Grande Engineering  
P.O. Box 93924  
Albuquerque, NM, 87199

**RE: Innova Plaza Phase 2  
401 Eubank Blvd SE  
Permanent C.O. - Accepted  
Engineer's Stamp Date: 12/11/17  
Engineer's Certification Date: 11/27/18  
Hydrology File: L20D067**

Dear Mr. Soule:

Based on the Certification received 11/27/18 and site visit on 11/29/18, this certification is approved in support of Permanent Release of Occupancy by Hydrology.

As a reminder, if the project total area of disturbance (including the staging area and any work within the adjacent Right-of-Way) is 1 acre or more, then an Erosion and Sediment Control (ESC) Plan and Owner's certified Notice of Intent (NOI) is required to be submitted to the Stormwater Quality Engineer (Curtis Cherne, PE, [ccherne@cabq.gov](mailto:ccherne@cabq.gov), 924-3420) 14 days prior to any earth disturbance.

If you have any questions, please contact me at 924-3995 or [rbrissette@cabq.gov](mailto:rbrissette@cabq.gov).

Sincerely,

Renée C. Brissette, P.E. CFM  
Senior Engineer, Hydrology  
Planning Department



# City of Albuquerque

Planning Department  
Development & Building Services Division

## DRAINAGE AND TRANSPORTATION INFORMATION SHEET (REV 6/2018)

**Project Title:** INNOVA PLAZA PHASE2 **Building Permit #:** \_\_\_\_\_ **Hydrology File #:** L20D067

**DRB#:** \_\_\_\_\_ **EPC#:** \_\_\_\_\_ **Work Order#:** \_\_\_\_\_

**Legal Description:** lot 1A BLCOK 48 SKYLINE HEIGHTS

**City Address:** 401 EUBANK SE

**Applicant:** GLAD, LLC **Contact:** \_\_\_\_\_

**Address:** \_\_\_\_\_

**Phone#:** \_\_\_\_\_ **Fax#:** \_\_\_\_\_ **E-mail:** \_\_\_\_\_

**Other Contact:** RIO GRANDE ENGINEERING **Contact:** DAVID SOULE

**Address:** PO BOX 93924 ALB NM 87199

**Phone#:** 505.321.9099 **Fax#:** 505.872.0999 **E-mail:** david@riograndeengineering.com

**TYPE OF DEVELOPMENT:** \_\_\_\_\_ PLAT \_\_\_\_\_ RESIDENCE \_\_\_\_\_ DRB SITE ☒ ADMIN SITE

Check all that Apply:

### DEPARTMENT:

☒ HYDROLOGY/ DRAINAGE  
☐ TRAFFIC/ TRANSPORTATION

### TYPE OF SUBMITTAL:

☒ ENGINEER/ARCHITECT CERTIFICATION  
☐ PAD CERTIFICATION  
☐ CONCEPTUAL G & D PLAN  
☐ GRADING PLAN  
☐ DRAINAGE REPORT  
☐ DRAINAGE MASTER PLAN  
☐ FLOODPLAIN DEVELOPMENT PERMIT APPLIC  
☐ ELEVATION CERTIFICATE  
☐ CLOMR/LOMR  
☐ TRAFFIC CIRCULATION LAYOUT (TCL)  
☐ TRAFFIC IMPACT STUDY (TIS)  
☐ STREET LIGHT LAYOUT  
☐ OTHER (SPECIFY) \_\_\_\_\_  
☐ PRE-DESIGN MEETING?

IS THIS A RESUBMITTAL?: ☒ Yes ☐ No

### TYPE OF APPROVAL/ACCEPTANCE SOUGHT:

☐ BUILDING PERMIT APPROVAL  
☒ CERTIFICATE OF OCCUPANCY  
☐ PRELIMINARY PLAT APPROVAL  
☐ SITE PLAN FOR SUB'D APPROVAL  
☐ SITE PLAN FOR BLDG. PERMIT APPROVAL  
☐ FINAL PLAT APPROVAL  
☐ SIA/ RELEASE OF FINANCIAL GUARANTEE  
☐ FOUNDATION PERMIT APPROVAL  
☐ GRADING PERMIT APPROVAL  
☐ SO-19 APPROVAL  
☐ PAVING PERMIT APPROVAL  
☐ GRADING/ PAD CERTIFICATION  
☐ WORK ORDER APPROVAL  
☐ CLOMR/LOMR  
☐ FLOODPLAIN DEVELOPMENT PERMIT  
☐ OTHER (SPECIFY) \_\_\_\_\_

**DATE SUBMITTED:** \_\_\_\_\_ **By:** \_\_\_\_\_

COA STAFF:

ELECTRONIC SUBMITTAL RECEIVED: \_\_\_\_\_

FEE PAID: \_\_\_\_\_



CAUTION:  
EXISTING UTILITIES ARE NOT SHOWN.  
IT SHALL BE THE SOLE RESPONSIBILITY  
OF THE CONTRACTOR TO CONDUCT ALL  
NECESSARY FIELD INVESTIGATIONS PRIOR  
TO ANY EXCAVATION TO DETERMINE THE  
ACTUAL LOCATION OF UTILITIES & OTHER  
IMPROVEMENTS.

I David Soule, NMPE 14522 , of the firm Rio Grande Engineering, hereby certify that  
this project has been graded and will drain in substantial compliance with and in  
accordance with the design intend of the approved plan dated 12/11/17 . The record  
information edited on the original design document has performed by me or under my  
direct supervision and is true and correct to the best of my knowledge and belief. The as-  
built survey was provided by THOMAS PATRICK NMPS 12651. The certification is  
submitted in support of a request for PERMANENT CERTIFICATE OF OCCUPANCY.  
The record information presented heron is not necessarily complete and intended only to  
verify substantial compliance of the grading and drainage aspects of this project. Those  
relying on this record document are advised to obtain independent verification of its  
accuracy before using it for any other purpose



11/27/18

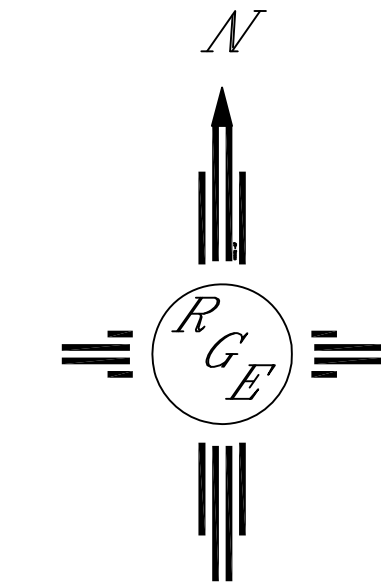
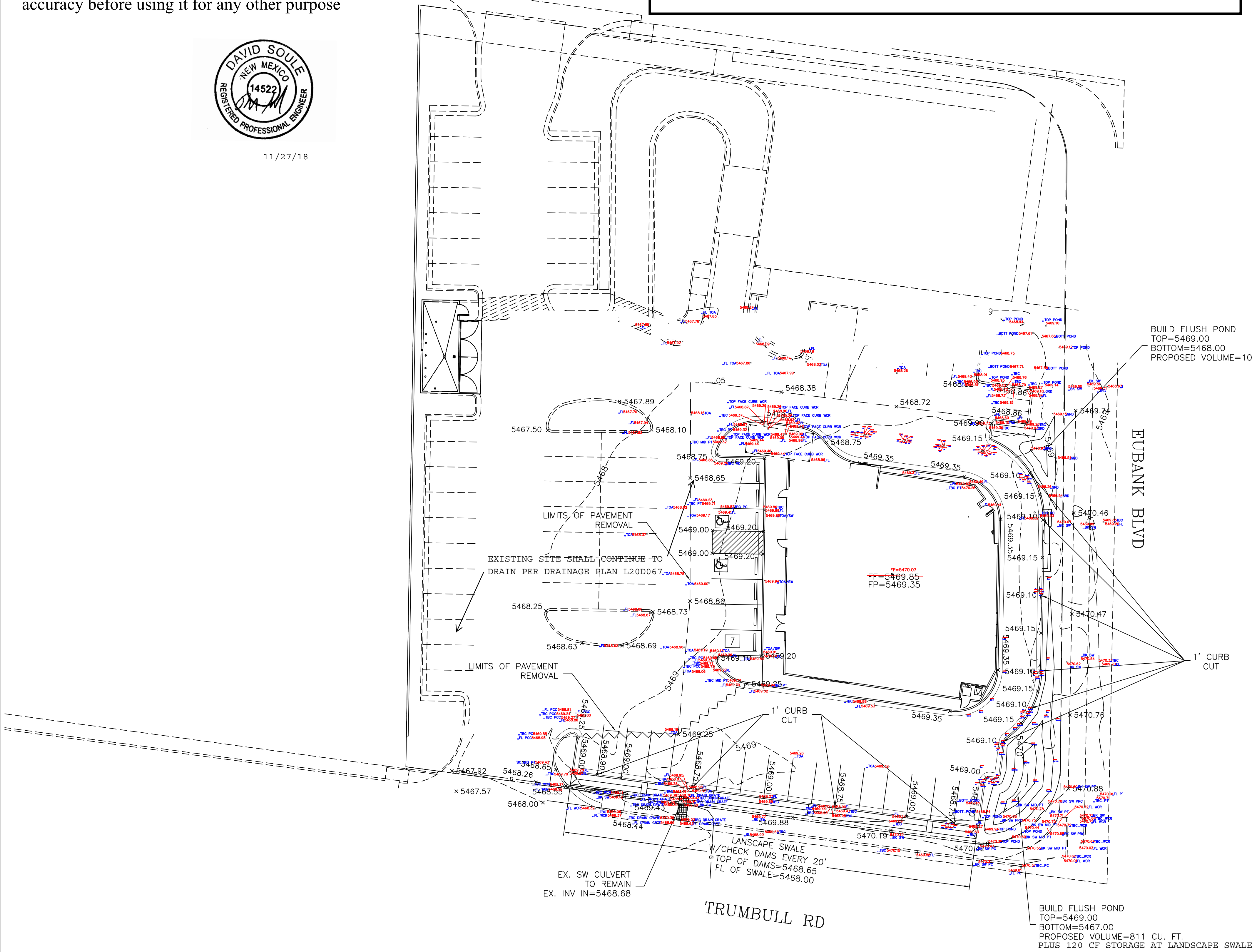

GRAPHIC SCALE

SCALE: 1"=20'

EROSION CONTROL NOTES:

1. CONTRACTOR IS RESPONSIBLE FOR OBTAINING A TOPSOIL DISTURBANCE PERMIT PRIOR TO BEGINNING WORK.
2. CONTRACTOR IS RESPONSIBLE FOR MAINTAINING RUN-OFF ON SITE DURING CONSTRUCTION.
3. CONTRACTOR IS RESPONSIBLE FOR CLEANING ALL SEDIMENT THAT GETS INTO EXISTING RIGHT-OF-WAY.
4. REPAIR OF DAMAGED FACILITIES AND CLEANUP OF SEDIMENT ACCUMULATIONS ON ADJACENT PROPERTIES AND IN PUBLIC FACILITIES IS THE RESPONSIBILITY OF THE CONTRACTOR.
5. ALL EXPOSED EARTH SURFACES MUST BE PROTECTED FROM WIND AND WATER EROSION PRIOR TO FINAL ACCEPTANCE OF ANY PROJECT.

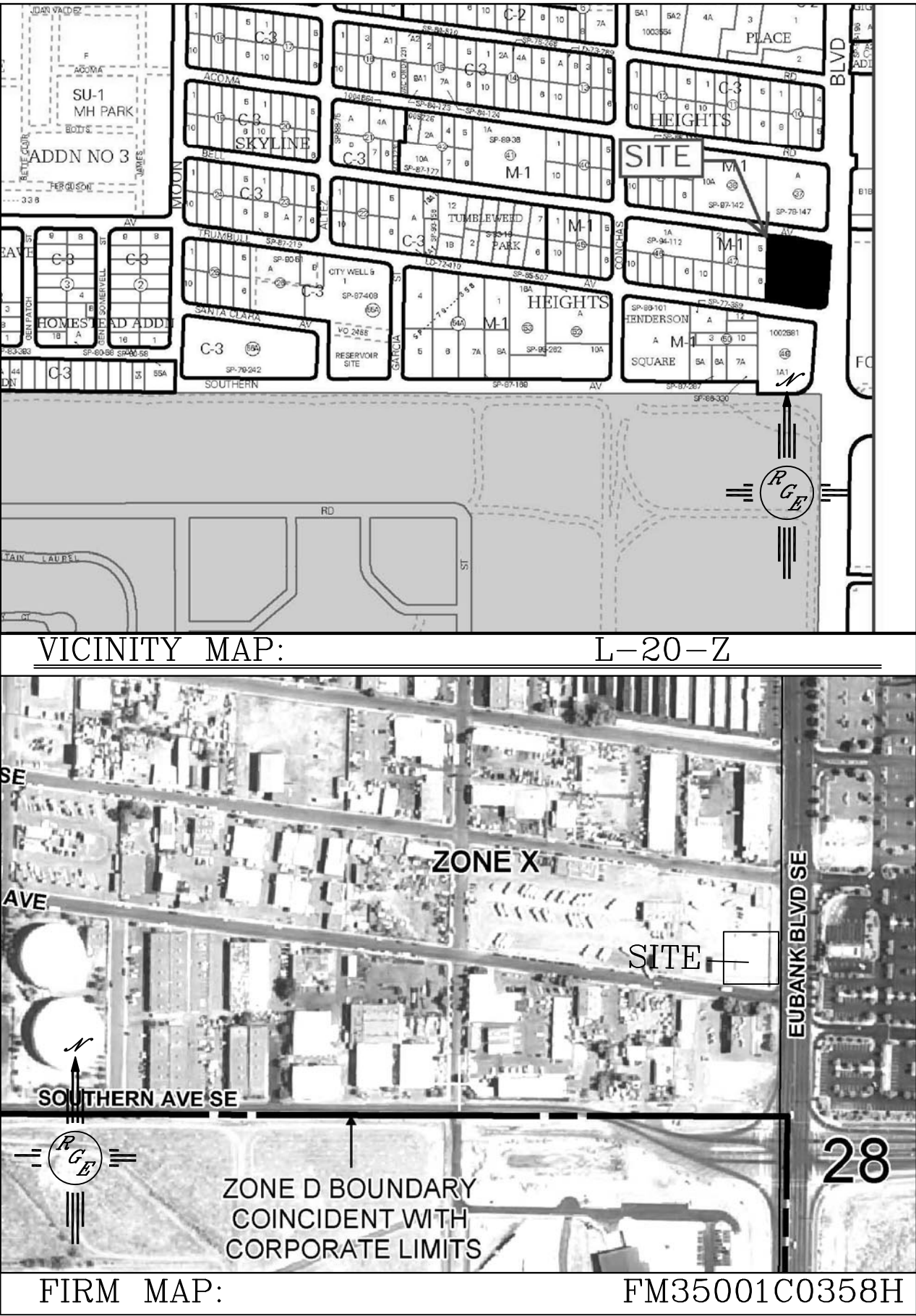

LEGAL DESCRIPTION:

NOTES:

1. ALL SPOT ELEVATIONS REPRESENT FLOWLINE ELEVATION UNLESS OTHERWISE NOTED.
2. ALL CURB AND GUTTER TO 6" HEADER UNLESS OTHERWISE NOTED.
3. ALL RETAINING WALL DESIGN SHALL BE BY OTHERS.
4. ALL NEW PAVING SHALL BE 6" PCC OVER 8" SUBGRADE PREPARATION IN CONFORMANCE TO ACI 330R-08. UNLESS OTHERWISE NOTED.
5. ANY CURBS OR PAVEMENT NEGATIVELY IMPACTED BY CONSTRUCTION ACTIVITY SHALL BE REPLACED TO MATCH EXISTING CONDITIONS.
6. ALL SITE WORK SHALL CONFORM TO CITY OF ALBUQUERQUE STANDARDS FOR PUBLIC WORKS CONSTRUCTION EDITION 9

LEGEND

- 5414--- EXISTING CONTOUR
- 5415--- EXISTING INDEX CONTOUR
- 5414--- PROPOSED CONTOUR
- 5415--- PROPOSED INDEX CONTOUR
- 5414--- SLOPE TIE
- 4048.25 EXISTING SPOT ELEVATION
- 4048.25 PROPOSED SPOT ELEVATION
- BOUNDARY
- CENTERLINE
- RIGHT-OF-WAY
- PROPOSED CURB
- EXISTING CURB AND GUTTER
- PROPOSED SIDEWALK
- EXISTING SIDEWALK

ENGINEER'S SEAL	INOVIA PLAZA	DRAWN BY WCWJ
DAVID SOULE NEW MEXICO REGISTERED PROFESSIONAL ENGINEER	GRADING AND DRAINAGE PLAN	DATE 12-05-17
12/11/17	Rio Grande Engineering 1606 CENTRAL AVENUE SE SUITE 201 ALBUQUERQUE, NM 87106 (505) 872-0999	21833-LAYOUT-12-05-17
DAVID SOULE P.E. #14522		SHEET # —
		JOB # 21833