

EROSION CONTROL AND TREE PROTECTION MEASURES SHALL BE INSTALLED PRIOR TO ANY OTHER CONSTRUCTION ACTIVITY AND MAINTAINED UNTIL PERMANENT GROUND COVER IS ESTABLISHED.

"THE ESCAPE OF SEDIMENT FROM THE SITE SHALL BE PREVENTED BY THE INSTALLATION OF EROSION AND SEDIMENT CONTROL MEASURES AND PRACTICES PRIOR TO, OR CONCURRENT WITH LAND-DISTURBING ACTIVITIES."

"EROSION CONTROL MEASURES WILL BE MAINTAINED AT ALL TIMES. IF FULL IMPLEMENTATION OF THE APPROVED PLAN DOES NOT PROVIDE FOR EFFECTIVE EROSION CONTROL, ADDITIONAL EROSION AND SEDIMENT CONTROL MEASURES SHALL BE IMPLEMENTED TO CONTROL OR TREAT THE SEDIMENT SOURCE"

ALL EROSION CONTROL MEASURES SHALL BE IN PLACE AS REQUIRED BY THE ENGINEER, PLANS, AND CITY REPRESENTATIVE. SILTATION CONTROL MEASURES SHALL BE INSPECTED PER THE NPDES PERMIT REQUIREMENTS. ANY DEFICIENCIES SHALL BE CORRECTED IMMEDIATELY AND NO FURTHER WORK WILL PROCEED UNTIL SAID DEFICIENCIES ARE CORRECTED TO THE CITY ENGINEER'S APPROVAL.

SEQUENCE OF CONSTRUCTION

PHASE I

1. INSTALL PERIMETER CONSTRUCTION FENCE.
2. INSTALL STABILIZED CONSTRUCTION ENTRANCES.
3. PREPARE TEMPORARY PARKING AND STORAGE AREA.
4. CONSTRUCT THE SILT FENCES ON THE SITE.
5. INSTALL ALL PERIMETER SEDIMENT MEASURES.
6. INSTALL ALL TEMPORARY EROSION & SEDIMENT CONTROLS AS NEEDED.
7. DEMOLISH ANY EXISTING STRUCTURES AS REQUIRED FOR PROPOSED IMPROVEMENTS.
8. CLEAR THE SITE.
9. BEGIN GRADING THE SITE.

PHASE II

10. START CONSTRUCTION OF UST INSTALL, BUILDING FOOTINGS, STRUCTURES, AND ANY OFF-SITE IMPROVEMENTS.
11. TEMPORARILY STABILIZE DENUDE AREAS.
12. INSTALL UTILITIES, UNDER DRAINS, STORM SEWERS, CURBS AND GUTTERS.
13. INSTALL INLET/FLUME PROTECTION DEVICES.
14. PREPARE SITE FOR PAVING.
15. PAVE SITE.
16. COMPLETE GRADING AND INSTALL PERMANENT AND PLANTINGS.
17. REMOVE EROSION AND TEMPORARY SEDIMENT CONTROL DEVICES AFTER FINAL STABILIZATION IS ACHIEVED.

BMP MAINTENANCE NOTES

ALL MEASURES STATED ON THIS SITE MAP, AND IN THE STORM WATER POLLUTION PREVENTION PLAN, SHALL BE MAINTAINED IN FULLY FUNCTIONAL CONDITION UNTIL NO LONGER REQUIRED FOR A COMPLETED PHASE OF WORK OR FINAL STABILIZATION OF THE SITE. ALL EROSION AND SEDIMENTATION CONTROL MEASURE SHALL BE CHECKED BY A QUALIFIED PERSON IN ACCORDANCE WITH THE CONTRACT DOCUMENTS OR THE APPLICABLE PERMIT, WHICHEVER IS MORE STRINGENT, AND REPAIRED IN ACCORDANCE WITH THE FOLLOWING:

1. INLET PROTECTION DEVICES AND BARRIERS SHALL BE REPAIRED OR REPLACED IF THEY SHOW SIGNS OF UNDERMINING OR DETERIORATION.
2. SILT FENCES SHALL BE REPAIRED TO THEIR ORIGINAL CONDITIONS IF DAMAGED. SEDIMENT SHALL BE REMOVED FROM THE SILT FENCES WHEN IT REACHES ONE-HALF OF THE SILT FENCE.
3. THE CONSTRUCTION EXITS SHALL BE MAINTAINED IN A CONDITION WHICH WILL PREVENT TRACKING OR FLOW OF MUD ONTO PUBLIC RIGHTS-OF-WAY. THIS MAY REQUIRE PERIODIC TOP DRESSING OF THE CONSTRUCTION EXITS AS CONDITIONS DEMAND.
4. THE TEMPORARY PARKING AND STORAGE AREA SHALL BE KEPT IN GOOD CONDITION (SUITABLE FOR PARKING AND STORAGE). THIS MAY REQUIRE PERIODIC TOP DRESSING OF THE TEMPORARY PARKING AREA AS CONDITIONS DEMAND.
5. FILTER TUBES SHALL BE REPAIRED TO THEIR ORIGINAL CONDITIONS IF DAMAGED. SEDIMENT SHALL BE REMOVED FROM TUBES WHEN IT REACHES $\frac{1}{3}$ OF ITS EXPOSED HEIGHT. SEE DETAILS.
6. PRIOR TO LEAVING THE SITE, ALL VEHICLES SHALL BE CLEANED OF DEBRIS. ANY DEBRIS AND/OR SEDIMENT REACHING THE PUBLIC STREET SHALL BE CLEANED IMMEDIATELY BY A METHOD OTHER THAN FLUSHING.

SITE LOCATION

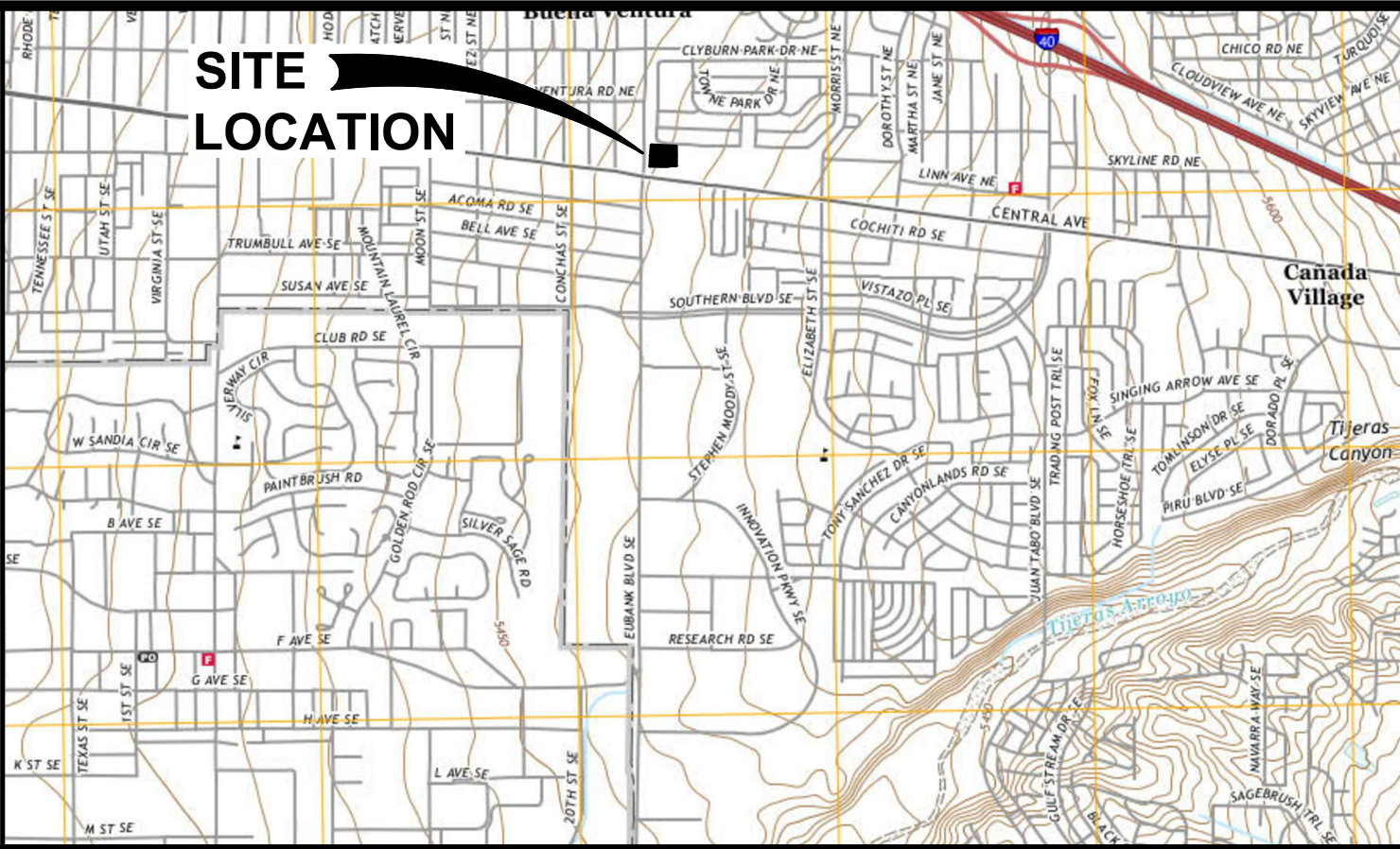

USGS QUADRANGLE MAP
N.T.S.

City ESC Plan Standard Notes (2020-07-16)

1. All Erosion and Sediment Control (ESC) work on these plans, except as otherwise stated or provided hereon shall be permitted, constructed, inspected, and maintained in accordance with:
 - a. The City Ordinance § 14-5-2-11, the ESC Ordinance,
 - b. The EPA's 2017 Construction General Permit (CGP), and
 - c. The City Of Albuquerque Construction BMP Manual.

<https://www.cabq.gov/planning/development-review-services/stormwater-quality-section>

2. All BMPs must be installed prior to beginning any earth moving activities except as specified hereon in the Phasing Plan. Construction of earthen BMPs such as sediment traps, sediment basins, and diversion berms shall be completed and inspected prior to any other construction or earthwork. Self-inspection is required after installation of the BMPs and prior to beginning construction.
3. Self-inspections - At a minimum a routine compliance self-inspection is required to review the project for compliance with the Construction General Permit once every 14 days and after any precipitation event of 1/4 inch or greater until the site construction has been completed and the site determined as stabilized by the city. Reports of these inspections shall be kept by the person or entity authorized to direct the construction activities on the site.
4. BMPs shall be inspected and maintained until all disturbed areas are stabilized in accordance with the Final Stabilization Criteria (CGP 2.2.14.b). Generally, all disturbed areas, other than structures, must have uniform perennial vegetation that provides 70 percent or more of the cover provided by native vegetation or seed the disturbed area and provide non-vegetative mulch that provides cover for at least three years without active maintenance. Final stabilization must be documented on self-inspection reports and approved by the City of Albuquerque prior to removal of BMPs and discontinuation of inspections.

DISTURBED AREA:

1. TOTAL SITE AREA = 0.93 ACS.
2. DISTURBED AREA = 1.29 ACS.

THE LOCATION OF THE SILT FENCE AND CONSTRUCTION FENCE ON THE DRAWINGS IS FOR GRAPHICAL REPRESENTATION ONLY. THE CONTRACTOR IS TO ENSURE THAT THE SILT FENCE AND CONSTRUCTION FENCE ENCOMPASSES THE ENTIRE WORK AREA.

GENERAL EROSION NOTES

- A. CONTRACTOR SHALL IMPLEMENT BEST MANAGEMENT PRACTICES AS REQUIRED BY THIS STORM WATER POLLUTION PREVENTION PLAN. ADDITIONAL BEST MANAGEMENT PRACTICES SHALL BE IMPLEMENTED AS DICTATED BY CONDITIONS AT NO ADDITIONAL COST OF OWNER THROUGHOUT ALL PHASES OF CONSTRUCTION.
- B. BEST MANAGEMENT PRACTICES (BMP'S) AND CONTROLS SHALL CONFORM TO FEDERAL, STATE, OR LOCAL REQUIREMENTS OR MANUAL OF PRACTICE, AS APPLICABLE. CONTRACTOR SHALL IMPLEMENT ADDITIONAL CONTROLS AS DIRECTED BY PERMITTING AGENCY OR OWNER.
- C. SITE MAP MUST CLEARLY DELINEATE ALL STATE WATERS, PERMITS FOR ANY CONSTRUCTION ACTIVITY IMPACTING STATE WATERS OR REGULATED WETLANDS MUST BE MAINTAINED ON SITE AT ALL TIMES.
- D. CONTRACTOR TO LIMIT DISTURBANCE OF SITE IN STRICT ACCORDANCE WITH EROSION CONTROL SEQUENCING SHOWN ON THIS PLAN, OR AS REQUIRED BY THE APPLICABLE GENERAL PERMIT. NO UNNECESSARY OR IMPROPERLY SEQUENCED CLEARING AND/OR GRADING SHALL BE PERMITTED.
- E. GENERAL CONTRACTOR SHALL DENOTE ON PLAN THE TEMPORARY PARKING AND STORAGE AREA WHICH SHALL ALSO BE USED AS THE EQUIPMENT MAINTENANCE AND CLEANING AREA, EMPLOYEE PARKING AREA, AND AREA FOR LOCATING PORTABLE FACILITIES, OFFICE TRAILERS, AND TOILET FACILITIES. CONTRACTOR SHALL CONSTRUCT TEMPORARY BERM ON DOWNSIDE SIDES AS NEEDED.
- F. ALL WASH WATER (CONCRETE TRUCKS, VEHICLE CLEANING, EQUIPMENT CLEANING, ETC.) SHALL BE RETAINED AND PROPERLY TREATED OR DISPOSED OF.
- G. SUFFICIENT OIL AND GREASE ABSORBING MATERIALS AND FLOTATION BOOMS SHALL BE MAINTAINED ON SITE OR READILY AVAILABLE TO CONTAIN AND CLEAN-UP FUEL OR CHEMICAL SPILLS AND LEAKS.
- H. DUST ON THE SITE SHALL BE MINIMIZED. THE USE OF MOTOR OILS AND OTHER PETROLEUM BASED OR TOXIC LIQUIDS FOR DUST SUPPRESSION OPERATIONS IS PROHIBITED.
- I. RUBBISH, TRASH, GARBAGE, LITTER, OR OTHER SUCH MATERIALS SHALL BE DEPOSITED INTO SEALED CONTAINERS. MATERIALS SHALL BE PREVENTED FROM LEAVING THE PREMISES THROUGH THE ACTION OF WIND OR STORMWATER DISCHARGE INTO DRAINAGE DITCHES OR WATERS OF THE STATE. CONTAINERS SHALL BE COVERED.
- J. ALL DENUDE/BARE AREAS THAT WILL BE INACTIVE FOR 14 DAYS OR MORE, MUST BE STABILIZED IMMEDIATELY UPON COMPLETION OF MOST RECENT GRADING ACTIVITY.
- K. DISTURBED PORTIONS OF THE SITE WHERE CONSTRUCTION ACTIVITY HAS PERMANENTLY STOPPED SHALL BE PERMANENTLY STABILIZED AS SHOWN ON THE PLANS. THESE AREAS SHALL BE STABILIZED NO LATER THAN 14 DAYS AFTER THE LAST CONSTRUCTION ACTIVITY OCCURRING IN THESE AREAS. REFER TO THE GRADING PLAN AND/OR LANDSCAPE PLAN.
- L. IF THE ACTION OF VEHICLES TRAVELING OVER THE GRAVEL CONSTRUCTION ENTRANCES IS NOT SUFFICIENT TO PREVENT TRACKING OF DIRT, DUST OR MUD, THEN THE TIRES MUST BE WASHED BEFORE THE VEHICLES ENTER A PUBLIC ROAD. PROVISIONS MUST BE MADE TO INTERCEPT THE WASH WATER AND TRAP THE SEDIMENT BEFORE IT IS CARRIED OFF THE SITE. ONLY USE INGRESS/EGRESS LOCATIONS AS PROVIDED.
- M. ALL MATERIALS SPILLED, DROPPED, WASHED, OR TRACKED FROM VEHICLES ONTO ROADWAYS OR INTO STORM DRAINS MUST BE REMOVED IMMEDIATELY.
- N. CONTRACTORS OR SUBCONTRACTORS WILL BE RESPONSIBLE FOR REMOVING SEDIMENT IN THE DETENTION POND AND ANY SEDIMENT THAT MAY HAVE COLLECTED IN THE STORM SEWER DRAINAGE SYSTEMS IN CONJUNCTION WITH THE STABILIZATION OF THE SITE.
- O. ON-SITE AND OFF-SITE SOIL STOCKPILE AND BORROW AREAS SHALL BE PROTECTED FROM EROSION AND SEDIMENTATION THROUGH IMPLEMENTATION OF BEST MANAGEMENT PRACTICES. STOCKPILE AND BORROW AREA LOCATIONS SHALL BE NOTED ON THE SITE MAP AND PERMITTED IN ACCORDANCE WITH GENERAL PERMIT REQUIREMENTS.
- P. SLOPES SHALL BE LEFT IN A ROUGHENED CONDITION DURING THE GRADING PHASE TO REDUCE RUNOFF VELOCITIES AND EROSION.
- Q. DUE TO THE GRADE CHANGES DURING THE DEVELOPMENT OF THE PROJECT, THE CONTRACTOR SHALL BE RESPONSIBLE FOR ADJUSTING THE EROSION AND SEDIMENT CONTROL MEASURES (SILT FENCES, ETC.) TO PREVENT EROSION AND POLLUTANT DISCHARGE.
- R. GENERAL CONTRACTOR IS TO DESIGNATE/IDENTIFY AREAS ON THE SITE MAPS, INSIDE OF THE LIMITS OF DISTURBANCE, FOR WASTE DISPOSAL AND DELIVERY AND MATERIAL STORAGE.

EXISTING

	Storm Drain Manhole		Hydrant
	Sanitary Sewer Manhole		Cable Pedestal
	Sanitary Sewer Line		Electric Pedestal
	Storm Drain Line		Utility Vault
	Storm Drain Inlet		Telephone Pedestal
	Underground Electric Line		Utility Box
	Underground Communications Line		Fiber Optic Box
	Underground Gas Line		Light Pole
	Underground Water Line		Concrete Symbol
	Sanitary Sewer Clean-out		Raised Truncated Dome Mat
	Water Meter		Control Point
	Water Valve		

PROPOSED

	BOUNDARY LINE
	CONTOUR ELEVATIONS
	CONSTRUCTION FENCE
	DRAINAGE FLOW
	LIMIT OF DISTURBED AREA
	SOIL TYPE DESIGNATION

PROJECT INFORMATION

RECEIVING WATER IS THE CITY DRAINAGE SYSTEM. DRAINAGE SYSTEM EVENTUALLY CONNECTS TO TIJERAS ARROYO ±2.3 MILES SOUTH OF PROJECT SITE.

PROPOSED PROJECT SITE MADE UP OF 3 COMMERCIAL LOT. STORM RUN-OFF FROM SITE WILL BE RETAINED ON-SITE.

PROPOSED PROJECT IS CONSTRUCTING A GAS STATION CONSISTING OF 2,824 S.F. CONVENIENT STORE WITH 8 PUMP ISLANDS AND ASSOCIATED PARKING AREA.

ANTICIPATED CONSTRUCTION START DATE IS AUGUST 17, 2020 AND COMPLETION DATE IS NOVEMBER 23, 2020.

CONTRACTOR TO TAKE APPROPRIATE MEASURES TO KEEP SEDIMENT FROM ESCAPING SITE AND ALL ACCUMULATED SEDIMENT SHALL BE CLEANED OUT AND REMOVED FROM SITE.

DOWNSIDE CONDITION WILL NOT BE NEGATIVELY AFFECTED BY PROPOSED DEVELOPMENT.

EROSION DETAILS — SEE DETAIL SHEET C-4.3

	CE STABILIZED CONSTRUCTION ACCESS
	CW CONCRETE WASH OUT AREA
	SF SEDIMENTATION / SILT FENCE WITH WIRE SUPPORT
	DC DUST CONTROL (USING: PHASING OF THE PROJECT, STABILIZATION, SPRINKLING WATER, SPRAY-ON-ADHESIVE, CALCIUM CHLORIDE, BARRIES, ETC.)
	TS TEMPORARY STABILIZATION STOCKPILE

SITE SOILS

	TgB TIJERAS — GRAVELLY FINE SANDY LOAMY, 1 TO 5 PERCENT SLOPES
--	--

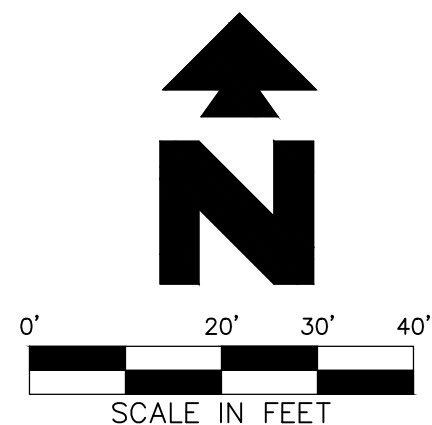

24 HR EMERGENCY CONTACT:
TERRY RIGDON 870-866-7457

SHEET NO.

C-4



9/14/20
Amos P. Blum, Jr.

EROSION CONTROL PH. I
MURPHY EXPRESS
110 EUBANK BOULEVARD N.E.
ALBUQUERQUE
NEW MEXICO

PAN AMERICAN ENGINEERS, LLC
1717 JACKSON STREET
ALEXANDRIA, LA. 71301
(504) 478-5100
CONTACT: RON BORDELON

MURPHY OIL USA, INC.

200 PEACH STREET
EL DORADO, AR 71730

MURPHY
USA