

REVISIONS

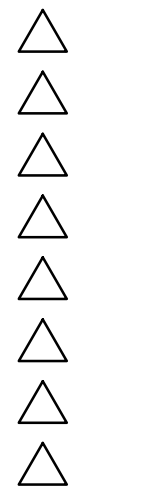

DRAWN BY BJB / DC

REVIEWED BY IMNA

DATE 07/30/2025

PROJECT NO 22-0220.002 / IAR2702

DRAWING NAME

PAVING &
TRAFFIC
CONTROL
PLAN

SHEET NO

CP101

ZONE ATLAS MAP - L21

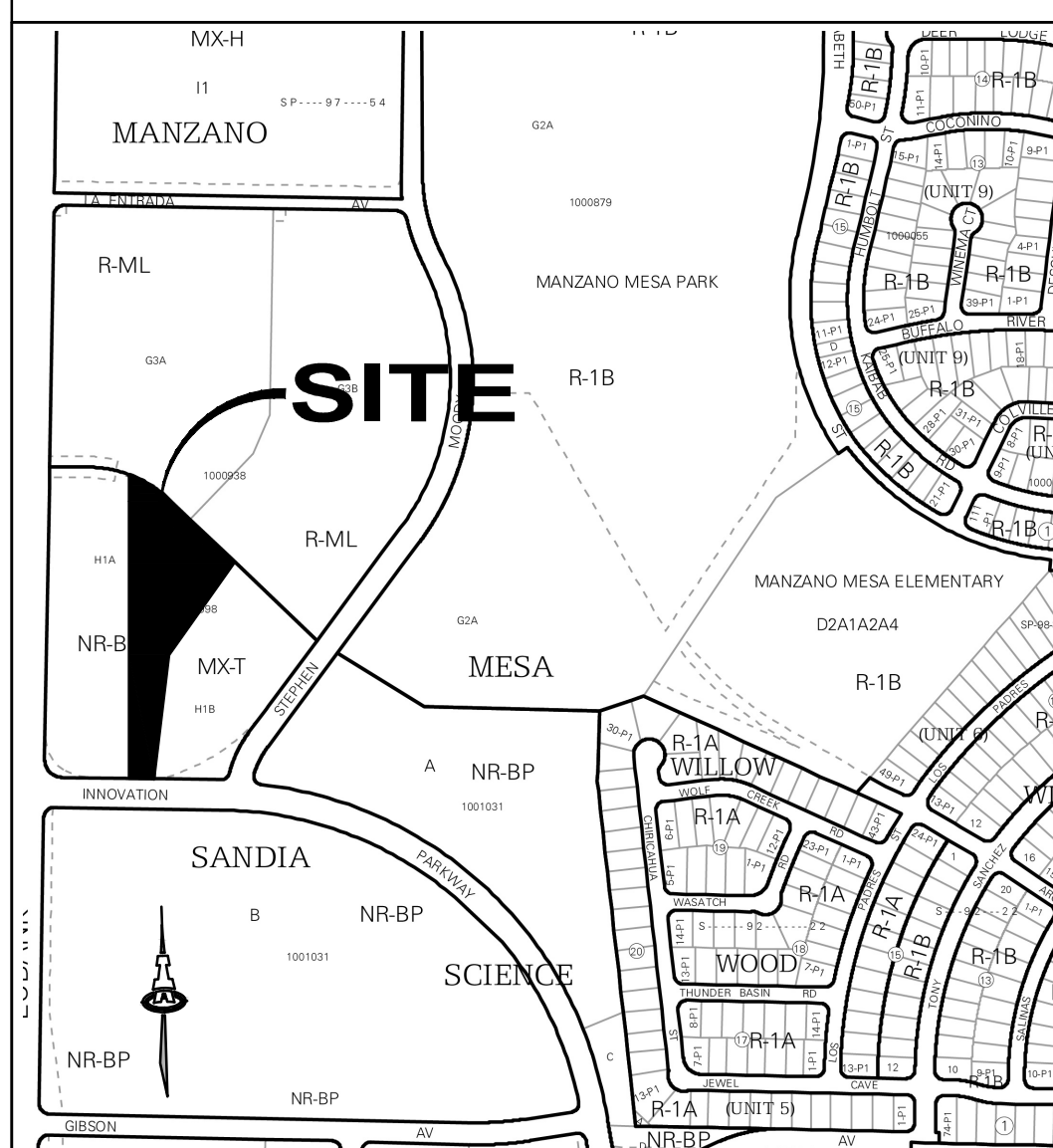

PROJECT INFORMATION

LEGAL DESCRIPTION:
TRACT H-1-B1 SHOWN AND DESIGNATED ON THE PLAT ENTITLED "MANZANO MESA"
TO BE FILLED IN THE OFFICE OF THE COUNTY CLERK OF BERNALILLO COUNTY, NEW
MEXICO.

SITE AREA: 6.7 ACRES

ZONING: MX-T

BUILDING CALCULATIONS: PHASE 2 CAFETERIA / MULTIPURPOSE FACILITY
GROSS FLOOR AREA (GFA)=4,342 SF

PARKING CALCULATIONS:

• FOR ELEMENTARY OR MIDDLE SCHOOLS, REQUIRED PARKING FORMULA IS
2-PARKING STALLS FOR EACH CLASSROOM PER IDO TABLE 5-5-1. THE EXISTING
SCHOOL BUILDING HAS A TOTAL OF 15 CLASSROOMS. NO ADDITIONAL
CLASSROOMS TO BE CONSTRUCTED WITH THE PHASE 2 CAFETERIA /
MULTIPURPOSE FACILITY.

REQUIRED PARKING: 24 SPACES / CLASSROOM; 12 CLASSROOMS ON SITE)
(2 SPACES / CLASSROOM; 12 CLASSROOMS ON SITE)

PROVIDED PARKING: 113 SPACES
(33 PROPOSED SPACES UNDER PHASE 1 / PHASE 2;
80 EXISTING SPACES ON SITE)

• FOR 101,300 PARKING SPACES PROVIDED ON SITE, NUMBER OF ACCESSIBLE
PARKING SPACES REQUIRED, PER NMBC TABLE 1106.2, IS:

ADA PARKING REQ'D: 8 SPACES (2 ADA VAN SPACES)

ADA PARKING PROVID: 9 SPACES (6 EXISTING / 3 PROPOSED; 4 ADA VAN
SPACES TOTAL)

• FOR 1-25 REQUIRED PARKING SPACES, 1 MOTORCYCLE (MC) SPACE IS
REQUIRED PER IDO TABLE 5-5-4.

MC PARKING REQUIRED: 1 MC SPACE

MC PARKING PROVIDED: 2 MC SPACES

• FOR ELEMENTARY OR MIDDLE SCHOOLS, REQUIRED BICYCLE PARKING IS 5 BIKE
SPACES OR 20% OF REQUIRED OFF-STREET PARKING SPACES, WHICHEVER IS
GREATER, PER IDO TABLE 5-5-5.

BIKE PARKING REQ'D: 5 SPACES (20% * 24 REQ'D SPACES = 4.8 SPACES)

BIKE PARKING PROVID: 11 SPACES (EXISTING BIKE RACK ON SITE)

GENERAL NOTES

- A. DIMENSIONS ARE TO FACE OF CURB, OR WALL, OR EDGE OF PAVEMENT
UNLESS OTHERWISE NOTED.
- B. ALL CURB RADII ARE 2' UNLESS OTHERWISE NOTED.
- C. CURBS AND ACCESSIBLE RAMPS WILL BE DESIGNED AND BUILT ACCORDING TO
THE CITY OF ALBUQUERQUE STANDARDS.
- D. STREETS, PARKING SPACES AND ASSOCIATED DRIVES TO BE ASPHALT UNLESS
NOTED OTHERWISE.
- E. LANDSCAPE AND SIGNAGE WILL NOT INTERFERE WITH CLEAR SIGHT
REQUIREMENTS. SIGNS, WALLS AND PLANTING BETWEEN 3 FEET AND 8 FEET
TALL (AS MEASURED FROM THE GUTTER PAN) WILL NOT BE PERMITTED IN THE
CLEAR SIGHT TRIANGLE.
- F. ALL LIGHTING SHALL BE PLACED SO AS TO DIRECT LIGHT AWAY FROM
RESIDENTIAL DISTRICTS AND SHALL BE FULLY SHIELDED TO COMPLY WITH THE
NM NIGHT SKY PROTECTION ACT AND IDO SECTION 14-16-5-8 OUTDOOR
LIGHTING. MAXIMUM HEIGHT FOR LIGHT POLES SHALL BE 16 FEET TALL.
- G. SEE C-100 FOR ALL CIVIL GENERAL NOTES.

LEGEND

=====	PROPERTY LINE
=====	EXISTING CURB AND GUTTER
=====	PROPOSED CURB
=====	ADA SPACE
=====	PEDESTRIAN CROSSWALK
=====	ADA PATHWAY
=====	BIKE RACK
=====	PARKING COUNT
=====	FIRELANE (RED) "NO PARKING"
=====	PCC PAVING SECTION
=====	LIGHT ASPHALT PAVING SECTION
=====	HEAVY ASPHALT PAVING SECTION
=====	EMERGENCY VEHICLE TURN AROUND BASE COURSE PAVING SECTION
=====	PCC SIDEWALK
=====	MINI CLEAR SIGHT TRIANGLE
=====	PHASE I & PHASE II LIMITS

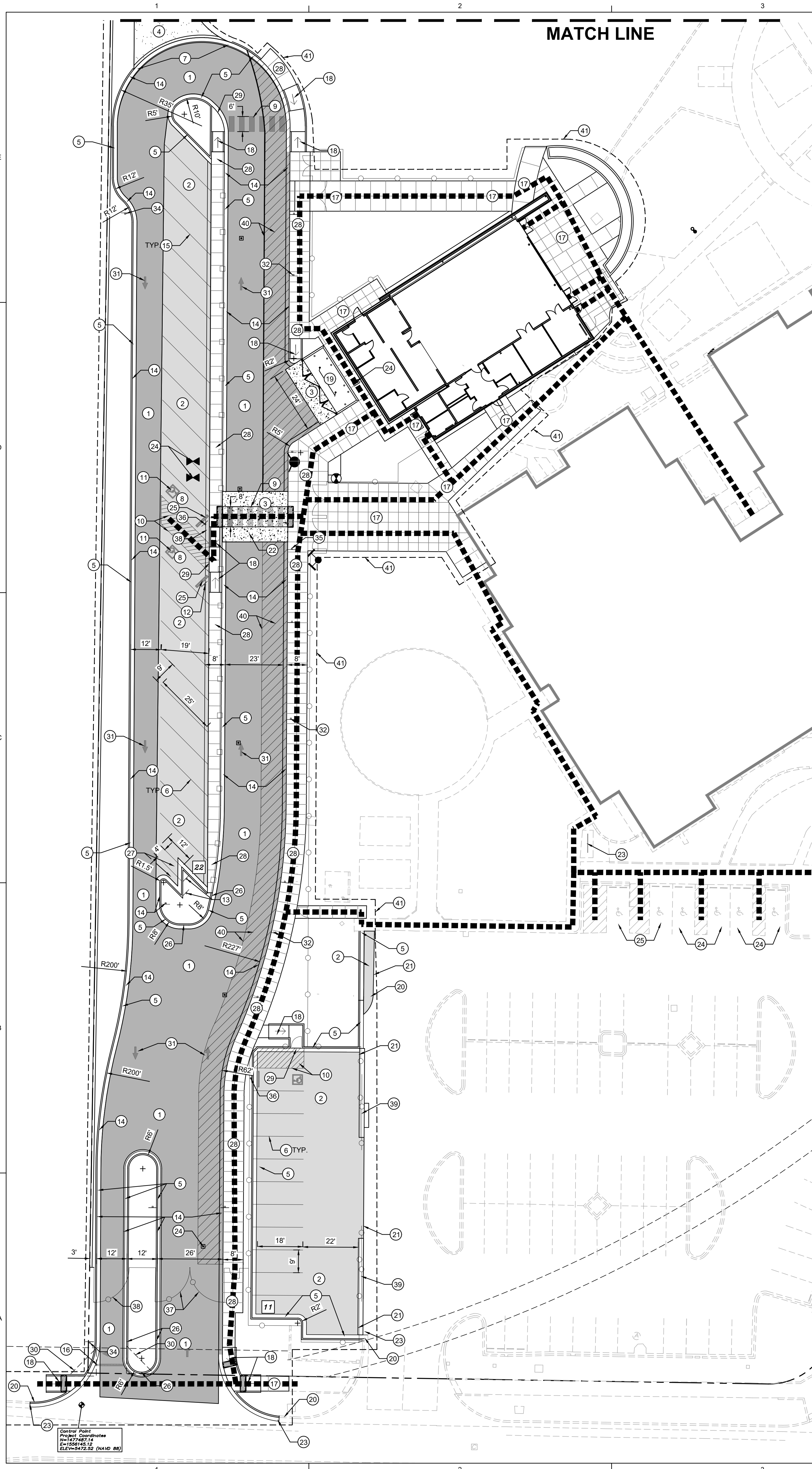

KEY NOTES

SEE SHEETS CP501, AS501 & AS502 FOR PAVING DETAILS AS UNDERLINED BELOW.

1. ASPHALT PAVEMENT - HEAVY DUTY.
2. ASPHALT PAVEMENT - LIGHT DUTY.
3. CONCRETE PAVEMENT SECTION.
4. BASE COURSE PAVING SECTION AT EMERGENCY VEHICLE TURN AROUND.
5. CONCRETE CURB AND GUTTER.
6. ROADWAY STRIPING - 4" WIDE WHITE PARKING LOT STRIPE.
7. CONCRETE MOUNTABLE CURB.
8. ACCESSIBLE PARKING, MAXIMUM 2% SLOPE IN ALL DIRECTIONS.
9. PAINTED CROSSWALK, WHITE, REFER TO PLAN VIEW FOR LENGTH, 2' WIDE AT 4' O.C.
10. ACCESSIBLE PARKING - ACCESS AISLE MARKINGS, PAINTED 4" ADA BLUE STRIPING, MAXIMUM 2% SLOPE IN ALL DIRECTIONS.
11. ACCESSIBLE PAVEMENT MARKING - ADA SYMBOL.
12. SITE SIGNAGE - ADA PARKING.
13. SITE SIGNAGE - MOTORCYCLE PARKING.
14. FIRE LANE STRIPING AND SIGNAGE.
15. ROADWAY STRIPING - 4" WHITE LANE STRIPE.
16. STOP LINE PAVEMENT STRIPING.
17. CONCRETE SIDEWALK, SIDEWALK WIDTH VARIES. SEE SITE PLAN.
18. SIDEWALK ACCESS RAMPS.
19. TRASH ENCLOSURE.
20. CONTRACTOR TO VERIFY LOCATION OF EXISTING CURB, ASPHALT, AND CONCRETE PAVEMENT TIE-IN LOCATIONS AND MATCH EXISTING WITH SMOOTH TRANSITION. NOTIFY ENGINEER OF ANY DISCREPANCIES.
21. SAWCUT REMOVE & DISPOSE EXISTING ASPHALT
22. RAISED PEDESTRIAN CROSSWALK.
23. EXISTING BIKE RACK (11 BIKE PARKING SPACES PROVIDED).
24. EXISTING ADA PARKING.
25. EXISTING ADA PARKING - VAN.
26. CURB OPENING, REFER TO CG-101 GRADING & DRAINAGE PLAN.
27. PROPOSED MOTORCYCLE PARKING.
28. SIDEWALK WITH TURNDOWN EDGE.
29. FLUSH CONCRETE SIDEWALK.
30. MINI SIGHT TRIANGLE AT DRIVEWAY.
31. DIRECTIONAL PAVEMENT ARROW.
32. SITE SIGNAGE - FIRE LANE SIGN.
33. SITE SIGNAGE - STOP SIGN.
34. SITE SIGNAGE - ONE WAY SIGN.
35. SITE SIGNAGE - PEDESTRIAN CROSSWALK SIGN.
36. SITE SIGNAGE - ADA VAN PARKING SIGN.
37. DOUBLE SWING VEHICULAR GATE.
38. SINGLE SWING VEHICULAR GATE.
39. DOUBLE ROLLING VEHICULAR GATE.
40. ROADWAY STRIPING - TRAFFIC CONTROL STRIPING
41. PHASE I & PHASE 2 LIMITS

NOTE:
ALL BROKEN OR CRACKED CONCRETE ON SITE
MUST BE REMOVED AND REPLACED

Albuquerque Control Survey Monument
"ACS 4-L22"
New Mexico State Plane Coordinates
Central Zone (NAD 83)
N= 1,480,509.445 U.S. Survey feet
E= 1,563,610.492 U.S. Survey feet
Ground to grid factor= 0.999643379
Delta Alpha= -00°08'50.94"

SOLID WASTE APPROVAL

DATE

M:\PROJECTS\2700--2799\2702\DWG\ - BUILDING PERMIT PLANS\2702 CP-501.dwg JAN 7/29/2025 3:30 PM

PCC CORNER CONCRETE

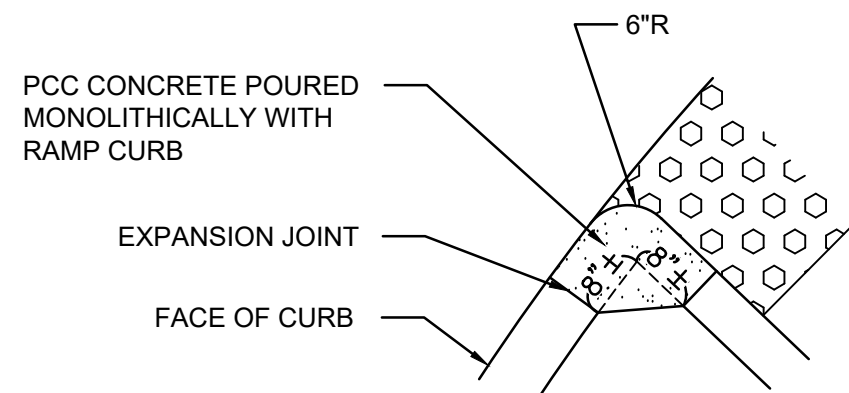

SCALE: 1"=2'

ACCESSIBLE RAMP "B"

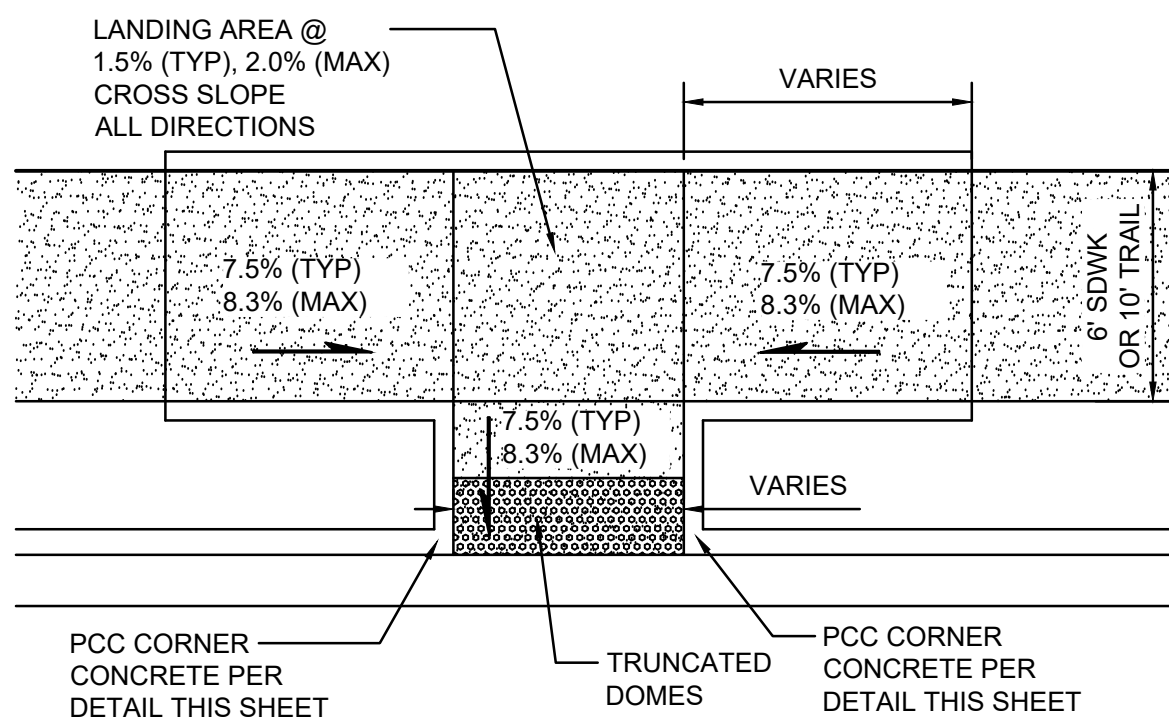

SCALE: 1"=5'

CURB OPENING

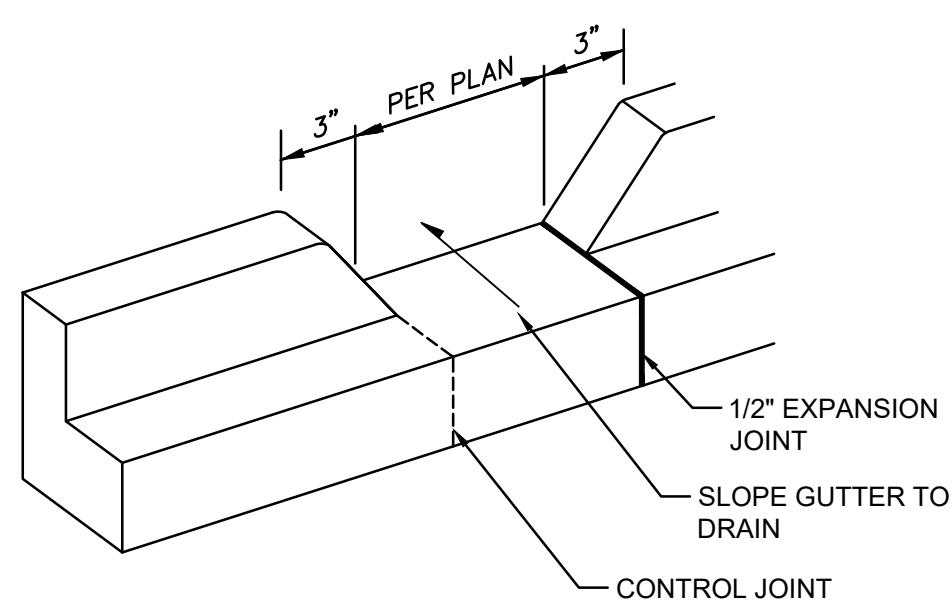

SCALE: N.T.S.

END ISLAND WITH WALK RAMP "C"

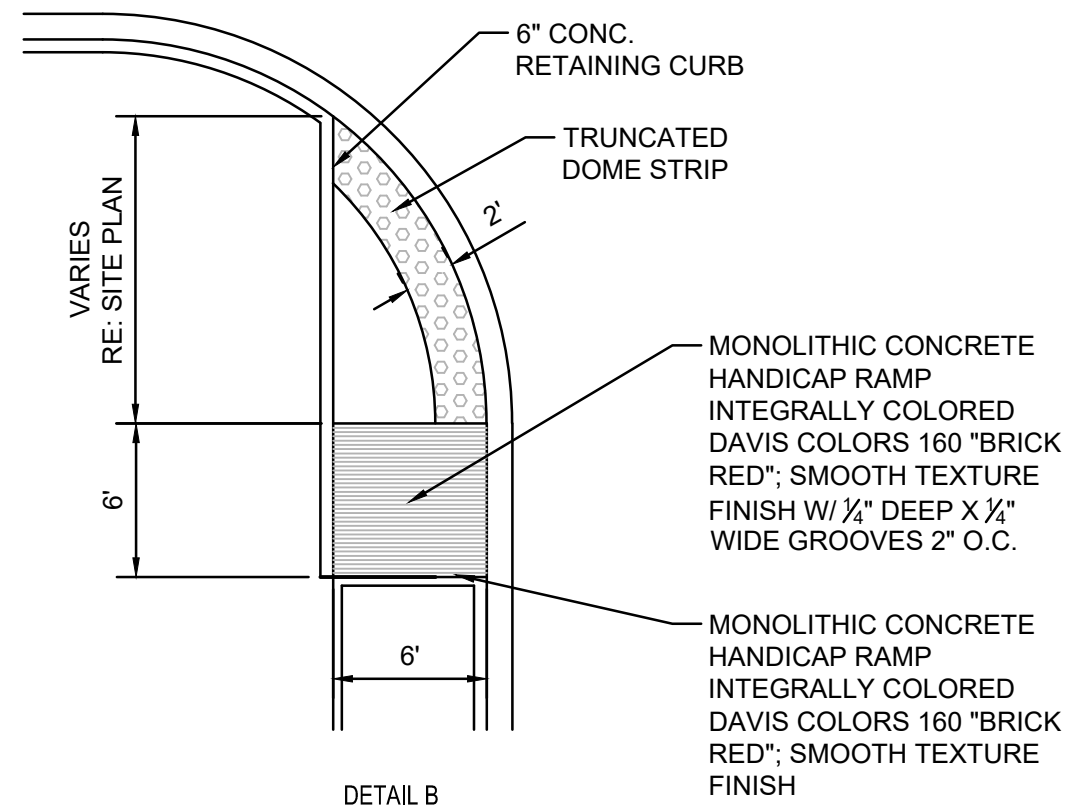

SCALE: N.T.S.

CONCRETE WHEEL STOP

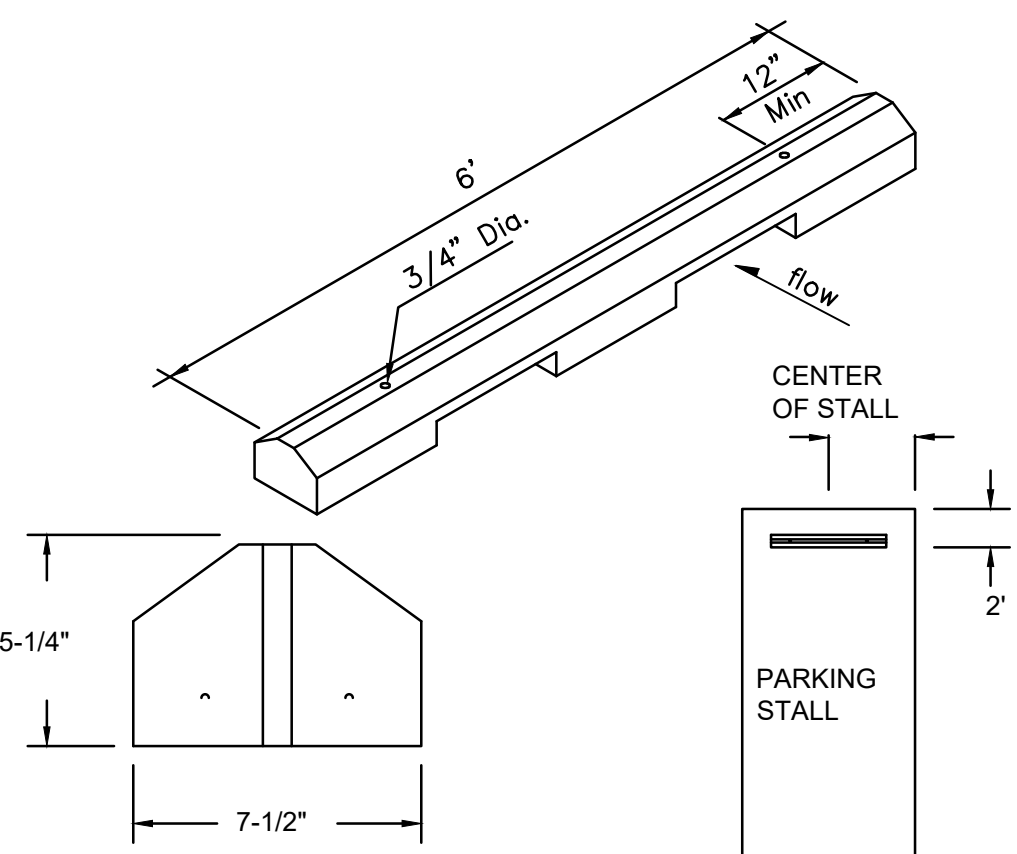

- GENERAL NOTES
1. WHEEL STOPS TO BE PLACED 2' BACK, CENTERED IN THE PARKING STALL. WHEEL STOPS CAN BE PAINTED IN A CONTRASTING COLOR SUCH AS GRAY, YELLOW OR BLACK.
 2. BLUE SHALL BE USED FOR HANDICAP PARKING STALLS.
 3. INSTALL EACH WITH TWO DOWELS PER MANUFACTURERS SPECIFICATIONS.

SCALE: N.T.S.

BASE COURSE PAVING SECTION

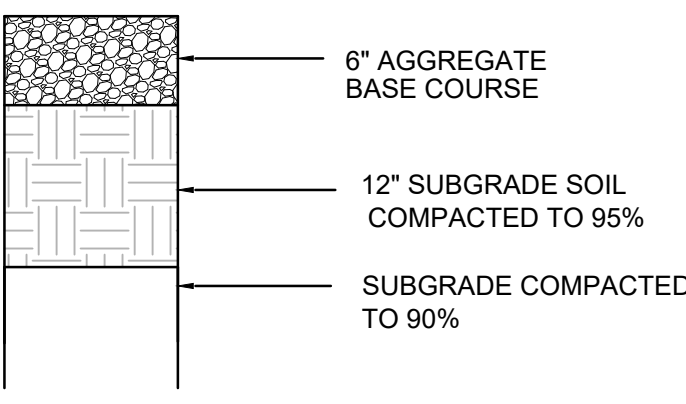

PER GEOTECHNICAL REPORT PAVING DESIGN SCALE: N.T.S.

CONCRETE PAVING SECTION

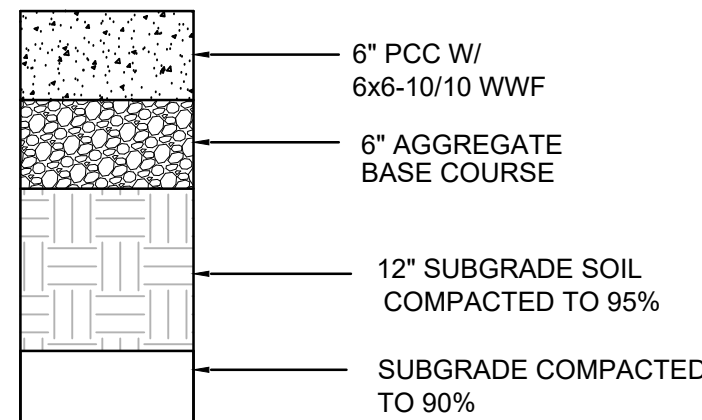

PER GEOTECHNICAL REPORT PAVING DESIGN SCALE: N.T.S.

ASPHALT PAVEMENT SECTIONS

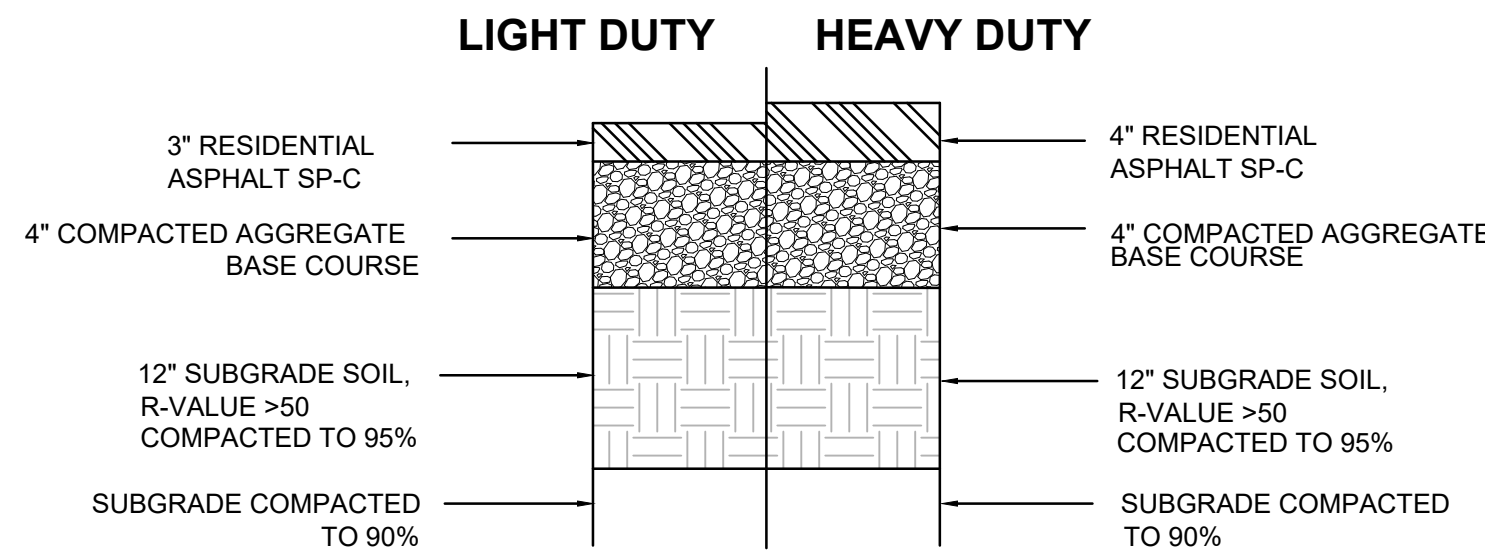

SCALE: N.T.S.

DIRECTIONAL CURB RAMP "A"

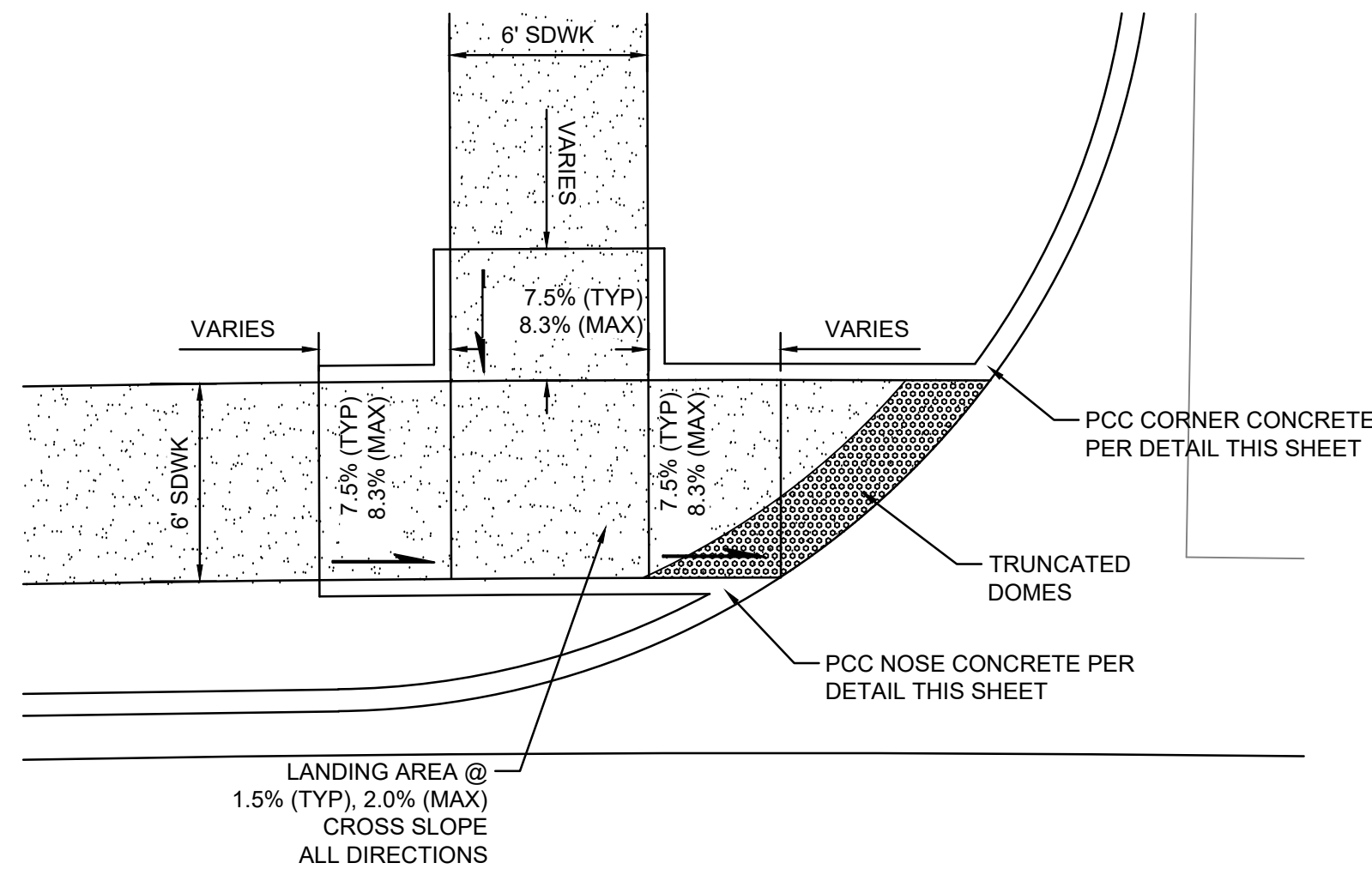

SCALE: N.T.S.

Dekker

NOT FOR CONSTRUCTION

NMSBVI ABQ Preschool Addition and Reno Phase I Site Improvement & Phase II Cafeteria/Multipurpose Facility

801 Stephen Moody SE
Albuquerque, NM 87123

90%
CONSTRUCTION
DOCUMENTS

REVISIONS

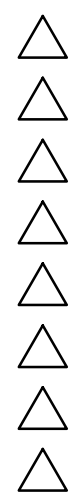

DRAWN BY BJB / DC

REVIEWED BY IMNA

DATE 07/30/2025

PROJECT NO 22-0220.002 / IAR2702

DRAWING NAME

PAVING
DETAILS

SHEET NO

CP501

- NOTES:
1. STRIPE CROSSWALK. SEE B4/AS501.
2. SEE A6/AS501 FOR CROSSWALK JOINTING.
3. DETECTABLE WARNING SURFACE IS REQUIRED ON BOTH SIDES OF RAISED CROSSINGS. SEE PLANS FOR LOCATION AND B1/AS501.

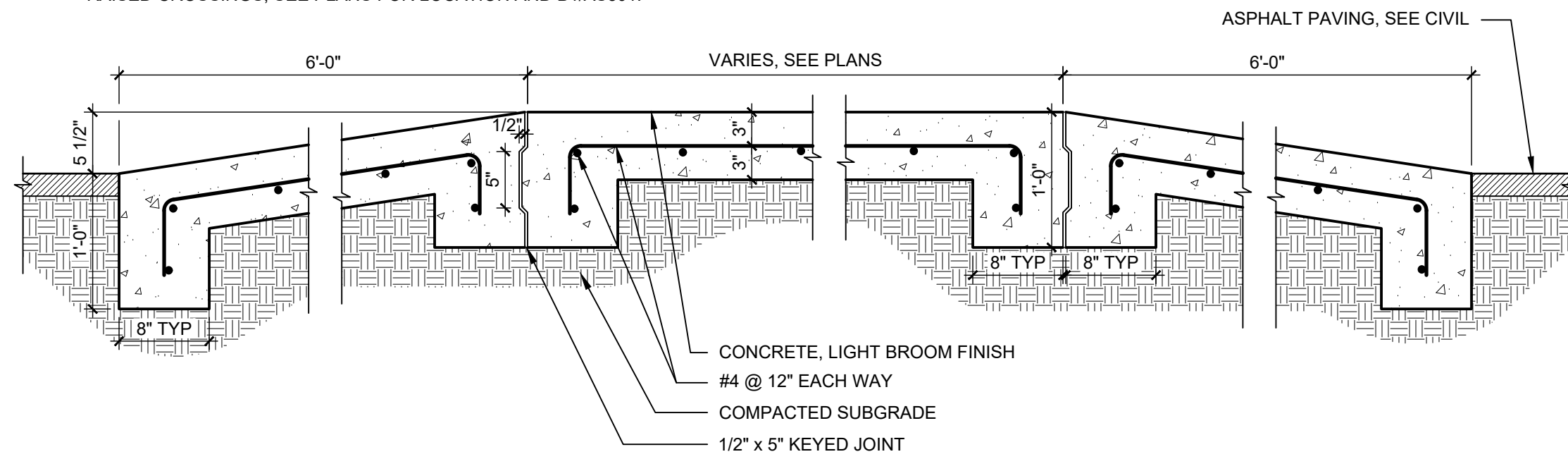

E1 RAISED PEDESTRIAN CROSSWALK

1" = 1'-0"

0 1/2' 1' 2'

- NOTES:
1. ALL SIGNS WILL HAVE THE SAME POLE AND FOOTING AS THE SITE SIGN SHOWN.
2. HEIGHT TO BOTTOM OF SIGN PER ANSI 502.7 AND MUTCD IS 84" ABOVE FINISH GRADE.

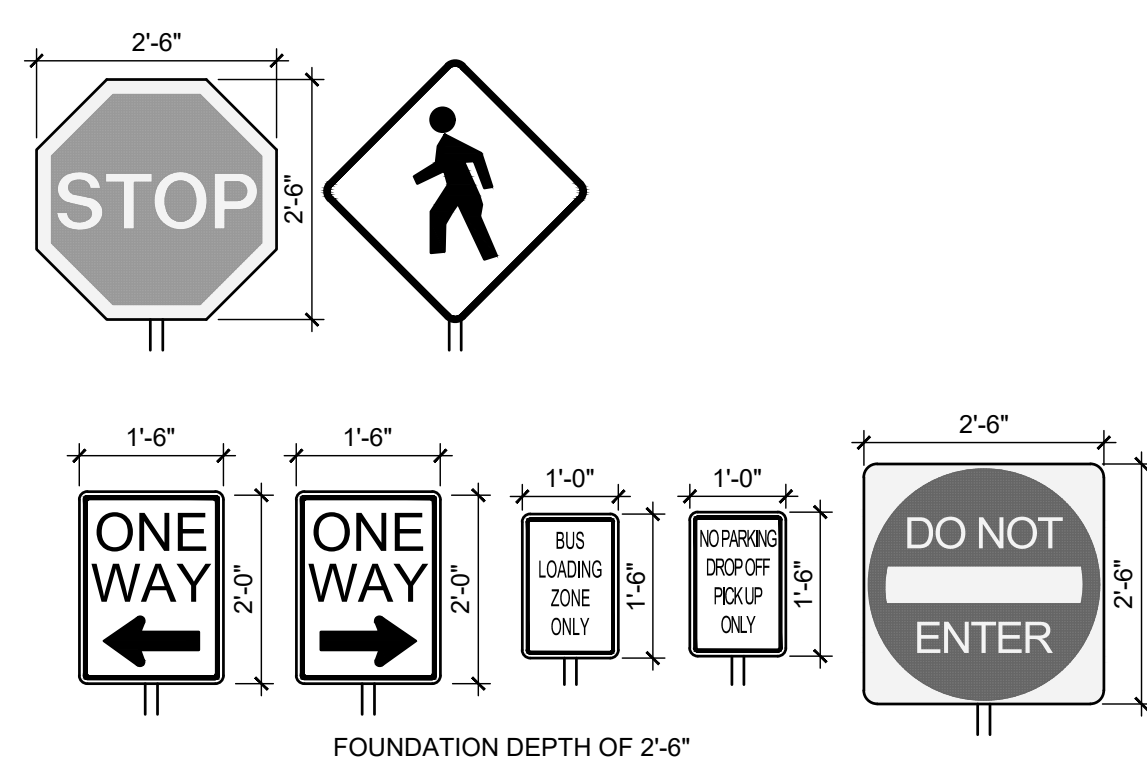

D1 SITE SIGNAGE

1/2" = 1'-0"

0 1' 2' 4'

- NOTES:
1. PAINT ARROWS WHERE SHOWN ON PLANS. COLOR: WHITE.
2. WHERE CONDITION OCCURS IN RIGHT OF WAY, USE REFLECTIVE PAINT.

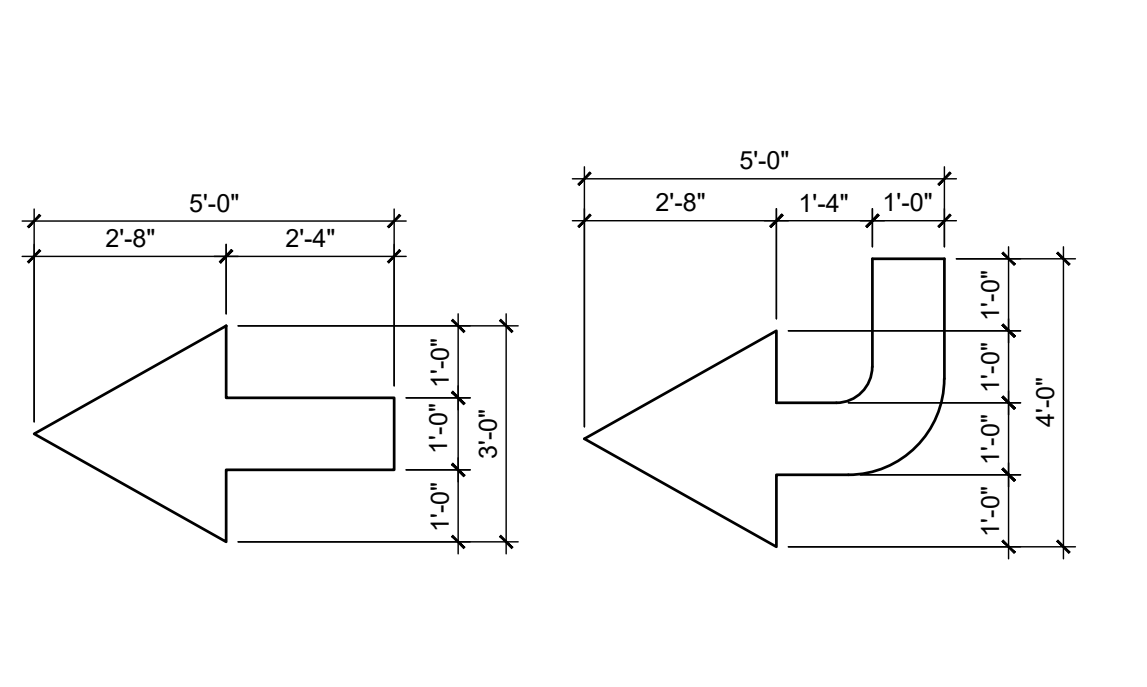

C1 DIRECTIONAL PAVEMENT ARROW

3/8" = 1'-0"

0 2' 4' 6'

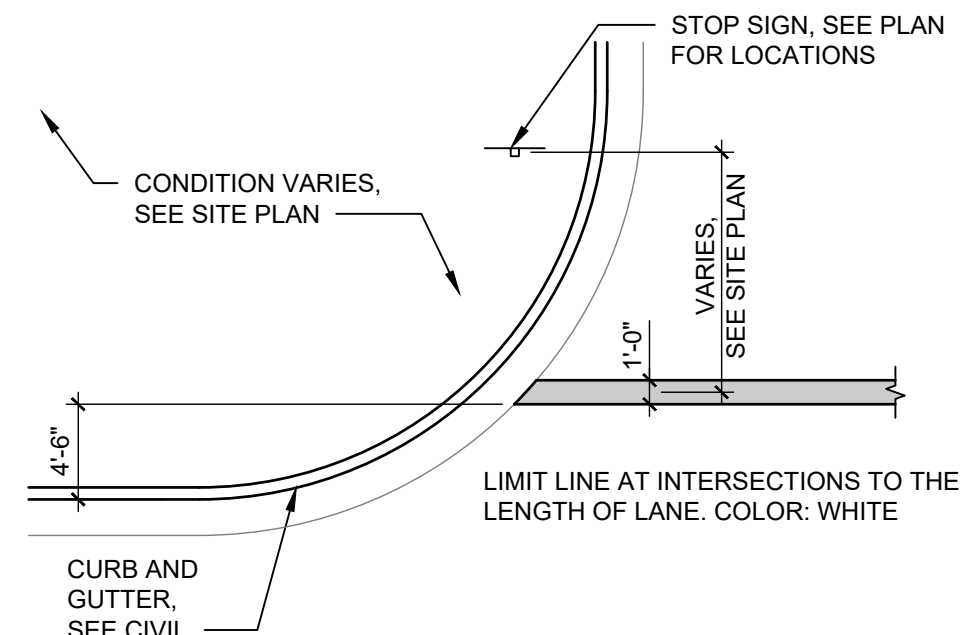

C2 STOP LINE PAVEMENT STRIPING

1/8" = 1'-0"

0 4' 8' 16'

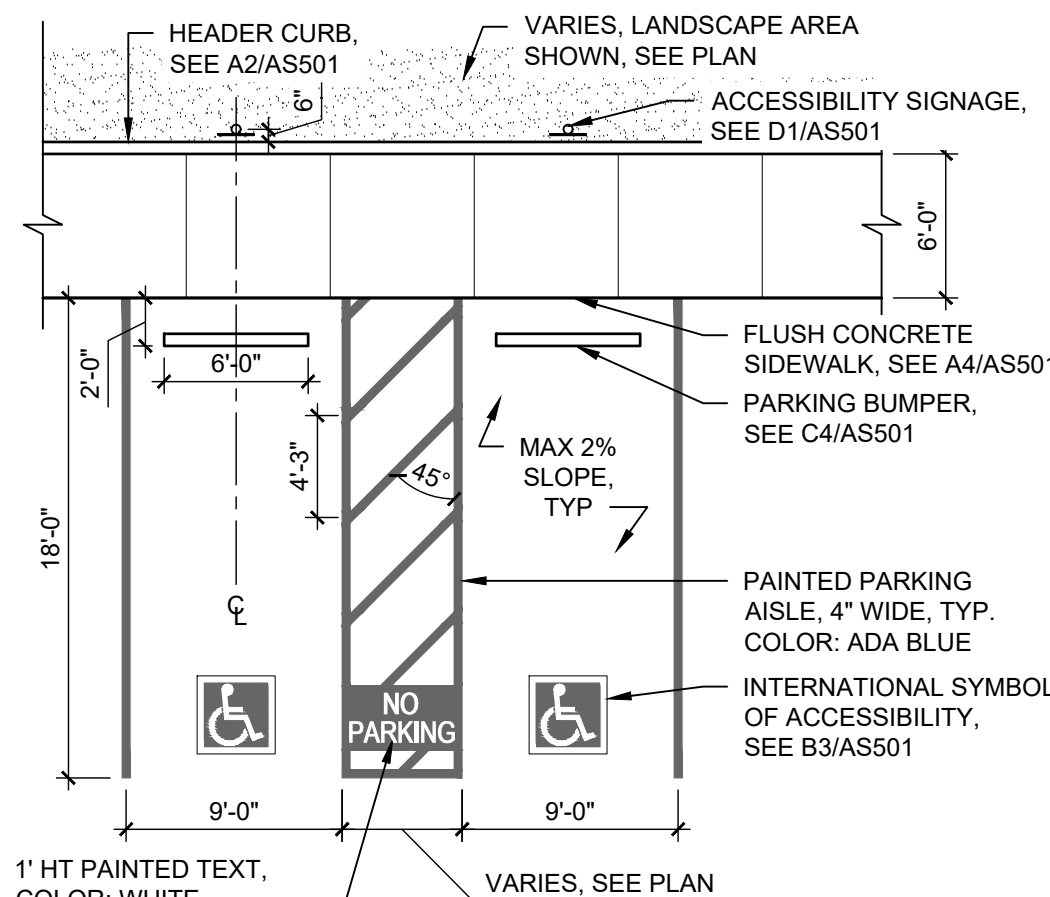

D3 ACCESSIBLE PARKING

1/8" = 1'-0"

0 4' 8' 16'

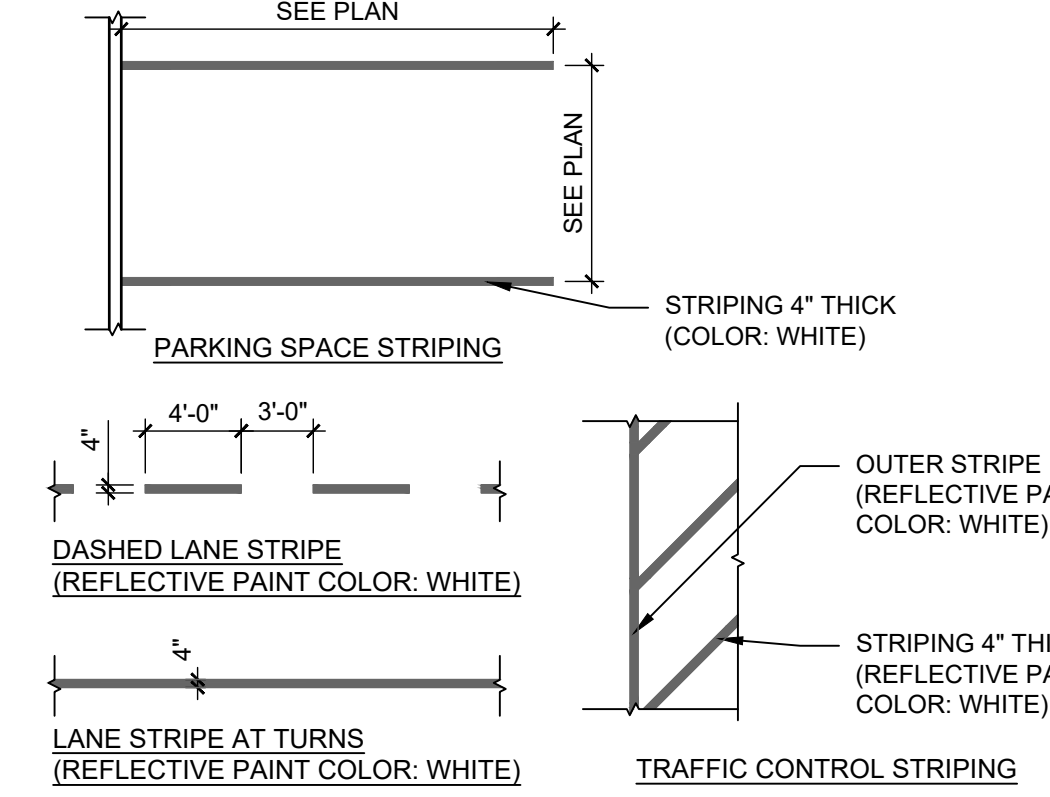

C3 ROADWAY STRIPING

1/8" = 1'-0"

0 4' 8' 16'

- NOTES:
1. JOINTING SHALL REFLECT THE JOINTING OF ADJACENT FLATWORK. SEE PLANS.
2. CREATE SMOOTH TRANSITION FROM ROLL CURB BACK TO REGULAR CURB.
3. CAST-IN-PLACE CONCRETE. LIGHT BROOM FINISH, WITH 1/2" RADIUS ON EXPOSED EDGES.

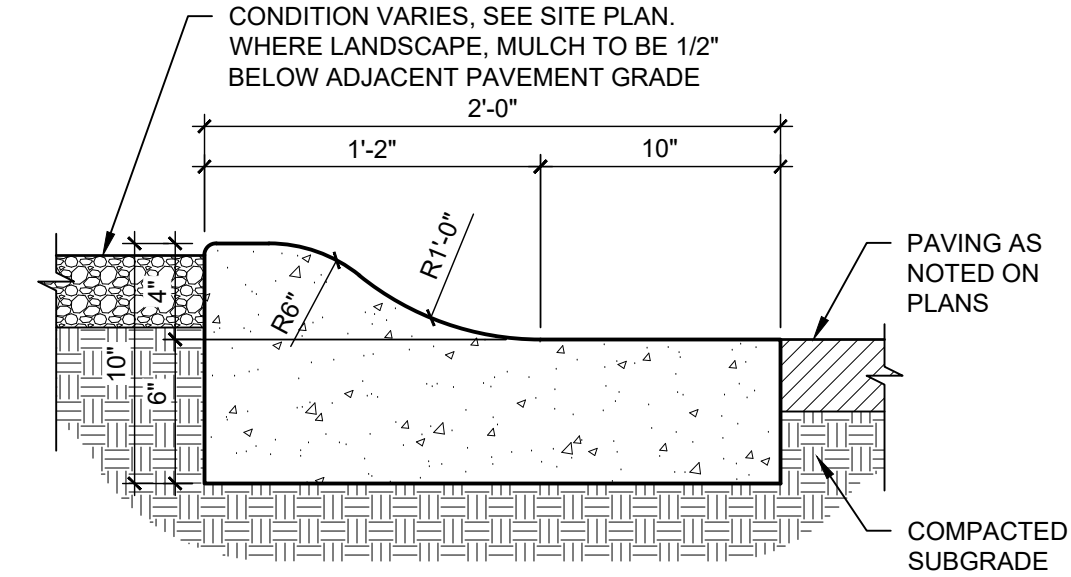

D4 CONCRETE MOUNTABLE CURB

1 1/2" = 1'-0"

0 1/2' 1' 1 1/2'

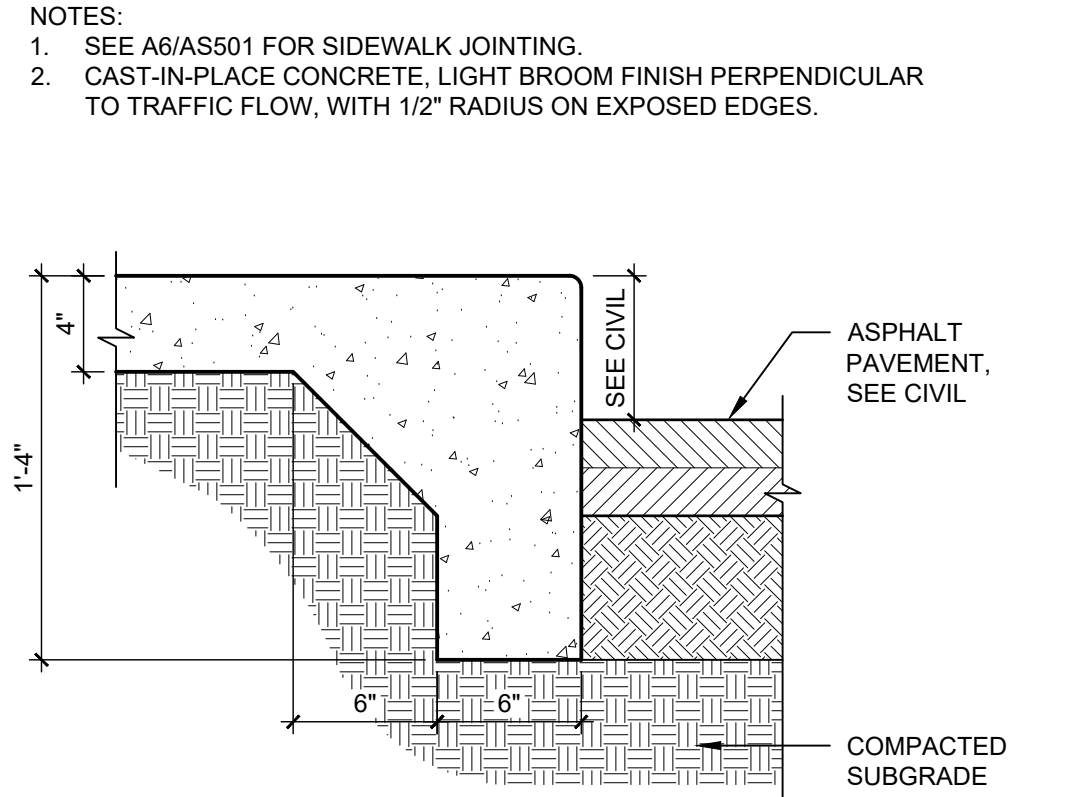

C4 SIDEWALK WITH TURNDOWN EDGE

1 1/2" = 1'-0"

0 1/2' 1' 1 1/2'

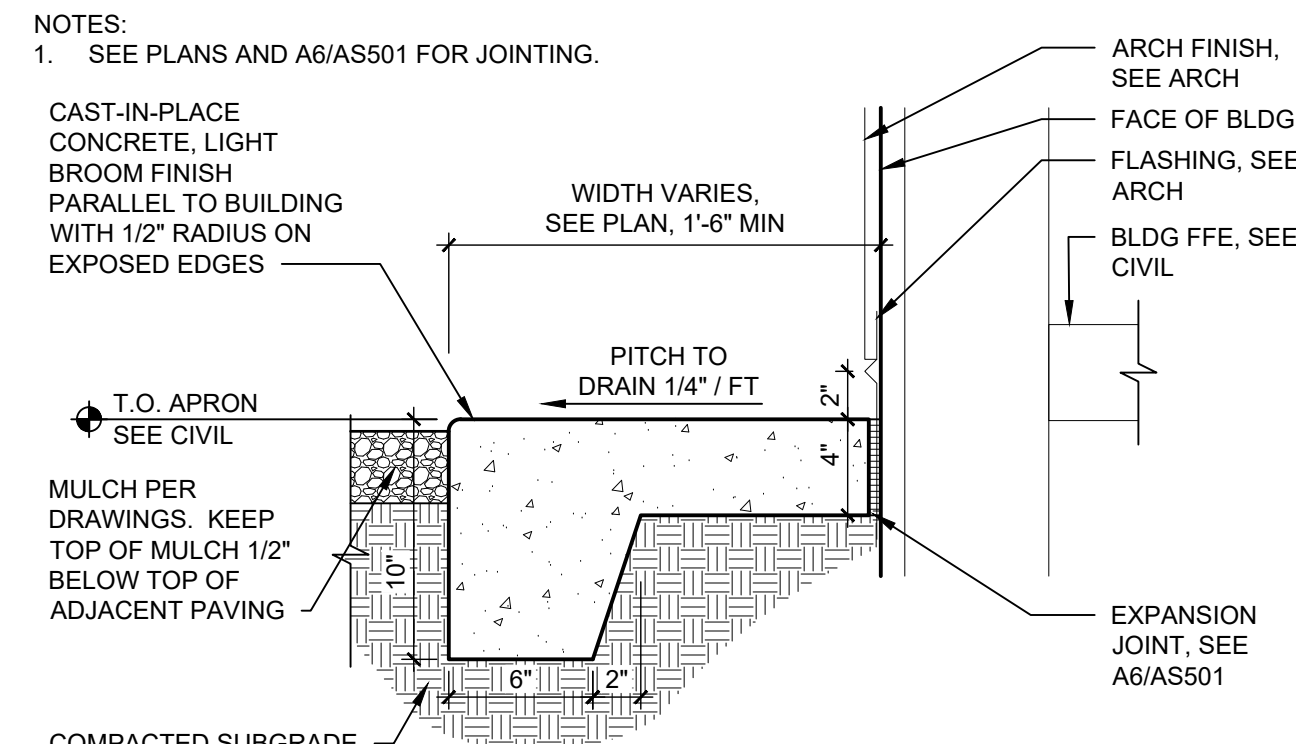

C5 CONCRETE BUILDING APRON

1 1/2" = 1'-0"

0 1/2' 1' 1 1/2'

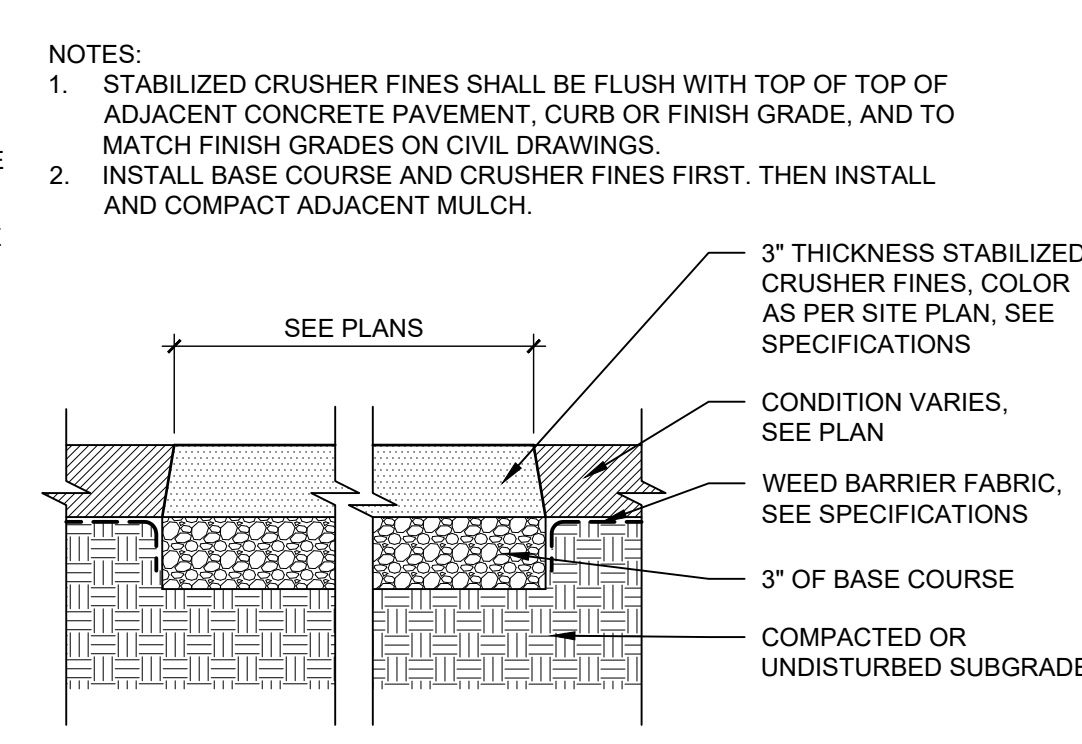

C6 STABILIZED CRUSHER FINES

1 1/2" = 1'-0"

0 1/2' 1' 1 1/2'

- NOTES:
1. SEE SPECIFICATIONS FOR MANUFACTURER AND COLOR.
2. INSTALL PER MANUFACTURER'S DETAILS AND SPECIFICATIONS.

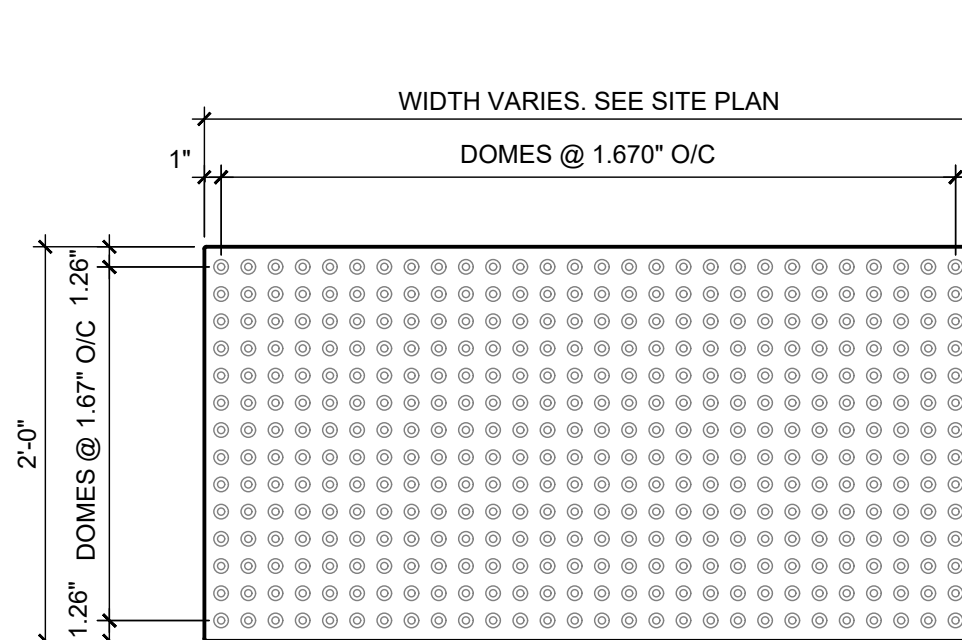

B1 DETECTABLE WARNING SURFACE

1" = 1'-0"

0 1/2' 1' 2'

- NOTES:
1. SEE PLANS FOR EXTENTS OF CURB PAINT.

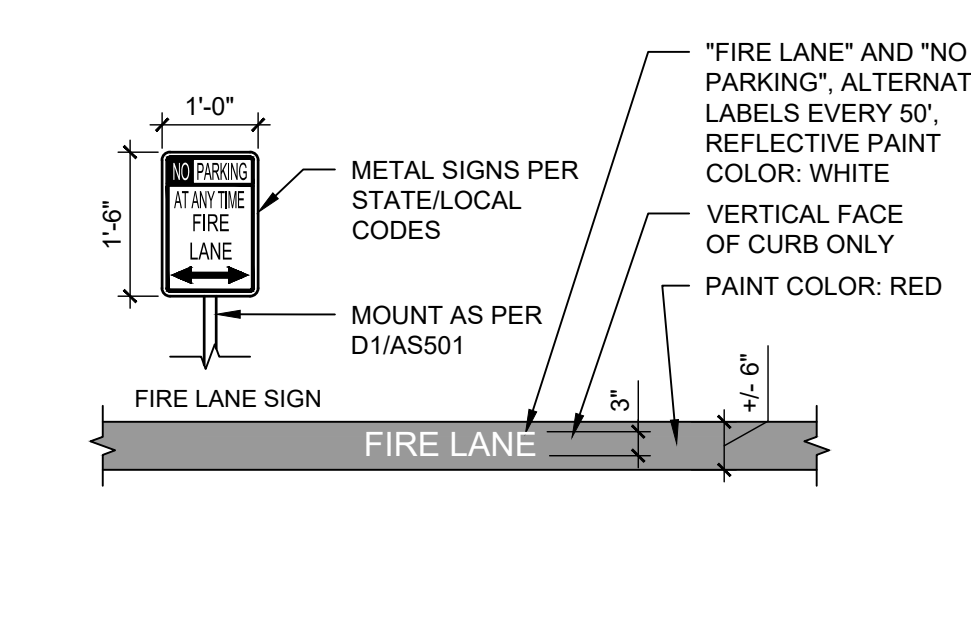

B2 FIRELANE STRIPING AND SIGNAGE

1/2" = 1'-0"

0 1' 2' 4'

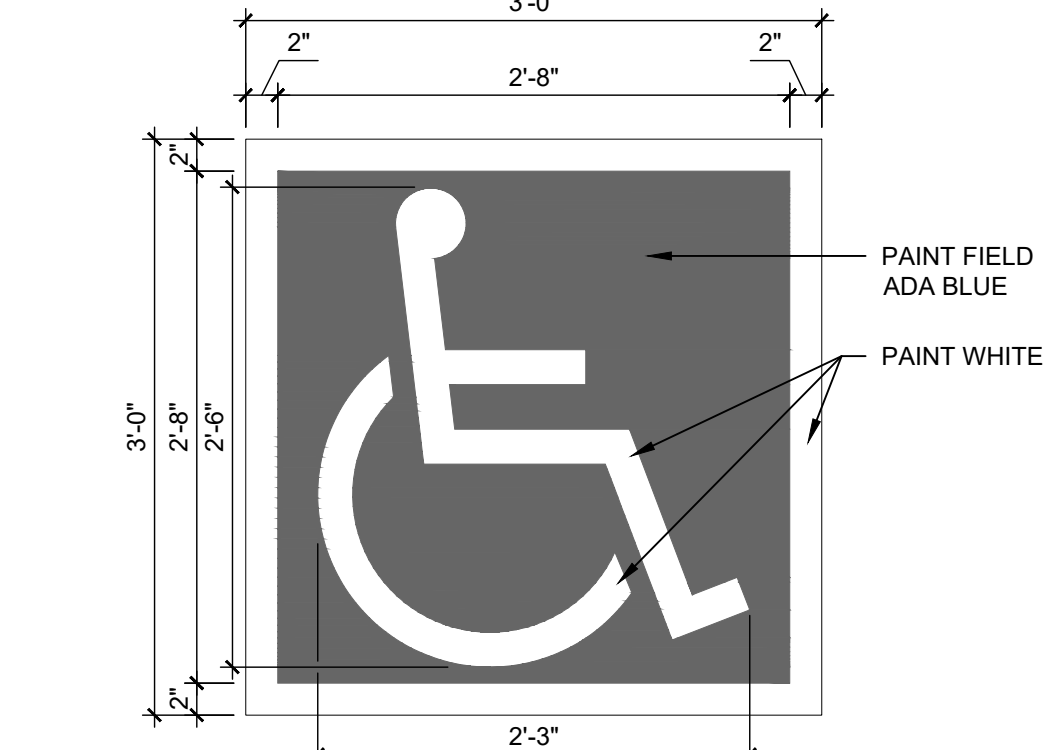

B3 ACCESSIBLE PAVEMENT MARKING

1" = 1'-0"

0 1/2' 1' 2'

- NOTES:
1. WHEN CONDITION OCCURS IN RIGHT OF WAY USE REFLECTIVE PAINT.

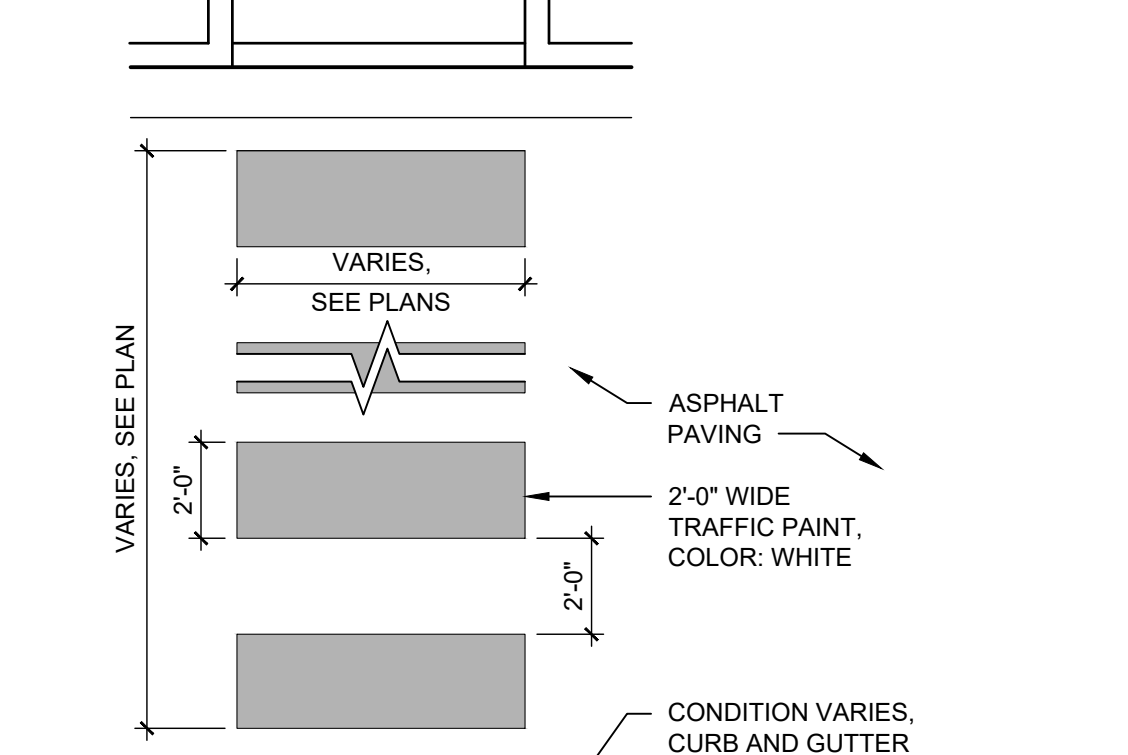

B4 PAINTED CROSSWALK

1/4" = 1'-0"

0 2' 4' 8'

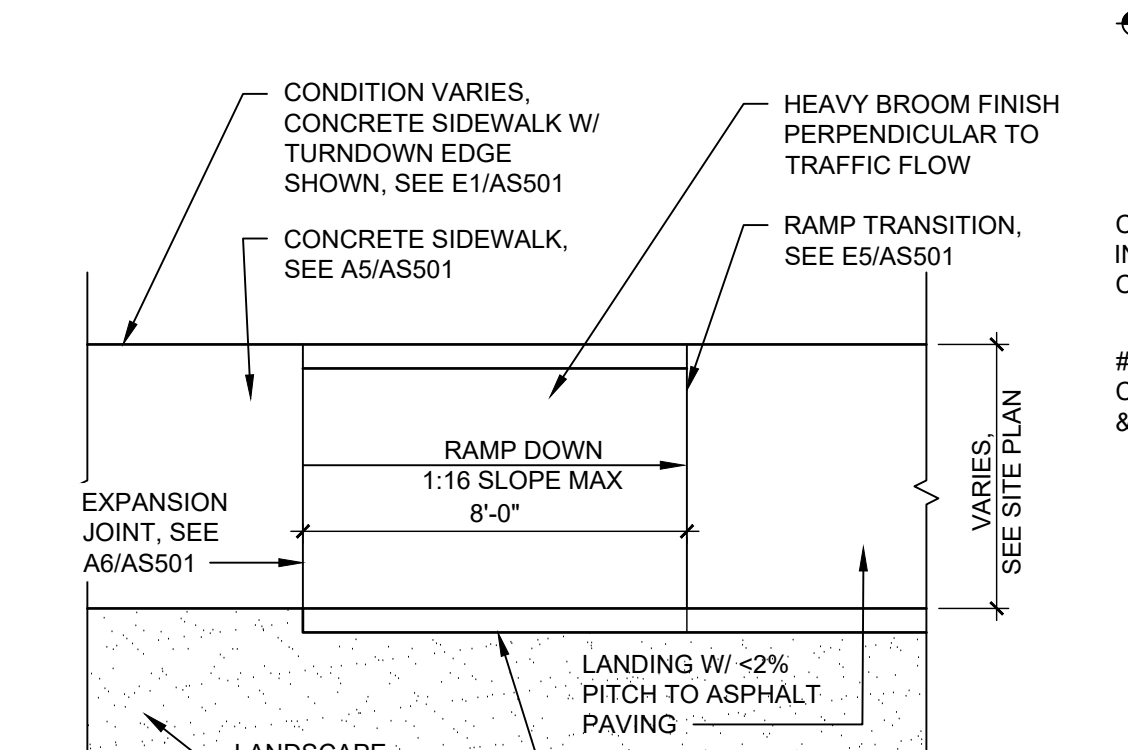

B5 ACCESSIBLE RAMP - TYPE A

1/4" = 1'-0"

0 2' 4' 8'

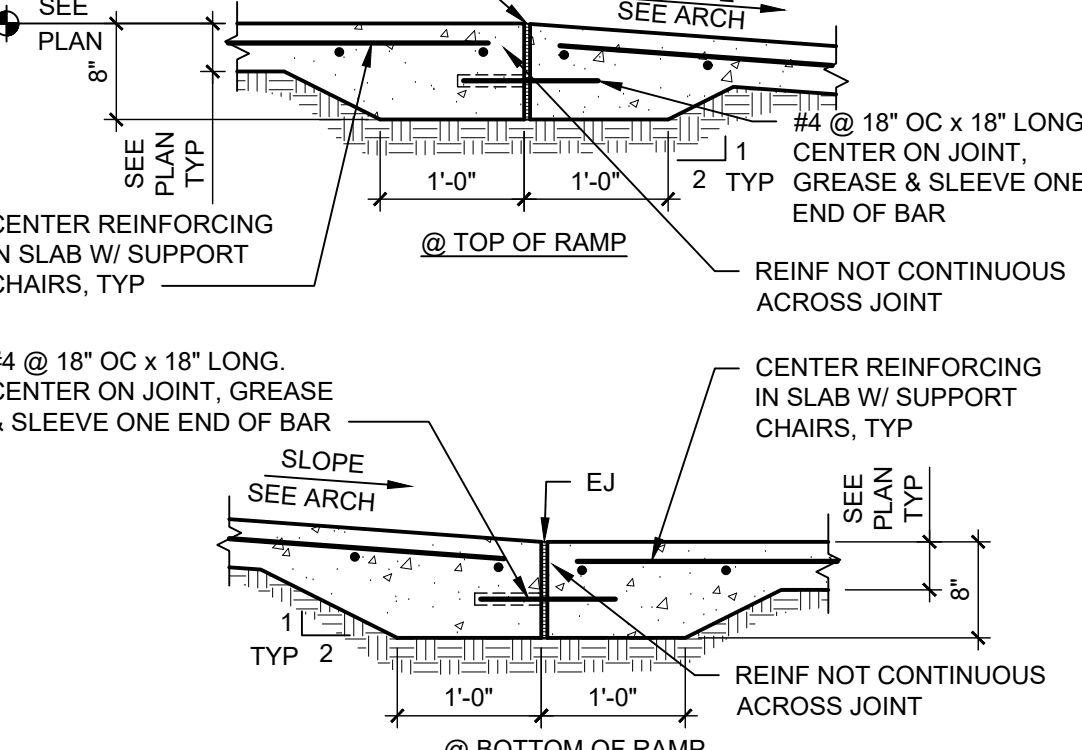

B6 TYP CONSTRUCTION JOINT @ RAMP LANDING EDGES

3/4" = 1'-0"

0 1' 2' 4' 8'

- NOTES:
1. WHERE BACK OF CURB AND GUTTER IS EXPOSED ALONG A RAMP, ADD 1/2" RADIUS ON EXPOSED EDGES.
2. CAST-IN-PLACE CONCRETE. LIGHT BROOM FINISH, WITH 1/2" RADIUS ON EXPOSED EDGES.

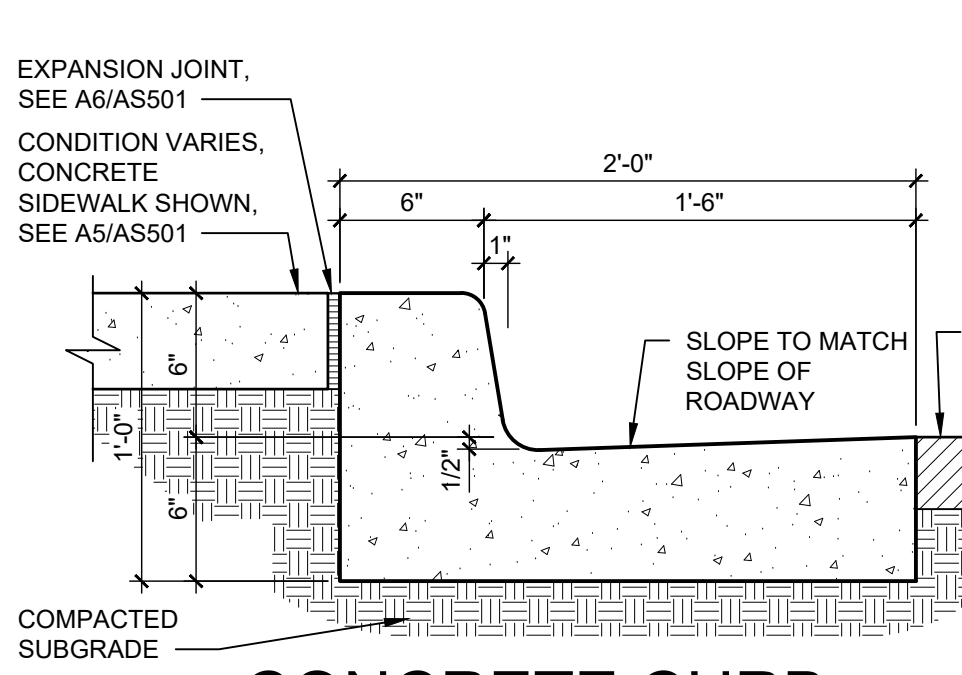

A1 CONCRETE CURB & GUTTER

1 1/2" = 1'-0"

0 1/2' 1' 1 1/2'

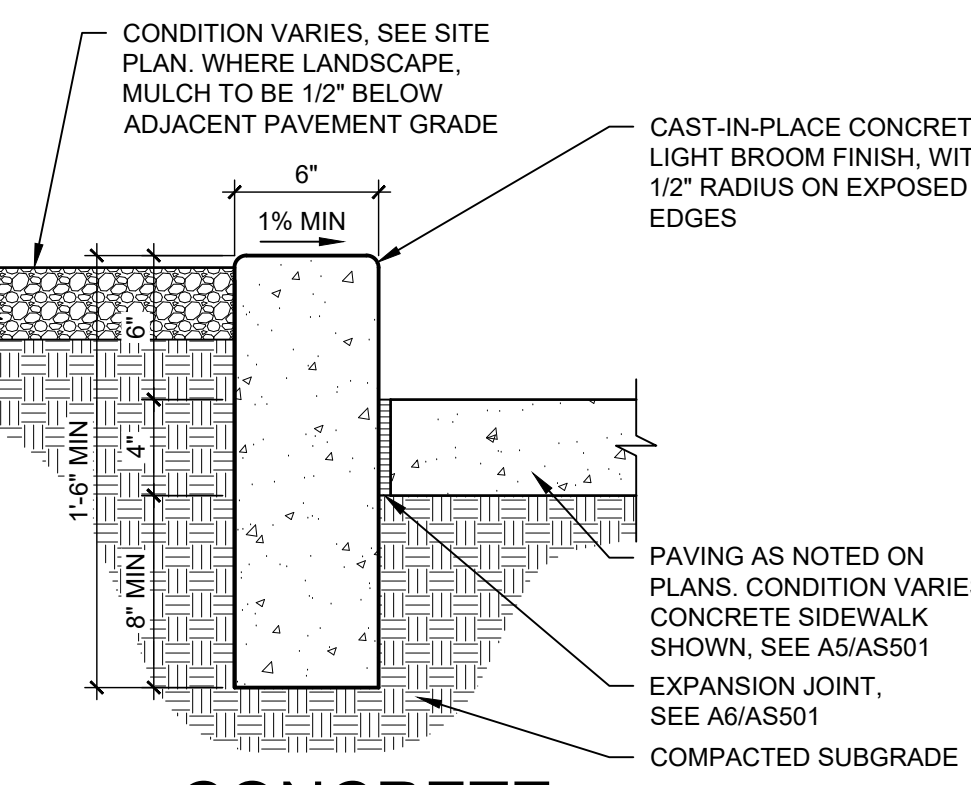

A2 CONCRETE HEADER CURB

1 1/2" = 1'-0"

0 1/2' 1' 1 1/2'

- NOTES:
1. JOINTING SHALL REFLECT THE JOINTING OF ADJACENT FLATWORK. SEE PLANS.
2. CREATE SMOOTH TRANSITION FROM ROLL CURB BACK TO REGULAR CURB.
3. CAST-IN-PLACE CONCRETE. LIGHT BROOM FINISH, WITH 1/2" RADIUS ON EXPOSED EDGES.

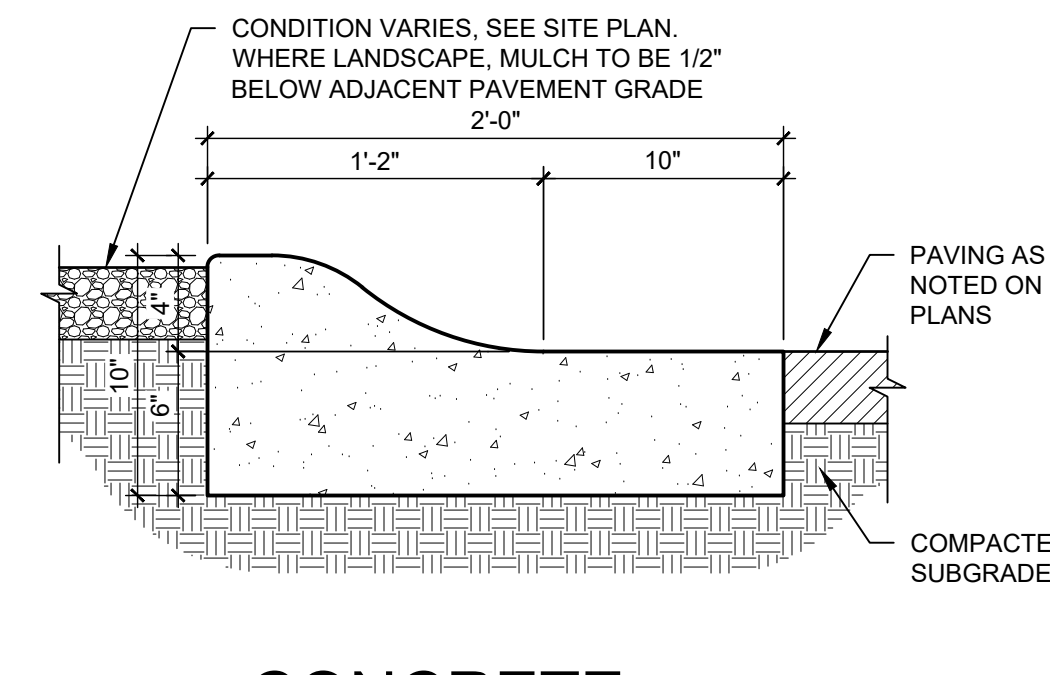

A3 CONCRETE MOUNTABLE CURB

1 1/2" = 1'-0"

0 1/2' 1' 1 1/2'

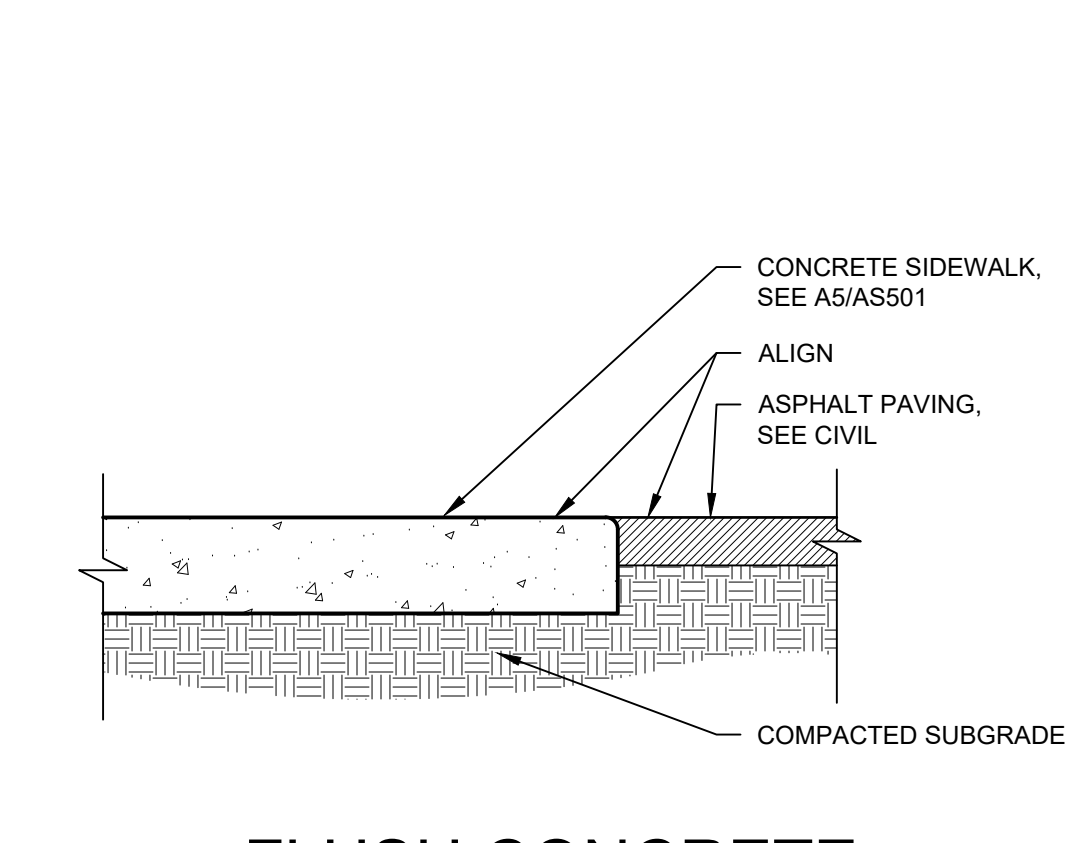

A4 FLUSH CONCRETE SIDEWALK

1 1/2" = 1'-0"

0 1/2' 1' 1 1/2'

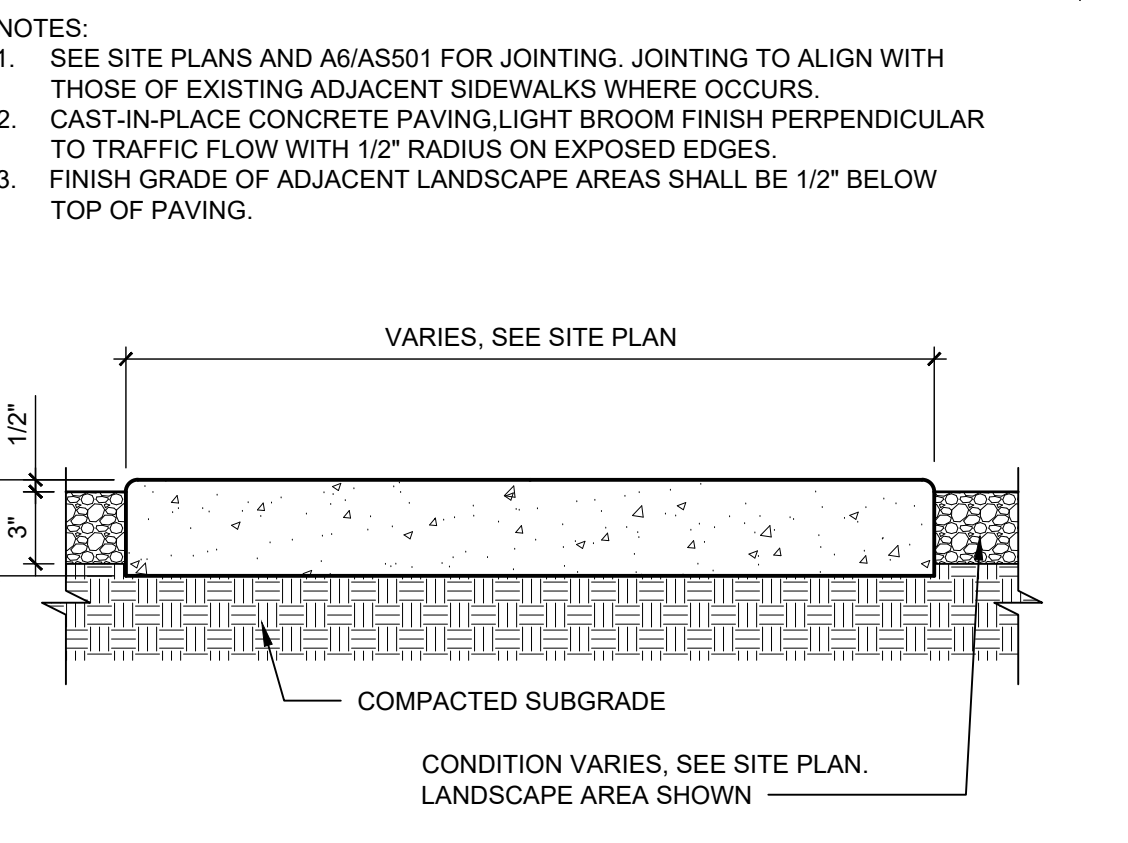

A5 CONCRETE SIDEWALK

1 1/2" = 1'-0"

0 1/2' 1' 1 1/2'

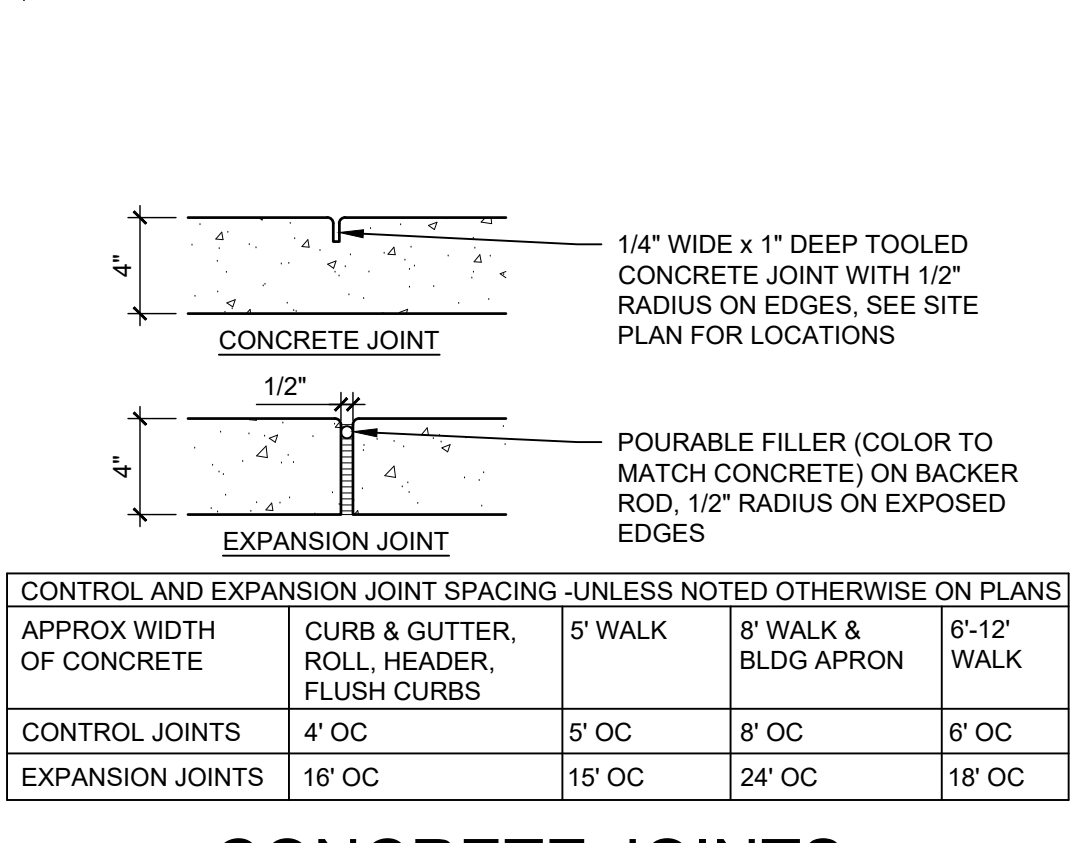

A6 CONCRETE JOINTS & JOINT SPACING

1 1/2" = 1'-0"

0 1/2' 1' 1 1/2'

CONTROL AND EXPANSION JOINT SPACING - UNLESS NOTED OTHERWISE ON PLANS				
APPROX WIDTH OF CONCRETE	CURB & GUTTER, ROLL, HEADER, FLUSH CURBS	5' WALK	8' WALK & BLDG APRON	6'-12" WALK
CONTROL JOINTS	4' OC	5' OC	8' OC	6' OC
EXPANSION JOINTS	16' OC	15' OC	24' OC	18' OC

