

PROJECT NARRATIVE

PROJECT CONSISTS OF CONSTRUCTING A CHURCH FACILITY WITH PARTIAL BASEMENT. CONSTRUCTION CONSISTS OF WOOD FRAMED WALLS AND WOOD TRUSSES. EXTERIOR FINISHES STUCCO WITH STONE VENEER WALLS, AND METAL ROOF SYSTEM.

DEFERRED SUBMITTALS:

A. FIRE PROTECTION SPRINKLER DRAWINGS AND DETAILS TO BE SUBMITTED TO CITY AS A SEPARATE PERMIT BY CONTRACTOR

INTERNATIONAL FIRE CODE 2019

TABLE 105.1 MINIMUM FIRE FLOW & DURATION:
TYPE VB - 4,801-6,200 SF = FIRE FLOW 2,000 GPM, DURATION 2 HOURS

B105.2 BUILDINGS OTHER THAN ONE- AND TWO-FAMILY DWELLINGS:
REDUCTION IN FIRE-FLOW BLDG. PROVIDED WITH APPROVED AUTOMATIC SPRINKLER SYSTEM: = FIRE FLOW 2,000 GPM/75 1,500 GPM DURATION -2 HOURS

SEC. B105.2
TABLE C105.1 NO. AND DISTRIBUTION FIRE HYDRANTS:
FIRE FLOW REQUIREMENT 1,750- OR LESS GPM MIN. 1 HYDRANT PER 1,500 GPM DURATION -2 HOURS

500' AVERAGE SPACING BETWEEN HYDRANTS, MAX. DISTANCE FROM ANY ONE POINT ON STREET OR ROAD FRONTAGE TO HYDRANT 250 FT

NO. HYDRANTS PROVIDED: (1) FIRE HYDRANT (BUILDING FULLY SPRINKLED)

LEGAL DESCRIPTION

TRACT B-1 & TRACT B-2; BLOCK 2; WELLS SANDIA MANOR; SECTION 26; TOWNSHIP 10 NORTH, RANGE 4 EAST, N.M.O.M. ALBUQUERQUE, BERNALILLO COUNTY, NEW MEXICO



INTERNATIONAL FIRE MARSHAL'S DIVISION OFFICE PLANS CHECKING DIVISION

PERMIT

PERMIT NUMBER: 21-005540

APPROVED DATE: 03/09/21

APPROVED

ALLOWABLE BLDG. HEIGHT: 30.0 FEET

ALLOWABLE BLDG. AREA: 5,034 S.F.

20'-10" FIN. GRADE

2-STORY - SPRINKLERED

24,000 S.F.

10'x30' TYPE VB SPRINKLED

5,034 S.F. (MAIN BLDG.)

2,533 S.F. (BASEMENT)

7,567 S.F. TOTAL

OCCUPANT LOAD (TABLE 1004.1.2.):

A3 - WORSHIP 108 FIXED SEATS = 112 OCC.

FOYER 1,520 S.F. / 15 = 101 OCC.

B-TRAINING & SKILLS 2,533 S.F./300 = 8 OCC.

TOTAL OCCUPANTS FOR WORSHIP SERVICE = 221 OCC.

SITE DATA

PROPERTY 47,108 SF (1.0814 AC)

BUILDING 5,034 SF (11%)

PARKING/PAVING 16,906 SF (36%)

LANDSCAPE 25,202 SF (53%)

- LIFE SAFETY GENERAL NOTES
- A. PREMISE IDENTIFICATION - SHALL BE MINIMUM 4 INCHES HIGH x .5 INCH WIDE AND SHALL CONTRAST WITH THEIR BACKGROUND AND SHALL BE VISIBLE FROM THE STREET OR ROAD FRONTING THE PROPERTY.
- B. GENERAL CONTRACTOR TO PROVIDE AND INSTALL KNOX BOX. KNOX BOX TO BE INSTALLED IN AN ACCESSIBLE LOCATION AND BE MOUNTED NO HIGHER THAN 6'-0" ABOVE FINISH FLOOR. THE KNOX BOX SHALL BE OF AN APPROVED TYPE LISTED IN ACCORDANCE WITH UL 1037, AND SHALL CONTAIN KEYS TO GAIN ACCESS TO BUILDING AND FIRE RISER ROOM. FINAL LOCATION TO BE APPROVED BY THE FIRE MARSHALL.
- C. FIRE PROTECTION SPRINKLER SYSTEMS SHALL BE DEFERRED SUBMITTALS AND SHALL BE NOTED AS SUCH ON THE PLAN. G.C. TO SUBMIT SHOP DRAWINGS TO THE FIRE MARSHALL OFFICE FOR REVIEW AND APPROVAL OF ANY INSTALLATION OR MODIFICATION TO THE FIRE SPRINKLER SYSTEM, FIRE ALARM SYSTEM, ANY OTHER FIRE RELATED SYSTEM. THE FIRE SPRINKLER SYSTEM WILL SUPERVISED WHEN REQUIRED BY THE 2015 INTERNATIONAL FIRE CODE.
- D. G.C. TO PROVIDE FIRE EXTINGUISHERS 2A-10-BC, 1 PER EACH 3,000 S.F. FLOOR PLAN FOR QUANTITY, LOCATIONS AND TYPE.
- E. ALL PENETRATIONS THROUGH A FIRE RATED WALL ASSEMBLY TO BE FIRESTOPPED WITH THERMAFIBER AS MANUFACTURED BY THERMAFIBER, LLC, WABASH, 46992 OR OTHER APPROVED EQUAL.
- F. ALL EXIT SIGNS AND EMERGENCY LIGHTING SHALL HAVE BATTERY BACK-UP, REF: ELECTRICAL.

- KEYED NOTES
1. FIRE DEPARTMENT CONNECTION, 6" DIA. CONNECTION TO BLDG. NEAREST FIRE HYDRANT 276' AWAY
2. NEW FIRE HYDRANT PER 2019 IFC, APPENDIX C, SEC. C103, W/6" DIA. WATER LINE PREMISES IDENTIFICATION ADDRESS PER 2015 IFC, SEC. 505, VERIFY LOCATION WITH FIRE MARSHALL
3. "KNOX BOX" LOCATION PER FIRE MARSHALL'S APPROVAL
4. 6" HIGH WROUGHT IRON FENCING
5. 6" HIGH MOTORIZED SLIDING GATE
6. WROUGHT IRON GATE WITH "KNOX BOX"
7. CONC. STAIRS DOWN TO FIRE RISER ROOM
8. FIRE RISER ROOM W/STANDPIPE, BACKFLOW PREVENTION AND ALL OTHER EQUIP.
9. ELEC. POWER SUPPLY TO SLIDING GATE
10. FIRE DEPARTMENT POST INDICATOR VALVE
11. CURB TO PAINTED RED WITH WHITE LETTERS "NO PARKING - FIRE LANE" PER IFC 503.3
12. EXIST. WATER VALVE AND 12" DIA. WATER SERVICE LINE
13. EXIST. WATER MANHOLE
14. 28' TURNING RADIUS
15. BUILDING FULLY SPRINKLED CONTRACTOR TO PROVIDE SHOP DRAWINGS TO FIRE MARSHALL FOR REVIEW AND COMMENTS AS A SEPARATE PERMIT
16. FIRE APPARATUS ACCESS ROADS SHALL HAVE AN ASPHALT OR OTHER APPROVED DRIVING SURFACE SUPPORTING AT LEAST 75,000 LBS - SEE CIVIL
17. FIRE APPARATUS ROADS SHALL NOT EXCEED 10% IN GRADE - SEE CIVIL

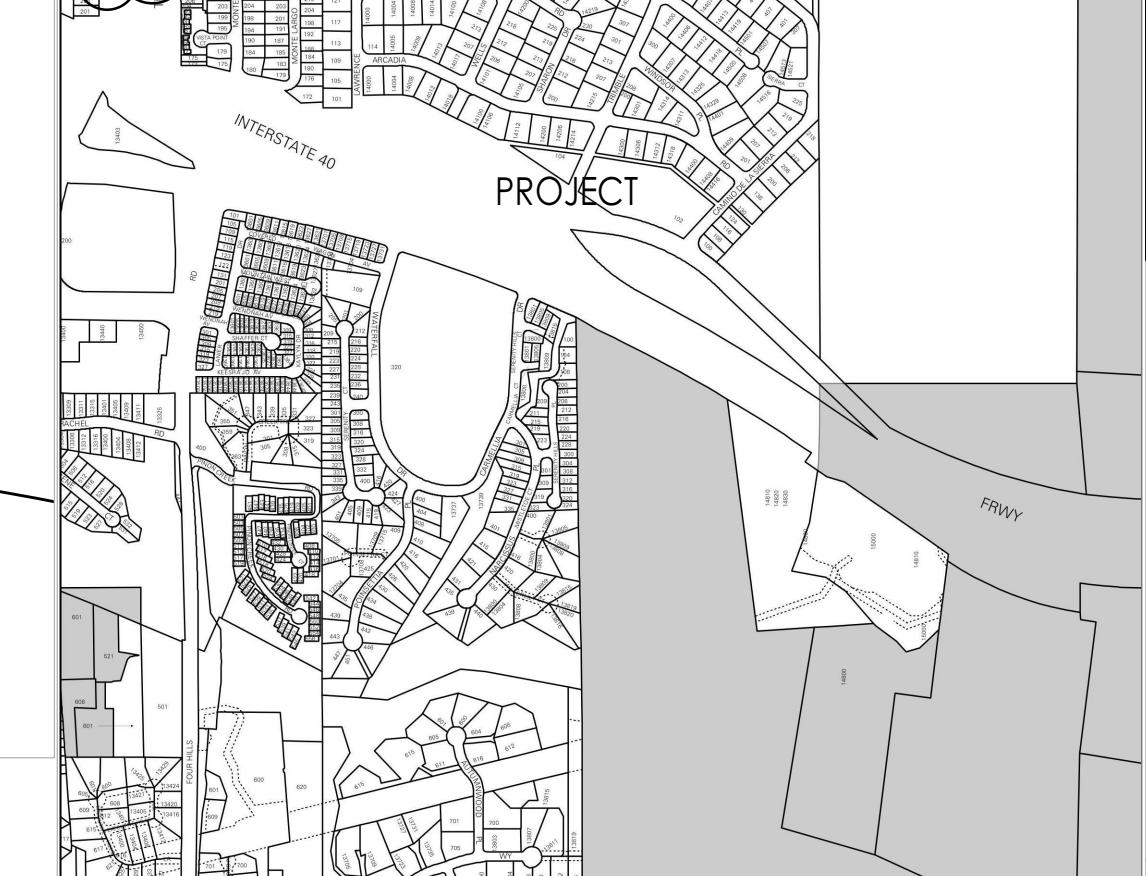

PARKING REQUIREMENTS

PARKING REQUIRED: 1 PER 4 SEATS, (WORSHIP SPACE)

PARKING REQUIRED: 1 PER 300 (BUSINESS/ TRAINING)

PARKING REQUIRED:

108 SEATS/4 = 27 SPACES

2533 S.F./300 = 8 SPACES

TOTAL = 35 SPACES (2 H.C.)

PARKING PROVIDED: 41 SPACES (2 H.C.) PROVIDED

MOTOR CYCLE PARKING 26-50 SPACES: 2 MOTOR CYCLE SPACES

BICYCLES: PARKING SPACES 41 x 10%: 4 BICYCLES

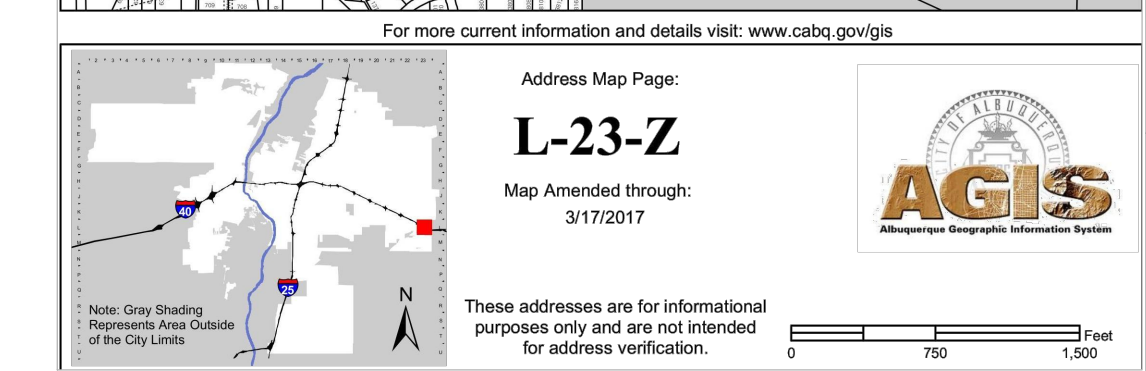

CHURCH OF CHRIST

FIRE SITE PLAN

102 CAMINO DE LA SIERRA, ALBUQUERQUE, NM

PROJECT #1960

REVISION DATE: 3/1/21

RESPONSE COMMENTS 3/1/21

STATE OF NEW MEXICO

RICHARD P. BENNETT

No. 1240

2/25/21

REGISTERED ARCHITECT

RBA ARCHITECTURE PC

ARCHITECT

PLANNING

DESIGN

1001 Park Ave. SW

Albuquerque, NM 87102

Phone: 505.263.0000

www.rbaa.com

DATE: 2-25-2021

SHEET NUMBER: F-1.0