

# CITY OF ALBUQUERQUE

Planning Department  
Alan Varela, Director



Mayor Timothy M. Keller

December 9, 2025

Fred Arfman, PE  
ISAACSON & ARFMAN, PA  
128 MONROE ST NE  
ALBUQUERQUE, NM 87108

[FREDA@IACIVIL.COM](mailto:FREDA@IACIVIL.COM)

**Re: Mack Recovery Outdoor Vehicle Storage**  
**2510 2nd SW**  
**Albuquerque, NM 87102**  
**Traffic Circulation Layout**  
Engineer's Stamp 11/5/25 (M14D042)-TRANS-2025-00232

Dear Mr. Arfman,

The TCL resubmittal received 12-9-25 is approved for Building Permit by Transportation. A copy of the stamped and signed plan will be needed for each of the building permit plans. Please keep the original to be used for certification of the site for final C.O. for Transportation.

PO Box 1293

When the site construction is completed and an inspection for Certificate of Occupancy (C.O.) is requested, use the original City stamped approved TCL for certification. Redline any minor changes and adjustments that were made in the field. A NM registered architect or engineer must stamp, sign, and date the certification TCL along with indicating that the development was built in "substantial compliance" with the TCL. Submit this certification, and the TCL to the [ABQ-PLAN](#) for log in and evaluation by Transportation.

Albuquerque

NM 87103

Once verification of certification is completed and approved, notification will be made to Building Safety to issue Final C.O. To confirm that a final C.O. has been issued, call Building Safety at 924-3690.

[www.cabq.gov](http://www.cabq.gov)

Sincerely,

*Sertil A. Kanbar*

Sertil Kanbar, PhD, PE, CFM  
Sr. Engineer, Planning Dept.  
Development Review Services

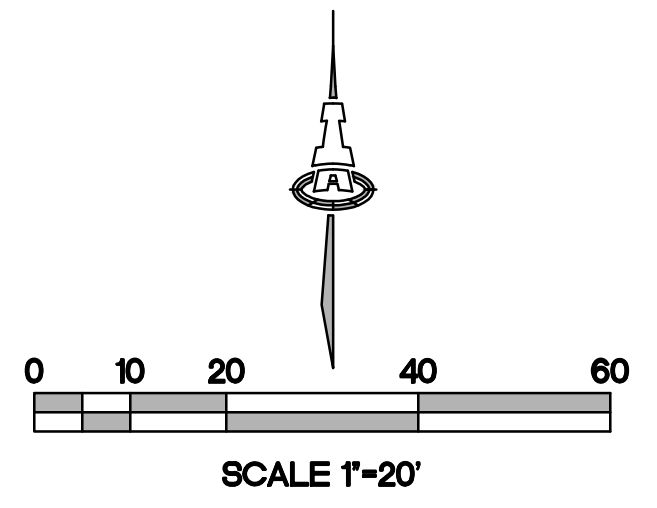
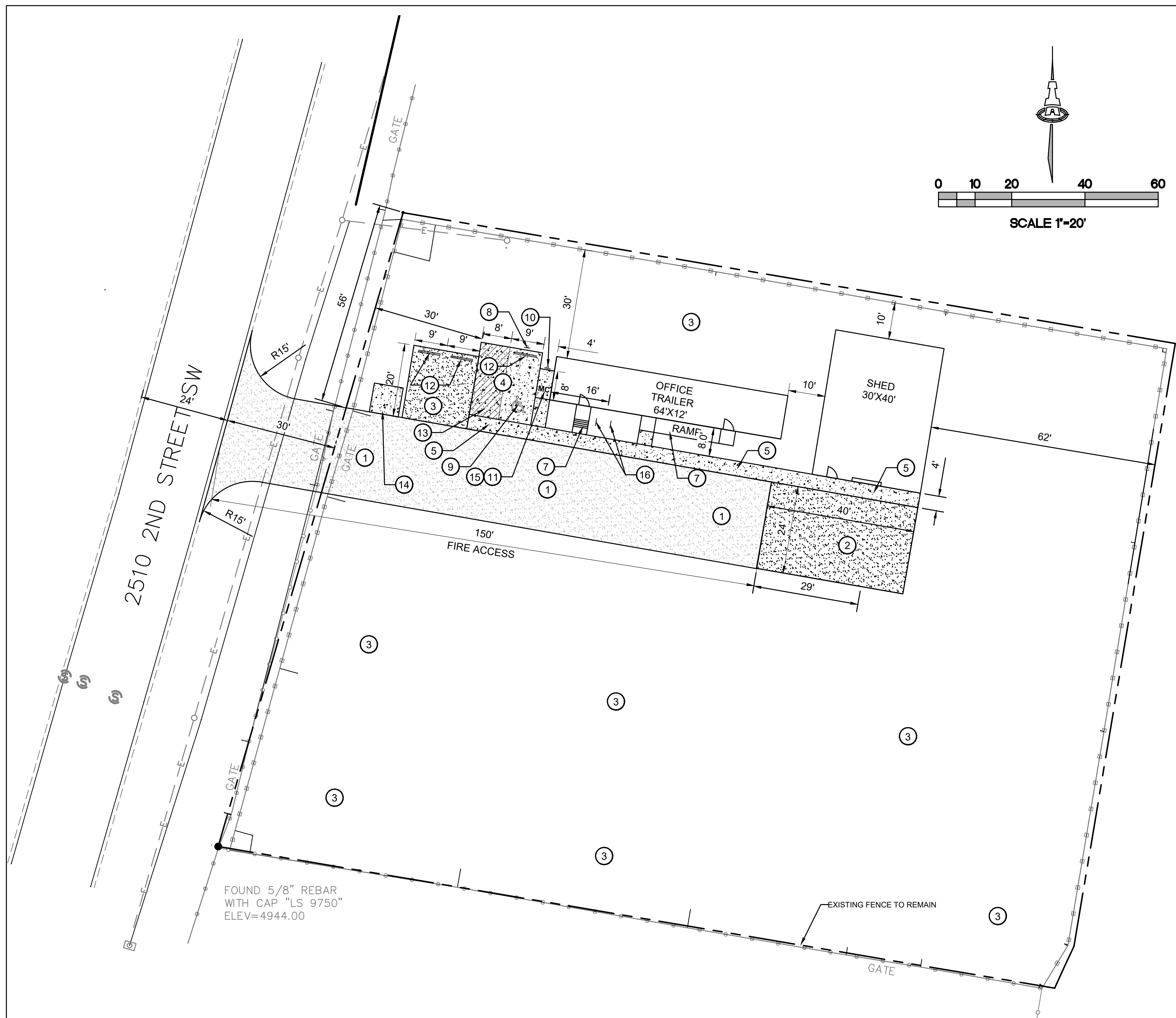

**KEYED NOTES**

1. 6" BASE COURSE PAVING, SEE SECTION SHEET CS-501.
2. 4" BASE COURSE PAVING, SEE SECTION SHEET CS-501.
3. 2" FRACTURED FACE GRAVEL PAVING, SEE SECTION SHEET CS-501
4. PCC PAVING, SEE SECTION SHEET CS-501.
5. PCC SIDEWALK, SEE DETAIL SHEET CS-501.
6. NOT USED
7. ADA ACCESS RAMP, SEE DETAIL SHEET CS-501.
8. ADA ACCESSIBLE PARKING SIGN, SEE DETAIL SHEET CS-501.
9. ADA ACCESSIBLE SYMBOL, SEE DETAIL SHEET CS-501.
10. MOTORCYCLE PARKING SIGN, SEE DETAIL SHEET CS-501.
11. MOTOR CYCLE PARKING SYMBOL, SEE DETAIL SHEET CP-501
12. PARKING WHEEL STOP, SEE DETAIL SHEET CS-501.
13. 4" BLUE DIAGONAL STRIPE.
14. CONCRETE PAD FOR ROLLOUT REFUSE BINS
15. PROPOSED MOTORCYCLE PARKING SPOT
16. PROPOSED BIKE RACK (2 BIKE PARKING SPACES PROVIDED)

**TRAFFIC CIRCULATION LAYOUT APPROVED**  
 Sertil A. Kanbar    12/9/2025  
 Signed                      Date

**GENERAL NOTES**

- A. FIVE WORKING DAYS PRIOR TO ANY EXCAVATION, THE CONTRACTOR MUST CONTACT NEW MEXICO ONE CALL SYSTEM (505-260-1990) FOR LOCATION OF EXISTING UTILITIES.
- B. PRIOR TO CONSTRUCTION, THE CONTRACTOR SHALL EXCAVATE AND VERIFY THE HORIZONTAL AND VERTICAL LOCATIONS OF ALL OBSTRUCTIONS. SHOULD A CONFLICT EXIST, THE CONTRACTOR SHALL NOTIFY THE ENGINEER IMMEDIATELY SO THAT THE CONFLICT CAN BE RESOLVED WITH A MINIMUM AMOUNT OF DELAY.
- C. SEE ARCHITECTURAL PLANS / DEVELOPMENT PLANS FOR DIMENSIONS.
- D. SEE CE-101 FOR EXISTING PAVEMENT REMOVAL ON SITE
- E. SEE CN-101 FOR ALL CIVIL GENERAL NOTES.

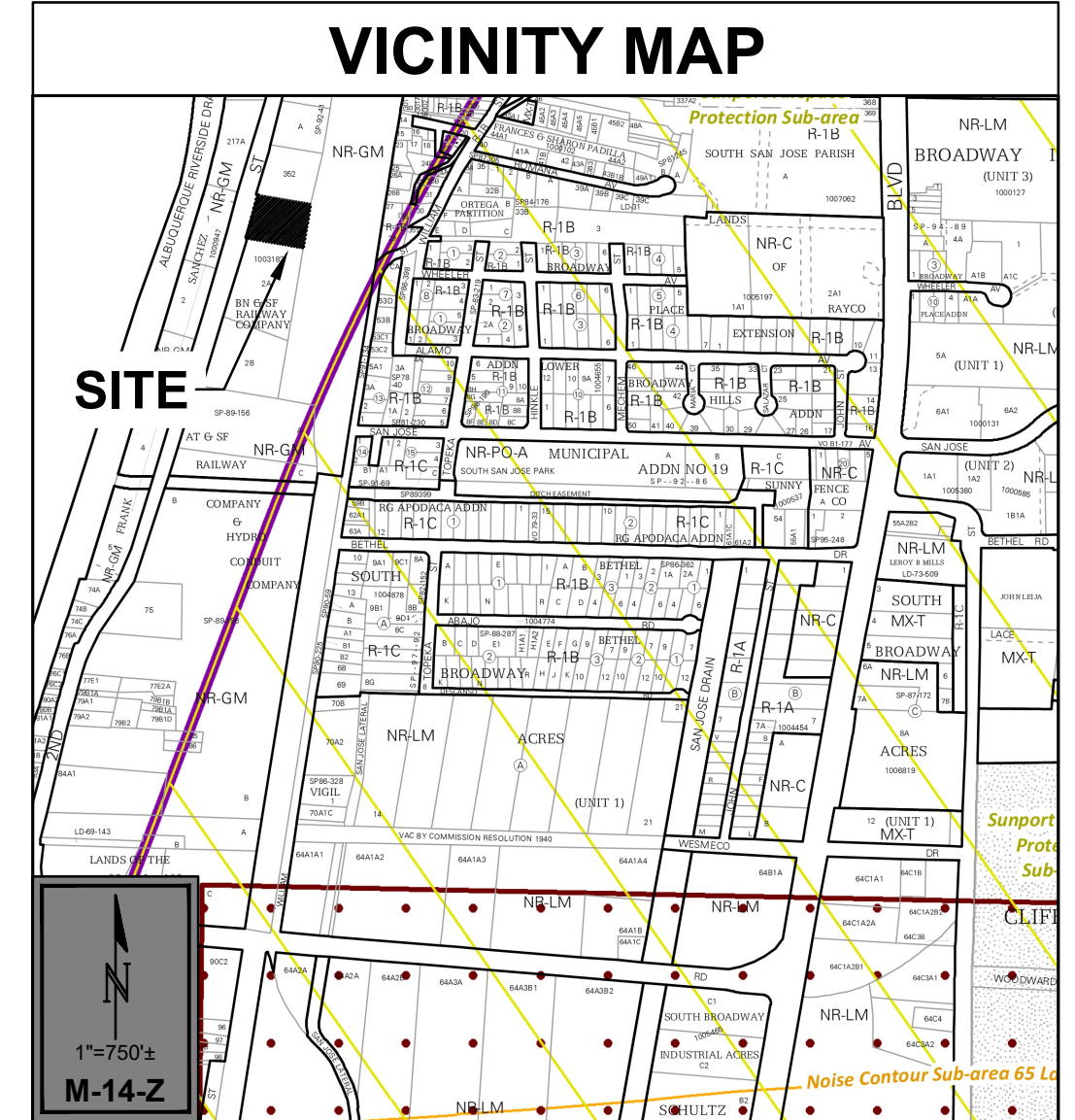

**PROJECT INFORMATION**

**LEGAL DESCRIPTION:**  
 TRACT 1, LANDS OF B.N. & S.F. RAILROAD CO. WITHIN THE M.R.G.C.D. MAP NO. 44, SEC. 32, T 10N, R 3E.

**STREET ADDRESS:**  
 2510 2ND ST SW, ALBUQUERQUE, NM 87102.

**SITE AREA:** 0.9226 ACRES

**ZONING:** NR-GM / GENERAL MAUFACTURING

**BUILDING CALCULATIONS:** GROSS FLOOR AREA (GFA)=1,968 SF ±

**PARKING CALCULATIONS:**

REQUIRED: THERE IS NO PARKING REQUIREMENTS FOR THE OUTDOOR VEHICLE STORAGE USE.  
 PROVIDED: 3 SPACES (INCLUDING 0 COMPACT SPACES)

ADA REQUIRED: 1 SPACES (1 VAN SPACE)  
 ADA PROVIDED: 1 SPACES (1 VAN SPACE)

MOTORCYCLE REQUIRED: 1 SPACES  
 MOTORCYCLE PROVIDED: 1 SPACES

BICYCLE REQUIRED: 3 SPACES OR 10% OF REQUIRED OFF-STREET PARKING SPACES  
 BICYCLE PROVIDED: 3 SPACES

**ADRIAN MAREZ**    11-5-25  
 SOLID WASTE APPROVAL    DATE

**LEGEND**

- 6" BASE COURSE PAVING SECTION
- HEAVY DUTY CONCRETE PAVING

© 2020 Isaacson & Arfman, Inc. This design, calculations, and concepts are owned by and remain the property of Isaacson & Arfman, Inc. and no part thereof shall be utilized by any person, firm or corporation for any purpose whatsoever except with the written permission of Isaacson & Arfman, Inc.

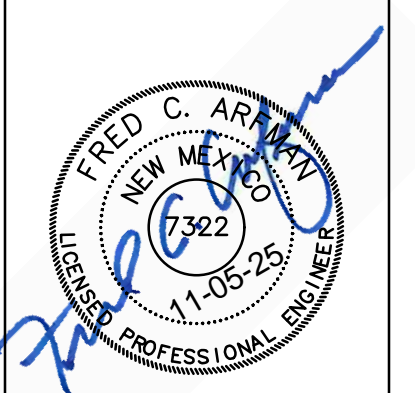

**MACK RECOVERY**  
 2510 SECOND ST. SW  
 ALBUQUERQUE, NM, 87102

<b>DESIGN DEVELOPMENT</b>	<b>ISSUE:</b>
PROJECT NUMBER: IA 2764	PROJECT NUMBER: IA 2764
FILE:	FILE:
DRAWN BY: BK	DRAWN BY: BK
CHECKED BY: FCA	CHECKED BY: FCA
DATE:	DATE:

No	Date	Description

**SHEET TITLE**  
 PAVING & TRAFFIC CONTROL PLAN  
**SHEET NUMBER**  
 CP-101

I:\PROJECTS\2025\2764\MACK RECOVERY\DRAWING\PMR\IA 2764 CP-101.dwg    11/05/2025 10:55 AM

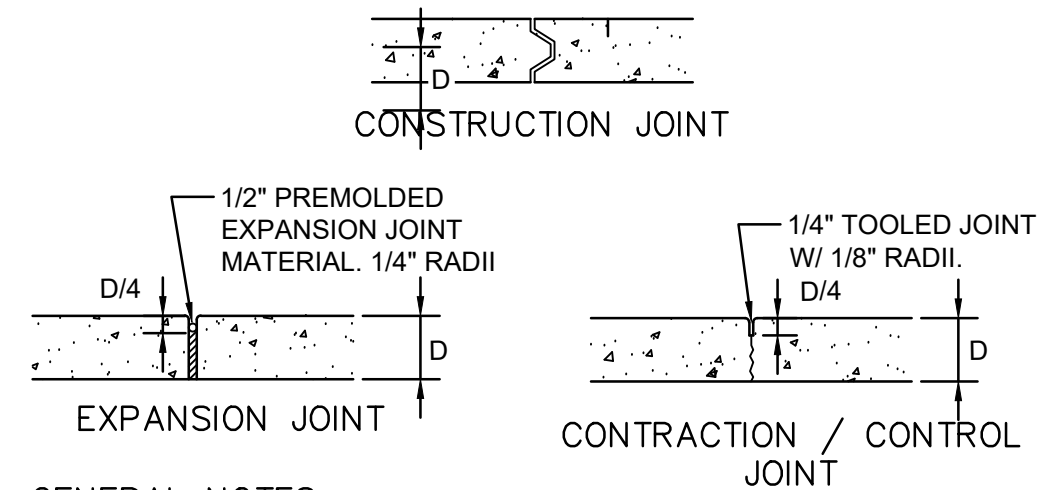

- GENERAL NOTES**
1. ODD-SHAPED AREAS OF PAVEMENT SHOULD BE AVOIDED TO MINIMIZE RANDOM CRACKING
  2. LONGITUDINAL JOINT SPACING SHALL NOT EXCEED 12.5'
  3. TRANSVERSE JOINT SPACING SHALL BE AT REGULAR INTERVALS OF 15' OR LESS
  4. OFFSETS AT RADIUS POINTS SHALL BE AT LEAST 1.5' WIDE

**CONCRETE JOINTS**  
SCALE: N.T.S.

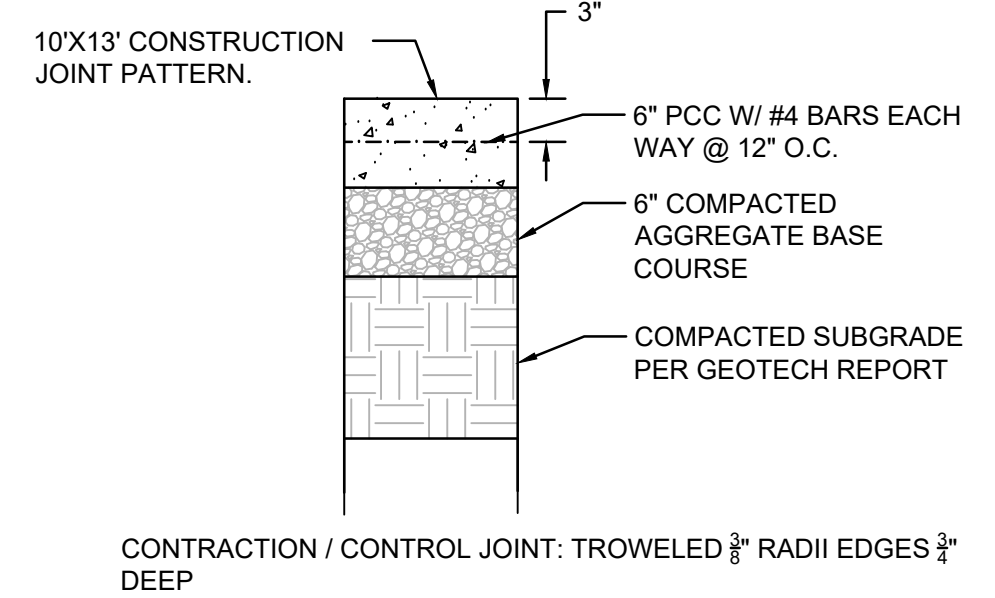

**CONCRETE PAVEMENT SECTION**  
SCALE: N.T.S.

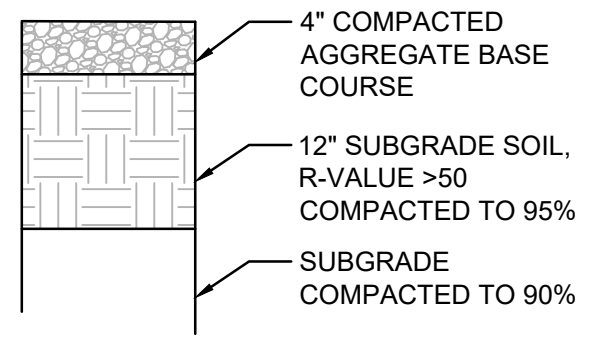

**4\"/>**

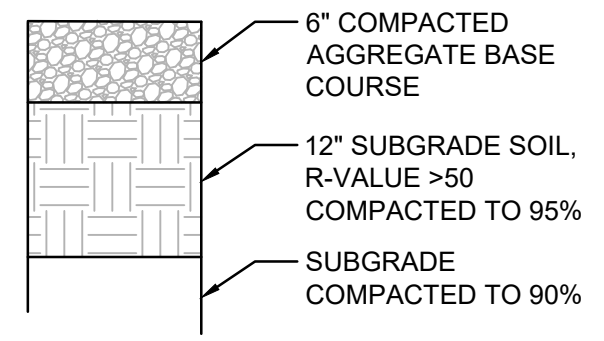

**6\"/>**

**TRAFFIC CIRCULATION LAYOUT APPROVED**  
Signed: Sertil A. Kanbar Date: 12/9/2025

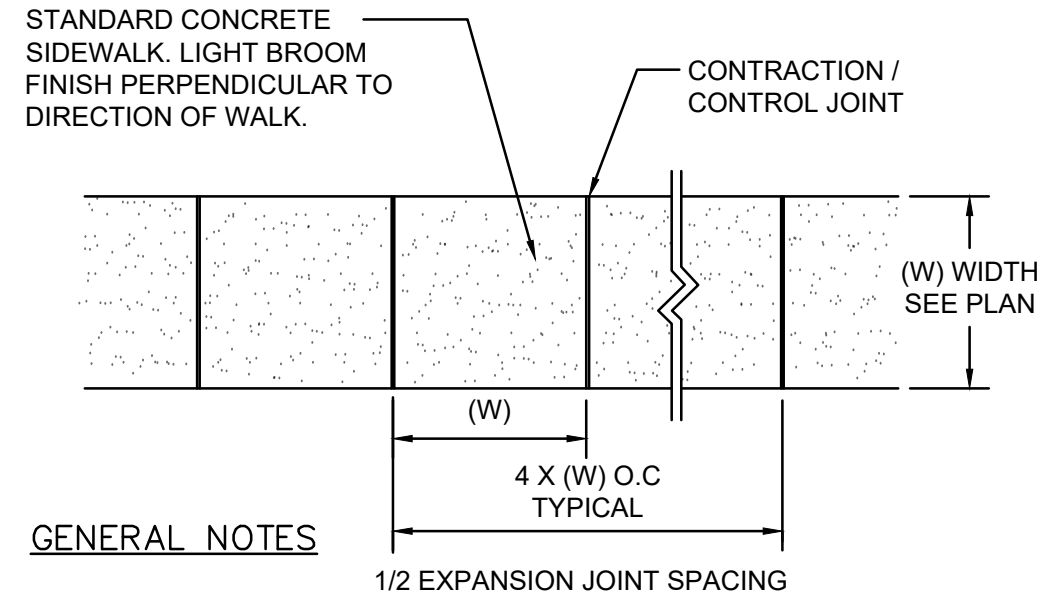

- GENERAL NOTES**
1. 4000 PSI COMPRESSIVE STRENGTH CONCRETE
  2. SEE CONCRETE JOINTS DETAIL
  3. FINISHED EDGE OF ASPHALT PAVING TO BE 1/2\"/>

**CONCRETE WALK**  
BROOM FINISH SCALE: N.T.S.

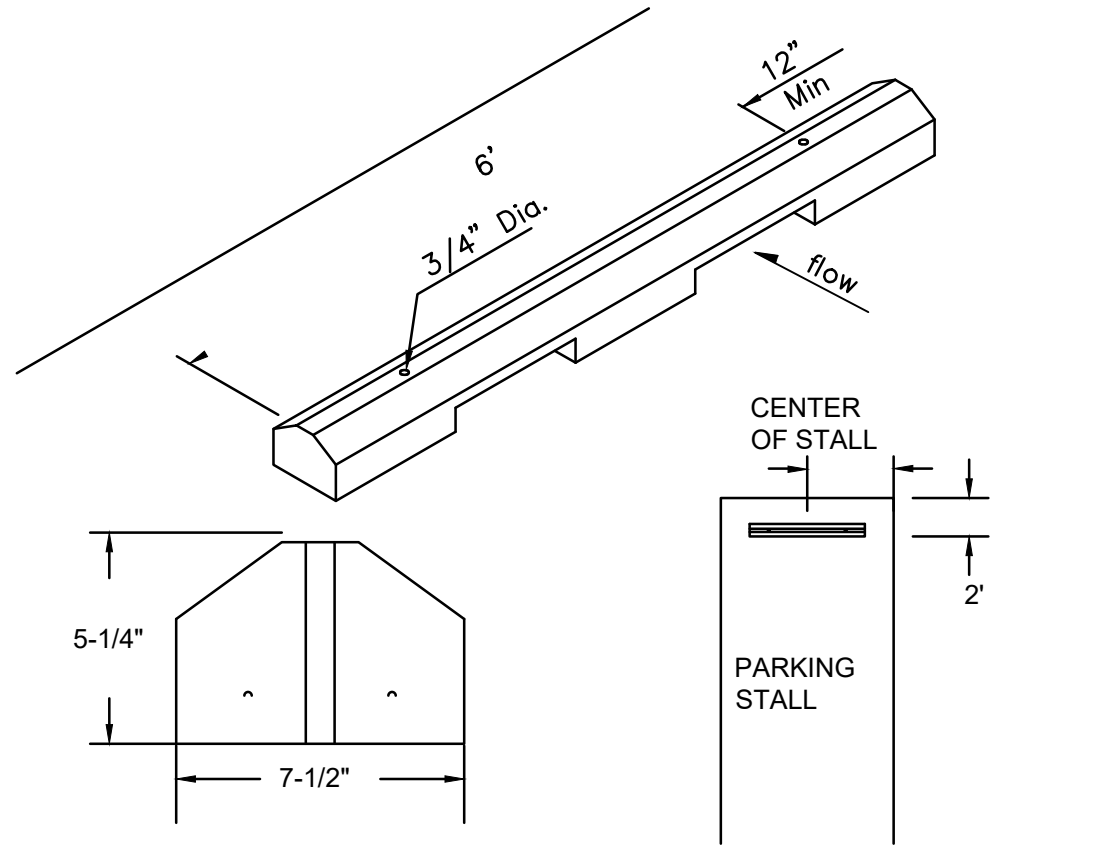

- GENERAL NOTES**
1. WHEEL STOPS TO BE PLACED 2' BACK, CENTERED IN THE PARKING STALL. WHEEL STOPS CAN BE PAINTED IN A CONTRASTING COLOR SUCH AS GRAY, YELLOW OR BLACK.
  2. BLUE SHALL BE USED FOR HANDICAP PARKING STALLS.
  3. INSTALL EACH WITH TWO DOWELS PER MANUFACTURERS SPECIFICATIONS.

**CONCRETE WHEEL STOP**  
SCALE: N.T.S.

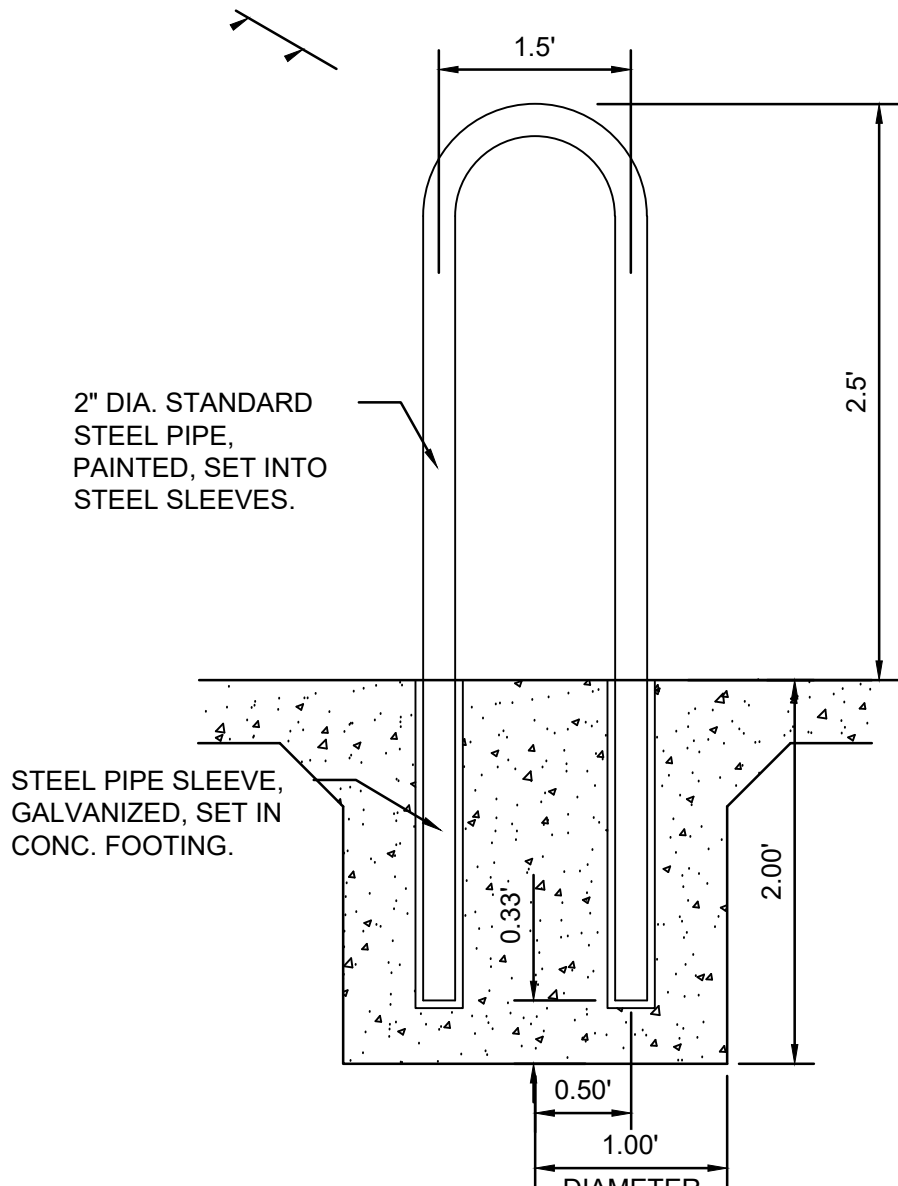

**BICYCLE RACK**  
SCALE: N.T.S.

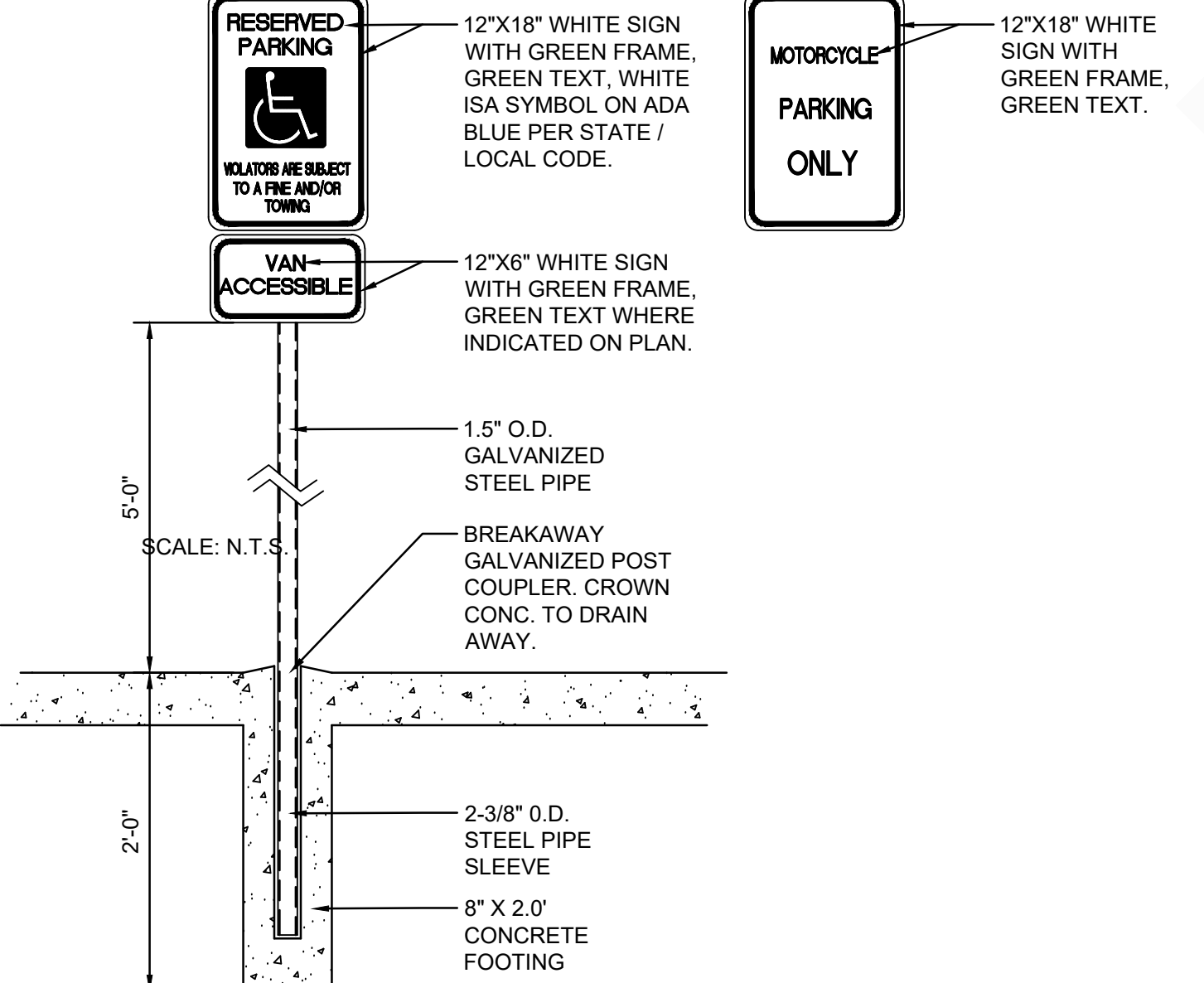

**SIGNAGE**  
SCALE: N.T.S.

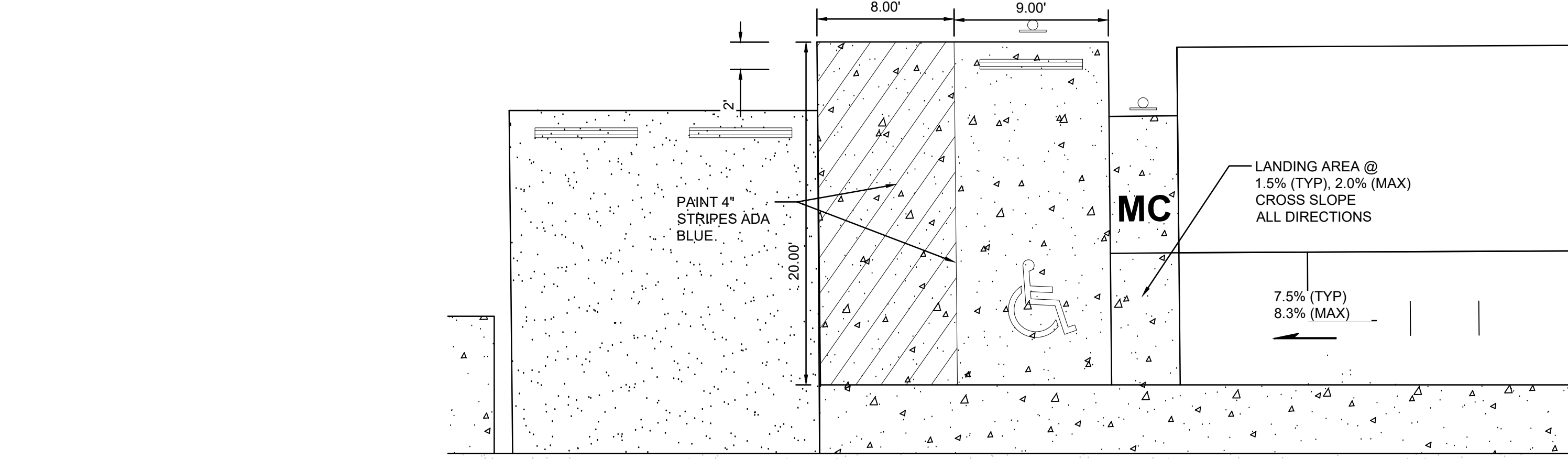

**ADA PARKING**  
SCALE: N.T.S.

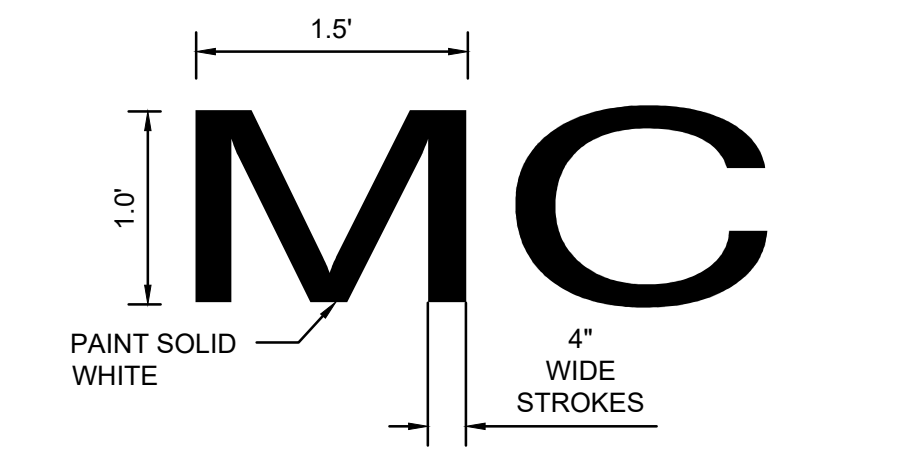

**PANTED 'MC' MOTORCYCLE**  
SCALE: N.T.S.

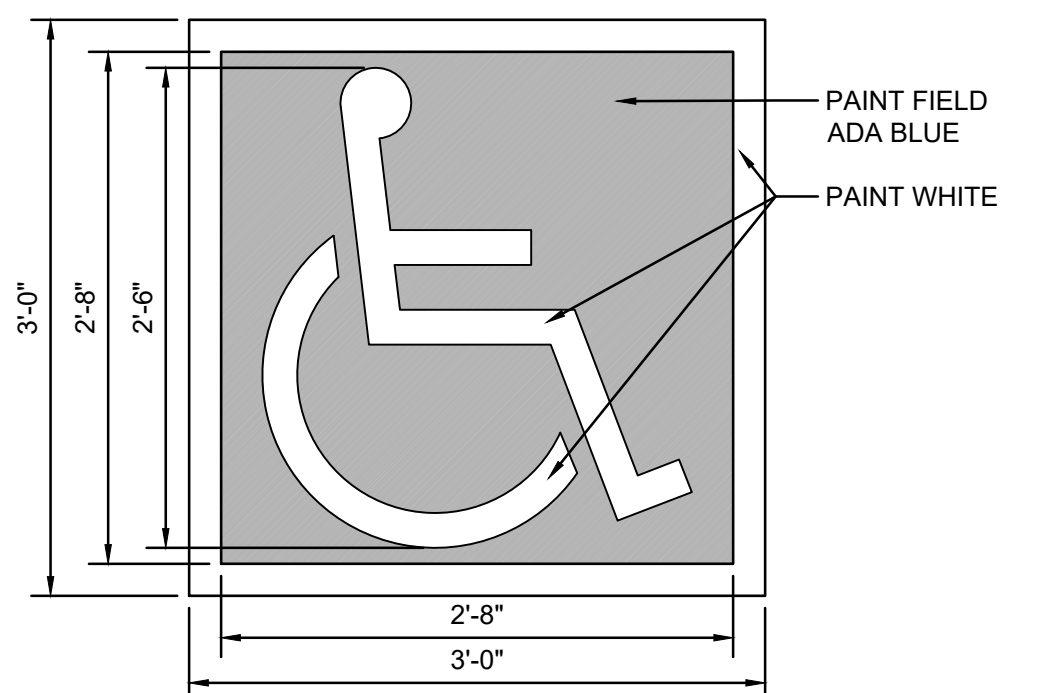

**ACCESSIBILITY SYMBOL**  
SCALE: N.T.S.

© 2020 Isaacson & Arfman, Inc. This design, calculations, and concepts are owned by and remain the property of Isaacson & Arfman, Inc. and no part thereof shall be utilized by any person, firm or corporation for any purpose whatsoever except with the written permission of Isaacson & Arfman, Inc.

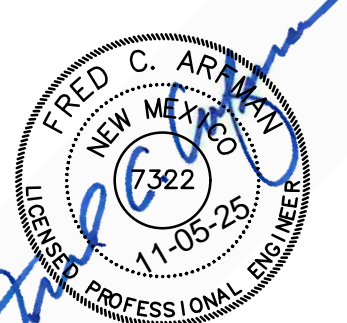

Engineer

**MACK RECOVERY**  
**2510 SECOND ST. SW**  
**ALBUQUERQUE, NM, 87102**

DESIGN	ISSUE: DEVELOPMENT
PROJECT NUMBER:	IA 2764
FILE:	-
DRAWN BY:	BK
CHECKED BY:	FCA
DATE:	--

No	Date	Description

SHEET TITLE

**PAVING DETAILS**

SHEET NUMBER

**CP-501**