

CITY OF ALBUQUERQUE



Planning Department
Alan Varela, Director

Mayor Timothy M. Keller

July 25, 2025

Michael Johnson, P.E.
Souder, Miller & Associates
3500 Sedona Hills Parkway
Las Cruces, NM 88011

Re: Maverik
2121 Yale Blvd. SE
30-Day Temporary Certificate of Occupancy
Transportation Development Final Inspection
Engineer's Stamp dated 01-04-24 (M15-D021D)
Certification dated 07-10-2025

Dear Mr. Johnson,

Based upon the information provided in your submittal received 07-11-25, Transportation Development has no objection to a 30-day Temporary Certificate of Occupancy based. This letter serves as a "green tag" from Transportation Development for a 30-day Temporary Certificate of Occupancy to be issued by the Building and Safety Division.

PO Box 1293

Prior to the issuance of a permanent Certificate of Occupancy, the following items must be addressed:

Albuquerque

1. Please provide Bike Racks in accordance with city requirements and the approved site plan. The wave style bike rack are no longer permitted for new projects.

NM 87103

www.cabq.gov

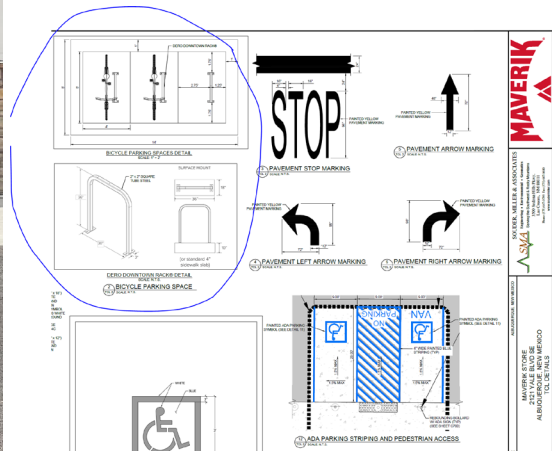

CITY OF ALBUQUERQUE



Planning Department
Alan Varela, Director

Mayor Timothy M. Keller

Once these corrections are complete, email pictures to malnajjar@cabq.gov for release of Final CO.

If you have any questions, please contact me at (505) 924-3675.

Sincerely,

Marwa Al-najjar

Marwa Al-najjar
Associate Engineer, Planning Dept.
Development Review Services

PO Box 1293

Albuquerque

NM 87103

www.cabq.gov



July 10, 2025

Mr. Ernest Armijo, P.E. C.F.M.
Principal Engineer
City of Albuquerque
400 Marquette NW
Albuquerque, New Mexico 87102

**RE: NM 718 MAVERIK ALBUQUERQUE – YALE AND GIBSON
TRAFFIC CIRCULATION LAYOUT CERTIFICATION**

Dear Mr. Armijo:

I, MICHAEL JOHNSON, NMPE 10751, OF THE FIRM SOUDER, MILLER AND ASSOCIATES, HEREBY CERTIFY THAT THIS PROJECT IS IN SUBSTANTIAL COMPLIANCE WITH AND IN ACCORDANCE WITH THE DESIGN INTENT OF THE APPROVED PLAN DATED JANUARY 2, 2024. THE RECORD INFORMATION EDITED ONTO THE ORIGINAL DESIGN DOCUMENT HAS BEEN OBTAINED BY MICHAEL JOHNSON OF THE FIRM SOUDER, MILLER AND ASSOCIATES. I FURTHER CERTIFY THAT I HAVE DETERMINED BY VISUAL INSPECTION THAT THE SURVEY DATA PROVIDED IS REPRESENTATIVE OF ACTUAL SITE CONDITIONS AND IS TRUE AND CORRECT TO THE BEST OF MY KNOWLEDGE AND BELIEF. THIS CERTIFICATION IS SUBMITTED IN SUPPORT OF A REQUEST FOR FINAL CERTIFICATE OF OCCUPANCY.

THE RECORD INFORMATION PRESENTED HEREON IS NOT NECESSARILY COMPLETE AND INTENDED ONLY TO VERIFY SUBSTANTIAL COMPLIANCE OF THE TRAFFIC ASPECTS OF THIS PROJECT. THOSE RELYING ON THE RECORD DOCUMENT ARE ADVISED TO OBTAIN INDEPENDENT VERIFICATION OF ITS ACCURACY BEFORE USING IT FOR ANY OTHER PURPOSE.

A handwritten signature in black ink, appearing to read 'Michael Johnson', written over a horizontal line.

MICHAEL JOHNSON, NMPE 10751



JULY 10, 2025

Date

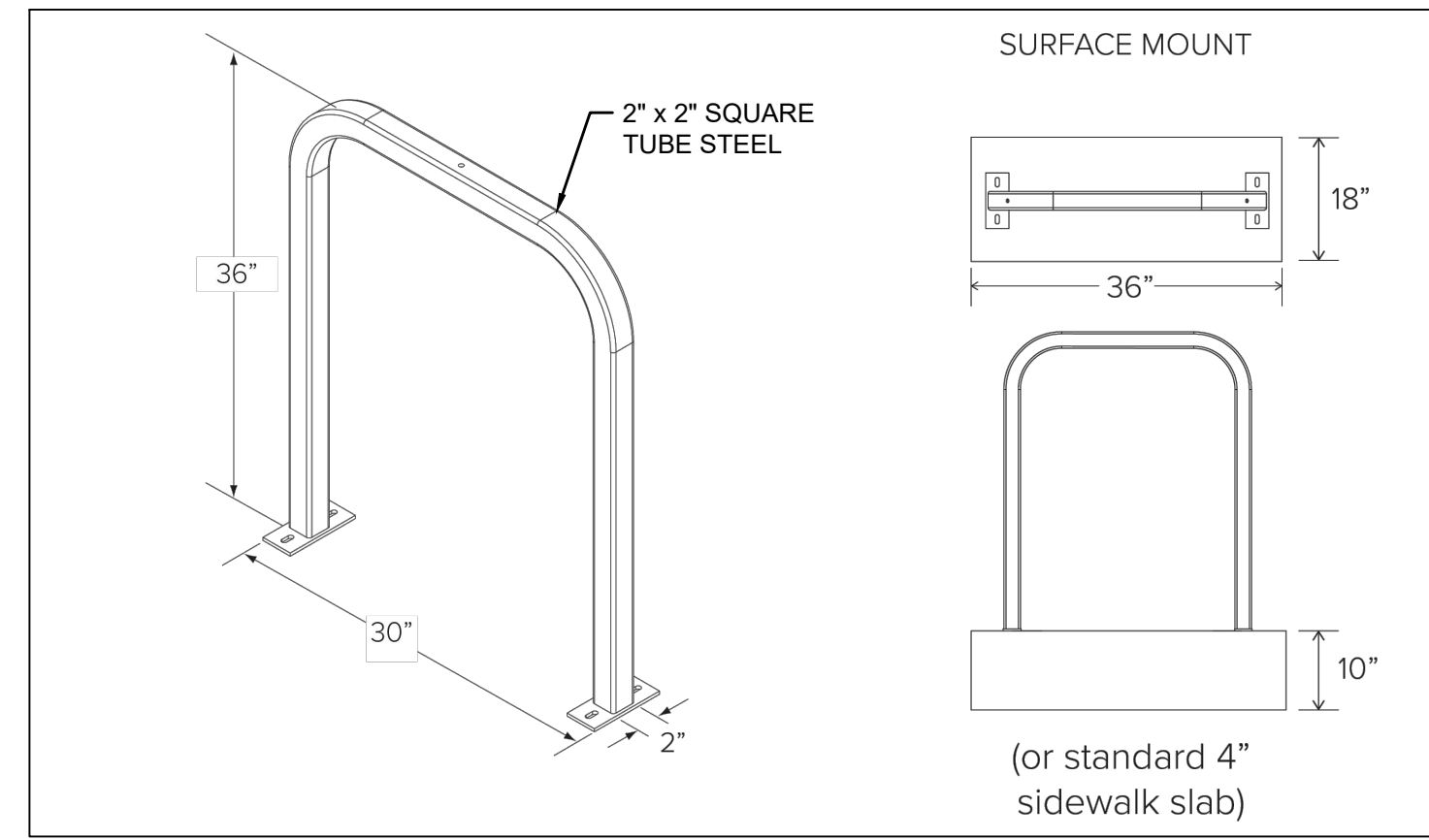
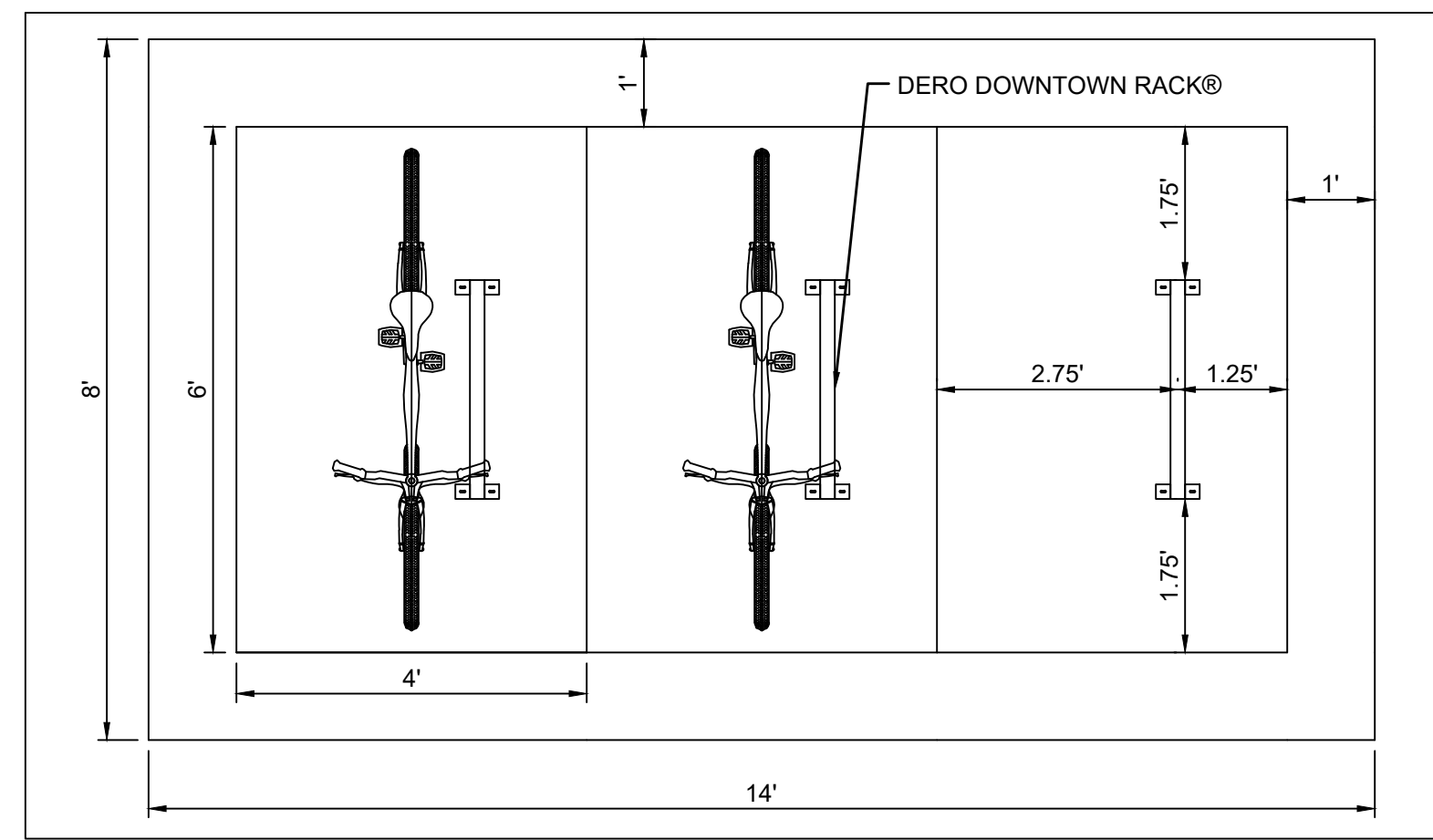
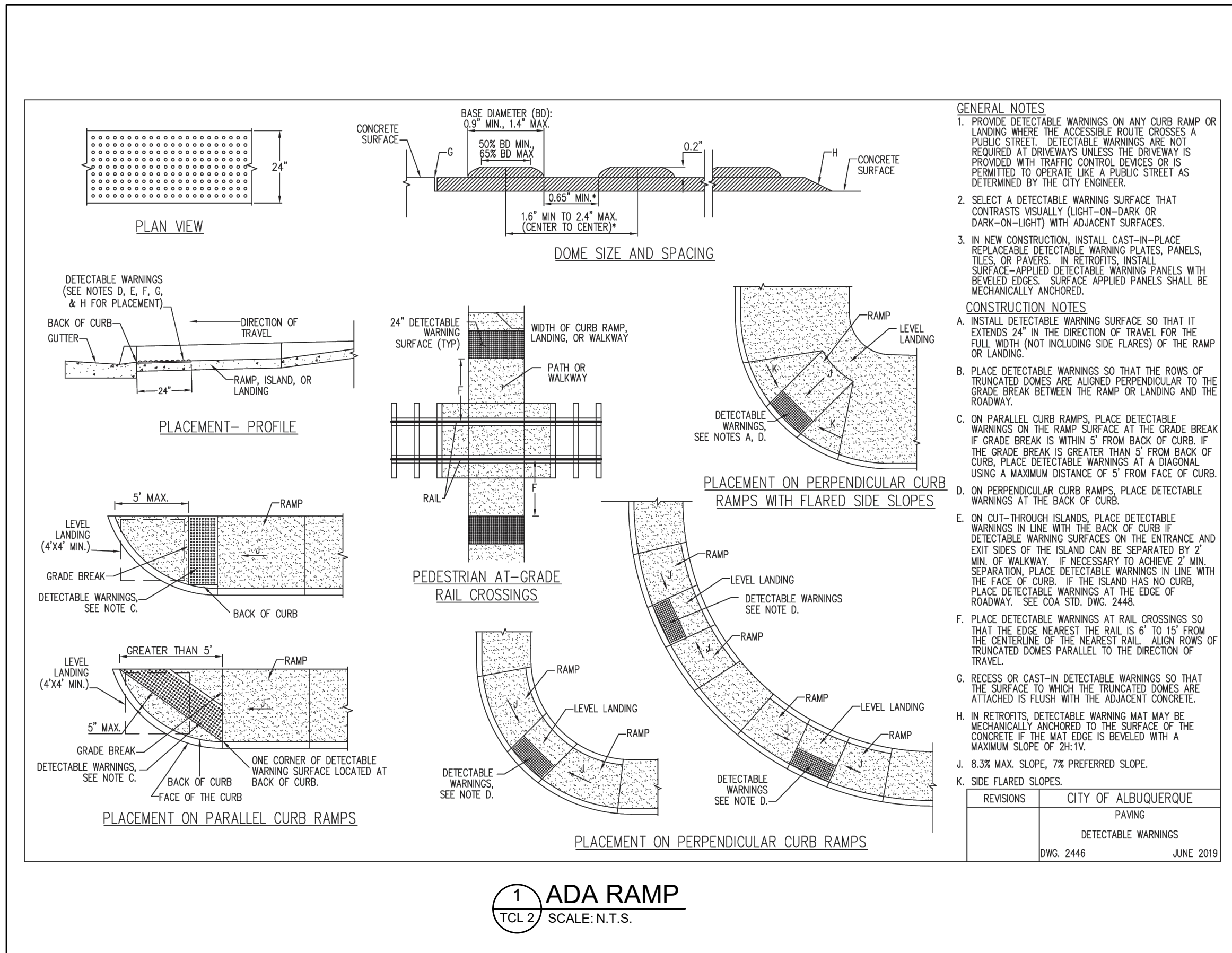

2 BICYCLE PARKING SPACE
TCL 2 SCALE: N.T.S.

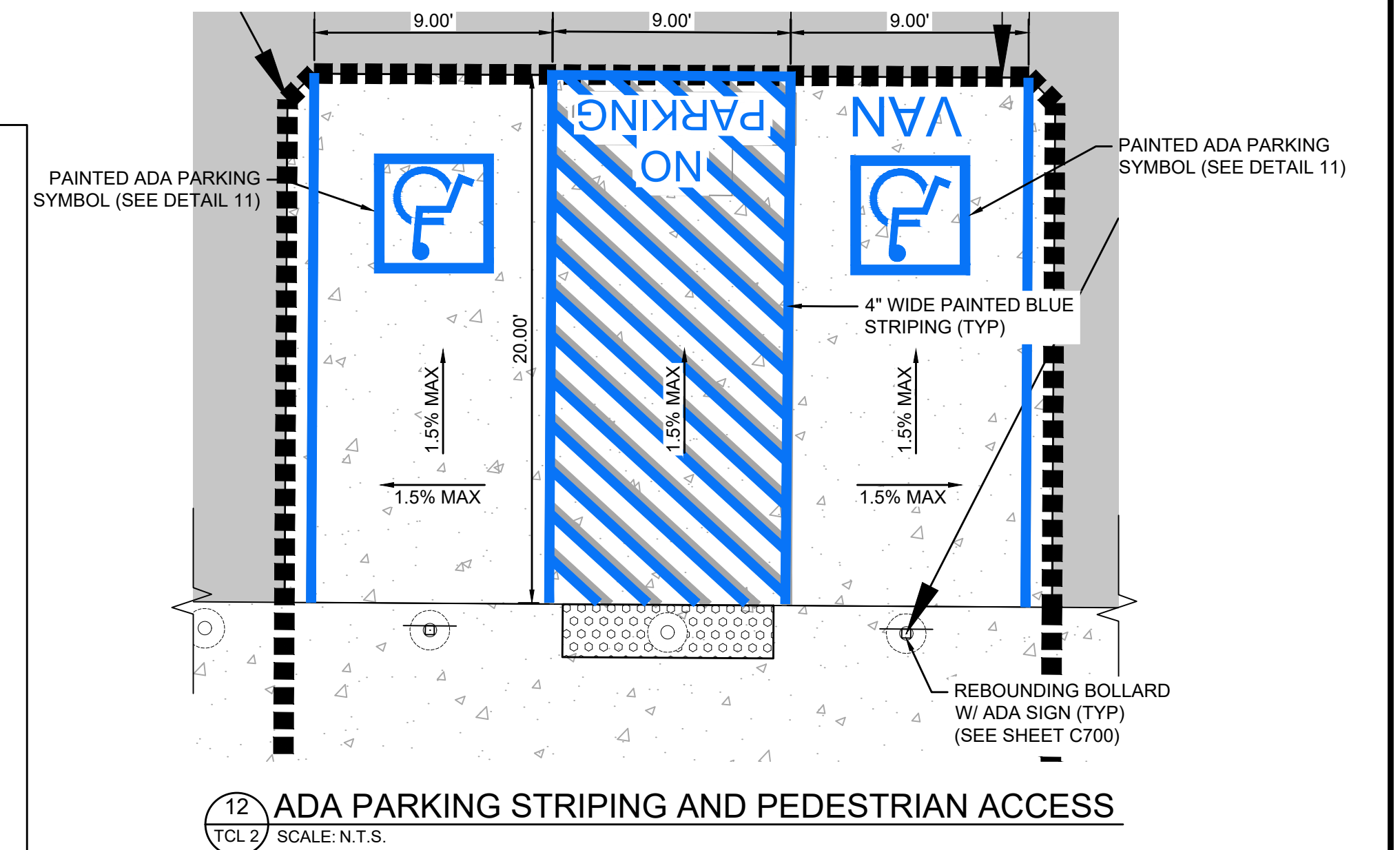
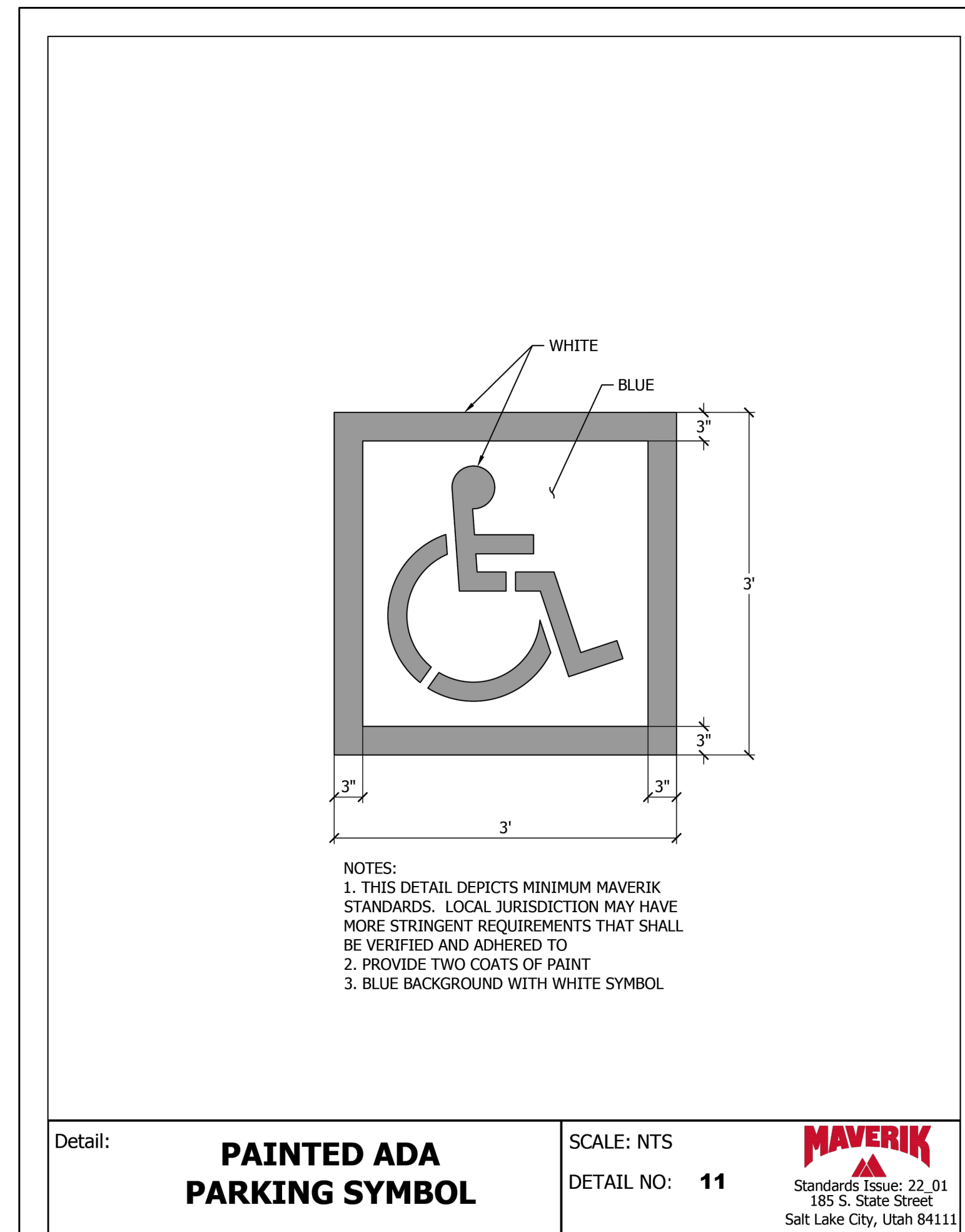
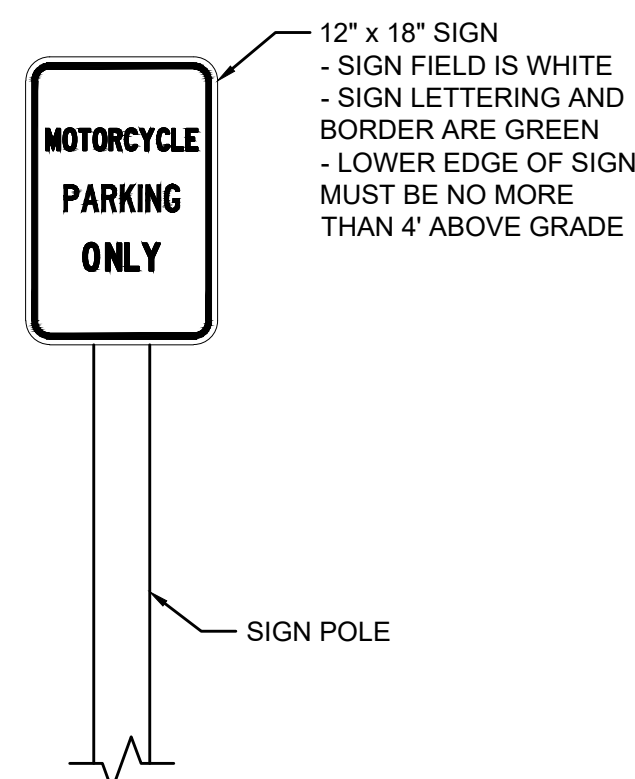
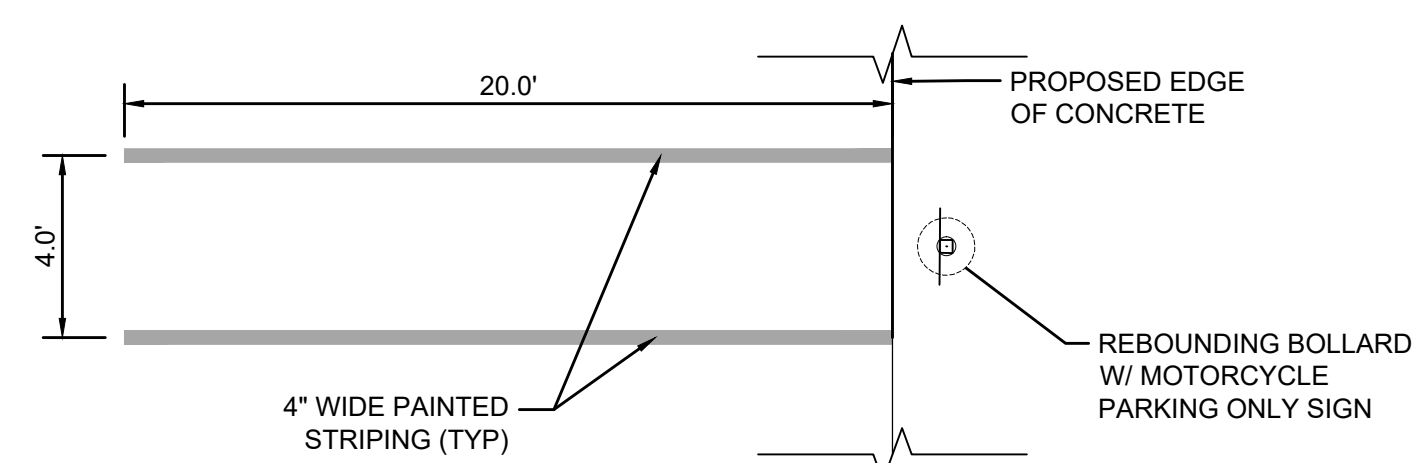
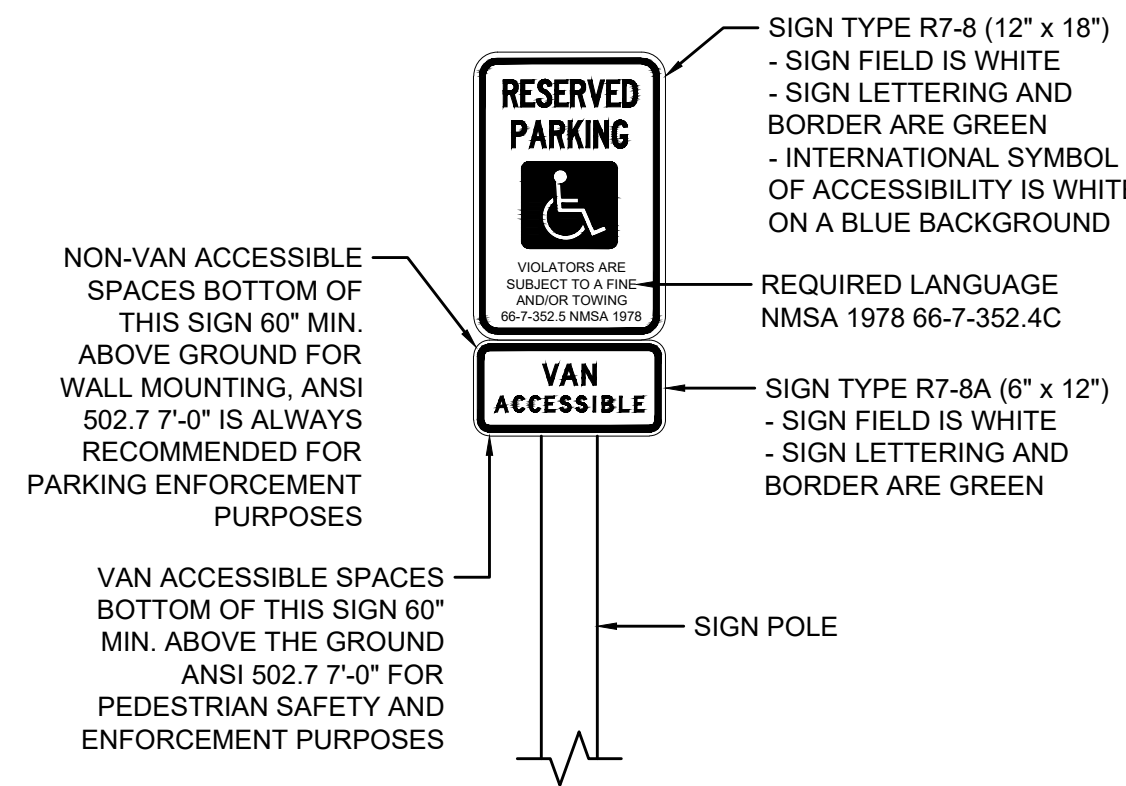
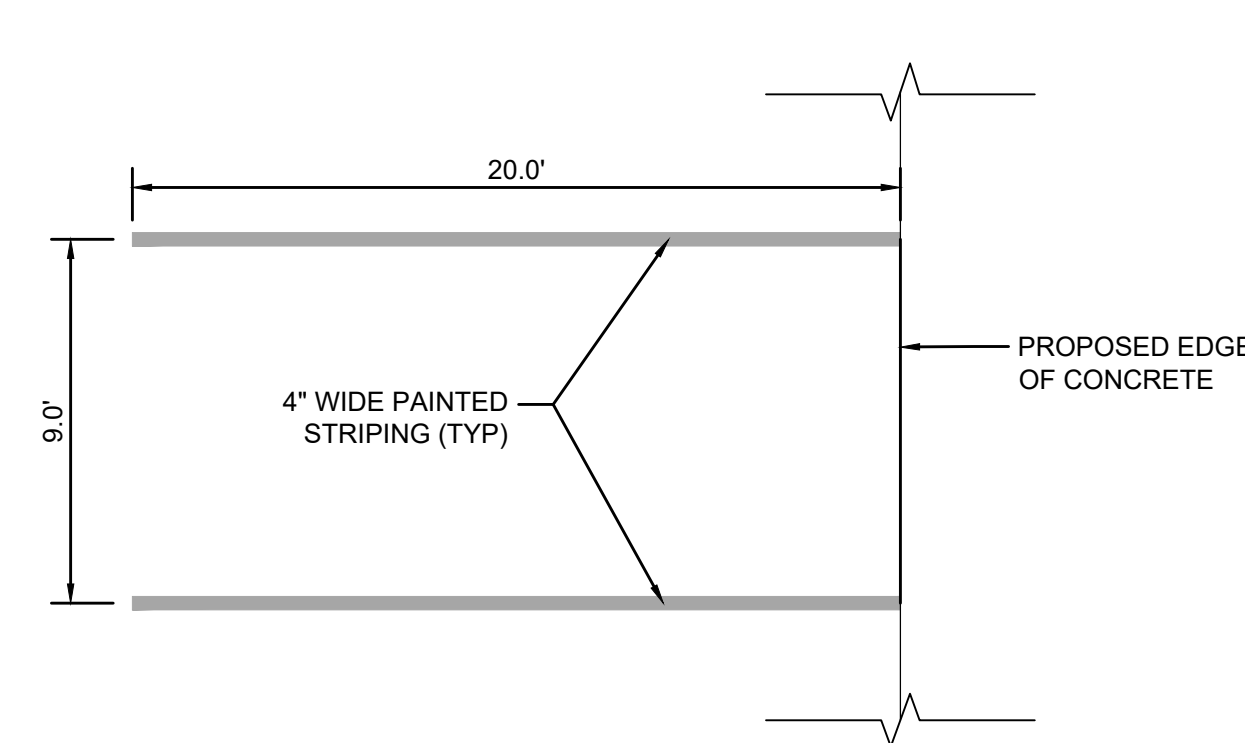
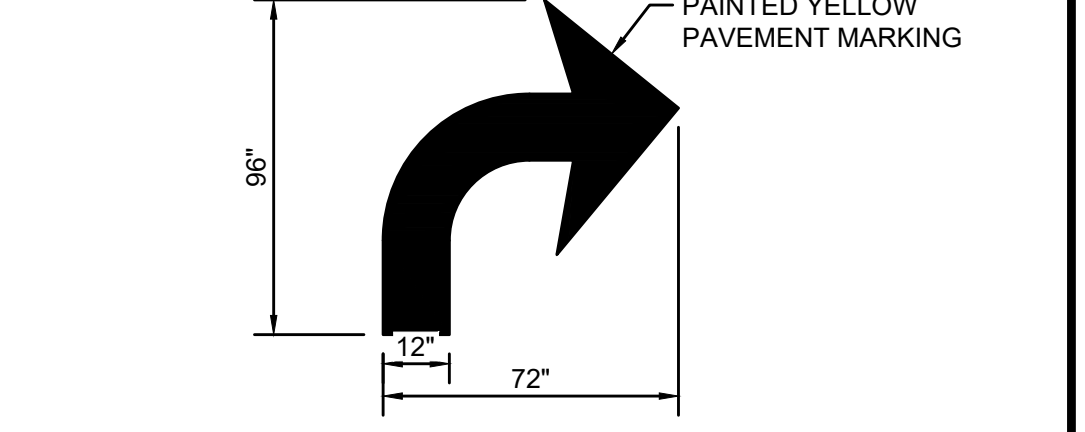
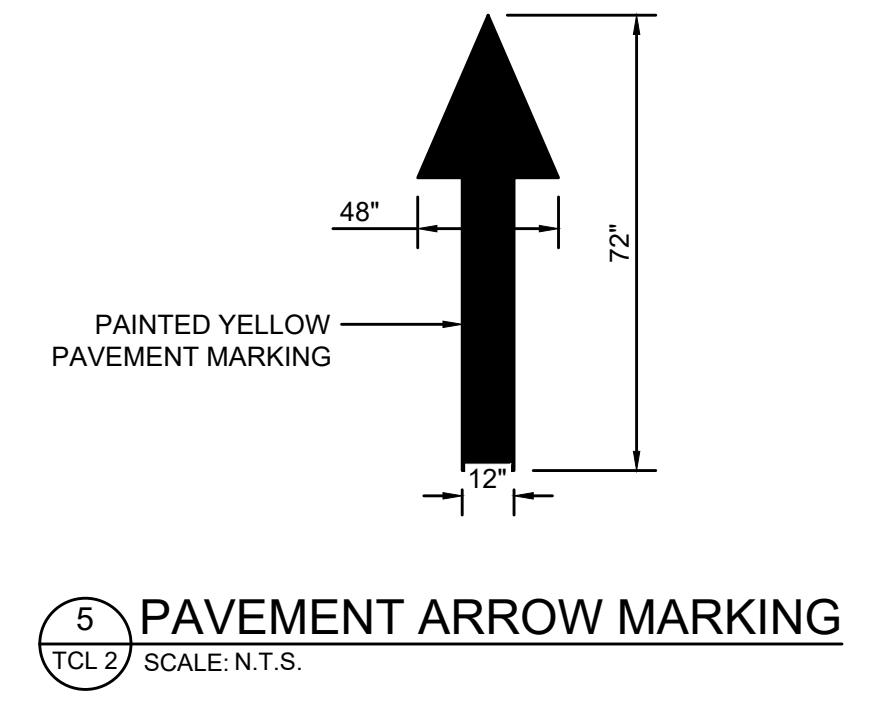
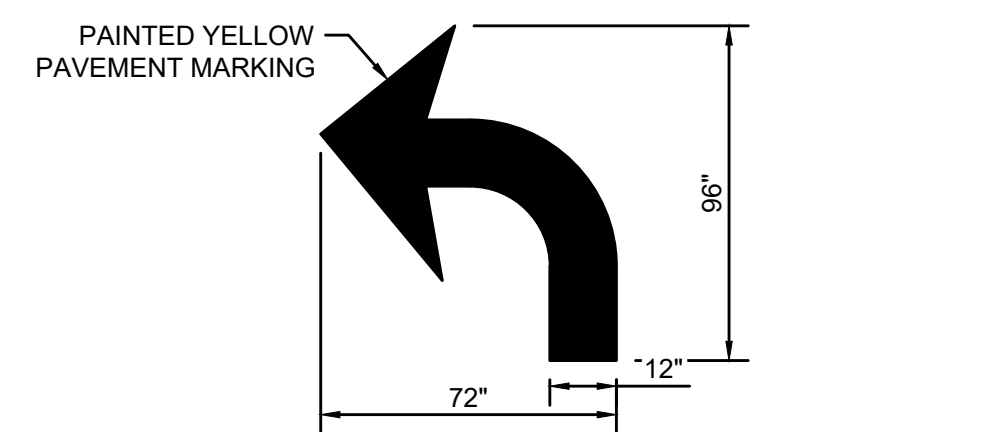
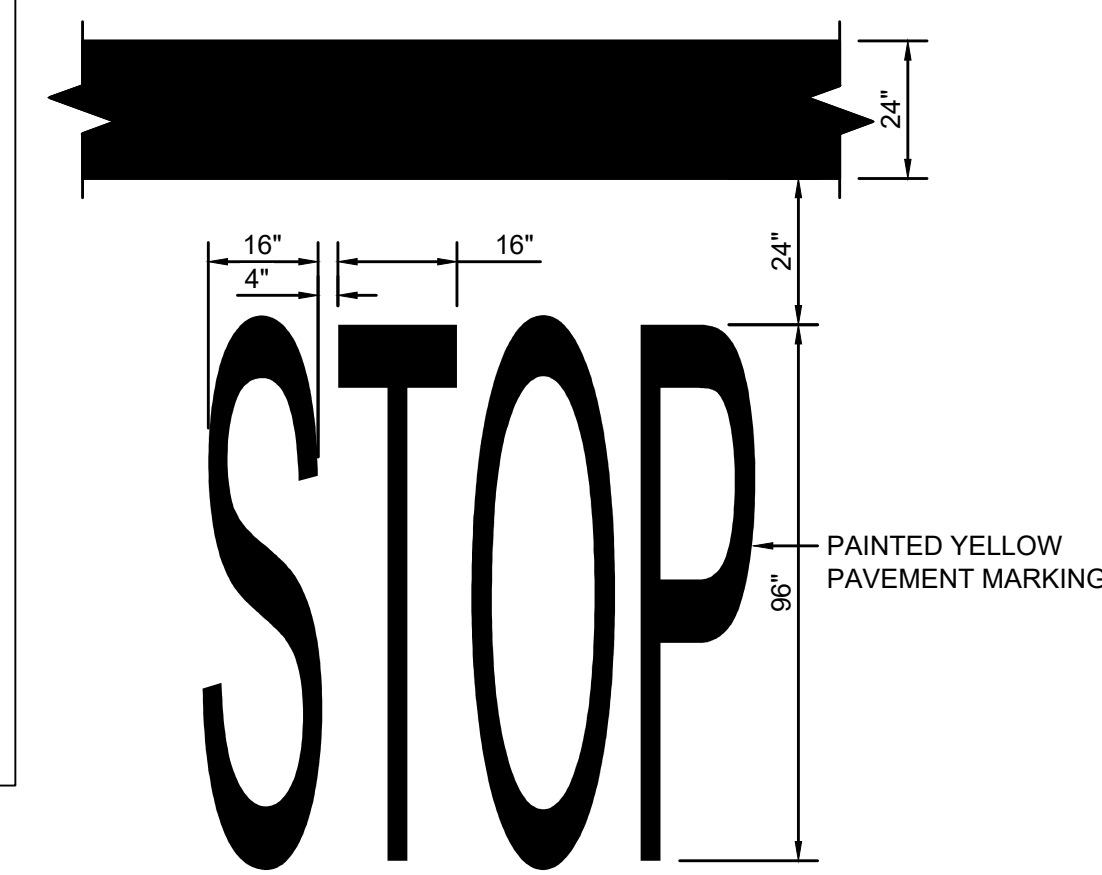

TRAFFIC CIRCULATION LAYOUT APPROVED
Ernest Armijo 1/2/2024
Signed Date



To Request a Line Locate Dial 811

New Mexico state law requires everyone involved in any excavation to provide at least two working days' notice to owners of underground facilities when a dig is planned. All facility owners are then required to mark the locations of any underground lines or take other appropriate measures to protect them.



MAVERIK
SOUDEY, MILLER & ASSOCIATES
Engineering • Environmental • Geomatics
Serving the Southwest & Rocky Mountains
3500 Sedona Hills Pkwy.
Las Cruces, NM 88011
Phone (575) 647-0799 Fax (575) 647-0680
www.soudermiller.com

ALBUQUERQUE, NEW MEXICO
MAVERIK STORE
2121 YALE BLVD SE
ALBUQUERQUE, NEW MEXICO
TCL DETAILS

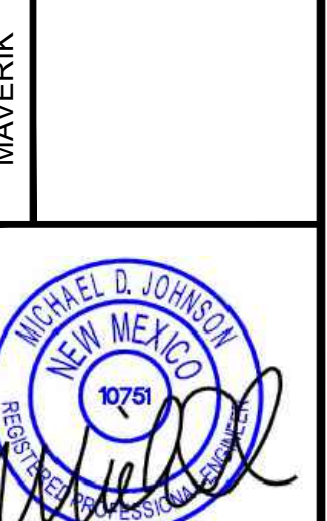

12/29/2023
THIS DRAWING IS INCOMPLETE AND NOT TO BE USED FOR CONSTRUCTION UNLESS IT IS STAMPED, SIGNED AND DATED.
Designed RWZ Drawn RWZ Checked DWMUR
Date: December 2023
Scale: Horiz: N/A Vert: N/A
Project No: 9431291
Sheet: TCL 2