

TALOS LOG No. SP 90-08-07-1056-0106

9070790

PLAT OF
LOTS 1-A, 2-A & 3-A
IN BLOCK 1
SUNPORT PARK
BEING A REPLAT OF LOTS 1 & 2
BLOCK 1

ALBUQUERQUE, NEW MEXICO
AUGUST, 1990

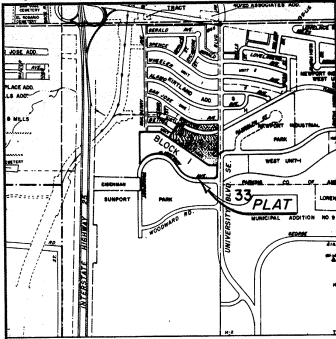

LOCATION MAP
ZONE ATLAS MAP M-15
SCALE: 1" = 1000'

ACS STA. "SDC 12-1"
NEW MEXICO STATE PLANE
COORDINATES (CENTRAL ZONE)
X = 384,530.65
Y = 1,475,334.52
S/G = 0.99997393
Δα = -0°13'18"
ELEV. = 5040.3

NOTES:

1. THE PURPOSE OF THIS PLAT IS TO REDIVIDE LOTS 1 AND 2, BLOCK 1 INTO LOTS 1A, 2A AND 3A.
2. BEARINGS AND DISTANCES ARE AS SHOWN ON THE PREVIOUSLY RECORDED PLATS OF SUNPORT PARK.
3. BEARINGS ARE STATE PLANE GRID BEARINGS.
4. ALL BLOCK CORNERS ARE IDENTIFIED BY A CAPPED REBAR MARKED "AARR L.S. 4071".
5. THIS PLAT DOES NOT CHANGE OR ALTER ANY EXISTING EASEMENTS OR RIGHTS-OF-WAY.
6. PRIOR TO DEVELOPMENT, CITY OF ALBUQUERQUE WATER AND SANITARY SEWER SERVICE TO LOTS 1A, 2A AND 3A, BLOCK 1 MUST BE VERIFIED AND COORDINATED WITH THE PUBLIC WORKS DEPARTMENT, CITY OF ALBUQUERQUE, VIA A REQUEST FOR A WATER AND SANITARY SEWER AVAILABILITY STATEMENT.

FREE CONSENT STATEMENT

THE PLAT SHOWN HEREON IS WITH THE FREE CONSENT OF, AND IN ACCORDANCE WITH THE WISHES AND DESIRES OF THE UNDERSIGNED OWNERS AND/OR PROPRIETORS THEREOF, THE UNDERSIGNED OWNERS DO HEREBY FREELY CONSENT TO ALL THE FOREGOING AND DO HEREBY REPRESENT THAT THEY ARE AUTHORIZED TO DO SO.

SUNPORT JOINT VENTURE - A REGISTERED NEW MEXICO PARTNERSHIP

BY: *Howard Mock*
J. HOWARD MOCK - MANAGING PARTNER

ACKNOWLEDGEMENT

STATE OF NEW MEXICO)
COUNTY OF BERNALILLO)

THE FOREGOING INSTRUMENT WAS ACKNOWLEDGED BEFORE ME THIS 12th DAY OF AUGUST, 1990 BY J. HOWARD MOCK, A MANAGING PARTNER IN SUNPORT JOINT VENTURE, A REGISTERED NEW MEXICO PARTNERSHIP.

MY COMMISSION EXPIRES 1-22-92

Carol J. McCarthy
CAROL J. MCCARTHY
JUDICIAL PUBLIC - STATE OF NEW MEXICO

DESCRIPTION

A CERTAIN TRACT OF LAND SITUATE WITHIN THE WEST ONE-HALF (1/2) OF SECTION 33, TOWNSHIP 10 NORTH, RANGE 3 EAST, N.M.P.M., BERNALILLO COUNTY, NEW MEXICO, BEING AND COMPRISING ALL OF BLOCK ONE (1) OF SUNPORT PARK AS THE SAME IS SHOWN AND DESIGNATED ON THE REPLAT THEREOF FILED IN THE OFFICE OF THE COUNTY CLERK OF BERNALILLO COUNTY, NEW MEXICO ON JANUARY 27, 1989 IN VOLUME C38, FILED 1052; AND BEING MORE PARTICULARLY DESCRIBED AS FOLLOWS:
BEGINNING AT THE NORTHWEST CORNER OF SAID BLOCK 1, SUNPORT PARK FROM WHENCE THE A.C.S. BRASS CAP MONUMENT "SDC 12-1" BEARS N 40°54'13" W, 465.73 FEET DISTANT; THENCE, FROM SAID POINT OF BEGINNING,
S 89°52'29" E, 221.03 FEET DISTANCE TO A POINT; THENCE,
S 89°32'29" E, 1,067.82 FEET DISTANCE TO A POINT; THENCE,
S 89°52'29" E, 144.14 FEET DISTANCE TO THE NORTHEAST CORNER OF SAID BLOCK 1; THENCE,
S 00°00'00" E, 265.53 FEET DISTANCE TO A POINT OF CURVATURE; THENCE,
SOUTHWESTERLY, 47.92 FEET DISTANCE ALONG THE ARC OF A CURVE BEARING TO THE RIGHT HAVING A RADIUS OF 30.00 FEET AND A CENTRAL ANGLE OF 91°30'45" TO A POINT OF TANGENCY; THENCE,
N 88°37'18" W, 310.34 FEET DISTANCE TO A POINT OF CURVATURE; THENCE,
NORTHWESTERLY, 342.26 FEET DISTANCE ALONG THE ARC OF A CURVE BEARING TO THE RIGHT HAVING A RADIUS OF 370.00 FEET AND A CENTRAL ANGLE OF 57°00'00" TO A POINT OF TANGENCY; THENCE,
N 35°37'18" W, 132.67 FEET DISTANCE TO A POINT OF CURVATURE; THENCE,
SOUTHWESTERLY, 699.04 FEET DISTANCE ALONG THE ARC OF A CURVE BEARING TO THE LEFT HAVING A RADIUS OF 330.00 FEET AND A CHORD WHICH BEARS S 84°33'43" W, 570.52 FEET TO A POINT ON CURVE AND THE SOUTHWEST CORNER OF SAID BLOCK 1; THENCE,
N 00°00'00" E, 638.01 FEET DISTANCE TO THE NORTHWEST CORNER AND POINT OF BEGINNING OF THE TRACT HEREIN DESCRIBED, CONTAINING 11.8720 ACRES, MORE OR LESS.

THIS IS TO CERTIFY THAT TAXES ARE CURRENT AND PAID ON UPC # 1-015-055-228-285-20340 90 Code
UPC # 1-015-055-152-326-20335 90 Code
PROPERTY OWNER OF RECORD:
AIRPORT JOINT VENTURE
BERNALILLO COUNTY TREASURER'S OFFICE:
KIRTLAND ADDITION UNIT 3
FILED 11-11-80, BK. C5, PG. 35
KIRTLAND PARK ADDITION
FILED 3-8-77, BK. C12, PG. 1

State of New Mexico)
County of Bernalillo)
This instrument was filed for record on
SEPT 01 1990
at the County Clerk's Office
By: *Carol J. McCarthy*
County Clerk

APPROVALS

Walt Whit 08-15-90
CHIEF, CITY ENGINEER DATE
John Thomas 8-21-90
PROPERTY MANAGER DATE
Michael H. Jank 8-21-90
TRACER ENGINEER DATE
Robert W. Kane 8-21-90
PARKS AND RECREATION DIRECTOR DATE
Robert W. Kane 8-21-90
WATER RESOURCES DEPARTMENT DATE
Frank J. Gagnier 9-5-90
ALBUQUERQUE METROPOLITAN AREA FLOOD CONTROL AUTHORITY DATE
Frank J. Gagnier 9-5-90
CITY ENGINEER, ENGINEERING DIVISION DATE
Frank J. Gagnier 9-10-90
PLANNING DIRECTOR, CITY/COUNTY PLANNING DIVISION DATE
PLAT NUMBER:
CASE NUMBER: DRB 90-301

SP-90-164

CURVE DATA			
NO.	DELTA	RADIUS	LENGTH
①	91°30'45"	30.00'	47.92'
②	57°00'00"	370.00'	342.26'
③	119°37'59"	330.00'	609.04'

SURVEYOR'S CERTIFICATE

I, GAYLE D. JEWELL, A REGISTERED LAND SURVEYOR UNDER THE LAWS OF THE STATE OF NEW MEXICO, DO HEREBY CERTIFY THAT THIS PLAT WAS PREPARED BY ME OR UNDER MY SUPERVISION, COMING ALL EASEMENTS OF RECORD, MEETS THE MINIMUM REQUIREMENTS FOR MONUMENTATION AND SURVEYS OF THE ALBUQUERQUE SUBDIVISION ORDINANCE, AND IS TRUE AND CORRECT TO THE BEST OF MY KNOWLEDGE AND BELIEF.

Gayle D. Jewell 13 Aug 90
GAYLE D. JEWELL, L.S. 4071 DATE



CITY OF ALBUQUERQUE
MILES WATERWORKS
TRACT 7
21A PUERTO
FILED: 4-5-79
BK. 05, PG. 134

TRACT A-4
REPLAT OF TR. A
MUNICIPAL
ADDITION No. 9
FILED: 5-12-86
BK. C24, PG. 146
NEW MEXICO

ANDREWS, ASBURY & ROBERT, INC.
CONSULTING ENGINEERS
801-460-1777
ALBUQUERQUE, NEW MEXICO