

CITY OF ALBUQUERQUE

Planning Department
David Campbell, Director



Mayor Timothy M. Keller

June 12, 2019

Mark Goodwin, P.E.
Mark Goodwin & Associates
PO Box 90606
Albuquerque, NM, 87199

**RE: Randolph Road Project
Grading and Drainage Plan
Engineer's Stamp Date: 05/28/19
Hydrology File: M15D046**

Dear Mr. Goodwin:

PO Box 1293

Based upon the information provided in your submittal received 05/29/2019, the Grading and Drainage Plan is approved for Paving Permit and Grading Permit.

Albuquerque

As a reminder, if the project total area of disturbance (including the staging area and any work within the adjacent Right-of-Way) is 1 acre or more, then an Erosion and Sediment Control (ESC) Plan and Owner's certified Notice of Intent (NOI) is required to be submitted to the Stormwater Quality Engineer (Curtis Cherne, PE, ccherne@cabq.gov, 924-3420) 14 days prior to any earth disturbance.

NM 87103

www.cabq.gov

Please provide a Drainage Covenant per Chapter 17 of the DPM for Stormwater Quality pond as soon as possible. Please submit this on the 4th floor of Plaza de Sol. A \$25 fee will be required.

If you have any questions, please contact me at 924-3995 or rbrissette@cabq.gov.

Sincerely,

Renée C. Brissette, P.E. CFM
Senior Engineer, Hydrology
Planning Department



City of Albuquerque

Planning Department
Development & Building Services Division

DRAINAGE AND TRANSPORTATION INFORMATION SHEET (REV 6/2018)

Project Title: Randolph Road Project Building Permit #: _____ Hydrology File #: _____

DRB#: _____ EPC#: _____ Work Order#: _____

Legal Description: Lot D-3, Newport Industrial Park-West Unit 1 within Section 33 Township 10 North, Range 3 east, NMPM City of Albuquerque, Bernalillo County, New Mexico

City Address: Randolph Rd SE, Albuquerque, NM 87106

Applicant: CSRA Contact: Jeff Nielsen

Address: 649 E South Temple Street, Salt Lake City, UT 84102

Phone#: 801-355-5915 Fax#: _____ E-mail: jnielsen@crsa-us.com

Other Contact: Mark Goodwin & Associates, PA Contact: Cory Pierce

Address: PO BOX 90606, Albuquerque, NM 87199

Phone#: 828.2200 Fax#: _____ E-mail: cory@goodwinengineers.com

TYPE OF DEVELOPMENT: _____ PLAT (# of lots) _____ RESIDENCE _____ DRB SITE X ADMIN SITE

IS THIS A RESUBMITTAL? _____ Yes X No

DEPARTMENT _____ TRANSPORTATION X HYDROLOGY/DRAINAGE

Check all that Apply:

TYPE OF SUBMITTAL:

- _____ ENGINEER/ARCHITECT CERTIFICATION
- _____ PAD CERTIFICATION
- _____ CONCEPTUAL G & D PLAN
- X _____ GRADING PLAN
- _____ DRAINAGE REPORT
- _____ DRAINAGE MASTER PLAN
- _____ FLOODPLAIN DEVELOPMENT PERMIT APPLIC
- _____ ELEVATION CERTIFICATE
- _____ CLOMR/LOMR
- _____ TRAFFIC CIRCULATION LAYOUT (TCL)
- _____ TRAFFIC IMPACT STUDY (TIS)
- _____ STREET LIGHT LAYOUT
- _____ OTHER (SPECIFY) _____
- _____ PRE-DESIGN MEETING?

TYPE OF APPROVAL/ACCEPTANCE SOUGHT:

- _____ BUILDING PERMIT APPROVAL
- _____ CERTIFICATE OF OCCUPANCY
- _____ PRELIMINARY PLAT APPROVAL
- _____ SITE PLAN FOR SUB'D APPROVAL
- _____ SITE PLAN FOR BLDG. PERMIT APPROVAL
- _____ FINAL PLAT APPROVAL
- _____ SIA/ RELEASE OF FINANCIAL GUARANTEE
- _____ FOUNDATION PERMIT APPROVAL
- X _____ GRADING PERMIT APPROVAL
- _____ SO-19 APPROVAL
- X _____ PAVING PERMIT APPROVAL
- _____ GRADING/ PAD CERTIFICATION
- _____ WORK ORDER APPROVAL
- _____ CLOMR/LOMR
- _____ FLOODPLAIN DEVELOPMENT PERMIT
- _____ OTHER (SPECIFY) _____

DATE SUBMITTED: May 29, 2019 By: Cory Pierce

COA STAFF:

ELECTRONIC SUBMITTAL RECEIVED: _____

FEE PAID: _____

LOT 12-A-1

RANDOLPH ROAD SE

LOT D-4

TRACT J

30' 15' 0' 30' 60'
SCALE: 1" = 30'

016.66H
AYMO PROGRAM SUMMARY TABLE (AYMO-S4)
INPUT FILE = -Project\191012 - Randolph Road\Drainage\ahymo_Randolph_Road_IN-C.txt
RUN DATE (MM/DD/YY) = 06/12/2019
USER NO. = M-Goodwin\BMS1\ca30075759
PAGE = 1
HYDROGRAPH ID ID AREA PEAK RUNOFF TIME TO CFS
IDENTIFICATION NO. NO. (SQ MI) (CFS) (AC-FT) (INCHES) (HOURS) PER NOTATION
COMMAND IDENTIFICATION NO. NO. (SQ MI) (CFS) (AC-FT) (INCHES) (HOURS) PER NOTATION
START LOCATION ALBUQUERQUE
*S RANDOLPH ROAD 19012
*S ON SITE RUNOFF
*S BY CITY PLANNING
RAINFALL TYPE= 1 NOAA 14
SEDIMENT BULK
COMPUTE HW BYD 202.00 - 3 0.00349 7.41 0.279 1.50177 1.530 3.321 PER EMP= 79.00
FINISH 016.66H
TIME= 0.00
RAINF= 1.900
PR BP= 1.06

SIDEWALK CULVERTS

Wier Depth (FT)	0.51
Width	2
Weir Coeff	2.6
Wier Discharge	3.79 (CFS)
x2 (Two sidewalk culverts)	7.58

DRAINAGE NARRATIVE:

RECENT STORM WATER QUALITY REQUIREMENTS OF THE CITY OF ALBUQUERQUE RESULT IN THE CAPTURE OF 0.34 INCHES OF RAINFALL OVER IMPERVIOUS SURFACES. THE IMPERVIOUS SURFACES OF THIS SITE INCLUDE THE PARKING LOT AREA AS WELL AS THE FLAT AREA IN THE NORTH EAST QUADRANT (FUTURE) TOTALING 76992 SF.

THE PROPOSED DESIGN CAPTURES THE REQUIRED WATER VOLUME WITHIN THE STORM WATER QUALITY POND AT THE LOW ELEVATIONS OF THE SITE.

FRENCH DRAINS ARE FEATURES OF THE DESIGN TO HASTEN INFILTRATION WITHIN THE PONDS WHEN RUNOFF IS CAPTURED FROM STORM EVENTS.

THE 100 YR 6 HR DESIGN STORM WILL FILL AND OVERFLOW FROM THE STORM WATER QUALITY POND THRU TWO(2) 24" WIDE SIDEWALK CULVERTS INTO RANDOLPH ROAD. THE 100 YR, 6 HR DISCHARGE WAS EVALUATED BY UTILIZING AIMO S4. INPUT TO INCLUDE SURFACE TREATMENTS, AND RAINFALL FROM NOAA 14 MITIGATED BY THE STORM WATER QUALITY RETENTION (0.34"). THE 100 YR PEAK DISCHARGE WAS EVALUATED TO BE 7.41 CFS. A WIER ANALYSIS WAS PERFORMED TO EVALUATE THE TWO(2) 24" SIDEWALK CULVERTS TO PASS THE 7.41 CFS AT AN ESTIMATED DEPTH OF 0.51'.

STORM WATER QUALITY VOLUME:

Proposed Impervious Area (SF)	76992
Storm Water Quality retention depth (inches):	0.34
Required Storm Water Quality Volume (CF):	2181

Proposed Storm Water Quality Retention Capacity:	
Temporary Retention Pond	
Depth (FT):	1.26
Bottom (SF) (58.40)	1,425
Top (SF) (60.03)	2,043
Volume (CF)	2,185

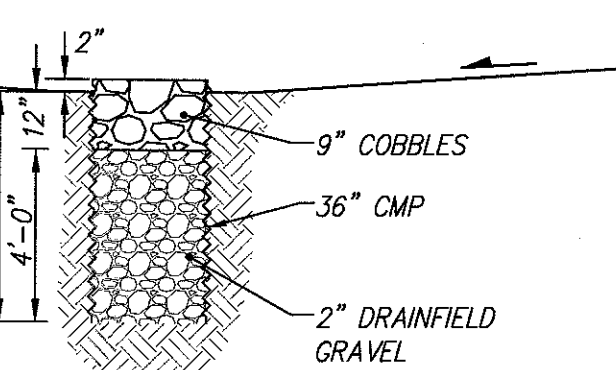

FRENCH DRAIN DETAIL
N.T.S.

UNDERGROUND UTILITIES CAUTION:

NOTE THAT ALL EXISTING UTILITIES MAY NOT BE SHOWN. ALL EXISTING SERVICE CONNECTIONS ARE NOT SHOWN. ANY EXISTING UTILITIES THAT ARE SHOWN ARE APPROXIMATE LOCATION ONLY. IT SHALL BE THE SOLE RESPONSIBILITY OF THE CONTRACTOR TO CONTACT ALL THE UTILITY OWNERS AND TO CONDUCT ALL NECESSARY FIELD INVESTIGATIONS PRIOR TO ANY EXCAVATIONS TO DETERMINE THE ACTUAL LOCATION OF UTILITIES AND OTHER IMPROVEMENTS.

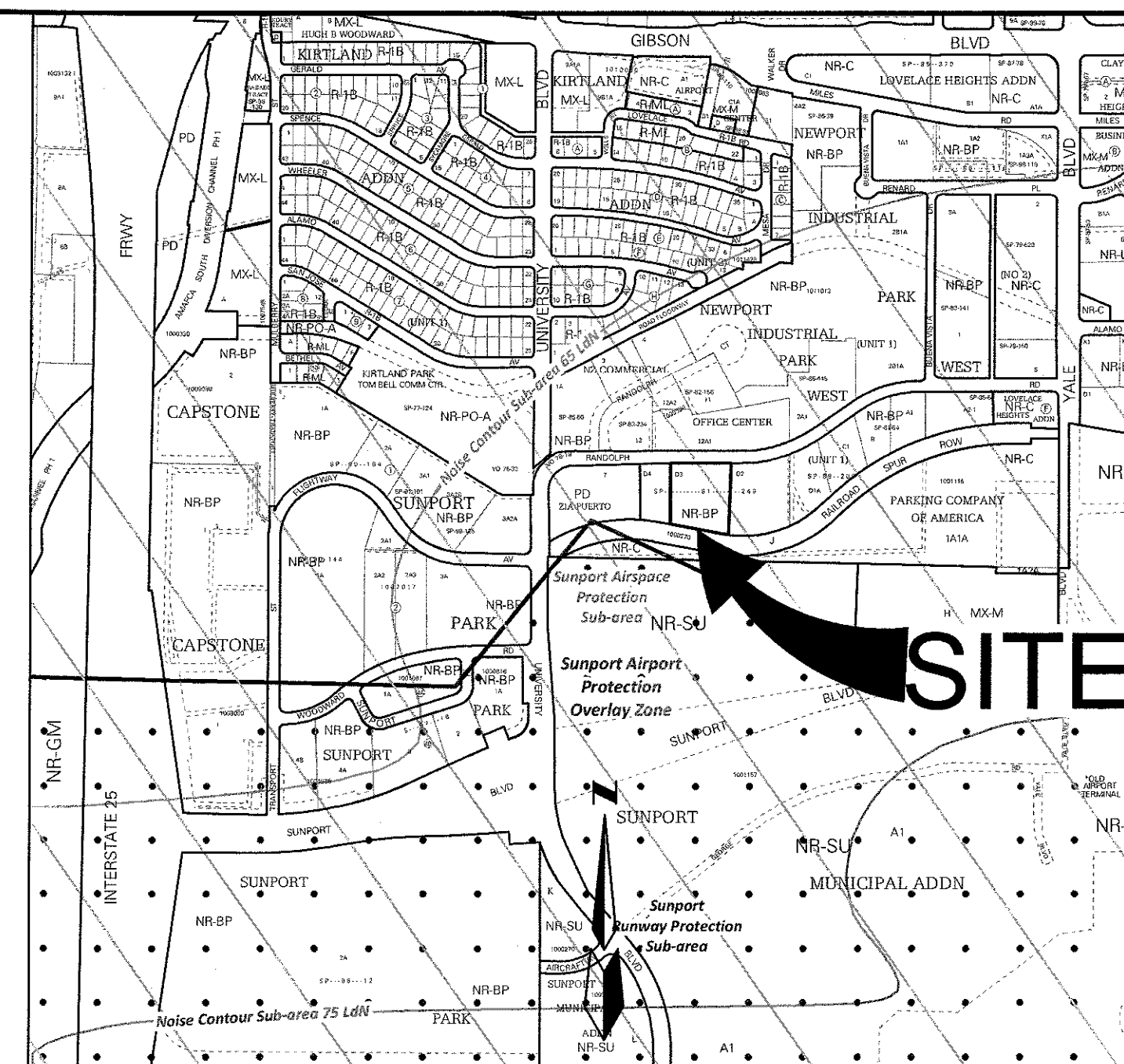

LOCATION MAP M-15-Z

LEGAL DESCRIPTION

LOT NUMBERED D-THREE (D-3), OF NEWPORT INDUSTRIAL PARK-WEST, UNIT 1, WITHIN SECTION 33, TOWNSHIP 10 NORTH, RANGE 3 EAST, CITY OF ALBUQUERQUE, BERNALILLO COUNTY, NEW MEXICO.

ACS BENCHMARKS

AGRS Brass Cap stamped "SDC-13-4"

From the Intersection of I-40 and Coors Road 0.2 miles to Ouray Road then along Ouray Road to the intersection of Ronda de Lechusos and a drainage channel. Then east along the south side of the channel 700 feet to the station.

Geographic Position, in feet (NAD83)

N.M. State Plane Coordinates (Central Zone)

N=1477145.578, E=1525011.494, G-G=0.999677909, DA=-00°13'17.49"

Elevation, in feet (NAVD88) = 5043.390

GENERAL NOTES:

- CONTRACTOR MUST OBTAIN A TOPSOIL DISTURBANCE PERMIT FROM THE ENVIRONMENTAL HEALTH DIVISION PRIOR TO CONSTRUCTION.
- CITY OF ALBUQUERQUE STANDARD SPECIFICATIONS FOR PUBLIC WORKS CONSTRUCTION, LATEST EDITION SHALL GOVERN ALL WORK.
- THE CONTRACTOR SHALL CONFORM TO ALL CITY, COUNTY, STATE AND FEDERAL DUST CONTROL MEASURES AND REQUIREMENTS AND WILL BE RESPONSIBLE FOR PREPARING AND OBTAINING ALL NECESSARY APPLICATIONS AND APPROVALS.
- THE CONTRACTOR SHALL ENSURE THAT NO SOIL ERODES FROM THE LOTS INTO PUBLIC RIGHT-OF-WAY. THIS CAN BE ACHIEVED BY CONSTRUCTING TEMPORARY BERMS AND WETTING THE SOIL TO KEEP IT FROM BLOWING.
- NO WORK ALLOWED IN THE PUBLIC RIGHT OF WAY WITHOUT AN APPROVED WORK ORDER.
- THE SITE IS NOT IN A FLOOD PLAIN IN ACCORDANCE WITH FEMA MAP 35001C0342G, EFFECTIVE DATE SEPTEMBER 26, 2008.

KEYED NOTES

- 5' WIDE SIDEWALK PER CITY OF ALBUQUERQUE DWG 2340
- TWO 2' WIDE SIDEWALK CULVERTS PER CITY OF ALBUQUERQUE DWG 2236. SAW CUT EXISTING CURB AND GUTTER.
- MEDIAN CURB AND GUTTER PER CITY OF ALBUQUERQUE DWG 2415B
- 4" MINUS RIPRAP (13 SY)
- FRENCH DRAIN, SEE DETAIL
- GRAVEL MULCH SLOPE
- SAWCUT AND REMOVE EXISTING CURB AND PAVEMENT AS REQUIRED
- REMOVE EXISTING TREE AND ASPHALT

LEGEND

- 5165- CONTOUR-MAJOR
- CONTOUR-MINOR
- TC= TOP CURB/FLOWLINE
- FL= SPOT ELEV
- x 00.00 CURB AND GUTTER
- CONCRETE/SIDEWALK
- WALL OR HEAD WALL
- SANITARY SEWER MANHOLE
- SANITARY SEWER
- STORM DRAIN MANHOLE
- CATCH BASIN/DROP INLET
- STORM DRAIN
- FIRE HYDRANT
- WATER VALVE
- WATER
- GAS MARKER-UG
- GAS METER
- TELEPHONE/FIBER OPTIC MANHOLE
- FIBER OPTIC PULL BOX
- FIBER OPTIC
- SIGN
- TREE

Randolph Road Project

GRADING & DRAINAGE PLAN

dmg MARK GOODWIN & ASSOCIATES, P.A.
CONSULTING ENGINEERS
P.O. BOX 90606
ALBUQUERQUE, NEW MEXICO 87199
(505)828-2200, FAX (505)797-9539

Designed: HC/ CP Drawn: SPS/ CP Checked: DMG
Scale: 1" = 30' Date: 5/24/2019 Job: A19012 Sheet 1 of 1