

CITY OF ALBUQUERQUE

Planning Department
David Campbell, Director



Mayor Timothy M. Keller

May 7, 2019

Steve Morrow, P.E.
Molzen-Corbin & Associates
2701 Miles Road SE
Albuquerque, NM 87106

**RE: Girard Landscape Improvements
Grading and Drainage Plan
Engineer's Stamp Date: 4/15/19 (G006, G007) & 5/6/19 (G005)
Hydrology File: M16D043**

Dear Mr. Morrow:

Based on the submittal received on 4/24/19, the Grading and Drainage Plan is approved for Grading Permit and Work Order.

PO Box 1293

If you have any questions, please contact me at 924-3695 or dpeterson@cabq.gov.

Albuquerque

Sincerely,

NM 87103

www.cabq.gov

Dana Peterson, P.E.
Senior Engineer, Planning Dept.
Development Review Services



City of Albuquerque

Planning Department
Development & Building Services Division

DRAINAGE AND TRANSPORTATION INFORMATION SHEET (REV 6/2018)

Project Title: Girard Landscape Improvements **Building Permit #:** _____ **Hydrology File #:** M-16D024N
DRB#: 1000270 **EPC#:** _____ **Work Order#:** 770010
Legal Description: A portion of Tract A-1, Sunport Municipal Addition
City Address: 2628 Sunport Boulevard SE, Albuquerque, NM 87106

Applicant: Molzen Corbin **Contact:** _____
Address: 2701 Miles Road SE, Albuquerque, NM 87106
Phone#: (505) 242-5700 **Fax#:** _____ **E-mail:** _____

Other Contact: City of Albuquerque Aviation Dept. **Contact:** Rhonda Methvin, PE
Address: PO Box 9948, Albuquerque, NM 87119
Phone#: (505) 244-7738 **Fax#:** _____ **E-mail:** RMethvin@cabq.gov

TYPE OF DEVELOPMENT: _____ PLAT (# of lots) _____ RESIDENCE ☒ DRB SITE _____ ADMIN SITE

IS THIS A RESUBMITTAL? ☒ Yes _____ No

DEPARTMENT _____ TRANSPORTATION ☒ HYDROLOGY/DRAINAGE

Check all that Apply:

TYPE OF SUBMITTAL:

- ☐ ENGINEER/ARCHITECT CERTIFICATION
- ☐ PAD CERTIFICATION
- ☐ CONCEPTUAL G & D PLAN
- ☒ GRADING PLAN
- ☐ DRAINAGE REPORT
- ☐ DRAINAGE MASTER PLAN
- ☐ FLOODPLAIN DEVELOPMENT PERMIT APPLIC
- ☐ ELEVATION CERTIFICATE
- ☐ CLOMR/LOMR
- ☐ TRAFFIC CIRCULATION LAYOUT (TCL)
- ☐ TRAFFIC IMPACT STUDY (TIS)
- ☐ STREET LIGHT LAYOUT
- ☐ OTHER (SPECIFY) _____
- ☐ PRE-DESIGN MEETING?

TYPE OF APPROVAL/ACCEPTANCE SOUGHT:

- ☐ BUILDING PERMIT APPROVAL
- ☐ CERTIFICATE OF OCCUPANCY
- ☐ PRELIMINARY PLAT APPROVAL
- ☐ SITE PLAN FOR SUB'D APPROVAL
- ☐ SITE PLAN FOR BLDG. PERMIT APPROVAL
- ☐ FINAL PLAT APPROVAL
- ☐ SIA/ RELEASE OF FINANCIAL GUARANTEE
- ☐ FOUNDATION PERMIT APPROVAL
- ☒ GRADING PERMIT APPROVAL
- ☐ SO-19 APPROVAL
- ☐ PAVING PERMIT APPROVAL
- ☐ GRADING/ PAD CERTIFICATION
- ☐ WORK ORDER APPROVAL
- ☐ CLOMR/LOMR
- ☐ FLOODPLAIN DEVELOPMENT PERMIT
- ☐ OTHER (SPECIFY) _____

DATE SUBMITTED: 04-24-2019 **By:** Steve Morrow, PE

COA STAFF:

ELECTRONIC SUBMITTAL RECEIVED: _____

FEE PAID: _____



CITY OF ALBUQUERQUE

DEPARTMENT OF MUNICIPAL DEVELOPMENT

ALBUQUERQUE, NEW MEXICO

APRIL 2019

construction plans for the:

GIRARD LANDSCAPE IMPROVEMENTS

Albuquerque International Sunport
2200 Sunport Blvd. SE
Albuquerque, New Mexico 87106

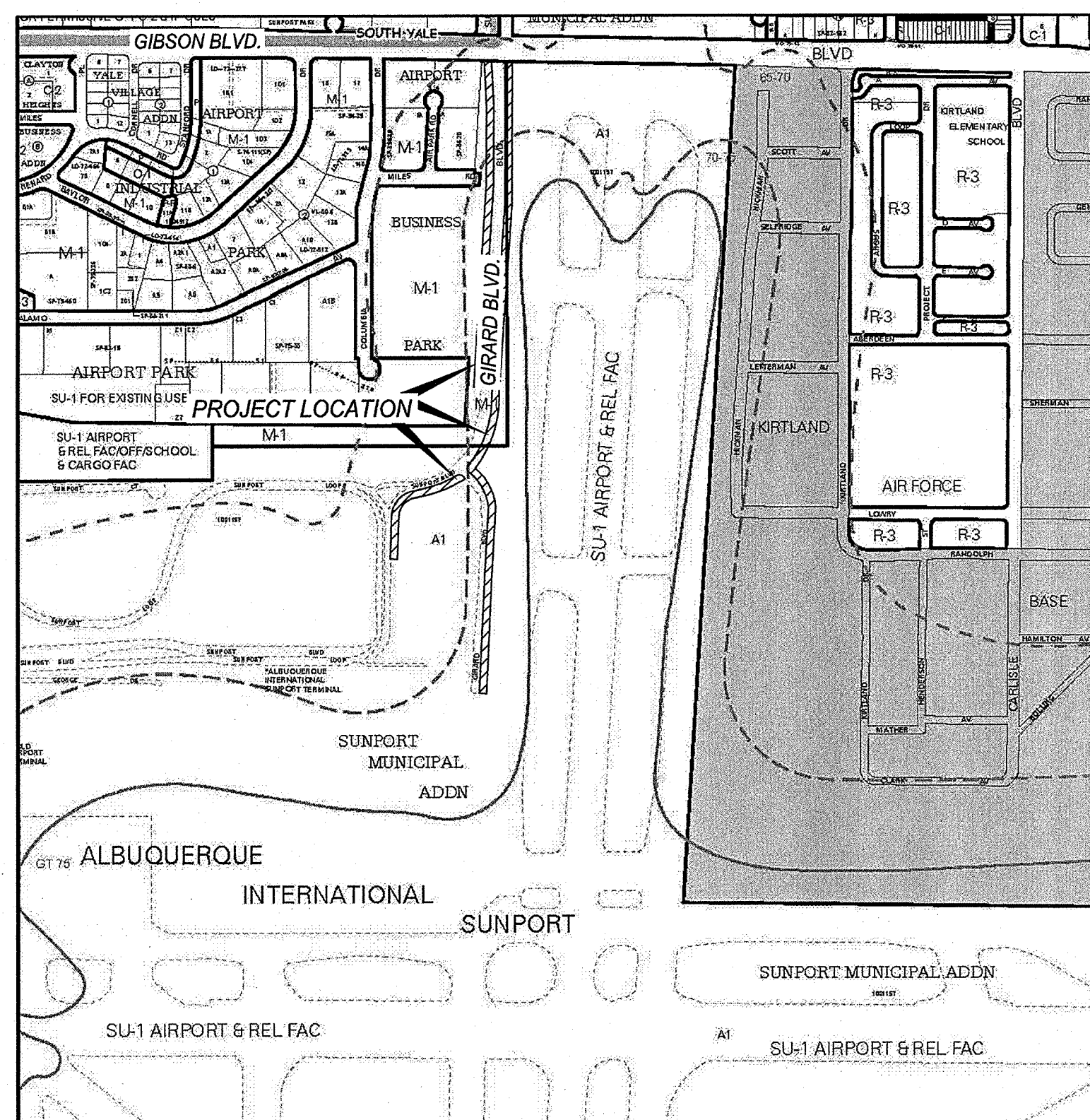

VICINITY MAP
COA ZONE ATLAS MAP M-16

THESE DRAWINGS DO NOT INCLUDE NECESSARY COMPONENTS FOR THE CONSTRUCTION SAFETY WHICH SHALL REMAIN THE RESPONSIBILITY OF THE CONTRACTOR.

NUMERIC SCALE CONFIRMATION

DRAWINGS ARE DEPICTED AT INTENDED
NUMERIC SCALES
IF THIS BAR EQUALS ONE INCH

MOLZENCORBIN
ENGINEERS | ARCHITECTS | PLANNERS

2701 Miles Road SE, Albuquerque, New Mexico 87106 505 242 5700 office 505 242 0673 fax

CERTIFICATION:

I, JOHN QUINN PATE, REGISTERED LANDSCAPE ARCHITECT NO. 0087
HEREBY CERTIFY THAT THE FOLLOWING PLANS AND DESIGNS WERE
MADE UNDER MY SUPERVISION AND DIRECTION AND THAT SAME IS
TRUE AND CORRECT TO THE BEST OF MY KNOWLEDGE AND BELIEF



N.M.R.L.A.

4/15/19
NO. 0087

CERTIFICATION:

I, STEVEN K. MORROW, REGISTERED
PROFESSIONAL ENGINEER NO. 13679
HEREBY CERTIFY THAT THE FOLLOWING PLANS AND
DESIGNS WERE MADE UNDER MY SUPERVISION
AND DIRECTION AND THAT SAME IS TRUE AND CORRECT
TO THE BEST OF MY KNOWLEDGE AND BELIEF

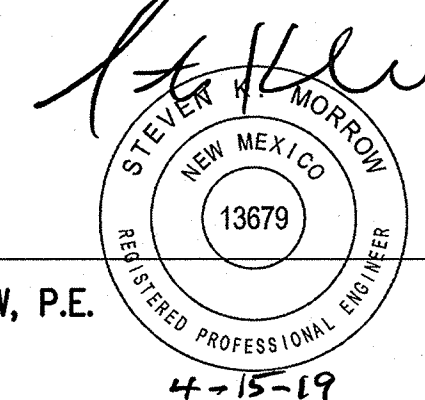

STEVEN K. MORROW, P.E.

NO. 13679
4-15-19

APPROVAL

James D. Hinder 4-12-19
AVIATION DEPARTMENT DATE

REV.	SHEETS	CITY ENGINEER	DATE	USER DEPARTMENT	DATE	USER DEPARTMENT	DATE		
			APPROVALS		DATE	*****			
			DRC Chairman						
			Transportation						
			Water/Wastewater						
			Hydrology						
			Constr. Mngnt.						
						City Engineer		Date	
City Project No.					770010		Sheet of		
							G-001		

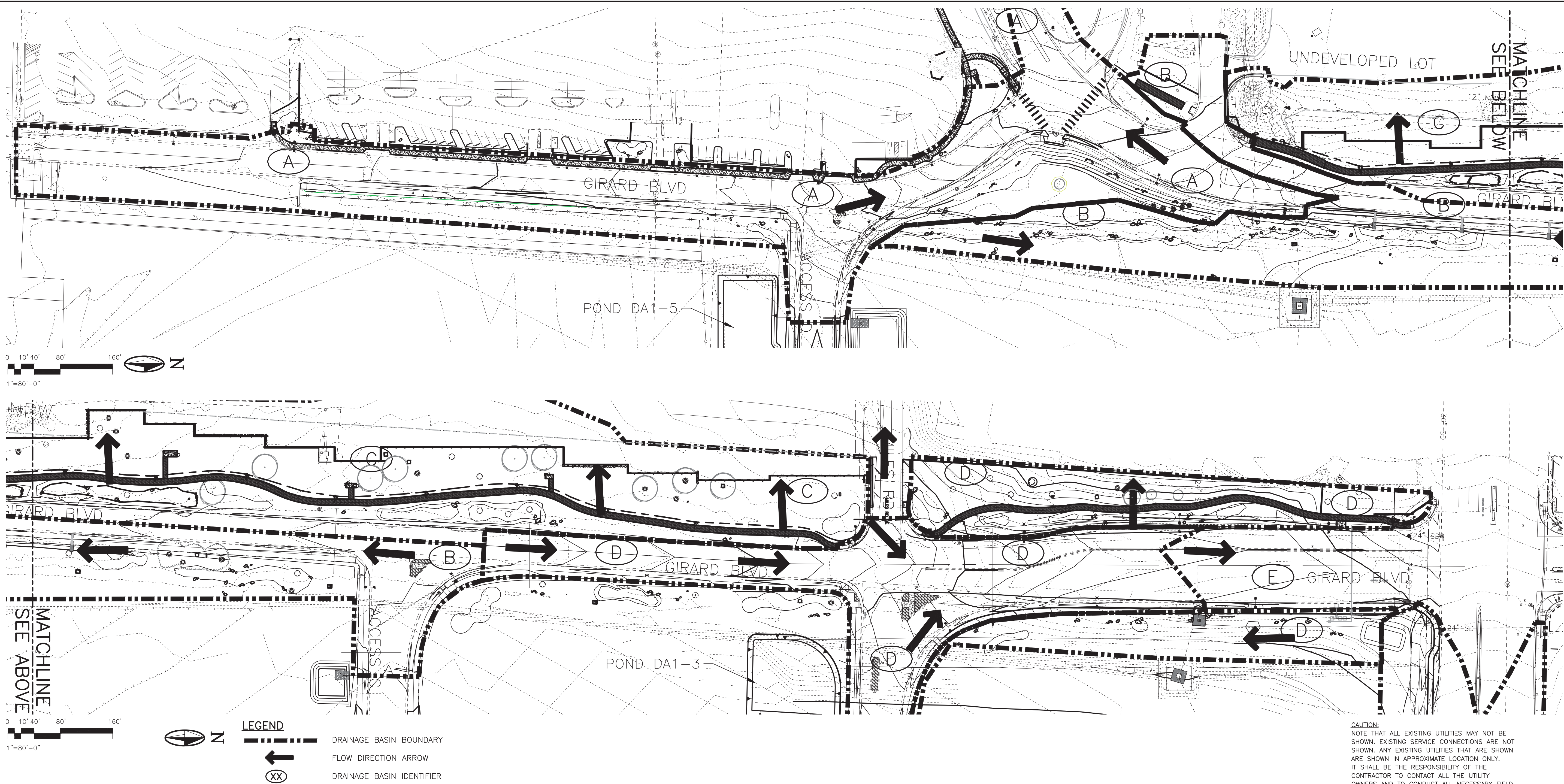

DRAINAGE CONDITIONS:

BASIN A
ADDITIONAL SIDEWALK AND SOME GRADING ARE NOT EXPECTED TO INCREASE OR CHANGE THE EXISTING DRAINAGE CONDITIONS. THE MOST SOUTHERN SECTION OF GIRARD BLVD FROM ITS TERMINATION AT THE SUNPORT TO THE INTERSECTION OF SUNPORT BLVD AND GIRARD HAS CURB AND GUTTER, AND RUNOFF FLOWS NORTH TO THE INTERSECTION. AT THE INTERSECTION RUNOFF FLOWS WEST, WHERE AN INLET IS LOCATED ON THE NORTHERN SECTION OF SUNPORT BLVD. THIS INLET TO A 24" SYSTEM CONNECTS TO THE EXISTING 42" SYSTEM THAT OUTFALLS INTO THE KIRTLAND CHANNEL AND FINALLY OUTLETS INTO THE SOUTH DIVERSION CHANNEL. THE 100 YEAR/24 HOUR RUNOFF FROM BASIN A TO THE 24" SYSTEM IS 13.84 CFS.

BASIN B
SOUTH OF MILES RD., GIRARD BLVD HAS CURB AND GUTTER AND TYPE C INLETS THAT WILL CAPTURE THIS AREA DRAINAGE. THESE INLETS WILL CAPTURE THE ADDITIONAL AREA AND ROUTE IT TO THE 42" SYSTEM. THE LANDSCAPED AREA EAST OF GIRARD WILL FLOW SOUTH TO A 24" CMP THAT CONNECTS TO THE EXISTING 42" SYSTEM. THAT SYSTEM OUTFALLS INTO THE KIRTLAND CHANNEL AND EVENTUALLY THE SOUTH DIVERSION CHANNEL. THE 100 YEAR/24 HOUR RUNOFF FROM BASIN B TO THE 42" SYSTEM IS 11.66 CFS.

THE EXISTING POND DA1-5, SHOWN ON SHEET G-006, THAT WAS CONSTRUCTED AS PART OF PROJECT 751580 IS TO BE EXPANDED TO A VOLUME OF 29400 CUBIC FEET, AS PER DESIGN IN THAT PROJECT. THE POND IS MAINTAINED BY THE COA AVIATION DEPARTMENT, AND RELOCATION IN THE FUTURE IS POSSIBLE IF COMPLIANCE WITH THE AVIATION CENTER OF EXCELLENCE APPROVED DRAINAGE MASTERPLAN (M16D024N) IS MAINTAINED.

BASIN C
THE WEST HALF OF GIRARD BLVD. HAS CURB AND GUTTER WITH CURB CUTS, AND THIS IMPERVIOUS. THE LANDSCAPE AREA WILL BE MODIFIED WITH LANDSCAPED ROCK AND SMALL DETENTION PONDS. THE EXISTING TRAIL WILL BE REMOVED AND REPLACED SOUTH OF MILES RD., AND WILL SHEET FLOW WEST. THE TOPOGRAPHY INDICATES A WESTWARD FLOW TO MULTIPLE OUTFALLS DEPENDENT ON THE TOPOGRAPHY OF THE VACANT LOT. THE PROPOSED IMPROVEMENTS WILL REDUCE 100 YEAR/24 HOUR RUNOFF FROM BASIN C TO THE UNDEVELOPED LOT TO THE WEST BY 1.60 CFS.

BASIN D
SOUTH OF THE INTERSECTION OF GIRARD AND MILES RD, GIRARD BLVD HAS CURB AND GUTTER, DIRECTING THAT RUNOFF TO BASIN D. IMPROVEMENTS TO THE TRAIL AREA INCLUDE REMOVAL AND REPLACEMENT OF THE TRAIL, AND LANDSCAPING. DIRECTION OF RUNOFF WILL NOT BE AFFECTED. RUNOFF FROM THE GRASS LANDSCAPED AREAS ALONG THE ROAD IS UNCHANGED. THE OUTFALL OF THESE AREAS IS DEPENDENT ON THE TOPOGRAPHY WITH THE EAST AREA DRAINING TO A 24" SYSTEM THAT EVENTUALLY CONNECTS TO THE GIBSON BLVD STORM SYSTEM NEAR COLUMBIA BLVD. THE WEST PARK AREA ALONG GIRARD SHEET FLOWS WEST WHERE IT IS INTERCEPTED IN TO THE PREVIOUSLY REFERENCED 24" SYSTEM. THE FINAL OUTFALL OF THE GIBSON BLVD STORM SYSTEM IS GENEVA'S ARROYO, AND TERMINATES IN THE SOUTH DIVERSION CHANNEL. THE 100 YEAR/24 HOUR RUNOFF TO THE 24" SYSTEM IS 13.94 CFS.

BASIN D CONTINUED
THE EXISTING POND DA1-3, SHOWN ON SHEET G-007, THAT WAS CONSTRUCTED AS PART OF PROJECT 751580 IS TO BE PROPERLY CONSTRUCTED TO A VOLUME OF 17000 CUBIC FEET, AS PER DESIGN IN THAT PROJECT. THE POND IS MAINTAINED BY THE COA AVIATION DEPARTMENT, AND RELOCATION IN THE FUTURE IS POSSIBLE IF COMPLIANCE WITH THE AVIATION CENTER OF EXCELLENCE APPROVED DRAINAGE MASTERPLAN (M16D024N) IS MAINTAINED.

BASIN E
RUNOFF FROM GIBSON BLVD IS COLLECTED INTO A 36" STORM DRAIN SYSTEM VIA CURB INLETS ALONG GIBSON BLVD. ANY BYPASS RUNOFF FROM BASIN D OF GIRARD BLVD. THE CURB AND GUTTER WILL DIRECT THIS RUNOFF TO INLETS AT THE INTERSECTION OF GIBSON AND GIRARD. FROM THE AIA DMP THE 36" STORM DRAIN IS PART OF A SYSTEM THAT OUTFALLS AT GENEVA'S ARROYO AND FINALLY THE SOUTH DIVERSION CHANNEL. THE 100 YEAR/24 HOUR RUNOFF TO THE GIBSON 36" STORM DRAIN IS 35.39 CFS.

REFER TO THE TABLES ON THIS SHEET G-006 FOR MORE INFORMATION ON SUB-BASINS. REFER TO THIS SHEET FOR BASIN LOCATIONS. SEE GRADING AND DRAINAGE SHEET FOR INLET LOCATIONS. THESE NEW INLETS MUST BE MAINTAINED TO OPERATE AS DESIGNED IN THIS REPORT.

SITE OUTFALLS			
OUTFALL	EXISTING RUNOFF Q100(CFS)	PROPOSED RUNOFF Q100(CFS)	ADDITIONAL RUNOFF Q100 (CFS)
24" SD (A)	13.84	13.84	0.00
42" (B)	11.66	11.66	0.00
SHEET FLOW (C)	1.60	1.60	0.00
24" SD (D)	13.94	13.94	0.00
GIBSON 36" SD (E)	35.39	35.39	0.00

CAUTION:
NOTE THAT ALL EXISTING UTILITIES MAY NOT BE SHOWN. EXISTING SERVICE CONNECTIONS ARE NOT SHOWN. ANY EXISTING UTILITIES THAT ARE SHOWN ARE SHOWN IN APPROXIMATE LOCATION ONLY. IT SHALL BE THE RESPONSIBILITY OF THE CONTRACTOR TO CONTACT ALL THE UTILITY OWNERS AND TO CONDUCT ALL NECESSARY FIELD INVESTIGATIONS PRIOR TO ANY EXCAVATION TO DETERMINE THE ACTUAL LOCATION OF UTILITIES AND OTHER IMPROVEMENTS.

MOLZENCORBIN

2701 Miles Road SE Albuquerque, New Mexico 87106

CITY OF ALBUQUERQUE PUBLIC WORKS DEPARTMENT ENGINEERING DEVELOPMENT GROUP			
TITLE: GIRARD LANDSCAPE IMPROVEMENTS			
BASIN MAP AND DRAINAGE REPORT			
Design Review Committee	City Engineer Approval	Last Design Update	
		Mo./Day/Yr. Mo./Day/Yr.	
City Project No. 770010		Zone Map No. M-16	Sheet 5 Of xx G-005

ENGINEER'S SEAL		SURVEY INFORMATION		BENCH MARKS		AS BUILT INFORMATION	
NO.		FIELD NOTES		19-L16 - 3 1/4 INCH ALUMINUM DISC		CONTRACTOR	
BY		DATE		N=479188.5779 E=52270.696 CL=5297.51		WORK	
REMARKS		NO.		14-L17 - 3 1/4 INCH ALUMINUM DISC		STAKED BY	
BY		DATE		N=480697.724 E=53406.820		ACCEPTANCE BY	
REVISIONS		NO.		NAD 83 NAVD 88 - CENTRAL ZONE		DATE	
DESIGN		DATE		MICRO-FILM INFORMATION		DATE	
DESIGNED BY SM / RD		APRIL 2019		RECORDED BY		DATE	
DRAWN BY RD		APRIL 2019		NO.			
CHECKED BY SM		APRIL 2019					

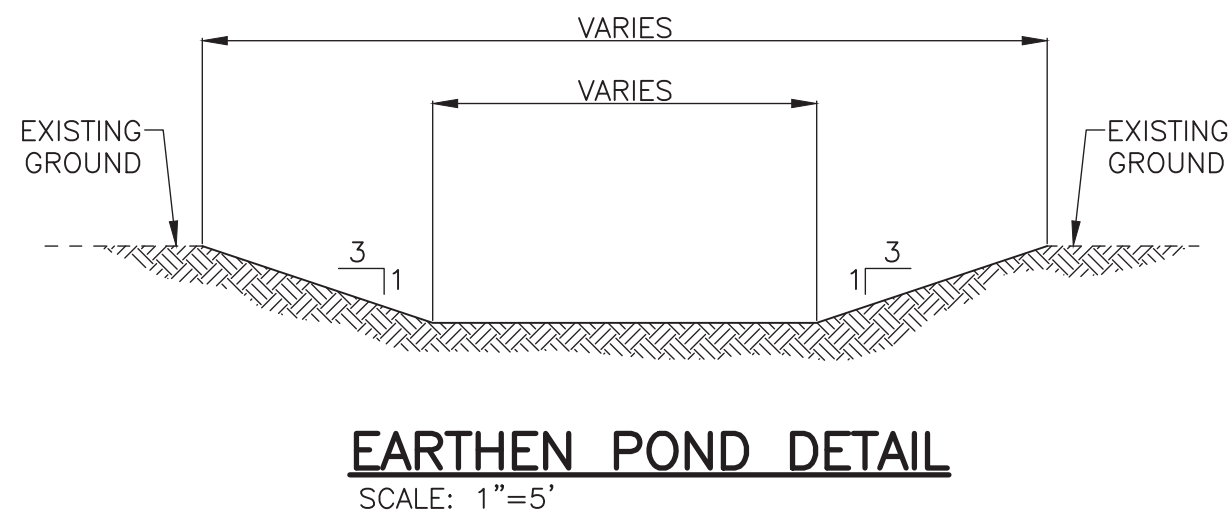
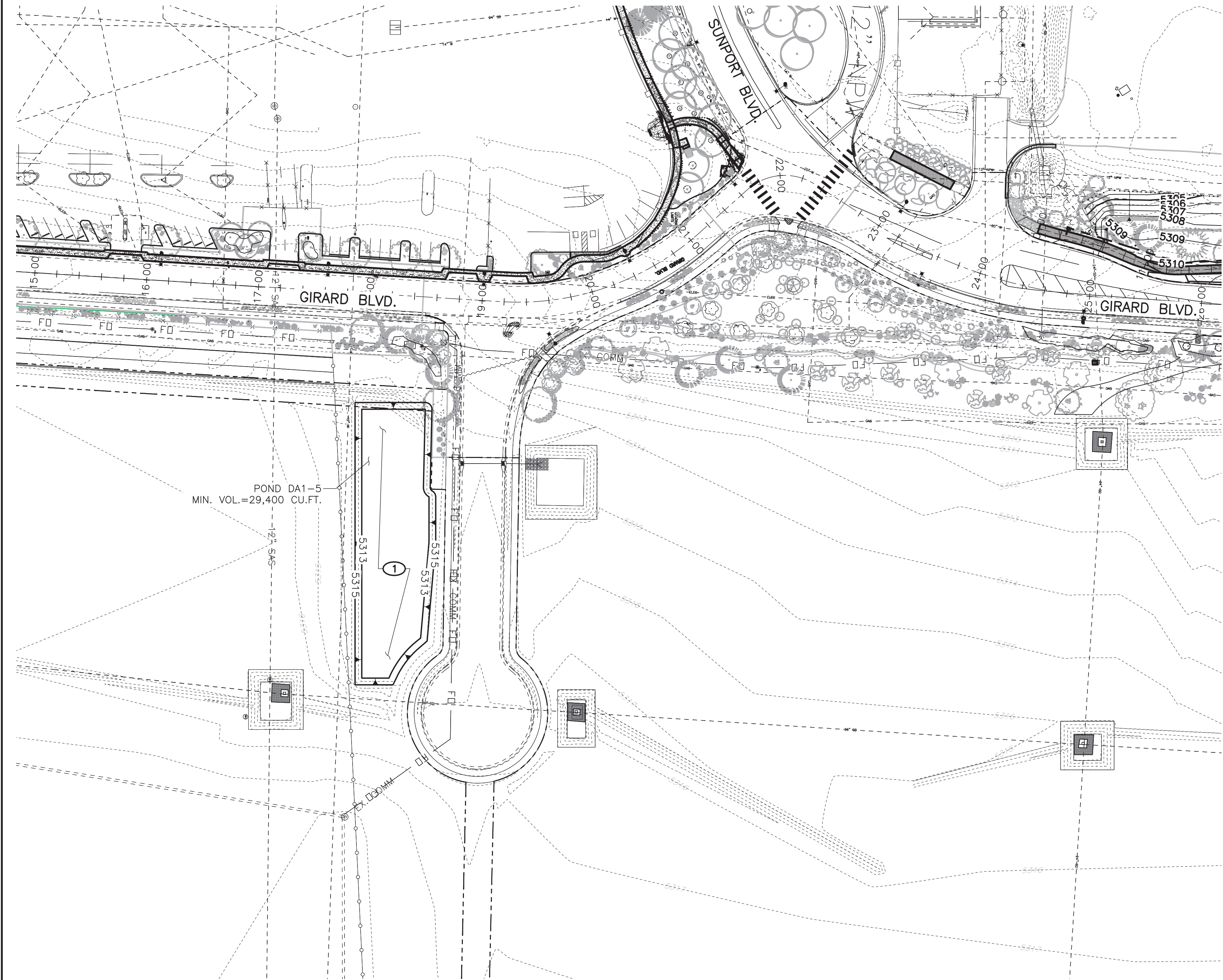

KEYED NOTES
① EARTHEN POND SEE DETAIL THIS SHEET

CAUTION: NOTE THAT ALL EXISTING UTILITIES MAY NOT BE SHOWN. EXISTING SERVICE CONNECTIONS ARE NOT SHOWN. ANY EXISTING UTILITIES THAT ARE SHOWN ARE SHOWN IN APPROXIMATE LOCATION ONLY. IT SHALL BE THE RESPONSIBILITY OF THE CONTRACTOR TO CONTACT ALL THE UTILITY OWNERS AND TO CONDUCT ALL NECESSARY FIELD INVESTIGATIONS PRIOR TO ANY EXCAVATION TO DETERMINE THE ACTUAL LOCATION OF UTILITIES AND OTHER IMPROVEMENTS.

MOLZENCORBIN
2701 Miles Road SE Albuquerque, New Mexico 87106

CITY OF ALBUQUERQUE
PUBLIC WORKS DEPARTMENT
ENGINEERING DEVELOPMENT GROUP

TITLE: GIRARD LANDSCAPE IMPROVEMENTS

OFFSITE GRADING (SOUTH)

Design Review Committee	City Engineer Approval	Last Design Update	Mo./Day/Yr.	Mo./Day/Yr.
City Project No.		Zone Map No.	Sheet X	Of
770010		M-16	G-006	

ENGINEER'S SEAL		SURVEY INFORMATION		BENCH MARKS		AS BUILT INFORMATION	
		NO.	BY	DATE	19-L16 - 3 1/4 INCH ALUMINUM DISC N=479188.5779, E=532270.696, EL.=5297.51	CONTRACTOR	
						VOI STAKED BY	DATE
						ACCEPTANCE BY	DATE
						FIELD VERIFICATION BY	DATE
						DRAWINGS CORRECTED BY	DATE
						MICRO-FILM INFORMATION	
						RECORDED BY	DATE
						NO.	

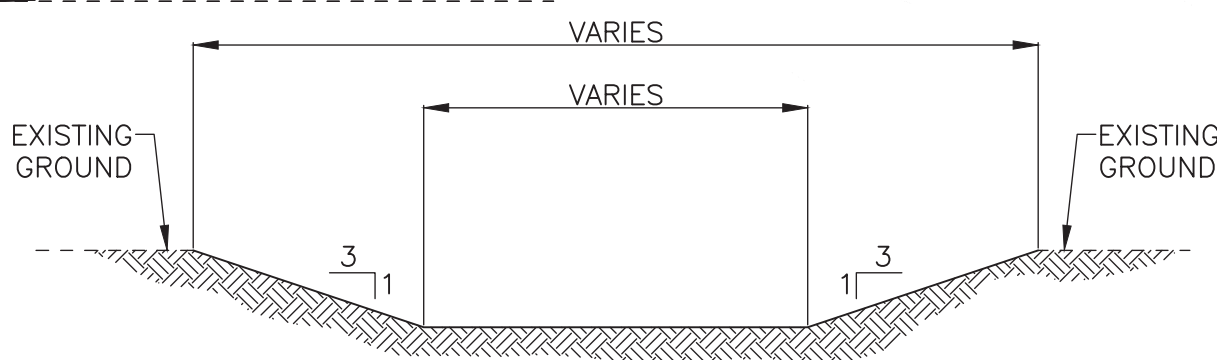
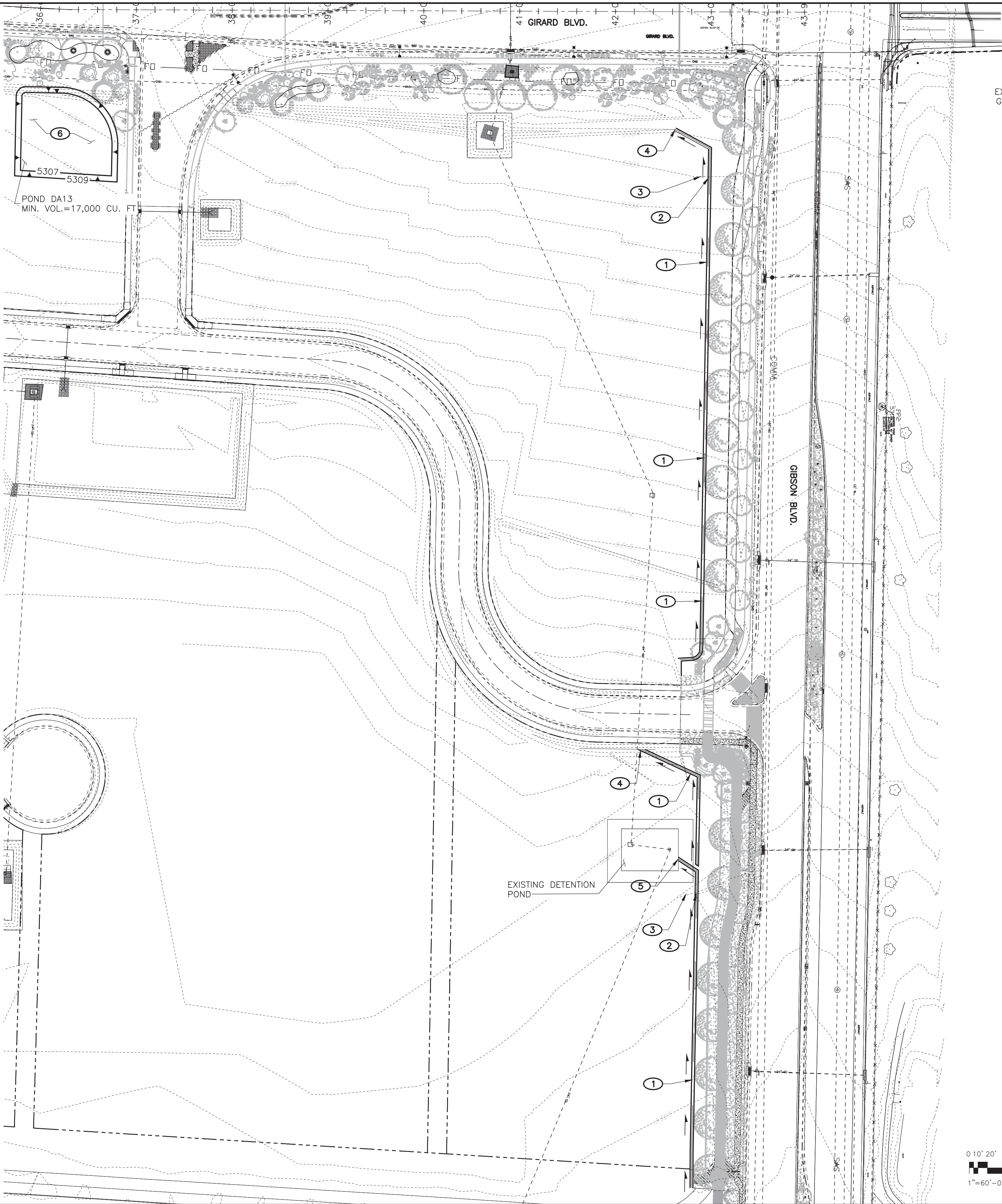

EARTHEN POND DETAIL
SCALE: 1"=5'

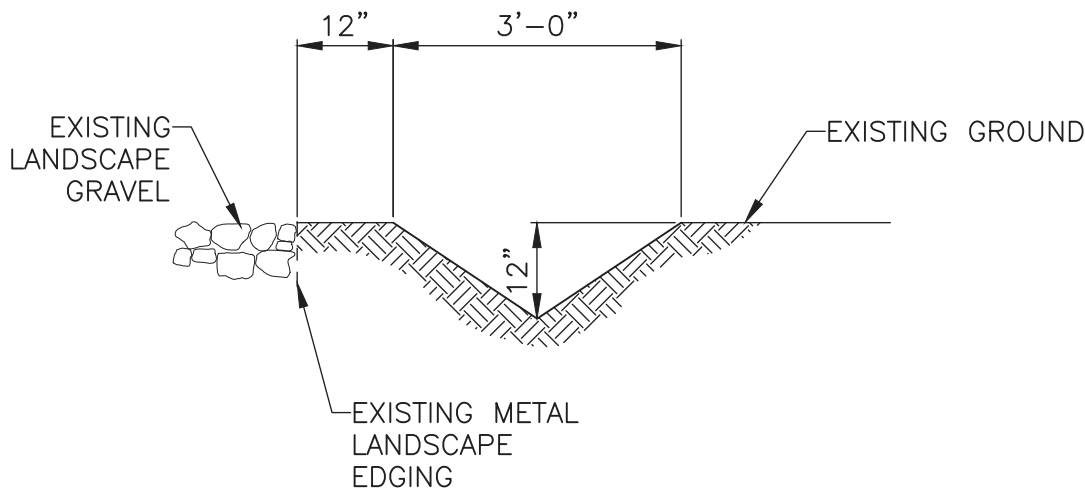

EARTHEN SWALE DETAIL
SCALE: 1"=2'

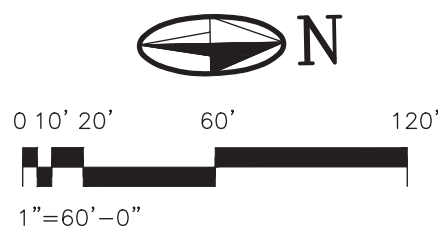

- KEYED NOTES**
- 1 EARTHEN SWALE SEE DETAIL THIS SHEET
 - 2 ADJUST EARTHEN SWALE TO MAINTAIN POSITIVE FLOW
 - 3 TO MITIGATE EROSION GRADE SLOPE AT BACK 4:1 ON HIGH POINTS
 - 4 TIE EARTHEN SWALE TO EXISTING EARTHEN SWALE. LOCATION OF EXISTING EARTHEN SWALE END UNKNOWN FIELD VERIFY
 - 5 TIE EARTHEN SWALE TO EXISTING POND
 - 6 EARTHEN POND SEE DETAIL THIS SHEET

GENERAL SHEET NOTE

1. RELOCATION OF IRRIGATION LINES, IRRIGATION APPURTENANCES AND LANDSCAPING SHALL BE INCIDENTAL TO THE WORK OF THE CONTRACT.

CAUTION: NOTE THAT ALL EXISTING UTILITIES MAY NOT BE SHOWN. EXISTING SERVICE CONNECTIONS ARE NOT SHOWN. ANY EXISTING UTILITIES THAT ARE SHOWN ARE SHOWN IN APPROXIMATE LOCATION ONLY. IT SHALL BE THE RESPONSIBILITY OF THE CONTRACTOR TO CONTACT ALL THE UTILITY OWNERS AND TO CONDUCT ALL NECESSARY FIELD INVESTIGATIONS PRIOR TO ANY EXCAVATION TO DETERMINE THE ACTUAL LOCATION OF UTILITIES AND OTHER IMPROVEMENTS.

MOLZENCORBIN

2701 Miles Road SE Albuquerque, New Mexico 87106

CITY OF ALBUQUERQUE
PUBLIC WORKS DEPARTMENT
ENGINEERING DEVELOPMENT GROUP

TITLE: GIRARD LANDSCAPE IMPROVEMENTS

OFFSITE GRADING (NORTH)

Design Review Committee	City Engineer Approval	Last Design Update	Mo./Day/Yr.	Mo./Day/Yr.
City Project No.	Zone Map No.	Sheet	X	Of
770010	M-16	G-007		

ENGINEER'S SEAL		SURVEY INFORMATION		BENCH MARKS		AS BUILT INFORMATION	
				NO.	FIELD NOTES	19-L16 – 3 1/4 INCH ALUMINUM DISC N=479188.5779, E=532270.698, EL.=5297.51	CONTRACTOR FOUNDED BY INSPECTED BY ACCEPTANCE BY VERIFICATION BY DRAWINGS CORRECTED BY MICRO – FILM INFORMATION
				BY	DATE	14-L17 – 3 1/4 INCH ALUMINUM DISC N=480697.7724 E=534906.820	DATE
						NAD 83 NAVD 88 – CENTRAL ZONE	DATE
							NO.
REVISIONS		REVISIONS		REVISIONS		REVISIONS	
DESIGN		DESIGN		DESIGN		DESIGN	
DESIGNED BY	JLB	DATE	APRIL 2019	DATE	APRIL 2019	DATE	APRIL 2019
DRAWN BY	JSL	DATE	APRIL 2019	DATE	APRIL 2019	DATE	APRIL 2019
CHECKED BY	SKM	DATE	APRIL 2019	DATE	APRIL 2019	DATE	APRIL 2019