

98TH STREET

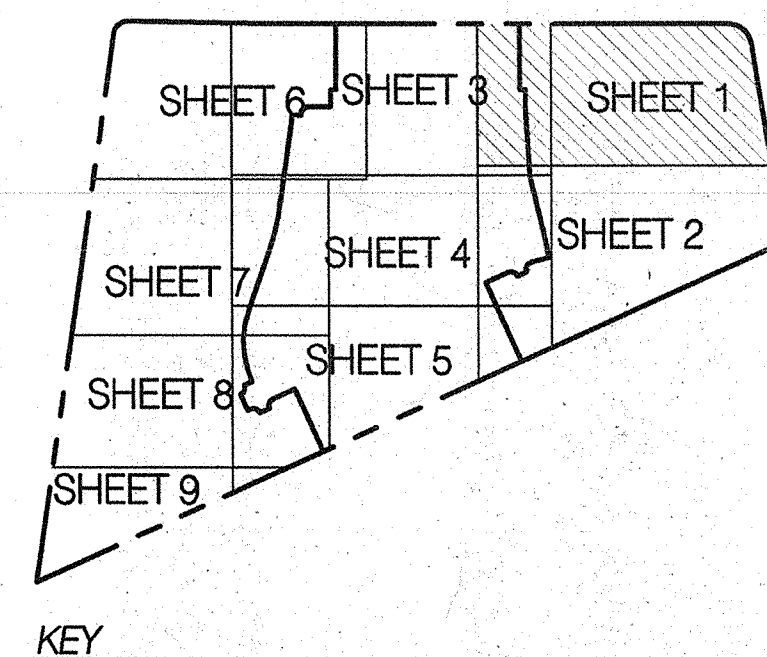

KEY

GENERAL NOTES

1. ALL WORK DETAILED ON THESE PLANS AND PERFORMED UNDER THIS CONTRACT SHALL BE CONSTRUCTED IN ACCORDANCE WITH THE PROJECT SPECIFICATIONS AND THE PROJECT GEOTECHNICAL REPORT, WHERE APPLICABLE, CITY OF ALBUQUERQUE PUBLIC WORKS STANDARDS SHALL APPLY.
2. THE CONTRACTOR SHALL ABIDE BY ALL LOCAL, STATE, AND FEDERAL LAWS, RULES AND REGULATIONS WHICH APPLY TO THE CONSTRUCTION OF THESE IMPROVEMENTS, INCLUDING EPA REQUIREMENTS WITH RESPECT TO STORM WATER DISCHARGE.
3. PRIOR TO CONSTRUCTION, THE CONTRACTOR SHALL FIELD VERIFY THE HORIZONTAL AND VERTICAL LOCATIONS OF ALL POTENTIAL OBSTRUCTIONS INCLUDING ALL UNDERGROUND UTILITIES. SHOULD A CONFLICT EXIST, THE CONTRACTOR SHALL NOTIFY THE CONSTRUCTION OBSERVER OR ENGINEER SO THAT THE CONFLICT CAN BE RESOLVED WITH A MINIMUM AMOUNT OF DELAY.
4. TWO (2) WORKING DAYS PRIOR TO ANY EXCAVATION, THE CONTRACTOR SHALL CONTACT LINE LOCATING SERVICE FOR LOCATION OF EXISTING UTILITIES.
5. ALL ELECTRICAL, TELEPHONE, CABLE TV, GAS AND OTHER UTILITY LINES, CABLES, AND APPURTENANCES ENCOUNTERED DURING CONSTRUCTION INCLUDING ALL UNDERGROUND UTILITIES, SHOULD BE COORDINATED WITH THAT UTILITY. THE CONTRACTOR SHALL BE RESPONSIBLE FOR COORDINATION OF ALL NECESSARY UTILITY ADJUSTMENTS. NO ADDITIONAL COMPENSATION WILL BE ALLOWED FOR DELAYS OR INCONVENIENCES CAUSED BY UTILITY COMPANY WORK CREWS. THE CONTRACTOR MAY BE REQUIRED TO RESCHEDULE HIS ACTIVITIES TO ALLOW UTILITY CREWS TO PERFORM THEIR REQUIRED WORK.
6. THE CONTRACTOR IS RESPONSIBLE FOR VERIFYING LOCATION & ELEVATION OF ALL EXISTING UTILITIES PRIOR TO CONSTRUCTION. THE CONTRACTOR IS ALSO RESPONSIBLE FOR PROTECTING ALL EXISTING UTILITY LINES WITHIN THE CONSTRUCTION AREA. ANY DAMAGE TO EXISTING FACILITIES CAUSED BY CONSTRUCTION ACTIVITY SHALL BE REPAIRED OR REPLACED AT THE CONTRACTOR'S EXPENSE AND APPROVED BY THE CONSTRUCTION OBSERVER.
7. CONSTRUCTION ACTIVITY SHALL BE LIMITED TO THE PROPERTY AND/OR PROJECT LIMITS. ANY DAMAGE TO ADJACENT PROPERTIES RESULTING FROM THE CONSTRUCTION PROCESS SHALL BE REPAIRED OR REPLACED AT THE CONTRACTOR'S EXPENSE.
8. OVERNIGHT PARKING OF CONSTRUCTION EQUIPMENT SHALL NOT OBSTRUCT DRIVEWAYS OR DESIGNATED TRAFFIC LANES. THE CONTRACTOR SHALL NOT STORE ANY EQUIPMENT OR MATERIAL WITHIN THE PUBLIC RIGHT-OF-WAY.
9. THE CONTRACTOR SHALL OBTAIN ALL THE NECESSARY PERMITS FOR THE PROJECT PRIOR TO COMMENCING CONSTRUCTION (I.E., BARRICADES, TOPSOIL DISTURBANCE, EXCAVATION PERMITS, EPA STORM WATER PERMITS, ETC.).
10. ALL PROPERTY CORNERS DESTROYED DURING CONSTRUCTION SHALL BE REPLACED AT THE CONTRACTOR'S EXPENSE. ALL PROPERTY CORNERS MUST BE RESET BY A REGISTERED LAND SURVEYOR.
11. ALL BARRICADES AND CONSTRUCTION SIGNING SHALL CONFORM TO APPLICABLE SECTIONS OF THE "MANUAL ON UNIFORM TRAFFIC CONTROL DEVICES" (MUTCD), US DEPARTMENT OF TRANSPORTATION, LATEST EDITION.
12. THE CONTRACTOR SHALL MAINTAIN ALL CONSTRUCTION BARRICADES AND SIGNING AT ALL TIMES. THE CONTRACTOR SHALL VERIFY THE PROPER LOCATION OF ALL BARRICADE AT THE END AND BEGINNING OF EACH DAY.
13. THE CONTRACTOR SHALL TAKE ALL STEPS NECESSARY TO CONFORM WITH EPA REQUIREMENTS, INCLUDING COMPLIANCE WITH NPDES PHASE 2 REQUIREMENTS.
14. THE CONTRACTOR IS RESPONSIBLE FOR SPPP PREPARATION AND IMPLEMENTATION.

KEYED NOTES

- * A. INSTALL 4" DIA. TYPE "E" MANHOLE PER COA STD. DWG. 2102.
- B. RETAINING WALL BY OTHERS. SEE SHEET C2.11 FOR TYPICAL RETAINING WALL NOMENCLATURE.
- * C. INSTALL TYPE "D" SINGLE GRATE INLET, PER COA STD DWG 2206.
- * D. INSTALL PVC MEDIAN CULVERT. SEE PLAN FOR SIZE AND ELEVATIONS. SEE DETAIL SHEET C2.11.
- * E. 2' CURB CUT PER DETAIL SHEET C2.11.
- * F. MODIFIED 4" DIA. TYPE "C" MANHOLE/INLET. SEE DETAIL SHEET C2.11.
- * G. MODIFIED 6" DIA. TYPE "C" MANHOLE/INLET. SEE DETAIL SHEET C2.11.
- * H. 1' RIBBON CHANNEL. SEE DETAIL SHEET C2.10.
- * I. SINGLE GRATE TYPE "A" INLET, PER COA STD DWGS 2201 & 2202.
- * J. DEBRIS TREATMENT MANHOLE SYSTEM PER DETAILS SHEET C2.11
- * K. INSTALL 6" DIA TYPE "E" MANHOLE PER COA STD DWG 2102.
- L. INSTALL 4" DIA PVC SIDEWALK CULVERT.
- * M. BUILD 10' WIDE 2" AC TRAIL PER COA STD DWG 2415B
- * N. INSTALL 6" DIA PVC SIDEWALK CULVERT.

* Not used this sheet.

MATERIALS:

SD LINE: CLASS II ROP OR HOPE (UNLESS OTHERWISE NOTED ON PLANS)

NOTICE TO CONTRACTORS

1. CONTRACTOR SHALL ADJUST ALL MANHOLES TO FINISHED GRADE PER COA STD. DWG. 2111.
2. 10' WIDE AC TRAIL SHALL BE CONSTRUCTED IN ACCORDANCE WITH THE CITY OF ALBUQUERQUE STANDARD SPECIFICATIONS FOR PUBLIC WORKS CONSTRUCTION, 1986 EDITION AS REVISED THROUGH UPDATE JRS.

GRADING NOTES

1. EXCEPT AS PROVIDED HEREIN, GRADING SHALL BE PERFORMED AT THE ELEVATIONS AND IN ACCORDANCE WITH THE DETAILS SHOWN ON THIS PLAN.
2. ALL WORK RELATIVE TO FOUNDATION CONSTRUCTION, SITE PREPARATION, AND PAVEMENT INSTALLATION, AS SHOWN ON THIS PLAN, SHALL BE CONSTRUCTED IN ACCORDANCE WITH THE "GEOTECHNICAL INVESTIGATION" AS PROVIDED BY THE ARCHITECT OR OWNER. ALL OTHER WORK SHALL UNLESS OTHERWISE STATED OR PROVIDED FOR HEREON, BE CONSTRUCTED IN ACCORDANCE WITH THE CITY OF ALBUQUERQUE STANDARD SPECIFICATIONS FOR PUBLIC WORKS.
3. EARTH SLOPES SHALL NOT EXCEED 3 HORIZONTAL TO 1 VERTICAL UNLESS SHOWN OTHERWISE.
4. IT IS THE INTENT OF THESE PLANS THAT THIS CONTRACTOR SHALL NOT PERFORM ANY WORK OUTSIDE OF THE PROPERTY BOUNDARIES EXCEPT AS REQUIRED BY THIS PLAN.
5. THE CONTRACTOR IS TO ENSURE THAT NO SOIL ERODES FROM THE SITE ONTO ADJACENT PROPERTY OR PUBLIC RIGHT-OF-WAY. THIS SHOULD BE ACHIEVED BY CONSTRUCTING TEMPORARY BERMS OR SILT FENCE AT THE PROPERTY LINES AND WETTING THE SOIL TO PROTECT IT FROM WIND EROSION.
6. A DISPOSAL SITE FOR ANY & ALL EXCESS EXCAVATION MATERIAL, AND UNSUITABLE MATERIAL AND/OR A BORROW SITE CONTAINING ACCEPTABLE FILL MATERIAL SHALL BE OBTAINED BY THE CONTRACTOR IN COMPLIANCE WITH APPLICABLE ENVIRONMENTAL REGULATIONS AND APPROVED BY THE OBSERVER. ALL COSTS INCURRED IN OBTAINING A DISPOSAL OR BORROW SITE AND Haul TO OR FROM SHALL BE CONSIDERED INCIDENTAL TO THE PROJECT AND NO SEPARATE MEASUREMENT OR PAYMENT SHALL BE MADE.
7. VERIFY ALL ELEVATIONS SHOWN ON PLAN FROM BASIS OF ELEVATION CONTROL STATION PRIOR TO BEGINNING CONSTRUCTION.
8. ALL CURB IS 6" MEDIAN CURB UNLESS OTHERWISE NOTED. ALL ELEVATIONS ARE TAKEN AT THE FLOWLINE OF THE CURB UNLESS OTHERWISE NOTED.
9. ALL ELEVATIONS SHOWN ALONG MEDIAN CURB ARE AT FLOWLINE UNLESS OTHERWISE INDICATED.

LEGEND

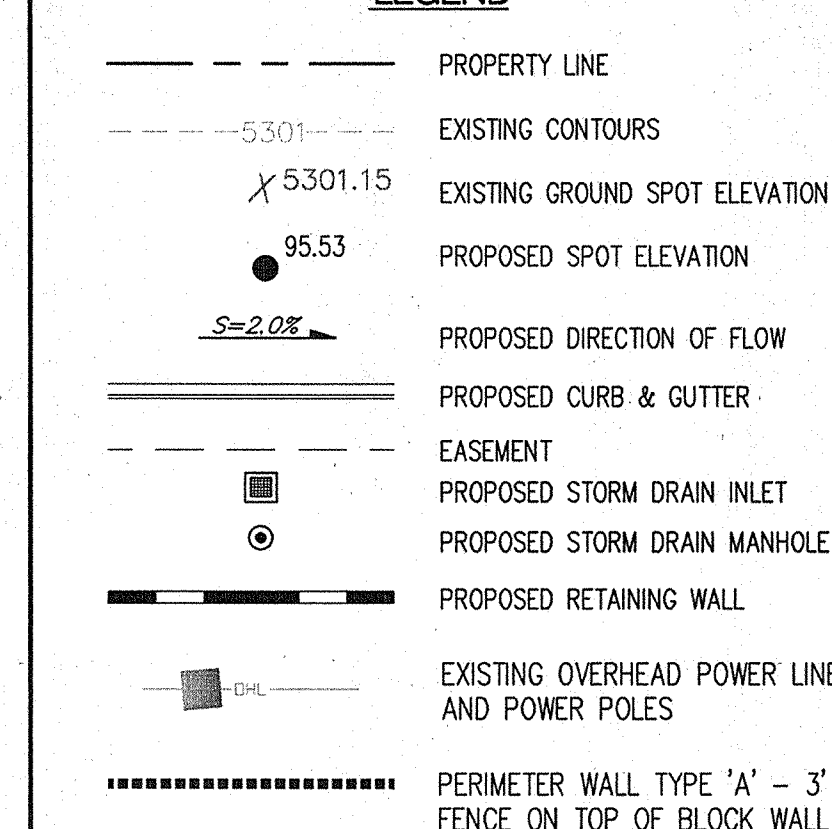

Bohannon & Huston

No. Date Issue / Description

Project :

DIAMOND MESA

ALBUQUERQUE, N.M.

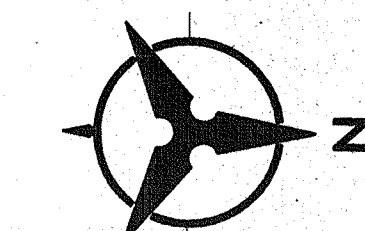

20 10 0 20
1" = 20'

ACS BRASS TABLET STAMPED "TRANS"
Geographic Position (NAD 1927)
N.M. State Plane Coordinates (Central Zone)
X= 354,899.45 Y= 1,471,822.67
Ground-to-Grid Factor = 0.99967921
ΔX = -00'16"42"
SLD 1929 Elevation = 5118.43

License Stamp:



Project Contact:
Phone #:
Fax #:
E-Mail:

Principal in Charge :
Project Director :
Project Designer:
Project Manager:

Sheet Title :

**GRADING & DRAINAGE
PLAN**

Sheet No. :

C2.01

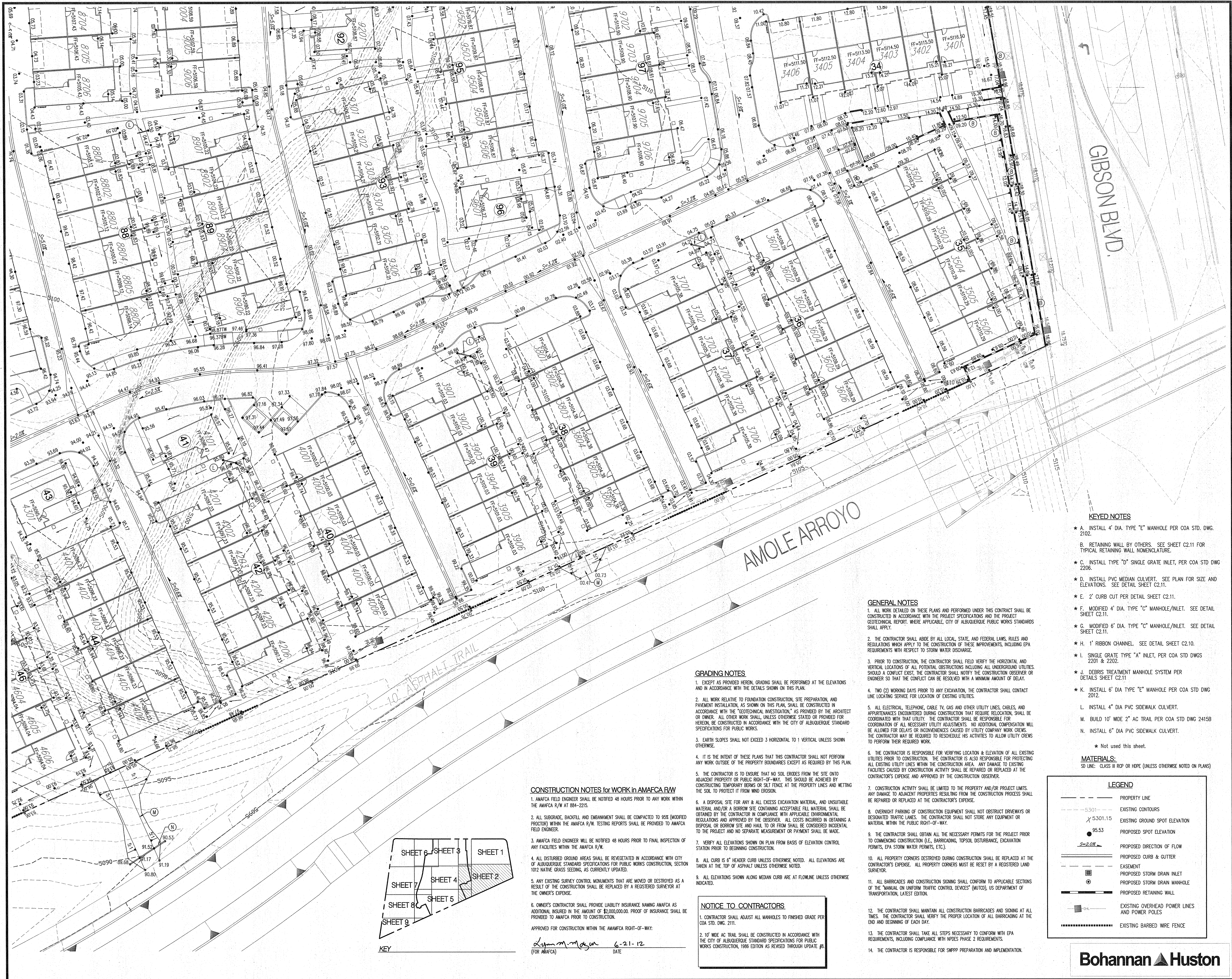

CONSTRUCTION NOTES for WORK in AMAFCA RW

1. AMAFCA FIELD ENGINEER SHALL BE NOTIFIED 48 HOURS PRIOR TO ANY WORK WITHIN THE AMAFCA R/W AT 884-2215.
2. ALL SUBGRADE, BACKFILL AND EMBANKMENT SHALL BE COMPACTED TO 95% (MODIFIED PROCTOR) WITHIN THE AMAFCA R/W. TESTING REPORTS SHALL BE PROVIDED TO AMAFCA FIELD ENGINEER.
3. AMAFCA FIELD ENGINEER WILL BE NOTIFIED 48 HOURS PRIOR TO FINAL INSPECTION OF ANY FACILITIES WITHIN THE AMAFCA R/W.
4. ALL DISTURBED GROUND AREAS SHALL BE REVEGETATED IN ACCORDANCE WITH CITY OF ALBUQUERQUE STANDARD SPECIFICATIONS FOR PUBLIC WORKS CONSTRUCTION, SECTION 1012 NATIVE GRASS SEEDING, AS CURRENTLY UPDATED.
5. ANY EXISTING SURVEY CONTROL MONUMENTS THAT ARE MOVED OR DESTROYED AS A RESULT OF THE CONSTRUCTION SHALL BE REPLACED BY A REGISTERED SURVEYOR AT THE OWNER'S EXPENSE.
6. OWNER'S CONTRACTOR SHALL PROVIDE LIABILITY INSURANCE NAMING AMAFCA AS ADDITIONAL INSURED IN THE AMOUNT OF \$2,000,000.00. PROOF OF INSURANCE SHALL BE PROVIDED TO AMAFCA PRIOR TO CONSTRUCTION.

APPROVED FOR CONSTRUCTION WITHIN THE AMAFCA RIGHT-OF-WAY:

Lyman Morgan
(FOR AMAFCA) 6-21-12
DATE

NOTICE TO CONTRACTORS

1. CONTRACTOR SHALL ADJUST ALL MANHOLES TO FINISHED GRADE PER COA STD. DWG. 2111.
2. 10' WIDE AC TRAIL SHALL BE CONSTRUCTED IN ACCORDANCE WITH THE CITY OF ALBUQUERQUE STANDARD SPECIFICATIONS FOR PUBLIC WORKS CONSTRUCTION, 1986 EDITION AS REVISED THROUGH UPDATE JR.

GENERAL NOTES

1. ALL WORK DETAILED ON THESE PLANS AND PERFORMED UNDER THIS CONTRACT SHALL BE CONSTRUCTED IN ACCORDANCE WITH THE PROJECT SPECIFICATIONS AND THE PROJECT GEOTECHNICAL REPORT, WHERE APPLICABLE. CITY OF ALBUQUERQUE PUBLIC WORKS STANDARDS SHALL APPLY.
2. THE CONTRACTOR SHALL ABIDE BY ALL LOCAL, STATE, AND FEDERAL LAWS, RULES AND REGULATIONS WHICH APPLY TO THE CONSTRUCTION OF THESE IMPROVEMENTS, INCLUDING EPA REQUIREMENTS WITH RESPECT TO STORM WATER DISCHARGE.
3. PRIOR TO CONSTRUCTION, THE CONTRACTOR SHALL FIELD VERIFY THE HORIZONTAL AND VERTICAL LOCATIONS OF ALL POTENTIAL OBSTRUCTIONS INCLUDING ALL UNDERGROUND UTILITIES. SHOULD A CONFLICT EXIST, THE CONTRACTOR SHALL NOTIFY THE CONSTRUCTION OBSERVER OR ENGINEER SO THAT THE CONFLICT CAN BE RESOLVED WITH A MINIMUM AMOUNT OF DELAY.
4. TWO (2) WORKING DAYS PRIOR TO ANY EXCAVATION, THE CONTRACTOR SHALL CONTACT LINE LOCATING SERVICE FOR LOCATION OF EXISTING UTILITIES.
5. ALL ELECTRICAL, TELEPHONE, CABLE TV, GAS AND OTHER UTILITY LINES, CABLES, AND APPURTENANCES ENCOUNTERED DURING CONSTRUCTION THAT REQUIRE RELOCATION, SHALL BE COORDINATED WITH THAT UTILITY. THE CONTRACTOR SHALL BE RESPONSIBLE FOR COORDINATION OF ALL NECESSARY UTILITY ADJUSTMENTS. NO ADDITIONAL COMPENSATION WILL BE ALLOWED FOR DELAYS OR INCONVENIENCES CAUSED BY UTILITY COMPANY WORK CREWS. THE CONTRACTOR MAY BE REQUIRED TO RESCHEDULE HIS ACTIVITIES TO ALLOW UTILITY CREWS TO PERFORM THEIR REQUIRED WORK.
6. THE CONTRACTOR IS RESPONSIBLE FOR VERIFYING LOCATION & ELEVATION OF ALL EXISTING UTILITIES PRIOR TO CONSTRUCTION. THE CONTRACTOR IS ALSO RESPONSIBLE FOR PROTECTING ALL EXISTING UTILITY LINES WITHIN THE CONSTRUCTION AREA. ANY DAMAGE TO EXISTING FACILITIES CAUSED BY CONSTRUCTION ACTIVITY SHALL BE REPAIRED OR REPLACED AT THE CONTRACTOR'S EXPENSE AND APPROVED BY THE CONSTRUCTION OBSERVER.
7. CONSTRUCTION ACTIVITY SHALL BE LIMITED TO THE PROPERTY AND/OR PROJECT LIMITS. ANY DAMAGE TO ADJACENT PROPERTIES RESULTING FROM THE CONSTRUCTION PROCESS SHALL BE REPAIRED OR REPLACED AT THE CONTRACTOR'S EXPENSE.
8. OVERNIGHT PARKING OF CONSTRUCTION EQUIPMENT SHALL NOT OBSTRUCT DRIVEWAYS OR DESIGNATED TRAFFIC LANES. THE CONTRACTOR SHALL NOT STORE ANY EQUIPMENT OR MATERIAL WITHIN THE PUBLIC RIGHT-OF-WAY.
9. THE CONTRACTOR SHALL OBTAIN ALL THE NECESSARY PERMITS FOR THE PROJECT PRIOR TO COMMENCING CONSTRUCTION (I.E., BARRICADEING, TOPSOIL DISTURBANCE, EXCAVATION PERMITS, EPA STORM WATER PERMITS, ETC.).
10. ALL PROPERTY CORNERS DESTROYED DURING CONSTRUCTION SHALL BE REPLACED AT THE CONTRACTOR'S EXPENSE. ALL PROPERTY CORNERS MUST BE RESET BY A REGISTERED LAND SURVEYOR.
11. ALL BARRICADES AND CONSTRUCTION SIGNING SHALL CONFORM TO APPLICABLE SECTIONS OF THE "MANUAL ON UNIFORM TRAFFIC CONTROL DEVICES" (MUTCD), US DEPARTMENT OF TRANSPORTATION, LATEST EDITION.
12. THE CONTRACTOR SHALL MAINTAIN ALL CONSTRUCTION BARRICADES AND SIGNING AT ALL TIMES. THE CONTRACTOR SHALL VERIFY THE PROPER LOCATION OF ALL BARRICADE AT THE END AND BEGINNING OF EACH DAY.
13. THE CONTRACTOR SHALL TAKE ALL STEPS NECESSARY TO CONFORM WITH EPA REQUIREMENTS, INCLUDING COMPLIANCE WITH NPDES PHASE 2 REQUIREMENTS.
14. THE CONTRACTOR IS RESPONSIBLE FOR SWPPP PREPARATION AND IMPLEMENTATION.

GRADING NOTES

1. EXCEPT AS PROVIDED HEREIN, GRADING SHALL BE PERFORMED AT THE ELEVATIONS AND IN ACCORDANCE WITH THE DETAILS SHOWN ON THIS PLAN.
2. ALL WORK RELATIVE TO FOUNDATION CONSTRUCTION, SITE PREPARATION, AND PAVEMENT INSTALLATION, AS SHOWN ON THIS PLAN, SHALL BE CONSTRUCTED IN ACCORDANCE WITH THE "GEOTECHNICAL INVESTIGATION" AS PROVIDED BY THE ARCHITECT OR OWNER. ALL OTHER WORK SHALL, UNLESS OTHERWISE STATED OR PROVIDED FOR HEREON, BE CONSTRUCTED IN ACCORDANCE WITH THE CITY OF ALBUQUERQUE STANDARD SPECIFICATIONS FOR PUBLIC WORKS.
3. EARTH SLOPES SHALL NOT EXCEED 3 HORIZONTAL TO 1 VERTICAL UNLESS SHOWN OTHERWISE.
4. IT IS THE INTENT OF THESE PLANS THAT THIS CONTRACTOR SHALL NOT PERFORM ANY WORK OUTSIDE OF THE PROPERTY BOUNDARIES EXCEPT AS REQUIRED BY THIS PLAN.
5. THE CONTRACTOR IS TO ENSURE THAT NO SOIL ERODES FROM THE SITE ONTO ADJACENT PROPERTY OR PUBLIC RIGHT-OF-WAY. THIS SHOULD BE ACHIEVED BY CONSTRUCTING TEMPORARY BERMS OR SILT FENCE AT THE PROPERTY LINES AND WETTING THE SOIL TO PROTECT IT FROM WIND EROSION.
6. A DISPOSAL SITE FOR ANY & ALL EXCESS EXCAVATION MATERIAL, AND UNSUITABLE MATERIAL AND/OR A BORROW SITE CONTAINING ACCEPTABLE FILL MATERIAL SHALL BE OBTAINED BY THE CONTRACTOR IN COMPLIANCE WITH APPLICABLE ENVIRONMENTAL REGULATIONS AND APPROVED BY THE OBSERVER. ALL COSTS INCURRED IN OBTAINING A DISPOSAL OR BORROW SITE AND Haul TO OR FROM SHALL BE CONSIDERED INCIDENTAL TO THE PROJECT AND NO SEPARATE MEASUREMENT OR PAYMENT SHALL BE MADE.
7. VERIFY ALL ELEVATIONS SHOWN ON PLAN FROM BASIS OF ELEVATION CONTROL STATION PRIOR TO BEGINNING CONSTRUCTION.
8. ALL CURB IS 8" HEADER CURB UNLESS OTHERWISE NOTED. ALL ELEVATIONS ARE TAKEN AT THE TOP OF ASPHALT UNLESS OTHERWISE NOTED.
9. ALL ELEVATIONS SHOWN ALONG MEDIAN CURB ARE AT FLOWLINE UNLESS OTHERWISE INDICATED.

KEYED NOTES

- * A. INSTALL 4" DIA. TYPE "E" MANHOLE PER COA STD. DWG. 2102.
- B. RETAINING WALL BY OTHERS. SEE SHEET C2.11 FOR TYPICAL RETAINING WALL NOMENCLATURE.
- * C. INSTALL TYPE "D" SINGLE GRATE INLET, PER COA STD DWG 2206.
- * D. INSTALL PVC MEDIAN CULVERT. SEE PLAN FOR SIZE AND ELEVATIONS. SEE DETAIL SHEET C2.11.
- * E. 2' CUB CUT PER DETAIL SHEET C2.11.
- * F. MODIFIED 4" DIA. TYPE "C" MANHOLE/INLET. SEE DETAIL SHEET C2.11.
- * G. MODIFIED 6" DIA. TYPE "C" MANHOLE/INLET. SEE DETAIL SHEET C2.11.
- * H. 1' RIBBON CHANNEL. SEE DETAIL SHEET C2.10.
- * I. SINGLE GRATE TYPE "A" INLET, PER COA STD DWGS 2201 & 2202.
- * J. DEBRIS TREATMENT MANHOLE SYSTEM PER DETAILS SHEET C2.11
- * K. INSTALL 6" DIA TYPE "E" MANHOLE PER COA STD DWG 2012.
- L. INSTALL 4" DIA PVC SIDEWALK CULVERT.
- M. BUILD 10' WIDE 2" AC TRAIL PER COA STD DWG 2415B
- N. INSTALL 6" DIA PVC SIDEWALK CULVERT.

* Not used this sheet.

MATERIALS:

SD LINE: CLASS III ROP OR HOPE (UNLESS OTHERWISE NOTED ON PLANS)

LEGEND

- PROPERTY LINE
- - - - - 5301.15 EXISTING CONTOURS
- 5301.15 EXISTING GROUND SPOT ELEVATION
- 95.53 PROPOSED SPOT ELEVATION
- S=2.0% PROPOSED DIRECTION OF FLOW
- PROPOSED CURB & GUTTER
- EASEMENT
- PROPOSED STORM DRAIN INLET
- PROPOSED STORM DRAIN MANHOLE
- PROPOSED RETAINING WALL
- EXISTING OVERHEAD POWER LINES AND POWER POLES
- EXISTING BARBED WIRE FENCE

No. Date Issue / Description

Project :

DIAMOND MESA

ALBUQUERQUE, N.M.

ACS BRASS TABLET STAMPED "TRANS"
Geographic Position (NAD 1927)
N.M. State Plane Coordinates (Central Zone)
X= 354,899.45 Y= 1,471,822.67
Ground-to-Grid Factor = 0.99967921
 $\Delta\alpha = -00^{\circ}16'42''$
SLD 1929 Elevation = 5118.43

License Stamp:

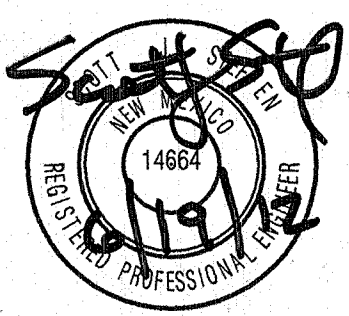

Project Contact:
Phone #:
Fax #:
E-Mail:

Principal in Charge :
Project Director :
Project Designer:
Project Manager:

Sheet Title :

**GRADING & DRAINAGE
PLAN**

Sheet No. :

C2.02

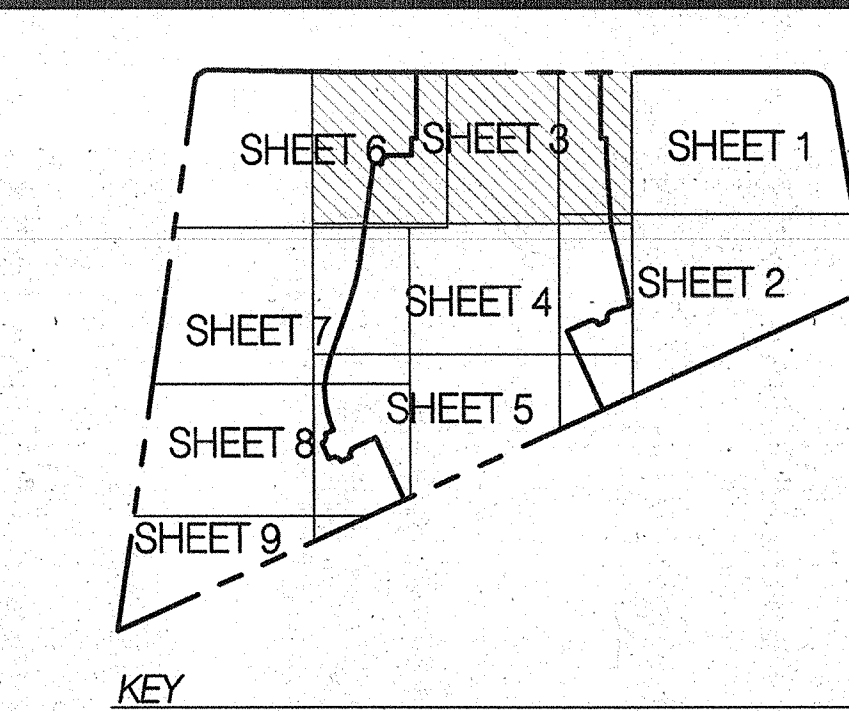
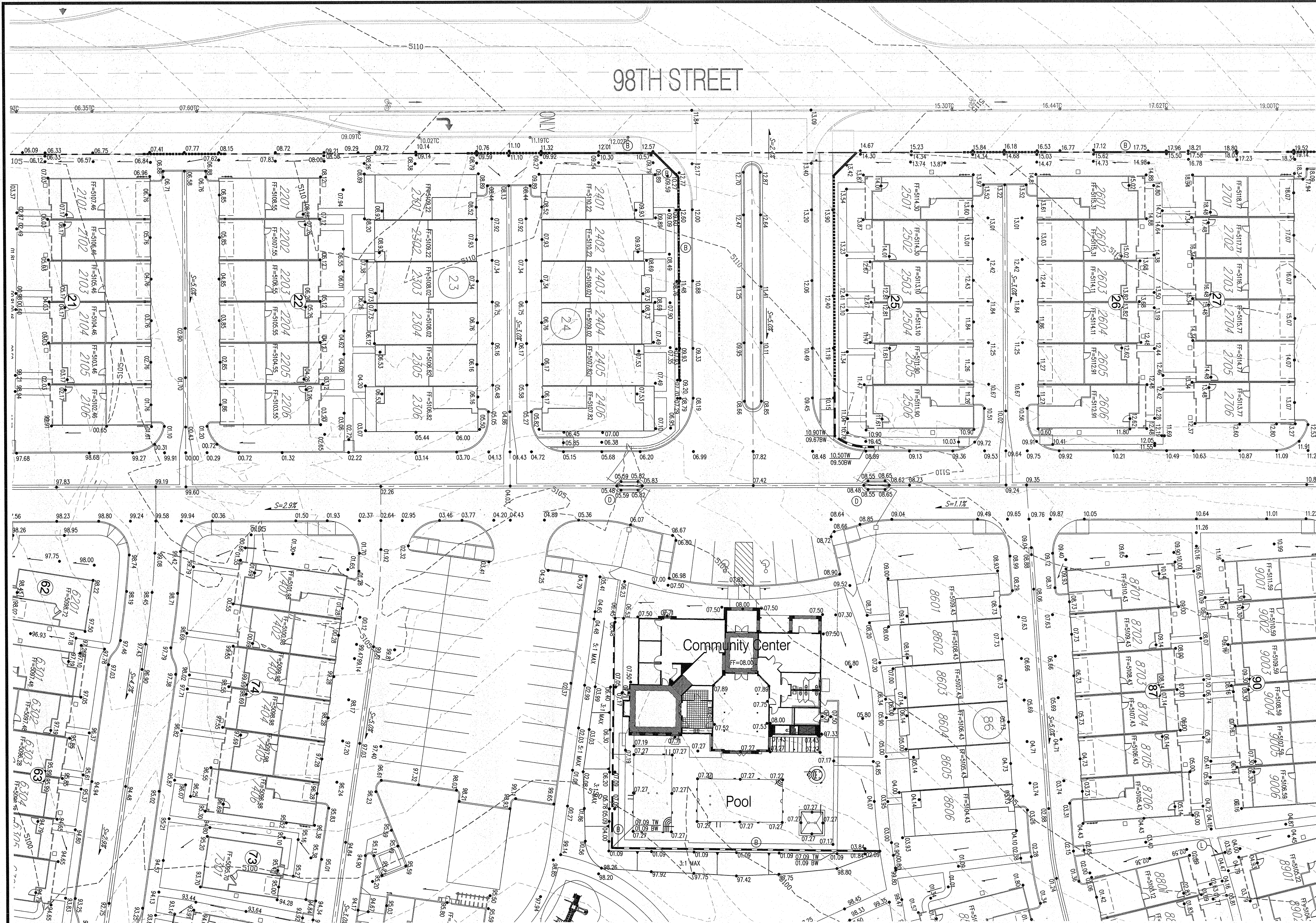

- GENERAL NOTES**
1. ALL WORK DETAILED ON THESE PLANS AND PERFORMED UNDER THIS CONTRACT SHALL BE CONSTRUCTED IN ACCORDANCE WITH THE PROJECT SPECIFICATIONS AND THE PROJECT GEOTECHNICAL REPORT. WHERE APPLICABLE, CITY OF ALBUQUERQUE PUBLIC WORKS STANDARDS SHALL APPLY.
 2. THE CONTRACTOR SHALL ABIDE BY ALL LOCAL, STATE, AND FEDERAL LAWS, RULES AND REGULATIONS WHICH APPLY TO THE CONSTRUCTION OF THESE IMPROVEMENTS, INCLUDING EPA REQUIREMENTS WITH RESPECT TO STORM WATER DISCHARGE.
 3. PRIOR TO CONSTRUCTION, THE CONTRACTOR SHALL FIELD VERIFY THE HORIZONTAL AND VERTICAL LOCATIONS OF ALL POTENTIAL OBSTRUCTIONS INCLUDING ALL UNDERGROUND UTILITIES. SHOULD A CONFLICT EXIST, THE CONTRACTOR SHALL NOTIFY THE CONSTRUCTION OBSERVER OR ENGINEER SO THAT THE CONFLICT CAN BE RESOLVED WITH A MINIMUM AMOUNT OF DELAY.
 4. TWO (2) WORKING DAYS PRIOR TO ANY EXCAVATION, THE CONTRACTOR SHALL CONTACT LINE LOCATING SERVICE FOR LOCATION OF EXISTING UTILITIES.
 5. ALL ELECTRICAL, TELEPHONE, CABLE TV, GAS AND OTHER UTILITY LINES, CABLES, AND APPURTENANCES ENCOUNTERED DURING CONSTRUCTION THAT REQUIRE RELOCATION, SHALL BE COORDINATED WITH THAT UTILITY. THE CONTRACTOR SHALL BE RESPONSIBLE FOR COORDINATION OF ALL NECESSARY UTILITY ADJUSTMENTS. NO ADDITIONAL COMPENSATION WILL BE ALLOWED FOR DELAYS OR INCONVENIENCES CAUSED BY UTILITY COMPANY WORK CREWS. THE CONTRACTOR MAY BE REQUIRED TO RESCHEDULE HIS ACTIVITIES TO ALLOW UTILITY CREWS TO PERFORM THEIR REQUIRED WORK.
 6. THE CONTRACTOR IS RESPONSIBLE FOR VERIFYING LOCATION & ELEVATION OF ALL EXISTING UTILITIES PRIOR TO CONSTRUCTION. THE CONTRACTOR IS ALSO RESPONSIBLE FOR PROTECTING ALL EXISTING UTILITY LINES WITHIN THE CONSTRUCTION AREA. ANY DAMAGE TO EXISTING FACILITIES CAUSED BY CONSTRUCTION ACTIVITY SHALL BE REPAIRED OR REPLACED AT THE CONTRACTOR'S EXPENSE AND APPROVED BY THE CONSTRUCTION OBSERVER.
 7. CONSTRUCTION ACTIVITY SHALL BE LIMITED TO THE PROPERTY AND/OR PROJECT LIMITS. ANY DAMAGE TO ADJACENT PROPERTIES RESULTING FROM THE CONSTRUCTION PROCESS SHALL BE REPAIRED OR REPLACED AT THE CONTRACTOR'S EXPENSE.
 8. OVERNIGHT PARKING OF CONSTRUCTION EQUIPMENT SHALL NOT OBSTRUCT DRIVEWAYS OR DESIGNATED TRAFFIC LANES. THE CONTRACTOR SHALL NOT STORE ANY EQUIPMENT OR MATERIAL WITHIN THE PUBLIC RIGHT-OF-WAY.
 9. THE CONTRACTOR SHALL OBTAIN ALL THE NECESSARY PERMITS FOR THE PROJECT PRIOR TO COMMENCING CONSTRUCTION (I.E., BARRICADES, TOPSOIL, DISTURBANCE, EXCAVATION, PERMITS, EPA STORM WATER PERMITS, ETC.).
 10. ALL PROPERTY CORNERS DESTROYED DURING CONSTRUCTION SHALL BE REPLACED AT THE CONTRACTOR'S EXPENSE. ALL PROPERTY CORNERS MUST BE RESET BY A REGISTERED LAND SURVEYOR.
 11. ALL BARRICADES AND CONSTRUCTION SIGNING SHALL CONFORM TO APPLICABLE SECTIONS OF THE "MANUAL ON UNIFORM TRAFFIC CONTROL DEVICES" (MUTCD), US DEPARTMENT OF TRANSPORTATION, LATEST EDITION.
 12. THE CONTRACTOR SHALL MAINTAIN ALL CONSTRUCTION BARRICADES AND SIGNING AT ALL TIMES. THE CONTRACTOR SHALL VERIFY THE PROPER LOCATION OF ALL BARRICADES AT THE END AND BEGINNING OF EACH DAY.
 13. THE CONTRACTOR SHALL TAKE ALL STEPS NECESSARY TO CONFORM WITH EPA REQUIREMENTS, INCLUDING COMPLIANCE WITH NPDES PHASE 2 REQUIREMENTS.
 14. THE CONTRACTOR IS RESPONSIBLE FOR SWPPP PREPARATION AND IMPLEMENTATION.

- KEYED NOTES**
- * A. INSTALL 4' DIA. TYPE "E" MANHOLE PER COA STD. DWG. 2102.
 - B. RETAINING WALL BY OTHERS. SEE SHEET C2.11 FOR TYPICAL RETAINING WALL NOMENCLATURE.
 - * C. INSTALL TYPE "D" SINGLE GRATE INLET, PER COA STD DWG 2206.
 - D. INSTALL PVC MEDIAN CULVERT. SEE PLAN FOR SIZE AND ELEVATIONS. SEE DETAIL SHEET C2.11.
 - * E. 2' CURB CUT PER DETAIL SHEET C2.11.
 - * F. MODIFIED 4' DIA. TYPE "C" MANHOLE/INLET. SEE DETAIL SHEET C2.11.
 - * G. MODIFIED 6' DIA. TYPE "C" MANHOLE/INLET. SEE DETAIL SHEET C2.11.
 - * H. 1' RIBBON CHANNEL. SEE DETAIL SHEET C2.10.
 - * I. SINGLE GRATE TYPE "A" INLET, PER COA STD DWGS 2201 & 2202.
 - * J. DEBRIS TREATMENT MANHOLE SYSTEM PER DETAILS SHEET C2.11
 - * K. INSTALL 6" DIA TYPE "E" MANHOLE PER COA STD DWG 2012.
 - L. INSTALL 4" DIA PVC SIDEWALK CULVERT.
 - * M. BUILD 10' WIDE 2" AC TRAIL PER COA STD DWG 2415B
 - * N. INSTALL 6" DIA PVC SIDEWALK CULVERT.

MATERIALS:
SD LINE: CLASS II ROP OR HOPE (UNLESS OTHERWISE NOTED ON PLANS)

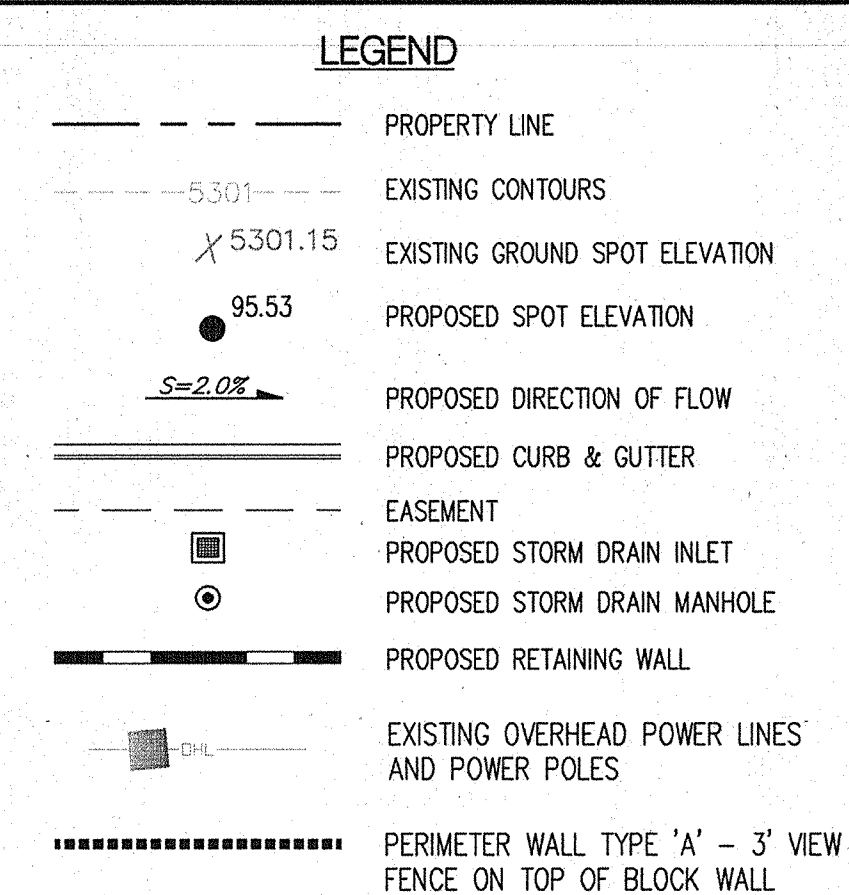

- GRADING NOTES**
1. EXCEPT AS PROVIDED HEREIN, GRADING SHALL BE PERFORMED AT THE ELEVATIONS AND IN ACCORDANCE WITH THE DETAILS SHOWN ON THIS PLAN.
 2. ALL WORK RELATIVE TO FOUNDATION CONSTRUCTION, SITE PREPARATION, AND PAVEMENT INSTALLATION, AS SHOWN ON THIS PLAN, SHALL BE CONSTRUCTED IN ACCORDANCE WITH THE "GEOTECHNICAL INVESTIGATION" AS PROVIDED BY THE ARCHITECT OR OWNER. ALL OTHER WORK SHALL, UNLESS OTHERWISE STATED OR PROVIDED FOR HEREON, BE CONSTRUCTED IN ACCORDANCE WITH THE CITY OF ALBUQUERQUE STANDARD SPECIFICATIONS FOR PUBLIC WORKS.
 3. EARTH SLOPES SHALL NOT EXCEED 3 HORIZONTAL TO 1 VERTICAL UNLESS SHOWN OTHERWISE.
 4. IT IS THE INTENT OF THESE PLANS THAT THIS CONTRACTOR SHALL NOT PERFORM ANY WORK OUTSIDE OF THE PROPERTY BOUNDARIES EXCEPT AS REQUIRED BY THIS PLAN.
 5. THE CONTRACTOR IS TO ENSURE THAT NO SOIL ERODES FROM THE SITE ONTO ADJACENT PROPERTY OR PUBLIC RIGHT-OF-WAY. THIS SHOULD BE ACHIEVED BY CONSTRUCTING TEMPORARY BERMS OR SILT FENCE AT THE PROPERTY LINES AND WETTING THE SOIL TO PROTECT IT FROM WIND EROSION.
 6. A DISPOSAL SITE FOR ANY & ALL EXCESS EXCAVATION MATERIAL, AND UNSUITABLE MATERIAL AND/OR A BORROW SITE CONTAINING ACCEPTABLE FILL MATERIAL SHALL BE OBTAINED BY THE CONTRACTOR IN COMPLIANCE WITH APPLICABLE ENVIRONMENTAL REGULATIONS AND APPROVED BY THE OBSERVER. ALL COSTS INCURRED IN OBTAINING A DISPOSAL OR BORROW SITE AND HAIL TO OR FROM SHALL BE CONSIDERED INCIDENTAL TO THE PROJECT AND NO SEPARATE MEASUREMENT OR PAYMENT SHALL BE MADE.
 7. VERIFY ALL ELEVATIONS SHOWN ON PLAN FROM BASIS OF ELEVATION CONTROL STATION PRIOR TO BEGINNING CONSTRUCTION.
 8. ALL CURB IS 6" MEDIAN CURB UNLESS OTHERWISE NOTED. ALL ELEVATIONS ARE TAKEN AT THE FLOWLINE OF THE CURB UNLESS OTHERWISE NOTED.
 9. ALL ELEVATIONS SHOWN ALONG MEDIAN CURB ARE AT FLOWLINE UNLESS OTHERWISE INDICATED.

NOTICE TO CONTRACTORS

1. CONTRACTOR SHALL ADJUST ALL MANHOLES TO FINISHED GRADE PER COA STD. DWG. 2111.
2. 10' WIDE AC TRAIL SHALL BE CONSTRUCTED IN ACCORDANCE WITH THE CITY OF ALBUQUERQUE STANDARD SPECIFICATIONS FOR PUBLIC WORKS CONSTRUCTION, 1986 EDITION AS REVISED THROUGH UPDATE #8.

No. Date Issue / Description

Project :
DIAMOND MESA
ALBUQUERQUE, N.M.

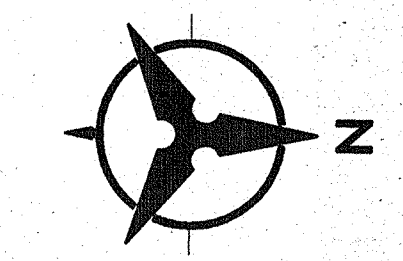

20 10 0 20
1" = 20'

ACS BRASS TABLET STAMPED "TRANS"
Geographic Position (NAD 1927)
N.M. State Plane Coordinates (Central Zone)
X= 354,899.45 Y= 1,471,822.67
Ground-to-Grid Factor = 0.99967921
ΔX = -00'16"42"
SLD 1929 Elevation = 5118.43

License Stamp:

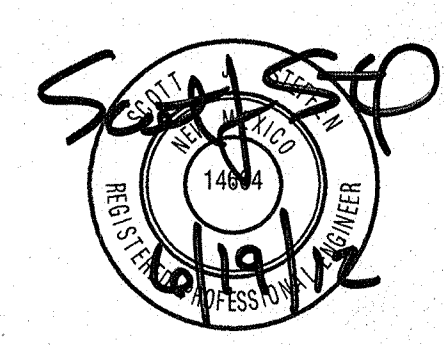

Project Contact:
Phone #:
Fax #:
E-Mail:

Principal in Charge :
Project Director :
Project Designer:
Project Manager:

Sheet Title :

GRADING & DRAINAGE PLAN

Sheet No. :

C2.103

Bohannon & Huston

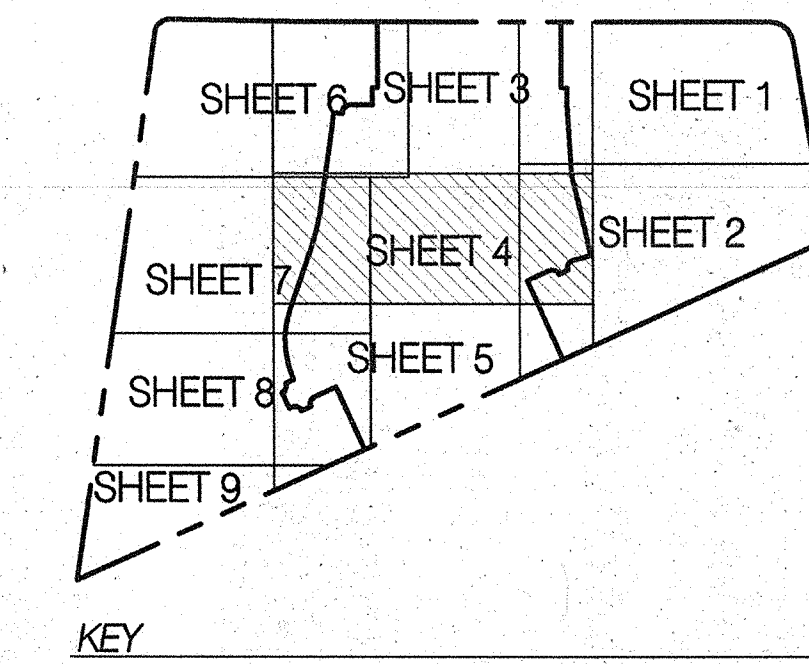

GENERAL NOTES

1. ALL WORK DETAILED ON THESE PLANS AND PERFORMED UNDER THIS CONTRACT SHALL BE CONSTRUCTED IN ACCORDANCE WITH THE PROJECT SPECIFICATIONS AND THE PROJECT GEOTECHNICAL REPORT, WHERE APPLICABLE, CITY OF ALBUQUERQUE PUBLIC WORKS STANDARDS SHALL APPLY.
2. THE CONTRACTOR SHALL ABIDE BY ALL LOCAL, STATE, AND FEDERAL LAWS, RULES AND REGULATIONS WHICH APPLY TO THE CONSTRUCTION OF THESE IMPROVEMENTS, INCLUDING EPA REQUIREMENTS WITH RESPECT TO STORM WATER DISCHARGE.
3. PRIOR TO CONSTRUCTION, THE CONTRACTOR SHALL FIELD VERIFY THE HORIZONTAL AND VERTICAL LOCATIONS OF ALL POTENTIAL OBSTRUCTIONS INCLUDING ALL UNDERGROUND UTILITIES. SHOULD A CONFLICT EXIST, THE CONTRACTOR SHALL NOTIFY THE CONSTRUCTION OBSERVER OR ENGINEER SO THAT THE CONFLICT CAN BE RESOLVED WITH A MINIMUM AMOUNT OF DELAY.
4. TWO (2) WORKING DAYS PRIOR TO ANY EXCAVATION, THE CONTRACTOR SHALL CONTACT LINE LOCATING SERVICE FOR LOCATION OF EXISTING UTILITIES.
5. ALL ELECTRICAL, TELEPHONE, CABLE TV, GAS AND OTHER UTILITY LINES, CABLES, AND APPURTENANCES ENCOUNTERED DURING CONSTRUCTION THAT REQUIRE RELOCATION, SHALL BE COORDINATED WITH THAT UTILITY. THE CONTRACTOR SHALL BE RESPONSIBLE FOR COORDINATION OF ALL NECESSARY UTILITY ADJUSTMENTS. NO ADDITIONAL COMPENSATION WILL BE ALLOWED FOR DELAYS OR INCONVENIENCES CAUSED BY UTILITY COMPANY WORK CREWS. THE CONTRACTOR MAY BE REQUIRED TO RESCHEDULE HIS ACTIVITIES TO ALLOW UTILITY CREWS TO PERFORM THEIR REQUIRED WORK.
6. THE CONTRACTOR IS RESPONSIBLE FOR VERIFYING LOCATION & ELEVATION OF ALL EXISTING UTILITIES PRIOR TO CONSTRUCTION. THE CONTRACTOR IS ALSO RESPONSIBLE FOR PROTECTING ALL EXISTING UTILITY LINES WITHIN THE CONSTRUCTION AREA. ANY DAMAGE TO EXISTING FACILITIES CAUSED BY CONSTRUCTION ACTIVITY SHALL BE REPAIRED OR REPLACED AT THE CONTRACTOR'S EXPENSE AND APPROVED BY THE CONSTRUCTION OBSERVER.
7. CONSTRUCTION ACTIVITY SHALL BE LIMITED TO THE PROPERTY AND/OR PROJECT LIMITS. ANY DAMAGE TO ADJACENT PROPERTIES RESULTING FROM THE CONSTRUCTION PROCESS SHALL BE REPAIRED OR REPLACED AT THE CONTRACTOR'S EXPENSE.
8. OVERNIGHT PARKING OF CONSTRUCTION EQUIPMENT SHALL NOT OBSTRUCT DRIVEWAYS OR DESIGNATED TRAFFIC LANES. THE CONTRACTOR SHALL NOT STORE ANY EQUIPMENT OR MATERIAL WITHIN THE PUBLIC RIGHT-OF-WAY.
9. THE CONTRACTOR SHALL OBTAIN ALL THE NECESSARY PERMITS FOR THE PROJECT PRIOR TO COMMENCING CONSTRUCTION (I.E., BARRICADEING, TOPSOIL DISTURBANCE, EXCAVATION PERMITS, EPA STORM WATER PERMITS, ETC.).
10. ALL PROPERTY CORNERS DESTROYED DURING CONSTRUCTION SHALL BE REPLACED AT THE CONTRACTOR'S EXPENSE. ALL PROPERTY CORNERS MUST BE RESET BY A REGISTERED LAND SURVEYOR.
11. ALL BARRICADES AND CONSTRUCTION SIGNING SHALL CONFORM TO APPLICABLE SECTIONS OF THE "MANUAL ON UNIFORM TRAFFIC CONTROL DEVICES" (MUTCD), US DEPARTMENT OF TRANSPORTATION, LATEST EDITION.
12. THE CONTRACTOR SHALL MAINTAIN ALL CONSTRUCTION BARRICADES AND SIGNING AT ALL TIMES. THE CONTRACTOR SHALL VERIFY THE PROPER LOCATION OF ALL BARRICADES AT THE END AND BEGINNING OF EACH DAY.
13. THE CONTRACTOR SHALL TAKE ALL STEPS NECESSARY TO CONFORM WITH EPA REQUIREMENTS, INCLUDING COMPLIANCE WITH NPDES PHASE 2 REQUIREMENTS.
14. THE CONTRACTOR IS RESPONSIBLE FOR SWPPP PREPARATION AND IMPLEMENTATION.

KEYED NOTES

- * A. INSTALL 4' DIA. TYPE "E" MANHOLE PER COA STD. DWG. 2102.
- * B. RETAINING WALL BY OTHERS. SEE SHEET C2.11 FOR TYPICAL RETAINING WALL NOMENCLATURE.
- * C. INSTALL TYPE "D" SINGLE GRATE INLET, PER COA STD DWG 2206.
- * D. INSTALL PVC MEDIAN CULVERT. SEE PLAN FOR SIZE AND ELEVATIONS. SEE DETAIL SHEET C2.11.
- * E. 2' CURB CUT PER DETAIL SHEET C2.11.
- * F. MODIFIED 4' DIA. TYPE "C" MANHOLE/INLET. SEE DETAIL SHEET C2.11.
- * G. MODIFIED 6' DIA. TYPE "C" MANHOLE/INLET. SEE DETAIL SHEET C2.11.
- * H. 1' RIBBON CHANNEL. SEE DETAIL SHEET C2.10.
- * I. SINGLE GRATE TYPE "A" INLET, PER COA STD DWGS 2201 & 2202.
- * J. DEBRIS TREATMENT MANHOLE SYSTEM PER DETAILS SHEET C2.11
- * K. INSTALL 6' DIA TYPE "E" MANHOLE PER COA STD DWG 2012.
- * L. INSTALL 4' DIA PVC SIDEWALK CULVERT.
- * M. BUILD 10' WIDE 2' AC TRAIL PER COA STD DWG 2415B
- * N. INSTALL 6' DIA PVC SIDEWALK CULVERT.

* Not used this sheet.

MATERIALS:

SD LINE: CLASS II ROP OR HEPE (UNLESS OTHERWISE NOTED ON PLANS)

GRADING NOTES

1. EXCEPT AS PROVIDED HEREIN, GRADING SHALL BE PERFORMED AT THE ELEVATIONS AND IN ACCORDANCE WITH THE DETAILS SHOWN ON THIS PLAN.
2. ALL WORK RELATIVE TO FOUNDATION CONSTRUCTION, SITE PREPARATION, AND PAVEMENT INSTALLATION, AS SHOWN ON THIS PLAN, SHALL BE CONSTRUCTED IN ACCORDANCE WITH THE "GEOTECHNICAL INVESTIGATION" AS PROVIDED BY THE ARCHITECT OR OWNER. ALL OTHER WORK SHALL, UNLESS OTHERWISE STATED OR PROVIDED FOR HEREON, BE CONSTRUCTED IN ACCORDANCE WITH THE CITY OF ALBUQUERQUE STANDARD SPECIFICATIONS FOR PUBLIC WORKS.
3. EARTH SLOPES SHALL NOT EXCEED 3 HORIZONTAL TO 1 VERTICAL UNLESS SHOWN OTHERWISE.
4. IT IS THE INTENT OF THESE PLANS THAT THIS CONTRACTOR SHALL NOT PERFORM ANY WORK OUTSIDE OF THE PROPERTY BOUNDARIES EXCEPT AS REQUIRED BY THIS PLAN.
5. THE CONTRACTOR IS TO ENSURE THAT NO SOIL ERODES FROM THE SITE ONTO ADJACENT PROPERTY OR PUBLIC RIGHT-OF-WAY. THIS SHOULD BE ACHIEVED BY CONSTRUCTING TEMPORARY BERMES OR SILT FENCE AT THE PROPERTY LINES AND NETTING THE SOIL TO PROTECT IT FROM WIND EROSION.
6. A DISPOSAL SITE FOR ANY & ALL EXCESS EXCAVATION MATERIAL, AND UNSUITABLE MATERIAL AND/OR A BORROW SITE CONTAINING ACCEPTABLE FILL MATERIAL SHALL BE OBTAINED BY THE CONTRACTOR IN COMPLIANCE WITH APPLICABLE ENVIRONMENTAL REGULATIONS AND APPROVED BY THE OBSERVER. ALL COSTS INCURRED IN OBTAINING A DISPOSAL OR BORROW SITE AND Haul TO OR FROM SHALL BE CONSIDERED INCIDENTAL TO THE PROJECT AND NO SEPARATE MEASUREMENT OR PAYMENT SHALL BE MADE.
7. VERIFY ALL ELEVATIONS SHOWN ON PLAN FROM BASIS OF ELEVATION CONTROL STATION PRIOR TO BEGINNING CONSTRUCTION.
8. ALL CURB IS 6" MEDIAN CURB UNLESS OTHERWISE NOTED. ALL ELEVATIONS ARE TAKEN AT THE FLOWLINE OF THE CURB UNLESS OTHERWISE NOTED.
9. ALL ELEVATIONS SHOWN ALONG MEDIAN CURB ARE AT FLOWLINE UNLESS OTHERWISE INDICATED.

NOTICE TO CONTRACTORS

1. CONTRACTOR SHALL ADJUST ALL MANHOLES TO FINISHED GRADE PER COA STD. DWG. 2111.
2. 10' WIDE AC TRAIL SHALL BE CONSTRUCTED IN ACCORDANCE WITH THE CITY OF ALBUQUERQUE STANDARD SPECIFICATIONS FOR PUBLIC WORKS CONSTRUCTION, 1998 EDITION AS REVISED THROUGH UPDATE #8.

LEGEND

---	PROPERTY LINE
---	EXISTING CONTOURS
X 5301.15	EXISTING GROUND SPOT ELEVATION
● 95.53	PROPOSED SPOT ELEVATION
S=2.0%	PROPOSED DIRECTION OF FLOW
---	PROPOSED CURB & GUTTER
---	EASEMENT
---	PROPOSED STORM DRAIN INLET
---	PROPOSED STORM DRAIN MANHOLE
---	PROPOSED RETAINING WALL
---	EXISTING OVERHEAD POWER LINES AND POWER POLES
---	PERIMETER WALL TYPE "A" - 3' VIEW FENCE ON TOP OF BLOCK WALL

Bohannon & Huston

No. Date Issue / Description

Project :

DIAMOND MESA

ALBUQUERQUE, N.M.

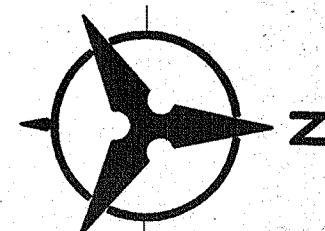

20 10 0 20
1" = 20'

ACS BRASS TABLET STAMPED "TRANS"
Geographic Position (NAD 1927)
N.M. State Plane Coordinates (Central Zone)
X= 354,899.45 Y= 1,471,822.67
Ground-to-Grid Factor = 0.99967921
 $\Delta\alpha = -00^{\circ}16'42''$
SLD 1929 Elevation = 5118.43

License Stamp:



Project Contact:
Phone #:
Fax #:
E-Mail:

Principal in Charge :
Project Director :
Project Designer:
Project Manager:

Sheet Title :

GRADING & DRAINAGE
PLAN

Sheet No. :

C2.04