

- GENERAL NOTES**
1. ALL WORK DETAILED ON THESE PLANS AND PERFORMED UNDER THIS CONTRACT SHALL BE CONSTRUCTED IN ACCORDANCE WITH THE PROJECT SPECIFICATIONS AND THE PROJECT GEOTECHNICAL REPORT, WHERE APPLICABLE. CITY OF ALBUQUERQUE PUBLIC WORKS STANDARDS SHALL APPLY.
  2. THE CONTRACTOR SHALL ABIDE BY ALL LOCAL, STATE, AND FEDERAL LAWS, RULES AND REGULATIONS WHICH APPLY TO THE CONSTRUCTION OF THESE IMPROVEMENTS, INCLUDING EPA REQUIREMENTS WITH RESPECT TO STORM WATER DISCHARGE.
  3. PRIOR TO CONSTRUCTION, THE CONTRACTOR SHALL FIELD VERIFY THE HORIZONTAL AND VERTICAL LOCATIONS OF ALL POTENTIAL OBSTRUCTIONS INCLUDING ALL UNDERGROUND UTILITIES. SHOULD A CONFLICT EXIST, THE CONTRACTOR SHALL NOTIFY THE CONSTRUCTION OBSERVER OR ENGINEER SO THAT THE CONFLICT CAN BE RESOLVED WITH A MINIMUM AMOUNT OF DELAY.
  4. TWO (2) WORKING DAYS PRIOR TO ANY EXCAVATION, THE CONTRACTOR SHALL CONTACT LINE LOCATING SERVICE FOR LOCATION OF EXISTING UTILITIES.
  5. ALL ELECTRICAL, TELEPHONE, CABLE TV, GAS AND OTHER UTILITY LINES, CABLES, AND APPURTENANCES ENCOUNTERED DURING CONSTRUCTION THAT REQUIRE RELOCATION, SHALL BE COORDINATED WITH THAT UTILITY. THE CONTRACTOR SHALL BE RESPONSIBLE FOR COORDINATION OF ALL NECESSARY UTILITY ADJUSTMENTS. NO ADDITIONAL COMPENSATION WILL BE ALLOWED FOR DELAYS OR INCONVENIENCES CAUSED BY UTILITY COMPANY WORK CREWS. THE CONTRACTOR MAY BE REQUIRED TO RESCHEDULE HIS ACTIVITIES TO ALLOW UTILITY CREWS TO PERFORM THEIR REQUIRED WORK.
  6. THE CONTRACTOR IS RESPONSIBLE FOR VERIFYING LOCATION & ELEVATION OF ALL EXISTING UTILITIES PRIOR TO CONSTRUCTION. THE CONTRACTOR IS ALSO RESPONSIBLE FOR PROTECTING ALL EXISTING UTILITY LINES WITHIN THE CONSTRUCTION AREA. ANY DAMAGE TO EXISTING FACILITIES CAUSED BY CONSTRUCTION ACTIVITY SHALL BE REPAIRED OR REPLACED AT THE CONTRACTOR'S EXPENSE AND APPROVED BY THE CONSTRUCTION OBSERVER.
  7. CONSTRUCTION ACTIVITY SHALL BE LIMITED TO THE PROPERTY AND/OR PROJECT LIMITS. ANY DAMAGE TO ADJACENT PROPERTIES RESULTING FROM THE CONSTRUCTION PROCESS SHALL BE REPAIRED OR REPLACED AT THE CONTRACTOR'S EXPENSE.
  8. OVERNIGHT PARKING OF CONSTRUCTION EQUIPMENT SHALL NOT OBSTRUCT DRIVEWAYS OR DESIGNATED TRAFFIC LANES. THE CONTRACTOR SHALL NOT STORE ANY EQUIPMENT OR MATERIAL WITHIN THE PUBLIC RIGHT-OF-WAY.
  9. THE CONTRACTOR SHALL OBTAIN ALL THE NECESSARY PERMITS FOR THE PROJECT PRIOR TO COMMENCING CONSTRUCTION (I.E., BARRICADING, TOPSOIL DISTURBANCE, EXCAVATION PERMITS, EPA STORM WATER PERMITS, ETC.).
  10. ALL PROPERTY CORNERS DESTROYED DURING CONSTRUCTION SHALL BE REPLACED AT THE CONTRACTOR'S EXPENSE. ALL PROPERTY CORNERS MUST BE RESET BY A REGISTERED LAND SURVEYOR.
  11. ALL BARRICADES AND CONSTRUCTION SIGNING SHALL CONFORM TO APPLICABLE SECTIONS OF THE "MANUAL ON UNIFORM TRAFFIC CONTROL DEVICES" (MUTCD), US DEPARTMENT OF TRANSPORTATION, LATEST EDITION.
  12. THE CONTRACTOR SHALL MAINTAIN ALL CONSTRUCTION BARRICADES AND SIGNING AT ALL TIMES. THE CONTRACTOR SHALL VERIFY THE PROPER LOCATION OF ALL BARRICADES AT THE END AND BEGINNING OF EACH DAY.
  13. THE CONTRACTOR SHALL TAKE ALL STEPS NECESSARY TO CONFORM WITH EPA REQUIREMENTS, INCLUDING COMPLIANCE WITH NPDES PHASE 2 REQUIREMENTS.
  14. THE CONTRACTOR IS RESPONSIBLE FOR SWPPP PREPARATION AND IMPLEMENTATION.

- KEY NOTES**
- A. INSTALL 4' DIA. TYPE "E" MANHOLE PER COA STD. DWG. 2102.
  - \* B. RETAINING WALL BY OTHERS. SEE SHEET C2.11 FOR TYPICAL RETAINING WALL NOMENCLATURE.
  - C. INSTALL TYPE "D" SINGLE GRATE INLET, PER COA STD DWG 2206.
  - \* D. INSTALL PVC MEDIAN CULVERT. SEE PLAN FOR SIZE AND ELEVATIONS. SEE DETAIL SHEET C2.11.
  - E. 2' CURB OUT PER DETAIL SHEET C2.11.
  - \* F. MODIFIED 4' DIA. TYPE "C" MANHOLE/INLET. SEE DETAIL SHEET C2.11.
  - \* G. MODIFIED 6' DIA. TYPE "C" MANHOLE/INLET. SEE DETAIL SHEET C2.11.
  - \* H. 1' RIBBON CHANNEL. SEE DETAIL SHEET C2.10.
  - \* I. SINGLE GRATE TYPE "A" INLET, PER COA STD DWGS 2201 & 2202.
  - \* J. DEBRIS TREATMENT MANHOLE SYSTEM PER DETAILS SHEET C2.11
  - \* K. INSTALL 6' DIA TYPE "E" MANHOLE PER COA STD DWG 2012.
  - L. INSTALL 4' DIA PVC SIDEWALK CULVERT.
  - \* M. BUILD 10' WIDE 2" AC TRAIL PER COA STD DWG 2415B
  - \* N. INSTALL 6' DIA PVC SIDEWALK CULVERT.
- \* Not used this sheet.
- MATERIALS:**  
SD LINE: CLASS B RCP OR HDPE (UNLESS OTHERWISE NOTED ON PLANS)

- GRADING NOTES**
1. EXCEPT AS PROVIDED HEREIN, GRADING SHALL BE PERFORMED AT THE ELEVATIONS AND IN ACCORDANCE WITH THE DETAILS SHOWN ON THIS PLAN.
  2. ALL WORK RELATIVE TO FOUNDATION CONSTRUCTION, SITE PREPARATION, AND PAVEMENT INSTALLATION, AS SHOWN ON THIS PLAN, SHALL BE CONSTRUCTED IN ACCORDANCE WITH THE "GEOTECHNICAL INVESTIGATION," AS PROVIDED BY THE ARCHITECT OR OWNER. ALL OTHER WORK SHALL, UNLESS OTHERWISE STATED OR PROVIDED FOR HEREON, BE CONSTRUCTED IN ACCORDANCE WITH THE CITY OF ALBUQUERQUE STANDARD SPECIFICATIONS FOR PUBLIC WORKS.
  3. EARTH SLOPES SHALL NOT EXCEED 3 HORIZONTAL TO 1 VERTICAL UNLESS SHOWN OTHERWISE.
  4. IT IS THE INTENT OF THESE PLANS THAT THIS CONTRACTOR SHALL NOT PERFORM ANY WORK OUTSIDE OF THE PROPERTY BOUNDARIES EXCEPT AS REQUIRED BY THIS PLAN.
  5. THE CONTRACTOR IS TO ENSURE THAT NO SOIL ERODES FROM THE SITE ONTO ADJACENT PROPERTY OR PUBLIC RIGHT-OF-WAY. THIS SHOULD BE ACHIEVED BY CONSTRUCTING TEMPORARY BERMES OR SILT FENCE AT THE PROPERTY LINES AND NETTING THE SOIL TO PROTECT IT FROM WIND EROSION.
  6. A DISPOSAL SITE FOR ANY & ALL EXCESS EXCAVATION MATERIAL, AND UNSUITABLE MATERIAL AND/OR A BORROW SITE CONTAINING ACCEPTABLE FILL MATERIAL SHALL BE OBTAINED BY THE CONTRACTOR IN COMPLIANCE WITH APPLICABLE ENVIRONMENTAL REGULATIONS AND APPROVED BY THE OBSERVER. ALL COSTS INCURRED IN OBTAINING A DISPOSAL OR BORROW SITE AND HAUL TO OR FROM SHALL BE CONSIDERED INCIDENTAL TO THE PROJECT AND NO SEPARATE MEASUREMENT OR PAYMENT SHALL BE MADE.
  7. VERIFY ALL ELEVATIONS SHOWN ON PLAN FROM BASIS OF ELEVATION CONTROL STATION PRIOR TO BEGINNING CONSTRUCTION.
  8. ALL CURB IS 6" MEDIAN CURB UNLESS OTHERWISE NOTED. ALL ELEVATIONS ARE TAKEN AT THE FLOWLINE OF THE CURB UNLESS OTHERWISE NOTED.
  9. ALL ELEVATIONS SHOWN ALONG MEDIAN CURB ARE AT FLOWLINE UNLESS OTHERWISE INDICATED.

**NOTICE TO CONTRACTORS**

1. CONTRACTOR SHALL ADJUST ALL MANHOLES TO FINISHED GRADE PER COA STD. DWG. 2111.

2. 10' WIDE AC TRAIL SHALL BE CONSTRUCTED IN ACCORDANCE WITH THE CITY OF ALBUQUERQUE STANDARD SPECIFICATIONS FOR PUBLIC WORKS CONSTRUCTION, 1986 EDITION AS REVISED THROUGH UPDATE #8.

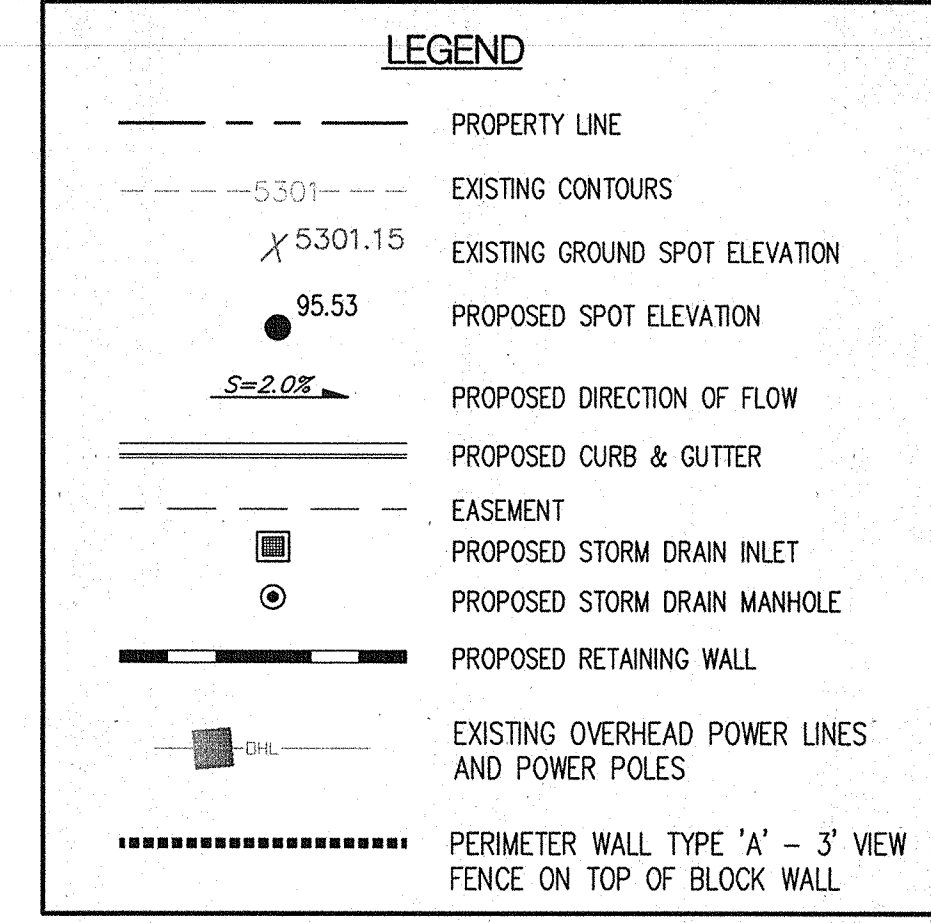

**Bohannon & Huston**

No.	Date	Issue / Description

Project :  
**DIAMOND MESA**  
**ALBUQUERQUE, N.M.**

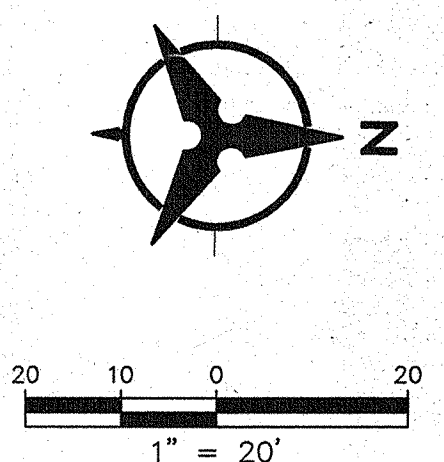

ACS BRASS TABLET STAMPED "TRANS"  
Geographic Position (NAD 1927)  
N.M. State Plane Coordinates (Central Zone)  
X= 354,899.45 Y= 1,471,822.67  
Ground-to-Grid Factor = 0.99967921  
ΔX = -00'16'42"  
SLD 1929 Elevation = 5118.43

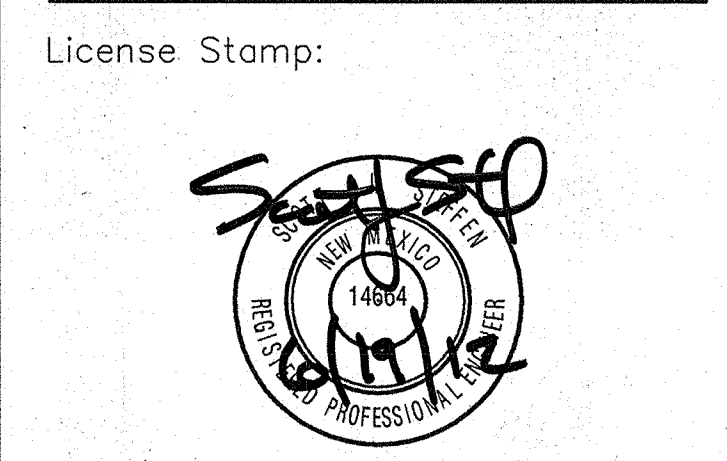

Project Contact:  
Phone #:  
Fax #:  
E-Mail:

Principal in Charge :  
Project Director :  
Project Designer:  
Project Manager:

Sheet Title :  
**GRADING & DRAINAGE PLAN**

Sheet No. :  
**C2.05**



98TH STREET

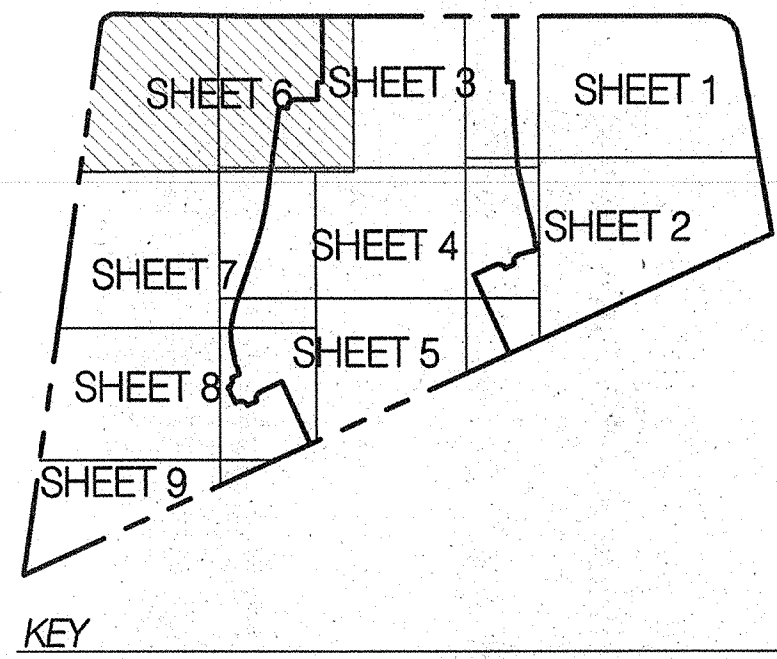

# GENERAL NOTES

1. ALL WORK DETAILED ON THESE PLANS AND PERFORMED UNDER THIS CONTRACT SHALL BE CONSTRUCTED IN ACCORDANCE WITH THE PROJECT SPECIFICATIONS AND THE PROJECT GEOTECHNICAL REPORT, WHERE APPLICABLE, CITY OF ALBUQUERQUE PUBLIC WORKS STANDARDS SHALL APPLY.
2. THE CONTRACTOR SHALL ABIDE BY ALL LOCAL, STATE, AND FEDERAL LAWS, RULES AND REGULATIONS WHICH APPLY TO THE CONSTRUCTION OF THESE IMPROVEMENTS, INCLUDING EPA REQUIREMENTS WITH RESPECT TO STORM WATER DISCHARGE.
3. PRIOR TO CONSTRUCTION, THE CONTRACTOR SHALL FIELD VERIFY THE HORIZONTAL AND VERTICAL LOCATIONS OF ALL POTENTIAL OBSTRUCTIONS INCLUDING ALL UNDERGROUND UTILITIES. SHOULD A CONFLICT EXIST, THE CONTRACTOR SHALL NOTIFY THE CONSTRUCTION OBSERVER OR ENGINEER SO THAT THE CONFLICT CAN BE RESOLVED WITH A MINIMUM AMOUNT OF DELAY.
4. TWO (2) WORKING DAYS PRIOR TO ANY EXCAVATION, THE CONTRACTOR SHALL CONTACT LINE LOCATING SERVICE FOR LOCATION OF EXISTING UTILITIES.
5. ALL ELECTRICAL, TELEPHONE, CABLE TV, GAS AND OTHER UTILITY LINES, CABLES, AND APPURTENANCES ENCOUNTERED DURING CONSTRUCTION THAT REQUIRE RELOCATION, SHALL BE COORDINATED WITH THAT UTILITY. THE CONTRACTOR SHALL BE RESPONSIBLE FOR COORDINATION OF ALL NECESSARY UTILITY ADJUSTMENTS. NO ADDITIONAL COMPENSATION WILL BE ALLOWED FOR DELAYS OR INCONVENIENCES CAUSED BY UTILITY COMPANY WORK CREWS. THE CONTRACTOR MAY BE REQUIRED TO RESCHEDULE HIS ACTIVITIES TO ALLOW UTILITY CREWS TO PERFORM THEIR REQUIRED WORK.
6. THE CONTRACTOR IS RESPONSIBLE FOR VERIFYING LOCATION & ELEVATION OF ALL EXISTING UTILITIES PRIOR TO CONSTRUCTION. THE CONTRACTOR IS ALSO RESPONSIBLE FOR PROTECTING ALL EXISTING UTILITY LINES WITHIN THE CONSTRUCTION AREA. ANY DAMAGE TO EXISTING FACILITIES CAUSED BY CONSTRUCTION ACTIVITY SHALL BE REPAIRED OR REPLACED AT THE CONTRACTOR'S EXPENSE AND APPROVED BY THE CONSTRUCTION OBSERVER.
7. CONSTRUCTION ACTIVITY SHALL BE LIMITED TO THE PROPERTY AND/OR PROJECT LIMITS. ANY DAMAGE TO ADJACENT PROPERTIES RESULTING FROM THE CONSTRUCTION PROCESS SHALL BE REPAIRED OR REPLACED AT THE CONTRACTOR'S EXPENSE.
8. OVERNIGHT PARKING OF CONSTRUCTION EQUIPMENT SHALL NOT OBSTRUCT DRIVEWAYS OR DESIGNATED TRAFFIC LANES. THE CONTRACTOR SHALL NOT STORE ANY EQUIPMENT OR MATERIAL WITHIN THE PUBLIC RIGHT-OF-WAY.
9. THE CONTRACTOR SHALL OBTAIN ALL THE NECESSARY PERMITS FOR THE PROJECT PRIOR TO COMMENCING CONSTRUCTION (I.E., BARRICADEING, TOPSOIL DISTURBANCE, EXCAVATION PERMITS, EPA STORM WATER PERMITS, ETC.).
10. ALL PROPERTY CORNERS DESTROYED DURING CONSTRUCTION SHALL BE REPLACED AT THE CONTRACTOR'S EXPENSE. ALL PROPERTY CORNERS MUST BE RESET BY A REGISTERED LAND SURVEYOR.
11. ALL BARRICADES AND CONSTRUCTION SIGNING SHALL CONFORM TO APPLICABLE SECTIONS OF THE "MANUAL ON UNIFORM TRAFFIC CONTROL DEVICES" (MUTCD), US DEPARTMENT OF TRANSPORTATION, LATEST EDITION.
12. THE CONTRACTOR SHALL MAINTAIN ALL CONSTRUCTION BARRICADES AND SIGNING AT ALL TIMES. THE CONTRACTOR SHALL VERIFY THE PROPER LOCATION OF ALL BARRICADEING AT THE END AND BEGINNING OF EACH DAY.
13. THE CONTRACTOR SHALL TAKE ALL STEPS NECESSARY TO CONFORM WITH EPA REQUIREMENTS, INCLUDING COMPLIANCE WITH NPDES PHASE 2 REQUIREMENTS.
14. THE CONTRACTOR IS RESPONSIBLE FOR SWPPP PREPARATION AND IMPLEMENTATION.

## KEYED NOTES

- \* A. INSTALL 4' DIA. TYPE "E" MANHOLE PER COA STD. DWG. 2102.
- \* B. RETAINING WALL BY OTHERS. SEE SHEET C2.11 FOR TYPICAL RETAINING WALL NOMENCLATURE.
- \* C. INSTALL TYPE "D" SINGLE GRATE INLET, PER COA STD DWG 2206.
- \* D. INSTALL PVC MEDIAN CULVERT. SEE PLAN FOR SIZE AND ELEVATIONS. SEE DETAIL SHEET C2.11.
- \* E. 2' CURB CUT PER DETAIL SHEET C2.11.
- \* F. MODIFIED 4' DIA. TYPE "C" MANHOLE/INLET. SEE DETAIL SHEET C2.11.
- \* G. MODIFIED 6' DIA. TYPE "C" MANHOLE/INLET. SEE DETAIL SHEET C2.11.
- \* H. 1" RIBBON CHANNEL. SEE DETAIL SHEET C2.10.
- \* I. SINGLE GRATE TYPE "A" INLET, PER COA STD DWGS 2201 & 2202.
- \* J. DEBRIS TREATMENT MANHOLE SYSTEM PER DETAILS SHEET C2.11
- \* K. INSTALL 6' DIA TYPE "E" MANHOLE PER COA STD DWG 2012.
- \* L. INSTALL 4" DIA PVC SIDEWALK CULVERT.
- \* M. BUILD 10' WIDE 2" AC TRAIL PER COA STD DWG 2415B
- \* N. INSTALL 6" DIA PVC SIDEWALK CULVERT.

\* Not used this sheet.

## MATERIALS:

SD LINC. CLASS III RCP OR HDPE (UNLESS OTHERWISE NOTED ON PLANS)

## LEGEND

- PROPERTY LINE
- - - - - EXISTING CONTOURS
- 5301.15 EXISTING GROUND SPOT ELEVATION
- 95.53 PROPOSED SPOT ELEVATION
- S=2.0% PROPOSED DIRECTION OF FLOW
- PROPOSED CURB & GUTTER
- - - - - EASEMENT
- PROPOSED STORM DRAIN INLET
- PROPOSED STORM DRAIN MANHOLE
- PROPOSED RETAINING WALL
- EXISTING OVERHEAD POWER LINES AND POWER POLES
- PERIMETER WALL TYPE "A" - 3' VIEW FENCE ON TOP OF BLOCK WALL

**Bohannon & Huston**

No. Date Issue / Description

Project :

DIAMOND MESA

ALBUQUERQUE, N.M.

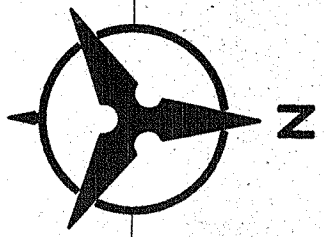

20 10 0 20  
1" = 20'

ACS BRASS TABLET STAMPED "TRANS"  
Geographic Position (NAD 1927)  
N.M. State Plane Coordinates (Central Zone)  
X= 354,899.45 Y= 1,471,822.67  
Ground-to-Grid Factor = 0.99967921  
 $\Delta\alpha = -00^{\circ}16'42''$   
SLD 1929 Elevation = 5118.43

License Stamp:

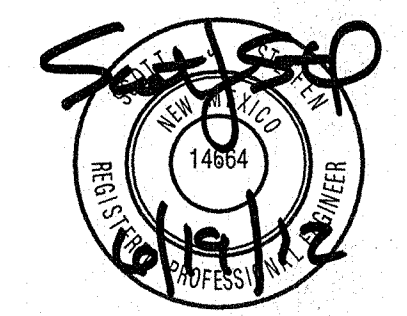

Project Contact:

Phone #:

Fax #:

E-Mail:

Principal in Charge :

Project Director :

Project Designer:

Project Manager:

Sheet Title :

**GRADING & DRAINAGE PLAN**

Sheet No. :

C2.06

## GRADING NOTES

1. EXCEPT AS PROVIDED HEREIN, GRADING SHALL BE PERFORMED AT THE ELEVATIONS AND IN ACCORDANCE WITH THE DETAILS SHOWN ON THIS PLAN.
2. ALL WORK RELATIVE TO FOUNDATION CONSTRUCTION, SITE PREPARATION, AND PAVEMENT INSTALLATION, AS SHOWN ON THIS PLAN, SHALL BE CONSTRUCTED IN ACCORDANCE WITH THE "GEOTECHNICAL INVESTIGATION" AS PROVIDED BY THE ARCHITECT OR OWNER. ALL OTHER WORK SHALL, UNLESS OTHERWISE STATED OR PROVIDED FOR HEREON, BE CONSTRUCTED IN ACCORDANCE WITH THE CITY OF ALBUQUERQUE STANDARD SPECIFICATIONS FOR PUBLIC WORKS.
3. EARTH SLOPES SHALL NOT EXCEED 3 HORIZONTAL TO 1 VERTICAL UNLESS SHOWN OTHERWISE.
4. IT IS THE INTENT OF THESE PLANS THAT THIS CONTRACTOR SHALL NOT PERFORM ANY WORK OUTSIDE OF THE PROPERTY BOUNDARIES EXCEPT AS REQUIRED BY THIS PLAN.
5. THE CONTRACTOR IS TO ENSURE THAT NO SOIL ERODES FROM THE SITE ONTO ADJACENT PROPERTY OR PUBLIC RIGHT-OF-WAY. THIS SHOULD BE ACHIEVED BY CONSTRUCTING TEMPORARY BERMS OR SILT FENCE AT THE PROPERTY LINES AND NETTING THE SOIL TO PROTECT IT FROM WIND EROSION.
6. A DISPOSAL SITE FOR ANY & ALL EXCESS EXCAVATION MATERIAL, AND UNSUITABLE MATERIAL AND/OR A BORROW SITE CONTAINING ACCEPTABLE FILL MATERIAL SHALL BE OBTAINED BY THE CONTRACTOR IN COMPLIANCE WITH APPLICABLE ENVIRONMENTAL REGULATIONS AND APPROVED BY THE OBSERVER. ALL COSTS INCURRED IN OBTAINING A DISPOSAL OR BORROW SITE AND Haul TO OR FROM SHALL BE CONSIDERED INCIDENTAL TO THE PROJECT AND NO SEPARATE MEASUREMENT OR PAYMENT SHALL BE MADE.
7. VERIFY ALL ELEVATIONS SHOWN ON PLAN FROM BASIS OF ELEVATION CONTROL STATION PRIOR TO BEGINNING CONSTRUCTION.
8. ALL CURB IS 6" DIAMETER CURB UNLESS OTHERWISE NOTED. ALL ELEVATIONS ARE TAKEN AT THE FLOWLINE OF THE CURB UNLESS OTHERWISE NOTED.
9. ALL ELEVATIONS SHOWN ALONG MEDIAN CURB ARE AT FLOWLINE UNLESS OTHERWISE INDICATED.

## NOTICE TO CONTRACTORS

1. CONTRACTOR SHALL ADJUST ALL MANHOLES TO FINISHED GRADE PER COA STD. DWG. 2111.
2. 10' WIDE AC TRAIL SHALL BE CONSTRUCTED IN ACCORDANCE WITH THE CITY OF ALBUQUERQUE STANDARD SPECIFICATIONS FOR PUBLIC WORKS CONSTRUCTION, 1986 EDITION AS REVISED THROUGH UPDATE #2.



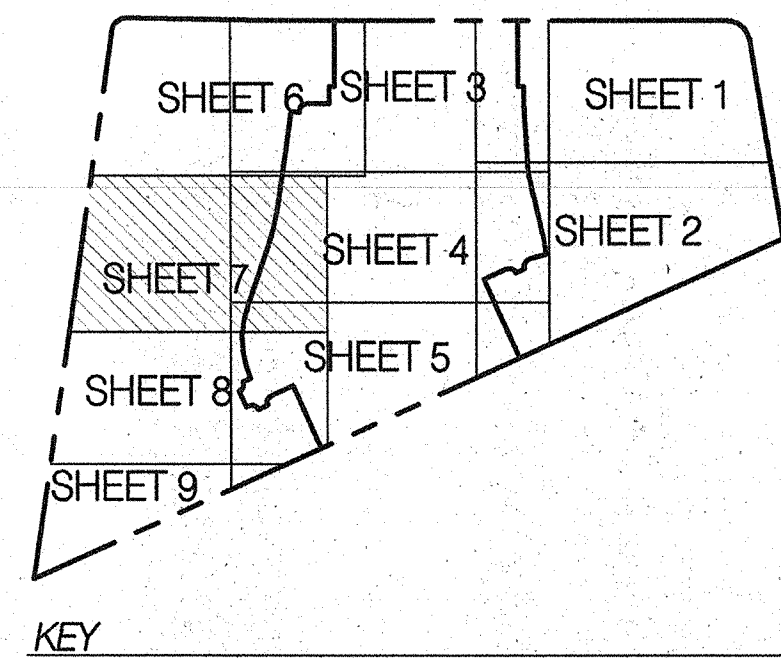

GENERAL NOTES

1. ALL WORK DETAILED ON THESE PLANS AND PERFORMED UNDER THIS CONTRACT SHALL BE CONSTRUCTED IN ACCORDANCE WITH THE PROJECT SPECIFICATIONS AND THE PROJECT GEOLOGICAL REPORT, WHERE APPLICABLE. CITY OF ALBUQUERQUE PUBLIC WORKS STANDARDS SHALL APPLY.
2. THE CONTRACTOR SHALL ABIDE BY ALL LOCAL, STATE, AND FEDERAL LAWS, RULES AND REGULATIONS WHICH APPLY TO THE CONSTRUCTION OF THESE IMPROVEMENTS, INCLUDING EPA REQUIREMENTS WITH RESPECT TO STORM WATER DISCHARGE.
3. PRIOR TO CONSTRUCTION, THE CONTRACTOR SHALL FIELD VERIFY THE HORIZONTAL AND VERTICAL LOCATIONS OF ALL POTENTIAL OBSTRUCTIONS INCLUDING ALL UNDERGROUND UTILITIES. SHOULD A CONFLICT EXIST, THE CONTRACTOR SHALL NOTIFY THE CONSTRUCTION OBSERVER OR ENGINEER SO THAT THE CONFLICT CAN BE RESOLVED WITH A MINIMUM AMOUNT OF DELAY.
4. TWO (2) WORKING DAYS PRIOR TO ANY EXCAVATION, THE CONTRACTOR SHALL CONTACT LINE LOCATING SERVICE FOR LOCATION OF EXISTING UTILITIES.
5. ALL ELECTRICAL, TELEPHONE, CABLE TV, GAS AND OTHER UTILITY LINES, CABLES, AND APPURTENANCES ENCOUNTERED DURING CONSTRUCTION THAT REQUIRE RELOCATION, SHALL BE COORDINATED WITH THAT UTILITY. THE CONTRACTOR SHALL BE RESPONSIBLE FOR COORDINATION OF ALL NECESSARY UTILITY ADJUSTMENTS. NO ADDITIONAL COMPENSATION WILL BE ALLOWED FOR DELAYS OR INCONVENIENCES CAUSED BY UTILITY COMPANY WORK CREWS. THE CONTRACTOR MAY BE REQUIRED TO RESCHEDULE HIS ACTIVITIES TO ALLOW UTILITY CREWS TO PERFORM THEIR REQUIRED WORK.
6. THE CONTRACTOR IS RESPONSIBLE FOR VERIFYING LOCATION & ELEVATION OF ALL EXISTING UTILITIES PRIOR TO CONSTRUCTION. THE CONTRACTOR IS ALSO RESPONSIBLE FOR PROTECTING ALL EXISTING UTILITY LINES WITHIN THE CONSTRUCTION AREA. ANY DAMAGE TO EXISTING FACILITIES CAUSED BY CONSTRUCTION ACTIVITY SHALL BE REPAIRED OR REPLACED AT THE CONTRACTOR'S EXPENSE AND APPROVED BY THE CONSTRUCTION OBSERVER.
7. CONSTRUCTION ACTIVITY SHALL BE LIMITED TO THE PROPERTY AND/OR PROJECT LIMITS. ANY DAMAGE TO ADJACENT PROPERTIES RESULTING FROM THE CONSTRUCTION PROCESS SHALL BE REPAIRED OR REPLACED AT THE CONTRACTOR'S EXPENSE.
8. OVERNIGHT PARKING OF CONSTRUCTION EQUIPMENT SHALL NOT OBSTRUCT DRIVEWAYS OR DESIGNATED TRAFFIC LANES. THE CONTRACTOR SHALL NOT STORE ANY EQUIPMENT OR MATERIAL WITHIN THE PUBLIC RIGHT-OF-WAY.
9. THE CONTRACTOR SHALL OBTAIN ALL THE NECESSARY PERMITS FOR THE PROJECT PRIOR TO COMMENCING CONSTRUCTION (I.E., BARRICADING, TOPSOIL DISTURBANCE, EXCAVATION PERMITS, EPA STORM WATER PERMITS, ETC.).
10. ALL PROPERTY CORNERS DESTROYED DURING CONSTRUCTION SHALL BE REPLACED AT THE CONTRACTOR'S EXPENSE. ALL PROPERTY CORNERS MUST BE RESET BY A REGISTERED LAND SURVEYOR.
11. ALL BARRICADES AND CONSTRUCTION SIGNING SHALL CONFORM TO APPLICABLE SECTIONS OF THE "MANUAL ON UNIFORM TRAFFIC CONTROL DEVICES" (MUTCD), US DEPARTMENT OF TRANSPORTATION, LATEST EDITION.
12. THE CONTRACTOR SHALL MAINTAIN ALL CONSTRUCTION BARRICADES AND SIGNING AT ALL TIMES. THE CONTRACTOR SHALL VERIFY THE PROPER LOCATION OF ALL BARRICADES AT THE END AND BEGINNING OF EACH DAY.
13. THE CONTRACTOR SHALL TAKE ALL STEPS NECESSARY TO CONFORM WITH EPA REQUIREMENTS, INCLUDING COMPLIANCE WITH NPDES PHASE 2 REQUIREMENTS.
14. THE CONTRACTOR IS RESPONSIBLE FOR SWPPP PREPARATION AND IMPLEMENTATION.

KEYED NOTES

- \* A. INSTALL 4' DIA. TYPE "E" MANHOLE PER COA STD. DWG. 2102.
- \* B. RETAINING WALL BY OTHERS. SEE SHEET C2.11 FOR TYPICAL RETAINING WALL NOMENCLATURE.
- \* C. INSTALL TYPE "D" SINGLE GRATE INLET, PER COA STD DWG 2206.
- \* D. INSTALL PVC MEDIAN CULVERT. SEE PLAN FOR SIZE AND ELEVATIONS. SEE DETAIL SHEET C2.11.
- \* E. 2' CURB CUT PER DETAIL SHEET C2.11.
- \* F. MODIFIED 4' DIA. TYPE "C" MANHOLE/INLET. SEE DETAIL SHEET C2.11.
- \* G. MODIFIED 6' DIA. TYPE "C" MANHOLE/INLET. SEE DETAIL SHEET C2.11.
- \* H. 1' RIBBON CHANNEL. SEE DETAIL SHEET C2.10.
- \* I. SINGLE GRATE TYPE "A" INLET, PER COA STD DWGS 2201 & 2202.
- \* J. DEBRIS TREATMENT MANHOLE SYSTEM PER DETAILS SHEET C2.11
- \* K. INSTALL 6' DIA TYPE "E" MANHOLE PER COA STD DWG 2012.
- \* L. INSTALL 4' DIA PVC SIDEWALK CULVERT.
- \* M. BUILD 10' WIDE 2' AC TRAIL PER COA STD DWG 2415B
- \* N. INSTALL 6" DIA PVC SIDEWALK CULVERT.

\* Not used this sheet.

MATERIALS:

SD LINE: CLASS II RCP OR HDPE (UNLESS OTHERWISE NOTED ON PLANS)

GRADING NOTES

1. EXCEPT AS PROVIDED HEREIN, GRADING SHALL BE PERFORMED AT THE ELEVATIONS AND IN ACCORDANCE WITH THE DETAILS SHOWN ON THIS PLAN.
2. ALL WORK RELATIVE TO FOUNDATION CONSTRUCTION, SITE PREPARATION, AND PAVEMENT INSTALLATION, AS SHOWN ON THIS PLAN, SHALL BE CONSTRUCTED IN ACCORDANCE WITH THE "GEOLOGICAL INVESTIGATION," AS PROVIDED BY THE ARCHITECT OR OWNER. ALL OTHER WORK SHALL, UNLESS OTHERWISE STATED OR PROVIDED FOR HEREON, BE CONSTRUCTED IN ACCORDANCE WITH THE CITY OF ALBUQUERQUE STANDARD SPECIFICATIONS FOR PUBLIC WORKS.
3. EARTH SLOPES SHALL NOT EXCEED 3 HORIZONTAL TO 1 VERTICAL UNLESS SHOWN OTHERWISE.
4. IT IS THE INTENT OF THESE PLANS THAT THIS CONTRACTOR SHALL NOT PERFORM ANY WORK OUTSIDE OF THE PROPERTY BOUNDARIES EXCEPT AS REQUIRED BY THIS PLAN.
5. THE CONTRACTOR IS TO ENSURE THAT NO SOIL ERODES FROM THE SITE ONTO ADJACENT PROPERTY OR PUBLIC RIGHT-OF-WAY. THIS SHOULD BE ACHIEVED BY CONSTRUCTING TEMPORARY BERMS OR SILT FENCE AT THE PROPERTY LINES AND NETTING THE SOIL TO PROTECT IT FROM WIND EROSION.
6. A DISPOSAL SITE FOR ANY & ALL EXCESS EXCAVATION MATERIAL, AND UNSUITABLE MATERIAL AND/OR A BORROW SITE CONTAINING ACCEPTABLE FILL MATERIAL SHALL BE OBTAINED BY THE CONTRACTOR IN COMPLIANCE WITH APPLICABLE ENVIRONMENTAL REGULATIONS AND APPROVED BY THE OBSERVER. ALL COSTS INCURRED IN OBTAINING A DISPOSAL OR BORROW SITE AND Haul TO OR FROM SHALL BE CONSIDERED INCIDENTAL TO THE PROJECT AND NO SEPARATE MEASUREMENT OR PAYMENT SHALL BE MADE.
7. VERIFY ALL ELEVATIONS SHOWN ON PLAN FROM BASIS OF ELEVATION CONTROL STATION PRIOR TO BEGINNING CONSTRUCTION.
8. ALL CURB IS 6" MEDIAN CURB UNLESS OTHERWISE NOTED. ALL ELEVATIONS ARE TAKEN AT THE FLOWLINE OF THE CURB UNLESS OTHERWISE NOTED.
9. ALL ELEVATIONS SHOWN ALONG MEDIAN CURB ARE AT FLOWLINE UNLESS OTHERWISE INDICATED.

NOTICE TO CONTRACTORS

1. CONTRACTOR SHALL ADJUST ALL MANHOLES TO FINISHED GRADE PER COA STD. DWG. 2111.
2. 10' WIDE AC TRAIL SHALL BE CONSTRUCTED IN ACCORDANCE WITH THE CITY OF ALBUQUERQUE STANDARD SPECIFICATIONS FOR PUBLIC WORKS CONSTRUCTION, 1986 EDITION AS REVISED THROUGH UPDATE #8.

LEGEND

- PROPERTY LINE
- - - - - 5301.15 EXISTING CONTOURS
- X 5301.15 EXISTING GROUND SPOT ELEVATION
- 95.53 PROPOSED SPOT ELEVATION
- S=2.0% PROPOSED DIRECTION OF FLOW
- PROPOSED CURB & GUTTER
- EASEMENT
- PROPOSED STORM DRAIN INLET
- PROPOSED STORM DRAIN MANHOLE
- PROPOSED RETAINING WALL
- EXISTING OVERHEAD POWER LINES AND POWER POLES
- ..... PERIMETER WALL TYPE "A" - 3' VIEW FENCE ON TOP OF BLOCK WALL

Bohannon & Huston

No. Date Issue / Description

Project :

DIAMOND MESA

ALBUQUERQUE, N.M.

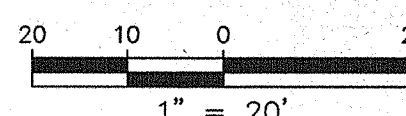
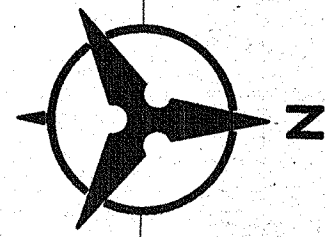

ACS BRASS TABLET STAMPED "TRANS"  
Geographic Position (NAD 1927)  
N.M. State Plane Coordinates (Central Zone)  
X= 354,899.45 Y= 1,471,822.67  
Ground-to-Ground Factor = 0.99967921  
ΔX = -00'16"42"  
SLD 1929 Elevation = 5118.43

License Stamp:

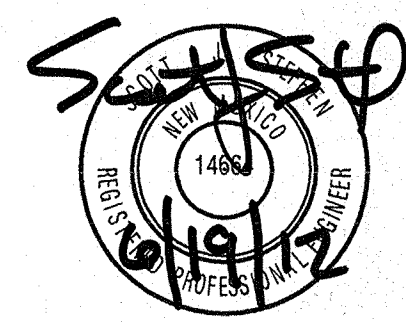

Project Contact:

Phone #:

Fax #:

E-Mail:

Principal in Charge :

Project Director :

Project Designer:

Project Manager:

Sheet Title :

GRADING & DRAINAGE  
PLAN

Sheet No. :

C2.07



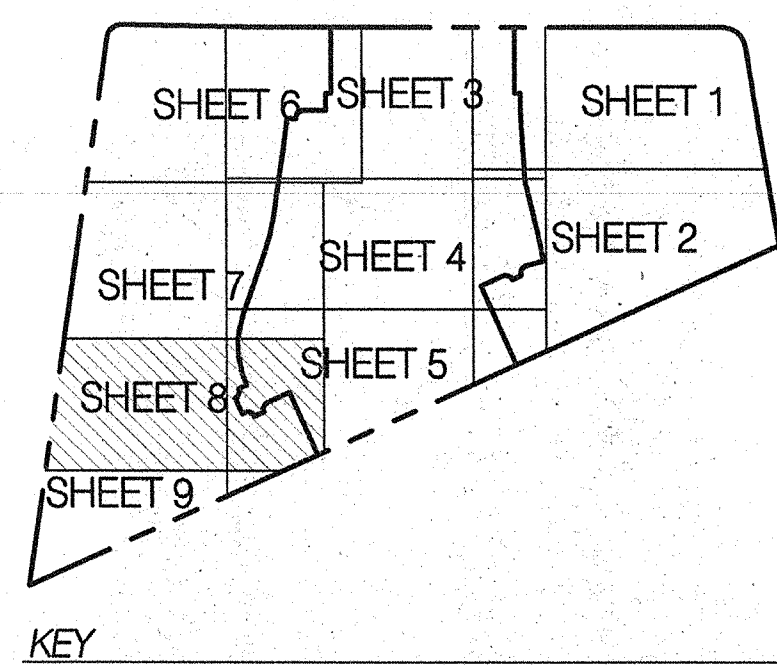



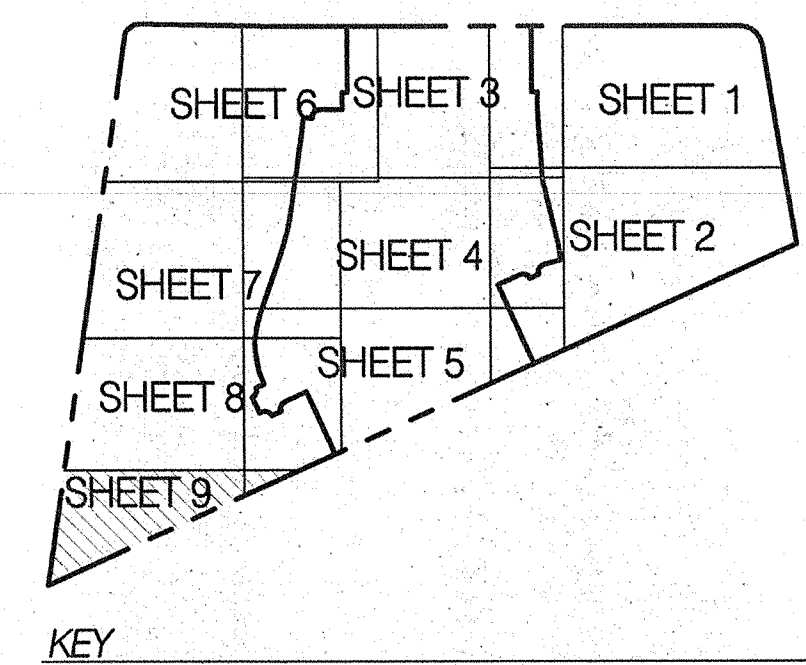

1. ALL WORK DETAILED ON THESE PLANS AND PERFORMANCE UNDER THIS CONTRACT SHALL BE COMPLETED IN ACCORDANCE WITH THE PROJECT SPECIFICATIONS AND THE PROJECT TECHNICAL REPORT. WHERE APPLICABLE, CITY OF ALBUQUERQUE PUBLIC WORKS STANDARDS SHALL APPLY.
2. THE CONTRACTOR SHALL ABIDE BY ALL LOCAL, STATE, AND FEDERAL LAWS, RULES AND REGULATIONS WHICH APPLY TO THE CONSTRUCTION OF THESE IMPROVEMENTS, INCLUDING EPA REQUIREMENTS WITH RESPECT TO STORM WATER DISCHARGE.
3. PRIOR TO CONSTRUCTION, THE CONTRACTOR SHALL FIELD VERIFY THE HORIZONTAL AND VERTICAL LOCATIONS OF ALL POTENTIAL OBSTRUCTIONS INCLUDING ALL UNDERGROUND UTILITIES SHOULD A CONFLICT EXIST. THE CONTRACTOR SHALL NOTIFY THE CONSTRUCTION OBSERVER OR ENGINEER SO THAT THE CONFLICT CAN BE RESOLVED WITH A MINIMUM AMOUNT OF DELAY.
4. TWO (2) WORKING DAYS PRIOR TO ANY EXCAVATION, THE CONTRACTOR SHALL CONTACT LINE LOCATING SERVICE FOR LOCATION OF EXISTING UTILITIES.
5. ALL ELECTRICAL, TELEPHONE, CABLE TV, GAS AND OTHER UTILITY LINES, CABLES, AND APPURTENANCES ENCOUNTERED DURING CONSTRUCTION THAT REQUIRE RELOCATION, SHALL BE COORDINATED WITH THAT UTILITY - THE CONTRACTOR SHALL BE RESPONSIBLE FOR OBTAINING ALL NECESSARY UTILITY ADJUSTMENTS. NO ADDITIONAL COMPENSATION SHALL BE ALLOWED FOR DELAYS OR INCONVENIENCES CAUSED BY UTILITY COMPANY WORK. THE CONTRACTOR MAY BE REQUIRED TO RESCHEDULE HIS ACTIVITIES TO ALLOW UTILITY CREWS TO PERFORM THEIR REQUIRED WORK.
6. THE CONTRACTOR IS RESPONSIBLE FOR VERIFYING LOCATION & ELEVATION OF ALL EXISTING UTILITIES PRIOR TO CONSTRUCTION. THE CONTRACTOR IS ALSO RESPONSIBLE FOR PROTECTING ALL EXISTING UTILITY LINES WITHIN THE CONSTRUCTION AREA. ANY DAMAGE TO EXISTING UTILITIES CAUSED BY CONSTRUCTION ACTIVITY SHALL BE REPAIRED OR REPLACED AT THE CONTRACTOR'S EXPENSE AND APPROVED BY THE CONSTRUCTION OBSERVER.
7. CONSTRUCTION ACTIVITY SHALL BE LIMITED TO THE PROPERTY AND/OR PROJECT LIMITS. ANY DAMAGE TO ADJACENT PROPERTIES RESULTING FROM THE CONSTRUCTION PROCESS SHALL BE REPAIRED OR REPLACED AT THE CONTRACTOR'S EXPENSE.
8. OVERNIGHT PARKING OF CONSTRUCTION EQUIPMENT SHALL NOT OBSTRUCT DRIVEWAYS OR DESIGNATED TRAFFIC LINES. THE CONTRACTOR SHALL NOT STORE ANY EQUIPMENT OR MATERIAL WITHIN THE PUBLIC RIGHT-OF-WAY.
9. THE CONTRACTOR SHALL OBTAIN ALL NECESSARY PERMITS, INCLUDING THE PROJECT PRIOR TO COMMENCING CONSTRUCTION (I.E., BARRICADE, TPOFF, DISTURBANCE, EXCAVATION PERMITS, EPA STORM WATER PERMITS, ETC.).
10. ALL PROPERTY CORNERS DESTROYED DURING CONSTRUCTION SHALL BE REPLACED AT THE CONTRACTOR'S EXPENSE. ALL PROPERTY CORNERS MUST BE RESET BY A REGISTERED LAND SURVEYOR.
11. ALL BARRICADES AND CONSTRUCTION SIGNING SHALL CONFORM TO APPLICABLE SECTIONS OF THE "MANUAL ON UNIFORM TRAFFIC CONTROL DEVICES" (MUTCD), US DEPARTMENT OF TRANSPORTATION, LATEST EDITION.
12. THE CONTRACTOR SHALL MAINTAIN ALL CONSTRUCTION BARRICADES AND SIGNING AT ALL TIMES. THE CONTRACTOR SHALL VERIFY THE PROPER LOCATION OF ALL BARRICADE AT THE END AND BEGINNING OF EACH DAY.
13. THE CONTRACTOR SHALL TAKE ALL STEPS NECESSARY TO CONFORM WITH EPA REQUIREMENTS, INCLUDING COMPLIANCE WITH NPDES PHASE 2 REQUIREMENTS.
14. THE CONTRACTOR IS RESPONSIBLE FOR SNIPPY PREPARATION AND IMPLEMENTATION.

- \* A. INSTALL 4" DIA. TYPE "E" MANHOLE PER COA STD. DWG. 2102.
- B. RETAINING WALL BY OTHERS. SEE SHEET C2.11 FOR TYPICAL RETAINING WALL NOMENCLATURE.
- \* C. INSTALL TYPE "D" SINGLE CURB INLET, PER COA STD DW 2206.
- D. INSTALL PVC MEDIAN CULVERT. SEE PLAN FOR SIZE AND ELEVATIONS. SEE DETAIL SHEET C2.11.
- E. 2' CURB CUT PER DETAIL SHEET C2.11.
- \* F. MODIFIED 4" DIA. TYPE "C" MANHOLE/INLET. SEE DETAIL SHEET C2.11.
- G. MODIFIED 6" DIA. TYPE "C" MANHOLE/INLET. SEE DETAIL SHEET C2.11.
- H. 1' RIBBON CHANNEL. SEE DETAIL SHEET C2.10.
- \* I. SINGLE GRATE TYPE "A" INLET, PER COA STD DWGS 2201 & 2202.
- J. DEBRIS TREATMENT MANHOLE SYSTEM PER DETAILS SHEET C2.11
- K. INSTALL 6" DIA TYPE "E" MANHOLE PER COA STD DWG 2102.
- L. INSTALL 4" DIA PVC SIDEWALK CULVERT.
- M. BUILD 10" WDE 2" AC TRAIL PER COA STD DWG 2415B
- N. INSTALL 6" DIA PVC SIDEWALK CULVERT.

**MATERIALS:**  
SD LINE: CLASS III RCP OR HDPE (UNLESS OTHERWISE NOTED ON PLANS)

	PROPERTY LINE
	EXISTING CONTOURS
	EXISTING GROUND SPOT ELEVATION
	PROPOSED SPOT ELEVATION
	PROPOSED DIRECTION OF FLOW
	PROPOSED CURB & GUTTER
	EASEMENT
	PROPOSED STORM DRAIN INLET
	PROPOSED STORM DRAIN MANHOLE
	PROPOSED RETAINING WALL
	EXISTING OVERHEAD POWER LINES AND POWER POLES
	PERIMETER WALL TYPE 'A' - 3' VIEW FENCE ON TOP OF BLOCK WALL

COPYRIGHT ©

C2.09

3. EXCEPT AS PROVIDED HEREIN, GRADING SHALL BE PERFORMED AT THE ELEVATIONS AND IN ACCORDANCE WITH THE DETAILS SHOWN ON THIS PLAN.
4. ANY WORK RELATIVE TO FOUNDATION CONSTRUCTION, SITE PREPARATION, AND PAVEMENT INSTALLATION, AS SHOWN ON THIS PLAN, SHALL BE CONSTRUCTED IN ACCORDANCE WITH THE "GEO TECHNICAL INVESTIGATION," AS PROVIDED BY THE ARCHITECT OR OWNER. ALL OTHER WORK SHALL UNLESS OTHERWISE STATED OR PROVIDED FOR BE CONSTRUCTED IN ACCORDANCE WITH THE CITY OF ALBUQUERQUE STANDARD SPECIFICATIONS FOR PUBLIC WORKS.
5. EARTH SLOPES SHALL NOT EXCEED 3 HORIZONTAL TO 1 VERTICAL UNLESS SHOWN OTHERWISE.
6. IT IS THE INTENT OF THESE PLANS THAT THIS CONTRACTOR SHALL NOT PERFORM ANY WORK OUTSIDE OF THE PROPERTY BOUNDARIES EXCEPT AS REQUIRED BY THIS PLAN.
7. THE CONTRACTOR IS TO ENSURE THAT NO SOIL ERODES FROM THE SITE ONTO ADJACENT PROPERTY. TO PREVENT EROSION, TEST SHOULD BE ACHIEVED BY CONSTRUCTING TEMPORARY BARRIERS OR SILT FENCE AT THE PROPERTY LINES AND WEEDING THE SOIL TO PROTECT IT FROM WIND EROSION.
8. A DISPOSAL SITE FOR ANY & ALL EXCESS EXCAVATION MATERIAL, AND UNSUITABLE MATERIAL AND/OR A BORROW SITE CONTAINING ACCEPTABLE FILL MATERIAL, SHALL BE OBTAINED BY THE CONTRACTOR IN COMPLIANCE WITH APPLICABLE ENVIRONMENTAL REGULATIONS. THE CONTRACTOR SHALL BE RESPONSIBLE FOR OBTAINING ALL NECESSARY DISPOSAL OR BORROW SITE AND HAUL TO OR FROM SHALL BE CONSIDERED INCIDENTAL TO THE PROJECT AND NO SEPARATE MEASUREMENT OR PAYMENT SHALL BE MADE.
9. VERIFY ALL ELEVATIONS SHOWN ON PLAN FROM BASES OF ELEVATION CONTROL STATION PRIOR TO BEGINNING CONSTRUCTION.
10. ALL CURB & G/P MEDIAN CURBS UNLESS OTHERWISE NOTED, THE ELEVATIONS ARE TAKEN AT THE FLOWLINE OF THE CURB UNLESS OTHERWISE NOTED.
11. ALL ELEVATIONS SHOWN ALONG MEDIAN CURBS ARE AT FLOWLINE UNLESS OTHERWISE INDICATED.

1. CONTRACTOR SHALL ADJUST ALL MANHOLES TO FINISHED GRADE PER COA STD. DWG. 2111.

2. 10' WIDE AC TRAIL SHALL BE CONSTRUCTED IN ACCORDANCE WITH THE CITY OF ALBUQUERQUE STANDARD SPECIFICATIONS FOR PUBLIC WORKS CONSTRUCTION, 1986 EDITION AS REVISED THROUGH UPDATE #8.