

PROJECT NO.:  
D  
C  
B  
A

## SITE DATA

LEGAL DESCRIPTION:  
TRACT 12-A-1 BULK LAND PLAN FOR EL RANCHO GRANDE TRACTS 8-A, 9-B-1, 9-B-2, 11-A, 12-A-1, 12-A-2, AND 13-D. SIZE: 6.78 ACRES

EXISTING ZONING: R-1A  
PROPOSED ZONING: NR-SU  
PROPOSED LAND USE: FIRE AND POLICE STATION, OFFICE SPACE

PEDESTRIAN AND VEHICLE ACCESS: PRIMARY VEHICULAR AND PEDESTRIAN ACCESS IS FROM AMOLE MESA AVENUE. A NEW 6 FOOT SIDEWALK WILL BE CONSTRUCTED ALONG AMOLE MESA, WITH PEDESTRIAN CONNECTIONS FROM THE SIDEWALK TO THE BUILDINGS.  
BUS ROUTES: ROUTE 198 ALONG 98<sup>TH</sup> STREET, WITH A PEAK FREQUENCY OF 30 MINUTES

## PARKING REQUIREMENTS

PARKING CALCULATIONS:  
PER IDO TABLE 5-5-1 MINIMUM OFF STREET PARKING REQUIREMENTS:  
• FIRE STATION OR POLICE STATION: 2 SPACES/ 1,000 SQ. FT. GFA  
• OFFICE: 3.5 SPACES PER 1000 SQ. FT. GFA

TOTAL REQUIRED:  
FIRE STATION #23- 12,356 SF, SO (12,356/1000)\*2 = 24.7 SPACES  
POLICE STATION- 3,170 SF, SO (3,170/1000)\*2 = 6.34 SPACES  
ACS- 3,387 SF, SO (3,387/1000)\*3.5 = 11.85 SPACES

TOTAL REQUIRED = 42.89 SPACES, SO 43 SPACES TOTAL

TOTAL PROVIDED:  
82 SPACES TOTAL ON SITE, OF WHICH 4 ARE HC ACCESSIBLE

PER 5-5(D)(1):  
A TOTAL OF 2 MOTORCYCLE SPACES ARE REQUIRED  
3 TOTAL MOTORCYCLE SPACES ARE PROVIDED.

PER TABLE 5-5-5 MINIMUM BICYCLE PARKING REQUIREMENTS:  
3 SPACES OR 10% OF REQUIRED OFF-STREET PARKING SPACES WHICHEVER IS GREATER IS REQUIRED  
SO A TOTAL OF 5 BICYCLE SPACES ARE MINIMUM REQUIRED.  
TOTAL PROVIDED IS 6

## EXECUTIVE SUMMARY

"THIS PROJECT IS A NEW 18,500 SQ. FT. TOTAL BUILDING CENTER. THE REPLACEMENT FIRE STATION, WITH 12,300 SQ. FT., HAS 8 BUNK ROOMS, 4 APPARATUS BAYS, AND 3 OFFICER SUITES. THE POLICE DEPARTMENT UNIT OFFICER SUITES, THE POLICE DEPARTMENT UNIT OFFICER SUITES, A CONFERENCE ROOM, AND WORKSTATIONS. THE COMMUNITY SAFETY CENTER, WITH 3,000 SQ. FT., INCLUDES A TRAINING ROOM, THREE PRIVATE OFFICES, AND WORKSTATIONS.

ALL VEHICLES ARE TO ENTER FROM THE EASTERN ACCESS POINT. VISITOR VEHICLES ARE NOT TO PASS THE SIGN READING "OFFICIAL VEHICLES ONLY BEYOND THIS POINT" (KEYNOTE 8). APD/AFD PERSONAL VEHICLES ARE TO PARK IN THEIR DESIGNATED PARKING LOTS (LOCATED DIRECTLY EAST OF THE FIRE STATION). ALL VEHICLES EXCEPT FOR FIRE TRUCKS ARE TO EXIT USING THE EASTERN SITE ACCESS POINT. ONLY FIRE APPARATUS VEHICLES ARE TO EXIT USING THE WESTERN DRIVEWAY."

- SLOPES ARE TO BE SPECIFIED REFER TO CIVIL DRAWINGS.
  - PARKING LOTS ARE TO HAVE A SLOPE BETWEEN 1% AND 8%
  - PARKING AREAS ADJACENT TO MAJOR CIRCULATION AISLES OR ADJACENT TO MAJOR ENTRANCES ARE TO BE BETWEEN 1% AND 6%
  - HANDICAP PARKING IS TO BE BETWEEN 1% AND 2%
- ALL LIGHT FIXTURES SHALL BE IN COMPLIANCE WITH IDO SECTION 5-8 OUTDOOR AND SITE LIGHTING. LANDSCAPING AND SIGNAGE WILL NOT INTERFERE WITH CLEAR SIGHT REQUIREMENTS. THEREFORE, SIGNS, WALLS, TREES, AND SHRUBBERY BETWEEN 3 AND 8 FEET TALL AS MEASURED FROM THE GUTTER PAN WILL NOT BE ACCEPTABLE IN THE AREA.
- ALL INTERNAL SIDEWALKS SHALL BE 5 FEET IN WIDTH. ON-SITE TRANSFORMERS SHALL HAVE A 5-FOOT CLEAR AREA ON THE SIDES AND REAR AND A 10-FOOT CLEAR AREA IN FRONT TO ALLOW FOR ACCESS AND MAINTENANCE.

GENERAL NOTES

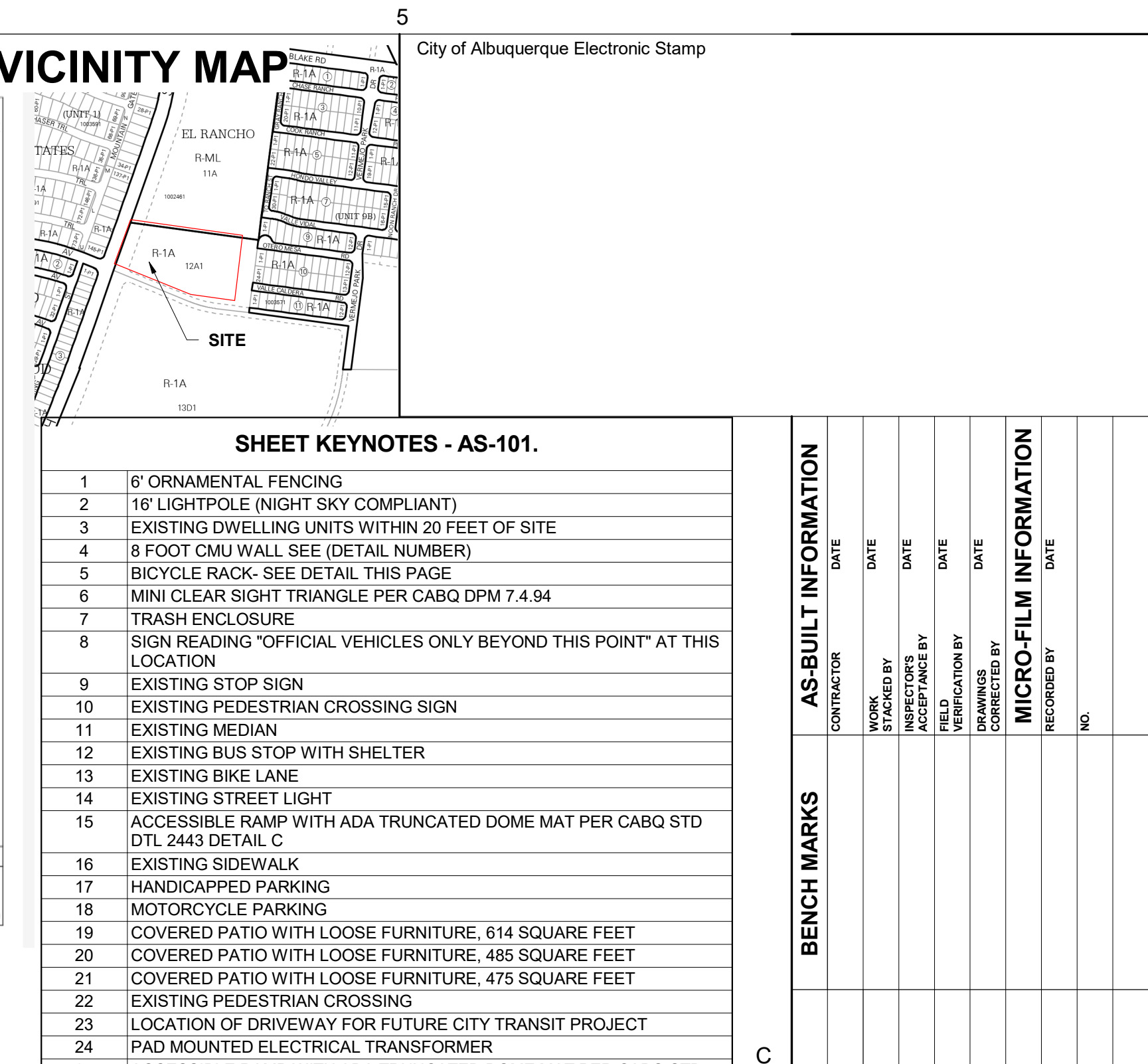
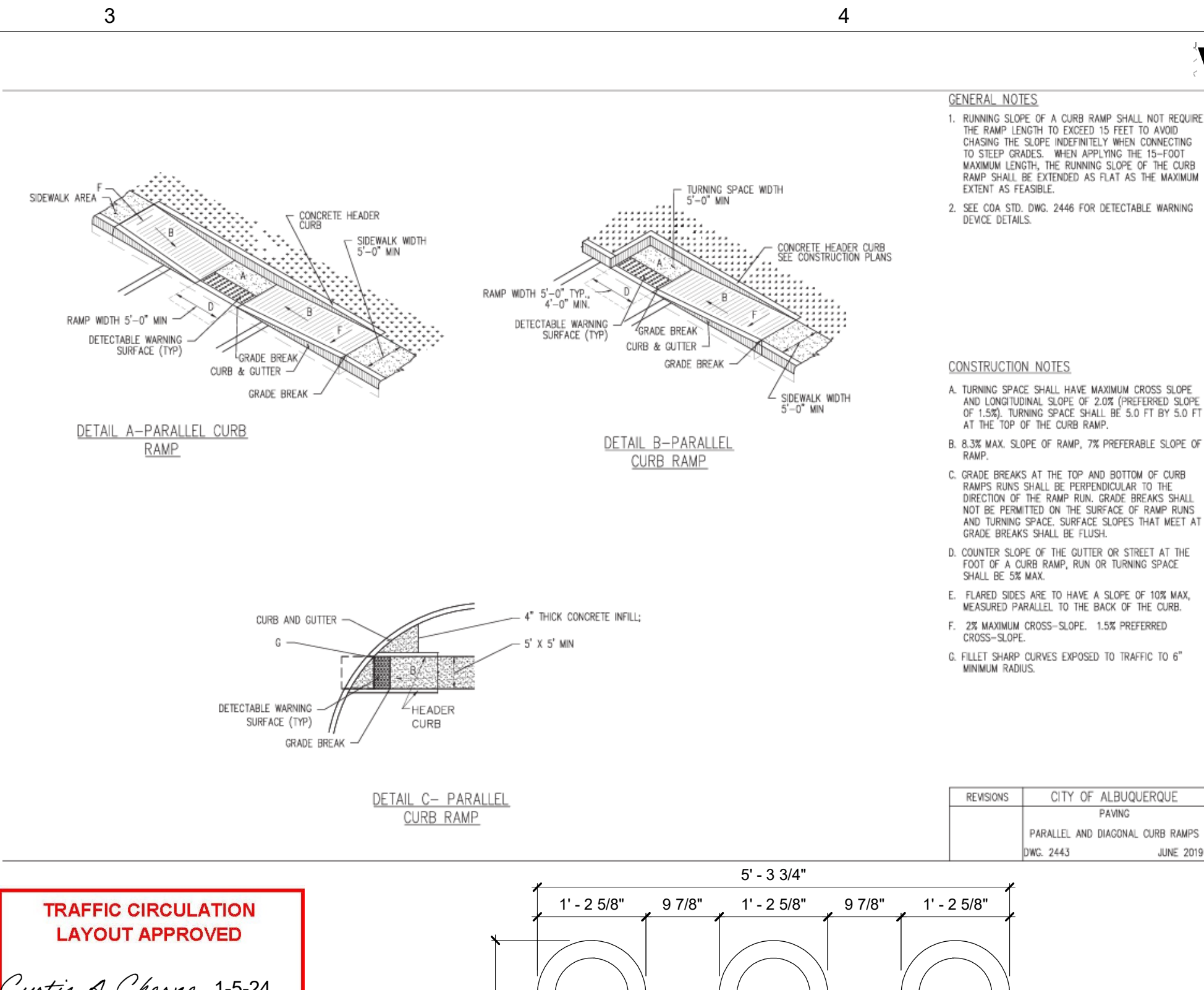
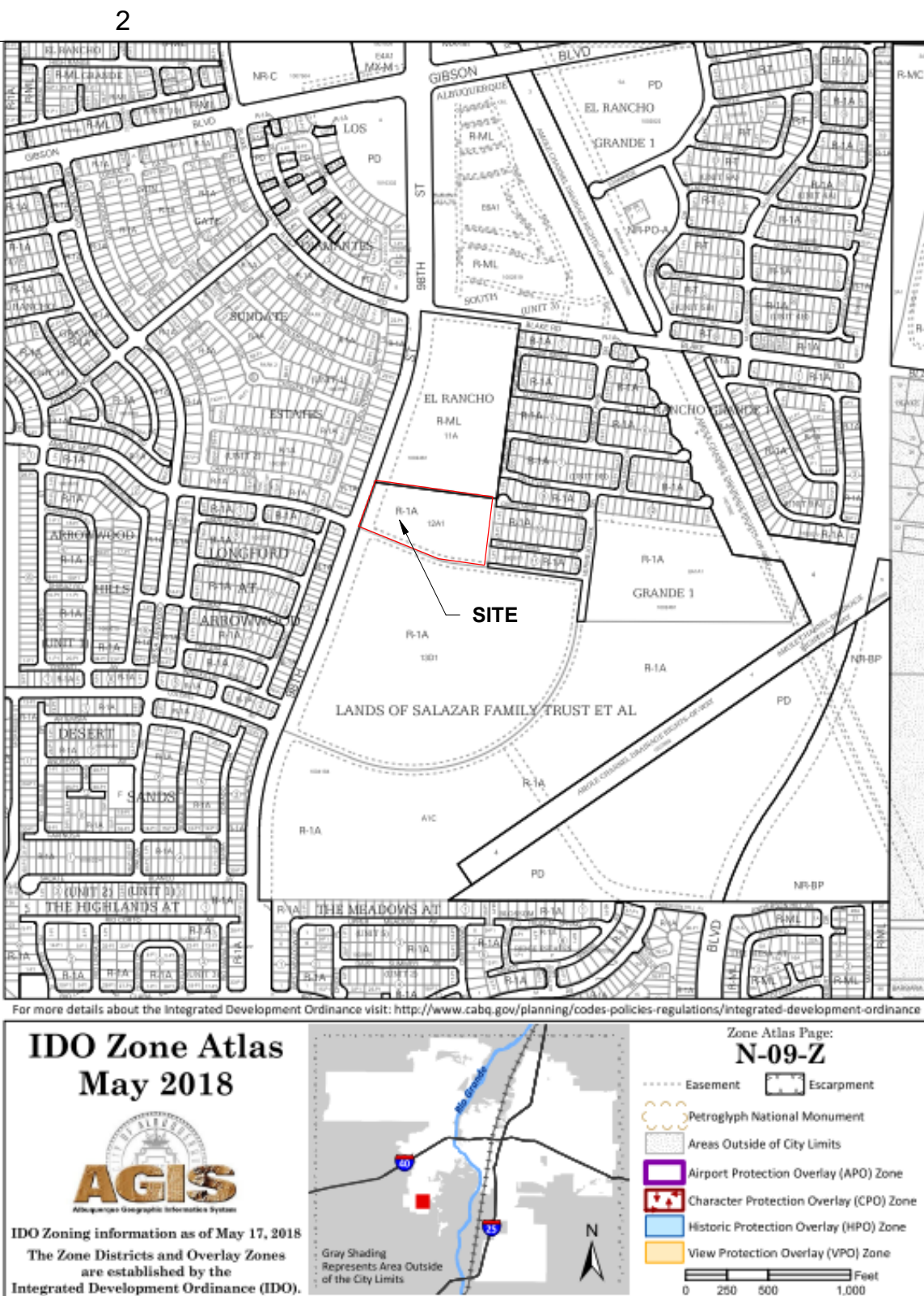

SHEET KEYNOTES - AS-101.	
1	6" ORNAMENTAL FENCING
2	16" LIGHTPOLE (NIGHT SKY COMPLIANT)
3	EXISTING DWELLING UNITS WITHIN 20 FEET OF SITE
4	8 FOOT CMU WALL SEE (DETAIL NUMBER)
5	BICYCLE RACK- SEE DETAIL THIS PAGE
6	MINI CLEAR SIGHT TRIANGLE PER CABQ DPM 7.4.94
7	TRASH ENCLOSURE
8	SIGN READING "OFFICIAL VEHICLES ONLY BEYOND THIS POINT" AT THIS LOCATION
9	EXISTING STOP SIGN
10	EXISTING PEDESTRIAN CROSSING SIGN
11	EXISTING MEDIAN
12	EXISTING BUS STOP WITH SHELTER
13	EXISTING BIKE LANE
14	EXISTING STREET LIGHT
15	ACCESSIBLE RAMP WITH ADA TRUNCATED DOME MAT PER CABQ STD DTL 2443 DETAIL C
16	EXISTING SIDEWALK
17	HANDICAPPED PARKING
18	MOTORCYCLE PARKING
19	COVERED PATIO WITH LOOSE FURNITURE, 614 SQUARE FEET
20	COVERED PATIO WITH LOOSE FURNITURE, 485 SQUARE FEET
21	COVERED PATIO WITH LOOSE FURNITURE, 475 SQUARE FEET
22	EXISTING PEDESTRIAN CROSSING
23	LOCATION OF DRIVEWAY FOR FUTURE CITY TRANSIT PROJECT
24	PAD MOUNTED ELECTRICAL TRANSFORMER
25	ACCESSIBLE RAMP WITH ADA TRUNCATED DOME MAT PER CABQ STD DTL 2443 DETAIL C
26	10' ELECTRICAL EASEMENT
27	EXISTING CIVIL DE-SAC
28	6'-0" TALL ORNAMENTAL CANTILEVER GATE. PROVIDE ELECTRIC OPERATOR WITH MAGNETIC INDUCTION LOOP IN CONCRETE PAVEMENT ON SECURE SIDE AND A PEDESTAL KEYPAD ON UNSECURED SIDE. POWER, CONDUITS, AND ANY COMMUNICATION REQUIREMENTS FULLY WITH OPERATOR UNIT MANUFACTURER REQUIREMENTS
29	6" SOLID WALL (DARK BROWN)
30	PAINTED PAVEMENT STRIPE- STOP LINE, WHITE COLOR
31	PAINTED CROSSWALK STIPES
32	ADA ACCESS PATH
33	PROPOSED DOOR LOCATION
34	6" CURB AND GUTTER TYP.
35	6" STANDING CURB TYP.
36	PROPOSED STANDARD "DO NOT ENTER" TRAFFIC SIGN
37	PROPOSED STANDARD "STOP" TRAFFIC SIGN
38	18" SLOPED CONCRETE MOW STRIP. REFERENCE SITE DETAILS
39	NEW 6' WIDE SIDEWALK PER CABQ STANDARDS
40	EXTENTS OF NEW SIDEWALK- ABUT FLUSH TO EXISTING SIDEWALK RE: CIVIL DRAWINGS
41	NEW 4' WIDE LANDSCAPE BUFFER PER CABQ STANDARDS
42	MOTORCYCLE PARKING SIGNAGE- SEE DETAIL THIS SHEET
43	HC PARKING SIGNAGE- SEE DETAIL THIS SHEET

LEGEND	
	PROPOSED BUILDING
	EXISTING BUILDING
	PAVED ASPHALT
	PAVED CONCRETE
	LANDSCAPE AREA
	PROPOSED 10' WIDE ELECTRICAL EASEMENT
	WEATHERED STEEL ORNAMENTAL FENCE
	WEATHERED STEEL GATE

CITY OF ALBUQUERQUE CAPITAL IMPLEMENTATION PROGRAM			
SOUTHWEST PUBLIC SAFETY CENTER			
Drawing Title			
TCL			
Design Review Committee	City Engineer Approval	Last Design Update	
		Mo./Day/Yr.	
		Mo./Day/Yr.	
Issue Date:	City Project No.	Sheet	
JANUARY 2024		TCL	



A2 HANDICAP PARKING SIGN  
Scale: 3/8" = 1'-0"  
MOTORCYCLE SIGN AND POST SIMILAR



A1 OVERALL SITE PLAN  
Scale: 1" = 40'-0"