

#### GENERAL NOTES

- ALL WORK DETAILED ON THESE PLANS AND PERFORMED UNDER THIS CONTRACT SHALL BE CONSTRUCTED IN ACCORDANCE WITH THE PROJECT SPECIFICATIONS AND THE PROJECT GEOTECHNICAL REPORT. WHERE APPLICABLE, CITY OF ALBUQUERQUE PUBLIC WORKS STANDARDS SHALL APPLY.
- THE CONTRACTOR SHALL ABIDE BY ALL LOCAL, STATE, AND FEDERAL LAWS, RULES AND REGULATIONS WHICH APPLY TO THE CONSTRUCTION OF THESE IMPROVEMENTS, INCLUDING EPA REQUIREMENTS WITH RESPECT TO STORM WATER DISCHARGE.
- PRIOR TO CONSTRUCTION, THE CONTRACTOR SHALL FIELD VERIFY THE HORIZONTAL AND VERTICAL LOCATIONS OF ALL POTENTIAL OBSTRUCTIONS INCLUDING ALL UNDERGROUND UTILITIES. SHOULD A CONFLICT EXIST, THE CONTRACTOR SHALL NOTIFY THE CONSTRUCTION OBSERVER OR ENGINEER SO THAT THE CONFLICT CAN BE RESOLVED WITH A MINIMUM AMOUNT OF DELAY.
- TWO (2) WORKING DAYS PRIOR TO ANY EXCAVATION, THE CONTRACTOR SHALL CONTACT LINE LOCATING SERVICE FOR LOCATION OF EXISTING UTILITIES.
- ALL ELECTRICAL, TELEPHONE, CABLE TV, GAS AND OTHER UTILITY LINES, CABLES, AND APPURTENANCES ENCOUNTERED DURING CONSTRUCTION THAT REQUIRE RELOCATION, SHALL BE COORDINATED WITH THAT UTILITY. THE CONTRACTOR SHALL BE RESPONSIBLE FOR COORDINATION OF ALL NECESSARY UTILITY ADJUSTMENTS. NO ADDITIONAL COMPENSATION WILL BE ALLOWED FOR DELAYS OR INCONVENIENCES CAUSED BY UTILITY COMPANY WORK CREWS. THE CONTRACTOR MAY BE REQUIRED TO RESCHEDULE HIS ACTIVITIES TO ALLOW UTILITY CREWS TO PERFORM THEIR REQUIRED WORK.
- THE CONTRACTOR IS RESPONSIBLE FOR PROTECTING ALL EXISTING UTILITY LINES WITHIN THE CONSTRUCTION AREA. ANY DAMAGE TO EXISTING FACILITIES CAUSED BY CONSTRUCTION ACTIVITY SHALL BE REPAIRED OR REPLACED AT THE CONTRACTOR'S EXPENSE AND APPROVED BY THE CONSTRUCTION OBSERVER.
- CONSTRUCTION ACTIVITY SHALL BE LIMITED TO THE PROPERTY AND/OR PROJECT LIMITS. ANY DAMAGE TO ADJACENT PROPERTIES RESULTING FROM THE CONSTRUCTION PROCESS SHALL BE REPAIRED OR REPLACED AT THE CONTRACTOR'S EXPENSE.
- OVERNIGHT PARKING OF CONSTRUCTION EQUIPMENT SHALL NOT OBSTRUCT DRIVEWAYS OR DESIGNATED TRAFFIC LANES. THE CONTRACTOR SHALL NOT STORE ANY EQUIPMENT OR MATERIAL WITHIN THE PUBLIC RIGHT-OF-WAY.
- THE CONTRACTOR SHALL OBTAIN ALL THE NECESSARY PERMITS FOR THE PROJECT PRIOR TO COMMENCING CONSTRUCTION (I.E., BARRICADING, TOPSOIL DISTURBANCE, EXCAVATION PERMITS, EPA STORM WATER PERMITS, ETC.).
- ALL PROPERTY CORNERS DESTROYED DURING CONSTRUCTION SHALL BE REPLACED AT THE CONTRACTOR'S EXPENSE. ALL PROPERTY CORNERS MUST BE RESET BY A REGISTERED LAND SURVEYOR.
- THE CONTRACTOR SHALL PREPARE A CONSTRUCTION TRAFFIC CONTROL AND SIGNING PLAN AND OBTAIN APPROVAL OF SUCH PLAN FROM THE CITY OF ALBUQUERQUE, TRAFFIC ENGINEERING DEPARTMENT, PRIOR TO BEGINNING ANY CONSTRUCTION WORK ON OR ADJACENT TO EXISTING STREETS.
- ALL BARRICADES AND CONSTRUCTION SIGNING SHALL CONFORM TO APPLICABLE SECTIONS OF THE "MANUAL ON UNIFORM TRAFFIC CONTROL DEVICES" (MUTCD), US DEPARTMENT OF TRANSPORTATION, LATEST EDITION.
- THE CONTRACTOR SHALL MAINTAIN ALL CONSTRUCTION BARRICADES AND SIGNING AT ALL TIMES. THE CONTRACTOR SHALL VERIFY THE PROPER LOCATION OF ALL BARRICADING AT THE END AND BEGINNING OF EACH DAY.
- THE CONTRACTOR SHALL TAKE ALL STEPS NECESSARY TO CONFORM WITH EPA REQUIREMENTS, INCLUDING COMPLIANCE WITH NPDES REQUIREMENTS.

#### GRADING NOTES

- EXCEPT AS PROVIDED HERIN, GRADING SHALL BE PERFORMED AT THE ELEVATIONS AND IN ACCORDANCE WITH THE DETAILS SHOWN ON THIS PLAN.
- CONTRACTOR SHALL OBTAIN AND ABIDE BY A TOPSOIL DISTURBANCE PERMIT FROM THE CITY OF ALBUQUERQUE ENVIRONMENTAL HEALTH DIVISION, PRIOR TO CONSTRUCTION. THE COST FOR REQUIRED CONSTRUCTION DUST AND EROSION CONTROL MEASURES SHALL BE INCIDENTAL TO THE PROJECT COST. THE CONTRACTOR SHALL CONFORM TO ALL CITY, COUNTY, STATE, AND FEDERAL DUST CONTROL MEASURES AND REQUIREMENTS AND WILL BE RESPONSIBLE FOR PREPARING AND OBTAINING ALL NECESSARY APPLICATIONS AND APPROVALS.
- ALL WORK RELATIVE TO FOUNDATION CONSTRUCTION, SITE PREPARATION, AND PAVEMENT INSTALLATION, AS SHOWN ON THIS PLAN, SHALL BE CONSTRUCTED IN ACCORDANCE WITH THE SOILS REPORT. ALL OTHER WORK, UNLESS OTHERWISE STATED OR PROVIDED FOR HEREON, SHALL BE CONSTRUCTED IN ACCORDANCE WITH THE PROJECT SPECIFICATIONS (FIRST PRIORITY), AND/OR THE CITY OF ALBUQUERQUE (COA) STANDARD SPECIFICATIONS FOR PUBLIC WORKS (SECOND PRIORITY).
- TWO WORKING DAYS PRIOR TO EXCAVATION, CONTRACTOR MUST CONTACT LINE LOCATING SERVICE FOR LOCATION OF EXISTING UTILITIES.
- PRIOR TO GRADING, ALL VEGETATION DEBRIS, AND NEAR SURFACE ORGANICALLY CONTAMINATED SOIL SHALL BE STRIPPED FROM ALL AREAS TO BE GRADED. VEGETATION AND DEBRIS SHALL BE DISPOSED OF OFF-SITE OR STOCK-PILED FOR USE IN PLANTERS AND NON-STRUCTURAL FILLS.
- EARTH SLOPES SHALL NOT EXCEED 4 HORIZONTAL TO 1 VERTICAL UNLESS SHOWN OTHERWISE.
- IT IS THE INTENT OF THESE PLANS THAT THIS CONTRACTOR SHALL NOT PERFORM ANY WORK OUTSIDE OF THE PROPERTY BOUNDARIES EXCEPT AS REQUIRED BY THIS PLAN.
- THE CONTRACTOR IS TO ENSURE THAT NO SOIL ERODES FROM THE SITE ONTO ADJACENT PROPERTY OR PUBLIC RIGHT-OF-WAY. THIS SHOULD BE ACHIEVED BY CONSTRUCTING TEMPORARY BERMS AT THE PROPERTY LINES WETTING THE SOIL TO PROTECT IT FROM WIND EROSION.
- A DISPOSAL SITE FOR ALL EXCESS EXCAVATION AND UNSUITABLE MATERIAL SHALL BE OBTAINED BY THE CONTRACTOR IN COMPLIANCE WITH APPLICABLE ENVIRONMENTAL REGULATIONS AND APPROVED BY THE OBSERVER. ALL COSTS INCURRED IN OBTAINING A DISPOSAL SITE AND HAUL THERE TO SHALL BE CONSIDERED INCIDENTAL TO THE PROJECT, AND NO SEPARATE MEASUREMENT OR PAYMENT SHALL BE MADE.
- PAVING AND ROADWAY GRADES SHALL BE +/- 0.1' FROM PLAN ELEVATIONS. PAD ELEVATION SHALL BE +/- 0.05' FROM BUILDING PLAN ELEVATIONS.
- ALL SPOT ELEVATIONS ARE TO FLOWLINE UNLESS OTHERWISE NOTED. VALLEY GUTTER ELEVATIONS ARE SHOWN AT FLOWLINE ELEVATION.
- GRADING SHALL BE IN ACCORDANCE WITH THE GEOTECHNICAL REPORT.

#### LEGEND

- PROPOSED SPOT ELEVATION • 5235.25
- EXISTING SPOT ELEVATION • EX 5235.25
- PROPOSED CONTOUR — 5025
- EXISTING STORM DRAIN LINE - - - - -
- PROPOSED STORM DRAIN INLET
- PROPOSED STORM DRAIN LINE
- PROPOSED STORM DRAIN MANHOLE
- PROPOSED WATER BLOCK
- PERIMETER WALL
- RETAINING WALL
- GARDEN WALL
- PAD
- STREET SLOPE
- DIRECTION OF FLOW
- SWALE
- WATER BLOCK
- PEDESTRIAN TRAIL
- SLOPE CHANGE IN REAR YARD

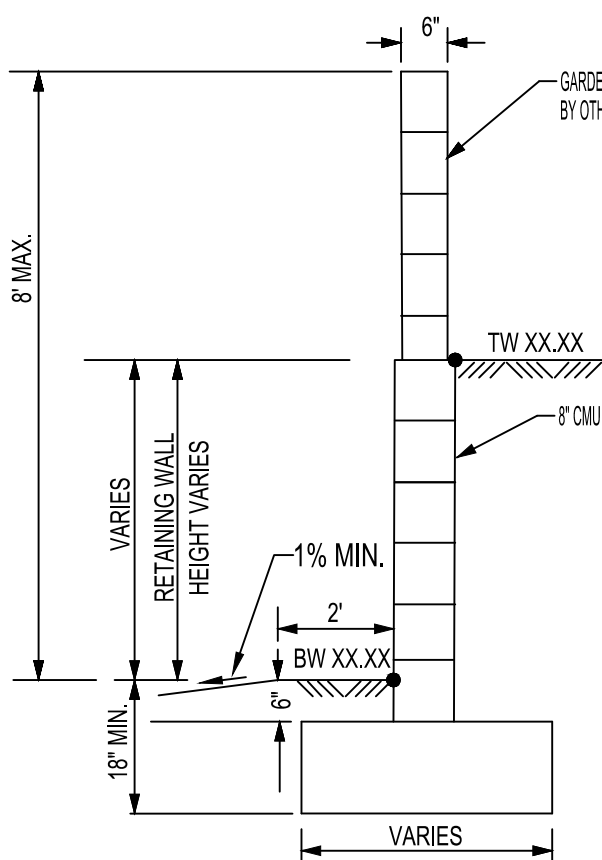

TW=FINISHED GRADE ELEVATION AT TOP OF RETAINING WALL  
BW=FINISHED GRADE ELEVATION AT BOTTOM OF RETAINING WALL

#### TYPICAL RETAINING WALL NOMENCLATURE NOT TO SCALE

(RETAINING HEIGHT IS TAKEN TO BE DIFFERENCE IN FINISHED GRADES ON LEFT AND RIGHT SIDE OF WALL.)

HEIGHT IS IN ACCORDANCE WITH CITY COMPREHENSIVE ZONING CODE, SECTION 14-16-3-19, GENERAL HEIGHT AND DESIGN REGULATIONS FOR WALLS, FENCES, AND RETAINING WALLS.

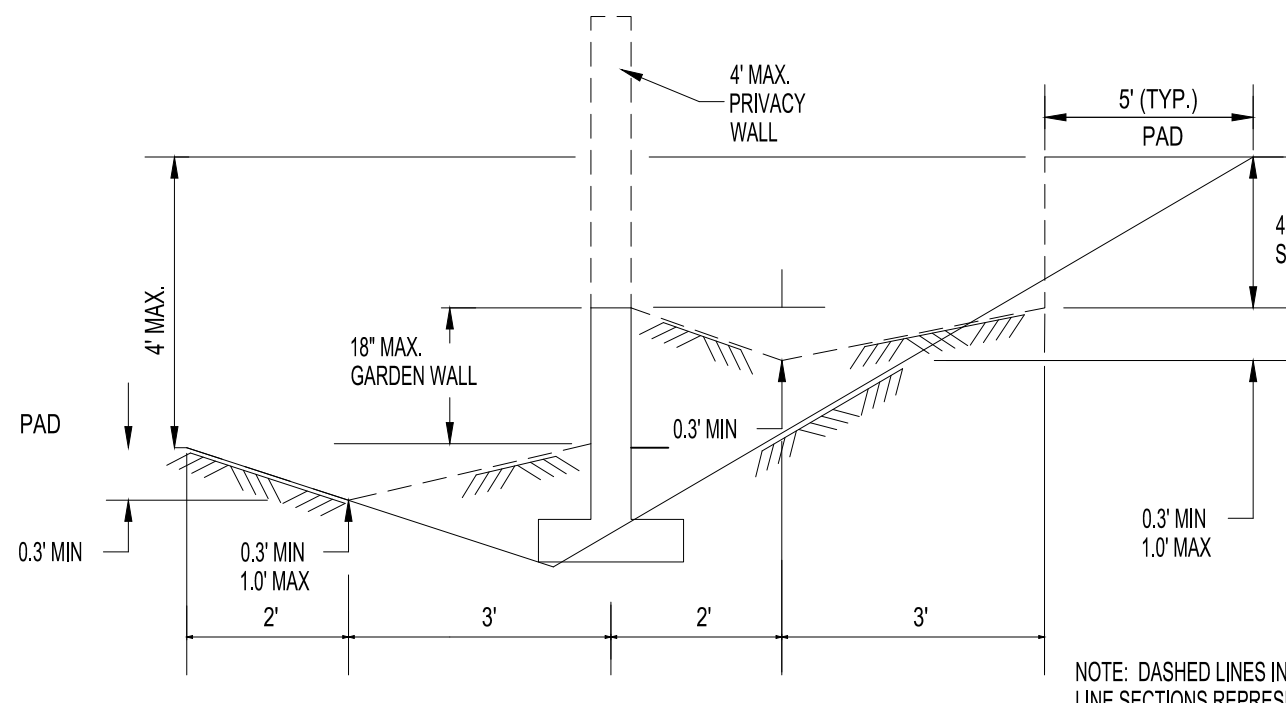

#### TYPICAL SIDE LOT LINE SECTION NOT TO SCALE

NOTE: DASHED LINES IN TYP. SIDE LOT LINE SECTIONS REPRESENT THE FINAL CONDITION AFTER THE GARDEN, STEM, AND PRIVACY WALLS HAVE BEEN CONSTRUCTED. THE INTERIM CONDITION, WHICH IS TO BE CONSTRUCTED BY THE GRADING CONTRACTOR AND CERTIFIED BY THE ENGINEER, IS REPRESENTED BY THE SOLID LINES. RETAINING WALLS WILL BE CONSTRUCTED PRIOR TO GRADING CERTIFICATION.

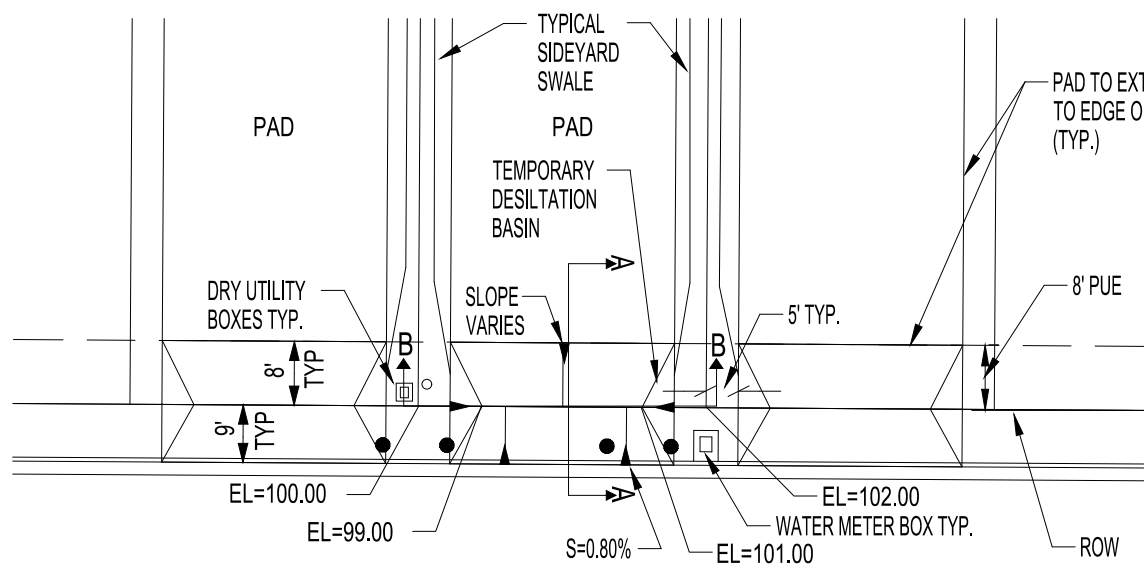
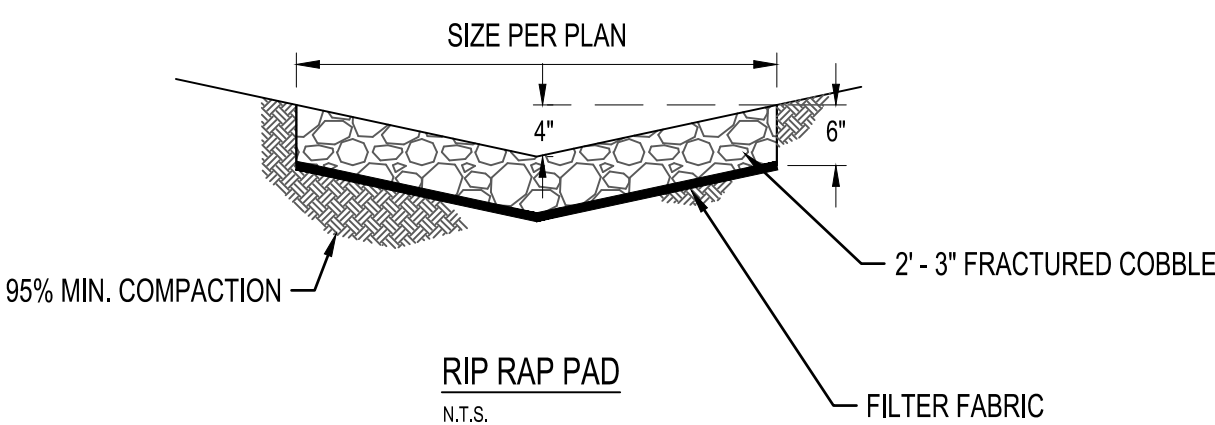

#### TEMPORARY DESILTATION BASIN NOT TO SCALE

\*\* BOTTOM OF BASIN IS 1' BELOW PROPERTY LINE  
ELEVATION SEE GRADING PLANS FOR EXACT ELEVATIONS

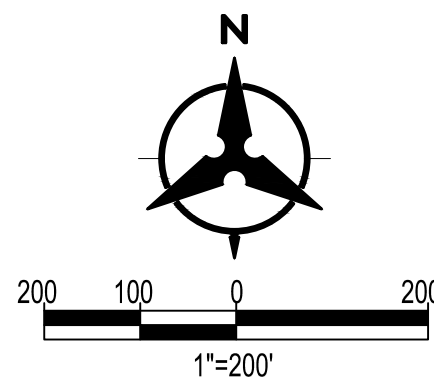
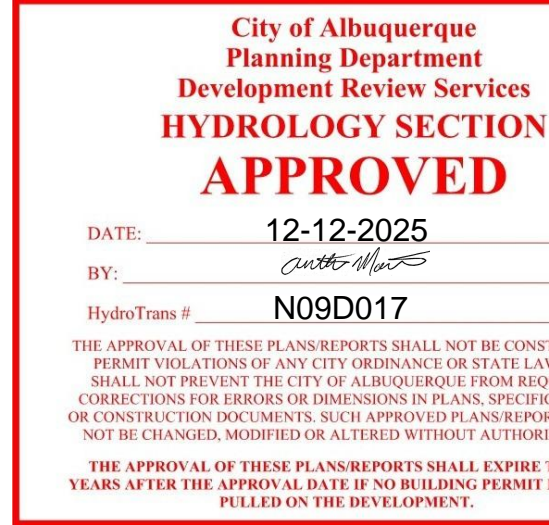

CALL NM ONE-CALL SYSTEM  
SEVEN (7) DAYS PRIOR TO  
ANY EXCAVATION

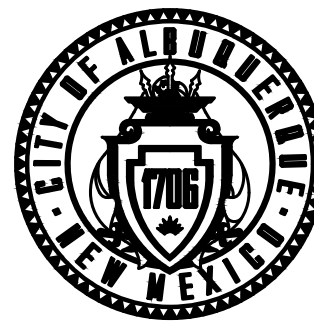

#### CITY OF ALBUQUERQUE DEPARTMENT OF MUNICIPAL DEVELOPMENT ENGINEERING DIVISION

#### TA LANDS PHASE 1 OVERALL GRADING PLAN

DESIGN REVIEW COMMITTEE	CITY ENGINEER APPROVAL	ZONE MAP NO. N-09-Z
		CITY PROJECT NO. 763684
		SHEET NO. 3 OF 43

CONSULTANTS

BENCH MARKS

ACS MONUMENT "2, P9  
NAD 1983 CENTRAL ZONE  
X=1494599.151 \*  
Y=1464676.438 \*  
Z=5056.962 \* (NAVD 1988)  
G-G=0.99986399  
MAPPING ANGLE=0°16'46.36"  
"U.S. SURVEY FEET



December 5, 2025

SEAL

NO.	DATE	DESCRIPTION	BY
		CONTRACTOR:	
		AS-BUILT INFORMATION	
		WORK STAKED BY:	DATE:
		INSPECTOR'S ACCEPTANCE BY:	DATE:
		FIELD VERIFICATION BY:	DATE:
		DRAWINGS CORRECTED BY:	DATE:

DESIGNED BY: KK  
DRAWN BY: DO, SMS, RV, RC  
CHECKED BY: KK  
DATE 12/12/2025



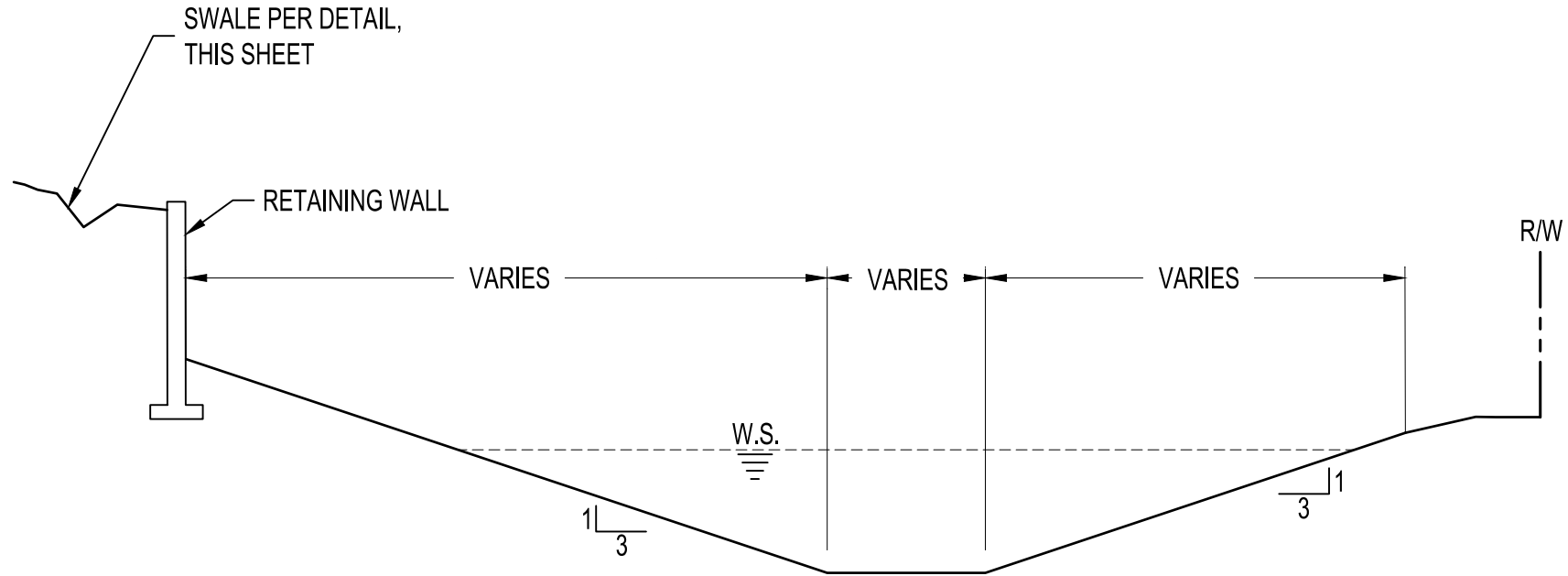

SECTION A-A  
N.T.S.

NORTH POND  
BOTTOM = 5041'  
POND TOP = 5048'  
Q<sub>in</sub> = 102.6 cfs  
Q<sub>out</sub> = 21.4 cfs  
PEAK ELEVATION = 5047.1'  
REQUIRED VOLUME = 100,188 CF  
PROVIDED VOLUME = 124,349.4 CF  
3:1 SIDE SLOPES  
1' FREE BOARD

INSTALL COBBLE SWALE  
FOR EROSION PROTECTION  
SEE DETAIL, THIS SHEET

POND TO BE  
CONSTRUCTED WITH  
INFRASTRUCTURE PLANS

MATCHLINE SHEET 7

MATCHLINE SHEET 5

LEGEND

- PROPOSED SPOT ELEVATION • 5235.25
- EXISTING SPOT ELEVATION • EX 5235.25
- PROPOSED CONTOUR -5025-
- EXISTING STORM DRAIN LINE - - - - -
- PROPOSED STORM DRAIN INLET
- PROPOSED STORM DRAIN LINE
- PROPOSED STORM DRAIN MANHOLE
- PROPOSED WATER BLOCK
- PERIMETER WALL
- RETAINING WALL
- GARDEN WALL
- PAD
- STREET SLOPE
- DIRECTION OF FLOW
- SWALE
- WATER BLOCK
- PEDESTRIAN TRAIL
- SLOPE CHANGE IN REAR YARD

GRADING KEYNOTES

- INSTALL RIP RAP PAD PER DETAIL SHEET 3
- 12' WIDE MAINTENANCE ROAD PER PAVEMENT SECTION

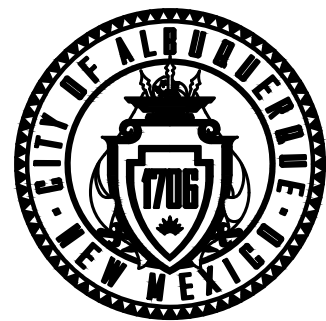
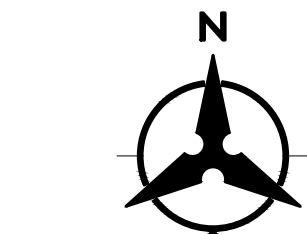
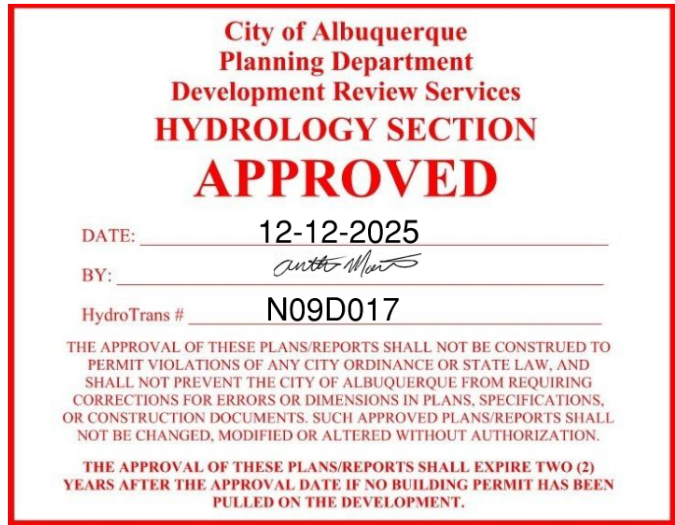
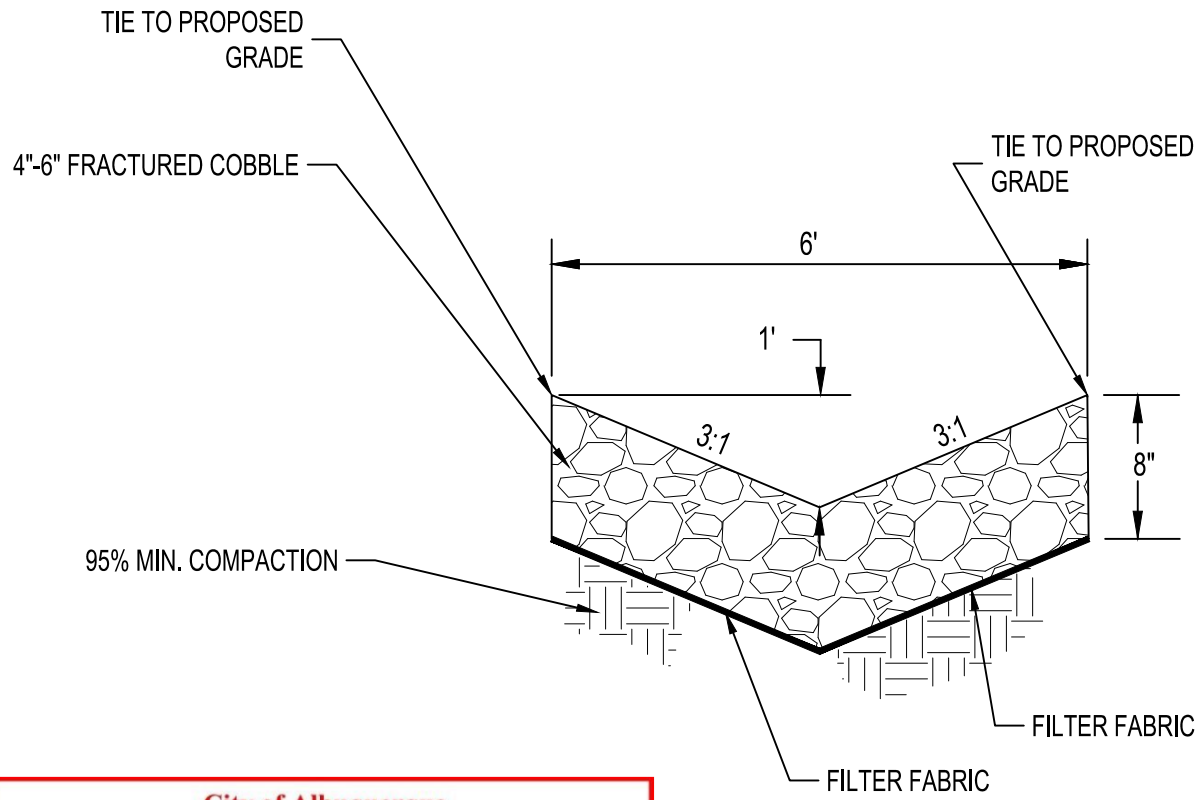

CITY OF ALBUQUERQUE  
DEPARTMENT OF MUNICIPAL DEVELOPMENT  
ENGINEERING DIVISION

TA LANDS PHASE 1  
GRADING PLAN

DESIGN REVIEW COMMITTEE	CITY ENGINEER APPROVAL	ZONE MAP NO. N-09-Z
		CITY PROJECT NO. 763684
		SHEET NO. 4 OF 43

CONSULTANTS  
ACS MONUMENT '2, P9  
NAD 1983 CENTRAL ZONE  
X=1494599.151 \*  
Y=1464676.438 \*  
Z=5056.962 \* (NAVD 1988)  
G-G=0.99986399  
MAPPING ANGLE=0°16'46.36"  
\*U.S. SURVEY FEET



December 5, 2025

SEAL	NO.	DATE	DESCRIPTION	BY
			CONTRACTOR:	
			WORK STAKED BY:	
			INSPECTOR'S ACCEPTANCE BY:	
			FIELD VERIFICATION BY:	
			DRAWINGS CORRECTED BY:	

DESIGNED BY: KK  
DRAWN BY: DO, SMS, RV, RC  
CHECKED BY: KK  
DATE 12/12/2025



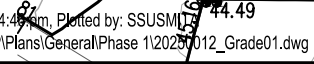
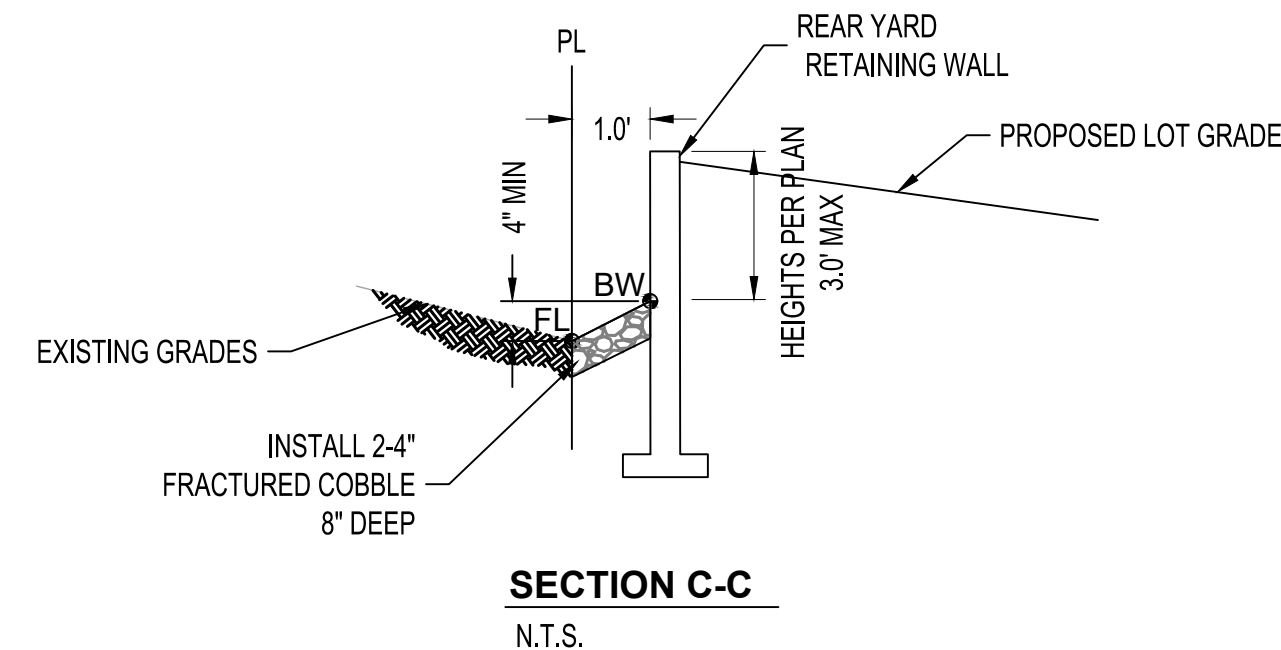

- GRADING KEYNOTES**
1. INSTALL RIP RAP PAD PER DETAIL SHEET 3
  2. 12' WIDE MAINTENANCE ROAD PER PAVEMENT SECTION



**TA LANDS PHASE 1  
GRADING PLAN**

ZONE MAP NO.	N-09-Z
CITY PROJECT NO.	763684
SHEET NO.	5 OF 43

**Bohannon  
▲ Huston**  
www.bhinc.com  
800.877.5332



December 5, 2025

BENCH MARK
ACS MONUMENT "2_P9
NAVD 1983 CENTRAL ZONE
X=1494599.151 *
Y=1464876.438 *
Z=5056.962 * (NAVD 1988)
G-G=0.999686399
MAPPING ANGLE=0° 16'46.36"
U.S. SURVEY FEET



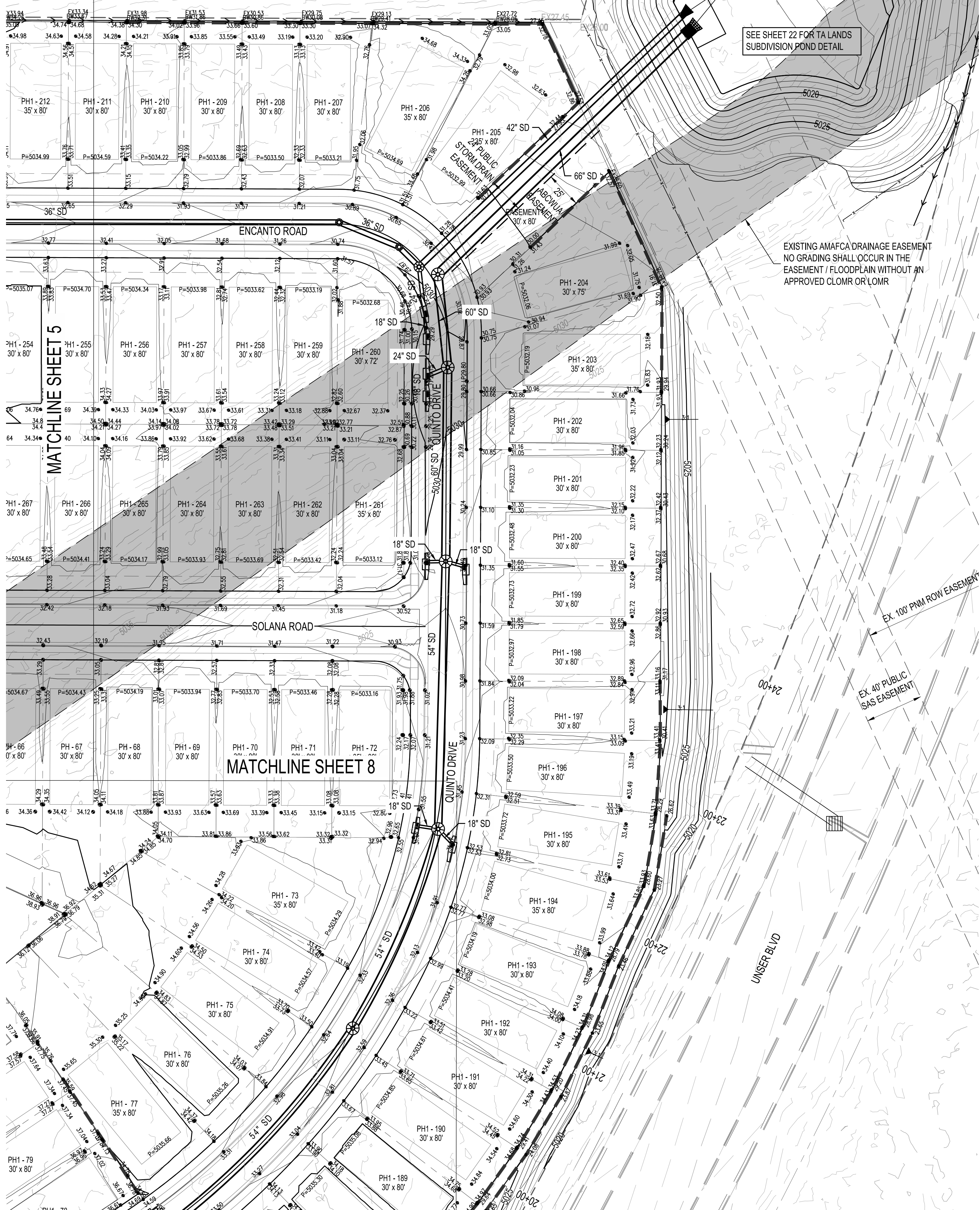

LEGEND

- PROPOSED SPOT ELEVATION • 5235.25
- EXISTING SPOT ELEVATION • EX 5235.25
- PROPOSED CONTOUR — 5025 —
- EXISTING STORM DRAIN LINE - - - - -
- PROPOSED STORM DRAIN INLET [Symbol]
- PROPOSED STORM DRAIN LINE [Symbol]
- PROPOSED STORM DRAIN MANHOLE [Symbol]
- PROPOSED WATER BLOCK [Symbol]
- PERIMETER WALL [Symbol]
- RETAINING WALL [Symbol]
- GARDEN WALL [Symbol]
- PAD [Symbol]
- STREET SLOPE [Symbol]
- DIRECTION OF FLOW [Symbol]
- SWALE [Symbol]
- WATER BLOCK [Symbol]
- PEDESTRIAN TRAIL [Symbol]
- SLOPE CHANGE IN REAR YARD [Symbol]

GRADING KEYNOTES

- INSTALL RIP RAP PAD PER DETAIL SHEET 3
- 12' WIDE MAINTENANCE ROAD PER PAVEMENT SECTION

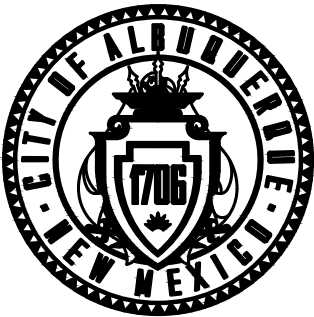
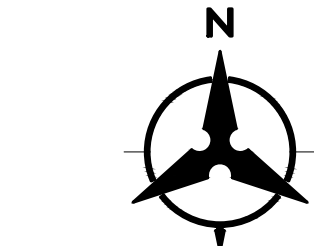
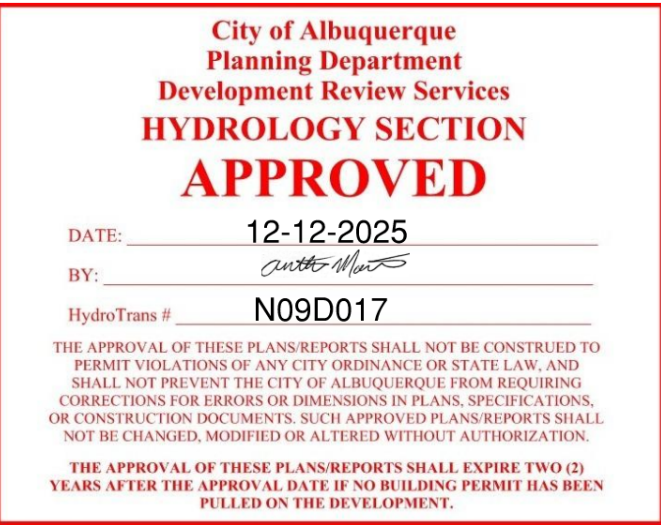

CITY OF ALBUQUERQUE  
DEPARTMENT OF MUNICIPAL DEVELOPMENT  
ENGINEERING DIVISION

TA LANDS PHASE 1  
GRADING PLAN

DESIGN REVIEW COMMITTEE	CITY ENGINEER APPROVAL	ZONE MAP NO. N-09-Z
		CITY PROJECT NO. 763684
		SHEET NO. 6 OF 43

CONSULTANTS

BENCH MARKS

ACS MONUMENT "2\_P9  
NAD 1983 CENTRAL ZONE  
X=1494599.151 \*  
Y=1464676.438 \*  
Z=5056.962 \* (NAVD 1988)  
G-G=0.99986399  
MAPPING ANGLE=0°16'46.36"  
\*U.S. SURVEY FEET



December 5, 2025

SEAL

NO.	DATE	DESCRIPTION	BY
		CONTRACTOR:	
		AS-BUILT INFORMATION	
		WORK STAKED BY:	
		INSPECTOR'S ACCEPTANCE BY:	
		FIELD VERIFICATION BY:	
		DRAWINGS CORRECTED BY:	

DESIGNED BY: KK  
DRAWN BY: DO, SMS, RV, RC  
CHECKED BY: KK  
DATE 12/12/2025



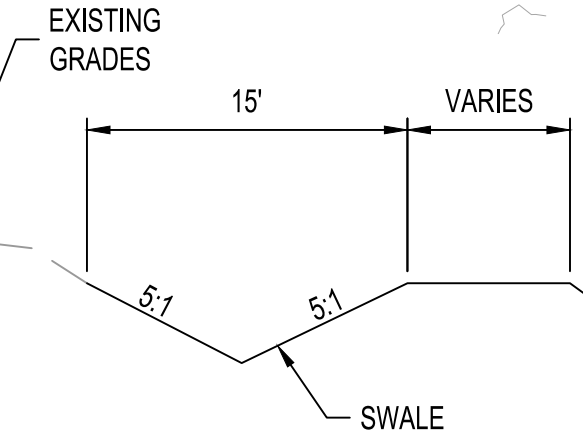
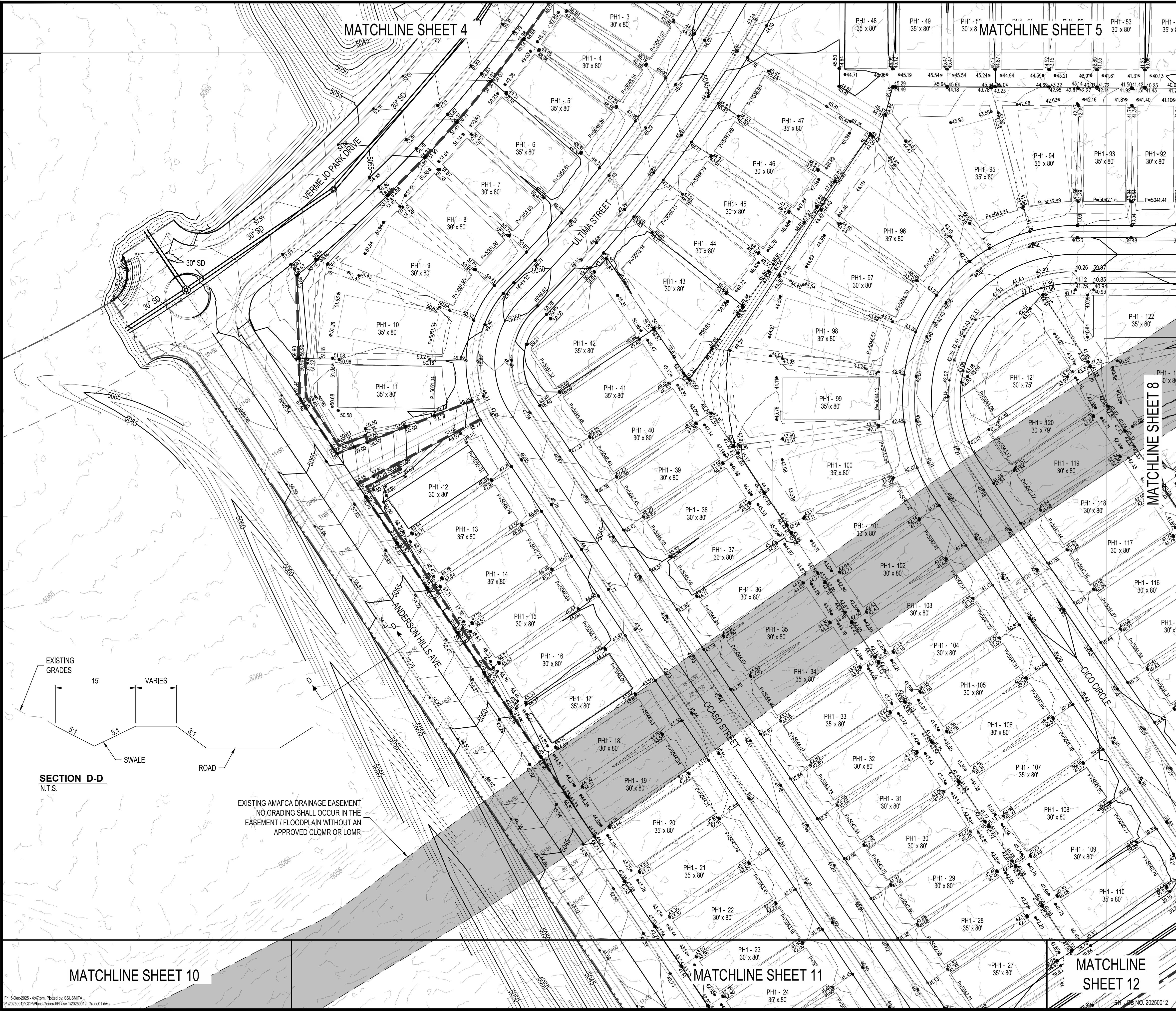

EXISTING AMAFCA DRAINAGE EASEMENT  
NO GRADING SHALL OCCUR IN THE  
EASEMENT / FLOODPLAIN WITHOUT AN  
APPROVED CLOMR OR LOMR

- LEGEND**
- PROPOSED SPOT ELEVATION • 5235.25
  - EXISTING SPOT ELEVATION ● EX 5235.25
  - PROPOSED CONTOUR -5025-
  - EXISTING STORM DRAIN LINE ---
  - PROPOSED STORM DRAIN INLET [Symbol]
  - PROPOSED STORM DRAIN LINE [Symbol]
  - PROPOSED STORM DRAIN MANHOLE [Symbol]
  - PROPOSED WATER BLOCK [Symbol]
  - PERIMETER WALL [Symbol]
  - RETAINING WALL [Symbol]
  - GARDEN WALL [Symbol]
  - PAD [Symbol]
  - STREET SLOPE [Symbol]
  - DIRECTION OF FLOW [Symbol]
  - SWALE [Symbol]
  - WATER BLOCK [Symbol]
  - PEDESTRIAN TRAIL [Symbol]
  - SLOPE CHANGE IN REAR YARD [Symbol]

- GRADING KEYNOTES**
- INSTALL RIP RAP PAD PER DETAIL SHEET 3
  - 12' WIDE MAINTENANCE ROAD PER PAVEMENT SECTION

City of Albuquerque  
Planning Department  
Development Review Services  
**HYDROLOGY SECTION**  
**APPROVED**

DATE: 12-12-2025  
BY: [Signature]  
HydroTrans # N09D017

THE APPROVAL OF THESE PLANS/REPORTS SHALL NOT BE CONSTRUED TO PERMIT VIOLATIONS OF ANY CITY ORDINANCE OR STATE LAW, AND SHALL NOT PREVENT THE CITY OF ALBUQUERQUE FROM REQUIRING CORRECTIONS FOR ERRORS OR DIMENSIONS IN PLANS, SPECIFICATIONS, OR CONSTRUCTION DOCUMENTS, SUCH APPROVED PLANS/REPORTS SHALL NOT BE CHANGED, MODIFIED OR ALTERED WITHOUT AUTHORIZATION.  
THE APPROVAL OF THESE PLANS/REPORTS SHALL EXPIRE TWO (2) YEARS AFTER THE APPROVAL DATE IF NO BUILDING PERMIT HAS BEEN PULLED ON THE DEVELOPMENT.

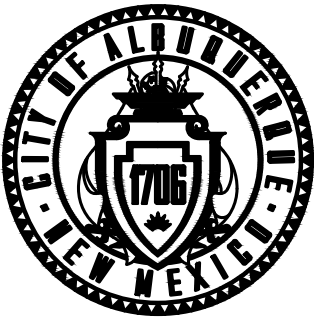
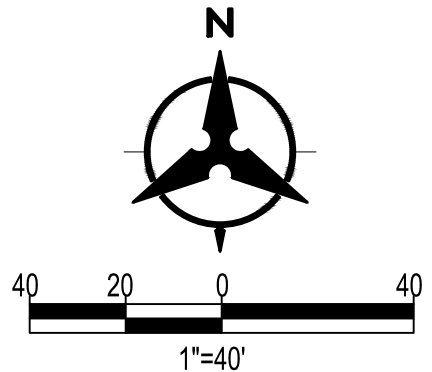

CITY OF ALBUQUERQUE  
DEPARTMENT OF MUNICIPAL DEVELOPMENT  
ENGINEERING DIVISION

**TA LANDS PHASE 1  
GRADING PLAN**

DESIGN REVIEW COMMITTEE	CITY ENGINEER APPROVAL	ZONE MAP NO. N-09-Z
		CITY PROJECT NO. 763684
		SHEET NO. 7 OF 43

CONSULTANTS

**Bohannon  
Huston**  
www.bhinc.com  
800.877.5332

BENCH MARKS

ACS MONUMENT "2" P9  
NAD 1983 CENTRAL ZONE  
X=1494599.151 \*  
Y=1464676.438 \*  
Z=5056.962 \* (NAVD 1988)  
G-G=0.99986399  
MAPPING ANGLE=0°16'46.36"  
\*U.S. SURVEY FEET



December 5, 2025

SEAL

NO.	DATE	DESCRIPTION	BY
		AS-BUILT INFORMATION	
		WORK STAKED BY:	
		INSPECTOR'S ACCEPTANCE BY:	
		FIELD VERIFICATION BY:	
		DRAWINGS CORRECTED BY:	

DESIGNED BY: KK
DRAWN BY: DO, SMS, RV, RC
CHECKED BY: KK
DATE: 12/12/2025





- LEGEND**
- PROPOSED SPOT ELEVATION • 5235.25
  - EXISTING SPOT ELEVATION ● EX 5235.25
  - PROPOSED CONTOUR -5025-
  - EXISTING STORM DRAIN LINE ---
  - PROPOSED STORM DRAIN INLET [Symbol]
  - PROPOSED STORM DRAIN LINE [Symbol]
  - PROPOSED STORM DRAIN MANHOLE [Symbol]
  - PROPOSED WATER BLOCK [Symbol]
  - PERIMETER WALL [Symbol]
  - RETAINING WALL [Symbol]
  - GARDEN WALL [Symbol]
  - PAD [Symbol]
  - STREET SLOPE XY
  - DIRECTION OF FLOW [Symbol]
  - SWALE [Symbol]
  - WATER BLOCK [Symbol]
  - PEDESTRIAN TRAIL [Symbol]
  - SLOPE CHANGE IN REAR YARD [Symbol]

- GRADING KEYNOTES**
- INSTALL RIP RAP PAD PER DETAIL SHEET 3
  - 12' WIDE MAINTENANCE ROAD PER PAVEMENT SECTION

City of Albuquerque  
Planning Department  
Development Review Services  
**HYDROLOGY SECTION**  
**APPROVED**

DATE: 12-12-2025  
BY: [Signature]  
HydroTrans # N09D017

THE APPROVAL OF THESE PLANS/REPORTS SHALL NOT BE CONSTRUED TO PERMIT VIOLATIONS OF ANY CITY ORDINANCE OR STATE LAW, AND SHALL NOT PREVENT THE CITY OF ALBUQUERQUE FROM REQUESTING CORRECTIONS FOR ERRORS OR DIMENSIONS IN PLANS, SPECIFICATIONS, OR CONSTRUCTION DOCUMENTS. SUCH APPROVED PLANS/REPORTS SHALL NOT BE CHANGED, MODIFIED OR ALTERED WITHOUT AUTHORIZATION. THE APPROVAL OF THESE PLANS/REPORTS SHALL EXPIRE TWO (2) YEARS AFTER THE APPROVAL DATE IF NO BUILDING PERMIT HAS BEEN FILED ON THE DEVELOPMENT.

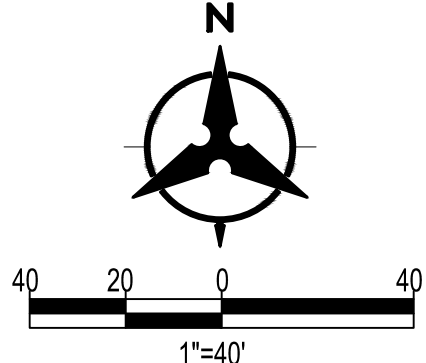

CITY OF ALBUQUERQUE  
DEPARTMENT OF MUNICIPAL DEVELOPMENT  
ENGINEERING DIVISION

**TA LANDS PHASE 1  
GRADING PLAN**

DESIGN REVIEW COMMITTEE	CITY ENGINEER APPROVAL	ZONE MAP NO. N-09-Z
		CITY PROJECT NO. 763684
		SHEET NO. 8 OF 43

CONSULTANTS

BENCH MARKS

ACS MONUMENT "2, P9  
NAD 1983 CENTRAL ZONE  
X=1494599.151 \*  
Y=1464676.438 \*  
Z=5056.962 \* (NAVD 1988)  
G-G=0.99986399  
MAPPING ANGLE=0°16'46.36"  
\*U.S. SURVEY FEET



December 5, 2025

NO.	DATE	DESCRIPTION	BY
		CONTRACTOR:	
		AS-BUILT INFORMATION	
		WORK STAKED BY:	
		INSPECTOR'S ACCEPTANCE BY:	
		FIELD VERIFICATION BY:	
		DRAWINGS CORRECTED BY:	

DESIGNED BY: KK  
DRAWN BY: DO, SMS, RV, RC  
CHECKED BY: KK  
DATE: 12/12/2025



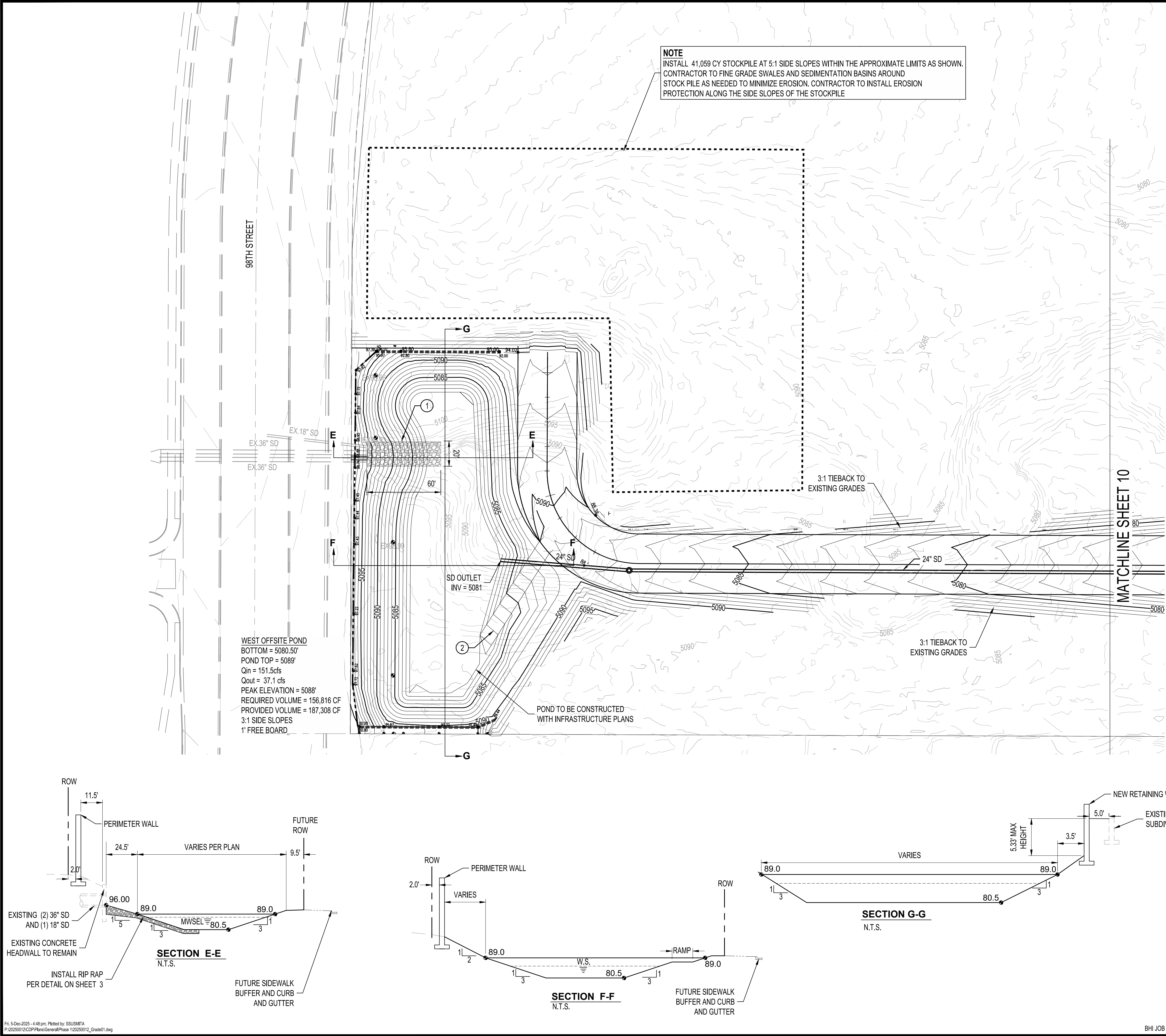

LEGEND

- PROPOSED SPOT ELEVATION • 5235.25  
EXISTING SPOT ELEVATION • EX 5235.25  
PROPOSED CONTOUR — 5025 —  
EXISTING STORM DRAIN LINE - - - - -  
PROPOSED STORM DRAIN INLET [Symbol]  
PROPOSED STORM DRAIN LINE [Symbol]  
PROPOSED STORM DRAIN MANHOLE [Symbol]  
PROPOSED WATER BLOCK [Symbol]  
PERIMETER WALL [Symbol]  
RETAINING WALL [Symbol]  
GARDEN WALL [Symbol]  
PAD [Symbol]  
STREET SLOPE [Symbol]  
DIRECTION OF FLOW [Symbol]  
SWALE [Symbol]  
WATER BLOCK [Symbol]  
PEDESTRIAN TRAIL [Symbol]  
SLOPE CHANGE IN REAR YARD [Symbol]

GRADING KEYNOTES

1. INSTALL RIP RAP PAD PER DETAIL SHEET 3  
2. 12' WIDE MAINTENANCE ROAD PER PAVEMENT SECTION

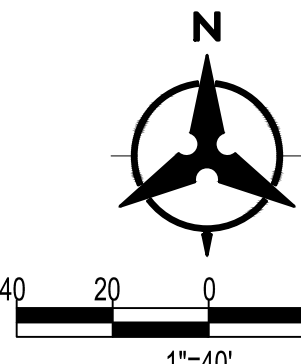
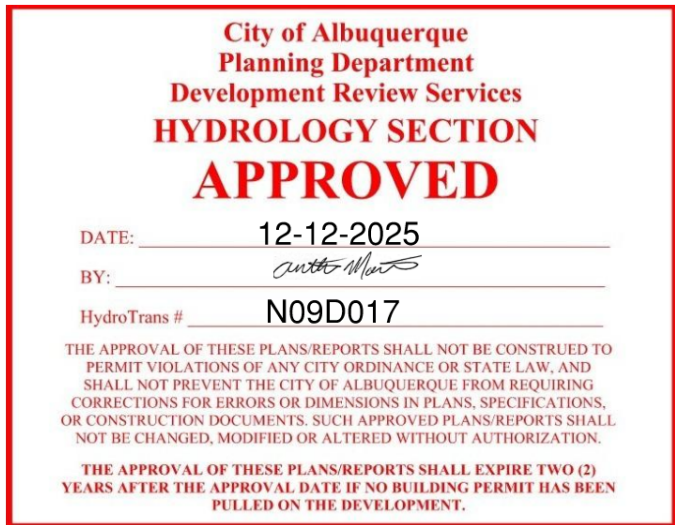

CALL NM ONE-CALL SYSTEM  
SEVEN (7) DAYS PRIOR TO  
ANY EXCAVATION

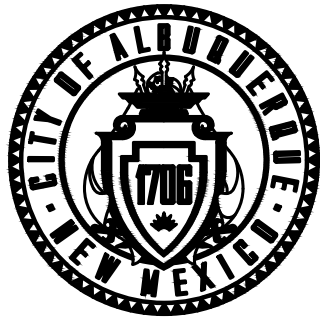

CITY OF ALBUQUERQUE  
DEPARTMENT OF MUNICIPAL DEVELOPMENT  
ENGINEERING DIVISION

TA LANDS PHASE 1  
GRADING PLAN

DESIGN REVIEW COMMITTEE	CITY ENGINEER APPROVAL	ZONE MAP NO. N-09-Z
		CITY PROJECT NO. 763684
		SHEET NO. 9 OF 43

CONSULTANTS

BENCH MARKS

ACS MONUMENT "2\_P9  
NAD 1983 CENTRAL ZONE  
X=1494599.151 \*  
Y=1464676.438 \*  
Z=5056.962 \* (NAVD 1988)  
G-G=0.99986399  
MAPPING ANGLE=0°16'46.36"  
\*U.S. SURVEY FEET



December 5, 2025

NO.	DATE	DESCRIPTION	BY
		CONTRACTOR:	
		AS-BUILT INFORMATION	
		WORK STAKED BY:	
		INSPECTOR'S ACCEPTANCE BY:	
		FIELD VERIFICATION BY:	
		DRAWINGS CORRECTED BY:	

DESIGNED BY: KK  
DRAWN BY: DO, SMS, RV, RC  
CHECKED BY: KK  
DATE: 12/12/2025



MATCHLINE SHEET 9

MATCHLINE SHEET 11











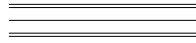

MATCHLINE SHEET 7

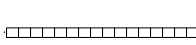
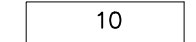
EXISTING AMAFCA DRAINAGE EASEMENT  
NO GRADING SHALL OCCUR IN THE  
EASEMENT / FLOODPLAIN WITHOUT AN  
APPROVED CLOMR OR LOMR

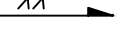
3:1 TIEBACK TO  
EXISTING GRADES

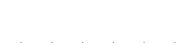
3:1 TIEBACK TO  
EXISTING GRADES

LEGEND

- PROPOSED SPOT ELEVATION • 5235.25  
EXISTING SPOT ELEVATION • EX 5235.25  
PROPOSED CONTOUR — 5025 —  
EXISTING STORM DRAIN LINE — — — —  
PROPOSED STORM DRAIN INLET   
PROPOSED STORM DRAIN LINE   
PROPOSED STORM DRAIN MANHOLE   
PROPOSED WATER BLOCK   
PERIMETER WALL   
RETAINING WALL   
GARDEN WALL   
PAD   
STREET SLOPE   
DIRECTION OF FLOW   
SWALE   
WATER BLOCK   
PEDESTRIAN TRAIL   
SLOPE CHANGE IN REAR YARD 

GRADING KEYNOTES

- INSTALL RIP RAP PAD PER DETAIL SHEET 3
- 12' WIDE MAINTENANCE ROAD PER PAVEMENT SECTION

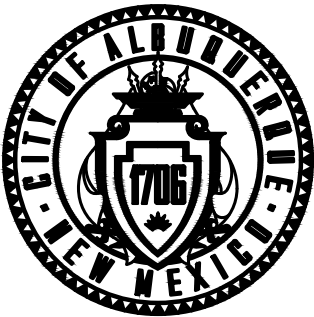
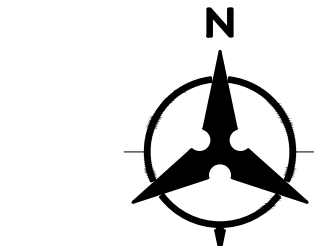
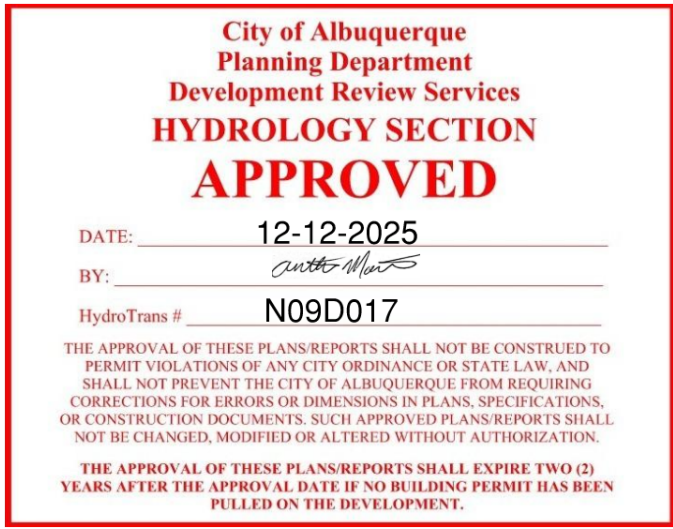

CITY OF ALBUQUERQUE  
DEPARTMENT OF MUNICIPAL DEVELOPMENT  
ENGINEERING DIVISION

TA LANDS PHASE 1  
GRADING PLAN

DESIGN REVIEW COMMITTEE	CITY ENGINEER APPROVAL	ZONE MAP NO. N-09-Z
		CITY PROJECT NO. 763684
		SHEET NO. 10 OF 43

CONSULTANTS

BENCH MARKS

ACS MONUMENT "2\_P9  
NAD 1983 CENTRAL ZONE  
X=1494599.151 \*  
Y=1464676.438 \*  
Z=5056.962 \* (NAVD 1988)  
G-G=0.99986399  
MAPPING ANGLE=0°16'46.36"  
\*U.S. SURVEY FEET



December 5, 2025

SEAL

NO.	DATE	DESCRIPTION	BY
		CONTRACTOR:	
		AS-BUILT INFORMATION	
		WORK STAKED BY:	
		INSPECTOR'S ACCEPTANCE BY:	
		FIELD VERIFICATION BY:	
		DRAWINGS CORRECTED BY:	

DESIGNED BY: KK  
DRAWN BY: DO, SMS, RV, RC  
CHECKED BY: KK  
DATE 12/12/2025



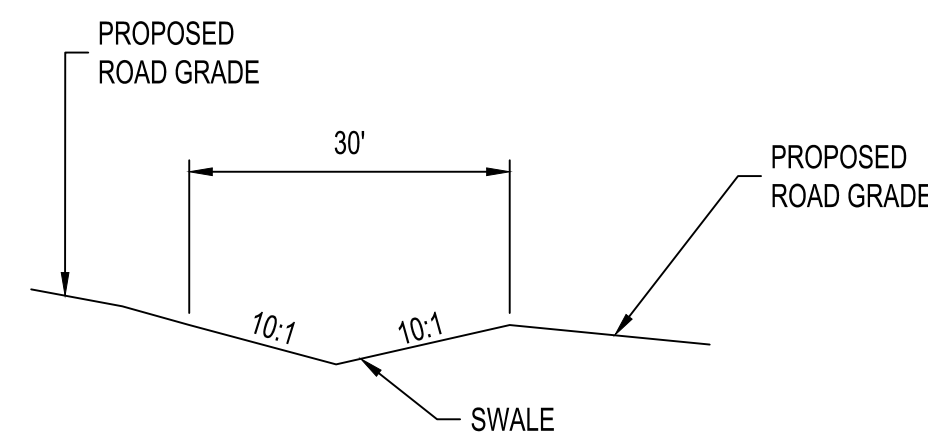
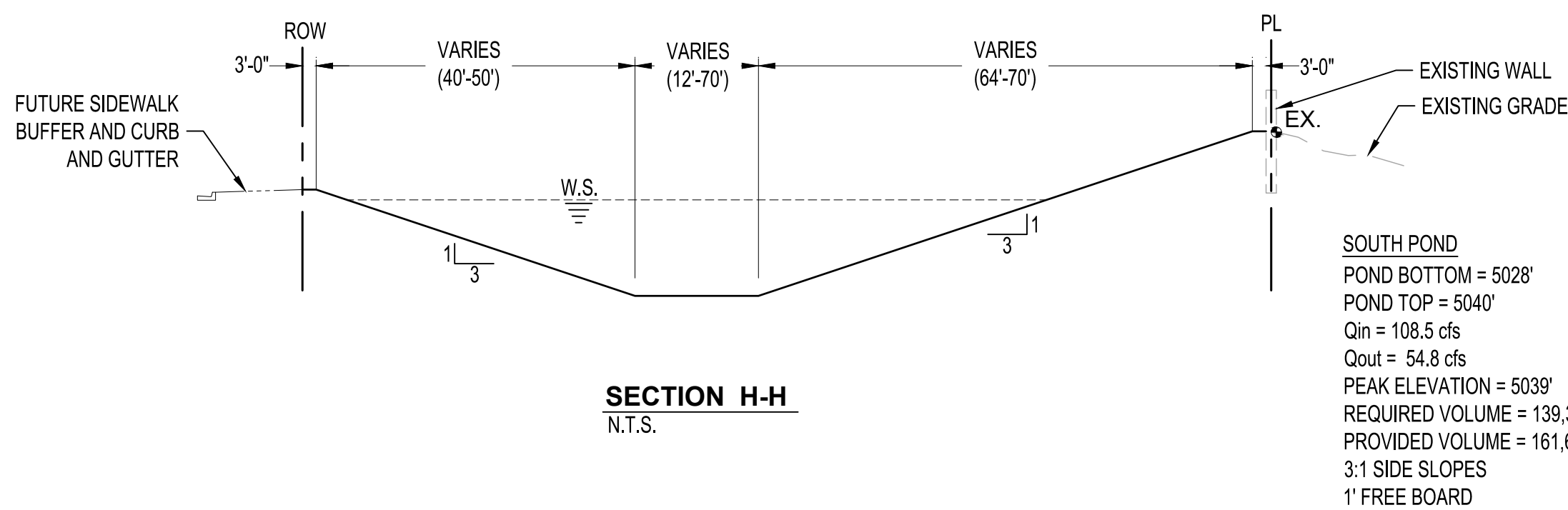

**SECTION J- J**  
N.T.S.

PROPOSED SPOT ELEVATION

EXISTING SPOT ELEVATION

PROPOSED CONTOUR

EXISTING STORM DRAIN LINE

PROPOSED STORM DRAIN INLET

PROPOSED STORM DRAIN LINE

PROPOSED STORM DRAIN MANHOLE

PROPOSED WATER BLOCK

PERIMETER WALL

RETAINING WALL

GARDEN WALL

PAD

STREET SLOPE

DIRECTION OF FLOW

SWALE

WATER BLOCK

PEDESTRIAN TRAIL

SLOPE CHANGE IN REAR YARD

1. INSTALL RIP RAP PAD PER DETAIL SHEET 3
2. 12' WIDE MAINTENANCE ROAD PER PAVEMENT SECTION

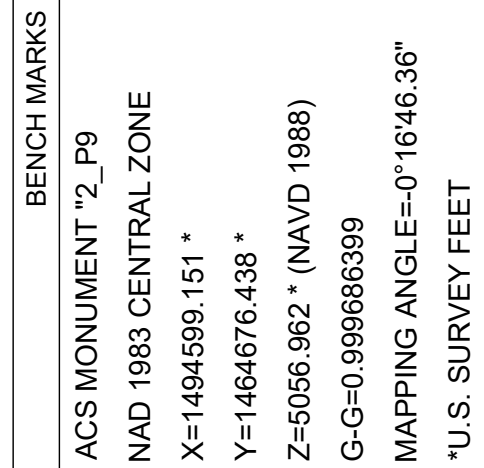

December 5, 2025

DESIGNED BY:	KK
DRAWN BY:	DO, SMS, RV, RC
CHECKED BY:	KK
DATE	12/12/2025

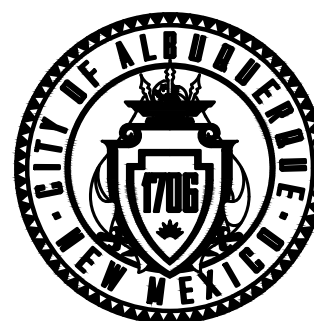

CITY OF ALBUQUERQUE  
DEPARTMENT OF MUNICIPAL DEVELOPMENT  
ENGINEERING DIVISION

**TA LANDS PHASE 1  
GRADING PLAN**

DESIGN REVIEW COMMITTEE	CITY ENGINEER APPROVAL	ZONE MAP NO. N-09-Z
		CITY PROJECT NO. 763684
		SHEET NO. 11 OF 43



MATCHLINE SHEET 7

MATCHLINE SHEET 8



LEGEND

- PROPOSED SPOT ELEVATION • 5235.25  
EXISTING SPOT ELEVATION • EX 5235.25  
PROPOSED CONTOUR — 5025 —  
EXISTING STORM DRAIN LINE ---  
PROPOSED STORM DRAIN INLET [Symbol]  
PROPOSED STORM DRAIN LINE [Symbol]  
PROPOSED STORM DRAIN MANHOLE [Symbol]  
PROPOSED WATER BLOCK [Symbol]  
PERIMETER WALL [Symbol]  
RETAINING WALL [Symbol]  
GARDEN WALL [Symbol]  
PAD [Symbol]  
STREET SLOPE [Symbol]  
DIRECTION OF FLOW [Symbol]  
SWALE [Symbol]  
WATER BLOCK [Symbol]  
PEDESTRIAN TRAIL [Symbol]  
SLOPE CHANGE IN REAR YARD [Symbol]

GRADING KEYNOTES

- INSTALL RIP RAP PAD PER DETAIL SHEET 3
- 12' WIDE MAINTENANCE ROAD PER PAVEMENT SECTION

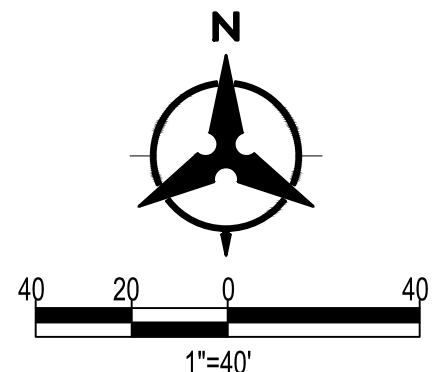
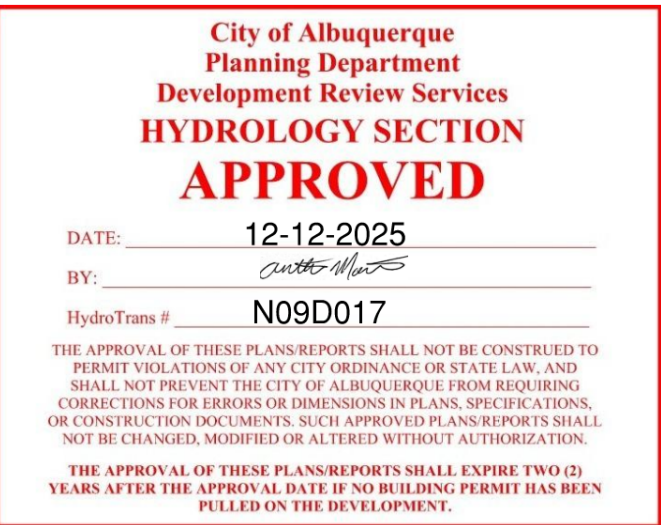

CALL NM ONE-CALL SYSTEM  
SEVEN (7) DAYS PRIOR TO  
ANY EXCAVATION

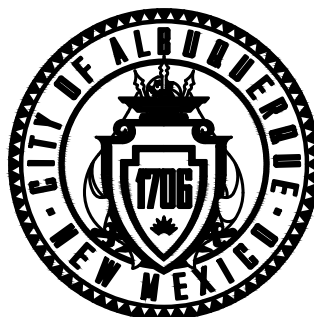

CITY OF ALBUQUERQUE  
DEPARTMENT OF MUNICIPAL DEVELOPMENT  
ENGINEERING DIVISION

TA LANDS PHASE 1  
GRADING PLAN

DESIGN REVIEW COMMITTEE	CITY ENGINEER APPROVAL	ZONE MAP NO. N-09-Z
		CITY PROJECT NO. 763684
		SHEET NO. 12 OF 43

CONSULTANTS

BENCH MARKS

ACS MONUMENT '2, P9  
NAD 1983 CENTRAL ZONE  
X=1494599.151 \*  
Y=1464676.438 \*  
Z=5056.962 \* (NAVD 1988)  
G-G=0.99986399  
MAPPING ANGLE=0°16'46.36"  
\*U.S. SURVEY FEET



December 5, 2025

SEAL

NO.	DATE	DESCRIPTION	BY
		AS-BUILT INFORMATION	
		WORK STAKED BY:	
		INSPECTOR'S ACCEPTANCE BY:	
		FIELD VERIFICATION BY:	
		DRAWINGS CORRECTED BY:	

DESIGNED BY: KK
DRAWN BY: DO, SMS, RV, RC
CHECKED BY: KK
DATE 12/12/2025