

**SITE WILL HAVE A SILT FENCE PERIMETER WITH INLET PORTECTION FOR ACTIVE INLETS. SITE DRAINS TO AN OFFSITE POND.**

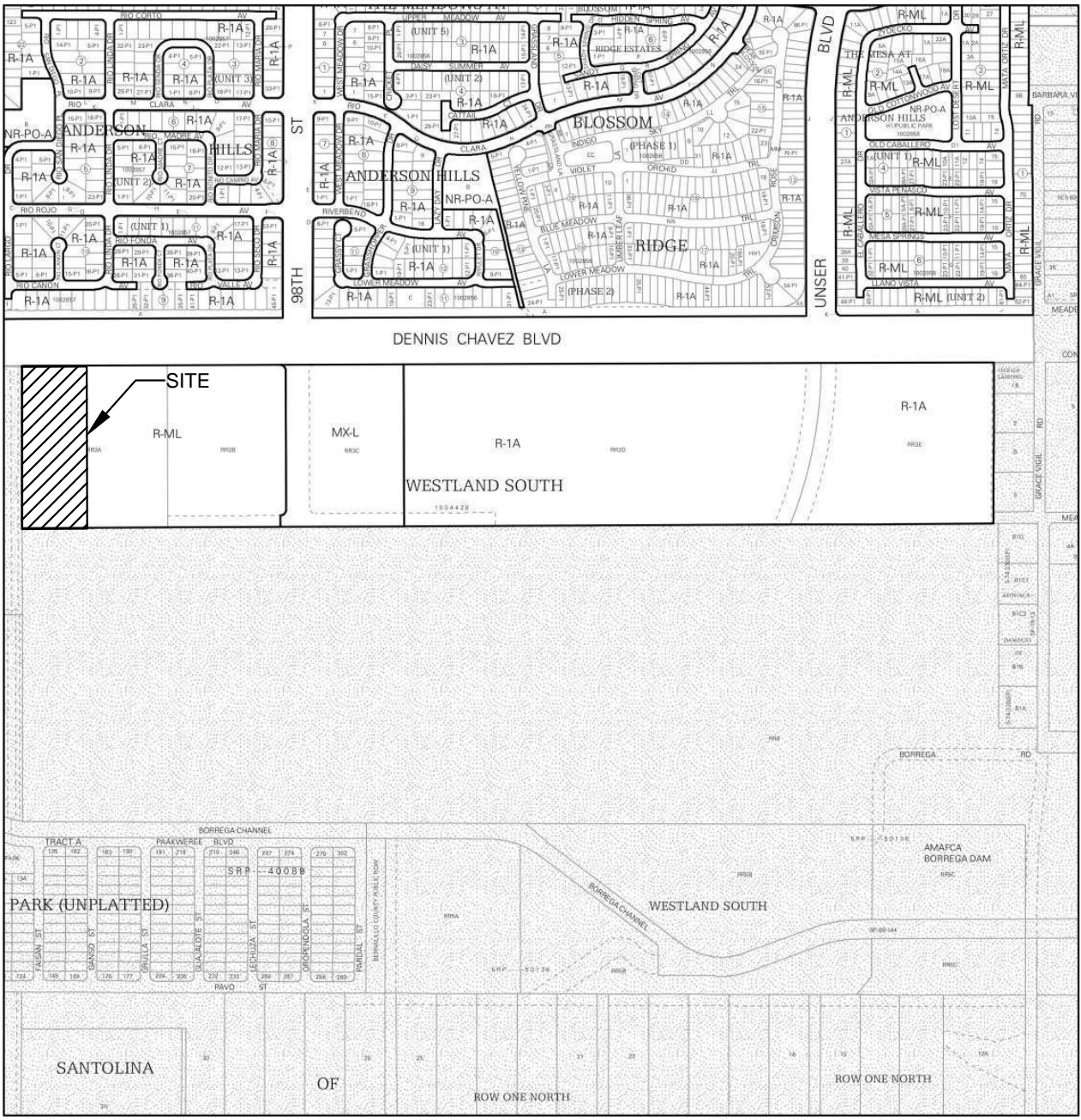

LEGEND	
TEMPORARY EROSION AND SEDIMENT CONTROL PLAN	
	PROJECT PERIMETER & DISTURBED AREA
	SILT FENCE
	MULCH SOCKS
	FLOW DIRECTION
	STAGING AREA
	STABILIZED CONSTRUCTION ENTRANCE
	TRASH RECEPTACLE
	CHEMICAL TOILET
	CONCRETE WASHOUT
	RETENTION POND
	RIP RAP
	CHECK DAM
	DROP INLET PROTECTION
	OUTFALL
	POSTING SIGN
	PRESERVED VEGETATION

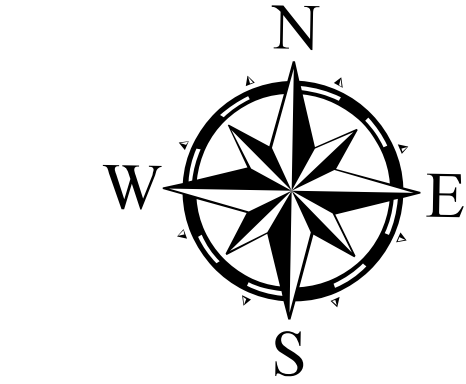

06/15/2020  
CPESC Stamp

RECEIVING WATERS: OFF SITE POND	
CRITICAL HABITAT: CRITERION "A"; THERE ARE NO CRITICAL HABITATS WITHIN THE PROJECT AREA.	
GPS LOCATION: 35.0231, -106.7446	
CEJA VISTA SENIOR APARTMENTS	
PROJECT TITLE	
ALBUQUERQUE, BERNALILLO COUNTY, NM	
CITY, COUNTY, STATE	
06/15/2020	DATE
C. DURKIN	DRAWN BY

INLET PROTECTION

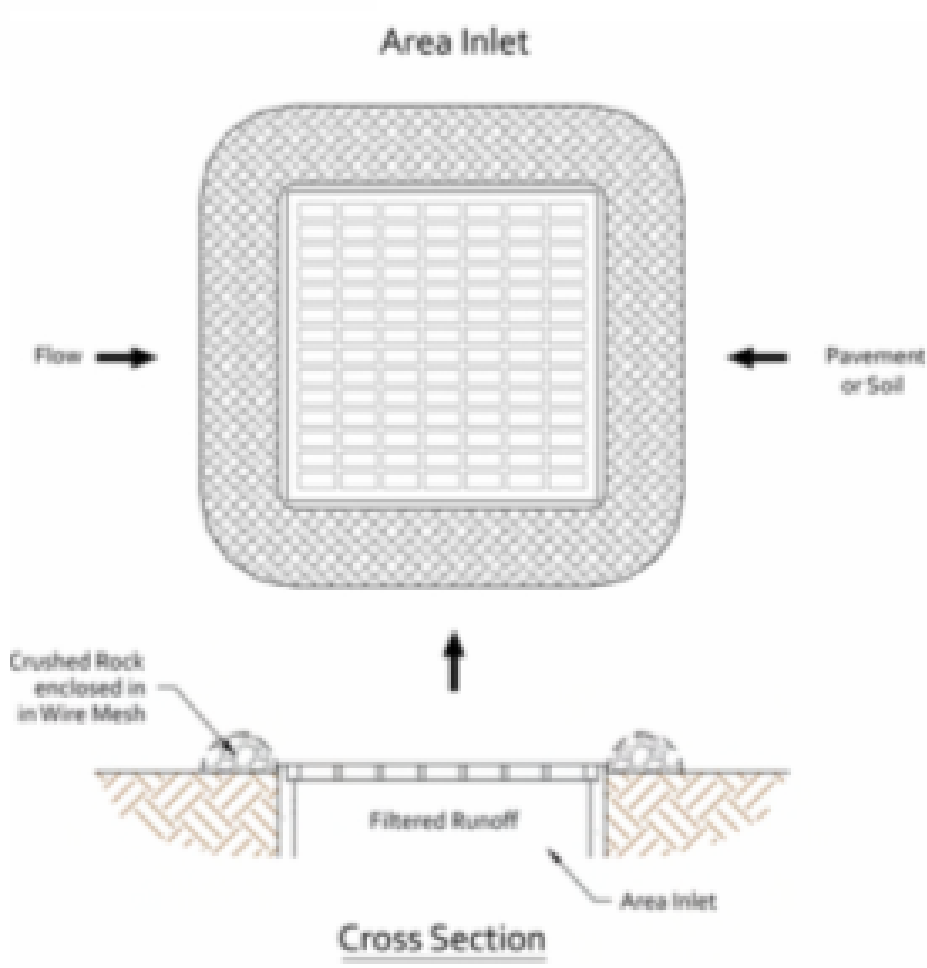

BMP Objectives

- Sediment Control
- Sheet Flow Runoff Control

SILT FENCE



BMP Objectives

- Sediment Control
- Sheet Flow Runoff Control
- Wind Erosion Control

SEDIMENT TRACK OUT CONTROL



BMP Objectives

- Sediment Control

MULCH SOCK/STRAW WATTLE



BMP Objectives

- Sediment Control
- Reduce Runoff Velocity
- Inlet Protection

BERMS AND SWALES



BMP Objectives

- Runoff Control
- Run-on Diversion

EROSION CONTROL NOTES  
ESC Plan Standard Notes (2020-06-03)

1.All Erosion and Sediment Control (ESC) work on these plans, except as otherwise stated or provided hereon shall be permitted, constructed, inspected, and maintained in accordance with:

a.The City Ordinance § 14-5-2-11, the ESC Ordinance,

b.The EPA's 2017 Construction General Permit (CGP), and

c.The City Of Albuquerque Construction BMP Manual.

2.All BMP's must be installed prior to beginning any earth moving activities except as specified hereon in the Phasing Plan. Construction of earthen BMP's such as sediment traps, sediment basins, and diversion berms shall be completed and inspected prior to any other construction or earthwork. Self-inspection is required after installation of the BMPs and prior to beginning construction.

3.Self-inspections - At a minimum a routine compliance self-inspection is required to review the project for compliance with the Construction General Permit once every 14 days and after any precipitation event of 1/4 inch or greater until the site construction has been completed and the site determined as stabilized by the city. Reports of these inspections shall be kept by the person or entity authorized to direct the construction activities on the site.

4.BMPs shall be inspected and maintained until all disturbed areas are stabilized in accordance with the Final Stabilization Criteria (CGP 2.2.14.b). Generally, all disturbed areas, other than structures, must have uniform perennial vegetation that provides 70 percent or more of the cover provided by native vegetation or seed the disturbed area and provide non-vegetative mulch that provides cover for at least three years without active maintenance. Final stabilization must be documented on prior to removal of BMPs and discontinuation of inspections.

RECEIVING WATERS: OFF SITE POND

CRITICAL HABITAT: CRITERION "A"; THERE ARE NO CRITICAL HABITATS WITHIN THE PROJECT AREA.

GPS LOCATION: 35.0231, -106.7446

CEJA VISTA SENIOR APARTMENTS

PROJECT TITLE

ALBUQUERQUE, BERNALILLO COUNTY, NM

CITY, COUNTY, STATE

06/15/2020

DATE

C. DURKIN

DRAWN BY

INSPECTIONS PLUS



06/15/2020

CPESC Stamp