

# CONSTRUCTION DOCUMENTS

# FLITE BANKING CENTERS, LLC

ADDITION OF ATM DRIVE-UP IN EXISTING #5430 WALMART PARKING LOT  
3500 COORS BLVD SW  
ALBUQUERQUE, NM 87121



VICINITY MAP  
NOT TO SCALE



LOCATION MAP  
NOT TO SCALE  
©2021 NEARMAP

SHEET INDEX	
SHEET NUMBER	SHEET TITLE
C0-00	COVER
C0-01	GENERAL NOTES
C1-00	SITE LOCATION
C1-20	EXISTING CONDITIONS & DEMOLITION PLAN
C2-00	SITE LAYOUT PLAN
C2-20	ATM & BOLLARD PLAN

#### PROJECT NOTES

- THIS LOCATION USES 11 PARKING SPACES
- ENTIRE ASPHALT WILL BE REMOVED AND REPLACED WITH CONCRETE
- ALL CURBS, INCLUDING ISLAND CURBS, WILL BE PAINTED WHITE
- DIRECTIONAL ARROWS AND "ENTER" & "EXIT" MESSAGING WILL BE PAINTED WHITE.
- ALL LIGHT POLE COLUMNS WILL BE FINISHED SMOOTH.
- BOLLARD WILL BE PAINTED, HAVE SHALLOW DOME CAP, AND SIT 56" ABOVE CONCRETE SURFACE.
- BOLLARDS WILL BE FILLED WITH CONCRETE, EXCEPT BOLLARDS A & B NOTED IN BOLLARD DETAIL.
- ATM SLAB WILL A MINIMUM 12" THICK TO ALLOW DRILLED ANCHOR POINTS.
- LIGHT ACTIVATION FOR LIGHT STANDARDS AND CANOPY WILL BE PERFORMED BY SINGLE PHOTOCELL PLACED ON METER & PANEL STRUCTURE
- EACH LIGHT POLE WILL RECEIVE ONE 1" DEDICATED DRY CONDUIT TERMINATING AT THE ATM PIT FOR FUTURE CATEGORY 6 CABLE.
- CANOPY EGRESS LEG WILL RECEIVE ONE 2" DEDICATED DRY CONDUIT TERMINATING AT THE ATM PIT FOR FUTURE MULTIPLE CATEGORY 6 CABLE.
- ATM PIT WILL RECEIVE ONE 2" DEDICATED DRY CONDUIT TERMINATE AT METER & PANEL FOR COMMUNICATION CABLING
- ATM PIT RECEIVES 2 CIRCUITS (30 AMP FOR ATM & 20 AMP FOR ANCILLARY DEVICES).
- ALL METAL BOLTS SHALL BE GALVANIZED METAL

#### OWNER / DEVELOPER



FLITE BANKING CENTERS, LLC.  
8955 KATY FREEWAY, STE. 107  
HOUSTON, TX, 77024  
PHONE: (281)-816-5391  
CONTACT: DEANGELO RIOS

#### PLANS PREPARED BY

**Kimley»Horn**

6200 SOUTH SYRACUSE WAY, SUITE 300  
GREENWOOD VILLAGE, CO 80111  
Main: 303.228.2300 | www.kimley-horn.com  
©2024 Kimley-Horn and Associates, Inc.

CITY OF ALBUQUERQUE  
BERNALILLO COUNTY, NM

#### PROJECT DESIGN TEAM

**CLIENT**  
FLITE BANKING CENTERS, LLC  
8955 KATY FWY, STE 107  
HOUSTON, TX 77024  
PHONE: (800) 370-3734  
CONTACT: DEANGELO RIOS

**CIVIL ENGINEER**  
KIMLEY-HORN AND ASSOCIATES, INC.  
6200 SOUTH SYRACUSE WAY, SUITE 300  
GREENWOOD VILLAGE, CO 80111  
PHONE: (303) 228-2300  
CONTACT: DANIELLE PRESCOTT, P.E.

#### PERMITTING / UTILITY CONTACTS

**ZONING/PLANNING**  
CITY OF ALBUQUERQUE  
600 2ND ST NW  
ALBUQUERQUE, NM 87102  
PHONE: (505) 924-3860

**FIRE CHIEF**  
FIRE RESCUE  
11500 SUNSET GARDENS SW  
ALBUQUERQUE, NM 87121  
PHONE: (505) 768-9300  
CONTACT: EMILY JARAMILLO

**BUILDING DEPT.**  
CITY OF ALBUQUERQUE  
600 2ND ST NW  
ALBUQUERQUE, NM 87102  
PHONE: (505) 924-3964

**TRANSPORTATION DEPT.**  
ALBUQUERQUE TRANSIT DEPARTMENT  
100 1ST ST SW  
ALBUQUERQUE, NM 87102  
PHONE: (505) 724-3100  
CONTACT: LESLIE KEENER

#### GENERAL DEVELOPMENT NOTES

- PART OF THE SUBJECT PROPERTY IS LOCATED IN AREAS DESIGNATED AS "ZONE X" (AREAS DETERMINED TO BE OUTSIDE THE 0.2 % ANNUAL CHANCE FLOODPLAIN) AS NOTED ON THE CURRENT FEMA FIRM COMMUNITY PANEL 35001C0339H.
- ANY EXCAVATION, FILL, OR DISTURBANCE OF THE EXISTING GROUND ELEVATION MUST BE DONE IN ACCORDANCE WITH STORM WATER MANAGEMENT ORDINANCE NO. 78/840 AND APPROVED BY THE ALBUQUERQUE PUBLIC WORKS DEPARTMENT.
- ALBUQUERQUE UTILITY DISTRICT SHALL BE PROVIDED SUFFICIENT AND UNENCUMBERED ACCESS IN ORDER TO MAINTAIN AND REPAIR UTILITIES IN THIS SITE.

#### SCOPE OF WORK

ADDITION OF A SINGLE DRIVE-UP ATM LANE IN AN EXISTING PARKING LOT.

#### EXISTING PROPERTY SUMMARY

PROPERTY ADDRESS: 3500 COORS BLVD SW  
ALBUQUERQUE, NM 87121  
TR 1-A-1 BULK LAND PLAT  
1A1  
LAMONICA & WENK  
ZONE ATLAS ID: P10  
U.S. FEMA FIRM PANEL: 35001C0339H DATED 08/16/2012  
EXISTING ZONING: MX-L  
EXISTING LAND USE: COMMERCIAL RETAIL



Know what's below.  
Call before you dig.



This document, together with the concepts and designs presented herein, is intended only for the specific purpose and client for which it was prepared. Reuse of and improper reliance on this document without written authorization and adaptation by Kimley-Horn and Associates, Inc. shall be without liability to Kimley-Horn and Associates, Inc.

CONTRACTOR RESPONSIBILITIES:

1. PRIOR TO CONSTRUCTION THE CONTRACTOR SHALL BE RESPONSIBLE FOR:
- A. THE CONTRACTOR SHALL VERIFY ALL PROPOSED AND EXISTING CONDITIONS INCLUDING UTILITIES (INVERTS, CONNECTIONS, MATERIALS, ETC.) AND DIMENSIONS WITHIN THE LIMITS OF WORK PRIOR TO THE START OF CONSTRUCTION.

B. REFER TO ARCHITECTURAL DRAWINGS FOR DETAILED BUILDING INFORMATION.

C. THE CONTRACTOR IS RESPONSIBLE FOR ALL NOTIFICATIONS AND LIAISONS WITH UTILITY COMPANIES DURING THE PROCESS OF LOCATING, RELOCATING, AND TYING INTO PUBLIC UTILITIES.

D. PRIOR TO COMMENCING LAND DISTURBANCE ACTIVITY, THE LIMITS OF LAND DISTURBANCE SHALL BE CLEARLY AND ACCURATELY DEMARCATED WITH STAKES, RIBBONS, OR OTHER APPROPRIATE MEANS. THE LOCATION AND EXTENT OF ALL AUTHORIZED AND DISTURBANCE SHALL OCCUR INSIDE THE APPROVED LIMITS INDICATED ON THE APPROVED PLANS.
2. DURING CONSTRUCTION:
- A. THE CONTRACTOR SHALL BE RESPONSIBLE FOR DEVIATIONS FROM THESE PLANS AND SPECIFICATIONS WITHOUT PRIOR WRITTEN CONSENT OF THE ENGINEER MAY CAUSE THE WORK TO BE UNACCEPTABLE.

B. THE CONTRACTOR SHALL USE MATERIALS AND EMPLOY CONSTRUCTION METHODS IN ORDER TO COMPLY WITH THE DRAWINGS AND SPECIFICATIONS. WHERE A CONFLICT OCCURS, THE STRICTEST DESIGN SHALL GOVERN. THE ENGINEER'S REVIEW OF SHOP DRAWINGS, PRODUCT DATA, ETC., DOES NOT RELIEVE THE CONTRACTOR FROM COMPLYING WITH THE CONTRACT DOCUMENTS. THE CONTRACTOR SHALL INFORM THE ENGINEER IN WRITING OF ANY SPECIFIC DEVIATIONS AND OBTAIN ENGINEER'S WRITTEN APPROVAL OF THE SPECIFIC DEVIATION.

C. IT IS SOLELY THE CONTRACTOR'S RESPONSIBILITY TO FOLLOW ALL APPLICABLE SAFETY CODES AND REGULATIONS DURING ALL PHASES OF CONSTRUCTION.

D. ALL CONSTRUCTION MUST CONFORM TO THE STANDARDS, SPECIFICATIONS, AND CODES OF THE GOVERNING MUNICIPALITIES.

E. CONSTRUCTION SHALL MEET ALL CURRENT STANDARDS SET FORTH IN THE AMERICANS WITH DISABILITIES ACT.

F. IF THE CONTRACTOR DAMAGES ANY EXISTING UTILITIES DURING CONSTRUCTION, HE SHALL, AT HIS OWN EXPENSE, REPLACE OR REPAIR THE UTILITIES TO ORIGINAL CONDITION AND QUALITY AS APPROVED BY THE OWNER AND REPRESENTATIVE OF THE APPROPRIATE UTILITY COMPANY.

G. SUFFICIENT BARRICADES, LIGHTS, SIGNS, AND OTHER TRAFFIC CONTROL METHODS IN ACCORDANCE WITH GOVERNING ORDINANCES MAY BE NECESSARY FOR THE PROTECTION AND SAFETY OF THE PUBLIC. SAID CONTROL DEVICES SHALL BE PER THE MANUAL OF TRAFFIC CONTROL DEVICES, M.U.T.C.D., CURRENT EDITION, AND SHALL BE PROVIDED AND MAINTAINED THROUGHOUT CONSTRUCTION.

H. TRAFFIC CONTROLS AND OTHER WARNING DEVICES SHALL BE INSTALLED PRIOR TO THE COMMENCEMENT OF ANY WORK ON CITY, COUNTY, OR NEW MEXICO DEPARTMENT OF TRANSPORTATION ROADS. THEY SHALL BE MAINTAINED THROUGHOUT CONSTRUCTION AND SHALL REMAIN IN PLACE UNTIL THE CONCLUSION OF ALL WORK.

I. ALL WARNING DEVICES SHALL BE EITHER TYPE I BARRICADES OR DRUMS WITH WARNING LIGHTS ON EVERY OTHER DEVICE. THEY SHALL CONFORM TO THE MANUAL ON UNIFORM TRAFFIC CONTROL DEVICES (MUTCD), CURRENT EDITION, AND CITY OF ALBUQUERQUE STANDARDS FOR COLOR, SIZE, REFLECTIVITY, HEIGHT, AND PLACEMENT.

J. FIRE DEPARTMENT ACCESS SHALL BE MAINTAINED AT ALL TIMES.

K. CONTRACTOR SHALL SHORE AND BRACE ALL EARTH, FORMS, CONCRETE, STEEL, WOOD, AND MASONRY TO RESIST GRAVITY, EARTH, WIND, THERMAL, CONSTRUCTION, AND MISCELLANEOUS LOADS DURING CONSTRUCTION.

L. ON-SITE BURIAL OF DEBRIS IS PROHIBITED.

M. UNLESS OTHERWISE NOTED THE CONTRACTOR SHALL SUBMIT SHOP DRAWINGS OF ALL FABRICATED MATERIALS TO THE ENGINEER. DESIGN DOCUMENTS SHALL NOT BE REPRODUCED AS SHOP DRAWINGS.

N. IN CASE OF UNFORESEEN CONSTRUCTION COMPLICATIONS OR DISCREPANCIES, THE CONTRACTOR IS TO IMMEDIATELY NOTIFY THE ENGINEER IN WRITING.

O. ALL REQUIRED TESTING REPORTS SHALL BE AVAILABLE AT THE JOB SITE.

P. AS-BUILT DRAWINGS OF ROADWAYS, STORM DRAINS, SANITARY SEWER AND WATER LINES, FIELD APPROVAL BY THE ENGINEER, AND ALL APPLICABLE BONDS ARE REQUIRED PRIOR TO FINAL ACCEPTANCE BY THE OWNER.

Q. CONTRACTOR SHALL MAINTAIN CONTINUOUS UTILITY SERVICE TO ALL EXISTING BUILDINGS THROUGHOUT CONSTRUCTION UNLESS APPROVAL FOR SERVICE INTERRUPTION IS OBTAINED FROM THE OWNERS IN ADVANCE.

R. THE CONTRACTOR SHALL VERIFY EXISTING CONDITIONS TO ENSURE THAT THE NEW WORK SHALL FIT INTO THE EXISTING SITE IN THE MANNER INTENDED AND AS SHOWN ON THE DRAWINGS. SHOULD ANY CONDITIONS EXIST THAT ARE CONTRARY TO THOSE SHOWN ON THE DRAWINGS, THE CONTRACTOR SHALL NOTIFY THE OWNER'S REPRESENTATIVE PRIOR TO PERFORMING ANY WORK IN THE AREA INVOLVING DIFFERENCES. NOTIFICATION SHALL BE IN THE FORM OF A DRAWING OR SKETCH INDICATING FIELD MEASUREMENTS AND NOTES RELATING TO THE AREA.

S. ANY FOREIGN ITEM FOUND DURING CONSTRUCTION IS THE PROPERTY OF THE OWNER. THIS INCLUDES, BUT IS NOT LIMITED TO, PRECIOUS METALS, COINS, PAPER CURRENCY, ARTIFACTS AND ANTIQUITIES.

T. THE CONTRACTOR SHALL BE RESPONSIBLE FOR ANY DAMAGE DONE TO THE PREMISES OR ADJACENT PREMISES, OR INJURIES TO THE PUBLIC DURING THE CONSTRUCTION OF THE WORK, WHETHER CAUSED BY HIMSELF, HIS SUBCONTRACTORS, OR THE CARELESSNESS OF ANY OF HIS EMPLOYEES.

U. THE CONTRACTOR SHALL FURNISH, INSTALL AND MAINTAIN ALL NECESSARY TEMPORARY WORKS FOR THE PROTECTION OF THE WORK AND THE PUBLIC, INCLUDING BARRICADES, WARNING SIGNS, LIGHTS, ETC.

V. THE CONTRACTOR ACKNOWLEDGES & AGREES THAT THE WORK IS ENTIRELY AT HIS RISK UNTIL SITE IS ACCEPTED, AND HE WILL BE HELD RESPONSIBLE FOR ITS SAFETY BY THE OWNER. THE CONTRACTOR WILL INDEMNIFY THE OWNER & OWNER'S REPRESENTATIVE FROM LIABILITY AT THE SITE THROUGHOUT THE CONSTRUCTION PROCESS.

W. THE CONTRACTOR SHALL GIVE ALL NECESSARY NOTICES AND OBTAIN ALL PERMITS AND PAY ALL LEGAL FEES. HE SHALL ALSO COMPLY WITH ALL CITY, COUNTY AND STATE BUILDING LAWS, ORDINANCES OR REGULATIONS RELATING TO BUILDING SIDEWALKS, STREETS, BLASTING, PUBLIC INFRASTRUCTURE, STORMWATER REGULATIONS, ETC.

X. THE CONTRACTOR IS TO CHECK AND VERIFY ALL MEASUREMENTS, LEVELS, ETC. BEFORE ORDERING MATERIALS AND PROCEEDING WITH THE WORK, AND IS TO BE RESPONSIBLE FOR THE SAME.

Y. REFERENCE POINTS AND HUBS DURING THE CONSTRUCTION OF HIS WORK, AND SHALL BEAR THE COST OF REPLACING SAME.

Z. CARE SHALL BE TAKEN TO PROTECT ANY UTILITIES, TREES, ETC. WHICH ARE TO REMAIN AND NOT TO BE DISTURBED BY THE CONSTRUCTION. THE CONTRACTOR SHALL BE RESPONSIBLE FOR ANY DAMAGES TO SUCH PROPERTY.

DEMOLITION INFORMATION:

1. NOTIFICATIONS:
- THE CONTRACTOR SHALL NOTIFY THE OWNER AND CITY INSPECTOR(S) 24 HOURS PRIOR TO ANY DEMOLITION OR CONSTRUCTION.
2. DISPOSAL GUIDELINES:
- A. ONLY ITEMS SPECIFICALLY NOTED TO BE DEMOLISHED SHALL BE REMOVED FROM THE SITE.

B. REMOVE EXISTING PAVED AREAS AS SHOWN INCLUDING DRIVEWAYS, SIDEWALKS, PARKING AREAS, SERVICE AREAS, EQUIPMENT PADS, AND ALL MISCELLANEOUS PAVING.

C. ALL DEBRIS RESULTING FROM DEMOLITION SHALL BE REMOVED FROM THE SITE AND DISPOSED OF LEGALLY BY THE CONTRACTOR IN ACCORDANCE WITH LOCAL STATE AND FEDERAL REGULATIONS. BACKFILL ALL TRENCHES AND EXCAVATIONS RESULTING FROM DEMOLITION.

D. ALL DEMOLISHED MATERIAL BECOMES THE PROPERTY OF THE CONTRACTOR UNLESS OTHERWISE NOTED.
3. TREE PROTECTION GUIDELINES:
- PROTECT ALL EXISTING TREES NOTED "TO REMAIN" AND ALL ITEMS TO BE TURNED OVER TO THE OWNER DURING DEMOLITION. TAKE ALL NECESSARY PRECAUTIONS AND PROTECTIVE MEASURES. ANY EXISTING ITEMS TO BE TURNED OVER TO THE OWNER WHICH ARE DAMAGED DURING DEMOLITION SHALL BE REPAIRED AT NO ADDITIONAL COST TO THE OWNER. TREES WHICH ARE DAMAGED WILL BE REPLACED OR REIMBURSED AT A RATE TO BE DETERMINED BY THE OWNER.
4. UTILITIES:
- A. PRIOR TO REMOVING OR ABANDONING ANY UTILITY THE CONTRACTOR SHALL VERIFY THAT NO UPSTREAM SERVICE WILL BE TERMINATED. THE CONTRACTOR SHALL INFORM THE ENGINEER IN WRITING OF ANY TERMINATION NOT SHOWN ON THE PLANS.

B. ALL ABANDONED WATER LINES, STORM SEWER PIPE, SANITARY SEWER PIPES, GAS LINES, OR ANY OTHER ABANDONED UNDERGROUND UTILITY SHALL BE ABANDONED IN PLACE UNLESS NOTED OTHERWISE.

SITE INFORMATION:

1. THE FOLLOWING ARE APPLICABLE TO ALL CIVIL DOCUMENTS:
- A. WHERE A DETAIL, SECTION, TYPICAL SECTION, OR A NOTE IS SHOWN FOR ONE CONDITION, IT SHALL APPLY FOR ALL LIKE OR SIMILAR CONDITIONS, UNLESS OTHERWISE NOTED ON THE PLANS.

B. EXISTING AND PROPOSED CONTOURS ARE AT ONE (1) FOOT INTERVALS.

C. ALL DIMENSIONS ARE TO FACE OF CURB UNLESS OTHERWISE NOTED.

D. ALL PIPE LENGTHS SPECIFIED IN THESE PLANS ARE THE HORIZONTAL DISTANCE AND ARE SHOWN FOR REFERENCE ONLY. IT IS THE RESPONSIBILITY OF THE CONTRACTOR TO DETERMINE ACTUAL LENGTHS BASED ON PROPOSED PIPE SLOPE.

E. PIPE LENGTHS IN PLANS ARE MEASURED FROM CENTER OF STRUCTURE TO CENTER OF STRUCTURE UNLESS OTHERWISE NOTED.

EROSION AND SEDIMENT CONTROL INFORMATION:

1. COMPREHENSIVE:
- A. THE ESCAPE OF SEDIMENT FROM THE SITE SHALL BE PREVENTED BY THE INSTALLATION OF EROSION AND SEDIMENT CONTROL MEASURES AND PRACTICES PRIOR TO OR CONCURRENT WITH LAND-DISTURBING ACTIVITIES.

B. PROVISIONS TO PREVENT EROSION OF SOIL FROM THE SITE SHALL BE AT A MINIMUM IN CONFORMANCE WITH THE REQUIREMENTS OF THE NEW MEXICO EROSION AND SEDIMENT CONTROL HANDBOOKS. IF FULL IMPLEMENTATION OF THE APPROVED PLAN DOES NOT PROVIDE FOR EFFECTIVE EROSION CONTROL, ADDITIONAL EROSION AND SEDIMENT CONTROL MEASURES SHALL BE IMPLEMENTED TO CONTROL OR TREAT THE SEDIMENT SOURCE.

C. FAILURE TO INSTALL, OPERATE, OR MAINTAIN ALL EROSION CONTROL MEASURES WILL RESULT IN ALL CONSTRUCTION BEING STOPPED ON THE JOB SITE UNTIL SUCH MEASURES ARE CORRECTED BACK TO THE STANDARDS SPECIFIED IN THE NEW MEXICO EROSION AND SEDIMENT CONTROL HANDBOOKS, CURRENT EDITION.

D. EROSION CONTROL MEASURES WILL BE MAINTAINED AT ALL TIMES. IF FULL IMPLEMENTATION OF THE APPROVED PLAN DOES NOT PROVIDE FOR EFFECTIVE EROSION CONTROL, ADDITIONAL EROSION AND SEDIMENT CONTROL MEASURES SHALL BE IMPLEMENTED TO CONTROL OR TREAT THE SEDIMENT SOURCE.

E. EROSION CONTROL DEVICES SHALL BE INSTALLED PRIOR TO LAND DISTURBANCE. THE LOCATION OF SOME OF THE EROSION CONTROL DEVICES MAY HAVE TO BE ALTERED FROM THAT SHOWN ON THE APPROVED PLANS IF DRAINAGE PATTERNS DURING CONSTRUCTION ARE DIFFERENT FROM THE FINAL PROPOSED DRAINAGE PATTERNS. IT IS THE CONTRACTOR'S RESPONSIBILITY TO ACCOMPLISH EROSION CONTROL FOR ALL DRAINAGE PATTERNS CREATED AT VARIOUS STAGES DURING CONSTRUCTION. ANY DIFFICULTY IN CONTROLLING EROSION DURING ANY PHASE OF CONSTRUCTION SHALL BE REPORTED TO THE ENGINEER IMMEDIATELY.

F. THE CONSTRUCTION OF THE SITE WILL COMMENCE WITH THE INSTALLATION OF EROSION CONTROL MEASURES SUFFICIENT TO CONTROL SEDIMENT DEPOSITS AND EROSION. ALL SEDIMENT CONTROL WILL BE MAINTAINED UNTIL ALL UPSTREAM GROUND WITHIN THE CONSTRUCTION AREA HAS BEEN COMPLETELY STABILIZED WITH PERMANENT VEGETATION AND ALL ROADS/DRIVEWAYS HAVE BEEN PAVED.

G. CONSTRUCTION EXITS SHALL BE CONSTRUCTED AT EACH POINT OF ENTRY OR EXIT FROM THE SITE AND SHALL BE MAINTAINED IN A CONDITION WHICH WILL PREVENT TRACKING OR FLOW OF MUD ONTO PUBLIC RIGHTS-OF-WAY. THIS MAY REQUIRE PERIODIC TOP DRESSING WITH STONE AS CONDITIONS DEMAND, REPAIR, AND/OR CLEANOUT OF ANY STRUCTURES USED TO TRAP SEDIMENT. ALL MATERIALS SPILLED, DROPPED, WASHED, OR TRACKED FROM VEHICLES OFF SITE ONTO PUBLIC RIGHTS-OF-WAY MUST BE REMOVED IMMEDIATELY. ACCESS POINTS PROTECTED WITH A CONSTRUCTION EXIT SHALL BE OTHERWISE BARRICADED UNTIL THE SITE IS STABILIZED.

ADA COMPLIANCE:

- A. CURB RAMPS ALONG PUBLIC STREETS AND IN THE PUBLIC RIGHT-OF-WAY SHALL BE CONSTRUCTED BASED ON THE CITY STANDARD CONSTRUCTION DETAILS AND SPECIFICATIONS.

B. PRIVATE CURB RAMPS ON THE SITE (I.E. OUTSIDE PUBLIC STREET RIGHT-OF-WAY) SHALL CONFORM TO ADA STANDARDS AND SHALL HAVE A DETECTABLE WARNING SURFACE THAT IS FULL WIDTH AND FULL DEPTH OF THE CURB RAMP, NOT INCLUDING FLARES.

C. ALL ACCESSIBLE ROUTES, GENERAL SITE AND BUILDING ELEMENTS, RAMPS, CURB RAMPS, STRIPING, AND PAVEMENT MARKINGS SHALL CONFORM TO ADA STANDARDS FOR ACCESSIBLE DESIGN, LATEST EDITION.

D. ANY COMPONENTS OF THE PROJECT SERVING MULTIFAMILY DWELLINGS IN BUILDINGS THAT HAVE 4 OR MORE UNITS PER DWELLING SHALL ALSO CONFORM TO THE FAIR HOUSING ACT (FHA), AND COMPLY WITH THE FAIR HOUSING ACT DESIGN MANUAL BY THE US DEPARTMENT OF HOUSING AND URBAN DEVELOPMENT.

E. BEFORE PLACING PAVEMENT, CONTRACTOR SHALL VERIFY THAT SUITABLE ACCESSIBLE PEDESTRIAN ROUTES (PER ADA AND FHA) EXIST TO AND FROM EVERY DOOR AND ALONG SIDEWALKS, ACCESSIBLE PARKING SPACES, ACCESS AISLES, AND ACCESSIBLE ROUTES. IN NO CASE SHALL AN ACCESSIBLE RAMP SLOPE EXCEED 1 VERTICAL TO 12 HORIZONTAL. IN NO CASE SHALL SIDEWALK CROSS SLOPE EXCEED 2.0 PERCENT. IN NO CASE SHALL LONGITUDINAL SIDEWALK SLOPE EXCEED 5.0 PERCENT. ACCESSIBLE PARKING SPACES AND ACCESS AISLES SHALL NOT EXCEED 2.0 PERCENT SLOPE IN ANY DIRECTION.

F. CONTRACTOR SHALL TAKE FIELD SLOPE MEASUREMENTS ON FINISHED SUBGRADE AND FORM BOARDS PRIOR TO PLACING PAVEMENT TO VERIFY THAT ADA SLOPE REQUIREMENTS ARE PROVIDED. CONTRACTOR SHALL CONTACT ENGINEER PRIOR TO PAVING IF ANY EXCESSIVE SLOPES ARE ENCOUNTERED. NO CONTRACTOR CHANGE ORDERS WILL BE ACCEPTED FOR ADA SLOPE COMPLIANCE ISSUES.

CONCRETE INFORMATION (SITE WORK ONLY):

1. PRODUCT CRITERIA:
- A. UNLESS OTHERWISE NOTED CEMENT SHALL BE TYPE I OR III CONFORMING TO ASTM C150. AGGREGATES SHALL BE NORMAL WEIGHT CONFORMING TO ASTM C33.

B. CONCRETE SHALL CONFORM TO ACI BUILDING CODE (318-89). UNLESS NOTED CONCRETE SHALL BE NORMAL WEIGHT AND HAVE A 28 DAY COMPRESSIVE STRENGTH OF 3,500 P.S.I.

C. SLUMP SHALL BE 3" TO 5" FOR REGULAR MIX. LARGER SLUMP SHALL BE PERMITTED WITH WATER REDUCING ADMIXTURES AND WRITTEN CONSENT OF THE ENGINEER.

D. THE RELATIONSHIP BETWEEN MAXIMUM AGGREGATE SIZE TO MINIMUM AMOUNT OF CEMENT IN CONCRETE PAVEMENT (LB. PER C.Y. OR MIX) SHALL BE AS FOLLOWS: 1" - 520, 3/4" - 540, 1/2" - 590, 3/8" - 610.
2. CURING CRITERIA:
- A. CONCRETE CURING SHALL COMPLY WITH ACI 308. CURING PROCESS SHALL START IMMEDIATELY FOLLOWING INITIAL SET. CURING SHALL BE BY CURING COMPOUND.

B. CONCRETE EXPOSED TO THE WEATHER SHALL BE AIR-ENTRAINED IN ACCORDANCE WITH ACI 318-89 TABLE 4.1.1. NORMAL WEIGHT CONCRETE SLABS SHALL HAVE AIR CONTENT IN ACCORDANCE WITH ACI 302.IR-89 TABLE 5.2.7A.

C. HOT WEATHER CONCRETING SHALL COMPLY WITH ACI 305. NO CONCRETE ABOVE 90 DEGREES FAHRENHEIT SHALL BE POURED. LOWER CONCRETE TEMPERATURE BY COOLING WATER AND AGGREGATE. FORMS, STEEL, AND SUBGRADE SHALL BE SPRINKLED WITH COLD WATER. AFTER FINISHING CONCRETE USE LIGHT FOG SPRAY UNTIL CURING COMPOUND IS USED.

D. COLD WEATHER CONCRETING SHALL COMPLY WITH ACI 306. SPECIAL MATERIAL PROCEDURES SHALL BE PROVIDED DURING PLACING AND CURING OF CONCRETE BELOW 40 DEGREES FAHRENHEIT.

E. E. CURING, HOT, AND COLD WEATHER CONCRETING PROCEDURES ARE ONLY GIVEN AS A GUIDE. IT IS THE CONTRACTOR'S RESPONSIBILITY TO PREVENT CONCRETE DAMAGE AND CRACKS. DAMAGED OR CRACKED CONCRETE WILL NOT BE ACCEPTED.

REINFORCING STEEL INFORMATION (SITE WORK ONLY):

1. PRODUCT CRITERIA:
- A. REINFORCING STEEL SHALL CONFORM TO ASTM A-615, GRADE 60 AND GRADE 40 FOR #3 AND SMALLER BARS. MINIMUM LAP 48" DIAMETER.

B. WELDED WIRE FABRIC SHALL CONFORM TO ASTM A-185, MINIMUM LAP SHALL BE 8".

C. REINFORCING THAT IS WELDED SHALL BE WELDABLE TYPE AND CONFORM TO ASTM A-706.
2. SIGNING AND STRIPING:
- A. SIGNING AND STRIPING TO BE PROVIDED BY THE CONTRACTOR ACCORDING TO THE DRAWINGS AND SPECIFICATIONS.

B. ALL PAVEMENT MARKINGS SHALL CONFORM TO CURRENT MUTCD STANDARDS. ALL PAVEMENT MARKINGS ON PRIVATE PROPERTY SHALL BE PAINT, UNLESS NOTED OTHERWISE. ALL PAVEMENT MARKINGS ON PUBLIC RIGHT-OF-WAY SHALL BE THERMOPLASTIC, UNLESS NOTED OTHERWISE.

STORM SEWER NOTES:

1. REINFORCED CONCRETE PIPE SHALL BE RCP CLASS III UNLESS OTHERWISE NOTED WITH BELL-AND-SPIGOT AND GASKETED JOINTS WITH ASTM C 443 RUBBER GASKETS.

2. FILL HEIGHTS OVER 13' REQUIRE CLASS IV RCP STORM PIPE.

3. STORM INLETS SHALL BE PRECAST IN ACCORDANCE WITH CITY OF ALBUQUERQUE PUBLIC WORKS SPECIFICATIONS WHICH MEET OR EXCEED ASTM C 478.

4. ALL MANHOLE FRAMES AND COVERS ARE TO BE PER CITY OF ALBUQUERQUE PUBLIC WORKS STANDARD DETAIL FOR DIMENSIONS AND MATERIALS AND AS BELOW IF NOT OTHERWISE INDICATED. FERROUS; 24-INCH (610-MM) ID BY 7- TO 9-INCH (175- TO 225-MM) RISER WITH 4-INCH- (102-MM-) MINIMUM WIDTH FLANGE AND 26-INCH- (660-MM-) DIAMETER COVER. INCLUDE INDENTED TOP DESIGN WITH LETTERING CAST INTO COVER, USING WORDING EQUIVALENT TO "STORM SEWER."

5. MATERIAL: GRAY IRON ASTM A48 CLASS 30 UNLESS OTHERWISE INDICATED.

6. ALL HDPE PIPE SHALL BE CORRUGATED HIGH DENSITY POLYETHYLENE SMOOTH INTERIOR PIPE. HDPE PIPE SHALL CONFORM TO ASTM D3350 WITH SOIL TIGHT JOINTS.

7. ALL HDPE SHALL BE INSTALLED PER MANUFACTURER'S RECOMMENDATIONS AND AASHTO SECTION 30.

8. CONTRACTOR TO PROVIDE AND INSTALL MANUFACTURER RECOMMENDED FITTINGS ON RCP CONNECTIONS TO HDPE STRUCTURES.

9. REFER TO PIPE CHART FOR CASTING TYPES. INSTALL REDUCERS AS NECESSARY PER MANUFACTURER'S SPECIFICATIONS TO ACCOMMODATE LARGER INLET SIZES.

10. FOLLOW CONSTRUCTION PLANS AND MANUFACTURER DETAILS, SPECIFICATIONS, AND INSTALLATION INSTRUCTION AS INCLUDED WITHIN THE PLANS AND PROVIDED BY MANUFACTURER FOR THE INSTALLATION OF WATER QUALITY AND DETENTION SYSTEMS.

11. CONTRACTOR SHALL SUBMIT SHOP DRAWINGS FOR ALL STORM SEWER PIPE, STRUCTURES, WATER QUALITY STRUCTURES, AND DETENTION STRUCTURES FOR ENGINEER AND OWNER APPROVAL PRIOR TO ORDERING MATERIALS.

CLEARING AND GRUBBING:

- A. DO NOT EXCEED CLEARING AND GRUBBING LIMITS OF CONSTRUCTION LINES INDICATED ON THE PLANS.

B. ALL AREAS OUTSIDE THE LIMITS OF CONSTRUCTION LINE SHALL NOT BE CROSSED BY HEAVY EQUIPMENT OR USED FOR STORING HEAVY EQUIPMENT OR MATERIALS.

C. NO EQUIPMENT SHALL BE STORED UNDER THE DRIP LINE OF TREES TO REMAIN.

D. DO NOT FALL ANY TREES OR PUSH PILES OF DEBRIS AGAINST ANY TREES TO REMAIN.

E. REMOVE ALL STUMPS, ROCKS, ASPHALT & CONCRETE DEBRIS, ETC. AND DISPOSE OFF SITE IN ACCORDANCE WITH LOCAL, STATE & FEDERAL REGULATIONS.

F. CONTACT ALL UTILITY AUTHORITIES WHO HAVE LINES WITHIN THE CLEARING AND GRUBBING LIMITS BEFORE STARTING WORK

E. ALL EROSION CONTROL SEDIMENT BARRIERS, SILT FENCES, AND TREE PROTECTION DEVICES SHALL BE INSTALLED PRIOR TO STARTING CLEARING AND GRUBBING.

F. AFTER STAKING IS COMPLETED, TREES WITHIN GRADING LIMITS TO BE SAVED WILL BE IDENTIFIED BY THE OWNER'S REPRESENTATIVE. FIELD CHANGES TO GRADING PLANS SHALL BE MADE FOR SMOOTH TRANSITION OF GRADES AROUND ALL TREES WHICH REQUIRE TREE WELLS WITHIN THE GRADING LIMITS.

G. ALL CLEARING SHALL BE LIMITED TO AREAS TO BE GRADED WITHIN 15 CALENDAR DAYS.

GRADING NOTES:

- A. TOPSOIL SHALL BE STORED ON SITE IN LOCATIONS APPROVED BY THE OWNER'S REPRESENTATIVE. DRAINAGE SHALL ROUT AROUND THESE TOPSOIL STOCKPILES FOR THE DURATION OF THE GRADING OPERATIONS. EROSION CONTROL MEASURES SHALL PREVENT THE LOSS OF TOPSOIL MATERIAL.

B. UNSUITABLE SOILS SHALL BE UNIFORMLY SPREAD ACROSS NON-STRUCTURAL FILL AREAS AND COVERED WITH TOPSOIL AND SEEDED.

C. FILL AREA SHALL BE PROOF-ROLLED WITH RUBBER-TIRED EQUIPMENT WITH A MINIMUM WEIGHT OF FIFTEEN TONS PRIOR TO BEGINNING FILL OPERATION. AREAS WHICH ARE SOFT OR UNSTABLE SHALL BE UNDERCUT UNTIL STABLE SOILS ARE FOUND. RE-COMPACTION OF THESE SOILS SHALL BE TO 98% MAXIMUM DRY DENSITY AS PER ASTM D698 (STANDARD PROCTOR).

D. CUT AREA SHALL BE PROOF-ROLLED AFTER FINAL SUBGRADE IS ACHIEVED IN THE SAME MANNER AS FILLED AREAS. SOFT OR UNSTABLE SOILS SHALL BE SCARIFIED TO A DEPTH OF 12" AND RE-COMPACTED TO 98% MAXIMUM DRY DENSITY AS PER ASTM D698 (STANDARD PROCTOR).

E. ALL GRADING SHALL BE COMPLETED TO THE LEVEL INDICATED BY THE SCOPE OF WORK LISTED IN THE BID DOCUMENTS.

F. ELEVATIONS SHOWN ON THE PLANS IS THE FINISH GRADE ELEVATION.

G. GRADING SHALL BE SEQUENCED SO THAT BASE STONE IS PLACED WITHIN 10 CALENDAR DAYS PF ACHIEVING OPTIMUM SUBGRADE COMPACTION.

H. SOILS TESTING LABORATORY/ SOILS ENGINEER, CONTRACTOR WILL EMPLOY A QUALIFIED SOILS TESTING LABORATORY/ ENGINEER TO OBSERVE THIS WORK AND MAKE TESTS AS REQUIRED.

I. HAVE EARTH BORROW FILL, AGGREGATE, AND TOPSOIL, AND STRUCTURAL FILL TESTED AND APPROVED BY DESIGNATED TESTING LABORATORY BEFORE MOVING IT TO THE JOB SITE.

J. CONTRACTOR SHALL OBSERVE PROOF-ROLLING OF AREAS WHERE BUILDING AND PAVING WILL BE LOCATED TO DETERMINE ADEQUACY OF SOIL COMPACTION AND IN-PLACE SOILS. OTHER AREAS WILL BE INSPECTED BY SOILS ENGINEER TO DETERMINE ADEQUACY IN THOSE AREAS. IF SOILS ARE NOT ADEQUATE TO BEAR WEIGHTS THAT WILL BE IMPOSED, TESTING LABORATORY WILL OBSERVE AND REPORT CORRECTIVE ACTION TAKEN.

K. TEST IN-PLACE SOIL AND FILLED AND COMPACTED AREAS. IF THESE ARE NOT ADEQUATE TO BEAR WEIGHTS IMPOSED, TESTING LABORATORY WILL ADVISE THE OWNER'S REPRESENTATIVE OF THEIR RECOMMENDATIONS. HE WILL DIRECT ANY CORRECTIVE MEASURES THAT ARE NECESSARY.

L. SOILS COMPACTION TESTING OF IN-PLACE AND FILLED AND COMPACTED AREAS WILL BE PERFORMED BY TESTING LABORATORY IN ACCORDANCE WITH THEIR REQUIREMENTS.

M. THE SOILS ENGINEER'S AND TESTING LABORATORY'S FEES WILL BE PAID BY THE CONTRACTOR.

N. APPLICABLE SPECIFICATIONS FOR COMPACTED FILL: THE FOLLOWING CURRENT AMERICAN SOCIETY OF TESTING MATERIALS (ASTM) STANDARDS ARE HEREBY MADE PART OF THIS SPECIFICATION:

• D421-58, DRY PREPARATION OF SOIL SAMPLES FOR GRAIN-SIZE ANALYSIS AND DETERMINATION OF SOIL CONSTANTS.

• D422-63, STANDARD METHOD OF PARTICLE SIZE ANALYSIS OF SOILS.

• D1140-54, METHOD OF TEST FOR AMOUNT OF MATERIAL IN SOILS FINER THAN NO.200 SIEVE.

• D698, METHOD FOR LABORATORY COMPACTION CHARACTERISTICS OF SOIL USING STANDARD EFFORT

• D1557-78, STANDARD TEST METHODS FOR MOISTURE-DENSITY RELATIONS OF SOILS AND SOIL-AGGREGATE MIXTURES USING 10 LB. (4.54-KG) RAMMER AND 18-INCH (457 MM) DROP.

O. PROVIDE POSITIVE DRAINAGE AWAY FROM BUILDINGS AT ALL LOCATIONS UNLESS OTHERWISE NOTED.

P. CONTRACTOR SHALL REVIEW THE SITE SPECIFIC GEOTECHNICAL REPORT PRIOR TO COMMENCING WITH GRADING OPERATIONS. WHERE CONFLICTS BETWEEN THE GRADING NOTES AND GEOTECHNICAL REPORT EXIST, THE MORE STRINGENT REQUIREMENT SHALL APPLY.

Q. CONTRACTOR IS RESPONSIBLE FOR DOCUMENTING WITH LOAD TICKETS, PHOTOGRAPHS, LOG BOOK, VIDEO RECORDING AND OTHER MEANS AS NECESSARY TO VERIFY THE INSTALLATION OF STORMWATER BEST MANAGEMENT PRACTICES REQUIRED BY THE LOCAL MUNICIPALITY AND JURISDICTION. AS-BUILT TOPOGRAPHY AND UTILITY PLANS HAVING BEEN PREPARED BY A QUALIFIED LAND SURVEYOR ARE REQUIRED TO BE SUBMITTED TO KIMLEY-HORN AT THE CONCLUSION OF THE PROJECT FOR VERIFICATION OF DESIGN INTENT. ANY MODIFICATIONS TO THE GRADING AND UTILITY SYSTEMS REQUIRED, NOT PREVIOUSLY APPROVED BY THE OWNER AND ENGINEER ARE THE RESPONSIBILITY OF THE CONTRACTOR.

Kimley»Horn

6200 SOUTH SYRACUSE WAY, SUITE 300  
GREENWOOD VILLAGE, CO 80111  
Main: 615.564.2701 | www.kimley-horn.com  
© 2021 Kimley-Horn and Associates, Inc.

WALMART #5430 ATM ADDITION  
FLITE BANKING CENTERS, LLC  
CONSTRUCTION DOCUMENTS  
ALBUQUERQUE, NM



BY		DATE	REVISIONS										
		dd/mm/yyyy	REVISION DESCRIPTION										
No.	1	2	3	4	5	6	7	8	9	10			
DESIGNED BY:			_____										
DRAWN BY:			_____										
CHECKED BY:			_____										
DATE:			05/17/2024										
KIMLEY-HORN PROJECT NO. 196235022													
GENERAL NOTES													
SHEET NUMBER <b>C0-01</b>													



This document, together with the concepts and designs presented herein, is intended only for the specific purpose and client for which it was prepared. Reuse of and improper reliance on this document without written authorization and adaptation by Kimley-Horn and Associates, Inc. shall be without liability to Kimley-Horn and Associates, Inc.

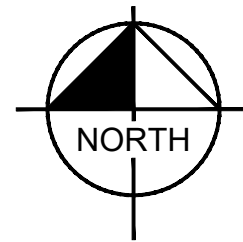
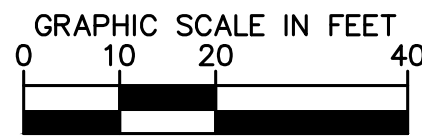
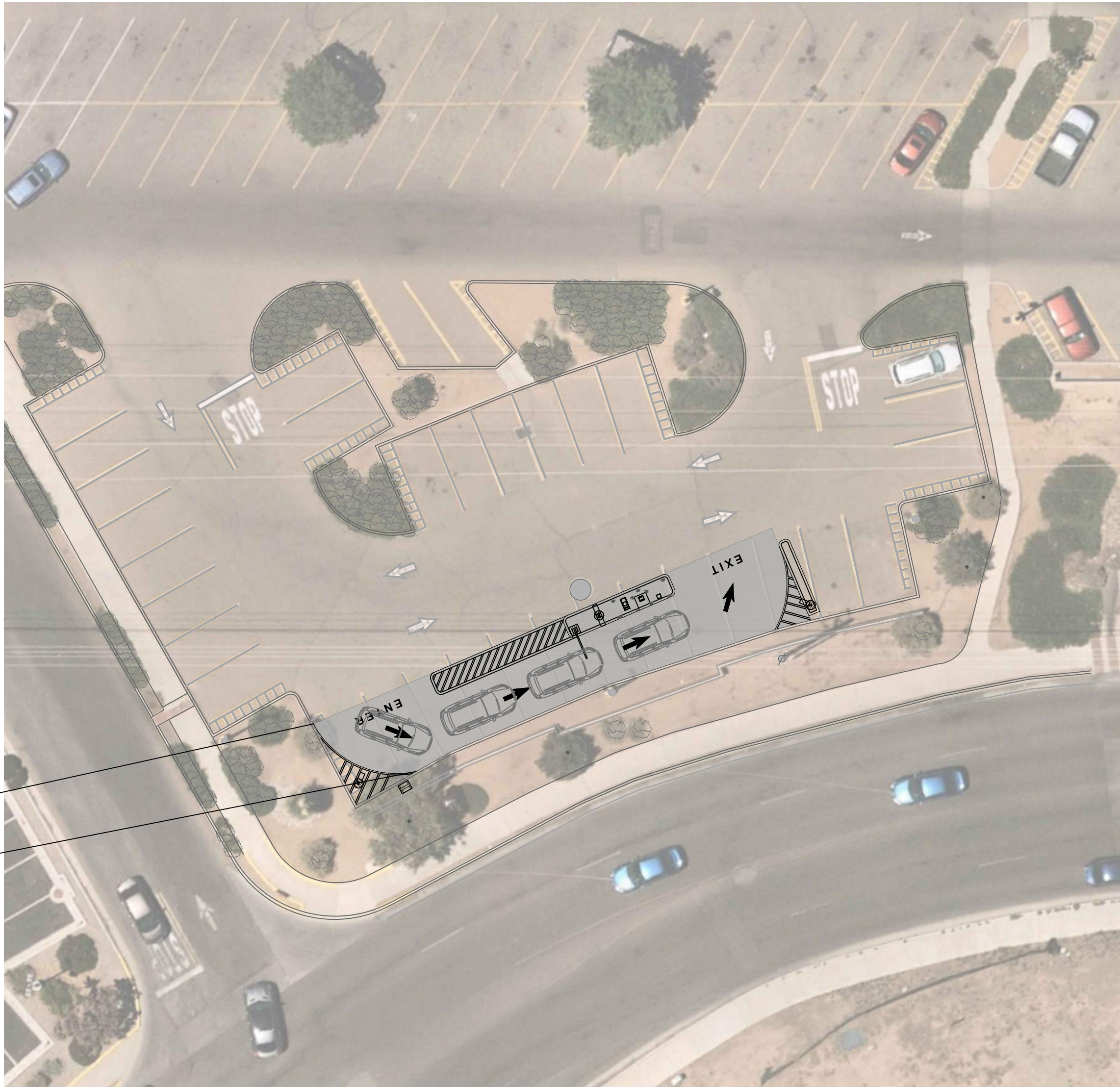
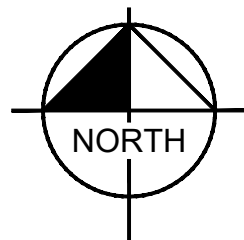
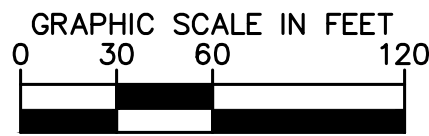

IMAGE SOURCE: NEARMAP  
IMAGE DATE: 06/30/2023

#### DISCLAIMER

THESE DRAWINGS WERE PRODUCED WITHOUT THE BENEFIT OF A CURRENT LAND SURVEY. ALL PROPERTY LINES, EASEMENTS, SETBACKS, EXISTING INFRASTRUCTURE AND TITLE DOCUMENTS SHALL BE VERIFIED PRIOR TO START OF CONSTRUCTION. KIMLEY-HORN AND FLITE BANKING CENTERS DO NOT GUARANTEE THE ACCURACY OF SAID PROPERTY LINES, EASEMENTS, SETBACKS, EXISTING INFRASTRUCTURE AND TITLE DOCUMENTS.

CONTRACTOR IS RESPONSIBLE FOR VERIFYING ALL FIELD CONDITIONS AND IS TO ALERT THE ENGINEER AND FLITE BANKING CENTERS OF ANY DISCREPANCIES PRIOR TO STARTING CONSTRUCTION. CONTRACTOR TO COORDINATE WITH FLITE BANKING CENTERS PM FOR ALL FINAL PLACEMENTS OF INFRASTRUCTURE.

# Kimley»Horn

6200 SOUTH SYRACUSE WAY, SUITE 300  
GREENWOOD VILLAGE, CO 80111  
Main: 615.564.2701 | www.kimley-horn.com  
© 2021 Kimley-Horn and Associates, Inc.

WALMART #5430 ATM ADDITION  
FLITE BANKING CENTERS, LLC  
CONSTRUCTION DOCUMENTS  
ALBUQUERQUE, NM



REVISIONS	DATE	BY
REVISION DESCRIPTION	dd/mm/yyyy	XXX
No.	1	2
DESIGNED BY:	MGK	MGK
DRAWN BY:	MGK	MGK
CHECKED BY:	DNP	DNP
DATE:	05/17/2024	05/17/2024
KIMLEY-HORN PROJECT NO.	196235022	196235022

SITE LOCATION

SHEET NUMBER

C1-00



This document, together with the concepts and designs presented herein, is intended only for the specific purpose and client for which it was prepared. Reuse of and improper reliance on this document without written authorization and adaptation by Kimley-Horn and Associates, Inc. shall be without liability to Kimley-Horn and Associates, Inc.

EXISTING CONDITIONS PLAN

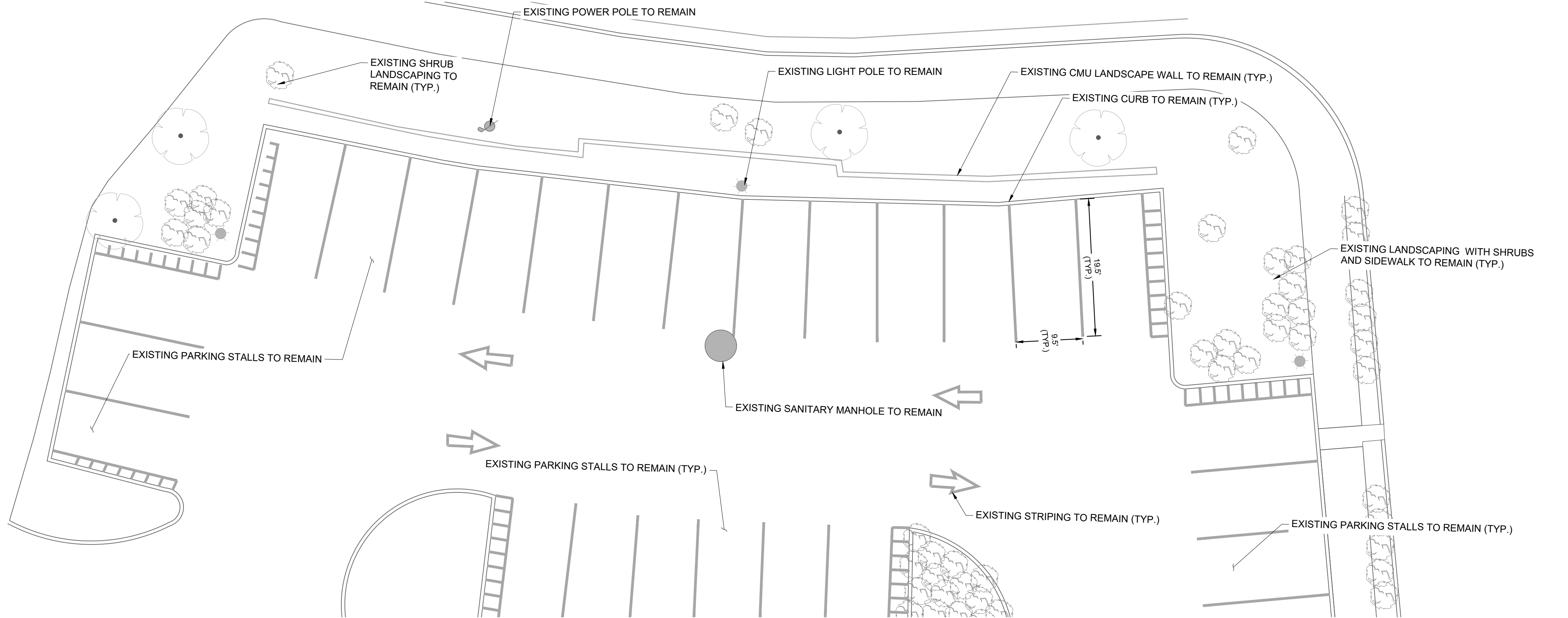

DEMOLITION PLAN

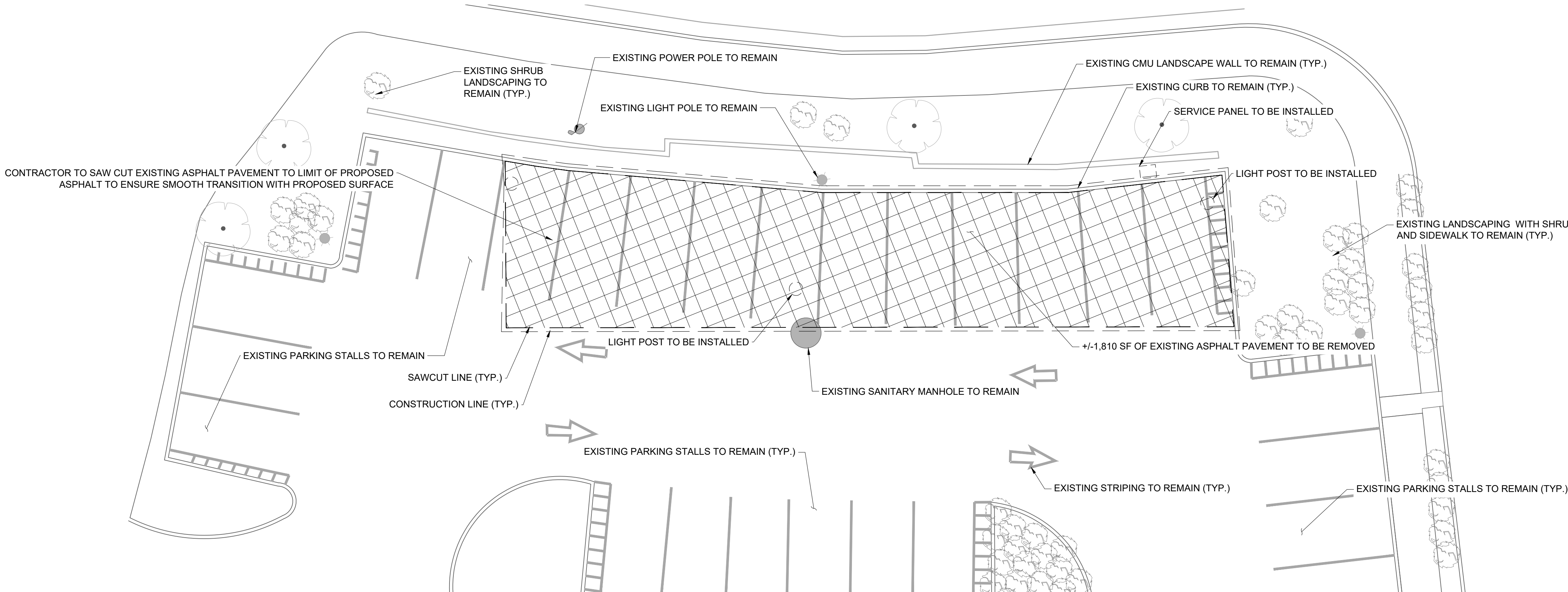

DEMOLITION LEGEND	
	REMOVE FULL-DEPTH ASPHALT PAVEMENT
	RIGHT OF WAY LINE
	SAW CUT LINE
	CONSTRUCTION LINE
	SERVICE PANEL TO BE INSTALLED
	LIGHT POST TO BE INSTALLED

EXISTING UTILITIES NOTE

CONTRACTOR SHALL VERIFY LOCATION OF ALL EXISTING UTILITIES AND NOTIFY ENGINEER IMMEDIATELY OF ANY DISCREPANCIES AND/OR CONFLICTS WITH EXISTING OR PROPOSED UTILITIES PRIOR TO PROCEEDING.

NOTES

- CONTRACTOR TO PROVIDE A 6'-0" CHAIN LINK FENCE AROUND CONSTRUCTION AREA.
- CONTRACTOR TO MATCH ALL EXISTING PAVEMENT ELEVATIONS. ALL PROPOSED ISLANDS TO BE 6" ABOVE EXISTING PAVEMENT. NEW WORK TO BE DONE WITHIN THE CONSTRUCTION AREA.
- ONE CALL NOTIFICATION SYSTEM. CALL BEFORE YOU DIG!!!
- CONTRACTOR TO SAW CUT, REMOVE AND HAUL OFF EXISTING ASPHALT AND/OR CONCRETE WITHIN DEMO AREA.

DEMOLITION NOTES

- THE CONTRACTOR IS RESPONSIBLE FOR THE DEMOLITION, REMOVAL, AND DISPOSAL (IN A LOCATION APPROVED BY ALL GOVERNING AUTHORITIES) ALL STRUCTURES, PADS, WALLS, FLUMES, FOUNDATIONS, PARKING, DRIVES, DRAINAGE STRUCTURES, UTILITIES, ETC., SUCH THAT THE IMPROVEMENTS SHOWN ON THE PROPOSED PLANS CAN BE CONSTRUCTED. ALL FACILITIES TO BE REMOVED SHALL BE UNDERCUT TO SUITABLE MATERIAL AND BROUGHT TO GRADE WITH SUITABLE COMPACTED FILL MATERIAL PER THE SPECIFICATIONS. PRIOR TO DEMOLITION OCCURRING, ALL EROSION CONTROL DEVICES ARE TO BE INSTALLED.
- THE CONTRACTOR IS RESPONSIBLE FOR REMOVING ALL DEBRIS FROM THE SITE AND DISPOSING THE DEBRIS IN A LAWFUL MANNER. THE CONTRACTOR IS RESPONSIBLE FOR OBTAINING ALL PERMITS REQUIRED FOR DEMOLITION AND DISPOSAL.
- CONTRACTOR MUST PROTECT THE PUBLIC AT ALL TIMES WITH FENCING, BARRICADES, ENCLOSURES, ETC., (AND OTHER APPROPRIATE BEST MANAGEMENT PRACTICES) AS APPROVED BY CITY AND OWNER.
- SHOULD REMOVAL AND/OR RELOCATION ACTIVITIES DAMAGE EXISTING FACILITIES TO REMAIN, THE CONTRACTOR SHALL PROVIDE NEW MATERIALS/ STRUCTURES IN ACCORDANCE WITH THE CONTRACT DOCUMENTS. EXCEPT FOR MATERIALS DESIGNED TO BE RELOCATED ON THIS PLAN, ALL OTHER CONSTRUCTION MATERIALS SHALL BE NEW.
- CONTRACTOR SHALL LIMIT SAW-CUT & PAVEMENT REMOVAL TO ONLY THOSE AREAS WHERE IT IS REQUIRED AS SHOWN ON THESE CONSTRUCTION PLANS, BUT IF ANY DAMAGE IS INCURRED ON ANY OF THE SURROUNDING PAVEMENT, ETC. THE CONTRACTOR SHALL BE RESPONSIBLE FOR ITS REMOVAL AND REPAIR.
- DAMAGE TO ALL EXISTING CONDITIONS TO REMAIN WILL BE REPLACED AT CONTRACTOR'S EXPENSE.
- CONCRETE/ASPHALT/BRICK, ETC. CAN BE CRUSHED (ON SITE OR OFFSITE) AND REUSED AS BASE MATERIAL FOR FUTURE PAVING AND BUILDING AREAS AS LONG AS IT MEETS REQUIRED GRADATION PER PLANS, CITY/STATE REQUIREMENTS AND GEOTECH REPORT.
- IT IS THE CONTRACTOR'S RESPONSIBILITY TO CONTACT THE VARIOUS UTILITY COMPANIES WHICH MAY HAVE BURIED OR AERIAL UTILITIES WITHIN OR NEAR THE CONSTRUCTION AREA BEFORE COMMENCING WORK. THE CONTRACTOR SHALL PROVIDE 72 HOURS MINIMUM NOTICE TO ALL UTILITY COMPANIES PRIOR TO BEGINNING CONSTRUCTION.
- CONTRACTOR SHALL REFERENCE THE LANDSCAPE PLAN FOR THE LOCATION OF THE TREES THAT ARE ALLOWED TO REMAIN/TO BE REMOVED ONCE A TREE REMOVAL PERMIT IS OBTAINED BY THE CONTRACTOR.
- ALL EXISTING UTILITIES SHOWN ARE LOCATED ACCORDING TO THE INFORMATION AVAILABLE TO THE ENGINEER AT THE TIME THE DRAWINGS WERE PREPARED AND HAVE NOT BEEN INDEPENDENTLY VERIFIED BY THE OWNER OR THE ENGINEER. GUARANTEE IS NOT MADE THAT ALL EXISTING UNDERGROUND UTILITIES ARE SHOWN OR THAT THE LOCATION OF THOSE SHOWN ARE ACCURATE. FINDING THE ACTUAL LOCATION OF ANY EXISTING UTILITIES IS THE CONTRACTOR'S RESPONSIBILITY AND SHALL BE DONE BEFORE HE COMMENCES ANY WORK IN THE VICINITY. FURTHERMORE, THE CONTRACTOR SHALL BE SOLELY RESPONSIBLE FOR ANY AND ALL DAMAGE DUE TO THE CONTRACTOR'S FAILURE TO EXACTLY LOCATE AND PRESERVE ANY AND ALL UNDERGROUND UTILITIES. THE OWNER OR ENGINEER WILL ASSUME NO LIABILITY FOR ANY DAMAGES SUSTAINED OR COST INCURRED BECAUSE OF THE OPERATIONS IN THE VICINITY OF EXISTING UTILITIES OR STRUCTURES, NOR FOR TEMPORARY BRACING AND SHORING OF SAME. IF IT IS NECESSARY TO SHORE, BRACE, SWING OR RELOCATE A UTILITY, THE UTILITY COMPANY OR DEPARTMENT AFFECTED SHALL BE CONTACTED BY THE CONTRACTOR AND THEIR PERMISSION OBTAINED REGARDING THE METHOD TO USE FOR SUCH WORK.
- THE CONTRACTOR SHALL HAVE AVAILABLE AT THE JOB SITE AT ALL TIMES ONE COPY OF THE CONTRACT DOCUMENTS INCLUDING PLANS, SPECIFICATIONS, COPIES OF ANY REQUIRED CONSTRUCTION PERMITS, AND EROSION CONTROL PLANS AND INSPECTION REPORTS (SWPPP).
- ANY DISCREPANCIES ON THE DRAWINGS SHALL BE IMMEDIATELY BROUGHT TO THE ATTENTION OF THE OWNER/ENGINEER BEFORE COMMENCING WORK. NO FIELD CHANGES OR DEVIATIONS FROM DESIGN ARE TO BE MADE WITHOUT PRIOR APPROVAL OF THE OWNER AND NOTIFICATION TO THE ENGINEER. NO CONSIDERATION WILL BE GIVEN TO CHANGE ORDERS FOR WHICH THE OWNER AND ENGINEER WERE NOT CONTACTED PRIOR TO CONSTRUCTION OF THE AFFECTED ITEM.
- CONTRACTOR IS RESPONSIBLE FOR PREPARING AND IMPLEMENTING A TRAFFIC CONTROL PLAN AND THE INSTALLATION OF TRAFFIC CONTROL DEVICES FOR ANY STREET WORK.
- ALL DEMOLITION WORK OR CONSTRUCTION VEHICLE TRAFFIC WITHIN 10 FEET OF THE CANOPY OF ANY TREE TO BE SAVED SHALL CLOSELY COORDINATED WITH TREE PRESERVATION ACTIVITIES.
- CONTRACTOR SHALL COMPLY TO THE FULLEST EXTENT WITH THE LATEST OSHA STANDARDS FOR EXCAVATION AND TRENCHING PROCEDURES. CONTRACTOR SHALL USE SUPPORT SYSTEMS, SLOPING, BENCHING, ETC. AS NECESSARY FOR THESE OPERATIONS, AND SHALL COMPLY WITH ALL OSHA PERFORMANCE CRITERIA.
- DO NOT INTERRUPT EXISTING UTILITIES SERVICING FACILITIES OCCUPIED AND USED BY THE OWNER OR OTHERS DURING OCCUPANCY HOURS EXCEPT WHEN SUCH INTERRUPTIONS HAVE BEEN AUTHORIZED IN WRITING BY THE OWNER AND THE LOCAL MUNICIPALITIES. INTERRUPTIONS SHALL ONLY OCCUR AFTER ACCEPTABLE TEMPORARY SERVICE HAS BEEN PROVIDED.
- ANY RECYCLED MATERIAL, TO BE STOCKPILED ON THE SITE SHALL BE STORED IN AS SMALL AN AREA AS PRACTICAL AND THE LOCATION OF ANY STOCKPILE SHALL BE WELL CLEAR OF THE BUILDING PAD AREA AND THE LOCATION MUST BE PRE-APPROVED BY THE ENGINEER AND OWNER PRIOR TO STOCKPILING.
- CONTRACTOR TO PULL ALL TREE REMOVAL PERMITS FOR ANY REQUIRED TREE REMOVAL.
- QUANTITIES SHOWN HERE ARE APPROXIMATE AND ARE PROVIDED FOR CONVENIENCE ONLY AND NOT FOR BID PURPOSES. CONTRACTOR SHALL VERIFY QUANTITIES NECESSARY TO DEMO FACILITIES SHOWN.

DISCLAIMER

THESE DRAWINGS WERE PRODUCED WITHOUT THE BENEFIT OF A CURRENT LAND SURVEY. ALL PROPERTY LINES, EASEMENTS, SETBACKS, EXISTING INFRASTRUCTURE AND TITLE DOCUMENTS SHALL BE VERIFIED PRIOR TO START OF CONSTRUCTION. KIMLEY-HORN AND FLITE BANKING CENTERS DO NOT GUARANTEE THE ACCURACY OF SAID PROPERTY LINES, EASEMENTS, SETBACKS, EXISTING INFRASTRUCTURE AND TITLE DOCUMENTS.

CONTRACTOR IS RESPONSIBLE FOR VERIFYING ALL FIELD CONDITIONS AND IS TO ALERT THE ENGINEER AND FLITE BANKING CENTERS OF ANY DISCREPANCIES PRIOR TO STARTING CONSTRUCTION. CONTRACTOR TO COORDINATE WITH FLITE BANKING CENTERS PM FOR ALL FINAL PLACEMENTS OF INFRASTRUCTURE.



SEE DEMOLITION NOTES, SHEET C0-01.

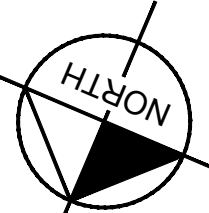
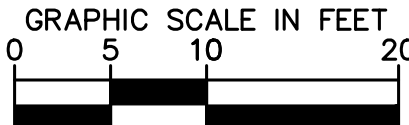

Kimley»Horn

6200 SOUTH SYRACUSE WAY, SUITE 300  
GREENWOOD VILLAGE, CO 80111  
Main: 615.564.2701 | www.kimley-horn.com  
© 2021 Kimley-Horn and Associates, Inc.

WALMART #5430 ATM ADDITION  
FLITE BANKING CENTERS, LLC  
CONSTRUCTION DOCUMENTS  
ALBUQUERQUE, NM



No.	BY	DATE	REVISIONS	REVISION DESCRIPTION	DESIGNED BY:	DRAWN BY:	CHECKED BY:	DATE:	KIMLEY-HORN PROJECT NO.	EXISTING CONDITIONS & DEMOLITION PLAN	SHEET NUMBER
1	XXX	dd/mm/yyyy			MGK	MGK	DNP	05/17/2024	196235022		C1-20



This document, together with the concepts and designs presented herein, is an instrument of service, intended only for the specific purpose and client for which it was prepared. Reuse of and improper reliance on this document without written authorization and adaptation by Kimley-Horn and Associates, Inc. shall be without liability to Kimley-Horn and Associates, Inc.

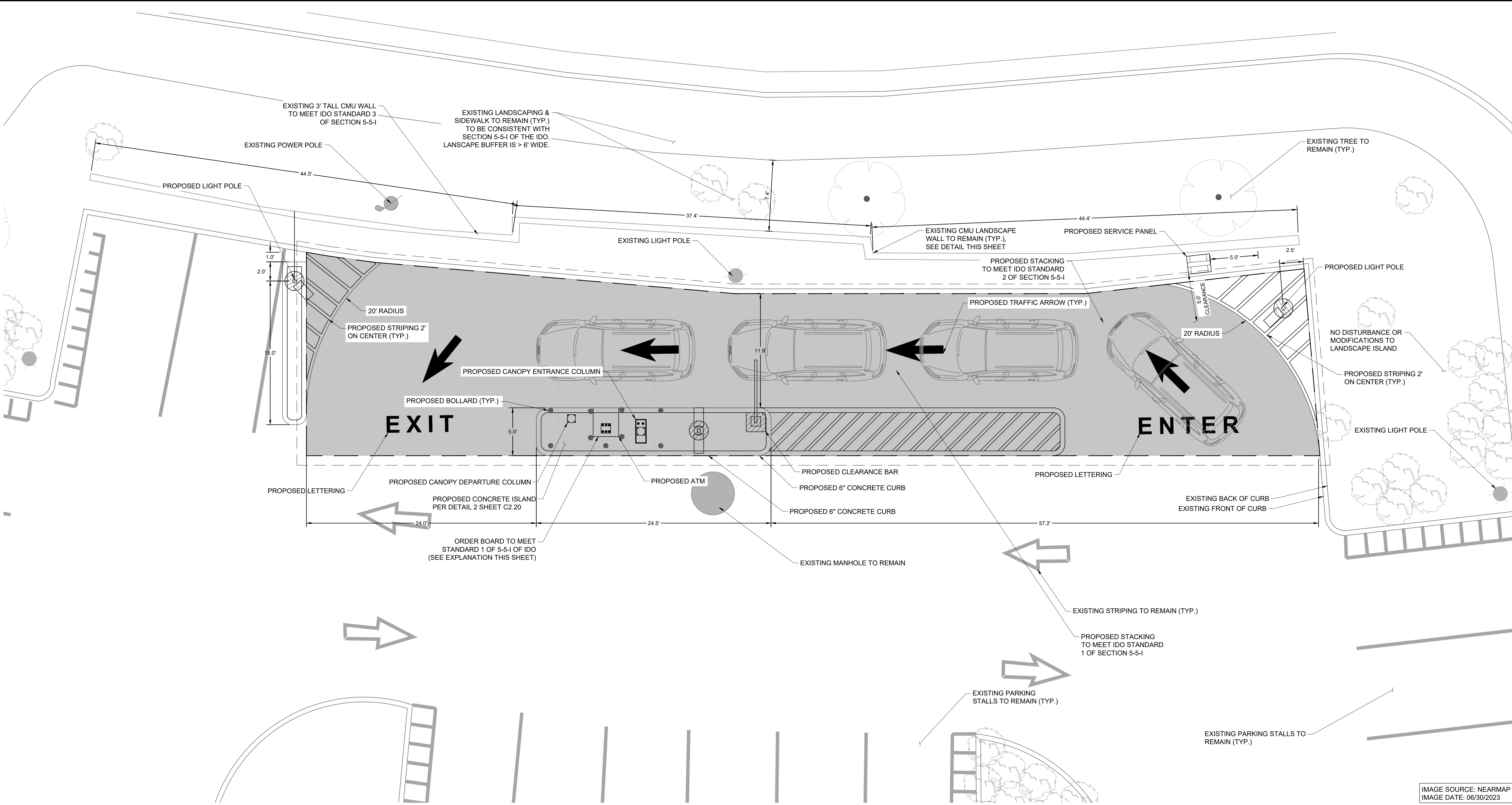

NOTES

1. STRIPING ON ALL CURBS, PAVEMENT, AND TRAFFIC ARROWS SHALL BE PAINTED WHITE.
2. LETTERING "ENTER" AND "EXIT" SHALL BE PAINTED WHITE.
3. CONTRACTOR SHALL MAINTAIN EXISTING DRAINAGE PATTERNS.
4. CONTRACTOR SHALL ENSURE A SMOOTH TRANSITION TO EXISTING GRADES.

GRADING NOTES

1. DISTURBED AREAS LEFT IDLE FOR FIVE DAYS, AND NOT TO FINAL GRADE, WILL BE ESTABLISHED TO TEMPORARY VEGETATION. MULCH, TEMPORARY VEGETATION OR PERMANENT VEGETATION SHALL BE COMPLETED ON ALL EXPOSED AREAS WITHIN 14 DAYS AFTER DISTURBANCE. ALL AREAS TO FINAL GRADE WILL BE ESTABLISHED TO PERMANENT VEGETATION UPON COMPLETION.
2. WHEN HAND PLANTING, MULCH (HAY OR STRAW) SHOULD BE UNIFORMLY SPREAD OVER SEEDED AREA WITHIN 24 HOURS OF SEEDING. IF UNABLE TO ACCOMPLISH, MULCH SHALL BE USED AS A TEMPORARY COVER, CONCENTRATED FLOW AREAS AND ALL SLOPES STEEPER THAN 2.5:1 AND WITH A HEIGHT OF TEN FEET OR GREATER (DOES NOT APPLY TO RETAINING WALLS), AND CUTS AND FILLS WITHIN BUFFERS, SHALL BE STABILIZED WITH THE APPROPRIATE EROSION CONTROL MATTING OR BLANKETS.
3. THE ESCAPE OF SEDIMENT FROM THE SITE SHALL BE PREVENTED BY THE INSTALLATION OF EROSION AND SEDIMENT CONTROL MEASURES AND PRACTICES PRIOR TO, OR CONCURRENT WITH, LAND-DISTURBING ACTIVITIES.
4. SEED ALL DISTURBED AREAS UNLESS OTHERWISE NOTED AS PART OF THIS CONTRACT.
5. THE CONTRACTOR SHALL DETERMINE THE EXACT LOCATION OF ALL EXISTING UTILITIES BEFORE COMMENCING WORK AND AGREES TO BE RESPONSIBLE FOR ANY AND ALL DAMAGES WHICH MIGHT RESULT FROM THE CONTRACTOR'S FAILURE TO EXACTLY LOCATE AND PRESERVE ANY UNDERGROUND UTILITIES TO REMAIN. THE CONTRACTOR IS TO NOTIFY ENGINEER IMMEDIATELY OF ANY DISCREPANCIES AND/OR CONFLICTS WITH EXISTING OR PROPOSED UTILITIES PRIOR TO PROCEEDING.
6. STOCKPILED TOPSOIL OR FILL MATERIAL IS TO BE TREATED SO THE SEDIMENT RUN-OFF WILL NOT CONTAMINATE SURROUNDING AREAS OR ENTER NEARBY STREAMS. STOCK PILE LOCATIONS SHALL BE COORDINATED WITH THE ENGINEER PRIOR TO GRADING ACTIVITIES. EROSION & SEDIMENT CONTROL PRACTICE SHALL BE INSTALLED PRIOR TO STOCKPILE OPERATIONS.
7. CONSTRUCT SILT BARRIERS BEFORE BEGINNING GRADING OPERATIONS.
8. MULCH AND SEED ALL DISTURBED AREAS AS SOON AS POSSIBLE AFTER FINAL GRADING IS COMPLETED (WITHIN 15 DAYS OF ACHIEVED FINAL GRADES) UNLESS OTHERWISE INDICATED. CONTRACTOR SHALL TAKE WHATEVER MEANS NECESSARY TO ESTABLISH PERMANENT SOIL STABILIZATION. STEEP SLOPES (GREATER THAN 3:1) SHALL BE STABILIZED WITHIN 7 DAYS OF FINAL GRADING.
9. PROVIDE TEMPORARY CONSTRUCTION ACCESS(ES) AT THE POINT(S) WHERE CONSTRUCTION VEHICLES EXIT THE CONSTRUCTION AREA. MAINTAIN PUBLIC ROADWAYS FREE OF TRACKED MUD AND DIRT.
10. DO NOT DISTURB VEGETATION OR REMOVE TREES EXCEPT WHEN NECESSARY FOR GRADING PURPOSE.

SITE PLAN LEGEND

	PROPOSED CONCRETE PLACEMENT
	SAW CUT LINE
	CONSTRUCTION LINE
	PROPOSED UNI-STRUT & METER SERVICE PANEL TO BE INSTALLED

NOTE: EXISTING CMU SCREENING WALL MEETS STANDARDS SET BY THE IDO (5-5-1-2-A) BY BEING AT LEAST 3' TALL AND UNDER 4' TALL. CMU WALL IS EXISTING AND IS TO REMAIN AS IS.

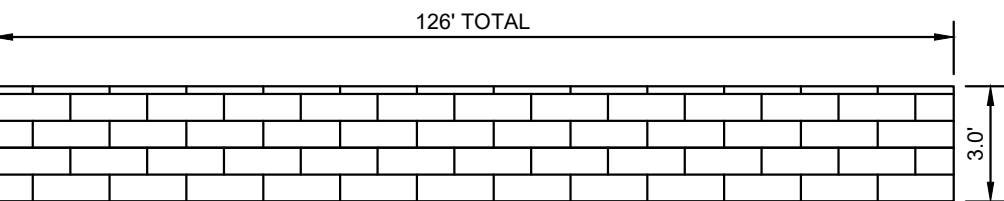

EXISTING CMU SCREENING WALL NTS

SITE ANALYSIS TABLE

BUILDING AREA	205,802 SF
PARKING REQUIRED (WALMART)	474 SPACES
EXISTING PARKING	1,005 SPACES
PARKING REMOVED	11 SPACES
PARKING PROPOSED	994 SPACES
PROPOSED RATIO	4.83 SPACES PER 1,000 SF
REQUIRED RATIO (WALMART)	2.3 SPACE PER 1,000 S.F.

NOTE:

1. PARKING CALCULATED PER CURRENT IDO STANDARDS TABLE 5-5-1 FOR ESTABLISHMENTS GREATER THAN 50,000 S.F. OF GFA AND DRIVE-THROUGH FACILITIES.
2. PER TABLE 5-5-1, NO PARKING IS REQUIRED FOR AUTOMATED TELLER MACHINES (ATM)

USE SPECIFIC STANDARDS COMPLIANCE

(4-3-F-5 OF IDO)

- A. EACH STACKING LANE IS LIMITED TO A MAXIMUM ORDER BOARD AREA OF 50 SQUARE FEET. THE FACE OF THE ORDER BOARDS SHALL BE ORIENTED AWAY FROM PUBLIC STREETS TO THE MAXIMUM EXTENT PRACTICABLE.  
JUSTIFICATION: THIS IS FOLLOWED. NO ORDER BOARD ASSOCIATED WITH ATM. ATM SCREEN IS LESS THAN 5 SQUARE FEET.
- B. THIS USE COMPLIES WITH THE PROVISIONS OF SECTION 14-16-5-5 (PARKING AND LOADING) AND SECTION 14-16-5-9 (NEIGHBORHOOD EDGES). PLEASE SEE PARKING TABLE (THIS SHEET). THIS SITE DOES NOT ABUT A PROTECTED LOT OR A REGULATED LOT.
- C. THIS USE IS NOT ACCESSORY TO CANNABIS RETAIL.
- D. THIS USE IS NOT WITHIN 330 FEET OF MAJOR PUBLIC OPEN SPACE. THE CLOSEST MAJOR PUBLIC OPEN SPACE IS LOCATED FURTHER THAN 330 FEET FROM THE SITE, WEST OF COORS BLVD SW.
- E. THIS USE IS NOT ADJACENT TO A MAJOR PUBLIC OPEN SPACE. THIS USE IS ADJACENT TO VARIOUS COMMERCIAL AND RETAIL USES.
- F. THIS USE IS NOT PROPOSED IN THE DOWNTOWN SMALL AREA, DOWNTOWN NEIGHBORHOOD AREA CPO-3, EAST DOWNTOWN CPO-4, EAST DOWNTOWN HPO-1, NOB HILL SMALL AREA, SAWMILL/WELLS PARK CPO-12, SOUTH YALE SMALL AREA, UNIVERSITY NEIGHBORHOODS SMALL AREA, UPTOWN SMALL AREA, VOLCANO HEIGHTS URBAN CENTER, AND VOLCANO MESA CPO-13 AS SPECIFIED IN THE IDO.

DISCLAIMER

THESE DRAWINGS WERE PRODUCED WITHOUT THE BENEFIT OF A CURRENT LAND SURVEY, ALL PROPERTY LINES, EASEMENTS, SETBACKS, EXISTING INFRASTRUCTURE AND TITLE DOCUMENTS SHALL BE VERIFIED PRIOR TO START OF CONSTRUCTION. KIMLEY-HORN AND FLITE BANKING CENTERS DO NOT GUARANTEE THE ACCURACY OF SAID PROPERTY LINES, EASEMENTS, SETBACKS, EXISTING INFRASTRUCTURE AND TITLE DOCUMENTS.

CONTRACTOR IS RESPONSIBLE FOR VERIFYING ALL FIELD CONDITIONS AND IS TO ALERT THE ENGINEER AND FLITE BANKING CENTERS OF ANY DISCREPANCIES PRIOR TO STARTING CONSTRUCTION. CONTRACTOR TO COORDINATE WITH FLITE BANKING CENTERS PM FOR ALL FINAL PLACEMENTS OF INFRASTRUCTURE.

USE SPECIFIC STANDARDS COMPLIANCE

(5-5-1 OF IDO)

1. VEHICLE STACKING SPACES ARE INTEGRATED INTO THE SITE LAYOUT AND DO NOT INTERFERE WITH SITE ACCESS POINTS, ACCESS TO PARKING OR LOADING SPACES OR AREAS, OR INTERNAL CIRCULATION AISLES AND SHALL COMPLY WITH STACKING SPACE DIMENSIONS REQUIRED BY THE DPM. VEHICLE STACKING SPACES ARE PROVIDED PURSUANT TO TABLE 5-5-8, AND OTHER STANDARDS IN THIS SUBSECTION 14-16-5-9(I). REQUIRED STACKING DISTANCES ARE MEASURED FROM THE END OF THE QUEUING LANE OR PROPERTY LINE TO THE POINT OF SERVICE, AS SPECIFIED IN TABLE 5-5-8.
- 2 (A). DRIVE-THROUGH LANES ADJACENT TO PUBLIC RIGHTS-OF-WAY ARE SCREENED BY A LANDSCAPE BUFFER AREA AT LEAST 6 FEET WIDE CONTAINING A VEGETATIVE SCREEN OR WALL CONSTRUCTED OF A MATERIAL SIMILAR IN TEXTURE, APPEARANCE, AND COLOR TO THE STREET-FACING FAÇADE OF THE PRIMARY BUILDING (BUT EXCLUDING EXPOSED CONCRETE MASONRY UNIT (CMU) BLOCK) AT LEAST 3 BUT NOT MORE THAN 4 FEET TALL. A LANDSCAPE BUFFER AREA IS PROVIDED AS REQUIRED ON THE PUBLIC STREET SIDE. IN ADDITION, A 3' SCREEN WALL IS PROVIDED BETWEEN THE SITE AND RIGHT OF WAY. PLEASE SEE EXISTING CMU DETAIL FOR FURTHER DETAILS OF EXISTING CMU SCREENING WALL.
- 2 (B). AUDIBLE ELECTRONIC DEVICES SUCH AS LOUDSPEAKERS, AUTOMOBILE SERVICE ORDER DEVICES, AND SIMILAR INSTRUMENTS ARE NOT AUDIBLE BEYOND THE PROPERTY LINE OF THE SITE. THE ATM DOES NOT HAVE SOUND OUTPUT.  
JUSTIFICATION: STANDARD FOLLOWED.
- 2 (C). DRIVE-THROUGH SERVICE WINDOWS SHALL BE ANGLED AT LEAST 45 DEGREES FROM PARALLEL WITH ANY ABUTTING LOT LINE OF A RESIDENTIAL ZONE DISTRICT SO THAT IT DOES NOT DIRECTLY FACE THE RESIDENTIAL LOT. THERE ARE NO SERVICE WINDOWS PROPOSED. ADDITIONALLY, THE USE IS NOT ABUTTING A RESIDENTIAL ZONE.
- 2 (D). THE SITE IS NOT WITHIN UC-MS-PT AREAS OR MX-H ZONE DISTRICT.
- 2 (E). THE SITE IS NOT WITHIN UC-MS-PT AREAS OR MX-H ZONE DISTRICT.
- 2 (F). DRIVE-THROUGH SERVICE WINDOWS AND ANY ASSOCIATED ORDER BOARD ARE LOCATED AT LEAST 50 FEET IN ANY DIRECTION FROM ANY ABUTTING RESIDENTIAL ZONE DISTRICT OR LOT CONTAINING A RESIDENTIAL USE IN ANY MIXED-USE ZONE DISTRICT. THE SITE IS NOT ABUTTING RESIDENTIAL ZONES OR USES. NO SERVICE WINDOWS PROPOSED.
- 2 (G). WHERE ABUTTING ANY RESIDENTIAL ZONE DISTRICT OR LOT CONTAINING A RESIDENTIAL USE IN ANY MIXED-USE ZONE DISTRICT, THE EDGE BUFFERING PROVISIONS OF SUBSECTION 14-16-5-6(E) (EDGE BUFFER LANDSCAPING) SHALL APPLY. THIS SITE DOES NOT BORDER ANY RESIDENTIAL ZONE DISTRICT.

IMAGE SOURCE: NEARMAP  
IMAGE DATE: 06/30/2023



GRAPHIC SCALE IN FEET  
0 2.5 5 10

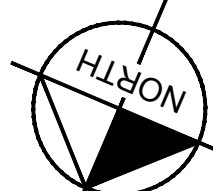

WALMART #5430 ATM ADDITION  
FLITE BANKING CENTERS, LLC  
CONSTRUCTION DOCUMENTS  
ALBUQUERQUE, NM

Kimley»Horn

6200 SOUTH SYRACUSE WAY, SUITE 300  
GREENWOOD VILLAGE, CO 80111  
Main: 615.564.2701 | www.kimley-horn.com  
© 2021 Kimley-Horn and Associates, Inc.



No.	DATE	BY	REVISIONS	DESCRIPTION	DATE	BY
1						
2						
3						
4						
5						
6						
7						
8						
9						
10						

DESIGNED BY: MGK  
DRAWN BY: MGK  
CHECKED BY: DNP  
DATE: 05/17/2024  
KIMLEY-HORN PROJECT NO. 196235022

SITE LAYOUT PLAN

SHEET NUMBER

C2-00



This document, together with the concepts and designs presented herein, is intended only for the specific purpose and client for which it was prepared. Reuse of and improper reliance on this document without written authorization and adaptation by Kimley-Horn and Associates, Inc. shall be without liability to Kimley-Horn and Associates, Inc.

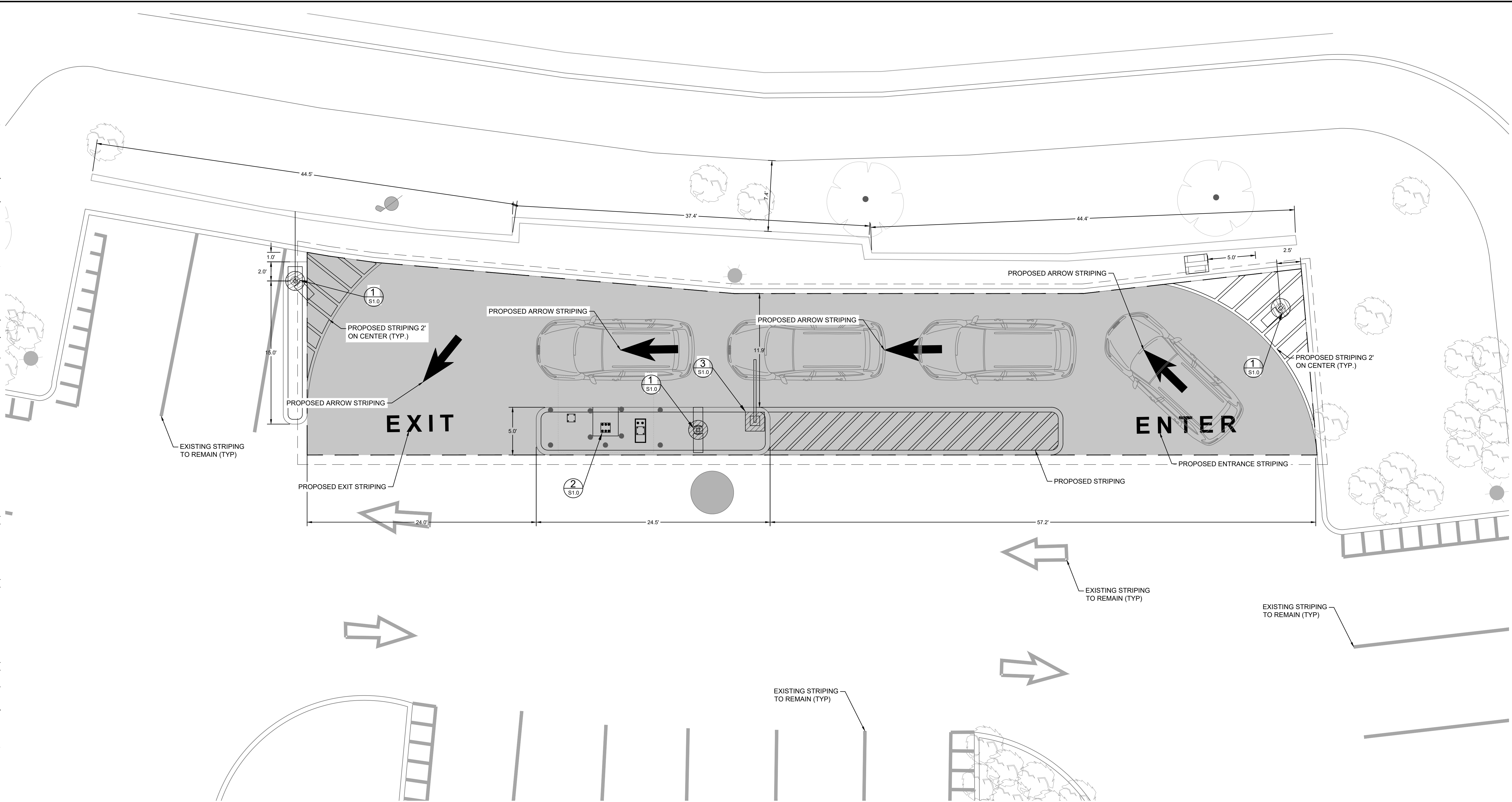

#### NOTES

1. STRIPING ON ALL CURBS, PAVEMENT, AND TRAFFIC ARROWS SHALL BE PAINTED WHITE.
2. LETTERING "ENTER" AND "EXIT" SHALL BE PAINTED WHITE.
3. CONTRACTOR SHALL MAINTAIN EXISTING DRAINAGE PATTERNS.
4. CONTRACTOR SHALL ENSURE A SMOOTH TRANSITION TO EXISTING GRADES.

#### GRADING NOTES

1. DISTURBED AREAS LEFT IDLE FOR FIVE DAYS, AND NOT TO FINAL GRADE, WILL BE ESTABLISHED TO TEMPORARY VEGETATION. MULCH, TEMPORARY VEGETATION OR PERMANENT VEGETATION SHALL BE COMPLETED ON ALL EXPOSED AREAS WITHIN 14 DAYS AFTER DISTURBANCE. ALL AREAS TO FINAL GRADE WILL BE ESTABLISHED TO PERMANENT VEGETATION UPON COMPLETION.
2. WHEN HAND PLANTING, MULCH (HAY OR STRAW) SHOULD BE UNIFORMLY SPREAD OVER SEEDED AREA WITHIN 24 HOURS OF SEEDING. IF UNABLE TO ACCOMPLISH, MULCH SHALL BE USED AS A TEMPORARY COVER. CONCENTRATED FLOW AREAS AND ALL SLOPES STEEPER THAN 2.5:1 AND WITH A HEIGHT OF TEN FEET OR GREATER (DOES NOT APPLY TO RETAINING WALLS), AND CUTS AND FILLS WITHIN BUFFERS, SHALL BE STABILIZED WITH THE APPROPRIATE EROSION CONTROL MATTING OR BLANKETS.
3. THE ESCAPE OF SEDIMENT FROM THE SITE SHALL BE PREVENTED BY THE INSTALLATION OF EROSION AND SEDIMENT CONTROL MEASURES AND PRACTICES PRIOR TO, OR CONCURRENT WITH, LAND-DISTURBING ACTIVITIES.
4. SEED ALL DISTURBED AREAS UNLESS OTHERWISE NOTED AS PART OF THIS CONTRACT.
5. THE CONTRACTOR SHALL DETERMINE THE EXACT LOCATION OF ALL EXISTING UTILITIES BEFORE COMMENCING WORK AND AGREES TO BE RESPONSIBLE FOR ANY AND ALL DAMAGES WHICH MIGHT RESULT FROM THE CONTRACTOR'S FAILURE TO EXACTLY LOCATE AND PRESERVE ANY UNDERGROUND UTILITIES TO REMAIN. THE CONTRACTOR IS TO NOTIFY ENGINEER IMMEDIATELY OF ANY DISCREPANCIES AND/OR CONFLICTS WITH EXISTING OR PROPOSED UTILITIES PRIOR TO PROCEEDING.
6. STOCKPILED TOPSOIL OR FILL MATERIAL IS TO BE TREATED SO THE SEDIMENT RUN-OFF WILL NOT CONTAMINATE SURROUNDING AREAS OR ENTER NEARBY STREAMS. STOCK PILE LOCATIONS SHALL BE COORDINATED WITH THE ENGINEER PRIOR TO GRADING ACTIVITIES. EROSION & SEDIMENT CONTROL PRACTICE SHALL BE INSTALLED PRIOR TO STOCKPILE OPERATIONS.
7. CONSTRUCT SILT BARRIERS BEFORE BEGINNING GRADING OPERATIONS.
8. MULCH AND SEED ALL DISTURBED AREAS AS SOON AS POSSIBLE AFTER FINAL GRADING IS COMPLETED (WITHIN 15 DAYS OF ACHIEVED FINAL GRADES) UNLESS OTHERWISE INDICATED. CONTRACTOR SHALL TAKE WHATEVER MEANS NECESSARY TO ESTABLISH PERMANENT SOIL STABILIZATION. STEEP SLOPES (GREATER THAN 3:1) SHALL BE STABILIZED WITHIN 7 DAYS OF FINAL GRADING.
9. PROVIDE TEMPORARY CONSTRUCTION ACCESS(ES) AT THE POINT(S) WHERE CONSTRUCTION VEHICLES EXIT THE CONSTRUCTION AREA. MAINTAIN PUBLIC ROADWAYS FREE OF TRACKED MUD AND DIRT.
10. DO NOT DISTURB VEGETATION OR REMOVE TREES EXCEPT WHEN NECESSARY FOR GRADING PURPOSE.

LEGEND	
	LOCATION OF PROPOSED PIERS
	SAW CUT LINE
	CONSTRUCTION LINE

#### DISCLAIMER

THESE DRAWINGS WERE PRODUCED WITHOUT THE BENEFIT OF A CURRENT LAND SURVEY. ALL PROPERTY LINES, EASEMENTS, SETBACKS, EXISTING INFRASTRUCTURE AND TITLE DOCUMENTS SHALL BE VERIFIED PRIOR TO START OF CONSTRUCTION. KIMLEY-HORN AND FLITE BANKING CENTERS DO NOT GUARANTEE THE ACCURACY OF SAID PROPERTY LINES, EASEMENTS, SETBACKS, EXISTING INFRASTRUCTURE AND TITLE DOCUMENTS.

CONTRACTOR IS RESPONSIBLE FOR VERIFYING ALL FIELD CONDITIONS AND IS TO ALERT THE ENGINEER AND FLITE BANKING CENTERS OF ANY DISCREPANCIES PRIOR TO STARTING CONSTRUCTION. CONTRACTOR TO COORDINATE WITH FLITE BANKING CENTERS PM FOR ALL FINAL PLACEMENTS OF INFRASTRUCTURE.

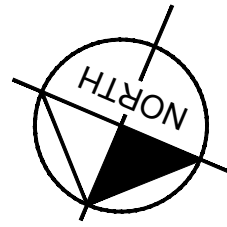

WALMART #5430 ATM ADDITION  
FLITE BANKING CENTERS, LLC  
CONSTRUCTION DOCUMENTS  
ALBUQUERQUE, NM



REVISIONS		DATE	BY
REVISION DESCRIPTION		dd/mm/yyyy	xxx
No.	1		
	2		
	3		
	4		
	5		
	6		
	7		
	8		
	9		
	10		
DESIGNED BY:		MGK	
DRAWN BY:		MGK	
CHECKED BY:		DNP	
DATE:		05/17/2024	
KIMLEY-HORN PROJECT NO. 196235022			
PIER, PAINTING & STRIPING PLAN			
SHEET NUMBER <b>C2-10</b>			

Kimley»Horn

6200 SOUTH SYRACUSE WAY, SUITE 300  
GREENWOOD VILLAGE, CO 80111  
Main: 615.564.2701 | www.kimley-horn.com

© 2021 Kimley-Horn and Associates, Inc.

