

VICINITY MAP  
R-15, 16, S-16

**TYPICAL LOT TEMPORARY STABILIZATION WILL CONSIST OF EARTH BERMS AND CUT BACK CURBS. SUBDIVISION HAS PERIMETER WALLS IN PLACE. INLETS SHALL BE PROTECTED AT ALL TIMES DURING ACTIVE CONSTRUCTION. FUTURE LOTS WILL BE ADDED WHEN PURCHASED WITHIN THE PROJECT BOUNDARY.**

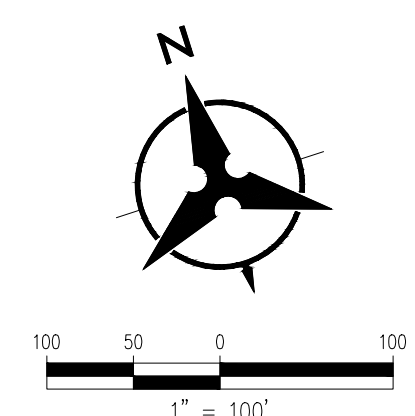
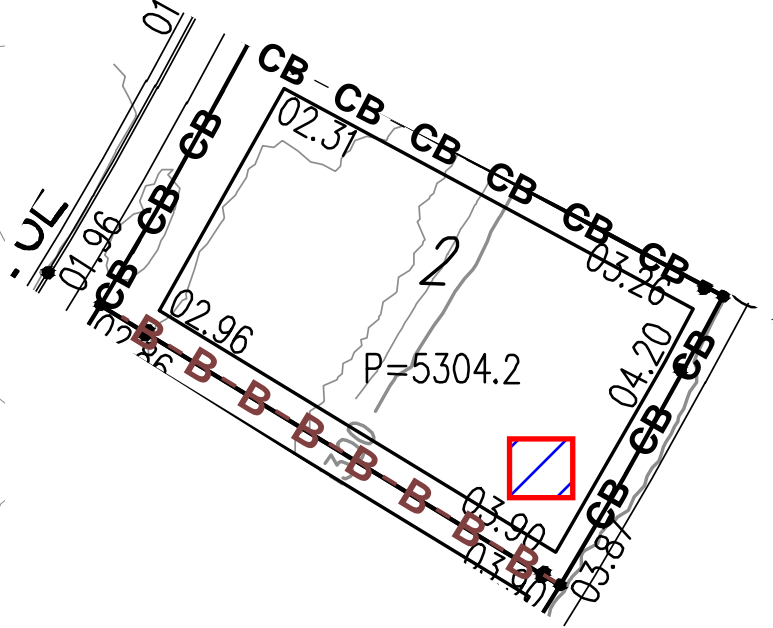

09/16/2020  
CPESC Stamp

LEGEND

TEMPORARY EROSION AND SEDIMENT CONTROL PLAN

**PB -PB -PB -PB** PROJECT PERIMETER & DISTURBED AREA

**-B -B -B -B** EARTH BERM

**CB -CB -CB -** CUT BACK CURB

FLOW DIRECTION

STAGING AREA

STABILIZED CONSTRUCTION ENTRANCE

TRASH RECEPTACLE

CHEMICAL TOILET

CONCRETE WASHOUT

RETENTION POND

RIP RAP

CHECK DAM

DROP INLET PROTECTION

OUTFALL

POSTING SIGN

PRESERVED VEGETATION

LOTS IN PLAN

RECEIVING WATERS: <b>UNNAMED POND</b>	
CRITICAL HABITAT: <b>CRITERION "A": NO CRITICAL HABITATS WITHIN PROJECT AREA</b>	
GPS LOCATION: <b>34.9842, -106.6155</b>	
<b>MESA DEL SOL, MONTAGE UNIT 3B</b> PROJECT TITLE	
<b>ALBUQUERQUE, BERNALILLO COUNTY, NM</b> CITY, COUNTY, STATE	
<b>09/16/2020</b> DATE	
<b>C. DURKIN</b> DRAWN BY	



INLET PROTECTION

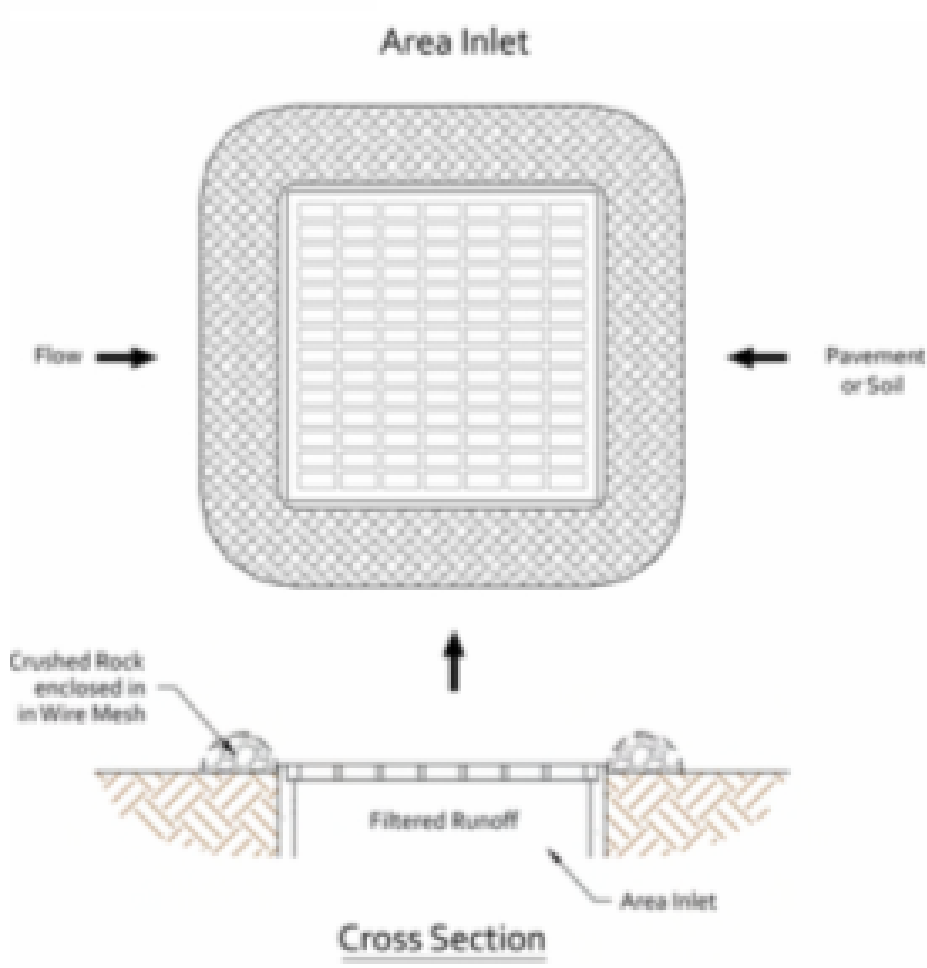

BMP Objectives

- Sediment Control
- Sheet Flow Runoff Control

SILT FENCE



BMP Objectives

- Sediment Control
- Sheet Flow Runoff Control
- Wind Erosion Control

MULCH SOCK/STRAW WATTLE



BMP Objectives

- Sediment Control
- Reduce Runoff Velocity
- Inlet Protection

EROSION CONTROL NOTES  
ESC Plan Standard Notes (2020-06-03)

- 1.All Erosion and Sediment Control (ESC) work on these plans, except as otherwise stated or provided hereon shall be permitted, constructed, inspected, and maintained in accordance with:
- a.The City Ordinance § 14-5-2-11, the ESC Ordinance,
  - b.The EPA's 2017 Construction General Permit (CGP), and
  - c.The City Of Albuquerque Construction BMP Manual.
- 2.All BMP's must be installed prior to beginning any earth moving activities except as specified hereon in the Phasing Plan. Construction of earthen BMP's such as sediment traps, sediment basins, and diversion berms shall be completed and inspected prior to any other construction or earthwork. Self-inspection is required after installation of the BMPs and prior to beginning construction.
- 3.Self-inspections - At a minimum a routine compliance self-inspection is required to review the project for compliance with the Construction General Permit once every 14 days and after any precipitation event of 1/4 inch or greater until the site construction has been completed and the site determined as stabilized by the city. Reports of these inspections shall be kept by the person or entity authorized to direct the construction activities on the site.
- 4.BMPs shall be inspected and maintained until all disturbed areas are stabilized in accordance with the Final Stabilization Criteria (CGP 2.2.14.b). Generally, all disturbed areas, other than structures, must have uniform perennial vegetation that provides 70 percent or more of the cover provided by native vegetation or seed the disturbed area and provide non-vegetative mulch that provides cover for at least three years without active maintenance. Final stabilization must be documented on prior to removal of BMPs and discontinuation of inspections.

SEDIMENT TRACK OUT CONTROL



BMP Objectives

- Sediment Control

BERMS AND SWALES



BMP Objectives

- Runoff Control
- Run-on Diversion

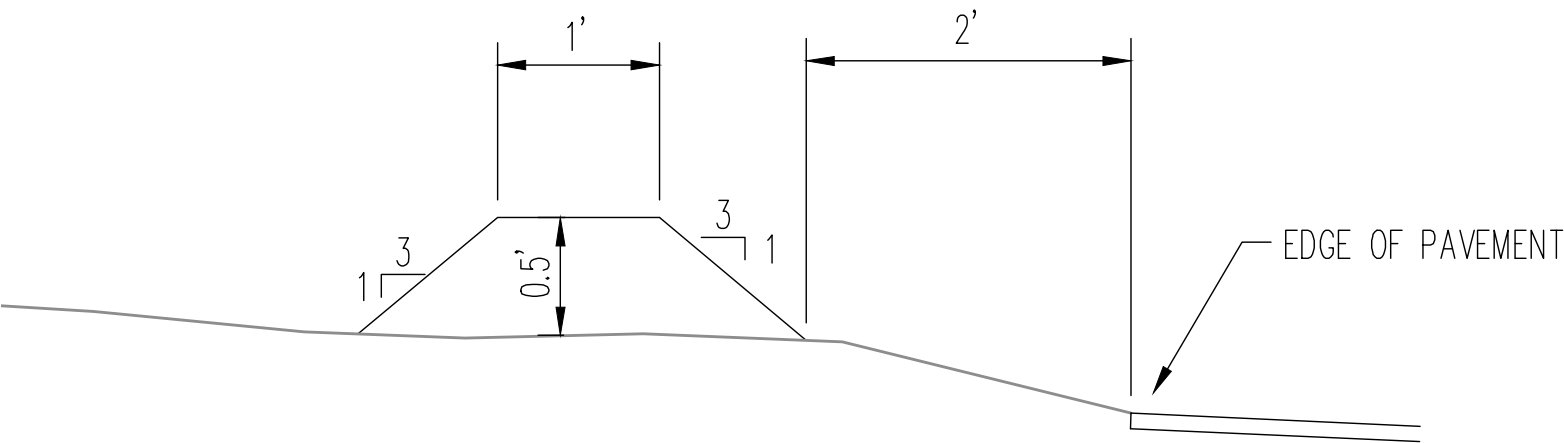

SECTION A-A  
TYPICAL TEMPORARY BERM  
NOT TO SCALE

RECEIVING WATERS: UNNAMED POND	
CRITICAL HABITAT: CRITERION"A": NO CRITICAL HABITATS WITHIN PROJECT AREA	
GPS LOCATION: 34.9842, -106.6155	
MESA DEL SOL, MONTAGE UNIT 3B	
PROJECT TITLE	
ALBUQUERQUE, BERNALILLO COUNTY, NM	
CITY, COUNTY, STATE	
09/16/2020	DATE
C. DURKIN	DRAWN BY



09/16/2020  
CPESC Stamp